

FLEXSTEEL®

Power Reclining Loveseat with Console, Power Headrest, Lumbar, Heat & Massage

IMPORTANT NOTE

Read these instructions carefully and familiarize yourself with each procedure before assembling the furniture. Check that you have all the component parts and familiarize yourself with each part before proceeding.

Take all the fittings out of the plastic bag and separate them into groups. Ensure you have enough space to lay out all the parts before assembly. To prevent damage to the parts, we recommend that you assemble the unit on a soft, level surface.

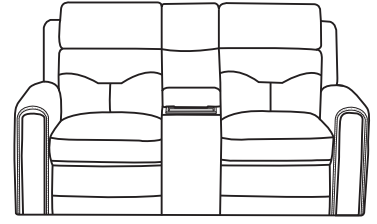

Part List

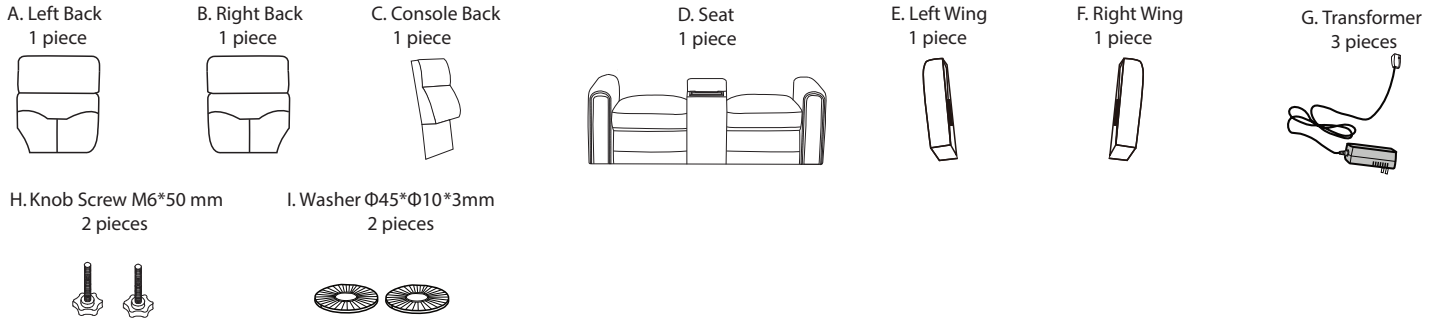

Assembly Instructions

STEP 1

Detach the Console Back (C), Transformers (G), Wings (E F) and Hardware (H I) from the bottom of the Seat (D). (See Figure 1.)

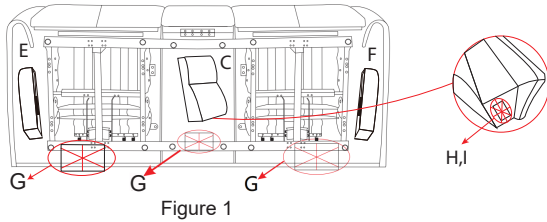

Figure 1

STEP 3

Zip the fabric on the bottom of the Backs (A B) with the back of the Seat (D). (See Figure 3.)

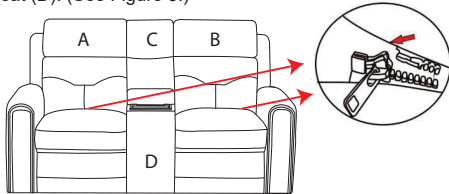

Figure 3

STEP 5

Fasten the back flaps to the bottom of the furniture. (See Figure 5.)

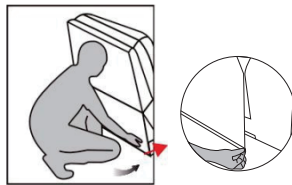

Figure 5

STEP 2

Attach the Console Back (C) to the Seat (D) by inserting the Knob Screws (H) and Washers (I) through the two holes on the top of the console base of the Seat (D) from underneath. Set the Console Back (C) on top of the console base, and rotate the Knob Screws (H) by hand clockwise until the Console Back (C) is tight. Attach the Backs (A B) to the Seat (D), Left Wing (E) to the Left Back (A), Right Wing (F) to the Right Back (B). Ensure the latches fit well. (See Figure 2.)

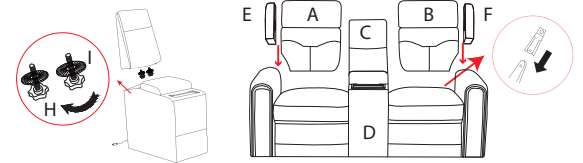

Figure 2

STEP 4

Flip up the back flaps, connect the Headrest, Switch and Air Massage cables between the Backs (A B) and the Seat (D). (See Figure 4.)

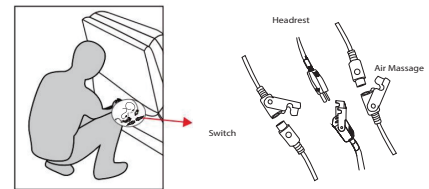

Figure 4

STEP 6

Connect all three of the power cables from the bottom of the Seat (D) to a Transformer (G), then plug the Transformers (G) into the nearby outlets. (See Figure 6.)

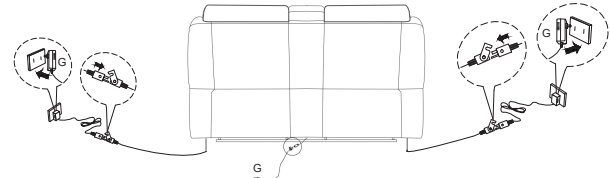

Figure 6

Disassembly Instructions

Unzip the zipper between Backs (A B) and Seat (D), then disconnect all the cables. Pull up the spring leaf in bracket, then lift Backs (A B) up. (See Figure 7.)

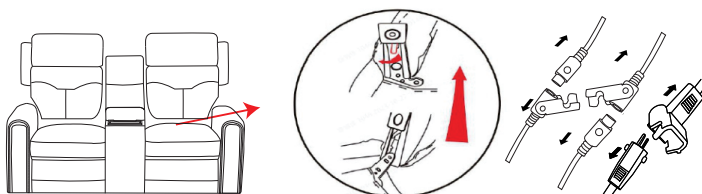

Figure 7

Remove the Knob Screws (H) by rotating them counter-clockwise until they are free. Pull the Console Back (C) up. (See Figure 8.)

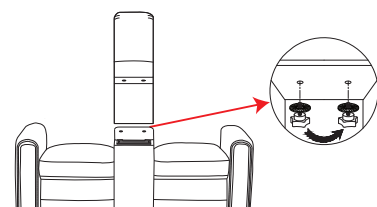
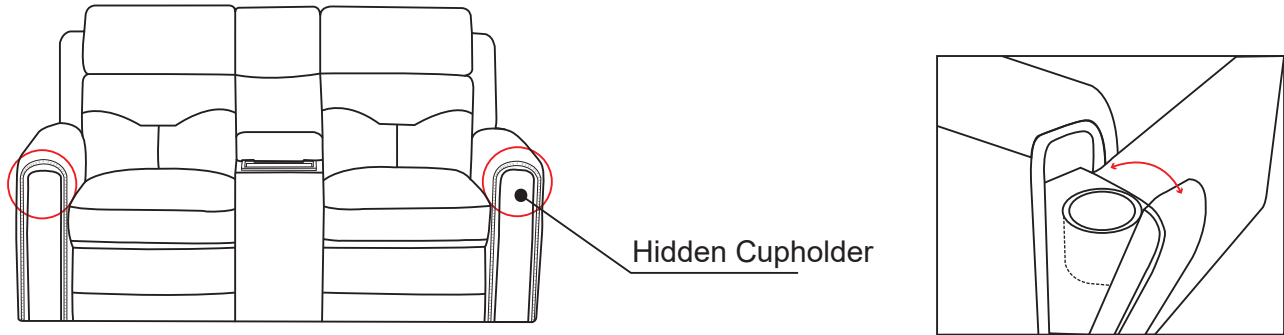
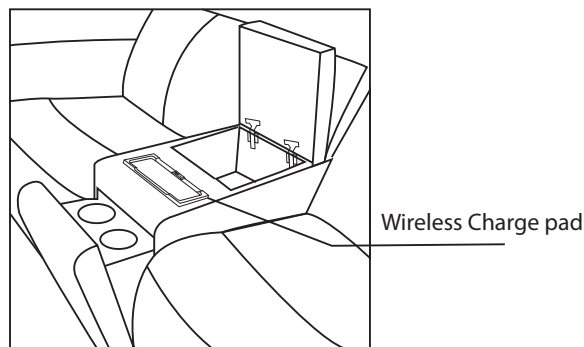

Figure 8

Hidden Cup Holder



Wireless Charging Pad



User Guide for Wireless Charger

Attention



1. It is common for heat to be generated in wireless charging through the energy transfer process. This is part of the normal wireless energy transfer.
2. Phone should be centered on the wireless charging icon if an icon is present. The further the current must travel, charging efficiency is reduced and more energy is lost to heat.
3. Phone should be centered on the tray if an icon is not present. The further the current must travel, charging efficiency is reduced and more energy is lost to heat.
4. Make sure there aren't any foreign objects on the charger when charging. This can cause the charger to start stop multiple times if the foreign object detector senses an object.
5. Make sure to disconnect the phone from Apps and WiFi during wireless charging while charging and don't use the phone while wireless charging.
6. Do not attempt to charge a device that is in a case with any metal components on the back. The metal components can interfere with the charging and become hot to the touch.
7. Note that charging devices with thick cases on them may reduce charging speeds and increase heat production. The further the current must travel, charging efficiency is reduced and more energy is lost to heat.

IMPORTANT NOTE

- To avoid any risk of suffocation to children or pets, dispose of all plastic bags immediately.
- To ensure proper performance, occasionally check for loose hardware and tighten as needed.
- If the reclining functions are not working properly, check for loose cable connections before contacting the retailer.