

USB 2.0 to 2.5/3.5" SATA HDD Docking Station SATHDDOCKU2

Introduction

Thank you for purchasing a StarTech.com Hard Drive Docking Station. This innovative device allows for simple installation of 2.5" or 3.5" SATA (I or II) Hard drives, without having to open the host computer case, or install the drive in an enclosure.

Features

- USB Bus-powered operation
- Compliant with USB 2.0 / USB 1.1 standards

System Requirements

- A USB 2.0 enabled computer (for maximum data transfer speed)
- Operating system requirement:
Windows ME, 2000, XP, Vista™;
Mac OS X and up; Linux

Package Contents

This package should contain:

- 1 x USB hard drive docking station
- 1 x Power adapter
- 1 x USB cable
- 1 x Hardware Guide

Hardware Guide

Top View

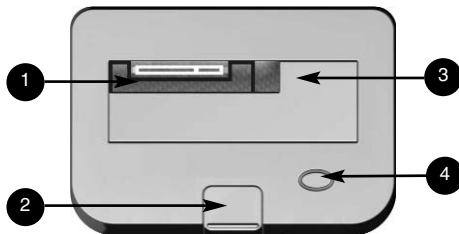

Rear View

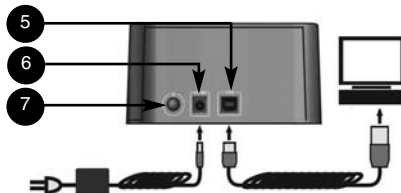

Front View



- 1 Drive Ejector (internal)
- 2 Drive Ejector Button
- 3 Drive Slot Cover
- 4 Drive Power / Activity Indicator
- 5 USB Port (to host PC)
- 6 DC Power Jack
- 7 Power Button
- 8 Installed 2.5" Drive
- 9 Installed 3.5" Drive

Disk Installation



Please Note: Hard drives require careful handling, especially when being transported. If you are not careful with your hard disk, lost data may result. Always handle your hard drive and storage device with caution.



WARNING: Hard drives, like all computer equipment can also be severely damaged by static electricity. Be sure that you are properly grounded before touching the hard drive you wish to install. StarTech.com recommends that you wear an anti-static strap when installing any computer equipment. If an antistatic strap is unavailable, discharge yourself of any static electricity build-up by touching a large grounded metal surface (such as the computer case) for several seconds.

Side View

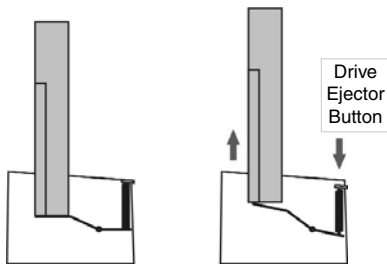

1. Connect the Dock to an available power outlet, using the provided power adapter.
2. Connect the Dock to the (powered) Host Computer, using the provided USB cable.
3. Insert the 2.5" or 3.5" SATA/SATA II drive you wish to install, such that the SATA power and data connectors at the back of the drive are properly aligned with the corresponding connectors inside the Dock.
4. Press the Power Button on the rear panel of the Dock

Once the drive has been inserted, the operating system will detect that it has been connected and automatically update the drivers for proper operation.

Safe Drive Removal

When removing the installed drive from the Dock, please ensure that you have followed the appropriate steps (dependant on operating system) to disconnect removable storage. In Windows for example, click on the **Safe Remove** icon located in the taskbar (pictured below). Select the drive from the menu provided, then click **Stop**. Select the device to disconnect, and click **OK**.



Specifications

Connectors	1 x USB Female (type B) 1 x DC IN (Power) 1 x SATA Power 1 x SATA Data
Certifications	FCC, CE, ROHS
Dimensions	130x90x65mm (L x W x H) 5.1 x 3.5 x 2.5" (L x W x H)
Weight	590g (20.8oz)

Support, Warranty Information, and Regulatory Compliance Statement

If you ever need help with your product, visit www.startech.com/support and access our comprehensive selection of online tools, documentation, and downloads. This product is backed by a one year warranty. In addition, StarTech.com warrants its products against defects in materials and workmanship for the periods noted, following the initial date of purchase. During this period, the products may be returned for repair, or replacement with equivalent products at our discretion. The warranty covers parts and labor costs only. StarTech.com does not warrant its products from defects or damages arising from misuse, abuse, alteration, or normal wear and tear.

Limitation of Liability

In no event shall the liability of StarTech.com Ltd. and StarTech.com USA LLP (or their officers, directors, employees or agents) for any damages (whether direct or indirect, special, punitive, incidental, consequential, or otherwise), loss of profits, loss of business, or any pecuniary loss, arising out of or related to the use of the product exceed the actual price paid for the product. Some states do not allow the exclusion or limitation of incidental or consequential damages. If such laws apply, the limitations or exclusions contained in this statement may not apply to you.

FCC Compliance Statement

This equipment has been tested and found to comply with the limits for a Class B digital device, pursuant to part 15 of the FCC Rules. These limits are designed to provide reasonable protection against harmful interference in a residential installation. This equipment generates, uses and can radiate radio frequency energy and, if not installed and used in accordance with the instructions, may cause harmful interference to radio communications. However, there is no guarantee that interference will not occur in a particular installation. If this equipment does cause harmful interference to radio or television reception, which can be determined by turning the equipment off and on, the user is encouraged to try to correct the interference by one or more of the following measures:

- Reorient or relocate the receiving antenna.
- Increase the separation between the equipment and receiver.
- Connect the equipment into an outlet on a circuit different from that to which the receiver is connected.
- Consult the dealer or an experienced radio/TV technician for help.