

NOTE

- **DO NOT** connect low-voltage LED linear fixtures to high-voltage power.
- Do not over tighten any screws.
- Maintain polarity on all connections, Red wire to (+, DC12V, DC24V, or WW) and Black wire to (-, GND, or CW).

Tools Needed

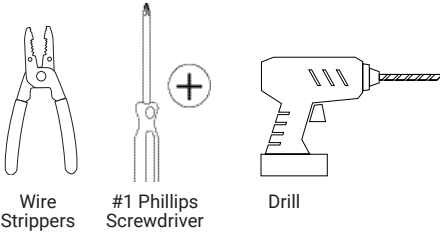

Product Legend

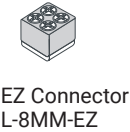

Step 1. Connecting wire to the EZ Connectors on the fixture

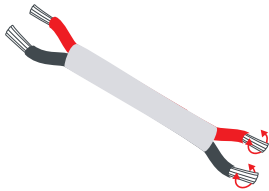

1. Use wire strippers to strip wire 1/4", then twist ends.
NOTE: wires may be folded over after being twisted, but it is not required.

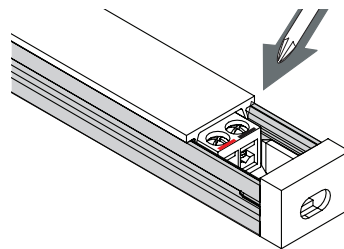

2. Remove frosted lens from the fixture. Use #1 Philips to loosen the 2 outer terminal screws on the EZ Connector.
NOTE: DO NOT loosen the two inner terminal screws.

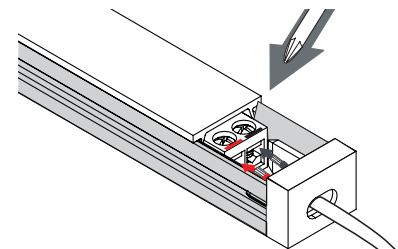

3. Insert low voltage wires from power supply through the end cap hole (if end cap is being used). Connect wire into outer terminal. Red wire to (+, DC24V, or WW) side marked in red, Black wire to (-, GND, or CW) side of tape marked in black; tighten screws. Replace frosted lens onto fixture.

Step 2. Secure housing to mounting surface

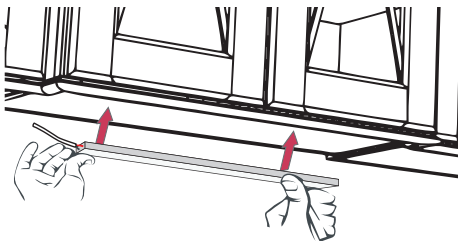

1. Center the fixture in the outer mounting space. Measure 1/2" from each end of fixture for mounting clip placement. Use provided screws to secure clip to mounting surface.
NOTE: When installing a fixture 30" and longer, center the third mounting clip between these.

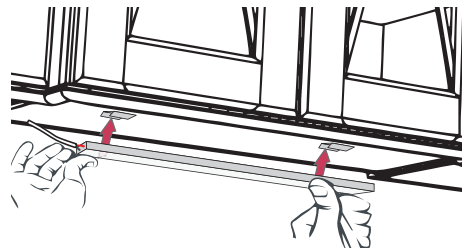

2. Snap fixture into mounting clips.

Follow instructions included in receiver or controller to properly hook up LED Linear Fixture system.

NOTE

- **DO NOT** connect low-voltage LED linear fixtures to high-voltage power.
- Do not over tighten any screws.
- Maintain polarity on all connections, Red wire to (+, DC12V, DC24V, or WW) and Black wire to (-, GND, or CW).

Tools Needed

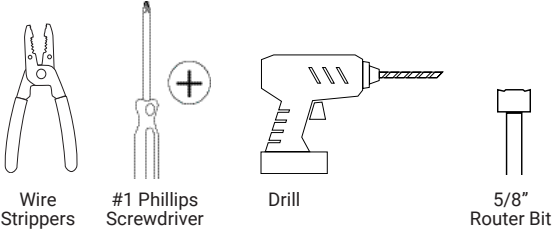

Product Legend



EZ Connector
L-8MM-EZ

Step 1. Route a Groove for the Fixture

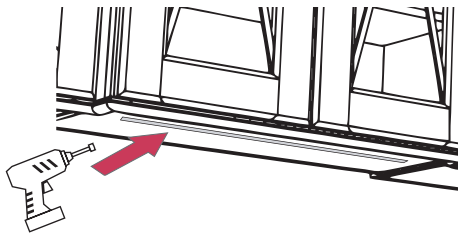

1. Using a 5/8" router bit, hollow out a groove (the length of the fixture) from cabinet or shelf bottom where the fixture will go. Square off router groove with chisel if needed.

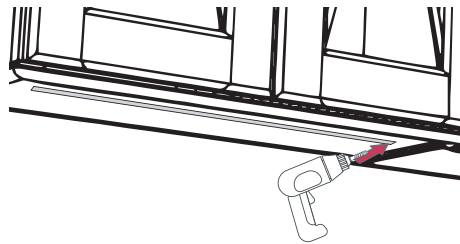

2. Drill a 1/4" hole at either end of the groove to run wire through.

Step 2. Connecting wire to the EZ Connectors on the fixture

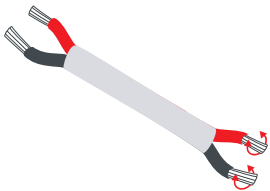

1. Use wire strippers to strip wire 1/4", then twist ends. **NOTE: wires may be folded over after being twisted, but it is not required.**

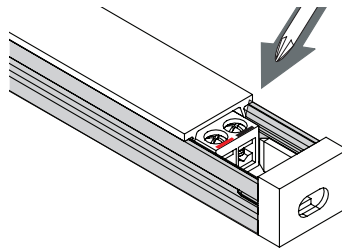

2. Remove frosted lens from the fixture. Use #1 Philips to loosen the 2 outer terminal screws on the 8MM-EZ Connector. **NOTE: DO NOT** loosen the two inner terminal screws.

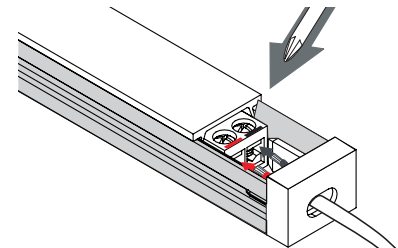

3. Run wires through pre-drilled hole at either end of the routed groove in the mounting surface. Insert low voltage wires from power supply through the end cap hole (if end cap is being used). Connect wire into outer terminal. Red wire to (+, DC24V, or WW) side marked in red, Black wire to (-, GND, or CW) side of tape marked in black; tighten screws. Replace frosted lens onto fixture.

Step 3. Insert Fixture into Groove

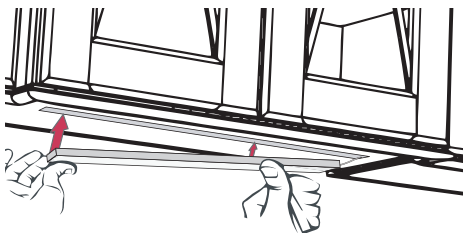

1. Insert fixture up into the groove. Fixture will fit tight. Press along the length of the fixture to ensure fixture is secure in groove.

Follow instructions included in receiver or controller to properly hook up LED Linear Fixture system.