

TECHNICAL INFORMATION

Mounting	Recessed
Voltage	12V–24V
Watts	30-watts at 12-volts 60-watts at 24-volts
Max Amps	2.5
Cord Length	19"
Environment	Dry location
Construction Material	Plastic
Warranty	3 years

PART NUMBER	DESCRIPTION	DIMENSIONS
T-TDS-R	12V–24V LED touch dimmer switch, recessed mount	2-1/4" x 29/64"

Tools Needed

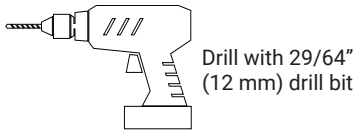

NOTE

- DO NOT connect low-voltage touch dimmer to high-voltage power.
- Cutting barrel plugs off recessed touch dimmer switch voids warranty.
- For a snug installation, use a 29/64" (12 mm) drill bit. If using a larger drill bit, an adhesive may be required.

INSTALLATION INSTRUCTIONS

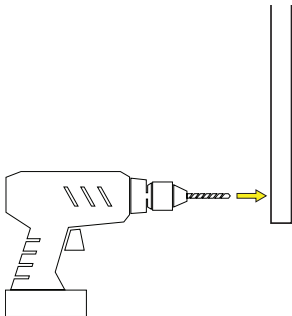

1. Drill hole in desired installation location.

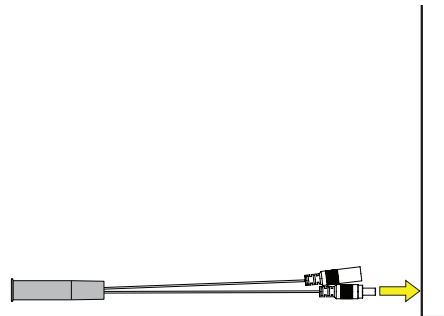

2. Run wires through hole and insert touch dimmer switch into hole.

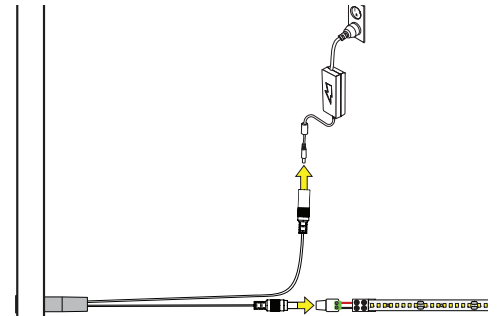

3. Insert male plug from power supply into female plug on touch dimmer switch. Insert male plug on touch dimmer switch into a female barrel connector that is wired to the lighting.
NOTE: The female barrel connector can be borrowed from a plug-in power supply.

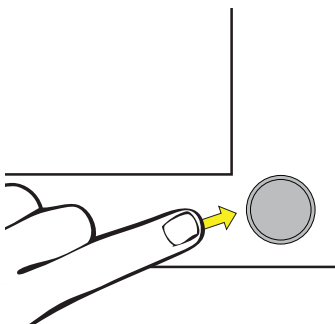

4. A quick touch and release will turn the lights on/off. Touch and hold with increase or decrease the light output.

Follow instructions included in LED Lighting to properly hookup lighting system.