

## Wireless Controller Kit Includes:



Tunable-White Series  
Tape Lighting  
L-T600-16-MW



WAV Smart Receiver/  
Power Supply  
T-TWAV-60W-PSR

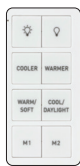

Tunable-White  
Wireless Controller  
T-T-1Z-WC-RF-WT



(12) Tape Light to  
Wire Connectors  
L-8MM-EZ6PK-W



20 Gauge  
Stranded Wire  
T-CW20G-STR-25

## Overview of WAV Smart Receiver Hookup Diagram

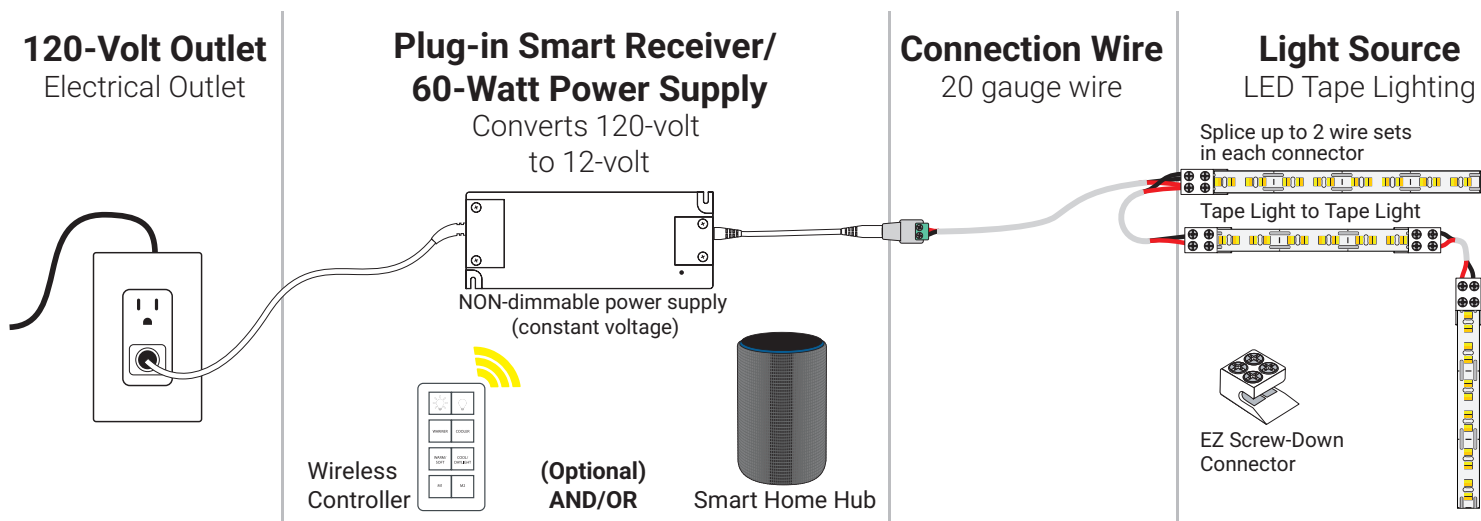
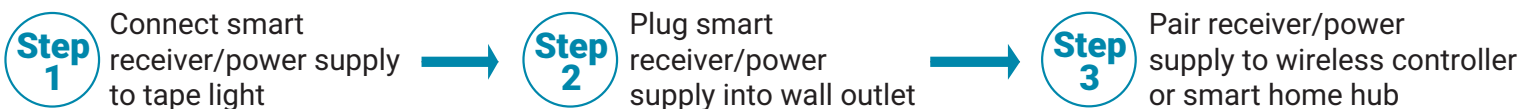

## Tools Needed

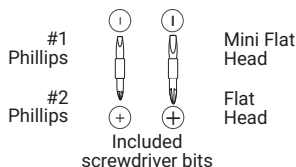
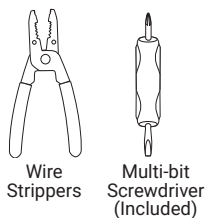

## Product Legend

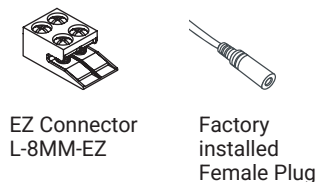

## NOTE

- **DO NOT** connect low-voltage LED tape light to high-voltage power.
- Do not over tighten any screws.
- Maintain polarity on all connections, Red to (WW+) and Black to (CW-).
- Maximum 32.8 feet of Tape Light can be connected together.
- For shorter lengths of Tape Light, cut with scissors at cut marks where a black line runs through 2 solder points  
– **CUT AT DESIGNATED CUT LINES ONLY**

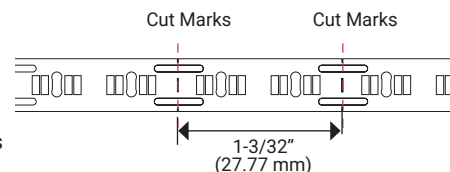

## Step 1. Connect Receiver to Tape Light with 8MM-EZ Connector

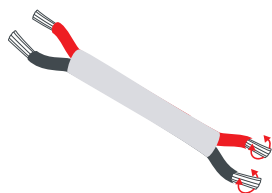

1. Cut a length of connection wire to run from Receiver to Tape Light location. Strip 1/4" insulation from both ends of wire, twist each wire, and fold stripped wires in half.

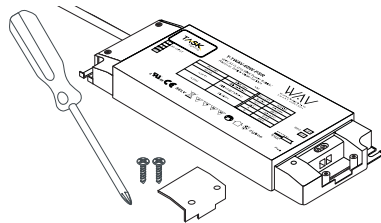

2. Use #2 Phillips to loosen screw and remove cover from WAV Smart Receiver/Power Supply. Use the flat head from the multi-bit screwdriver to loosen one terminal marked (CW-) and one marked (WW+).

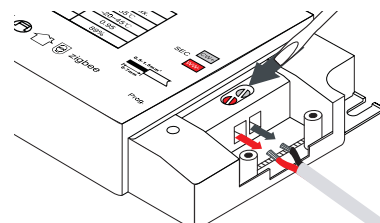

3. Insert one end of stripped wires into WAV Smart Receiver LED Terminals, Red wire to (WW+) and Black wire to (CW-) terminals. Tighten screws.

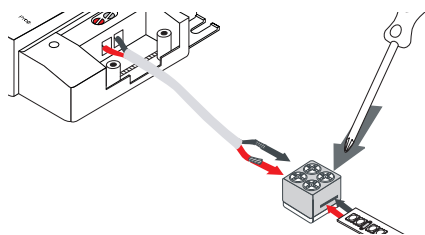

4. Use #1 Phillips to loosen the 4 terminal screws on 8MM-EZ Connector. Peel 1/2" of the adhesive protector from back of LED tape light, and scrape waterproof coating, insert into connector, evenly tighten screws. Insert wires from WAV Smart Receiver/Power Supply into terminals, Red wire to (+ or WW) side of tape, Black wire to (- or CW) side of tape; tighten screws.

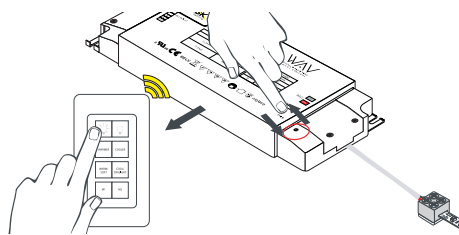

5. Plug WAV Smart Receiver/Power Supply into 120V receptacle and pair to Controller.

## Step 2. Mount Tape Light

For fuller countertop coverage, install the Tape Light 1-1/2" from the back of the cabinet face frame or light rail.

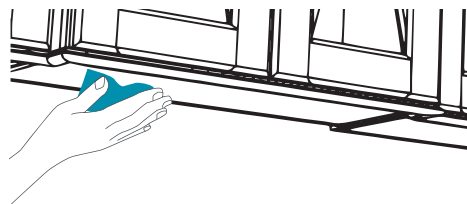

1. Make sure mounting surface is clean, dry, oil-free, and dust-free. Using the Adhesion Promoter Wipes will ensure an extra tight bond to surface.

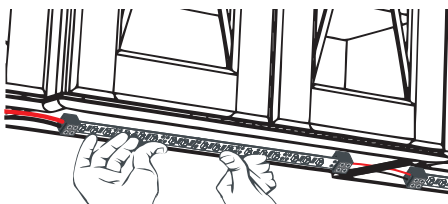

2. Peel the adhesive backing from the Tape Light and mount directly to cleaned surface. Use adhesive pads for securing the connectors to surface.

## Step 3. Pair Receiver to Wireless Controller

Pairing Instructions – if pairing to a Smart Home Hub, visit [www.Vimeo.com/Channels/WAVSmartControl](http://www.Vimeo.com/Channels/WAVSmartControl)

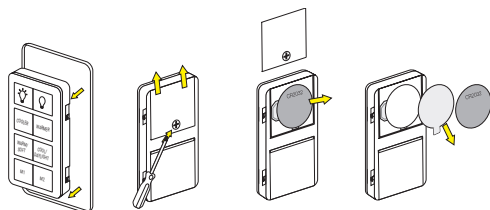

1. Remove Controller from back plate. Use included screw driver to remove screw, slide battery compartment open, remove battery, and discard clear plastic tab. Reinsert battery, replace cover, and screw down.

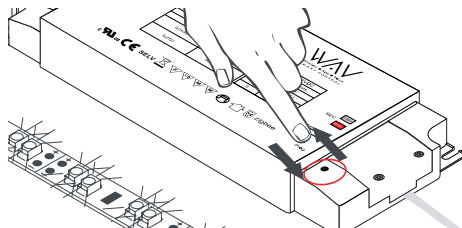

2. If setting the receiver up for the first time, clear the memory by pressing and holding the "Prog." button until the lights blink.

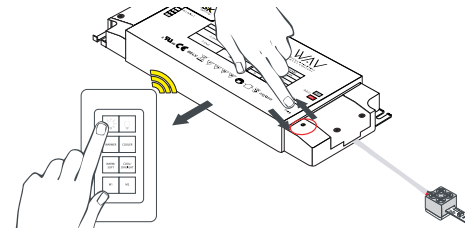

3. Very quickly, click and release the "Prog." button and, within 5 seconds, quickly click and release the "ON Lightbulb" button on the Controller. When lights blink once, Controller and Receiver are paired.

**NOTE:** when pairing additional controllers to the same receiver, DO NOT clear the memory.