

# ASSEMBLY INSTRUCTIONS

## COUNTER HEIGHT CHAIR

**A** Back Leg Frame

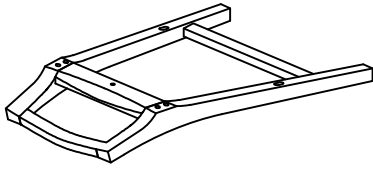

1 PC

**B** Seat

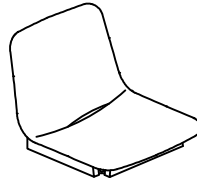

1 PC

**C** Front Leg - Left



1 PC

**D** Front Leg - Right

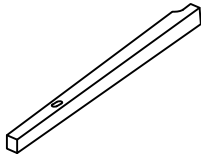

1 PC

**E** Side Stretcher - Front



1 PC

**F** Side Stretcher - Left & Right



2 PCS

**G** Bolt  
Ø5/16" x 80mm



**H** Bolt  
Ø5/16" x 65mm



**I** Bolt  
Ø1/4" x 35mm

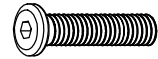

**J** 4 PCS  
Spring Washer  
Ø5/16" x Ø13mm x 2mm



**K** 4 PCS  
Flat Washer  
Ø5/16" x Ø19mm x 2mm



**L** 1 PC  
Spring Washer  
Ø1/4" x Ø13mm x 2mm



**M** 8 PCS  
Flat Washer  
Ø1/4" x Ø19mm x 2mm

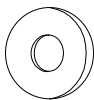

1 PC

**N** 8 PCS  
Allen Wrench  
4mm



1 PC

**O** 1 PC  
Screw  
Ø3.5mm x 38mm



6 PCS

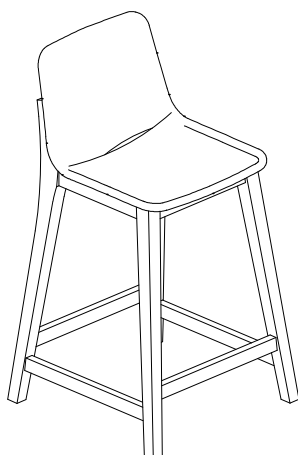

This page lists all the contents included in the box. Please take the time to identify the hardware as well as the individual components to this product. As you unpack and prepare for assembly, place the contents on a carpeted or padded area to protect them from damage.

**1** Attach Seat (B) to Back Leg Frame (A) using Bolt (G & I), Spring Washer (J & L) and Flat Washer (K & M) with Allen Wrench (N). Do not fully tighten the bolts in this step.

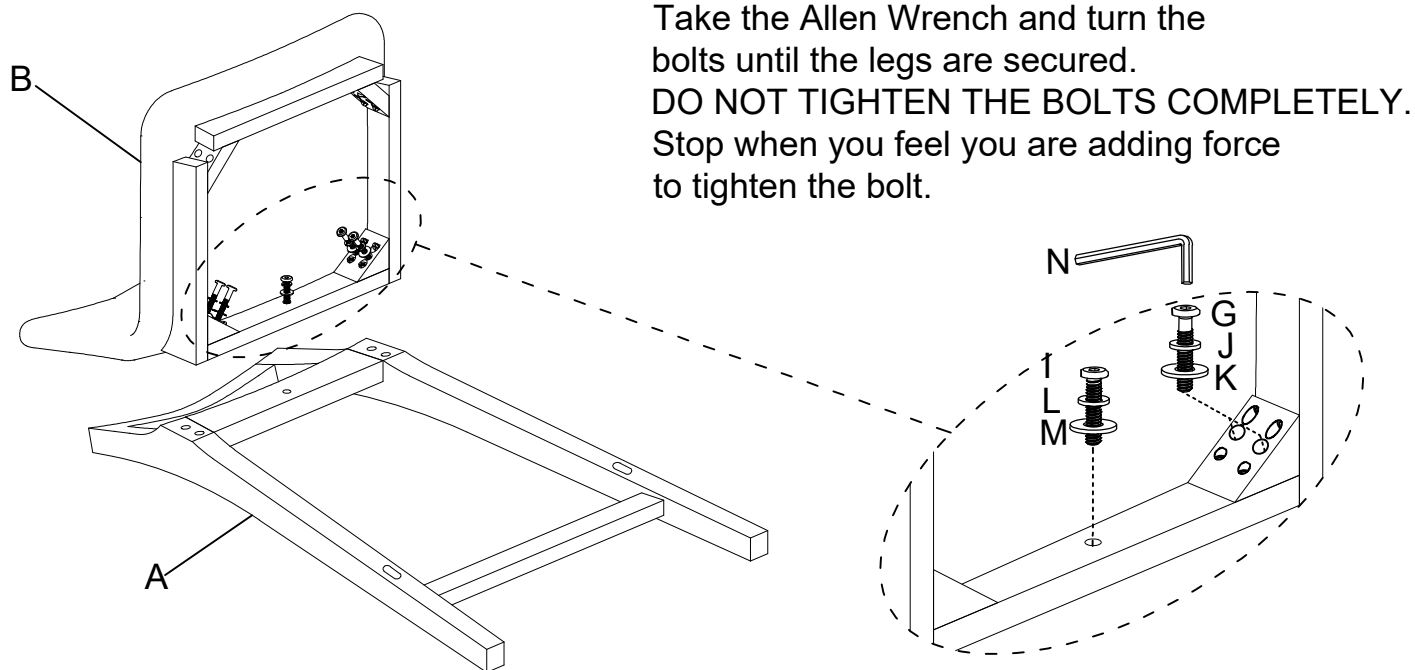

Take the Allen Wrench and turn the bolts until the legs are secured.  
**DO NOT TIGHTEN THE BOLTS COMPLETELY.**  
Stop when you feel you are adding force to tighten the bolt.

**2** Attach Front Leg (C & D) to Seat (B) using Bolt (H), Spring Washer (J) and Flat Washer (K) with Allen Wrench (N). Half tighten all the bolts in this step.

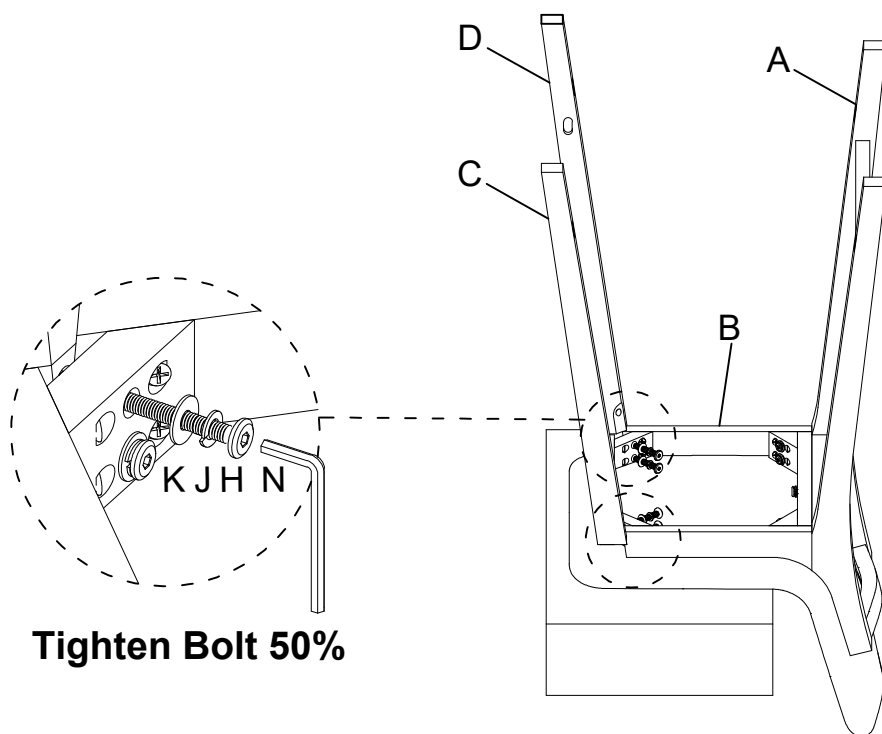

**Tighten Bolt 50%**

**3** Attach Side Stretcher (E & F) to Front Leg (C & D) and Back Leg Frame (A) using Screw (O) with Screwdriver (Not Provided). Fully tighten all the bolts and screws in this step.

(Not Provided)

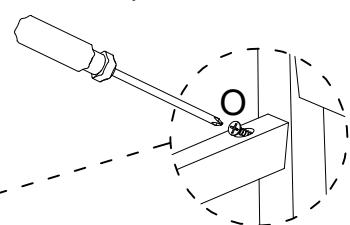

**Tighten Screw 100%**

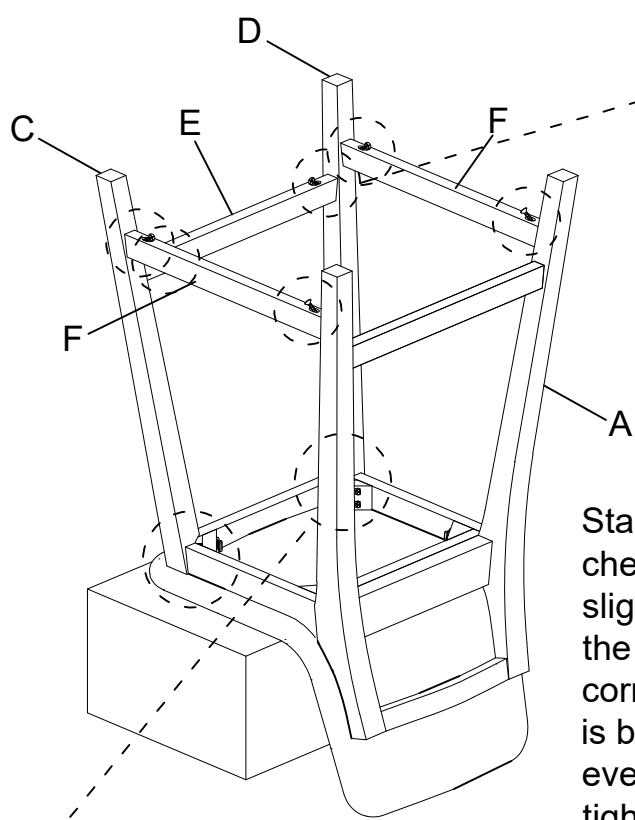

Stand the chair on an even surface and check for balance. If the chair wobbles slightly, apply downward pressure on the uneven leg and tighten the bolts to correct the imbalance. Once the chair is balanced, apply downward pressure evenly in the center of the chair and tighten all bolts, being careful not to over-tighten beyond the hole depth.

Helpful Tip: While tightening the bolts from underneath, have someone sit in the chair.

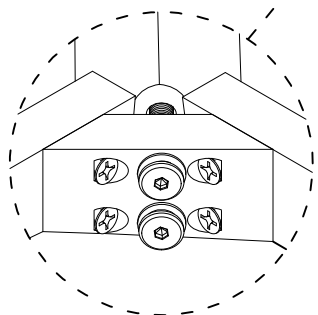

**Tighten Bolt 100%**

### Cleaning & Care

Treat surfaces with care. Surfaces are resistant to scratches but are not scratch resistant. Clean surfaces with a dry or damp soft cloth. Do not use abrasive cleaners. Hardware may loosen over time. Periodically check that all connections are tight.