

Installation Guide

Under-Mount Bathroom Sink

K-2361

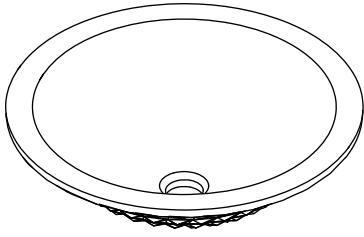

K-2741

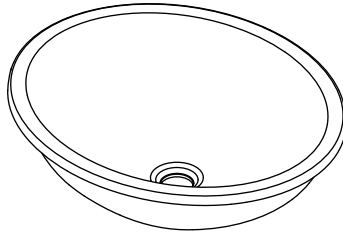

M product numbers are for Mexico (i.e. K-12345**M**)
Los números de productos seguidos de
M corresponden a México (Ej.
K-12345**M**)
Français, page "Français-1"
Español, página "Español-1"

THE BOLD LOOK
OF **KOHLER**®

1145059-2-C

Tools

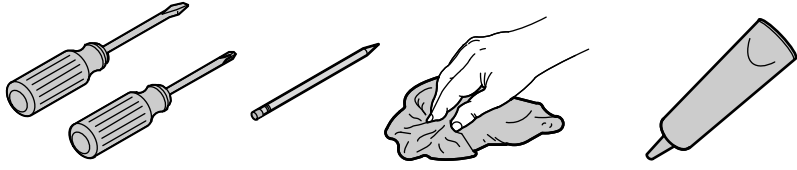

100% Silicone Sealant

Before You Begin



CAUTION: Risk of personal injury. Handle with care. Product can break, chip or cause injury if handled carelessly.

IMPORTANT! For bathroom sinks without faucet holes, ensure adequate clearance for faucet installation when determining the bathroom sink placement.

- Observe all local plumbing and building codes.
- Inspect the drain and supply tubing. Replace if necessary.
- Use the template supplied with the bathroom sink.
- Provide your countertop manufacturer with your bathroom sink model number when ordering your countertop.
- If a counter-mount faucet is required, provide the faucet information to the countertop installer to ensure the correct holes are drilled.
- Countertop manufacturer should preinstall the anchors into the underside of the countertop. Use the anchors and fasteners provided by the countertop manufacturer and the clamps provided with your bathroom sink.

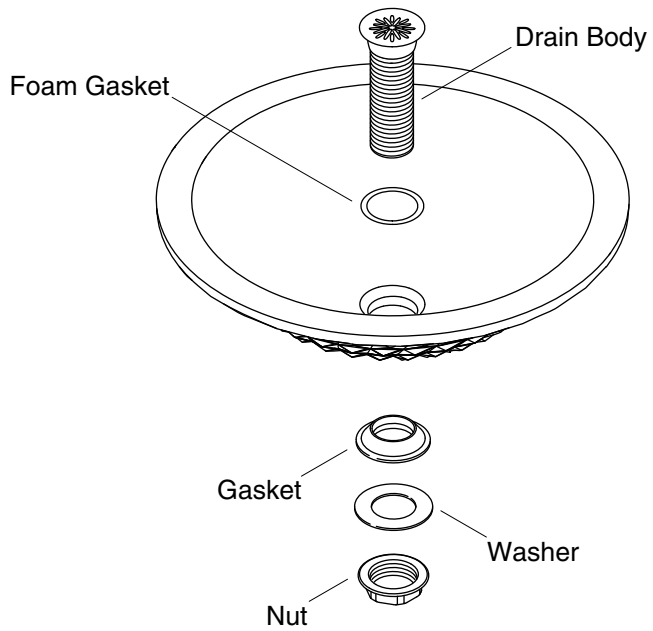

1. Preparation

- Install the water supplies and drain piping according to the roughing-in information.
- Install the countertop.
- Verify cabinet clearance beneath the countertop to accommodate the sink basin, faucet valving, and drain piping.
- Clean the underside of the countertop at the bathroom sink installation area thoroughly.
- If possible, install the drain to the bathroom sink before installing the bathroom sink.
- Discard the O-ring supplied with your drain and install the drain using the gasket provided with the bathroom sink.

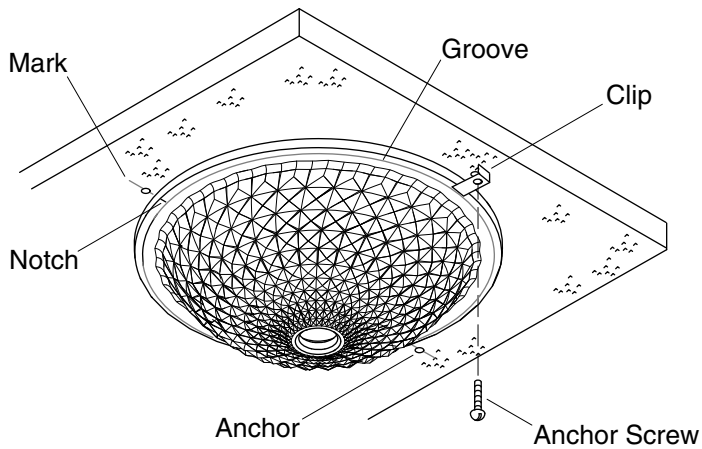

2. Install the Lavatory

- **TIP:** To assist in positioning the bathroom sink, mark the 12, 3, 6, and 9 o'clock positions on the underside of the countertop.
- Apply a generous bead of silicone sealant around the rim of the bathroom sink.
- Position the bathroom sink with the KOHLER logo at 12 o'clock and align the marks on the underside of the countertop with the notches in the bathroom sink.

NOTE: To ensure the clips will not be seen once the bathroom sink is installed, keep the edges of the clamps positioned between the edge of the bathroom sink and the groove in the underside of the rim.

- Secure the bathroom sink with the clips and screws.
- Immediately wipe away any excess sealant.