

FLEXSTEEL®

Power Lift Recliner with Headrest, Lumbar, Heat and Massage

IMPORTANT NOTE

Read these instructions carefully, and familiarize yourself with each procedure before assembling the furniture. Check that you have all the component parts, and familiarize yourself with each part before proceeding.

Take all the fittings out of the plastic bag and separate them into groups. Ensure you have enough space to lay out all the parts before assembly. To prevent damage to the parts, we recommend that you assemble the unit on a soft, level surface.

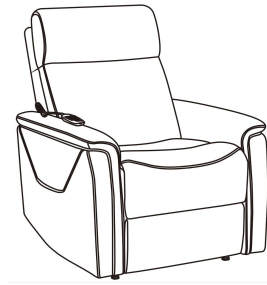

Part List

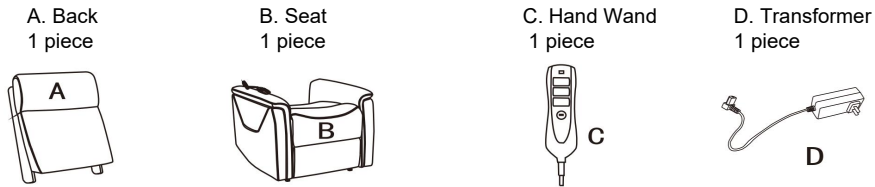

Assembly Instructions

STEP 1

Take out the Hand Wand (C) and Transformer (D) from the bottom of the Seat (B). (See Figure 1)

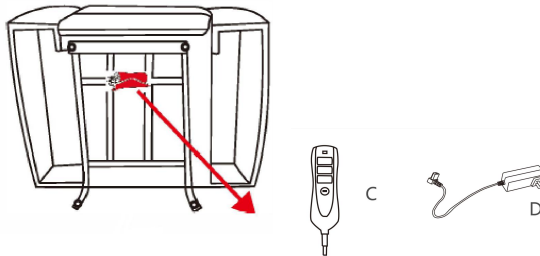

Figure 1

STEP 2

Attach the Back (A) to the Seat (B), ensure the latches fit well. (See Figure 2)

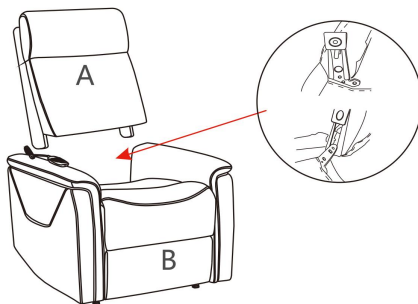

Figure 2

STEP 3

Lay the Hand Wand (C) on the Seat (B) and insert the plug through the slot below the zipper. Zip the fabric on the bottom of Back (A) with the back of the Seat (B). (See Figure 3)

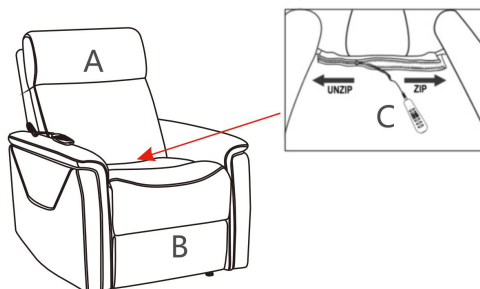

Figure 3

STEP 4

Flip up the back flap and connect the headrest, heat and massage, and hand wand cables between the back (A) and the Seat (B) to their corresponding connectors. (See Figure 4)

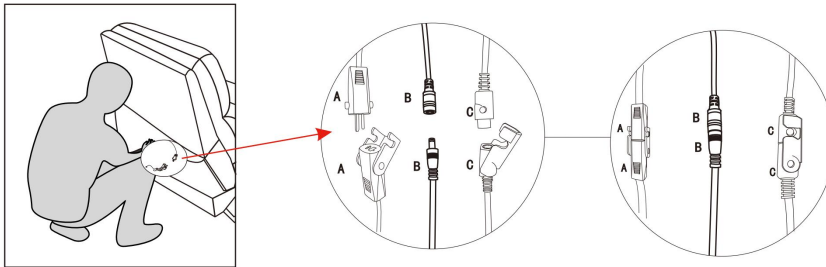

Figure 4

STEP 5

Connect the Transformer (D) into the power port on the back of the Seat (B), then plug it into a nearby outlet, still making sure it is clear of the metal base. (See Figure 5).

Then fasten the back flap to the bottom of the furniture. (See Figure 6)

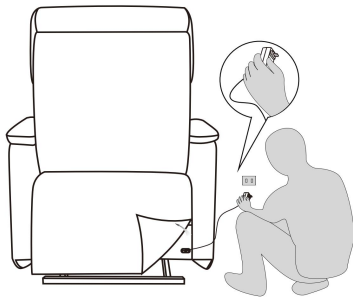

Figure 5

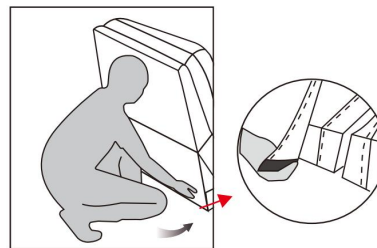

Figure 6

Disassembly Instructions

Unzip the zipper between Back (A) and Seat (B), then disconnect all cables. Pull up the spring leaf in bracket, then lift Back (A) up. (See Figure 7)

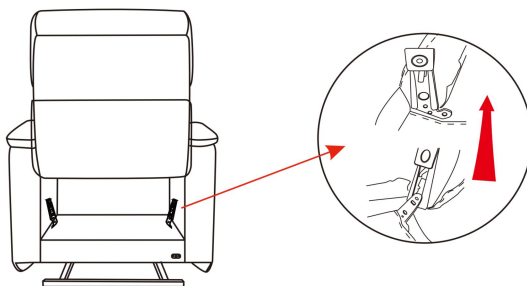

Figure 7

IMPORTANT NOTE

- To avoid any risk of suffocation to children or pets, dispose of all plastic bags immediately.
- To ensure proper performance, occasionally check for loose screws and tighten as needed.
- If the reclining functions are not working properly, check for loose cable connections before contacting the retailer.