

# P280097

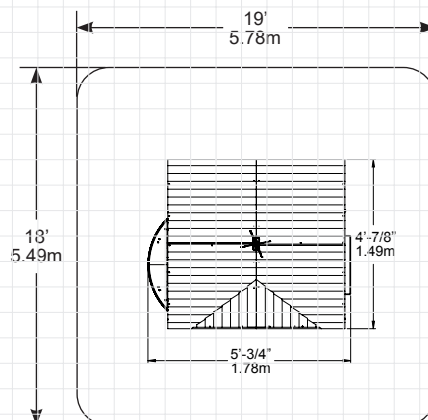
# COUNTRY VISTA PLAYHOUSE



**OBSTACLE FREE SAFETY ZONE** - 19' x 18' (5.78 x 5.49m) area requires Protective Surfacing. See page 4.

**CAPACITY** - 5 Users Maximum, Ages 3 to 10; Weight Limit 110 lbs. (50 kg) per child.

**RESIDENTIAL HOME USE ONLY.** Not intended for public areas such as multi-unit residences, schools, churches, nurseries, day cares or parks.



## INSTALLATION AND OPERATING INSTRUCTIONS

### FOR 24/7 ONLINE PARTS REPLACEMENT

**parts.kidkraft.com**

KidKraft, Inc.  
4630 Olin Road  
Dallas, Texas 75244  
USA

customerservice@kidkraft.com

1.800.933.0771  
972.385.0100

**parts.kidkraft.eu**

KidKraft Netherlands BV  
Olympisch Stadion 8  
1076 DE Amsterdam  
The Netherlands

europecustomerservice@kidkraft.com

+31 20 305 8620  
M-F from 09:00 to 17:30 (GMT+1)

9400097

Rev 08/26/2022



### ⚠ WARNING

To reduce the risk of serious injury or death, please read and follow these instructions. Keep and refer to instructions as needed and pass along to any future owners of this item.

## **Congratulations on purchasing a KidKraft product!**

**Our items are made of high-quality, durable Cunninghamia Lanceolata wood from the cypress family.**

**Lumber from these trees are known for their light weight and excellent strength. The porosity of this wood allows the moisture to absorb and evaporate in the fibers, resisting rot and bugs.**

**Engineered for great play, our products also go through extensive testing for safety.**

**Plus, our team has developed a series of proprietary methods for a simpler, more organized assembly. Less build time and more play time is our motto!**

**However, during assembly if you have any questions or concerns, please reach out. Our Customer Service can help with missing parts, instructions or maintenance.**



# Warnings and Safe Play Instructions



**CONTINUOUS ADULT SUPERVISION REQUIRED.** Most serious injuries and deaths on playground equipment have occurred while children were unsupervised! Our products are designed to meet mandatory and voluntary safety standards. Complying with all warnings and recommendations in these instructions will reduce the risk of serious or fatal injury to children using this play system. Go over the warnings and safe play instructions regularly with your children and make certain that they understand and follow them. Remember on-site adult supervision is required for children of all ages.



## WARNING

### CHOKING HAZARD/SHARP EDGES & POINTS

Adult assembly required. This product contains small parts and parts with sharp edges and points. Keep parts away from children until fully assembled.

### STRANGULATION HAZARD

- **NEVER** allow children to play with ropes, clotheslines, pet leashes, cables, chains or cord-like items when using this playhouse or to attach these items to the playhouse.
- **NEVER** allow children to wear loose fitting clothing, ponchos, hoods, scarves, capes, necklaces, items with draw-strings, cords or ties when using this playhouse.
- **NEVER** allow children to wear bike or sport helmets when using this playhouse.

Failure to prohibit these items, even helmets with chin straps, increases the risk of serious injury and death to children from entanglement and strangulation.

### TIP OVER HAZARD

Choose a level location for the equipment. This can reduce the likelihood of the playhouse tipping over and loose-fill surfacing materials washing away during heavy rains.

**DO NOT** allow children to play on the playhouse until the assembly is complete.

### PLACEMENT

Place the toy on a level surface at least 2m from any structure or obstruction such as fences, garages, house, overhanging branches, laundry or electrical wires.



## WARNING – Safe Play Instructions

- ✓ Dress children with well fitting and full foot enclosing footwear.
- ✓ Check for splintered, broken or cracked wood; missing, loose, or sharp edged hardware. Replace, tighten and or sand smooth as required prior to playing.
- ✓ Replace defective parts in accordance with manufacturer's instructions.
- ✗ Do not allow children to wear open toe or heel footwear like sandals, flip-flops or clogs.
- ✗ Do not permit climbing on equipment when it is wet.
- ✗ Do not permit rough play or use of equipment in a manner for which it was not intended. Standing or climbing on or jumping from the roof.

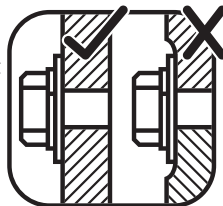
## Instructions for Proper Maintenance

Your KidKraft Play System is designed and constructed of quality materials with your child's safety in mind. As with all outdoor products used by children, it will weather and wear. To maximize the enjoyment, safety and life of your Playhouse, it is important that you, the owner, properly maintain it.

**Check the following at the beginning of the play season:**

### HARDWARE:

- ✓ Check metal parts for rust. If found, sand and repaint using a non-lead paint complying with 16 CFR 1303.
- ✓ Inspect and tighten all hardware. On wood assemblies **DO NOT OVER-TIGHTEN** as to cause crushing and splintering of wood.
- ✓ Check for sharp edges or protruding screw threads, add washers if required.



### WOOD PARTS:

- ✓ Check all wood members for deterioration, structural damage and splintering. Sand down splinters and replace deteriorated wood members. As with all wood, some checking and small cracks in grain is normal.
- ✓ Applying a water repellent or stain (water-based) on a yearly basis is important maintenance to maintain maximum life and performance of the product.

**Check twice a month during play season:**

### HARDWARE:

- ✓ Inspect for tightness. Must be firmly against, but not crushing the wood. **DO NOT OVER-TIGHTEN.** This will cause splintering of wood.
- ✓ Check for sharp edges or protruding screw threads. Add washers if required.

**If you dispose of your playhouse:** Please disassemble and dispose of your unit so that it does not create any unreasonable hazards at the time it is discarded. Be sure to follow your local waste ordinances.

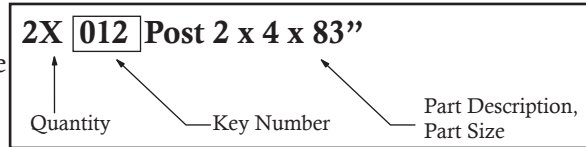
# Keys to Assembly Success

## Tools Required

<ul style="list-style-type: none"> <li>• Carpenters Level</li> <li>• Carpenters Square</li> </ul>	<ul style="list-style-type: none"> <li>• Claw Hammer</li> <li>• Tape Measure</li> </ul>	<ul style="list-style-type: none"> <li>• Standard or Cordless Drill</li> <li>• Pencil</li> </ul>	<ul style="list-style-type: none"> <li>• Safety Glasses</li> <li>• Adult Helpers</li> </ul>
---	---	--	---

## Part Identification Key

On each page, you will find the parts and quantities required to complete the assembly step illustrated on that page. Here is a sample.



**Key Number:** The first two digits represent the step number. The third digit represents the piece. Note that if the part is used in multiple steps then the number only reflects the first step it is used in.

## Symbols

Throughout these instructions symbols are provided as important reminders for proper and safe assembly.

<p>This identifies information that requires special attention. Improper assembly could lead to an unsafe or dangerous condition.</p>		<p>Check that set or assembly is properly level before proceeding.</p> <p>Use Level</p>
<p>Use Help</p>	<p>Use Help</p>	<p>Pre-drill 1/8" &amp; 3/16" Bit</p>
<p>Where this is shown, 2 or 3 people are required to safely complete the step. To avoid injury or damage to the assembly make sure to get help!</p>	<p>Pre-drill a pilot hole before fastening screw or lag to prevent splitting of wood.</p>	<p>Tighten Bolts</p>
<p>Measure Distance</p>	<p>Check that assembly is square before tightening bolts.</p>	<p>This indicates time to tighten bolts, but not too tight! Do not crush the wood. This may create splinters and cause structural damage.</p>
<p>Square Assembly</p>	<p>Use a measuring tape to assure proper location.</p>	

## CAUTION – Protrusion Hazard

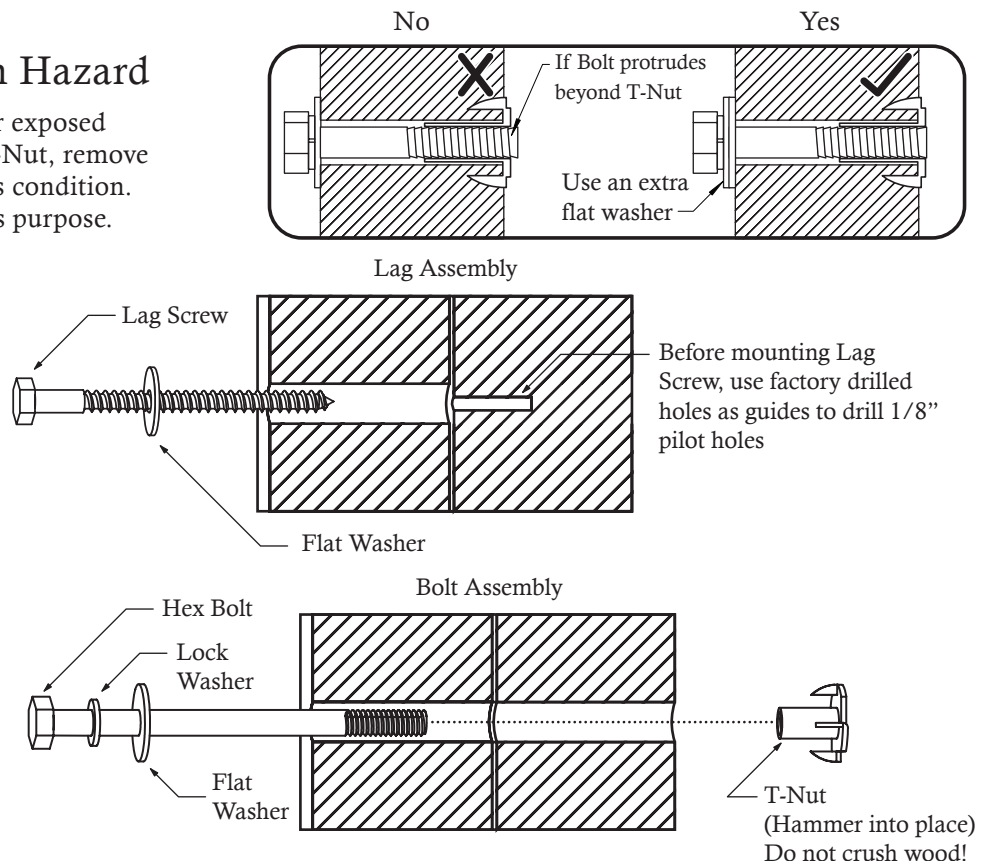
Once the assembly is tightened, watch for exposed threads. If a thread protrudes from the T-Nut, remove the bolt and add washers to eliminate this condition. Extra washers have been provided for this purpose.

## Proper Hardware Assembly

Lag screws require drilling pilot holes to avoid splitting wood. Only a flat washer is required. For ease of installation liquid soap can be used on all lag-type screws.

For bolts, tap T-Nut into hole with hammer. Insert the hex bolt through lock washer first then flat washer then hole. Because the assemblies need to be squared do not completely tighten until instructed. Pay close attention to diameter of the bolts. 5/16" is slightly larger than 1/4".

Note: Wafer head bolts with blue lock tight or a bolt with a Ny-Lok nut do NOT require a lock washer.





## About Our Wood

KidKraft Premium Play Systems uses only premium playset lumber, ensuring the safest product for your children's use. Although we take great care in selecting the best quality lumber available, wood is still a product of nature and susceptible to weathering which can change the appearance of your set.

### **What causes weathering? Does it affect the strength of my Play System?**

One of the main reasons for weathering is the effects of water (moisture); the moisture content of the wood at the surface is different than the interior of the wood. As the climate changes, moisture moves in or out of the wood, causing tension which can result in checking and or warping. You can expect the following due to weathering. These changes will not affect the strength of the product:

1. **Checking** is surface cracks in the wood along the grain. A post (4" x 4") will experience more checking than a board (1" x 4") because the surface and interior moisture content will vary more widely than in thinner wood.
2. **Warping** results from any distortion (twisting, cupping) from the original plane of the board and often happens from rapid wetting and drying of the wood.
3. **Fading** happens as a natural change in the wood color as it is exposed to sun-light and will turn a grey over time.

### **How can I reduce the amount of weathering to my Play System?**

At the factory we have coated the wood with a water repellent or stain. This coating decreases the amount of water absorption during rain or snow thus decreasing the tension in the wood. Sunlight will break down the coating, so we recommend applying a water repellent or stain on a yearly basis (see your local stain and paint supplier for a recommended product).

Most weathering is just the normal result of nature and will not affect safe play and enjoyment for your child. However if you are concerned that a part has experienced a severe weathering problem please call our consumer relations department for further assistance.

**Complete and mail registration card to receive important product notifications and assure prompt warranty service.**

# KidKraft Limited Warranty

## MISSING OR DAMAGED PARTS:

KidKraft will replace any parts within 90 days from date of purchase found to be missing from or damaged in the original packaging. See Fig. 1

Fig. 1	<u>Product Age (All Parts)</u>	<u>Consumer Pays</u>
	0-90 Days from date of purchase	\$0 for Part + Free Shipping

## DEFECTS IN MATERIAL AND WORKMANSHIP:

KidKraft warrants that this product is free from defects in materials and workmanship for a period of one (1) year from the original date of purchase (dated sales receipt and/or product registration is required). This one (1) year warranty covers all parts including wood, hardware, and all accessories (Such as swings, rides, and slides). See Fig. 2

Fig. 2	<u>Product Age (All Parts)</u>	<u>Consumer Pays</u>
	91 Days to 1 Year	\$0 for Part + Free Shipping

## WOOD ROT, DECAY, AND INSECT DAMAGE:

All wood carries a five (5) year warranty against rot, decay, and insect damage (dated sales receipt and/or product registration is required). Refer to the schedule below for charges associated with replacement of wood parts under this **Limited Warranty**. See Fig. 3

Fig. 3	<u>Product Age (Wood Parts)</u>	<u>Consumer Pays</u>
	0 Days to 1 Year	\$0 for Part + Free Shipping
	After 1 Year to 5 Year	\$0 for Part + Shipping & Handling
	Over 5 Years	100% for Part (if available) + Shipping & Handling

This warranty applies to the original owner and registrant and is non-transferable. Regular maintenance is required to ensure the integrity of this product. Failure by the owner to maintain the product according to the maintenance requirements may void this warranty.

This Limited Warranty does NOT cover:

- Any inspection cost
- Labor and/or costs for replacement of any defective item(s), including but not limited to, professional installer costs
- Incidental or consequential damages, including but not limited to, as a result of set relocation, move and/or reinstall
- Cosmetic defects which do not affect performance or integrity of a part or the entire product
- Vandalism, improper use or installation, or acts of nature, including but not limited to, high winds, fire, and flood
- Minor twisting, warping, checking, or any natural occurring properties of wood that do not affect performance or integrity.
- Any KidKraft product purchased, including but not limited to, a non-approved retailer, auction houses, second-hand, and as-is clearance items.

KidKraft products have been designed for safety and quality. Modifications made to the original product may damage the structural integrity of the unit leading to failure and possible injury. KidKraft cannot assume any responsibility for the modified products. Furthermore, modifications void all warranties.

This product is warranted for **RESIDENTIAL USE ONLY**. Under no circumstance should a KidKraft product be used in public settings such as schools, churches, playgrounds, parks, home and professional day cares and the like. Such use may lead to product failure and potential injury. Public use will void this warranty. KidKraft disclaims all other representations and warranties of any kind, express or implied.

# Part Identification (Reduced Part Size)

**3pc. - [023]** - 1 x 1 x 15-3/4" (25.4 x 25.4 x 400mm) - Base Inside Blocks FSC - 38082313



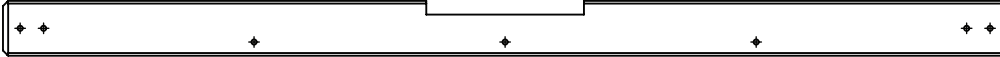
**2pc. - [024]** - 1 x 1 x 32-3/8" (25.4 x 25.4 x 823mm) - Front Doors Base Beam FSC - 38082413



**1pc. - [025]** - 1 x 2 x 36-5/8" (25.4 x 50.8 x 930mm) - Bottom Door Stop Panel FSC - 38082513



**1pc. - [026]** - 2 x 2 x 36-5/8" (25.4 x 50.8 x 930mm) - Top Door Stop Panel FSC - 38085213



**1pc. - [027]** - 1/2 x 2 x 20" (12.7 x 50.8 x 508mm) - Reinforce FSC - 38082613



**2pc. - [045]** - 1/2 x 3-1/2 x 38-5/8" (12.7 x 90 x 980.9mm) - Roof Support Panel FSC - 38082713



**2pc. - [046]** - 1/2 x 3-1/2 x 22-7/8" (12.7 x 90 x 580.9mm) - Roof Support Short Panel FSC - 38082813



**1pc. - [042]** - 1/2 x 2 x 38-5/8" (12.7 x 50.8 x 980.9mm) - Top Back Roof Lip Long FSC - 38082913



**1pc. - [043]** - 1/2 x 2 x 22-7/8" (12.7 x 50.8 x 580.9mm) - Top Back Roof Lip FSC - 38083013



**2pc. - [044]** - 1/2 x 1 x 35-3/4" (12.7 x 25.4 x 908.8mm) - Side Frame Support Panel FSC - 38083113



**1pc. - [041]** - 1-3/8 x 2-1/2 x 12" (34.9 x 63.5 x 305.9mm) - Roof Beam FSC - 38083213



**4pc. - [053]** - 1 x 2 x 28" (25.4 x 50.8 x 711mm) - Triangle Bottom FSC - 38083313



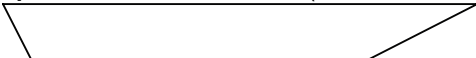
**4pc. - [054]** - 1 x 2-1/2 x 30-1/8" (25.4 x 63.5 x 766.7mm) - Triangle Top FSC - 38083413



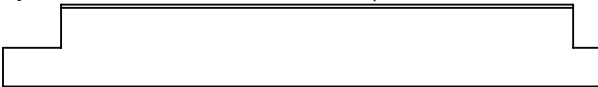
**1pc. - [071]** - 1 x 2 x 38-5/8" (25.4 x 50.8 x 982mm) - Roof Add On-Bottom FSC - 38083513



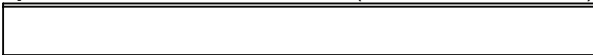
**2pc. - [072]** - 1 x 2 x 17-1/4" (25.4 x 50.8 x 439.1mm) - Roof Add On-Inside Rim FSC - 38083613



**2pc. - [091]** - 3/4 x 2-1/2 x 21-7/8" (19 x 63.5 x 553.4mm) - Outside Bay Window Beam FSC - 38083705

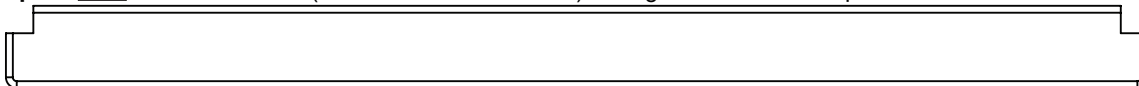


**2pc. - [092]** - 3/4 x 2 x 21-19/32" (19 x 50.8 x 548.3mm) - Inside Bay Window Beams FSC - 38083805

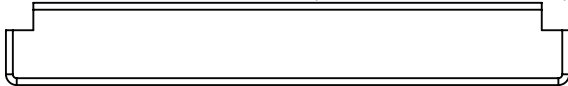


# Part Identification (Reduced Part Size)

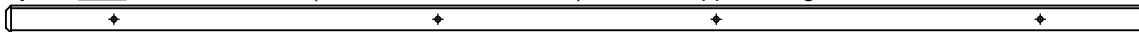
1pc. - **084** - 1 x 3 x 41-5/8" (25.4 x 76.2 x 1057.8mm) - Long Bench Countertop FSC - 38083906



1pc. - **082** - 1 x 3 x 20-1/2" (25.4 x 76.2 x 521.6mm) - Bench Countertop FSC - 38084006



1pc. - **083** - 1 x 1 x 41-5/8" (25.4 x 25.4 x 1057.8mm) - Table Support Long FSC - 38084113



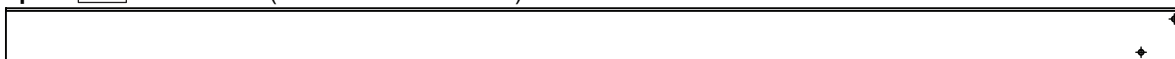
1pc. - **081** - 1 x 1 x 20-1/2" (25.4 x 25.4 x 521.6mm) - Table Support FSC - 38084213



2pc. - **031** - 2 x 2 x 13-1/2" (50.8 x 50.8 x 343.6mm) - Seat Base Beam FSC - 38084313



2pc. - **032** - 2 x 2 x 43" (50.8 x 50.8 x 1092mm) - Patio Beam FSC - 38084413



2pc. - **035** - 1 x 3-1/8 x 13-1/2" (25.4 x 80.9 x 343.6mm) - Patio Side Bench Seat FSC - 38084506



2pc. - **036** - 1 x 3-1/8 x 13-1/2" (25.4 x 80.9 x 343.6mm) - Patio Side Bench Seat Front FSC - 38084606



4pc. - **034** - 1 x 1-1/2 x 5-3/4" (25.4 x 38.1 x 146.9mm) - Seat Base Block FSC - 38084713



4pc. - **033** - 1 x 1-1/2 x 8-1/4" (25.4 x 38.1 x 208.2mm) - Seat Base Gusset FSC - 38084813



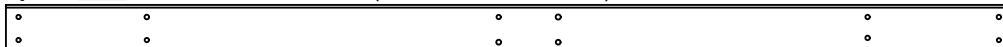
1pc. - **055** - 1 x 2-1/2 x 4" (25.4 x 63.5 x 100mm) - Roof Assembly Support FSC - 38084913



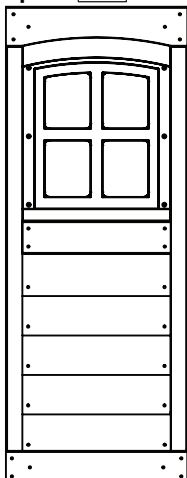
3pc. - **094** - 1 x 1-1/2 x 10-31/32" (25.4 x 38.1 x 278.6mm) - Kitchen support FSC - 38085013



1pc. - **093** - 1/2 x 1-3/4 x 36-3/4" (12.7 x 43.9 x 932mm) - Horizontal rail FSC - 38085113



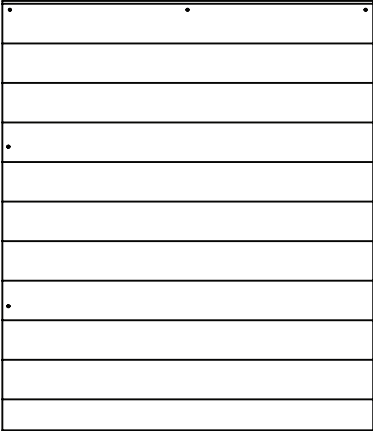
2pc. - **101** - 1 x 15-1/8 x 39-3/4" (25.4 x 384 x 1010mm) - Door FSC - 378079206



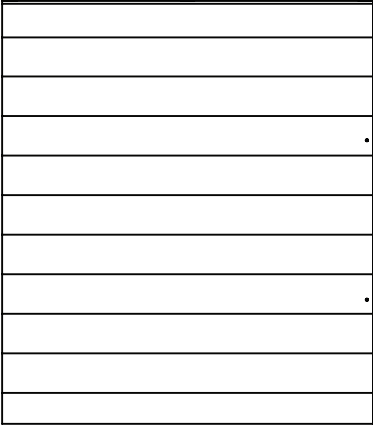


# Part Identification (Reduced Part Size)

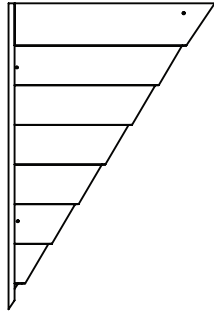
**2pc.** - **[051]** - 1-1/8 x 30-3/4 x 35-5/8" (28.6 x 780.9 x 905.5mm)  
- Roof Panel Front FSC - 378079309



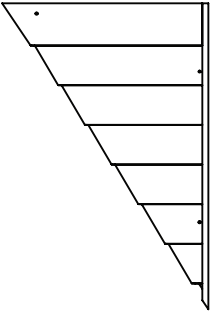
**2pc.** - **[052]** - 1-1/8 x 30-3/4 x 35-1/8" (28.6 x 780.9 x 891.9mm)  
- Roof Panel Back FSC - 378079409



**1pc.** - **[073]** - 1-1/2 x 17 x 25-3/8" (38.1 x 434.2 x 645.2mm)  
- Roof Add On-Outside Rim-Right FSC - 378079509

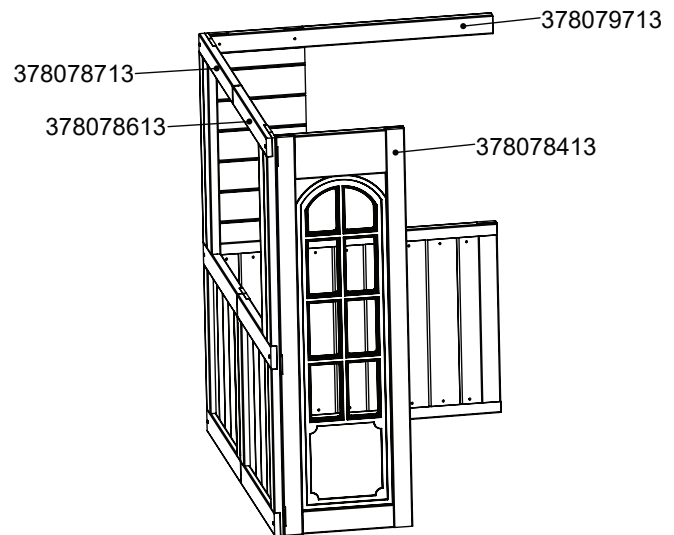
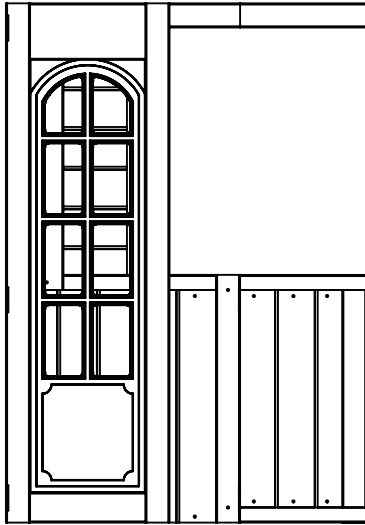


**1pc.** - **[074]** - 1-1/2 x 17 x 25-3/8" (38.1 x 434.2 x 645.2mm)  
- Roof Add On-Outside Rim-Left FSC - 378079609



# Part Identification (Reduced Part Size)

**1pc. - 022** - 4 x 29-3/4 x 43" (101.6 x 755.4 x 1092mm)  
 - Panel Assembly B FSC - 378081313

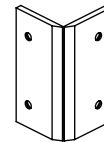


**If you need to order parts, please order below part #**

378078413 Front Window Assembly Left - 1 pc  
 378078613 Side Wall Assembly Right - 1 pc  
 378078713 Side Wall Assembly Left - 1 pc  
 378079713 Front Wall Assembly Right - 1pc  
 9327885 - Small Wall Hing - 1pc  
 9321887 - Wall Hinge - 8pcs  
 S39 - 52013903 - Wood Screw #5 x 3/4" - 36pcs



S39 - 52013903

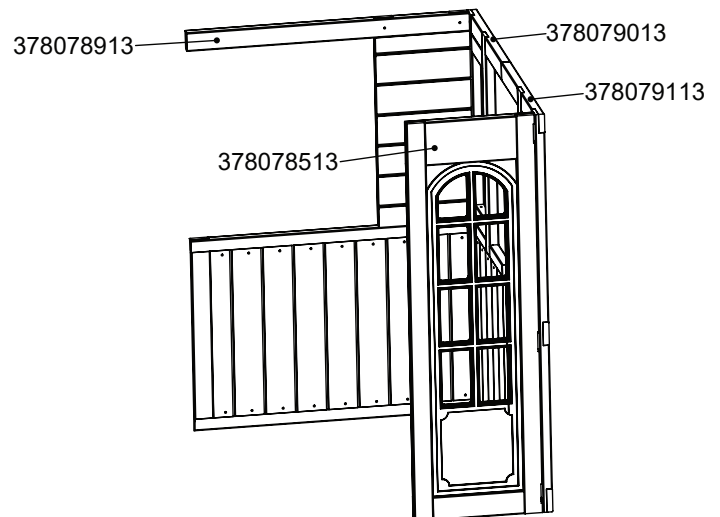
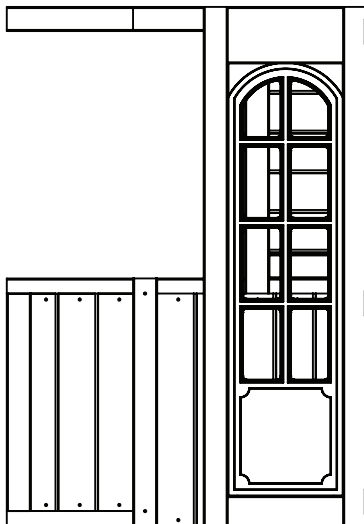


9321887



9327885

**1pc. - 021** - 4 x 29-3/4 x 43" (101.6 x 755.4 x 1092mm)  
 - Panel Assembly A FSC - 378081213

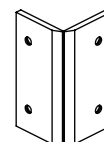


**If you need to order parts, please order below part #**

378078513 Front Window Assembly Right - 1 pc  
 378079113 Side Wall Assembly Chalk Left - 1pc  
 378079013 Side Wall Assembly Chalk Right - 1pc  
 378078913 Front Wall Assembly Left - 1pc  
 9327885 - Small Wall Hing - 1pc  
 9321887 - Wall Hinge - 8pcs  
 S39 - 52013903 - Wood Screw #5 x 3/4" - 36pcs



S39 - 52013903

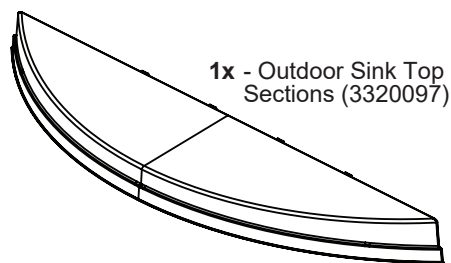


9321887



9327885

# Part Identification (Reduced Part Size)

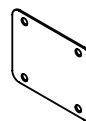


1x - Outdoor Sink Top Sections (3320097)

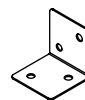
1x - Country Vista Bracket Set (3200097)



1x - Narrow Angle Bracket 2pk (3206732)

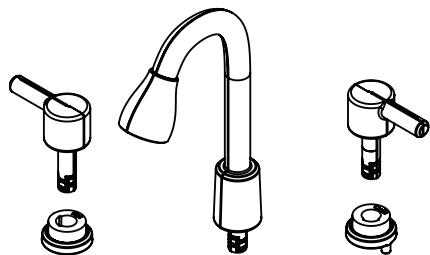


1x - Jamb Mount 7pk (3326707)

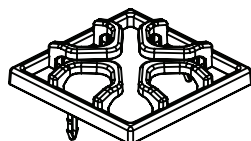


1x - Corner Panel Bracket 2pk (3206772)

1x - Bay Window Assembly Bottom Set (3320096)



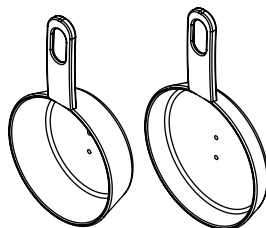
1x - Two Handle Hot & Cold Faucet (3320098)



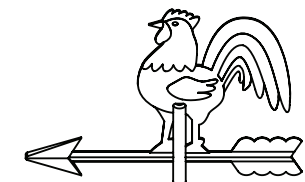
2x - Larger Gas Burner (9330735)



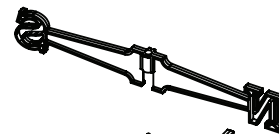
2x - Clip-In Stove Base (9337839)



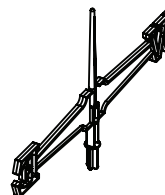
1x - Pan, Pot (9320889GG)



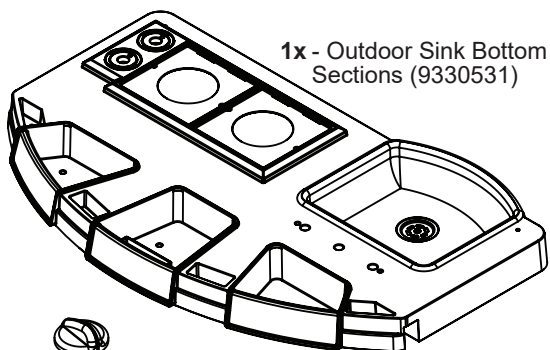
1x - Weather Vane (3327800)



1x - Rooster (3321600)



1x - Plastic Vane Block (9331640)



1x - Outdoor Sink Bottom Sections (9330531)



2x - Knob (9337836)



5x - Clip (9337837)



2x - Clicker (9337838)

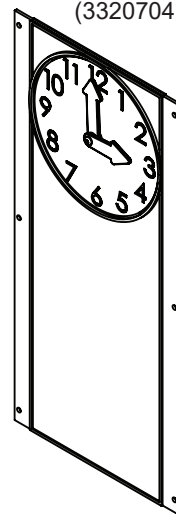


1x - Door Bumper (2Pk) (3330032)

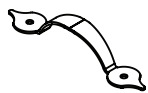


1x - Spatula (9320889RD)

2x - Clock Chalk Sign (3320704)



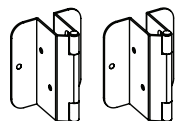
2x - Magnetic Catch Kit (3201730)



2x - Door Handle (9207711)

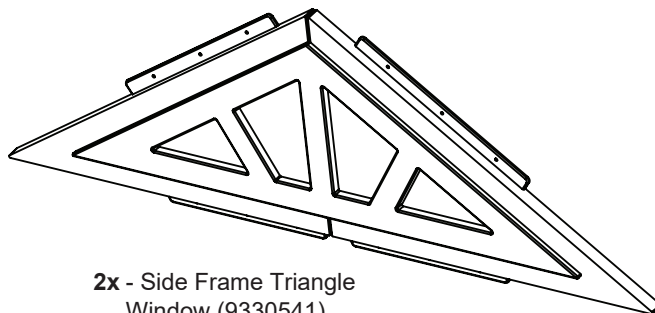
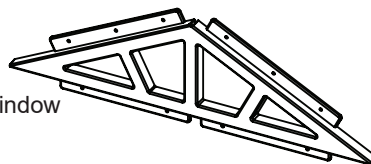


1x - Magnetic Door Catch (9207813)



2x - Factory Mount Door Hinge (2Pk) (3200147)

1x - Domer Triangle Window (9330542)



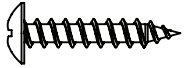
2x - Side Frame Triangle Window (9330541)

1x - Playhouse Plaque (9320371)



# Hardware Identification (Actual Size)

114pc. (S0) - Truss Screw #8 x 7/8" (22mm) - (52933505)



44pc. (S1) - Wood Screw #8 x 1-1/8" (27mm) - (52043514)



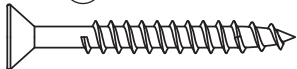
35pc. (S3) - Wood Screw #8 x 2-1/2" (64mm) - (52043522)



18pc. (S4) - Wood Screw #8 x 3" (76mm) - (52043530)



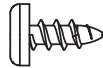
3pc. (S2) - Wood Screw #8 x 1-1/2" - (52043512)



90pc. (S15) - Wood Screw #8 x 1-3/4" (44mm) - (52043513)



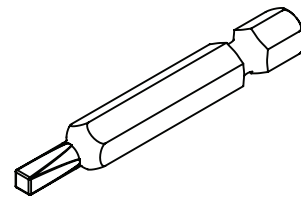
6pc. (S5) - Pan Screw #8 x 1/2" (13mm) - (52433502)



40pc. (S13) - Pan Screw #6 x 5/8" (16mm) - (52413908)



35pc. (FW3) - #8 Flat Washer - (51003500)



1pc. (D4) - #2 x 2 Robertson Driver Bit - (9200014)

**Note: Hardware bag includes extra hardware**

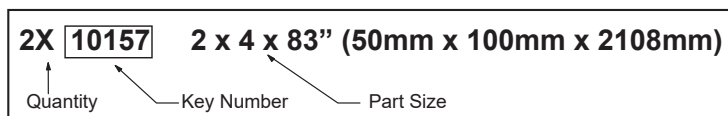


## Step 1: Inventory Parts - Read This Before Starting Assembly



Inventory should be completed before starting installation. KidKraft will not cover costs of any additional installation trip due to missing or damaged pieces.

- A. This is the time for you to inventory all your hardware, wood and accessories, referencing the parts identification sheets. This will assist you with your assembly.
- The wood pieces will have the key number stamped on the ends of the boards. Organize the wood pieces by step, as per the key numbering system below.



- B. Read the assembly manual completely, paying special attention to ANSI warnings; notes; and safety/maintenance information on pages 1 - 8.

**If there are missing or damaged pieces,  
please contact the KidKraft Consumer Engagement team  
before going back to the retailer.**

## Order Replacement Parts 24/7

You can order replacement parts for this product 24 hours a day / 7 days a week:

**Outdoor Swingsets and Playhouse Parts Ordering**  
**<https://parts.kidkraft.com/partsorderemail>**

If you have assembly or product questions, please refer to the front cover for direct contact information for our Consumer Engagement team OR you can also use this QR code with your smartphone for common questions and contact information.



**KidKraft Help Center**    **<https://kidkraft.zendesk.com/hc/en-us/>**

## Step 2: Frame Assembly Part 1



**A:** Stand (021) Panel Assembly A and (022) Panel Assembly B so that window openings are at the top. (Fig. 2.1 )

**B:** Flush to the bottom and centred on the Back Wall attach 1 (023) Base Inside Block with 4 (S15) #8 x 1-3/4" Wood Screws. (Fig. 2.2 )

Fig. 2.1

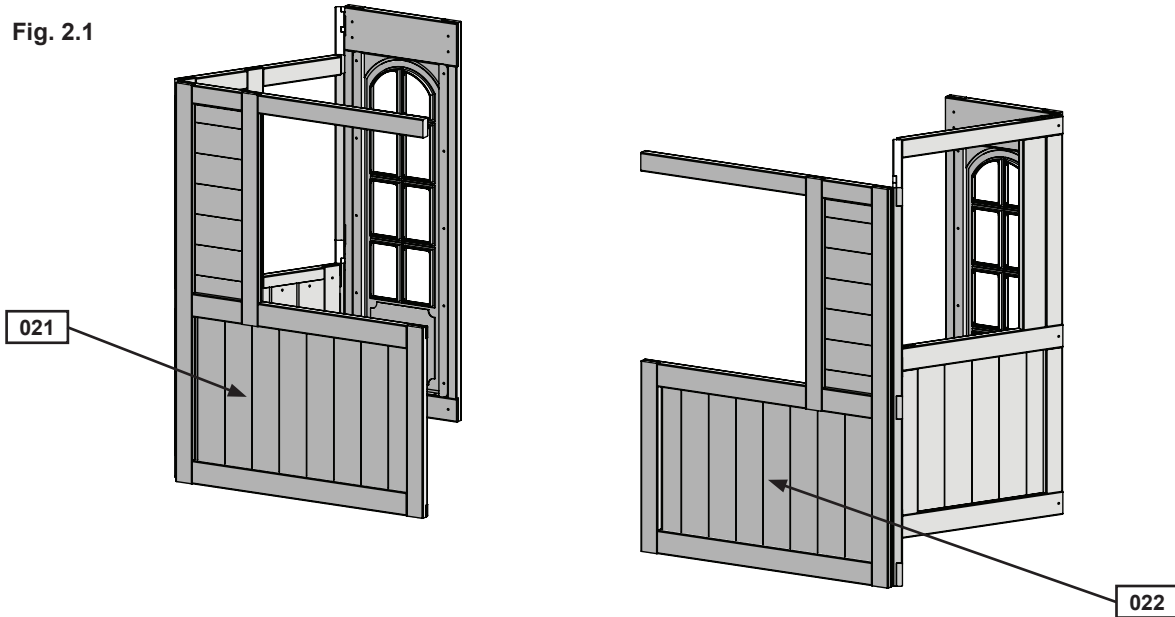
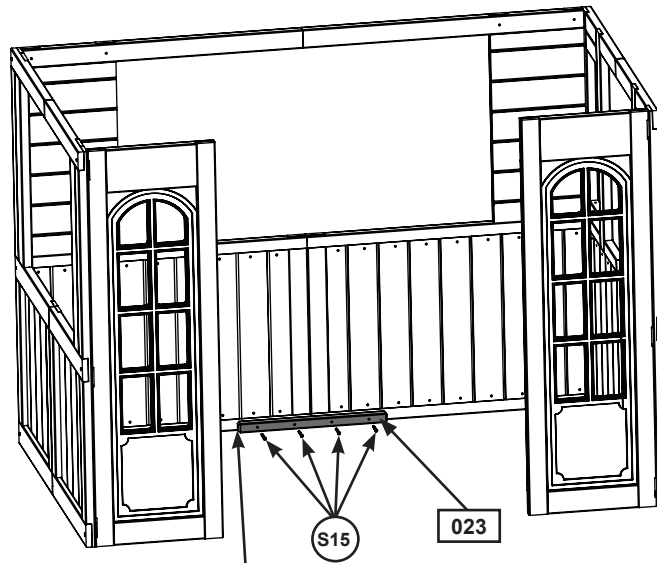


Fig. 2.2



Flush to the bottom  
and centred on the  
Back Wall

### Wood Parts

- 1 x 021 Panel Assembly A 4 x 29-3/4 x 43"
- 1 x 022 Panel Assembly B 4 x 29-3/4 x 43"
- 1 x 023 Base Inside Blocks 1 x 1 x 15-3/4"

### Hardware

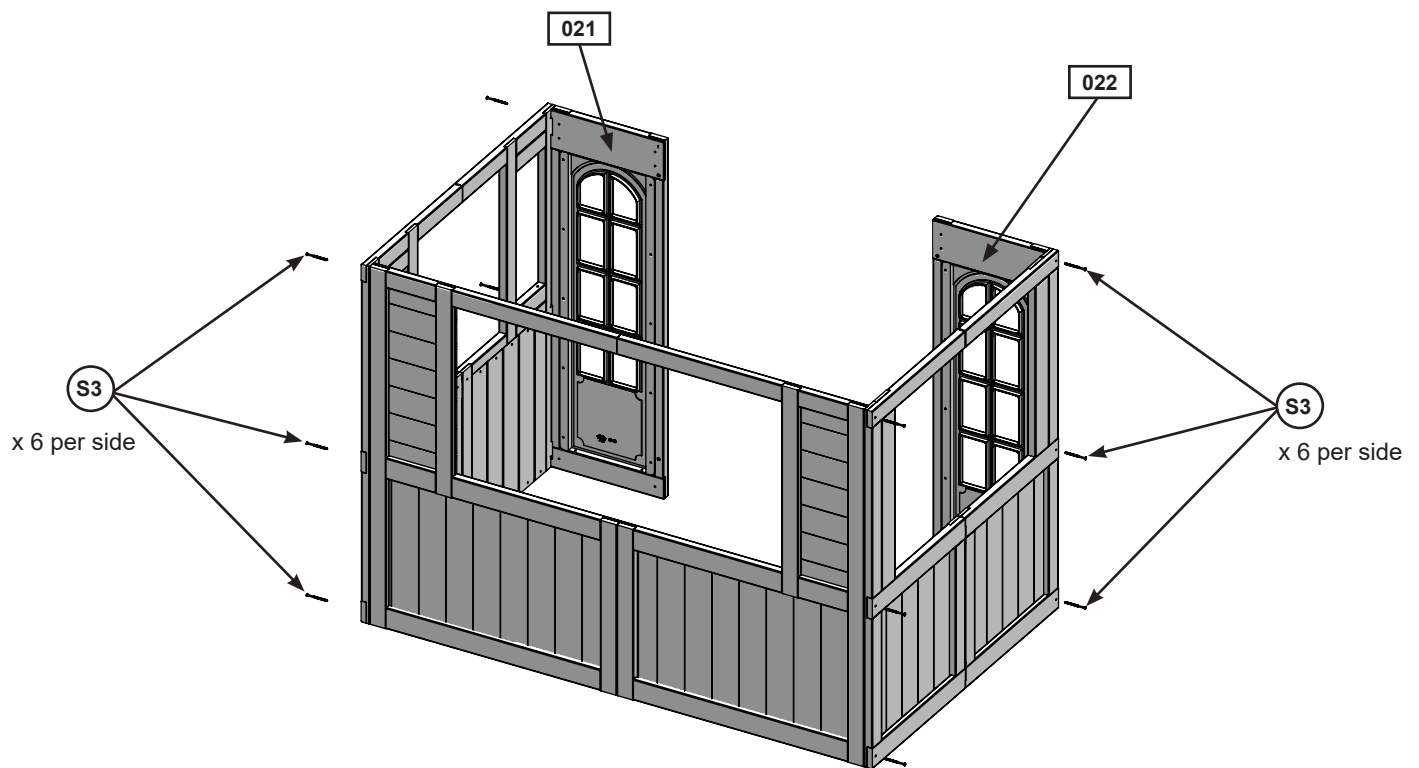
- 4 x S15 #8 x 1-3/4" Wood Screw

## Step 2: Frame Assembly Part 2



**C:** In the locations shown in fig. 2.3 install 6 (S3) #8 x 2-1/2" Wood Screws into the edges of each Side Wall. (Fig. 2.3)

Fig. 2.3



### Hardware

12 x (S3) #8 x 2-1/2" Wood Screw

# Step 2: Frame Assembly

## Part 3



**D:** Flush to the bottom and centred on the Side Walls attach 1 (023) Base Inside Block to each wall with 4 (S15) #8 x 1-3/4" Wood Screws per board. (Fig. 2.4, 2.5 and 2.6)

Fig. 2.4

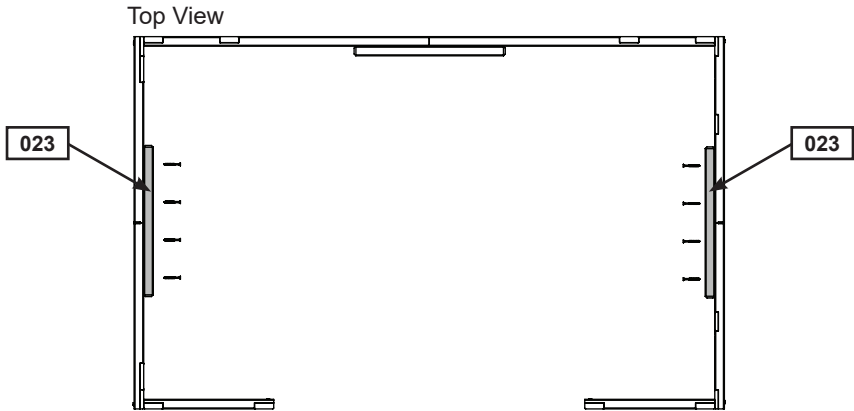


Fig. 2.5  
Inside View

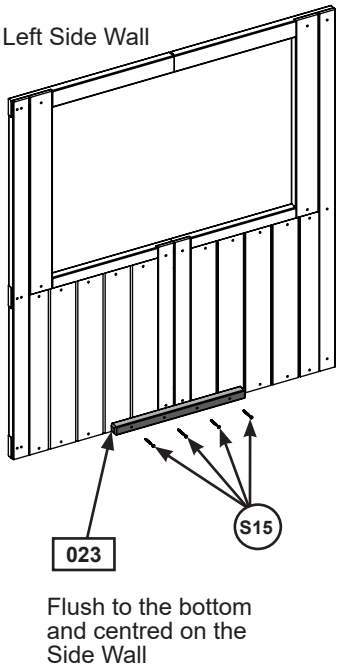
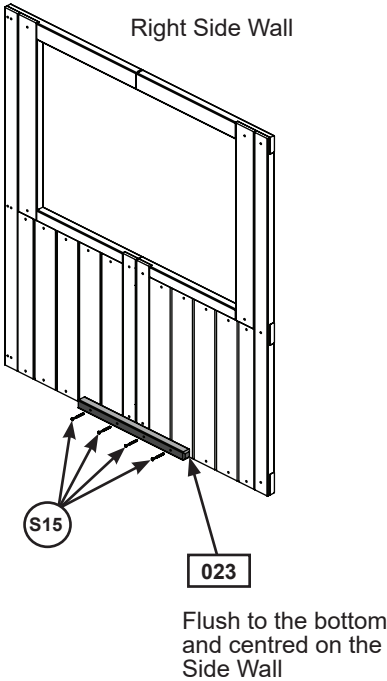


Fig. 2.6  
Inside View



### Wood Parts

2 x 023 Base Inside Blocks 1 x 1 x 15-3/4"

### Hardware

8 x S15 #8 x 1-3/4" Wood Screw



## Step 2: Frame Assembly Part 4



**E:** Center 1 (024) Front Door Base Beam to the front of (025) Bottom Door Stop Panel making sure that it's flush to the top. Attach using 3 (S15) #8 x 1-3/4" Wood Screws. (Fig. 2.7 and 2.8)

**F:** Center 1 (024) Front Door Base Beam that it's flush with (026) Top Door Stop Panel and attach using 3 (S15) #8 x 1-3/4" Wood Screws. (Fig. 2.9 and 2.10)

Fig. 2.7

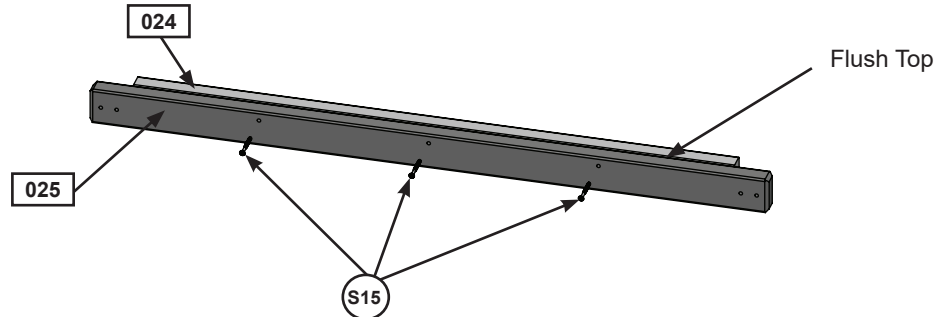


Fig. 2.8  
Front View

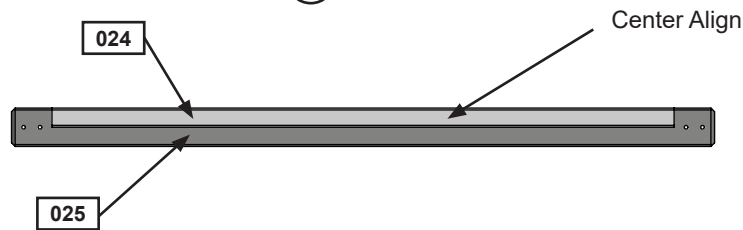


Fig. 2.9

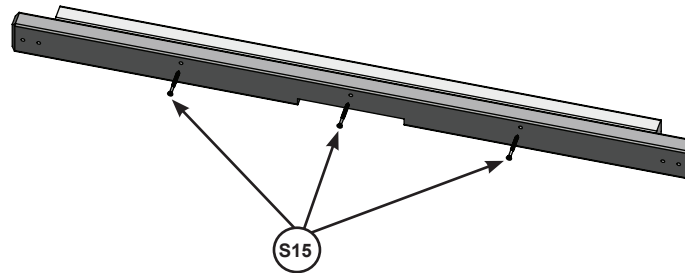
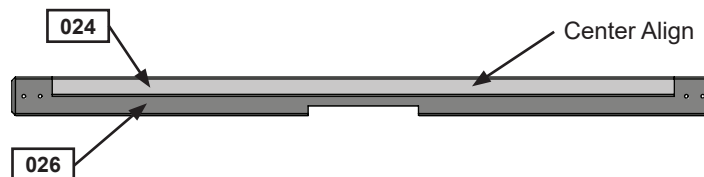


Fig. 2.10  
Front View



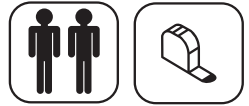
### Wood Parts

- 2 x 024 Front Doors Base Beam 1 x 1 x 32-3/8"
- 1 x 025 Bottom Door Stop Panel 1 x 2 x 36-5/8"
- 1 x 026 Top Door Stop Panel 2 x 2 x 36-5/8"

### Hardware

- 6 x S15 #8 x 1-3/4" Wood Screw

## Step 2: Frame Assembly Part 5



**G:** From inside the assembly, with a helper, place Top Door Stop Panel assembly across the top of the door opening ensuring that it's flush with the top of the walls. Attach using 2 (S15) #8 x 1-3/4" Wood Screws per side. (Fig. 2.11, 2.12 and 2.13)

**H:** From the inside of the assembly place Bottom Door Stop Assembly as shown in fig. 2.11 and attach using 2 (S15) #8 x 1-3/4" Wood Screws per side. (Fig. 2.11, 2.12 and 2.13)

**I:** With a helper, flush to the top and centred on the Back Wall attach 1 (027) Reinforce with 4 (S1) #8 x 1-1/8" Wood Screws. (Fig. 2.14)

Fig. 2.11

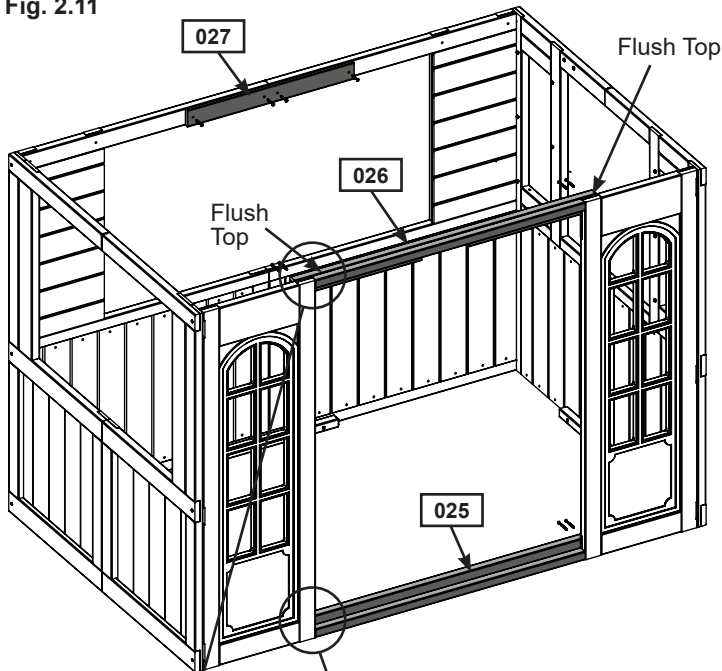


Fig. 2.13  
Inside View

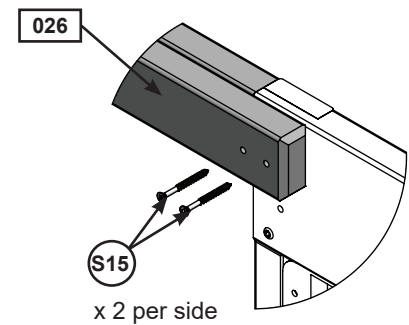
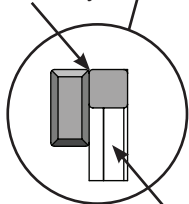


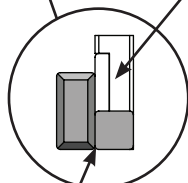
Fig. 2.12

Top Door Stop  
Panel assembly



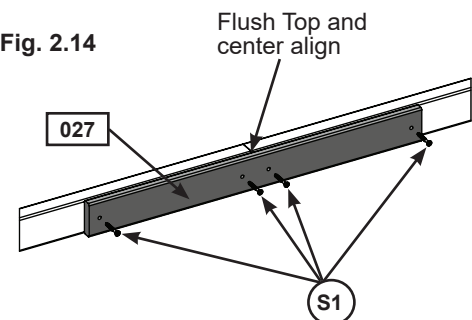
Front  
Wall

Front  
Wall



Bottom Door Stop  
Assembly

Fig. 2.14



### Wood Parts

1 x 027 Reinforce 1/2 x 2 x 20"

### Hardware

4 x S1 #8 x 1-1/8" Wood Screw

8 x S15 #8 x 1-3/4" Wood Screw

# Step 3: Patio Side Assembly Part 1



**A:** Place 1 (031) Seat Base Beam on each side of the Back Wall making sure that they are flush with the Side Walls. Attach from the inside corners using 1 Corner Panel Bracket per side with 4 (S0) #8 x 7/8" Truss Screws and from the top of the (031) Seat Base with 1 Narrow Angle Bracket and 2 (S0) #8 x 7/8" Truss Screws per side. (Fig. 3.1 and 3.2)

Fig. 3.1

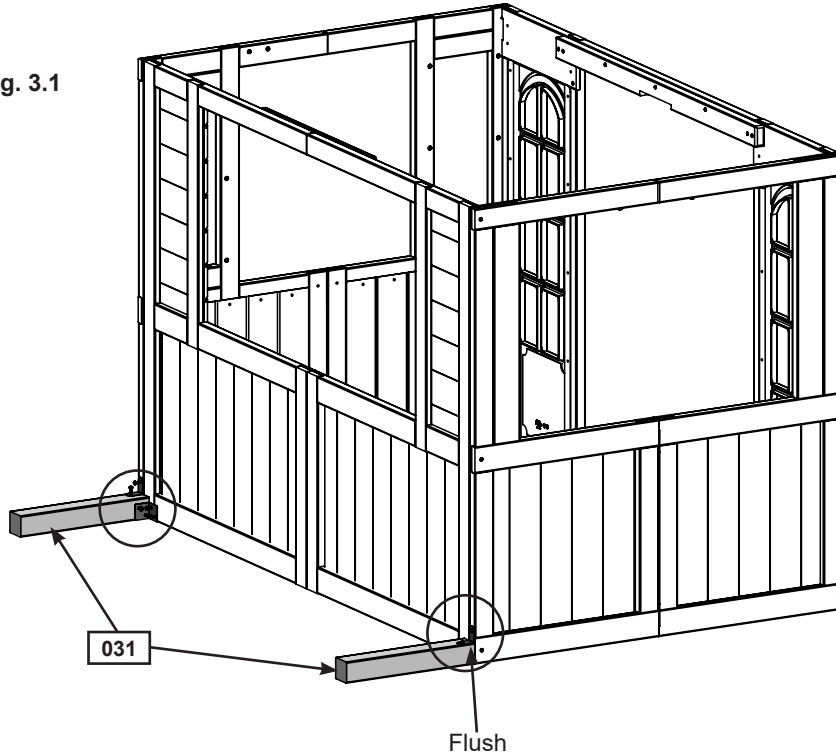
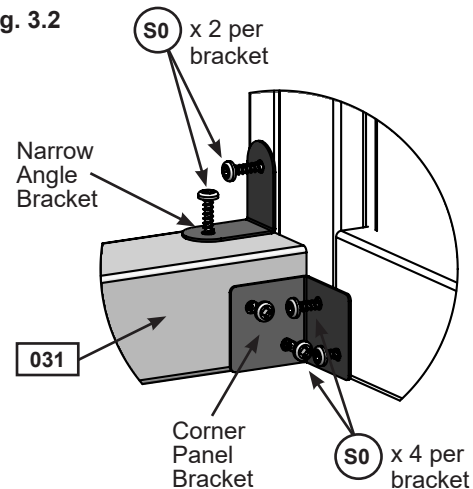


Fig. 3.2



## Wood Parts

2 x 031 Seat Base Beam 2 x 2 x 13-1/2"

## Hardware

12 x S0 #8 x 7/8" Truss Screw

## Other Parts

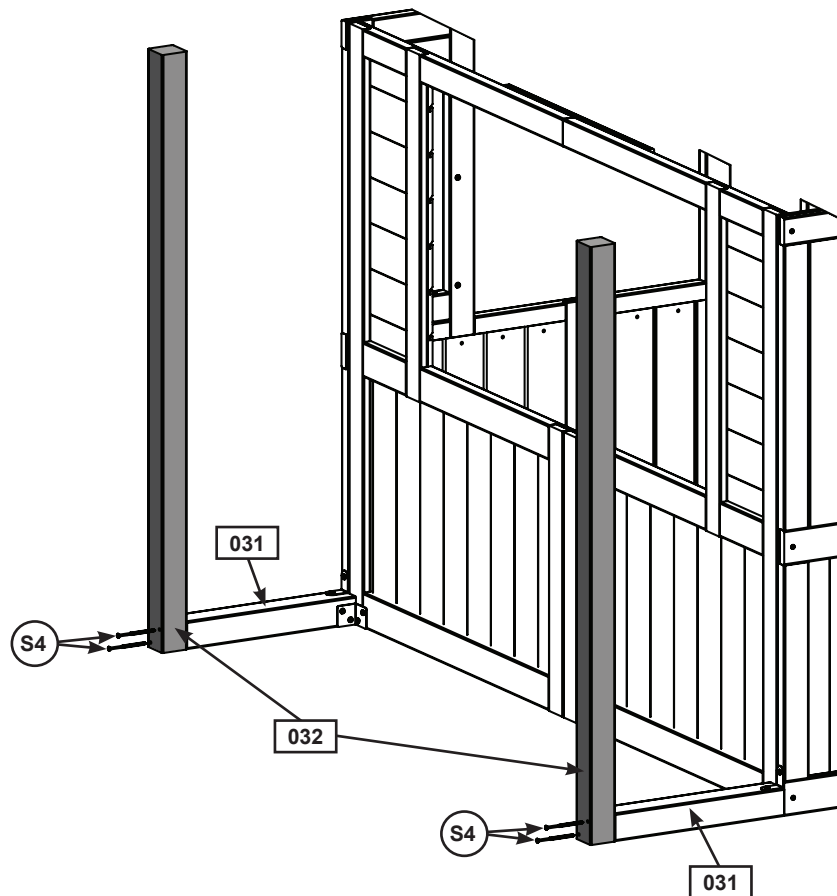
2 x Corner Panel Bracket  
2 x Narrow Angle Bracket

## Step 3: Patio Side Assembly Part 2



**B:** Place 1 (032) Patio Beam against the ends of each (031) Seat Base Beam as shown in fig. 3.3. Attach each beam using 2 (S4) #8 x 3" Wood Screws. (fig. 3.3 )

Fig. 3.3



### Wood Parts

2 x 032 Patio Beam 2 x 2 x 43"

### Hardware

4 x S4 #8 x 3" Wood Screw



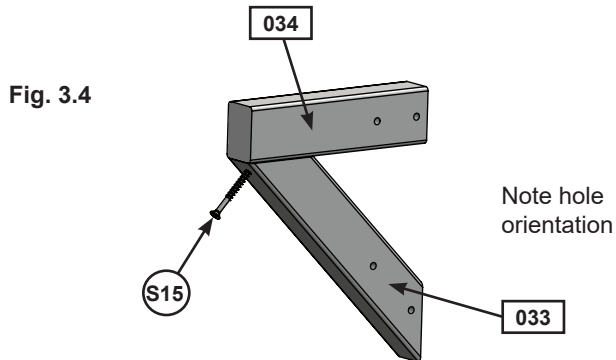
# Step 3: Patio Side Assembly Part 3



**C:** Attach 1 (033) Seat Base Gusset to 1 (034) Seat Base Block using 1 (S15) #8 x 1-3/4" Wood Screw making sure to note hole orientation. (Fig. 3.4)

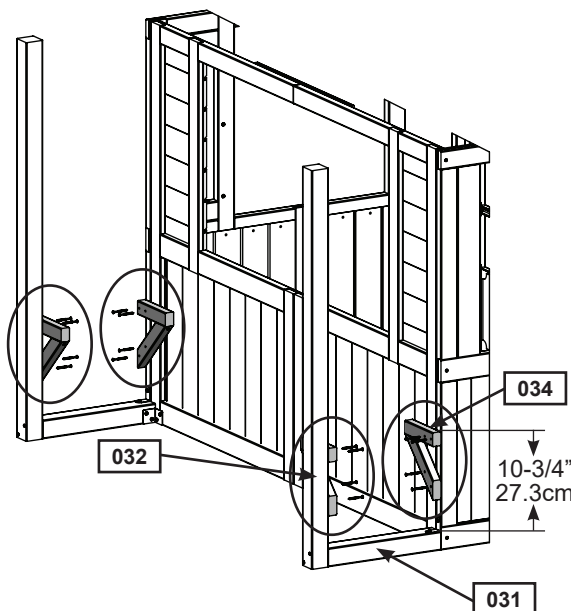
**D:** Repeat Step C to make 3 more Seat Base assemblies.

**E:** Measure 10-3/4" (27.3 cm) up from the top of each (031) Seat Base Beam. Install Seat Base assemblies to the inside of the Panel Assembly and the (032) Patio Beams as shown in fig.3.5, using 4 (S15) #8 x 1-3/4" Wood Screws per assembly. (Fig. 3.5 and 3.6)

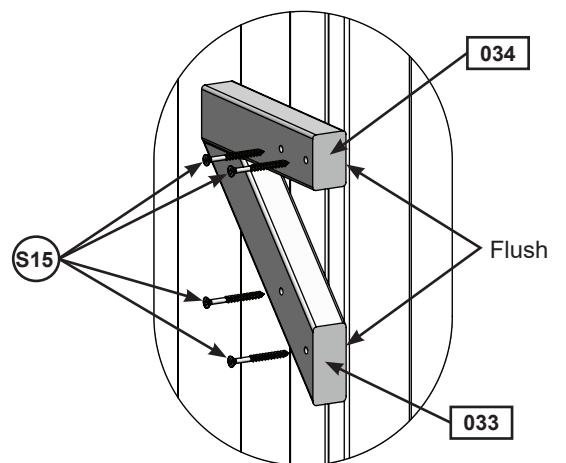


*Repeat for the other 3 Seat Base assemblies*

**Fig. 3.5**



**Fig. 3.6**



## Wood Parts

- 4 x 033 Seat Base Gusset 1 x 1-1/2 x 8-1/4"
- 4 x 034 Seat Base Block 1 x 1-1/2 x 5-3/4"

## Hardware

- 20 x S15 #8 x 1-3/4" Wood Screw

# Step 3: Patio Side Assembly

## Part 4

**F:** Place (035) Patio Side Bench Seat so that it's flush with the back ends of each (034) Seat Base Block and place (036) Patio Side Bench Seat Front so it's flush at the front. Attach using 2 (S15) #8 x 1-3/4" Wood Screws per board. (Fig. 3.7 and 3.8)

**G:** Repeat Step F to install Bench Seats on the opposite side. (Fig. 3.7 and 3.8)

Fig. 3.7

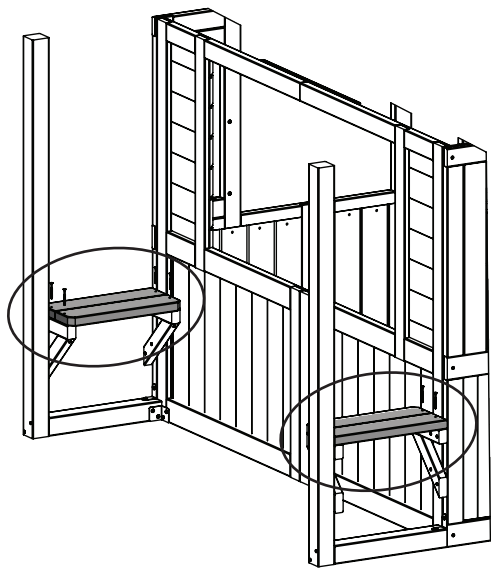
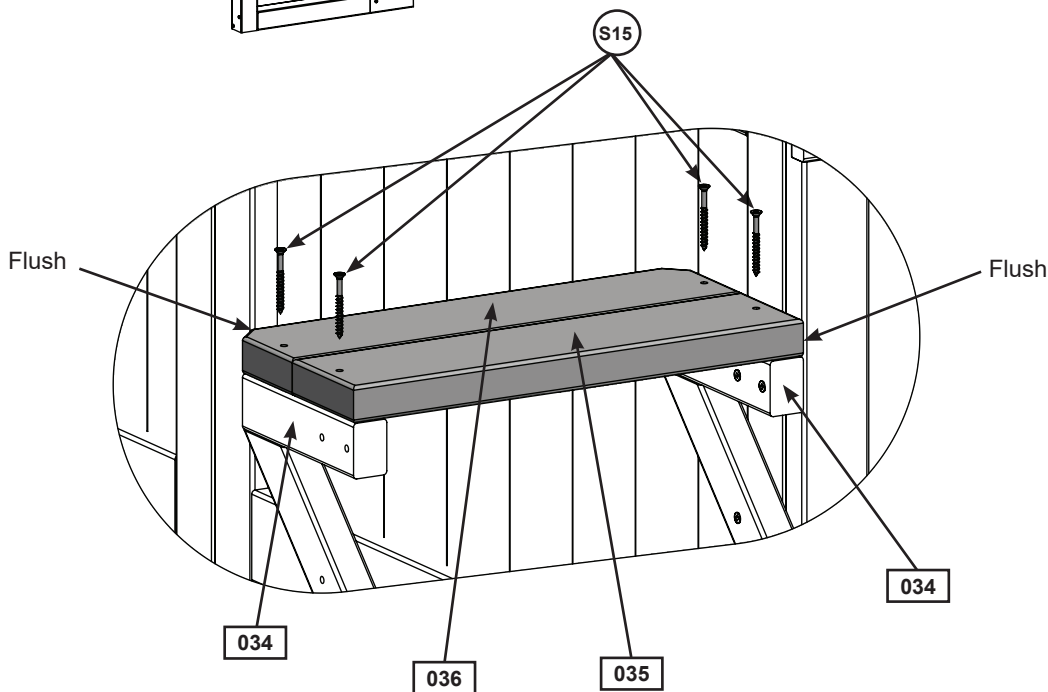


Fig. 3.8



**Wood Parts**

- 2 x 035 Patio Side Bench Seat 1 x 3-1/8 x 13-1/2"
- 2 x 036 Patio Side Bench Seat Front 1 x 3-1/8 x 13-1/2"

**Hardware**

- 8 x (S15) #8 x 1-3/4" Wood Screw

## Step 4: Attach Soffits Part 1

**A:** Place (041) Roof Beam so that it sits over the 2 pre-drilled holes in (042) Top Back Roof Lip Long. **It is important to make sure the remaining pre-drilled holes in (042) Top Back Roof Lip Long are on the outside and that the angle on (041) Roof Beam is facing the outside.** Attach from underneath using 2 (S15) #8 x 1-3/4" Wood Screws. (Fig 4.1 and 4.2)

Fig. 4.1

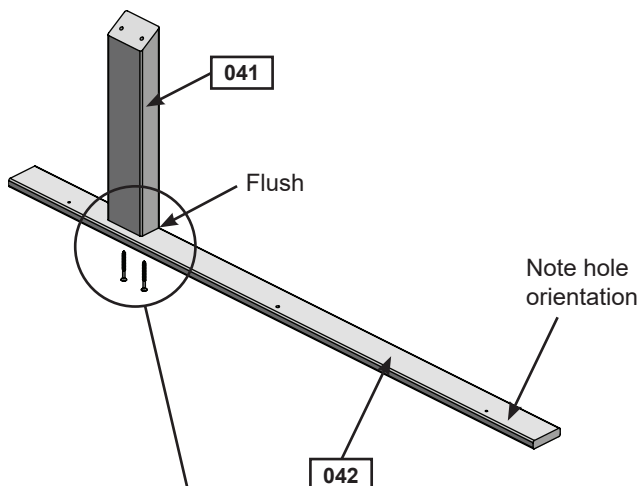
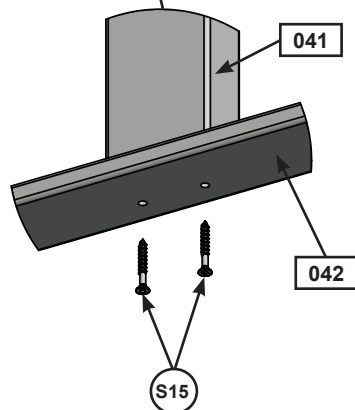


Fig. 4.2  
Bottom  
View



### Wood Parts

- 1 x 041 Roof Beam 1-3/8 x 2-1/2 x 12"
- 1 x 042 Top Back Roof Lip Long 1/2 x 2 x 38-5/8"

### Hardware

- 2 x S15 #8 x 1-3/4" Wood Screw

## Step 4: Attach Soffits Part 2



**It is important to note hole orientations for the following steps.**

**B:** Flush to the inside face of each Side Wall center 1 (044) Side Frame Support Panel and attach with 4 (S15) #8 x 1-3/4" Wood Screws. (Fig. 4.3 and 4.4)

**C:** On the right side of the Back Wall, tight to the (044) Side Frame Support Panel and flush to the inside face of the wall attach 1 (043) Top Back Roof Lip Soffit Long using 2 (S15) #8 x 1-3/4" Wood Screws. Note hole orientations. (Fig. 4.3 and 4.4)

**D:** Repeat Step C to install (042) Top Back Roof Lip Long on the left side using 3 (S15) #8 x 1-3/4" Wood Screws. Note hole orientations. (Fig. 4.3 and 4.4)

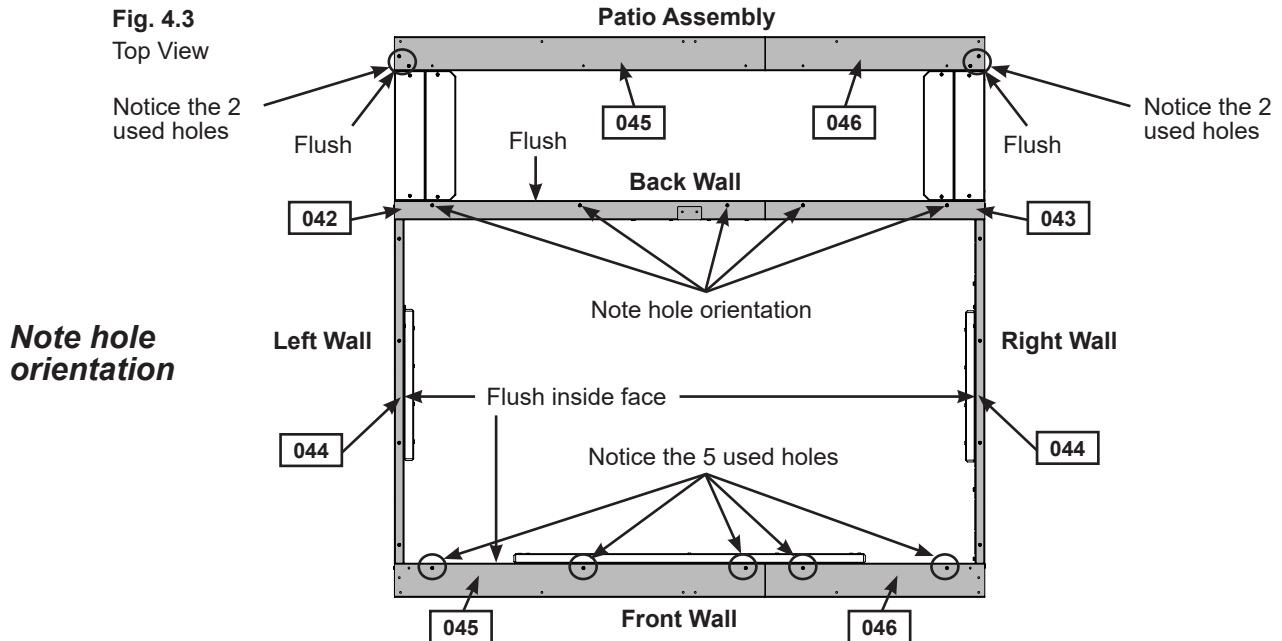
**E:** On the left side of the Front Wall, tight to the (044) Side Frame Support Panel and flush to the inside face of the wall attach 1 (045) Roof Support Panel using 2 (S1) #8 x 1-1/8" and 1 (S15) #8 x 1-3/4" Wood Screws. Note hole orientations. (Fig. 4.3 and 4.4)

**F:** Repeat Step E to install (046) Roof Support Short Panel on the right side using 1 (S1) #8 x 1-1/8" and 1 (S15) #8 x 1-3/4" Wood Screws. Note hole orientations. (Fig. 4.3 and 4.4)

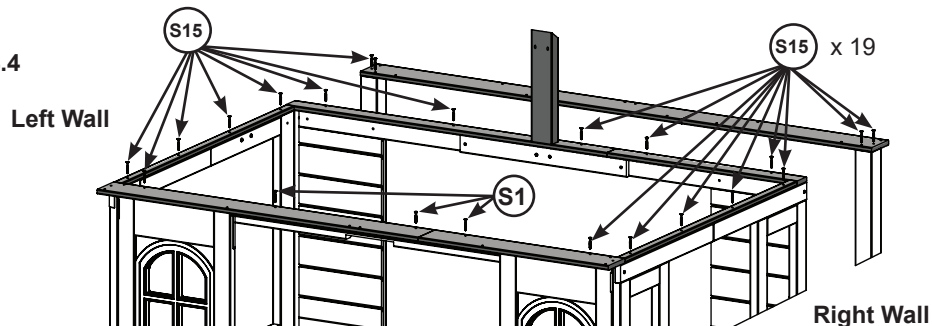
**G:** With a helper, repeat Steps E and F to install (045) Roof Support Panel and (046) Roof Support Short Panel on the Patio Assembly. These boards will need to be held in place until the next step. (Fig. 4.3 and 4.4)

**Fig. 4.3**

Top View



**Fig. 4.4**



### Wood Parts

- 1 x 043 Top Back Roof Lip 1/2 x 2 x 22-7/8"
- 2 x 044 Side Frame Support Panel 1/2 x 1 x 35-3/4"
- 2 x 045 Roof Support Panel 1/2 x 3-1/2 x 38-5/8"
- 2 x 046 Roof Support Short Panel 1/2 x 3-1/2 x 22-7/8"

### Hardware

- 3 x S1 #8 x 1-1/8" Wood Screw
- 19 x S15 #8 x 1-3/4" Wood Screw

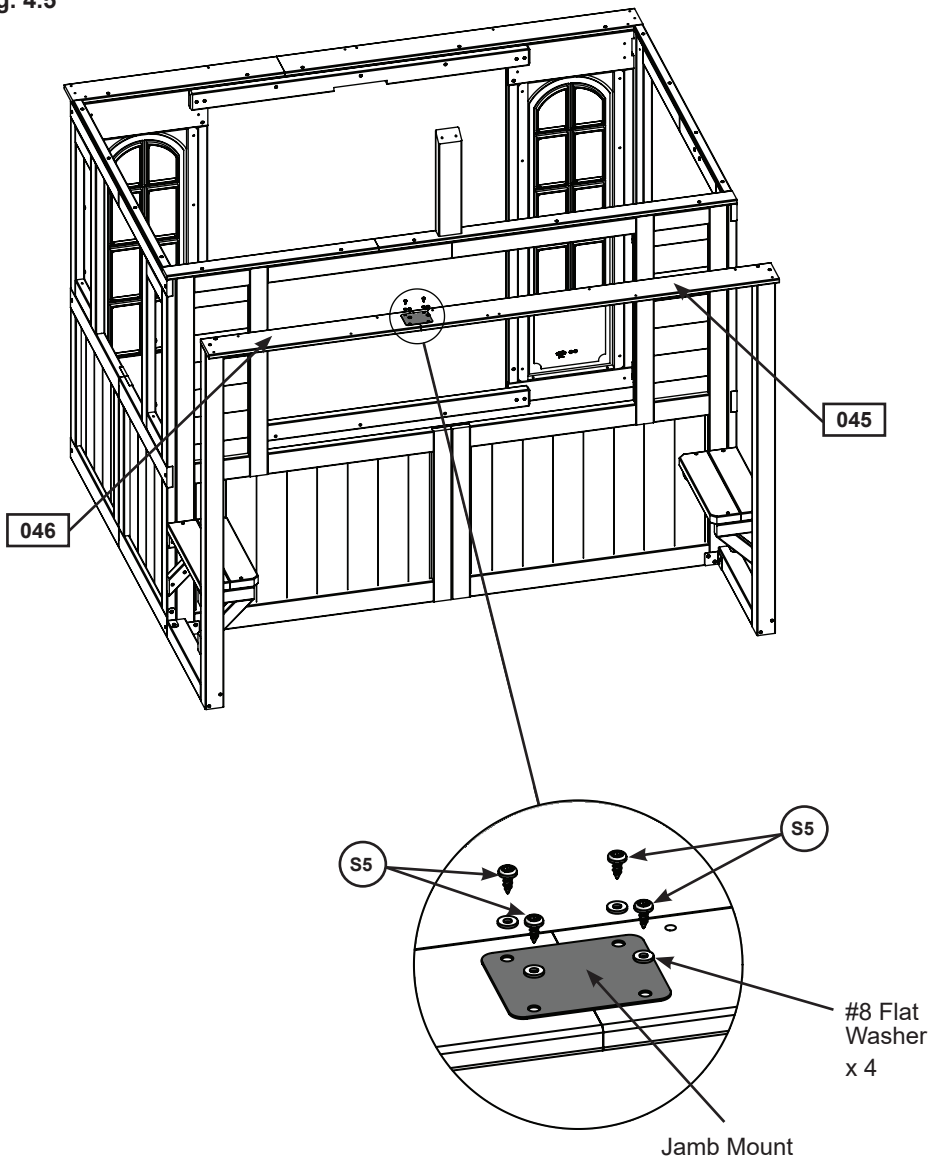
# Step 4: Attach Soffits

## Part 3



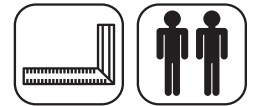
**H:** Have a helper hold (045) Roof Support Panel and (046) Roof Support Short Panel in place. From above, install a Jamb Mount using 4 (S5) #8 x 1/2" Pan Screws (with #8 washer) joining the pieces together. (Fig. 4.5)

Fig. 4.5



Hardware		Other Parts
4 x	 #8 x 1/2" Pan Screw (with #8 Flat Washer)	1 x Jamb Mount

# Step 5: Roof Assembly Part 1



**A:** Connect 1 (051) Roof Panel Front to (052) Roof Panel Back so that (051) Roof Panel Front overlaps and the inside angle is square and tight. Attach panels together with 3 (S1) #8 x 1-1/8" Wood Screws. (Fig. 5.1 and 5.2)

**B:** Repeat to create a second roof assembly.

Fig. 5.1

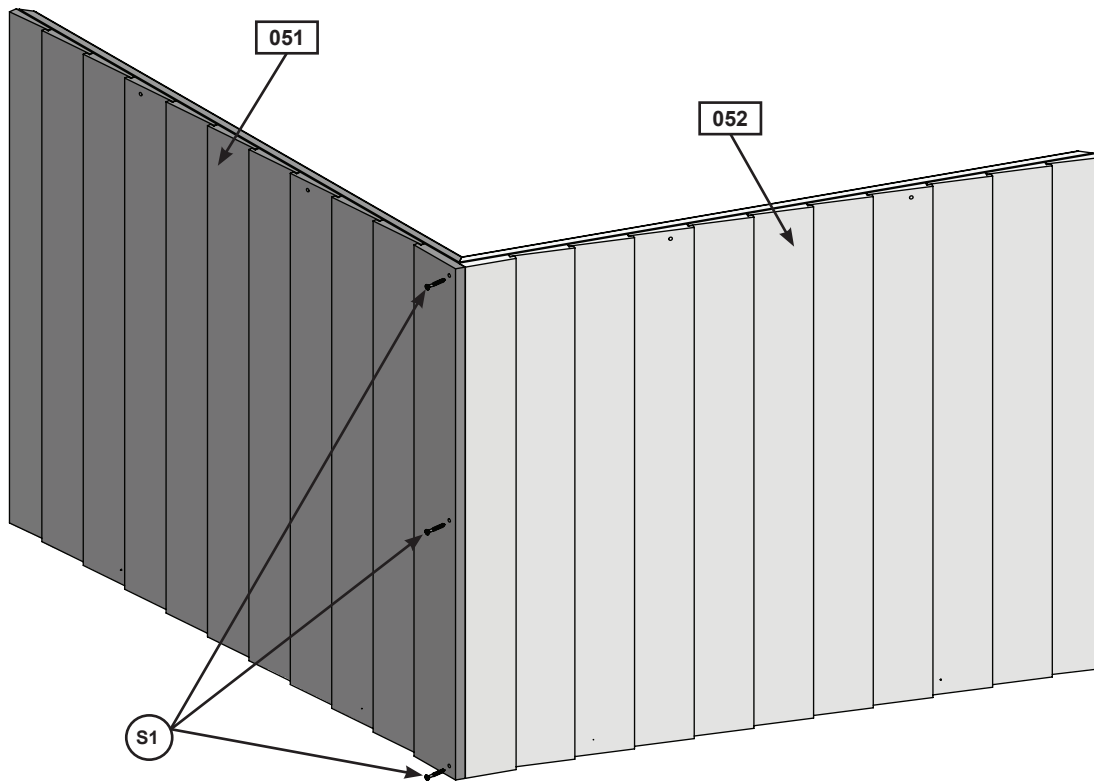
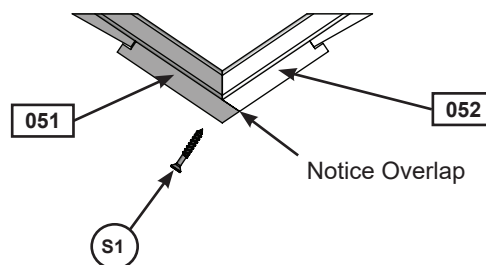


Fig. 5.2  
Top View



**Repeat to create a second roof assembly**

## Wood Parts

- 2 x 051 Roof Panel Front 1-1/8 x 30-3/4 x 35-1/8"
- 2 x 052 Roof Panel Back 1-1/8 x 30-3/4 x 35-5/8"

## Hardware

- 6 x S1 #8 x 1-1/8" Wood Screw

## Step 5: Roof Assembly Part 2



**C:** Place 2 (054) Triangle tops together as shown in fig. 5.3, making sure that the sharper angle is at the bottom. (Fig. 5.3)

**D:** Making sure that all edges are flush, place 2 (053) Triangle Bottoms tight together and tight to (054) Triangle Tops. (Fig. 5.3)

**E:** Place 1 Side Frame Triangle Folding Window inside the Truss assembly and attach using 12 (S0) #8 x 7/8" Truss Screws. (Fig. 5.4)

**F:** Install 3 (S4) #8 x 3" Wood Screws into each frame as shown in fig. 5.5.

**G:** Repeat Steps C - F to create a second truss.

Fig. 5.3

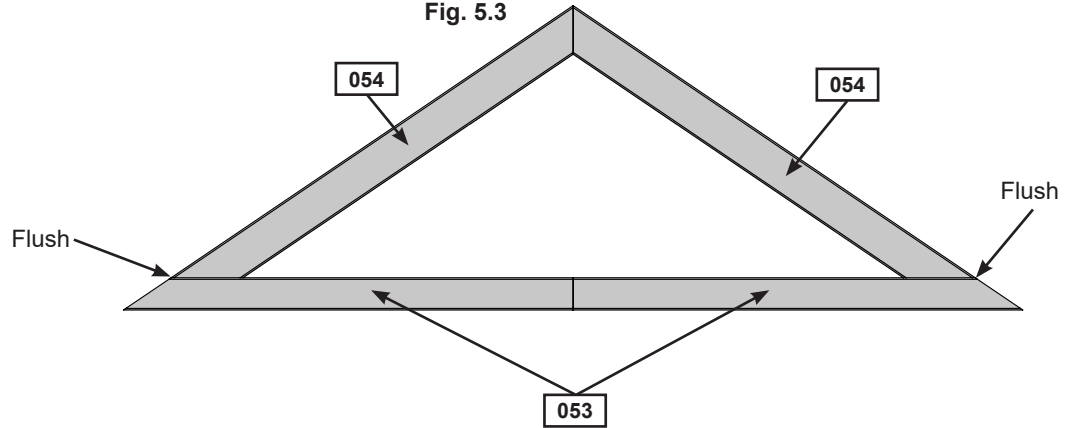
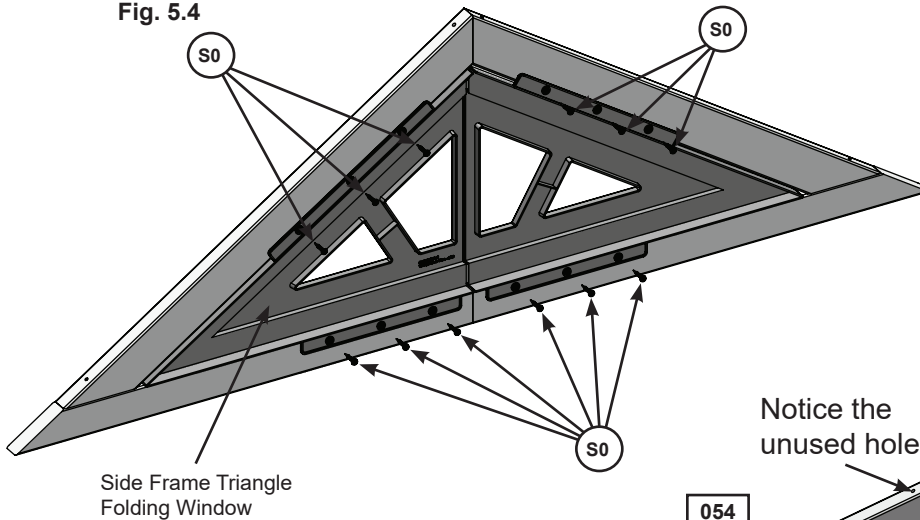
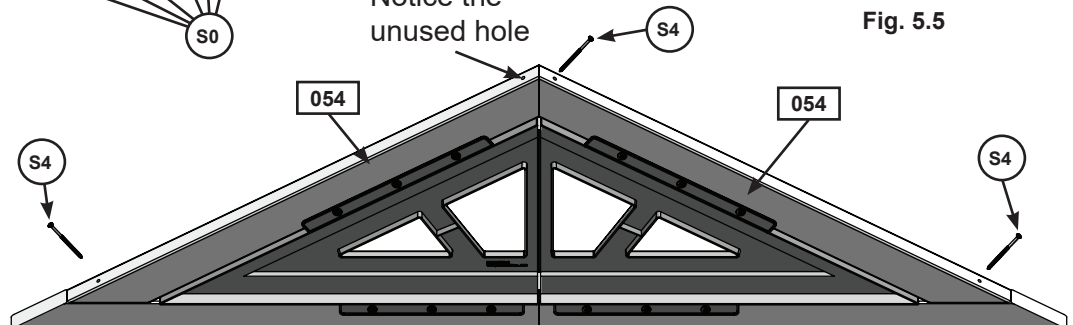


Fig. 5.4



Notice the unused hole

Fig. 5.5



*Repeat to create a second truss*

### Wood Parts

- 4 x 053 Triangle Bottom 1 x 2 x 28"
- 4 x 054 Triangle Top 1 x 2-1/2 x 30-1/8"

### Hardware

- 24 x S0 #8 x 7/8" Truss Screw
- 6 x S4 #8 x 3" Wood Screw

### Other Parts

- 2 x Side Frame Triangle Folding Window



## Step 5: Roof Assembly Part 3



**H:** With both roof assemblies on their sides, have a helper hold each truss assembly in place at the underside of each roof edge making sure that all edges are flush. Attach from the outside using 4 (S3) #8 x 2-1/2" Wood Screws per side. (Fig 5.6 and 5.7)

Fig. 5.6

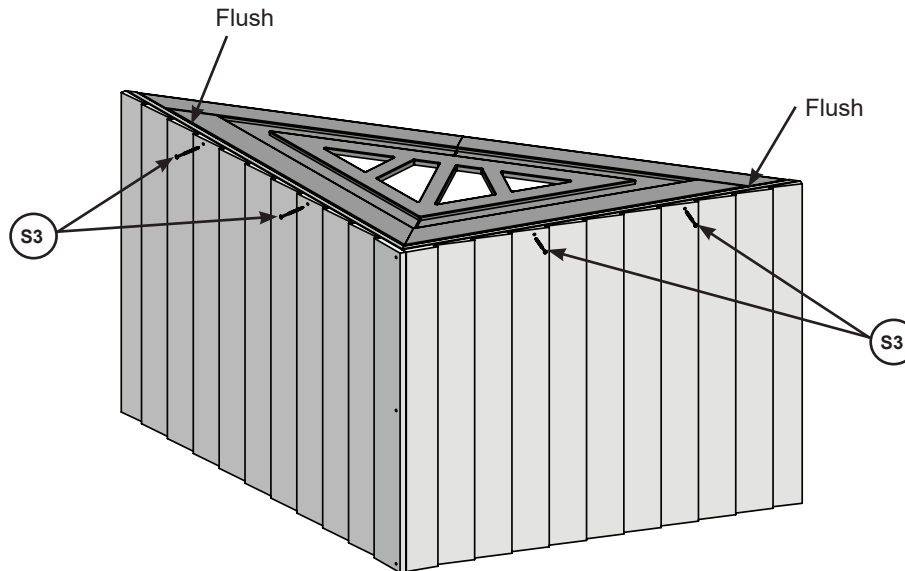
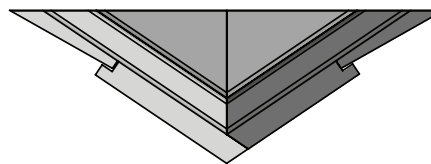


Fig. 5.7



Notice Overlap

*Repeat for the second roof assembly*

### Hardware

8 x (S3) #8 x 2-1/2" Wood Screw

## Step 5: Roof Assembly Part 4



**I:** With a helper, join the 2 roof assemblies from the inside, centering 1 (055) Roof Assembly Support at the peak as shown in fig. 5.8. Attach using 4 (S1) #8 x 1-1/8" Wood Screws. (Fig 5.8 and 5.9)

**J:** On each side of the of the roof assembly, measure 8-1/2" from the inside peak and install 1 Jamb Mount using 4 (S0) #8 x 7/8" Truss Screws (with #8 washer). (Fig 5.10 and 5.11)

**K:** Install a second Jamb Mount on each side, this time measuring 25" from the inside peak. Attach using 4 (S0) #8 x 7/8" Truss Screws (with #8 washer) per side. (Fig 5.10 and 5.11)

Fig. 5.8

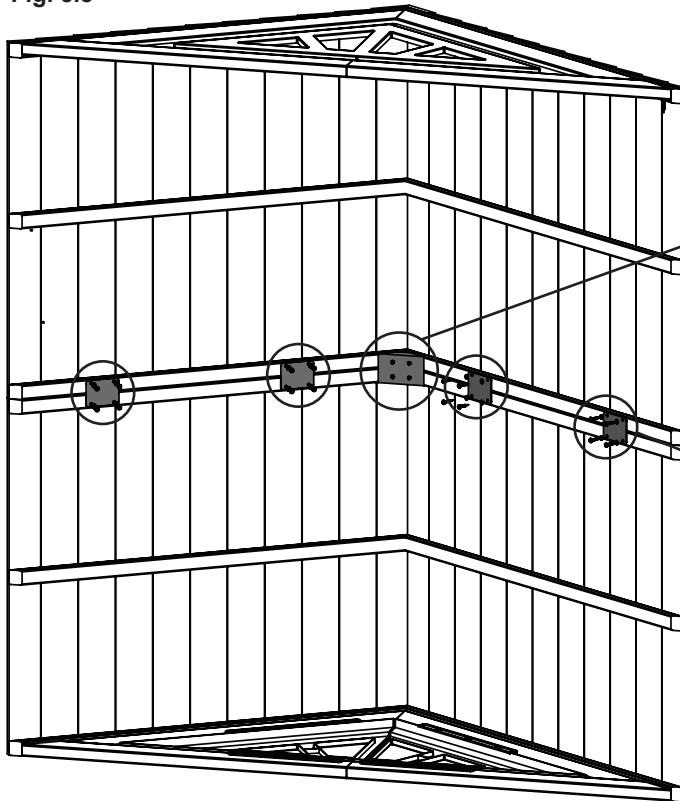


Fig. 5.9

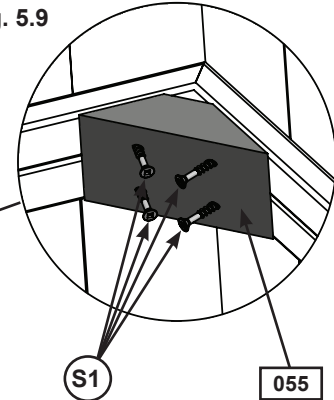


Fig. 5.10

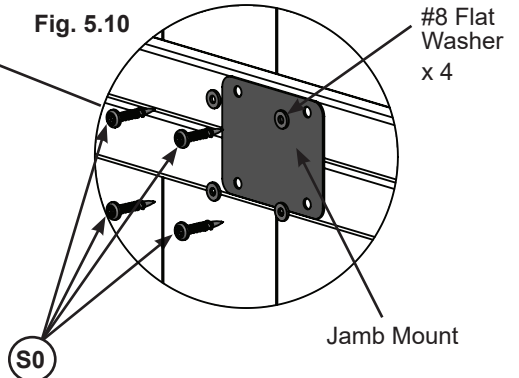
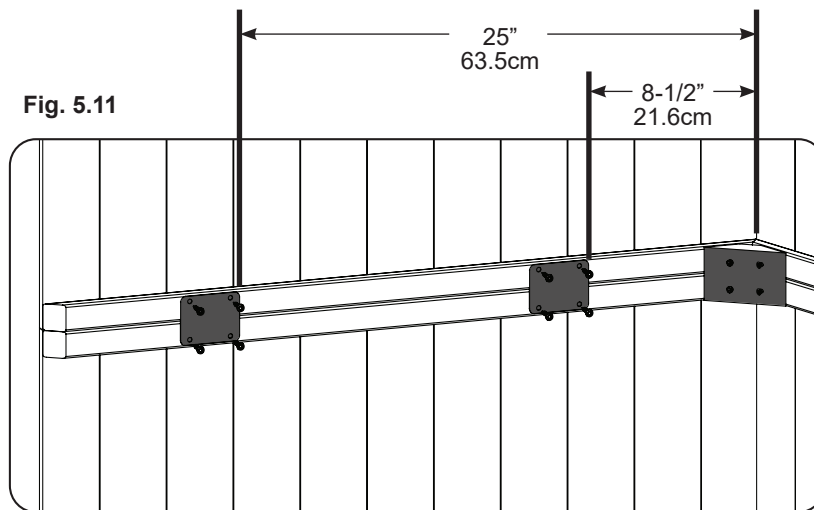


Fig. 5.11



### Wood Parts

1 x 055 Roof Assembly Support 1 x 2-1/2 x 4"

### Hardware

4 x S1 #8 x 1-1/8" Wood Screw

16 x S0 #8 x 7/8" Truss Screw (with #8 Flat Washer)

### Other Parts

4 x Jamb Mount

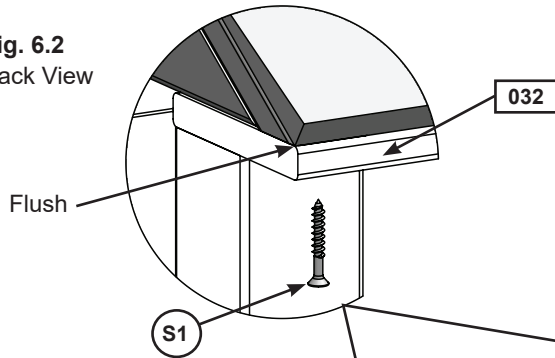
## Step 6: Attach Roof to Frame Part 1



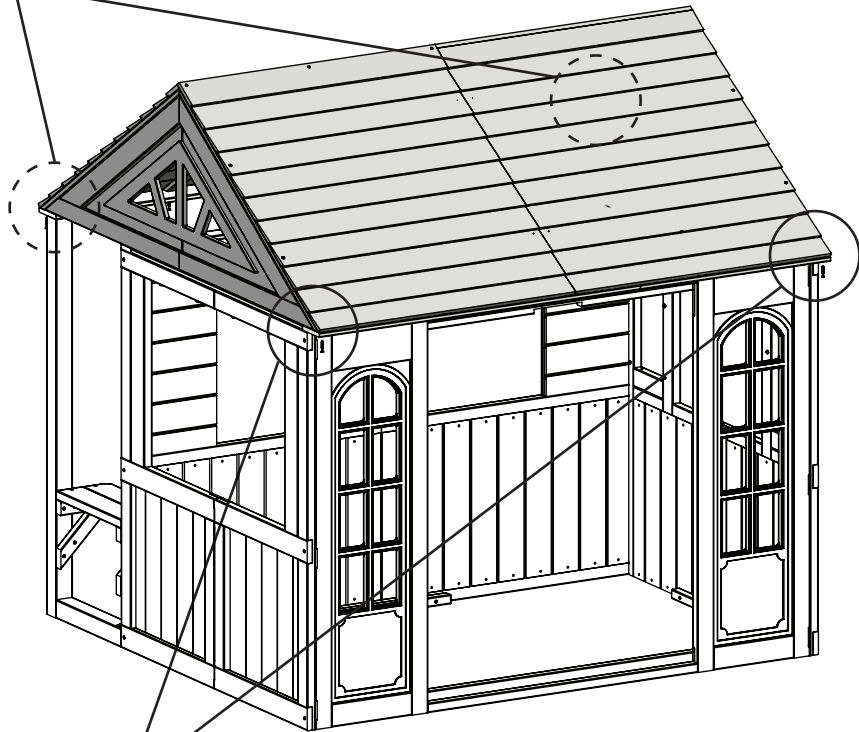
**A:** With a helper, lift the roof assembly and place it onto the main frame, making sure that all 4 corners are flush. (Fig. 6.1, 6.2 and 6.3)

**B:** Install 1 (S1) #8 x 1-1/8" Wood Screw into the underside of each corner to secure the roof to the frame. (Fig. 6.1, 6.2, 6.3)

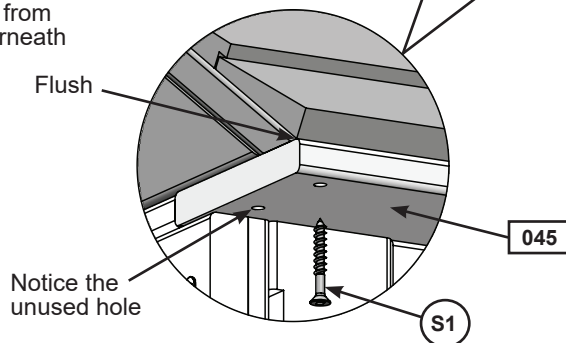
**Fig. 6.2**  
Back View



**Fig. 6.1**



**Fig. 6.3**  
View from underneath



### Hardware

4 x (S1) #8 x 1-1/8" Wood Screw

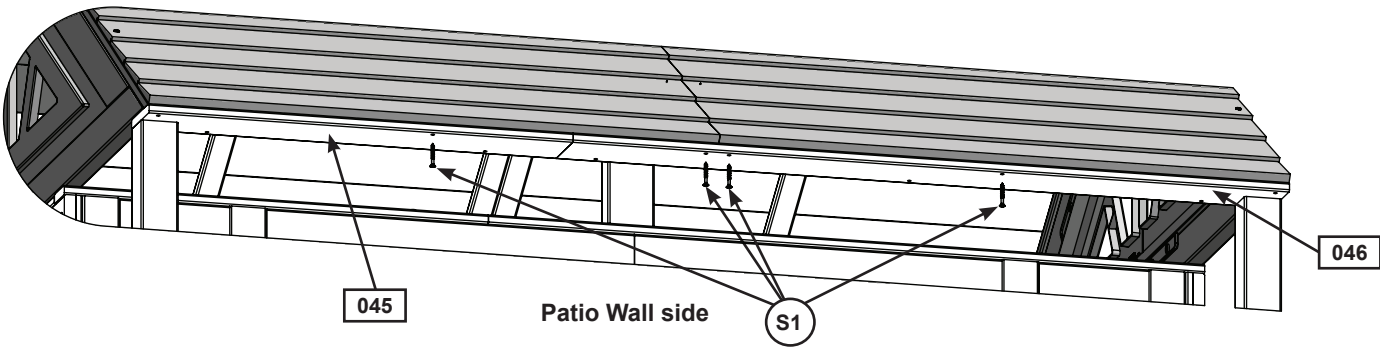
# Step 6: Attach Roof to Frame

## Part 2

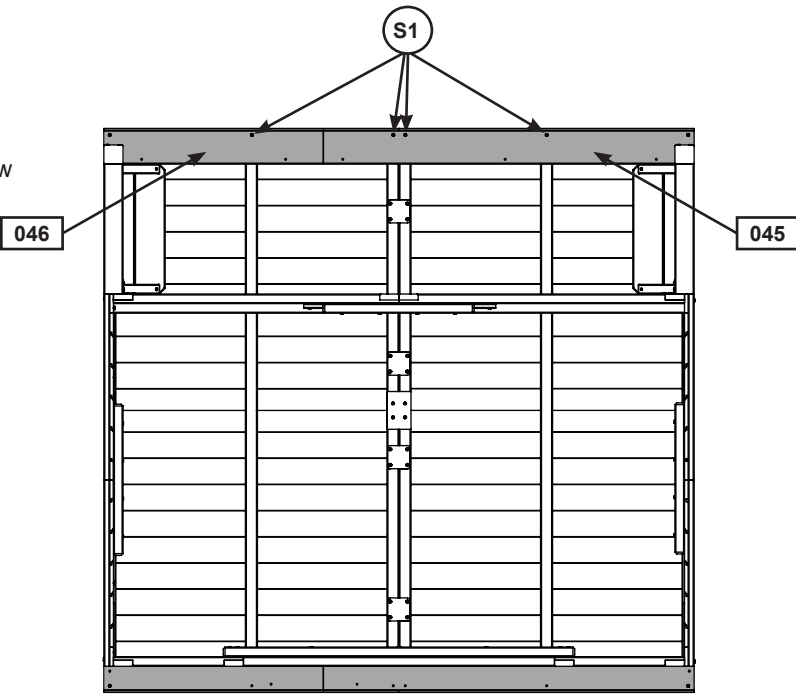


**C:** From the underside of the roof on the Patio Wall side install 4 (S1) #8 x 1-1/8" Wood Screws into the outside pre-drilled holes. (Fig. 6.4 and 6.5)

**Fig. 6.4**  
Back View from underneath



**Fig. 6.5**  
Bottom View



**Hardware**

4 x (S1) #8 x 1-1/8" Wood Screw

# Step 6: Attach Roof to Frame

## Part 3



D: Attach (041) Roof Beam to center support beam using 2 (S2) #8 x 1-1/2" Wood Screw. (Fig. 6.6 and 6.7)

Fig. 6.6

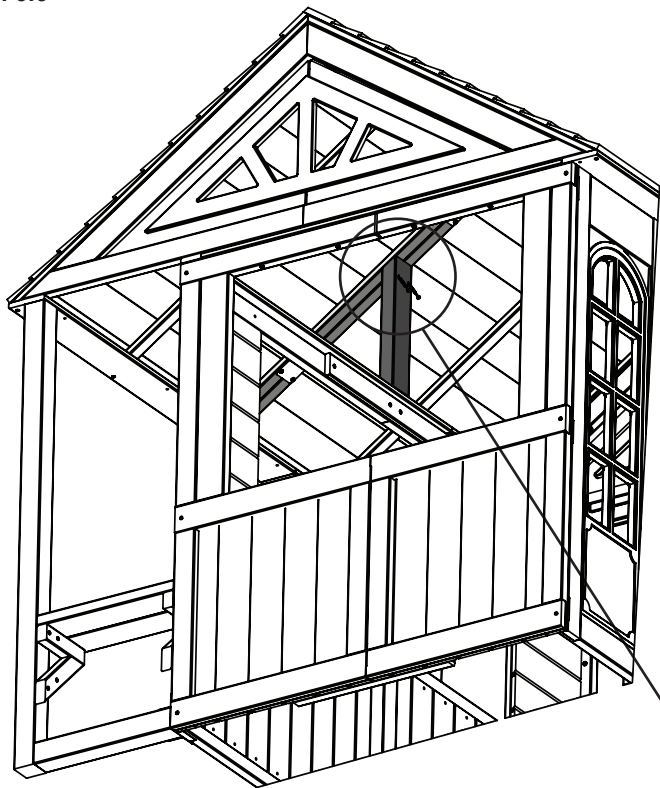
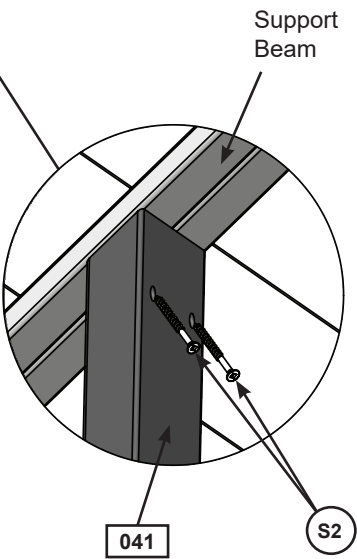



Fig. 6.7



**Hardware**

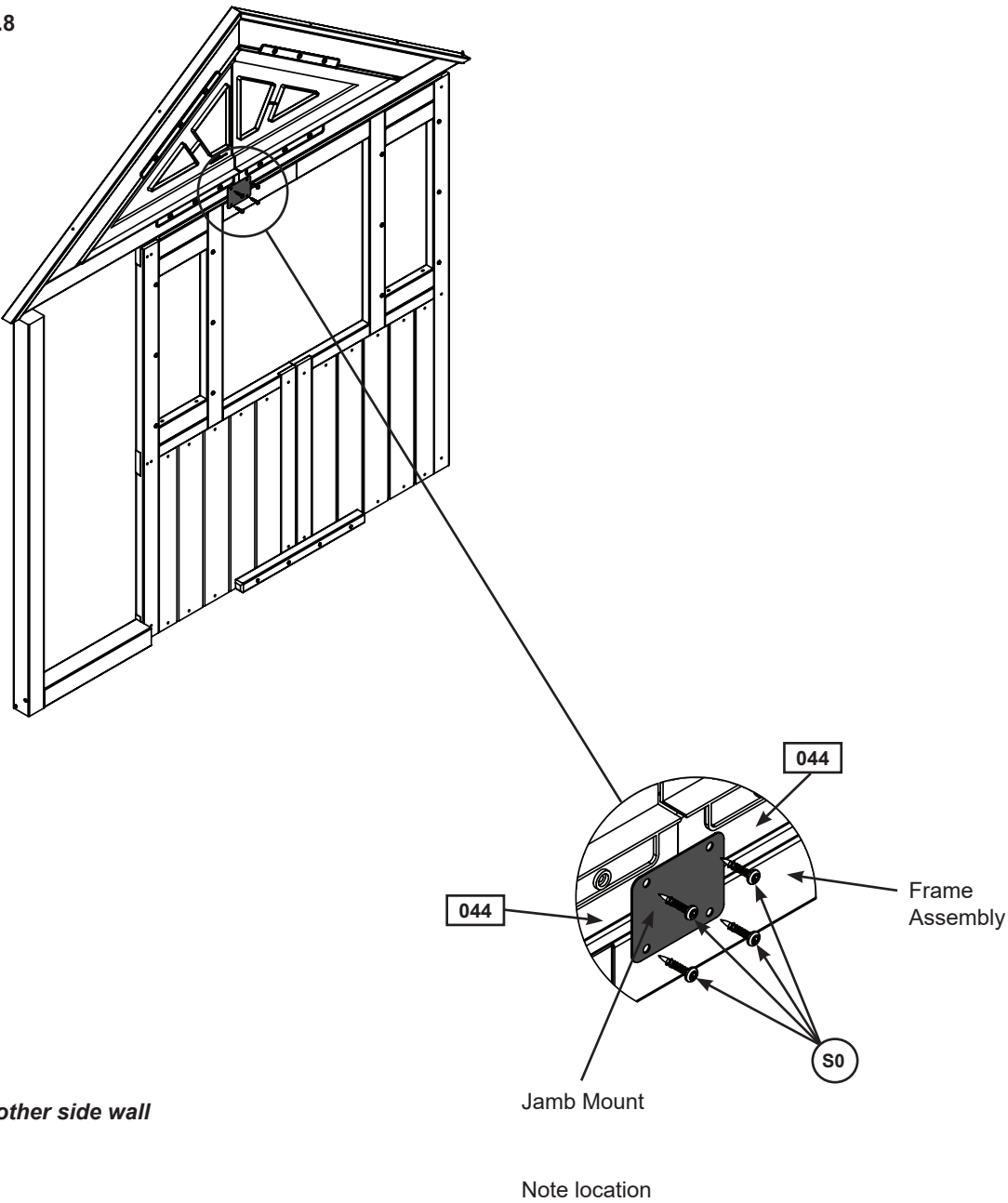
2 x  #8 x 1-1/2" Wood Screw

# Step 6: Attach Roof to Frame

## Part 4

**E:** On each side wall, center a Jamb Mount over (044) Side Frame Support Panels making sure the top set of holes are over the (044) Side Frame Support Panel and the bottom set of holes are over the Frame assembly. Attach each Jamb Mount using 4 (S0) #8 x 7/8" Truss Screws. (Fig. 6.8)

Fig. 6.8



**Hardware**

8 x (S0) #8 x 7/8" Wood Screw

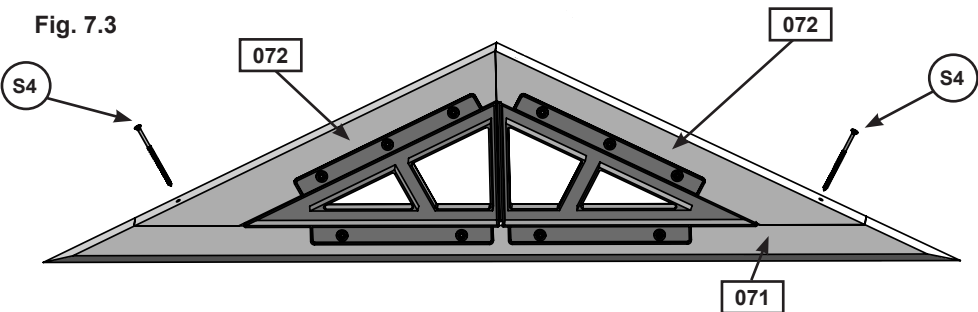
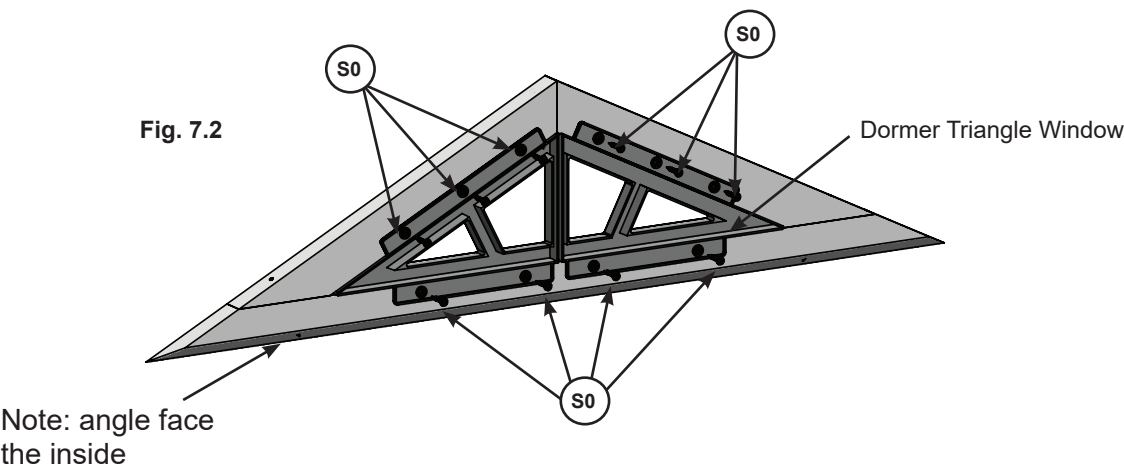
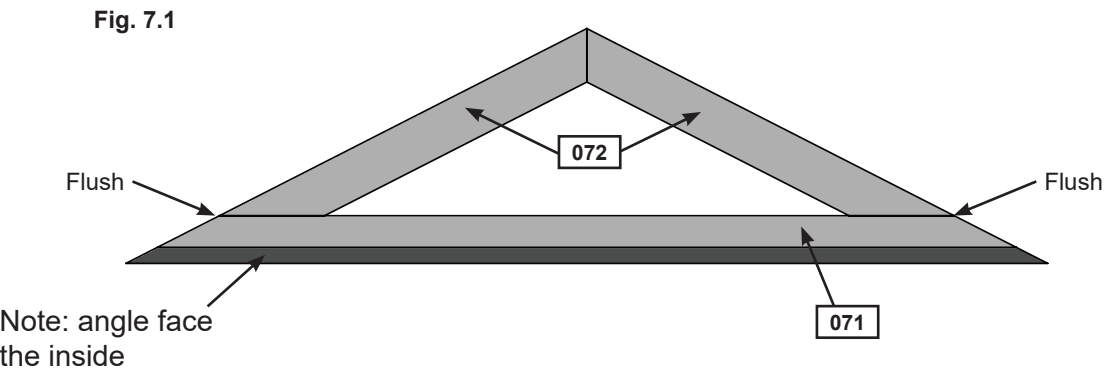
**Other Parts**

2 x Jamb Mount

# Step 7: Attach Dormer to Roof

## Part 1

- A:** Place 2 (072) Roof Add On-Inside Rims together as shown in fig.7.1, making sure that the sharper angle is at the bottom. (Fig. 7.1)
- B:** Making sure that the angled edge is on the inside and that the corners are flush, place (071) Roof Add On-Bottom to create the dormer frame. (Fig. 7.1)
- C:** Place Dormer Triangle Window Add On inside the dormer assembly and attach using 10 (S0) #8 x 7/8" Truss Screws. (Fig. 7.2)
- D:** Install 2 (S4) #8 x 3" Wood Screws into each frame as shown in fig. 7.3.



**Wood Parts**

- 1 x 071 Roof Add On-Bottom 1 x 2 x 38-5/8"
- 2 x 072 Roof Add On-Inside Rim 1 x 2 x 17-1/4"

**Hardware**

- 10 x S0 #8 x 7/8" Truss Screw
- 2 x S4 #8 x 3" Wood Screw

**Other Parts**

- 1 x Dormer Triangle Window

# Step 7: Attach Dormer to Roof

## Part 2



E: Center the dormer assembly over the door opening on the front roof and attach from underneath using 4 (S3) #8 x 2-1/2" Wood Screws. (Fig. 7.4 and 7.5)

Fig. 7.4

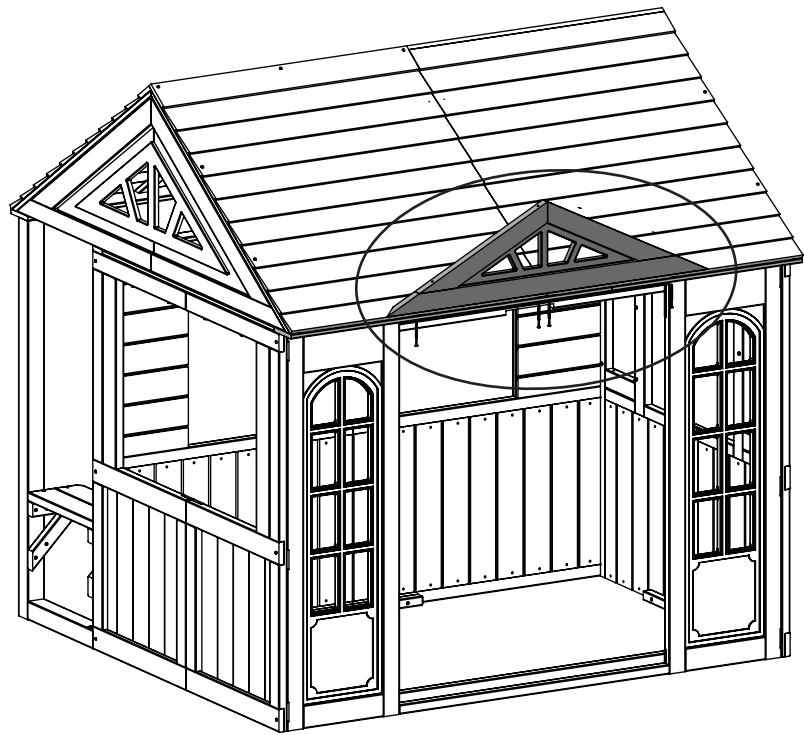
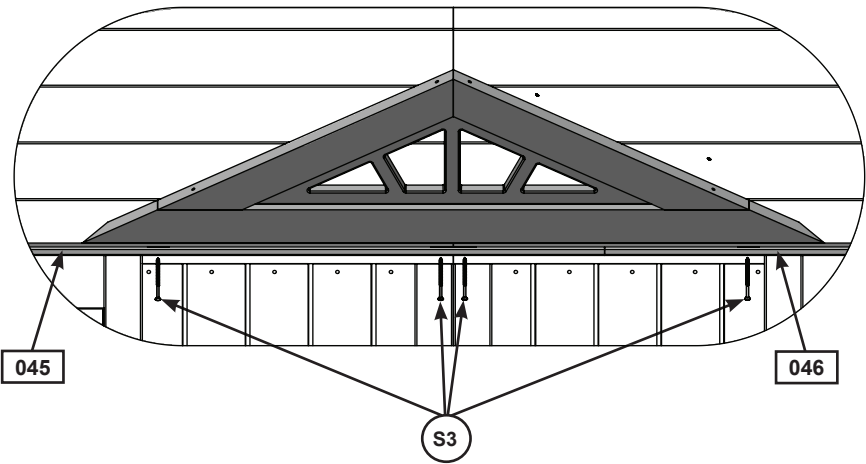



Fig. 7.5



### Hardware

4 x  #8 x 2-1/2" Wood Screw



# Step 7: Attach Dormer to Roof Part 3



**F:** Place (074) Roof Add On-Outside Rim-Left and (073) Roof Add On-Outside Rim Right over the dormer assembly so they meet tightly together at the peak and are tight to the roof panels. Attach using 1 (S15) #8 x 1-3/4" Wood Screw, 2 (S3) #8 x 2-1/2" Wood Screws per side. (Fig. 7.6 and 7.7)

Fig. 7.6

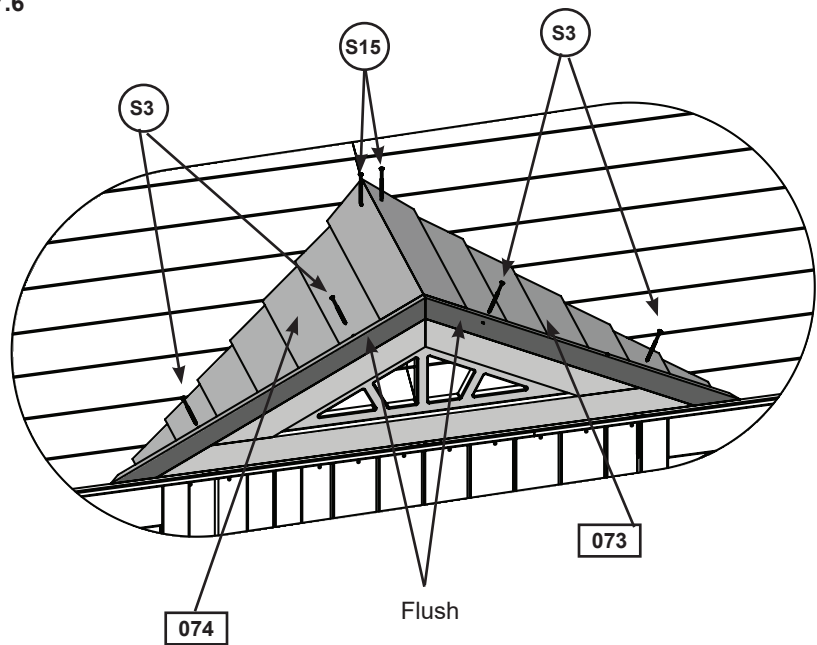
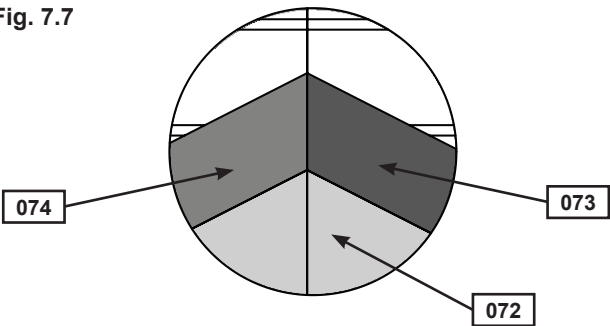


Fig. 7.7



**Wood Parts**

- 1 x 073 Roof Add On-Outside Rim-Right 1-1/2 x 17 x 25-3/8"
- 1 x 074 Roof Add On-Outside Rim-Left 1-1/2 x 17 x 25-3/8"

**Hardware**

- 2 x S15 #8 x 1-3/4" Wood Screw
- 4 x S3 #8 x 2-1/2" Wood Screw

## Step 8: Cafe Assembly

**A:** Place (081) Table Support centered below the right side window so that it's flush with the frame, taking note of the hole orientation. Attach using 2 (S15) #8 x 1-3/4" Wood Screws. (Fig. 8.1 and 8.2)

**B:** Fit (082) Bench Countertop into the window opening over (081) Table Support and attach from underneath with 4 (S15) #8 x 1-3/4" Wood Screws. (Fig. 8.1 and 8.2)

**C:** Place (083) Table Support Long centered below the Back Wall window so that it's flush with the frame, taking note of the hole orientation. Attach using 2 (S15) #8 x 1-3/4" Wood Screws. (Fig. 8.1 and 8.3)

**D:** Fit (084) Long Bench Countertop into the window opening over (083) Table Support Long and attach from underneath with 4 (S15) #8 x 1-3/4" Wood Screws. (Fig. 8.1 and 8.3)

Fig. 8.1

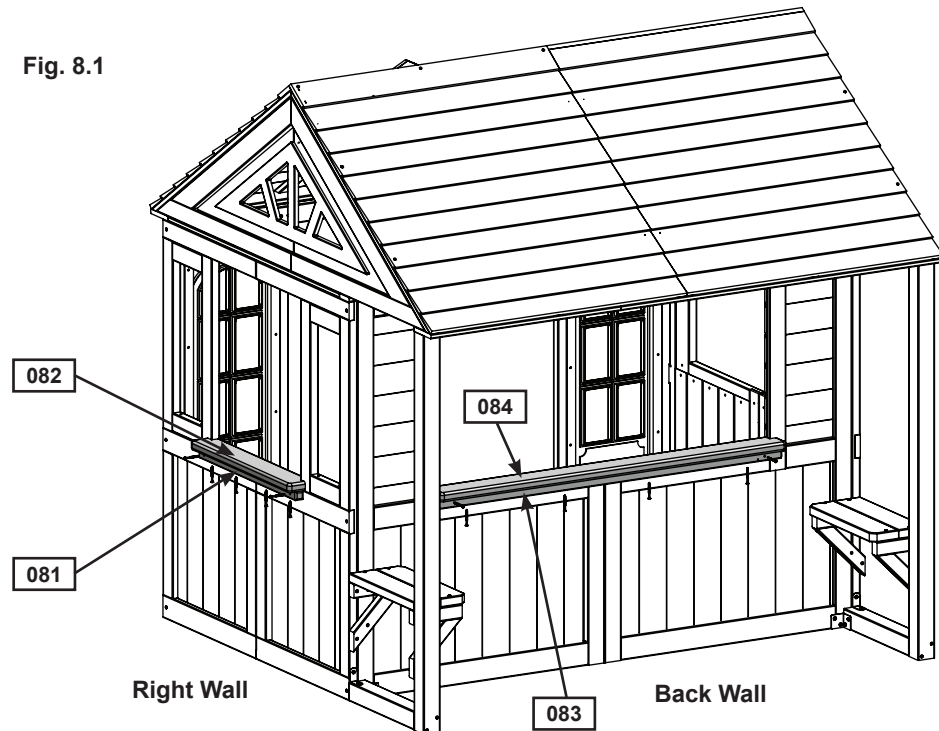


Fig. 8.2

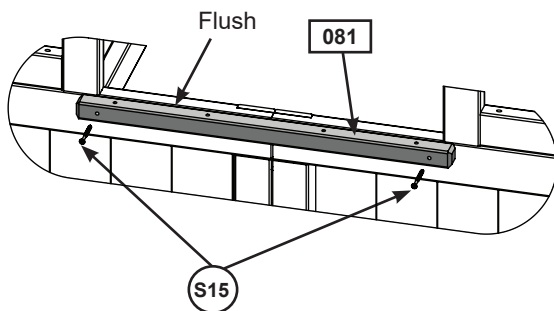
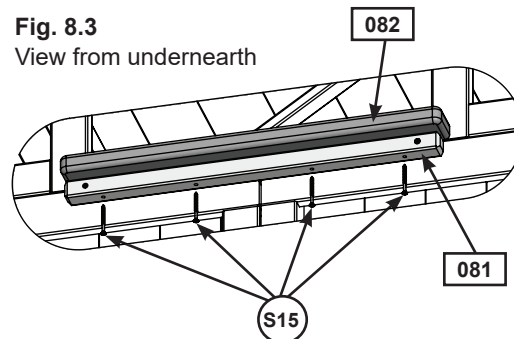


Fig. 8.3

View from underneath



*Repeat step to attach (083) and (084)*

### Wood Parts

- 1 x 081 Table Support 1 x 1 x 20-1/2"
- 1 x 082 Bench Countertop 1 x 3 x 20-1/2"
- 1 x 083 Table Support Long 1 x 1 x 41-5/8"
- 1 x 084 Long Bench Countertop 1 x 3 x 41-5/8"

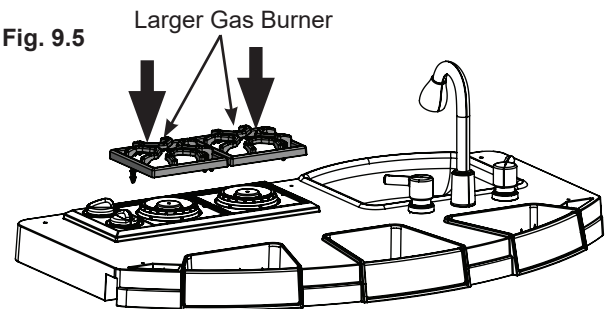
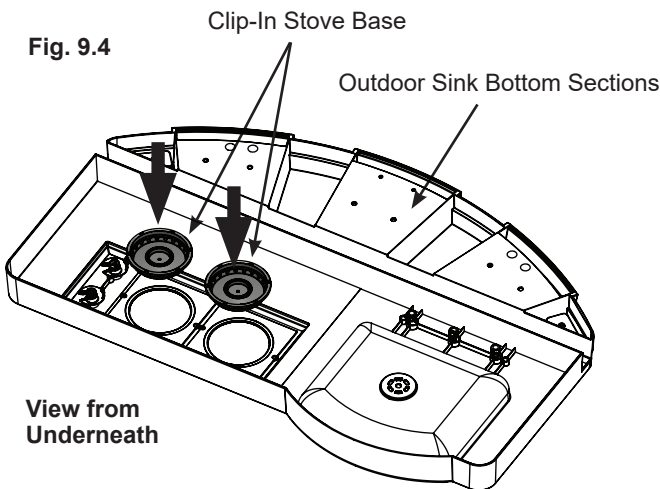
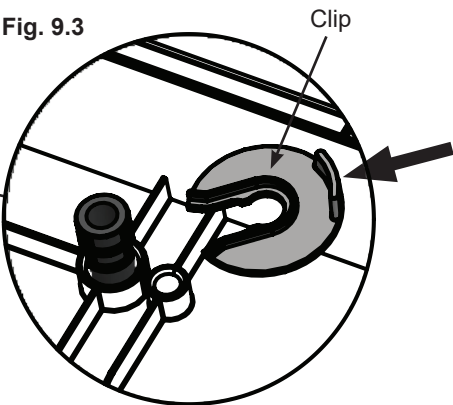
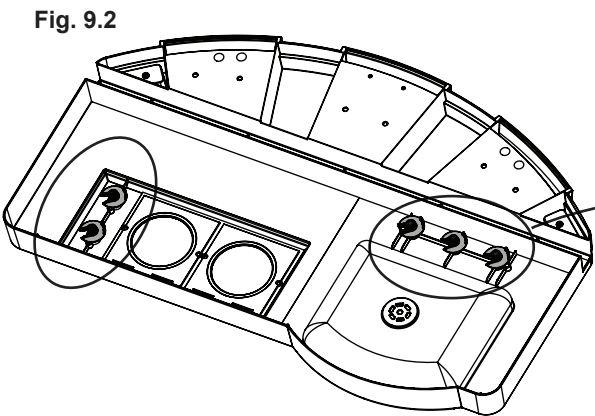
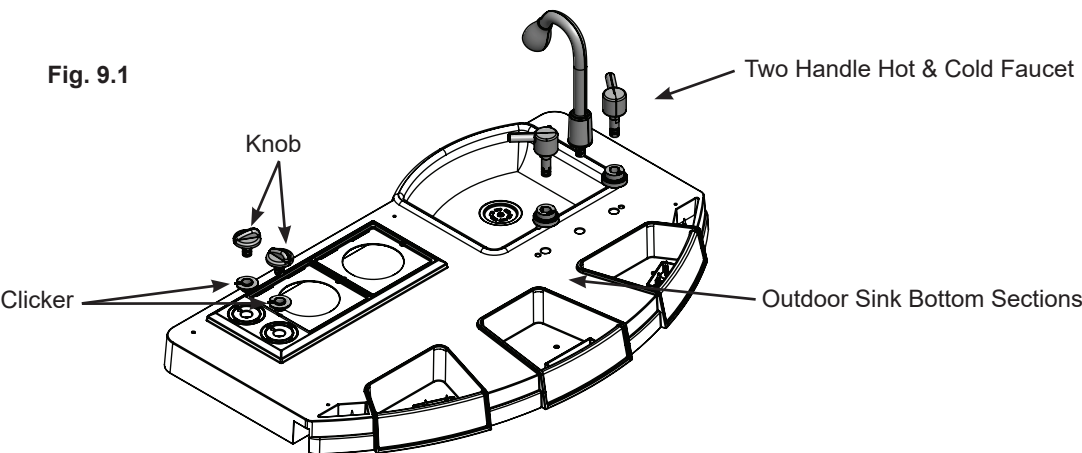
### Hardware

- 12 x S15 #8 x 1-3/4" Wood Screw

# Step 9: Bay Window Assembly

## Part 1

**A:** Place all faucets, knobs, stove bases and burners into place as shown in fig. 9.1, fig. 9.4 and fig. 9.5. From under the Bottom Sections secure each item using a “c” clip. (Fig. 9.2 and Fig. 9.3)



- Other Parts**
- |                                  |                        |
|----------------------------------|------------------------|
| 1 x Outdoor Sink Bottom Sections | 2 x Larger Gas Burner  |
| 2 x Clicker                      | 2 x Clip-In Stove Base |
| 2 x Baby Knob                    |                        |
| 5 x Clip                         |                        |
| 1 x Two Handle Hot & Cold Faucet |                        |

## Step 9: Bay Window Assembly Part 2

**B:** Place Bottom Sections sink assembly into the opening of the left wall window as shown in fig. 9.7 and at the top corners install 2 (S0) #8 x 7/8" Truss Screws to hold the assembly in place.

**C:** In the outside openings of the Outdoor Sink Top Sections place 1 (091) Outside Window Beam making sure that there is a gap measuring greater than 1/2" between the wall and the (091) Outside Window Beam. Install using 1 (S0) #8 x 7/8" Truss Screw per side. **It is important to make sure that board orientation is correct as shown in fig. 9.8.**

**D:** Place (092) Inside Bay Window Beams at the inside locations on the Outdoor Sink Top Sections and attach using 2 (S0) #8 x 7/8" Truss Screws per side. (Fig. 9.8)

Fig. 9.6

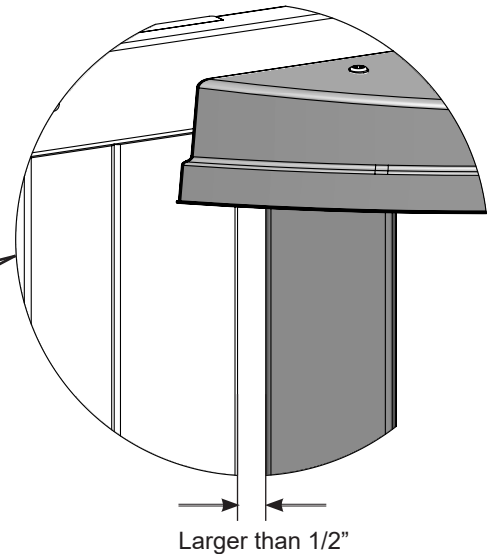
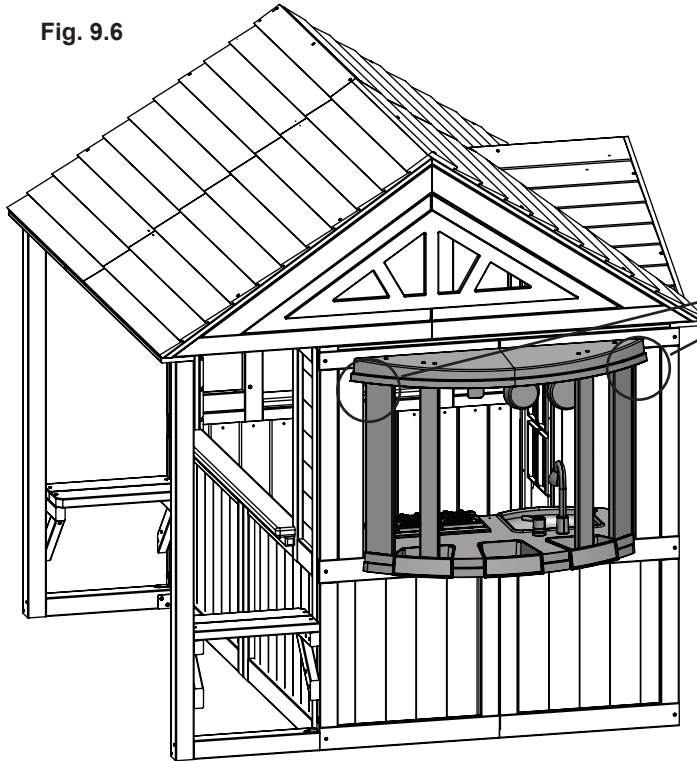


Fig. 9.7  
Outdoor Sink Bottom Sections  
Left Wall

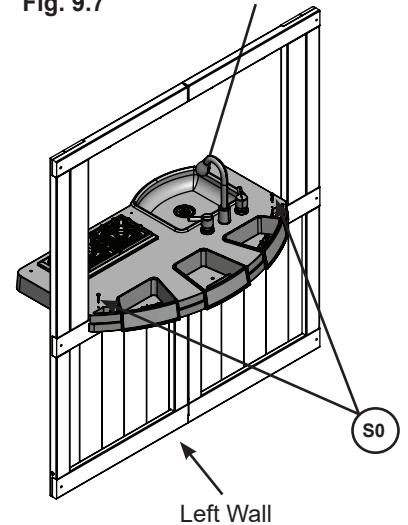


Fig. 9.8

Outdoor Sink Top Sections

Note: Notch facing the outside

Note: Notch facing the outside

**Wood Parts**  
2 x 091 Outside Bay Window Beam 3/4 x 2-1/2 x 21-7/8"  
2 x 092 Inside Bay Window Beams 3/4 x 2 x 21-19/32"

**Hardware**  
8 x S0 #8 x 7/8" Truss Screw

**Other Parts**  
1 x Outdoor Sink Top Sections

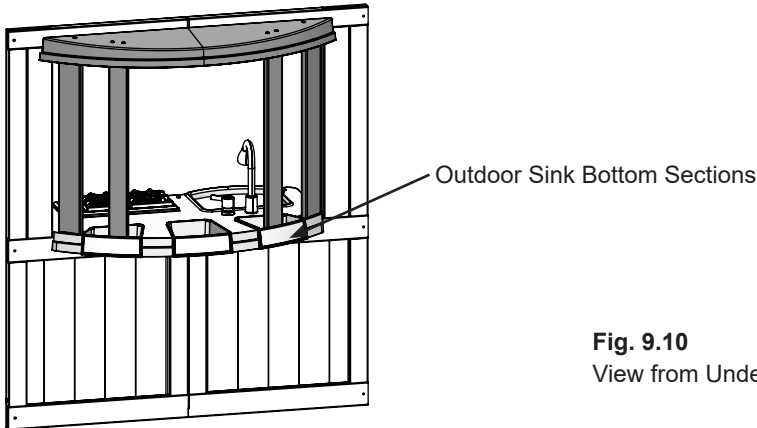
## Step 9: Bay Window Assembly Part 2



**E:** With a helper, insert Outdoor Sink Top Assembly into the Bottom Sections as shown in fig. 9.9 and attach from underneath using 6 (S0) #8 x 7/8" Truss Screws. (Fig. 9.10)

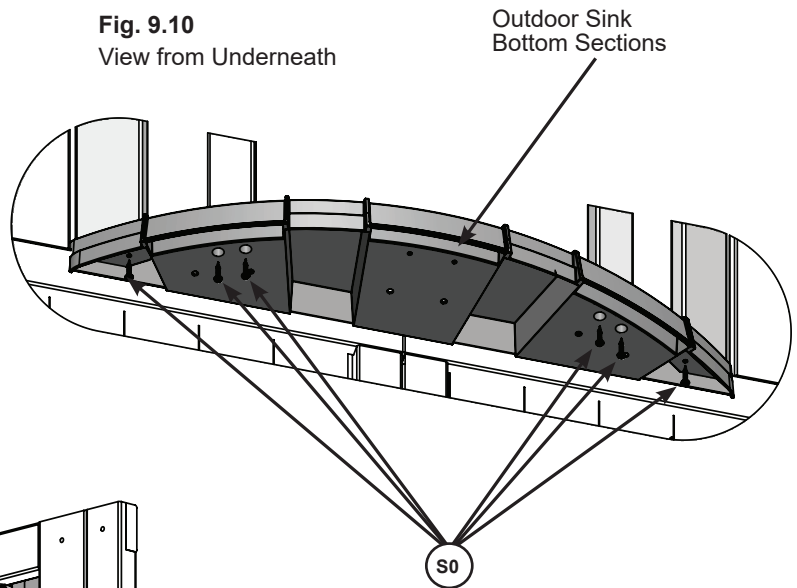
**F:** From inside the assembly install 4 (S0) #8 x 7/8" Truss Screws to secure the top of the assembly to the frame. (Fig. 9.11)

**Fig. 9.9**

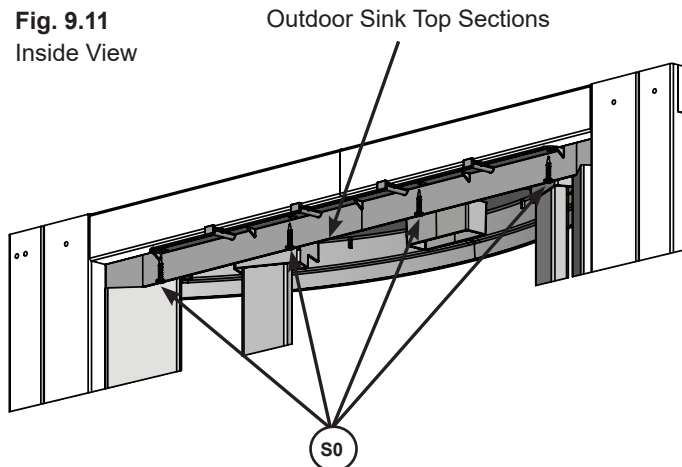


**Fig. 9.10**

View from Underneath



**Fig. 9.11**  
Inside View



### Hardware

10 x (S0) #8 x 7/8" Truss Screw

## Step 9: Bay Window Assembly Part 3



**G:** Making sure to note the hole orientation, install 3 (094) Kitchen Supports to (093) Horizontal Rail using 6 (S1) #8 x 1-1/8" Wood Screws. (Fig. 9.12)

**H:** Place the Horizontal Rail assembly so that the rail is against the side wall and the Kitchen Supports are underneath the Bottom Sections to support it. Make sure that all areas are level and attach the (093) Horizontal Rail to the wall using 6 (S1) #8 x 1-1/8" Wood Screws. (Fig. 9.13)

**I:** Secure the Bottom Sections to the (094) Kitchen Supports using 1 (S0) per board. (Fig. 9.13)

Fig. 9.12

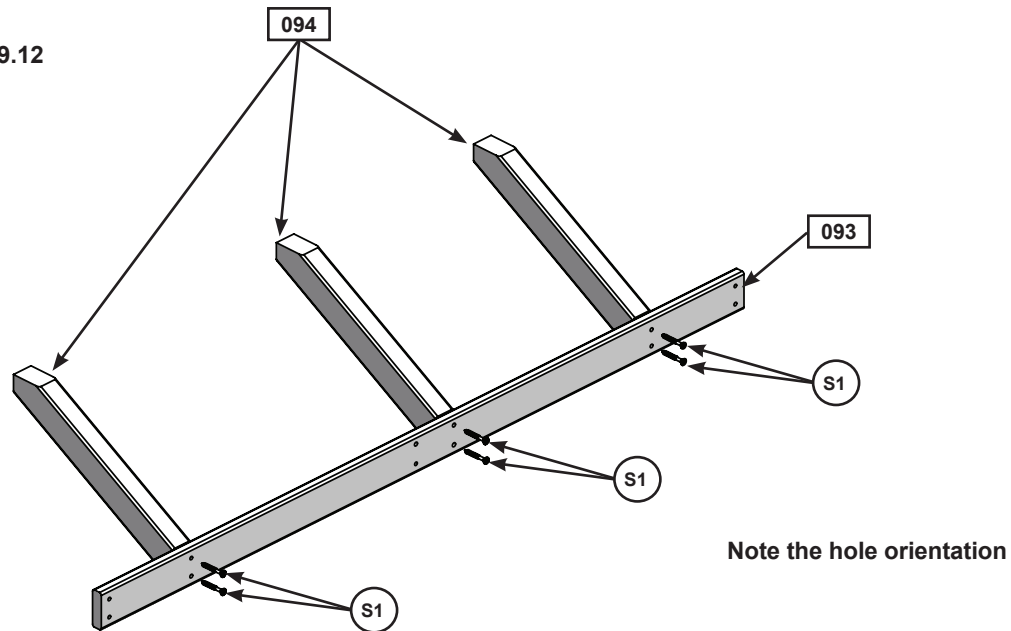
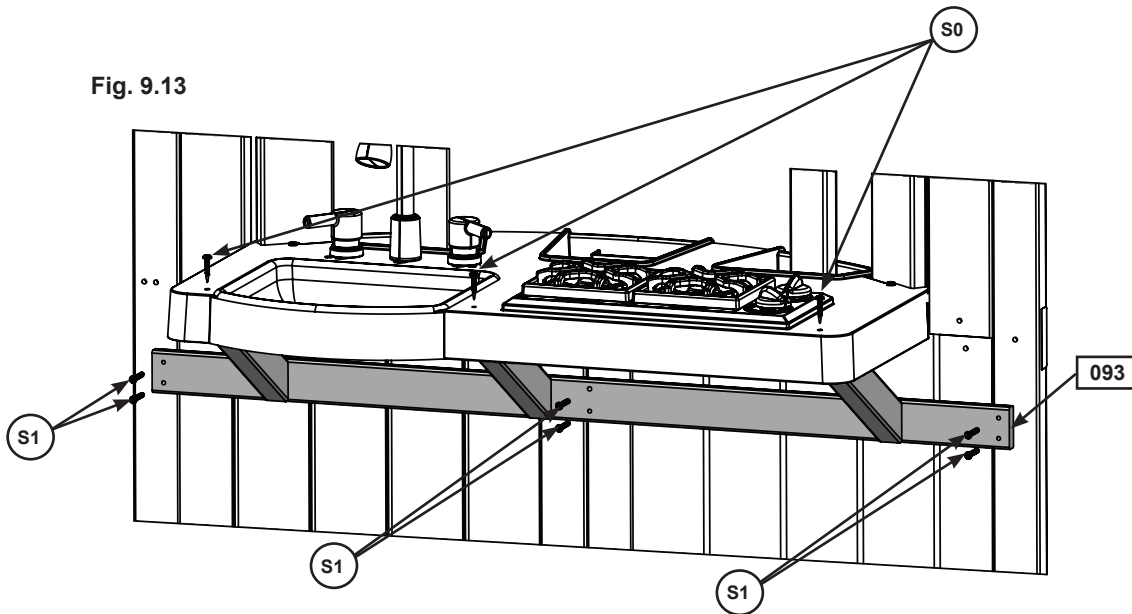


Fig. 9.13



### Wood Parts

- 1 x 093 Horizontal Rail 1/2 x 1-3/4 x 36-3/4"
- 3 x 094 Kitchen Support 1 x 1-1/2 x 11-1/8"

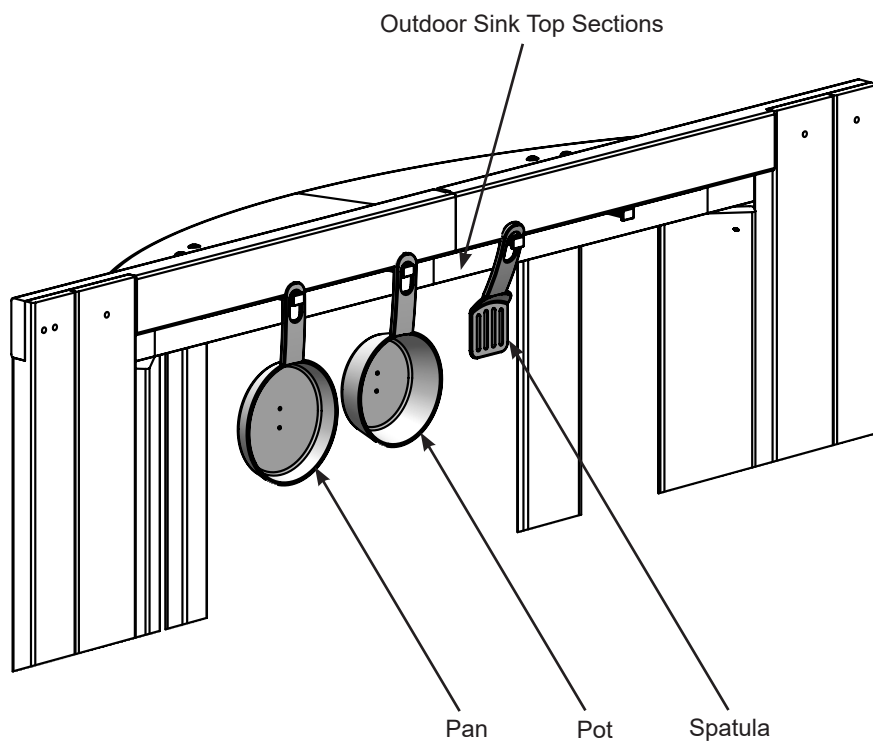
### Hardware

- 3 x S0 #8 x 7/8" Truss Screw
- 12 x S1 #8 x 1-1/8" Wood Screw

## Step 9: Bay Window Assembly Part 4

**J:** From inside the assembly hang Pot, Pan and Spatula from the hooks on the Outdoor Sink Top Sections.  
(Fig. 9.14)

**Fig. 9.14**



### Other Parts

1 x Pan  
1 x Pot  
1 x Spatula

# Step 10: Attach Door Panel Accessories Part 1

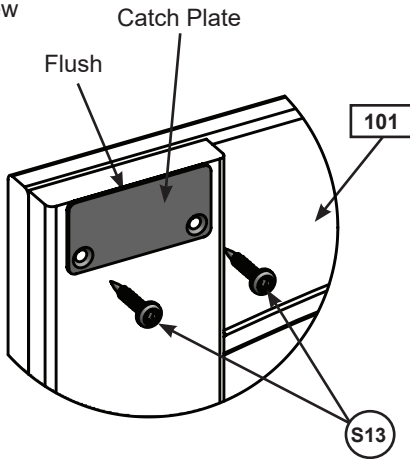


**A:** At the top, inside corner of each (101) Door place one Catch Plate so that it's flush with the top of the (101) Door. Attach each Catch Plate with 2 (S13) #6 x 5/8" Pan Screws. (Fig. 10.1 and 10.2)

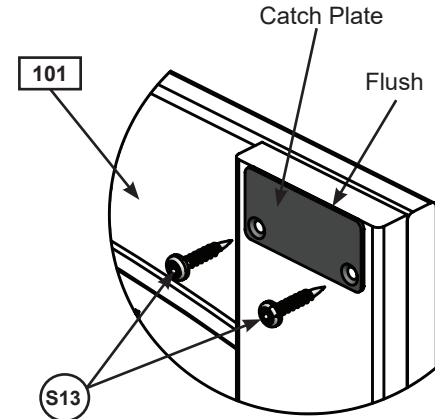
**B:** On the outside bottom edge of each (101) Door measure 1" up from the bottom and install 1 Door Bumper using 1 (S0) #8 x 7/8" Truss Screw. There should be a measurement of 5/8" from the back of (101) Door to the screw hole. (Fig. 10.3, 10.4 and 10.5)

**C:** On the inside edge of both (101) Doors, measure 22-1/4" (56.5cm) up from the bottom and install door handles on both sides using 2 (S13) #6 x 5/8" Pan Screws per handle. (Fig. 10.3 and 10.4)

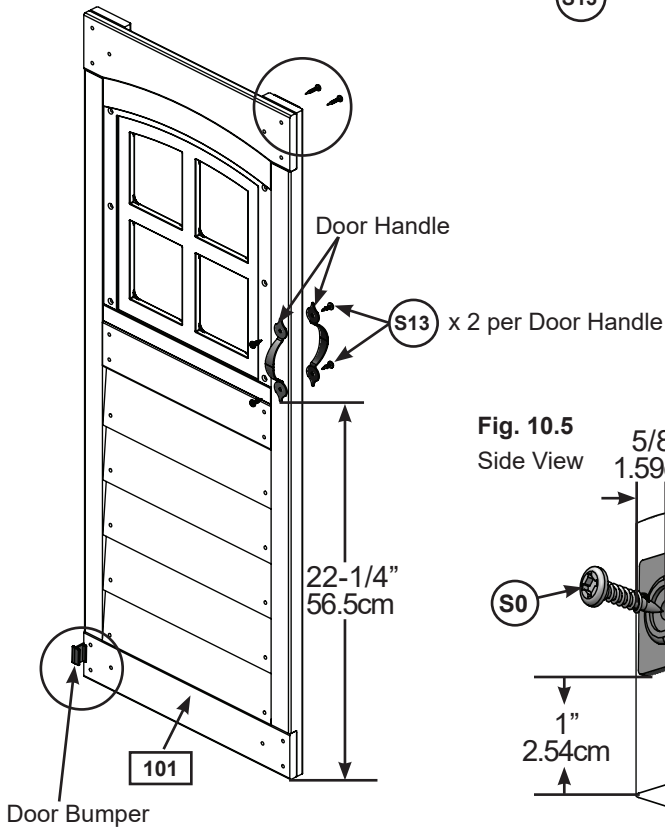
**Fig. 10.1**  
Back View



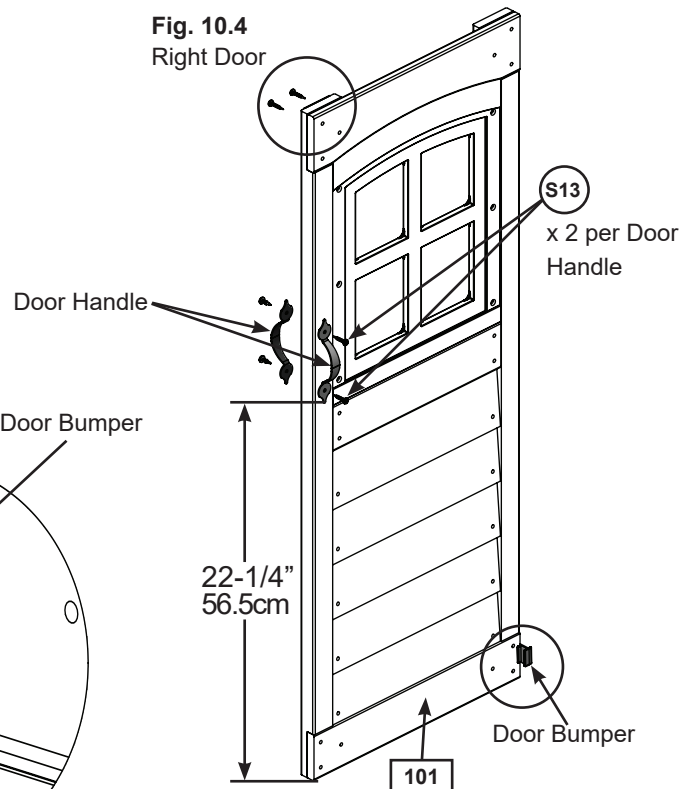
**Fig. 10.2**  
Back View



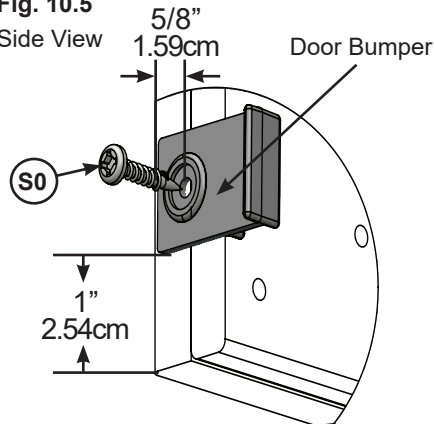
**Fig. 10.3**  
Left Door



**Fig. 10.4**  
Right Door



**Fig. 10.5**  
Side View



## Wood Parts

2 x 101 Door 1 x 15-1/8 x 39-3/4"

## Hardware

2 x S0 #8 x 7/8" Truss Screw  
12 x S13 #6 x 5/8" Pan Screw

## Other Parts

2 x Door Bumper  
4 x Door Handle  
2 x Catch Plate



## Step 10: Attach Door Panel Accessories Part 2



**D:** On each side of the door opening measure 5-1/2" (14cm) down from the top of the opening and install 1 Door Hinge per side using 3 (S13) #6 x 5/8" Pan Screws per hinge as shown in fig. 10.6 and 10.7.

**E:** Measure 5-1/2" up from the bottom of the opening on each side and repeat Step D to install 2 lower Door Hinges. (Fig. 10.7 and 10.8)

Fig. 10.6

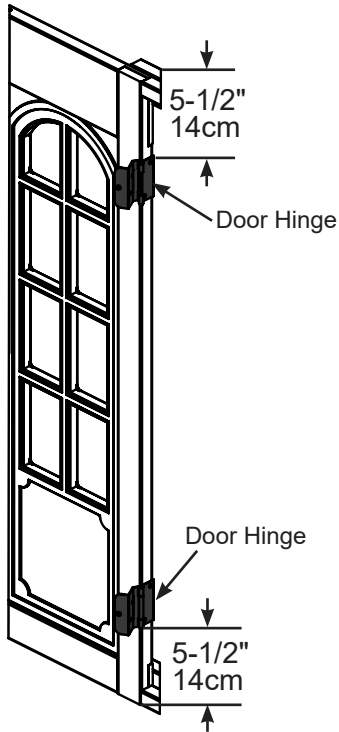


Fig. 10.7

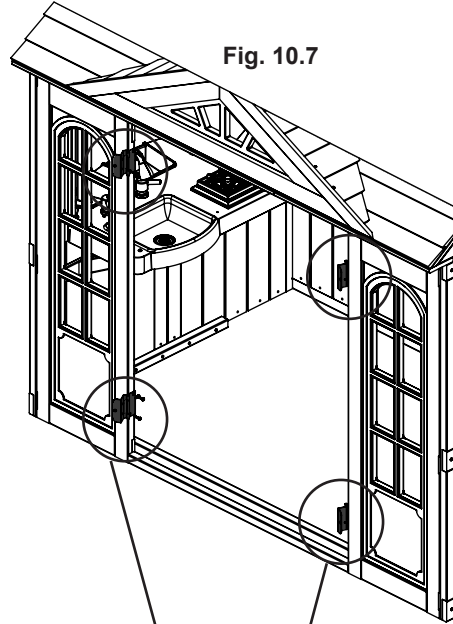
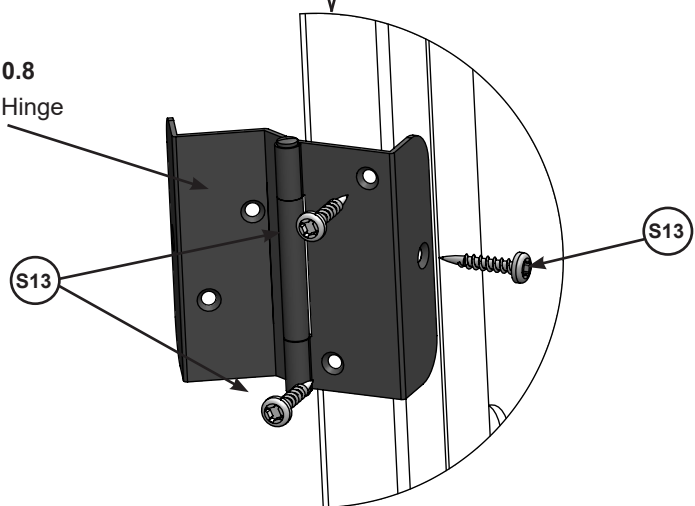


Fig. 10.8  
Door Hinge



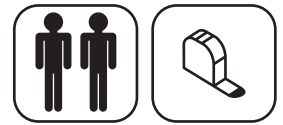
### Hardware

12 x (S13) #6 x 5/8 Pan Screw

### Other Parts

4 x Door Hinge

## Step 10: Attach Door Panel Accessories Part 2



**F:** With a helper, hold each (101) Door in place making sure that there is a 5/8" (1.59cm) gap between the (101) Door bottom and the (025) Bottom Door Stop Panel. Attach to the Door Hinges using 3 (S13) #6 x 5/8" Pan Screws per hinge. (Fig. 10.9, 10.10, 10.11, and 10.12)

Fig. 10.10

Door Hinge

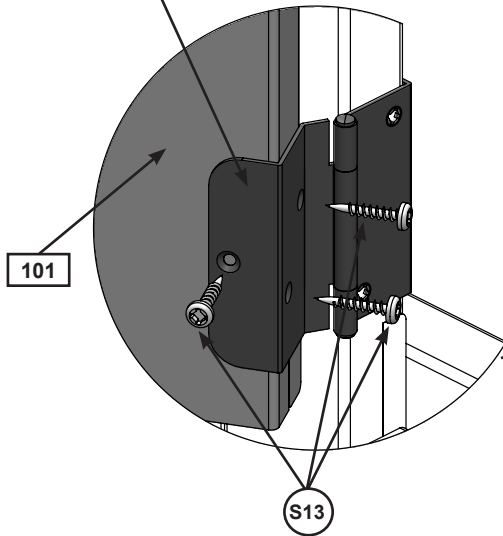


Fig. 10.9

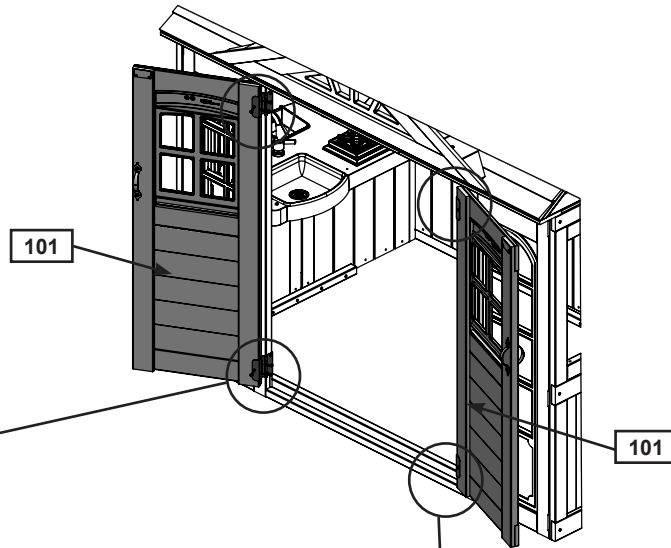


Fig. 10.11

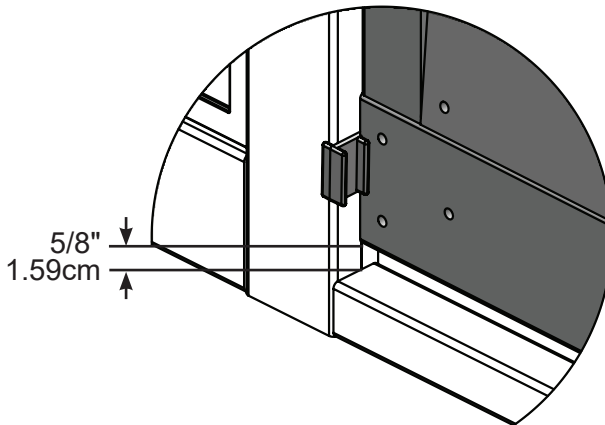
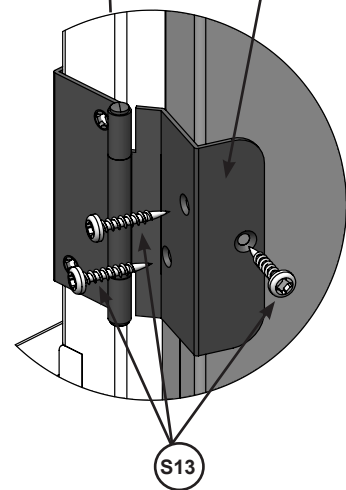


Fig. 10.12

Door Hinge



### Hardware

12 x (S13) #6 x 5/8 Pan Screw

# Step 10: Attach Door Panel Accessories

## Part 3

**G:** In the opening of (026) Top Door Stop Panel, position Door Catches and Catch Plates making sure that the magnets line up with the Catch Plates on the doors. Attach using 2 (S0) #8 x 7/8" Truss Screws per side. (Fig. 10.14 and 10.15)

Fig. 10.13

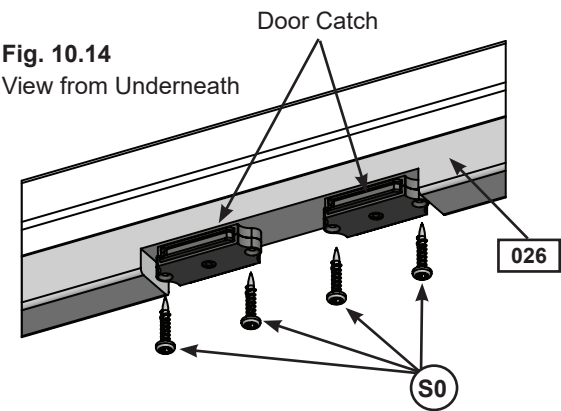
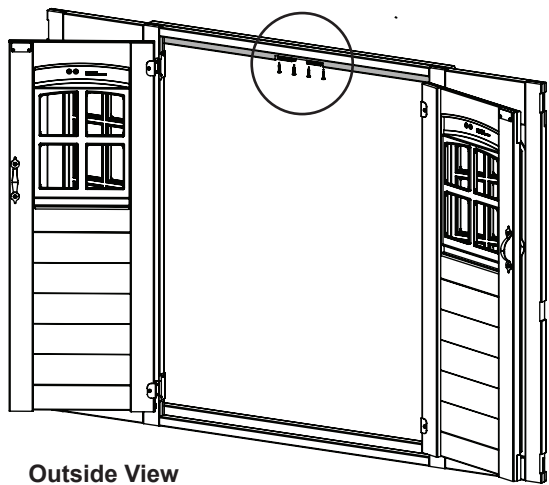
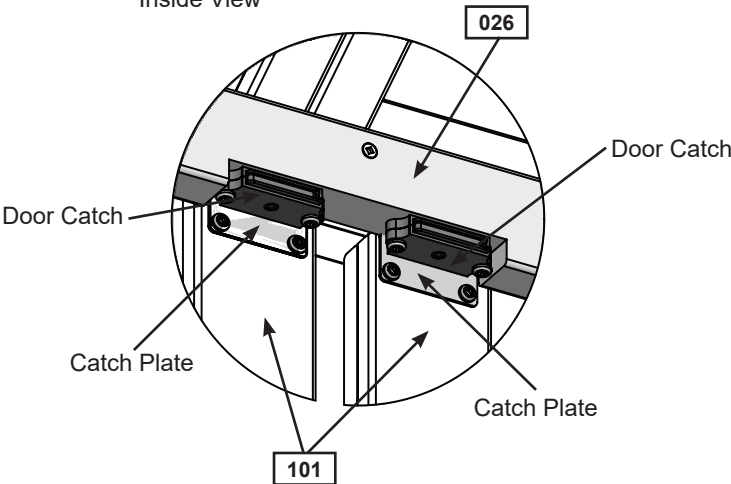


Fig. 10.15  
Inside View



**Hardware**

4 x (S0) #8 x 7/8" Truss Screw

**Other Parts**

2 x Door Catch

# Step 11: Attach Clock Chalk Sign

**A:** Install Clock Chalk Signs in both side openings of the right Side Wall, reversing sides as desired. Attach from the inside using 6 (S0) #8 x 7/8" Truss Screws per side. (Fig. 11.1 and 11.2)

Fig. 11.1

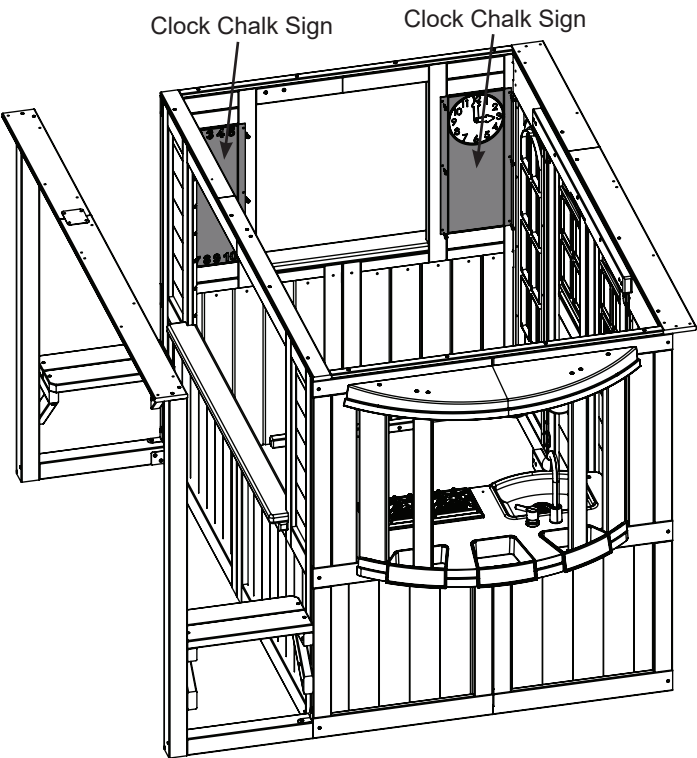
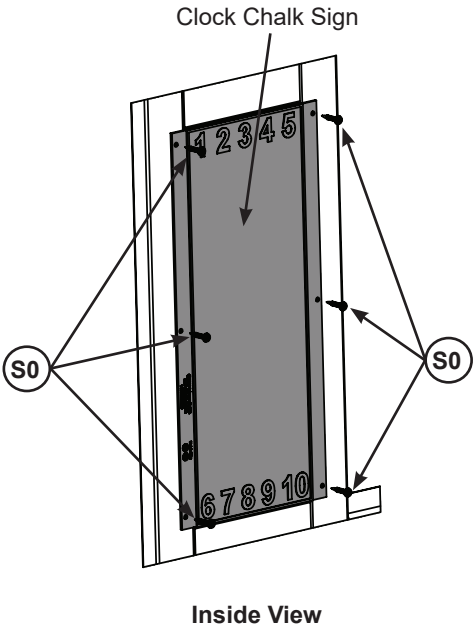


Fig. 11.2



**Hardware**

12 x  #8 x 7/8" Truss Screw

**Other Parts**

2 x Clock Chalk Sign

## Step 12: Weather Vane Assembly Part 1



**A:** Center Plastic Vane Block on the peak of the Roof as shown in fig.12.1. Attach using 2 (S3) #8 x 2 -1/2" Wood Screws. (Fig. 12.2)

Fig. 12.1

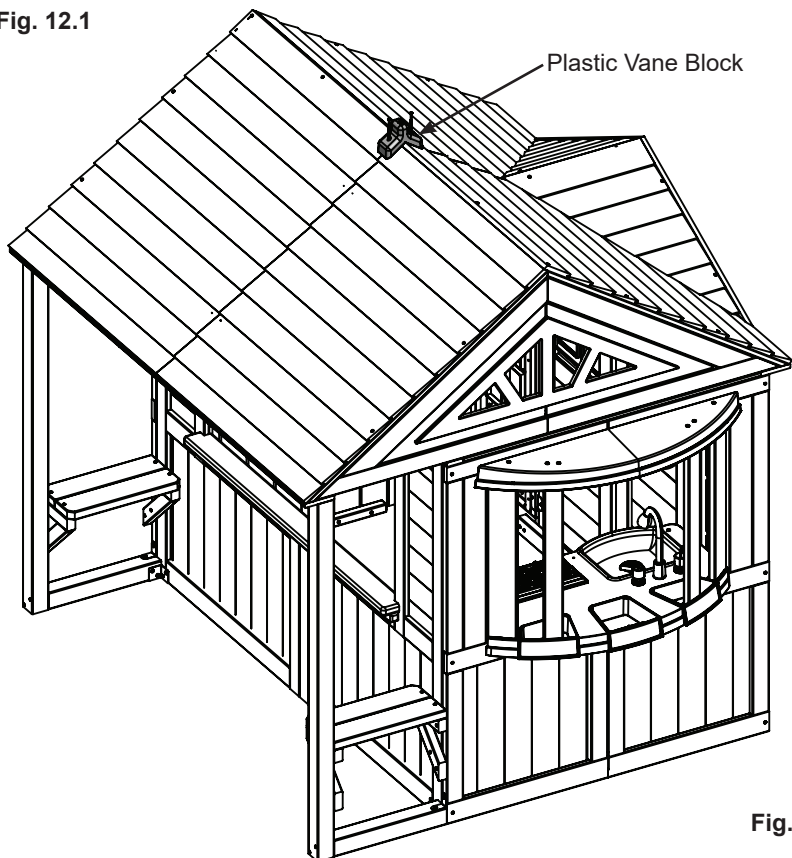
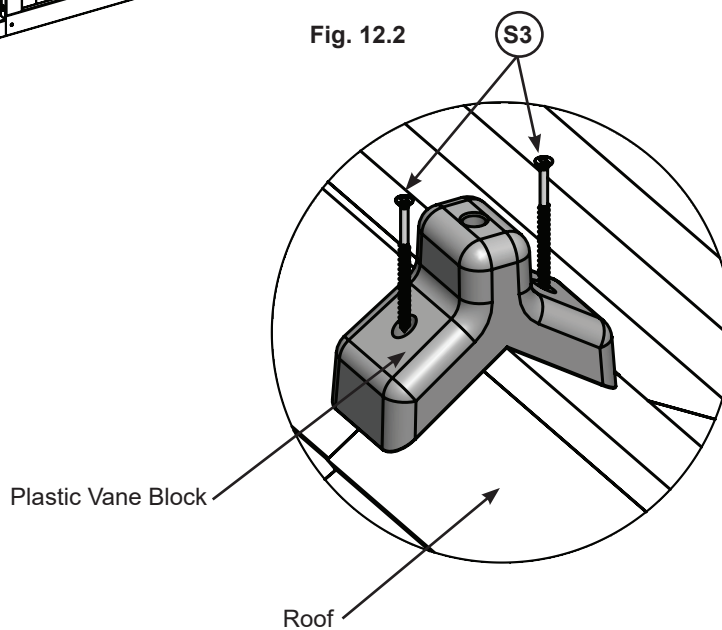


Fig. 12.2



### Hardware

2 x  #8 x 2-1/2" Wood Screw

### Other Parts

1 x Plastic Vane Block

## Step 12: Weather Vane Assembly Part 2



**B:** Assemble Weather Vane as shown in fig.12.4 . Once assembled, insert the Weather Vane into the Plastic Vane Block. (Fig. 12.3 and 12.5)

Fig. 12.3

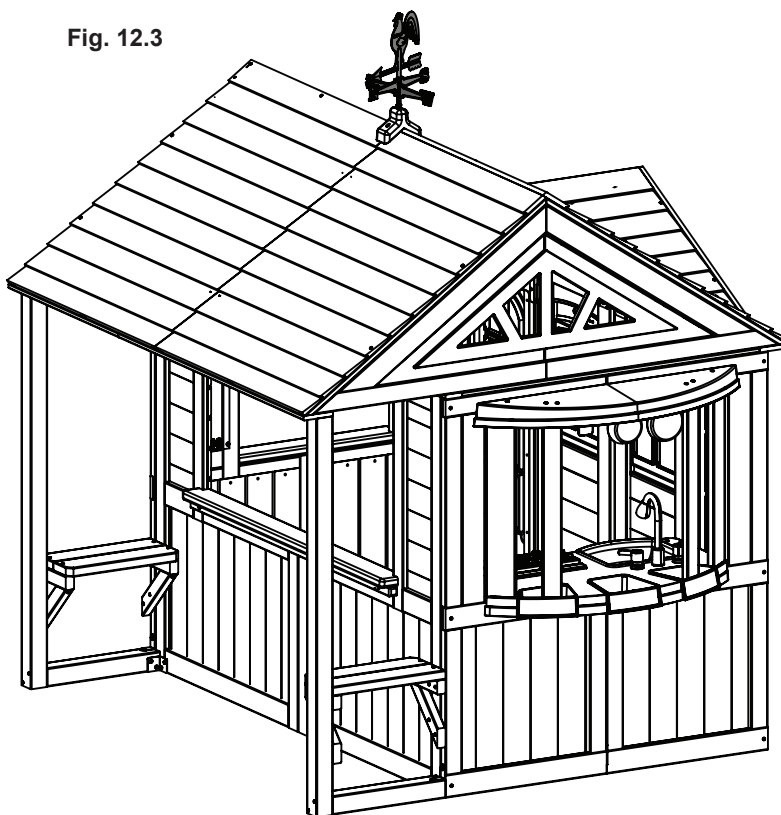


Fig. 12.4

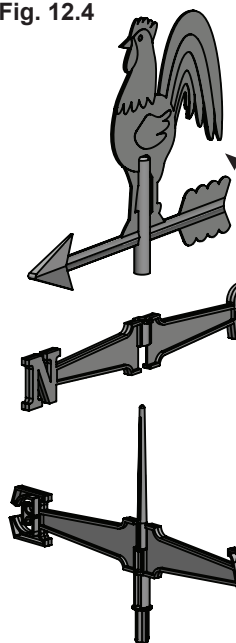
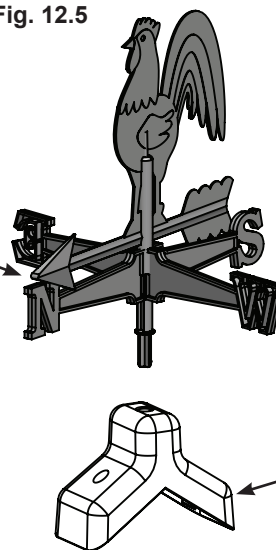


Fig. 12.5

Weather Vane



Plastic Vane Block

### Other Parts

1 x Weather Vane

## Final Step: Attach Playhouse Plaque

**A:** To the right of the door, on the top right hand corner of the narrow window panel install the Playhouse Plaque with 2 (S5) #8 x 1/2" Pan Screws. (Fig. 13.1 and 13.2)

Fig. 13.1

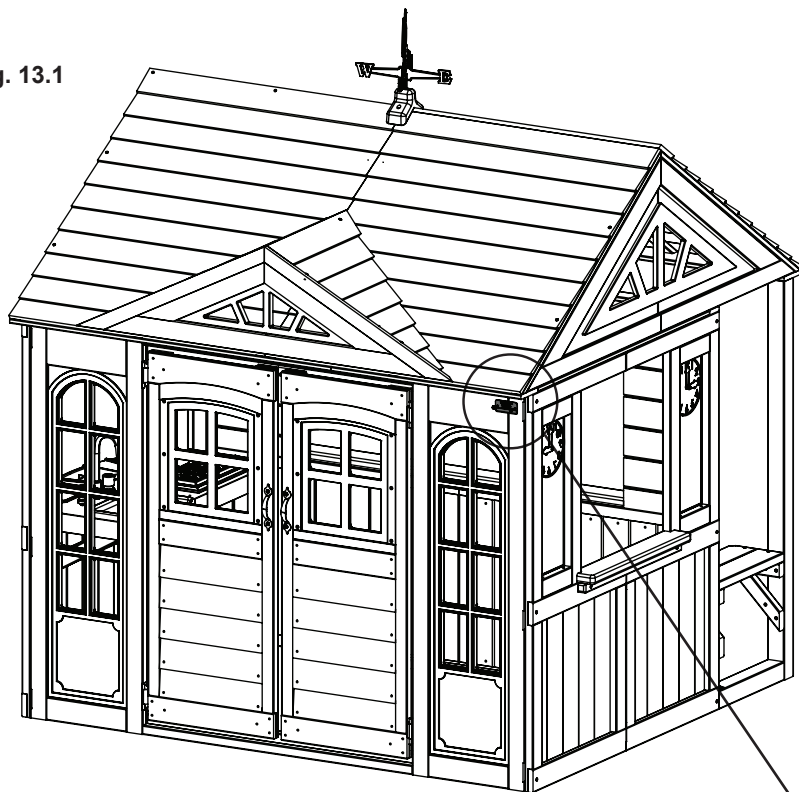
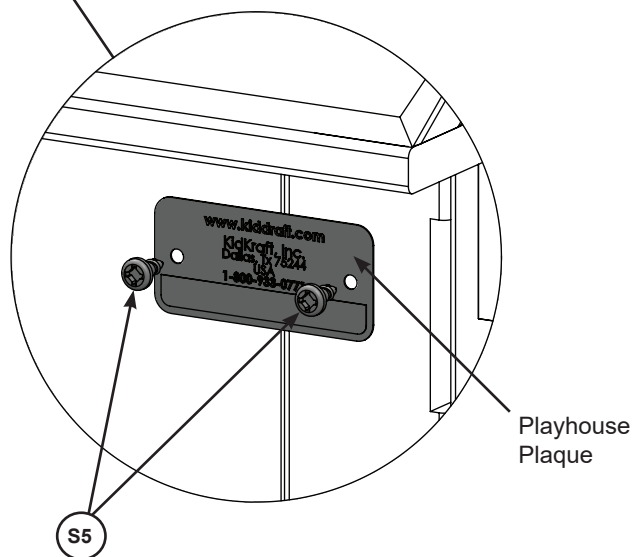


Fig. 13.2



### Hardware

2 x (S5) #8 x 1/2" Pan Screw

### Other Parts

1 x Playhouse Plaque

[illegible]



## 3 EASY WAYS TO REGISTER YOUR PRODUCT 24/7

- 1) Scan this QR Code with your smart phone to complete your product registration directly from your phone:
- 2) Complete the registration online at: [https://www.kidkraft.com/us\\_en/warranty/](https://www.kidkraft.com/us_en/warranty/)
- 3) Mail this completed form to: KidKraft Inc., 4630 Olin Road, Dallas, Tx 75244 USA  
Make sure to include a copy of your proof of purchase



# KIDKRAFT

## Consumer Registration Card

First Name

Initial

Last Name

Street

Apt. No.

City

State/Province ZIP/Postal Code

--	--	--	--

Country

Telephone Number

A horizontal number line with tick marks at every integer from 0 to 20. The line is divided into 20 equal segments by vertical tick marks.

E-Mail Address

Model Number

Model Name

Model Number & Name example  
F24145 AINSLEY PLAY SYSTEM

Purchased From

Date Purchase

MM / DD / YY

Serial Number (on ID Plaque)

[illegible]

## ID Plaque example

Box #: \_\_\_\_\_ 1 of \_\_\_\_\_

Box #: \_\_\_\_\_ 4 of \_\_\_\_\_

Box # (Ex: B29410 1of 6)

Box #: \_\_\_\_\_ 2 of \_\_\_\_\_

Box #: \_\_\_\_\_ 5 of \_\_\_\_\_

Box #: \_\_\_\_\_ 3 of \_\_\_\_\_

Box #: \_\_\_\_\_ 6 of \_\_\_\_\_

1 OF 6

ITEM #  
ARTICLE N°  
N.º DE ARTÍCULO  
**B29410**

For common questions or for information on ordering replacement parts:



Help Center: <https://kidkraft.zendesk.com/hc/en-us/>