



Manufactured by:
Backyard Discovery
3305 Airport Drive, Pittsburg, KS 66762
800-856-4445

Basepoint Business Centre: Rivermead Drive, Westlea, Swindon SN5 7EX Phone: 0800-118-2476 J.P. Coenstraat 7, The Bridge, The Hague, 2595 WP, Netherlands Phone: 08005678990

LANGSTON KITCHEN GUTTER KITS

MODEL #: 9260016, 9260023, 9260030



Please visit www.backyarddiscovery.com
For the most up to date assembly manual, to register your product, or to order
replacement parts Para obtener instrucciones en español, visite
www.backyarddiscovery.com

OWNER'S MANUAL - PARTS IDENTIFICATION

Hardware Components



**H101414 SCREW SELF PIERCING #8x1/2
(x10)**

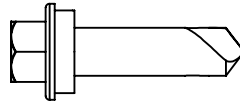

**H101480 SCREW SELF TAPPING #9x1 BLK
(x20) 1/4 x 1**

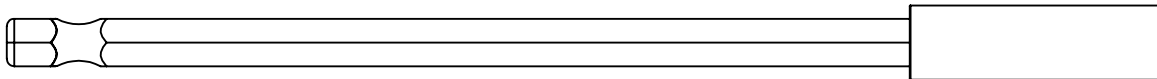

**H101278 6" MAGNETIC DRIVER EXTENSION
(x1)**



**A6P01531 10 OZ SILICONE TUBE
(x1)**

OWNER'S MANUAL - PARTS IDENTIFICATION

Accessory Components (NOT TO SCALE)

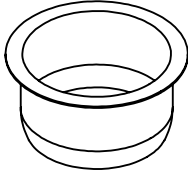

A4M04761 DOWNSPOUT OUTLET
(x2) 1 7/16"x2 7/8" [37x73]

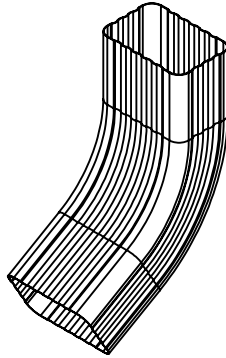

A4M04931 DOWNSPOUT ELBOW
(x2) 3"x5 7/16"x7 11/16" [76x138x195]

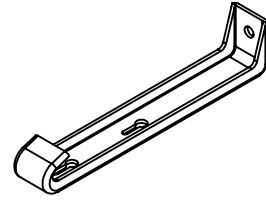

A4M04759 GUTTER HANGER
(x12) 3/4"x1"x4 15/16" [19x25x125]

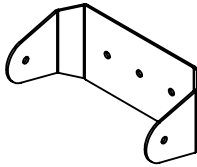

A4M04782 DOWNSPOUT CLIP
(x4) 1 7/16"x1 7/16"x3 1/8" [37x37x79]

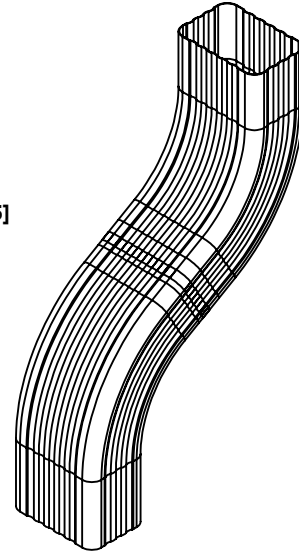

A4M06693 DOWNSPOUT OFFSET - 6"
(x2) 3"x8"x12 1/8" [76x203x308]

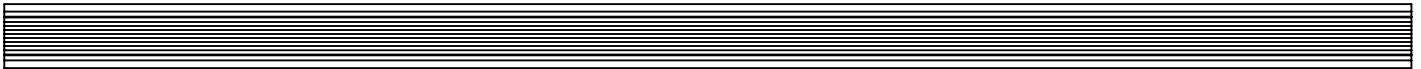

A4M06685 DOWNSPOUT - 66"
(x2) 2"x3"x66" [51x76x1675]



A4M06832 GUTTER W/ OUTLET
(x1) 3 11/16"x5 1/8"x126 3/16" [93x130x3205]

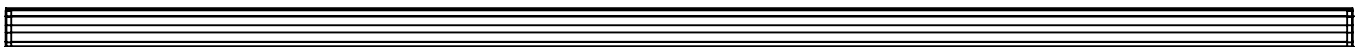

A4M06833 GUTTER W/ OUTLET
(x1) 3 11/16"x5 1/8"x126 3/16" [93x130x3205]

OFFSET ORIENTATION

TO ENSURE WATER FLOWS PROPERLY, IT IS IMPORTANT TO ORIENT DOWNSPOUT PIPING CORRECTLY. STARTING AT THE TOP, DOWNSPOUTS MUST FEED INTO THE NEXT SECTION AS SHOWN.

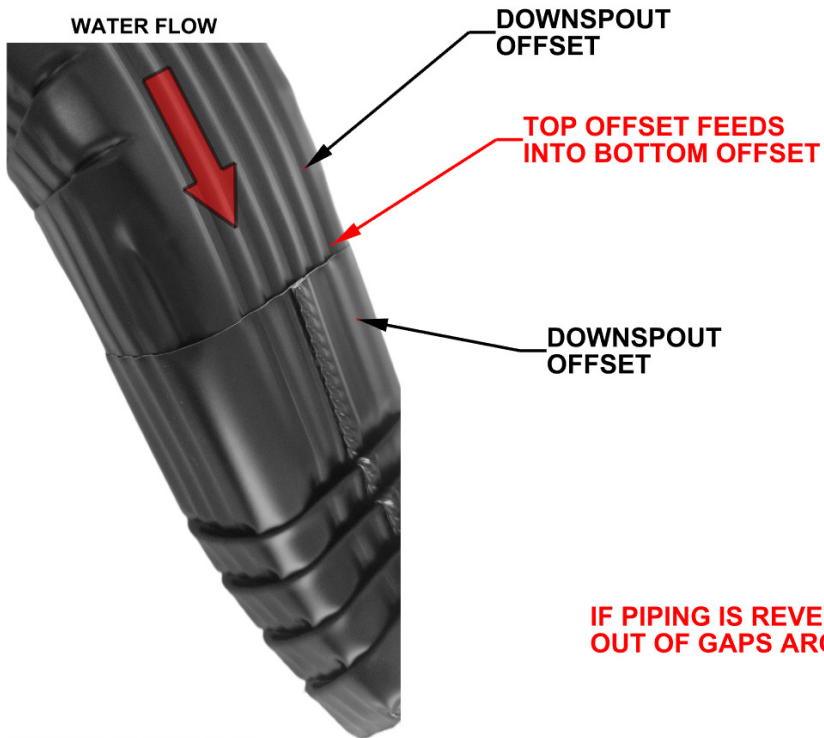

IF PIPING IS REVERSED, WATER WILL RUN OUT OF GAPS AROUND JOINTS

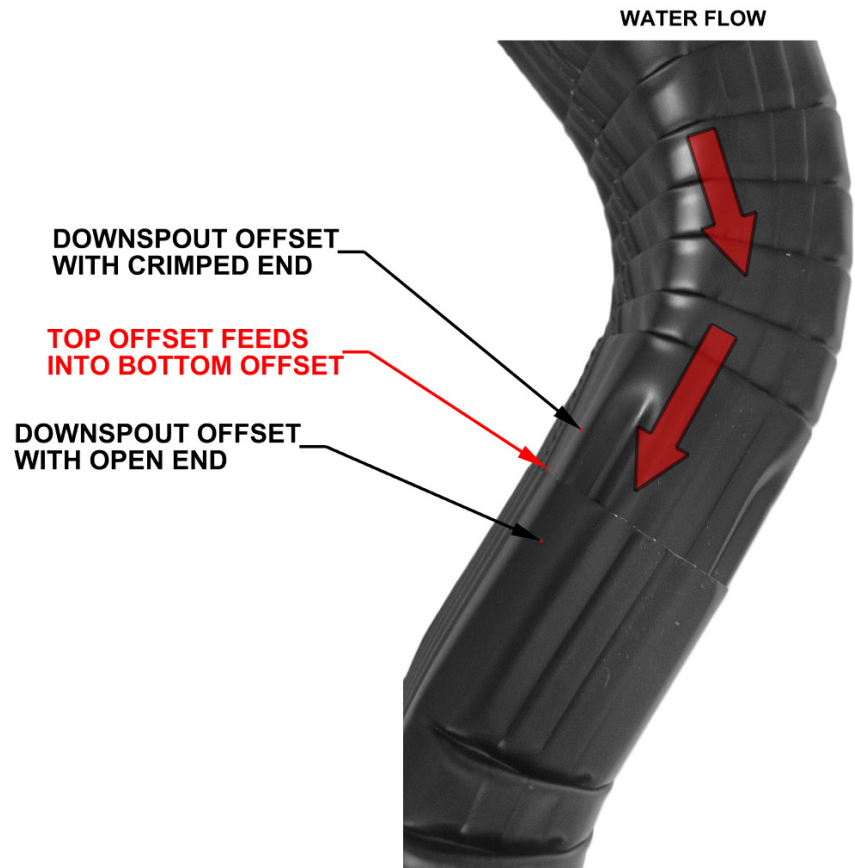

STEP 1 - GUTTER ASSEMBLY

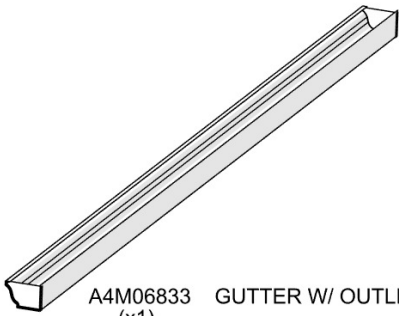

A4M06833 GUTTER W/ OUTLET
(x1)

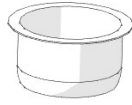

A4M04761 DOWNSPOUT OUTLET
(x2)

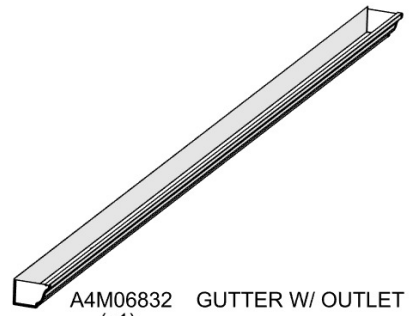

A4M06832 GUTTER W/ OUTLET
(x1)

- APPLY A BEAD OF SILICONE AROUND THE BOTTOM LIP OF THE DOWNSPOUT OUTLET AND PLACE OUTLET INSIDE GUTTER AS SHOWN.

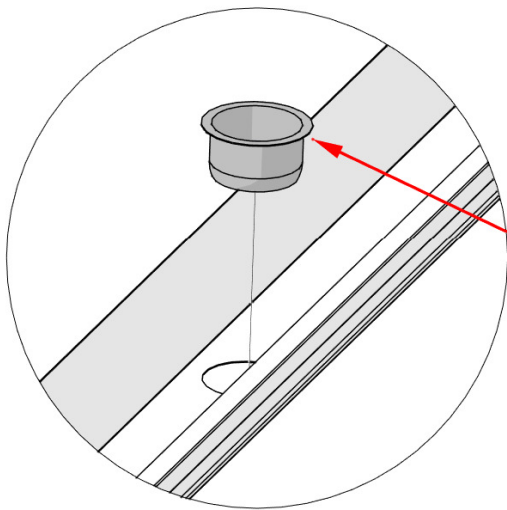

APPLY SILICONE

6833 (x1)
GUTTER W/ OUTLET

6832 (x1)
GUTTER W/ OUTLET

TIP: USING A WET FINGER, APPLY GENTLE PRESSURE AND FLATTEN SILICONE BEAD INSIDE GUTTER.

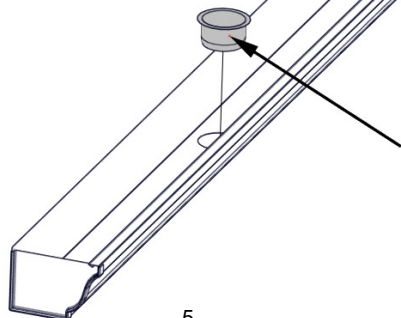
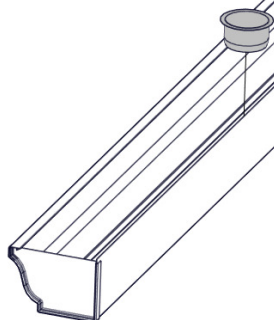

4761 (x2)
DOWNSPOUT OUTLET

STEP 2 - GUTTER ASSEMBLY

QTY	PART NUMBER	DESCRIPTION
2	H101480	SCREW SELF PIERCING #9x1 BLK

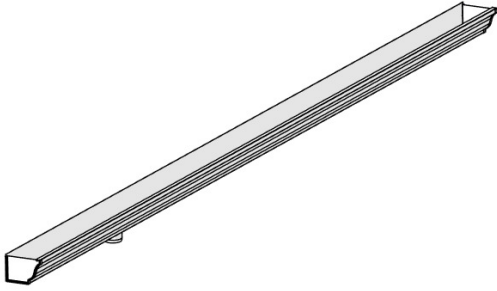

A4M06832 GUTTER ASSEMBLY - STEP 1
(x1)

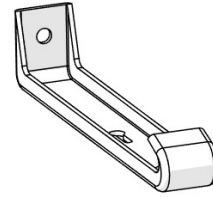

A4M04759 GUTTER HANGER
(x2)

- SLIDE GUTTER ASSEMBLY UP UNDER DRIP EDGE AND TO ROOF LINE.
- CENTER GUTTER AND ENSURE THE DOWNSPOUT IS CENTERED ON THE POST.
- USE A CLAMP TO HOLD THE GUTTER TO THE METAL BEAM FOR ASSISTANCE.
- INSTALL THE OUTSIDE HANGERS APPROXIMATELY 4" [100mm] FROM THE INSIDE OF THE GUTTER.
- PRE-DRILL 1/8" [3mm] PILOT HOLE FOR EASE OF ASSEMBLY.

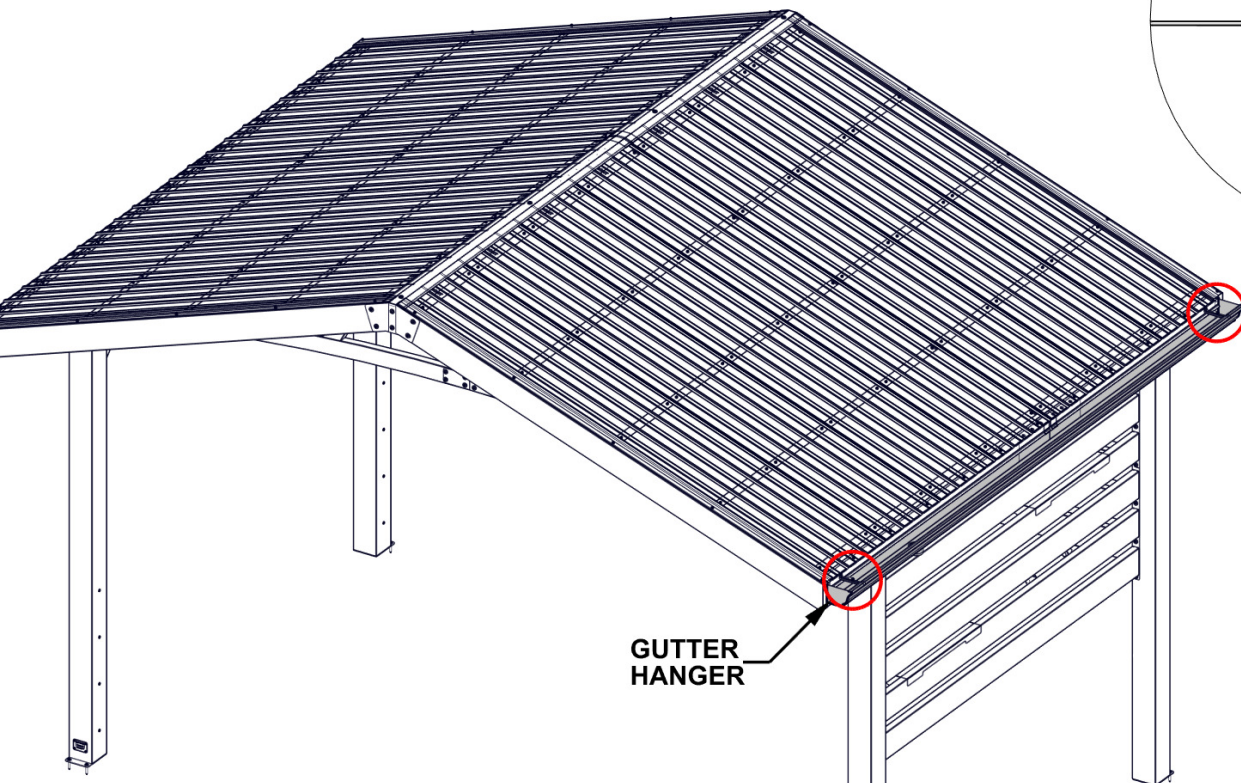
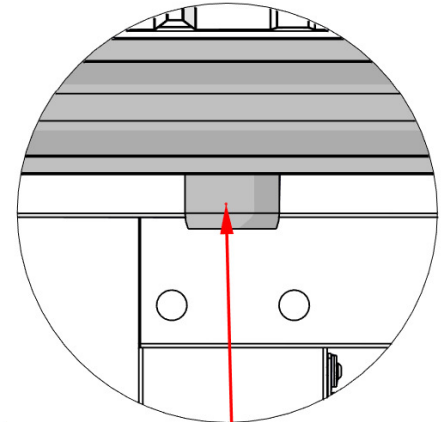
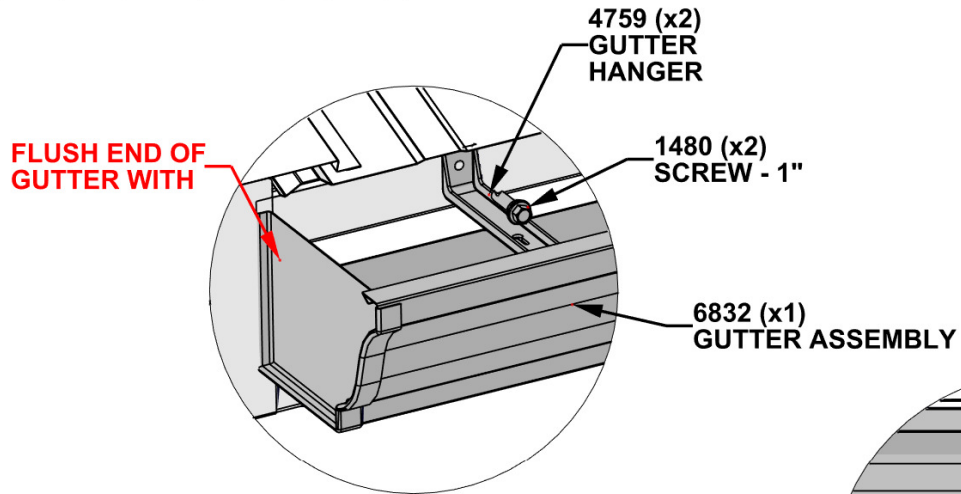

STEP 3 - GUTTER ASSEMBLY



A4M06833 GUTTER ASSEMBLY - STEP 1 (x1)

QTY	PART NUMBER	DESCRIPTION
2	H101480	SCREW SELF PIERCING #9x1 BLK

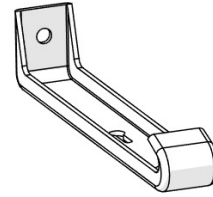

A4M04759 GUTTER HANGER (x2)

- SLIDE GUTTER ASSEMBLY UP UNDER DRIP EDGE AND TO ROOF LINE.
- CENTER GUTTER AND ENSURE THE DOWNSPOUT IS CENTERED ON THE POST.
- USE A CLAMP TO HOLD THE GUTTER TO THE METAL BEAM FOR ASSISTANCE.
- INSTALL THE OUTSIDE HANGERS APPROXIMATELY 4" [100mm] FROM THE INSIDE OF THE GUTTER.
- PRE-DRILL 1/8" [3mm] PILOT HOLE FOR EASE OF ASSEMBLY.

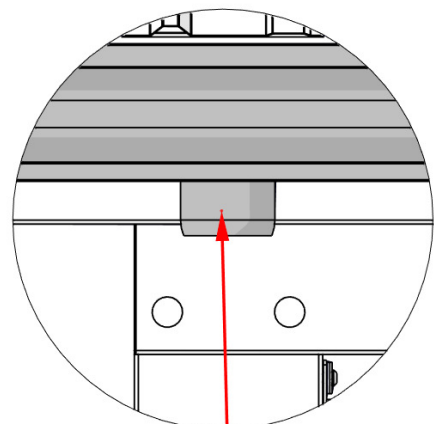
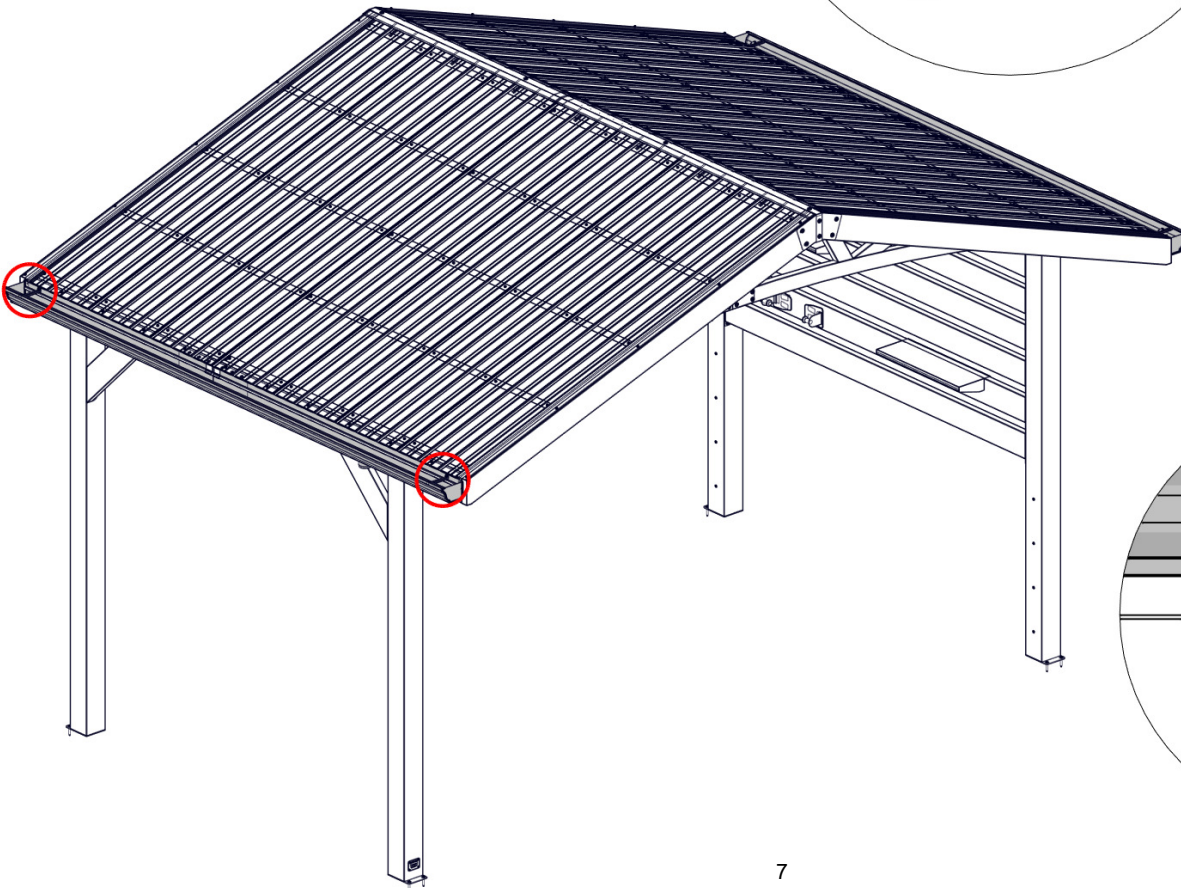
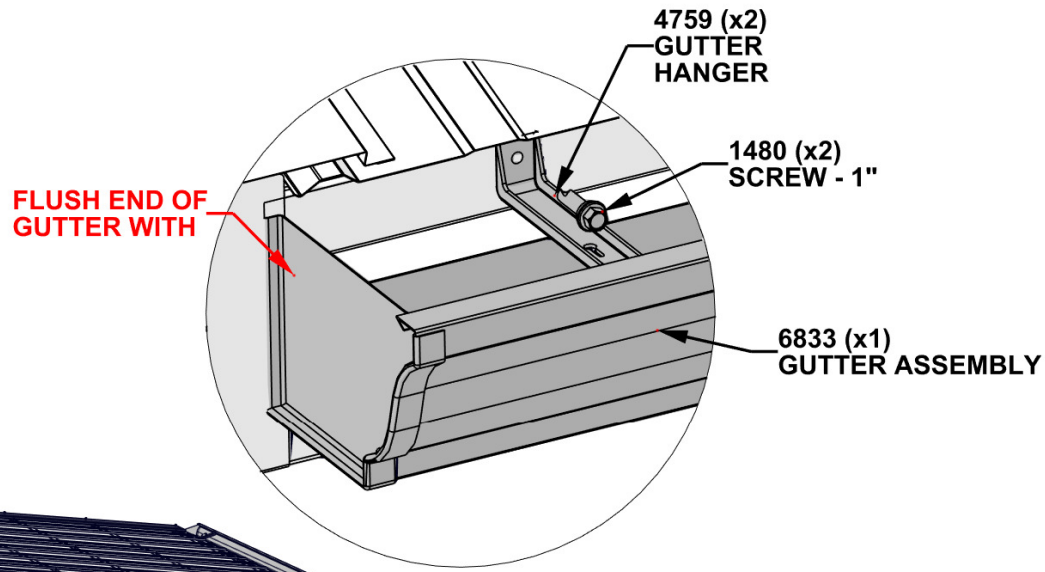

DOWNSPOUT
OUTLET
CENTERED ON
POST

STEP 4 - GUTTER ASSEMBLY

QTY	PART NUMBER	DESCRIPTION
8	H101480	SCREW SELF TAPPING #9x1 BLK

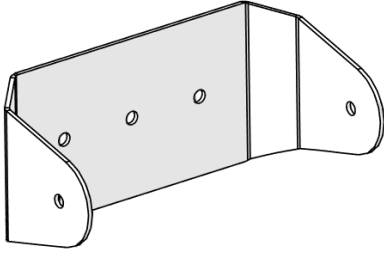

A4M04782 DOWNSPOUT CLIP
(x4)

- IT IS IMPORTANT TO CENTER 4782 DOWNSPOUT CLIPS ON CENTER OF POST.
- ATTACH A4M04785 CLIP APPROXIMATELY 10-3/4" [275mm] AND 75-3/4" [1925mm] OFF THE GROUND.
- COMPLETE ON BOTH FRONT POSTS.

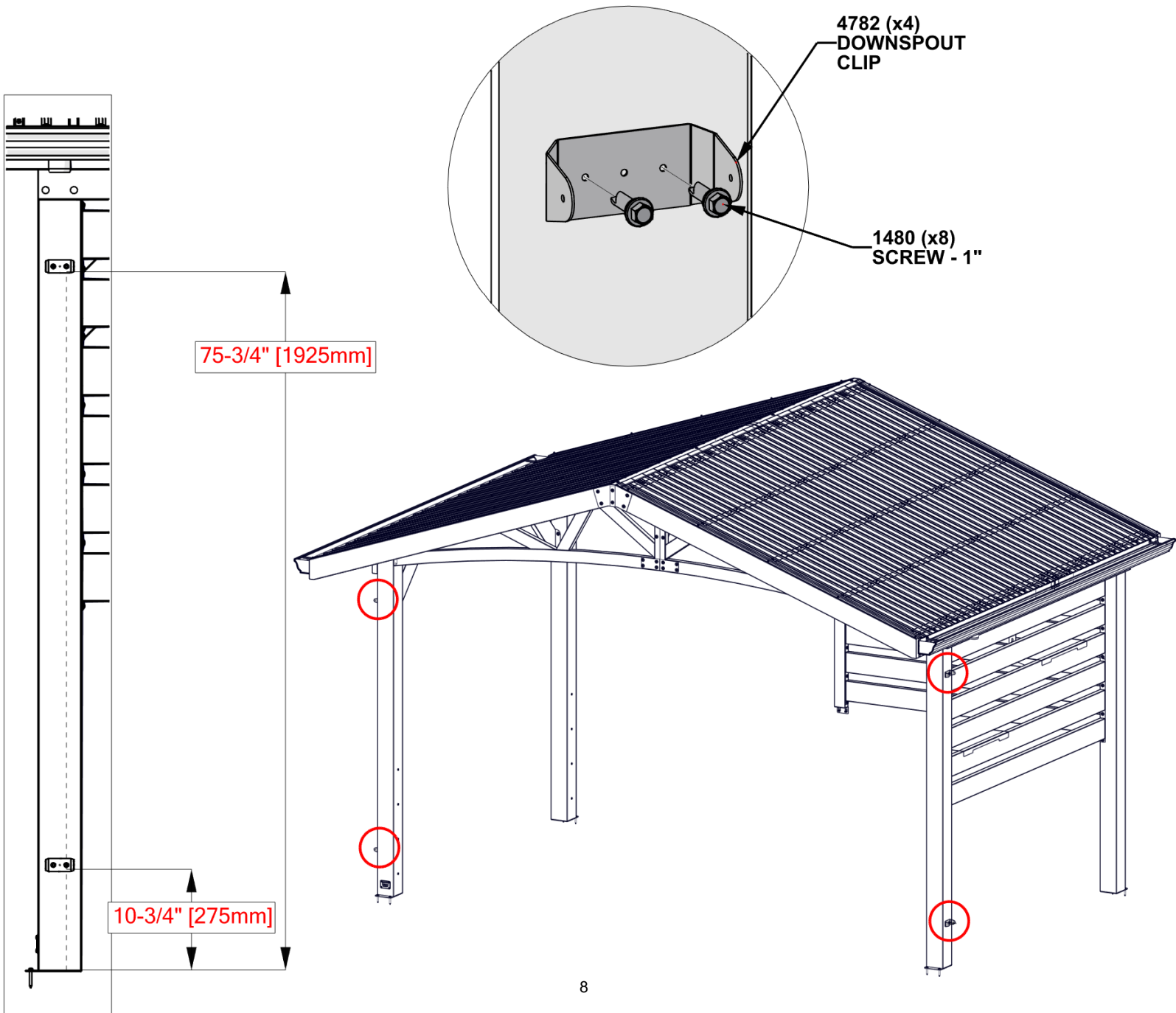

STEP 5 - GUTTER ASSEMBLY

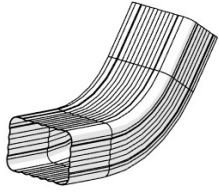

A4M04931 DOWNSPOUT ELBOW
(x2)



A4M06685 DOWNSPOUT - 66"
(x2)

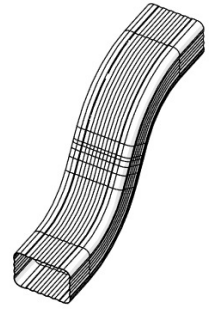

A4M06693 DOWNSPOUT OFFSET - 6"
(x2)

- INSERT TAPERED ENDS INTO LARGER ENDS AS SHOWN.
- NOTE ORIENTATION OF DOWNSPOUT OFFSET. SEE DOWNSPOUT OFFSET PAGE FOR DETAIL.
- COMPLETE THIS STEP TWICE.

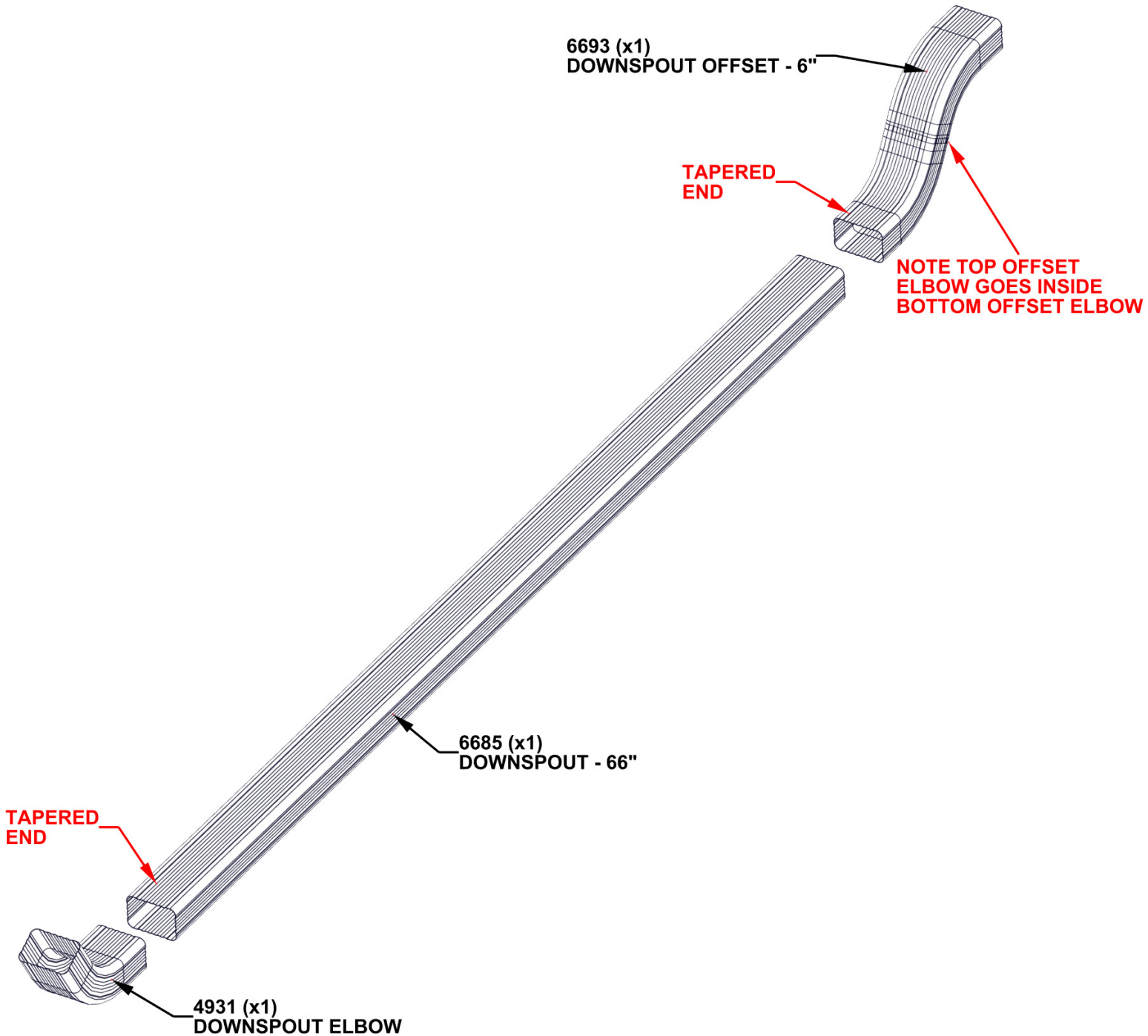

STEP 6 - GUTTER ASSEMBLY

QTY	PART NUMBER	DESCRIPTION
2	H101414	SCREW SELF PIERCING #8x1/2 BLK



DOWNSPOUT ASSEMBLY - STEP 5
(x2)

- SLIDE DOWNSPOUT ASSEMBLY OVER GUTTER OUTLET AND ATTACH WITH HARDWARE PROVIDED.
- NOTE GUTTER WILL NOT EXTEND TO GROUND, THERE WILL BE FLOATING SPACE.
- COMPLETE AT BOTH DOWNSPOUT LOCATIONS ON FRONT POST.

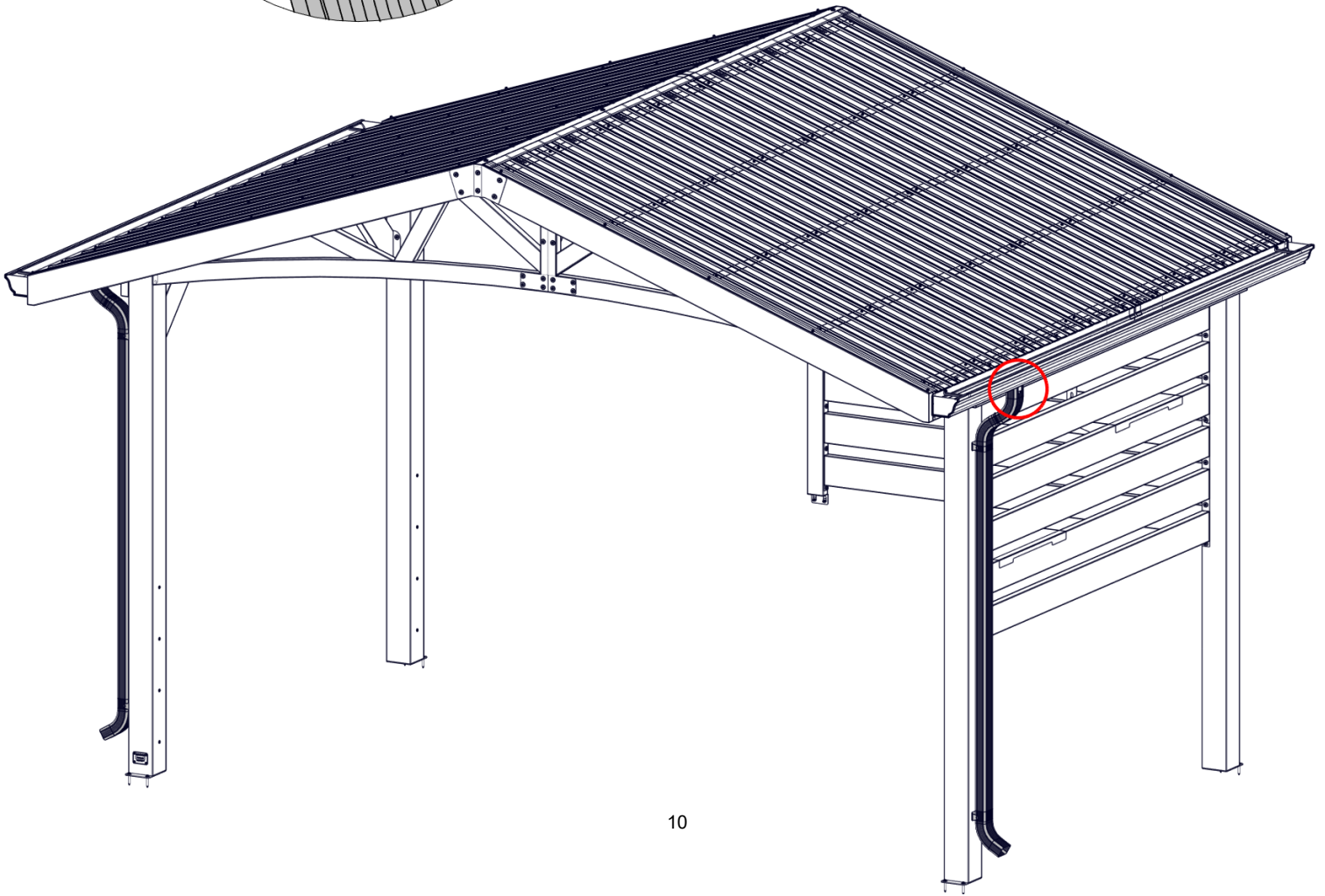
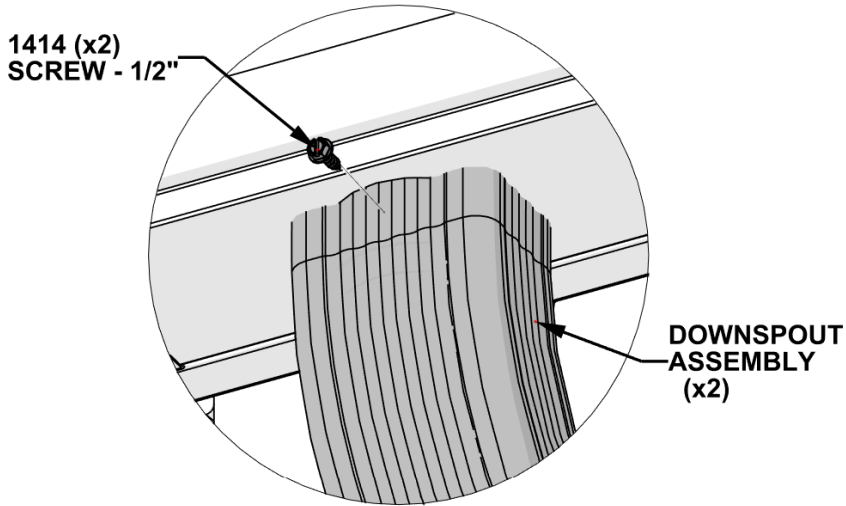

STEP 7 - GUTTER ASSEMBLY

QTY	PART NUMBER	DESCRIPTION
8	H101414	SCREW SELF PIERCING #8x1/2 BLK

- FASTEN DOWNSPOUT CLIP TO DOWNSPOUT USING HARDWARE PROVIDED.
- COMPLETE AT BOTH FRONT DOWNSPOUTS.

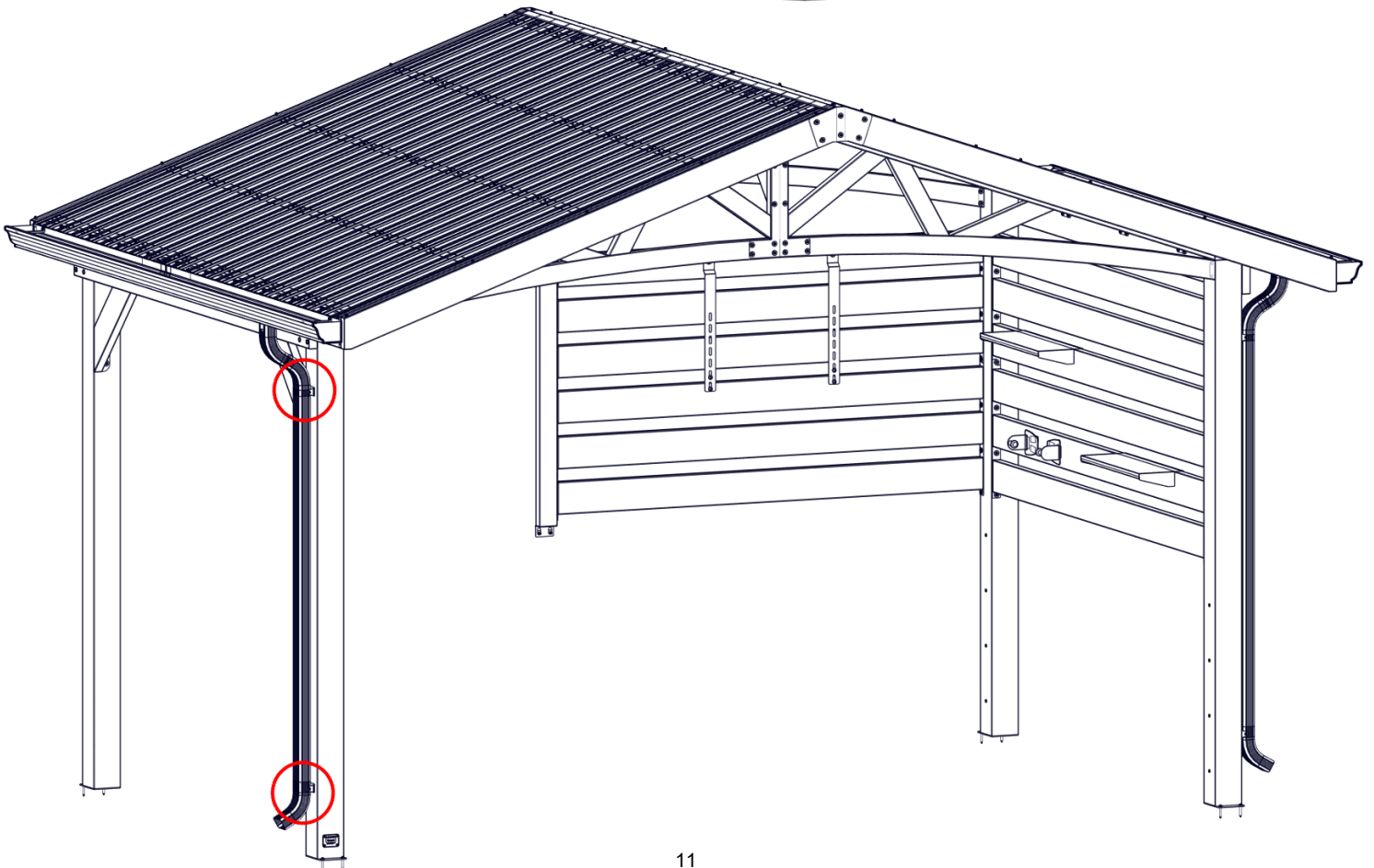
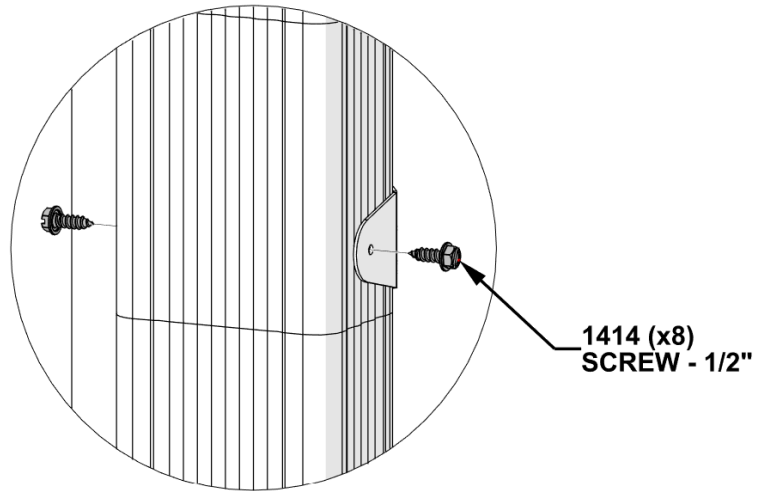

STEP 8 - GUTTER ASSEMBLY

QTY	PART NUMBER	DESCRIPTION
8	H101480	SCREW SELF TAPPING #9x1 BLK

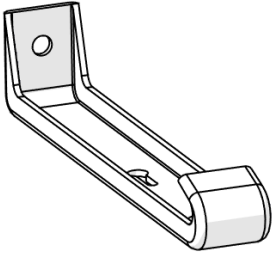

A4M04782 GUTTER HANGER
(x8)

- EVENLY SPACE AND ATTACH REMAINING GUTTER HANGERS WITH HARDWARE.
- SPACE HANGERS APPROXIMATELY 23-1/2" [595mm].

