

# STAINLESS STEEL SEALING LOCKNUTS

## Features:

- Manufactured in type 316 stainless steel to meet any stringent sanitary condition
- Polished to a bright, easily maintainable finish that is modern, attractive, easy to clean, and that also enhances the surface's resistance to pitting and bacterial corrosion
- Heavy-duty locknut bites into the box and enclosure to prevent vibratory loosening of the connection
- Integrally fused PVC gasket provides positive seal against water, oils and other liquids
- Designed for use with rain tight, watertight, and oil tight enclosures
- NPSL - straight threads
- No package quantity required



## Applications:

For use on threaded stainless rigid/IMC conduit to provide a seal against water and oil.

| Part Number | Trade Size (in) | A (in) | ID (in) | Wall Thickness (in) | Weight per each (lb) |
|-------------|-----------------|--------|---------|---------------------|----------------------|
| S60500LNWS  | ½               | 1.250  | 0.760   | 0.227               | 0.020                |
| S60700LNWS  | ¾               | 1.450  | 0.975   | 0.260               | 0.030                |
| S61000LNWS  | 1               | 1.820  | 1.210   | 0.294               | 0.060                |
| S61200LNWS  | 1¼              | 2.210  | 1.570   | 0.308               | 0.080                |
| S61500LNWS  | 1½              | 2.450  | 1.810   | 0.325               | 0.090                |
| S62000LNWS  | 2               | 2.915  | 2.300   | 0.342               | 0.100                |

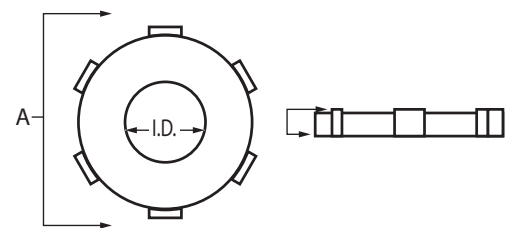

All dimensions are for informational purposes only \*Tolerances +/- 5%

