

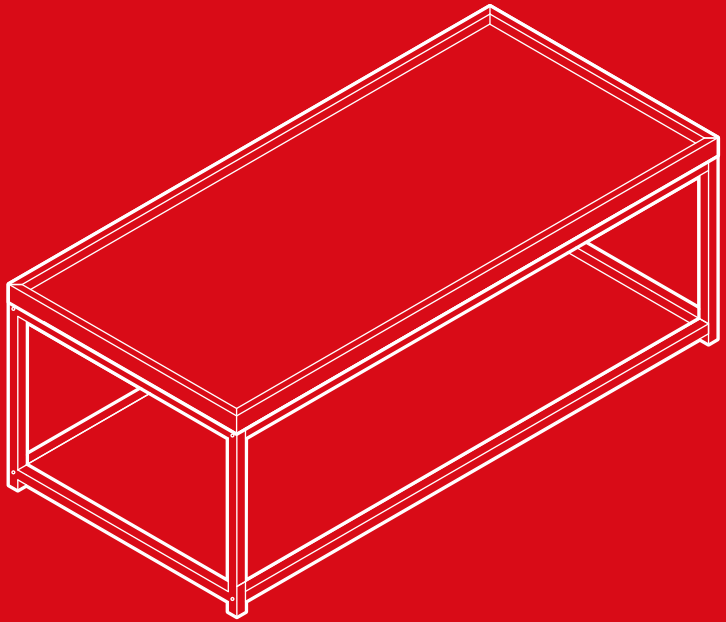

BEST CHOICE  
PRODUCTS



# INSTRUCTION MANUAL

---

2-Tier Tray Top Coffee Table

## ! NOTICE

Please retain these instructions for future reference.

- Firmly secure all bolts, screws and knobs before use.
- Reconfirm that all bolts, screws, and knobs are secure every 90 days.
- Do not use or store this item in the proximity of open flame or flammable/combustible chemicals.
- Always lay components on a clean, soft-cushioned surface during assembly.
- Improper installation may cause damage to the product.
- Product is intended for indoor use only.
- If any parts are missing, broken, damaged, or worn, stop using this item until repairs are made and/or factory replacement parts are installed.
- Do not use this item in a way inconsistent with the manufacturer's instructions as this could void the product warranty.
- To wipe down the furniture, use a damp cloth. Then, wipe it down once more with a dry cloth.
- Reconfirm that all bolts, screws, and knobs are secure every 90 days.
- Be aware that extra hardware may be included.

## TOOLS REQUIRED



ALLEN WRENCH  
(PROVIDED)



PHILLIPS  
SCREWDRIVER



ELECTRIC DRILL  
(RECOMMENDED)



90 LBS  
CAPACITY



2 PERSON  
ASSEMBLY



UP TO 30 MIN.  
ASSEMBLY

## HARDWARE

**A** M6 x 30mm  
DOWEL



8 PCS

**B** M6 x 35mm  
CAM BOLT



12 PCS

**C** M15 x 10mm  
CAM LOCK



12 PCS

**D** M4 x 40mm  
WOOD SCREW



4 PCS

**E** M6 x 35mm  
SCREW



8 PCS

**F** M4 x 14mm  
SCREW



12 PCS

## PARTS

**1** TABLE TOP

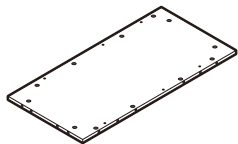

1 PC

**2** TABLE EDGE PANEL  
FRONT/BACK

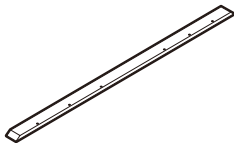

2 PCS

**3** TABLE EDGE PANEL  
SIDE



2 PCS

**4** BOTTOM BOARD

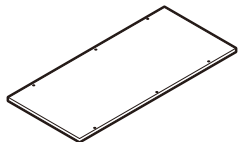

1 PC

**5** TABLE FRAME SIDE

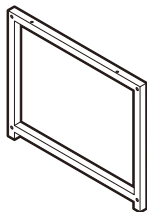

2 PCS

**6** TABLE FRAME TOP

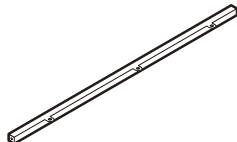

2 PCS

**7** TABLE FRAME BOTTOM

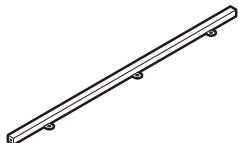

2 PCS

## PRODUCT ASSEMBLY

1

Insert eight **part B cam bolts** into two **part 2 table tray edges**, four bolts per edge.

Insert four **part B cam bolts** into two **part 3 table tray edges**, two bolts per edge.

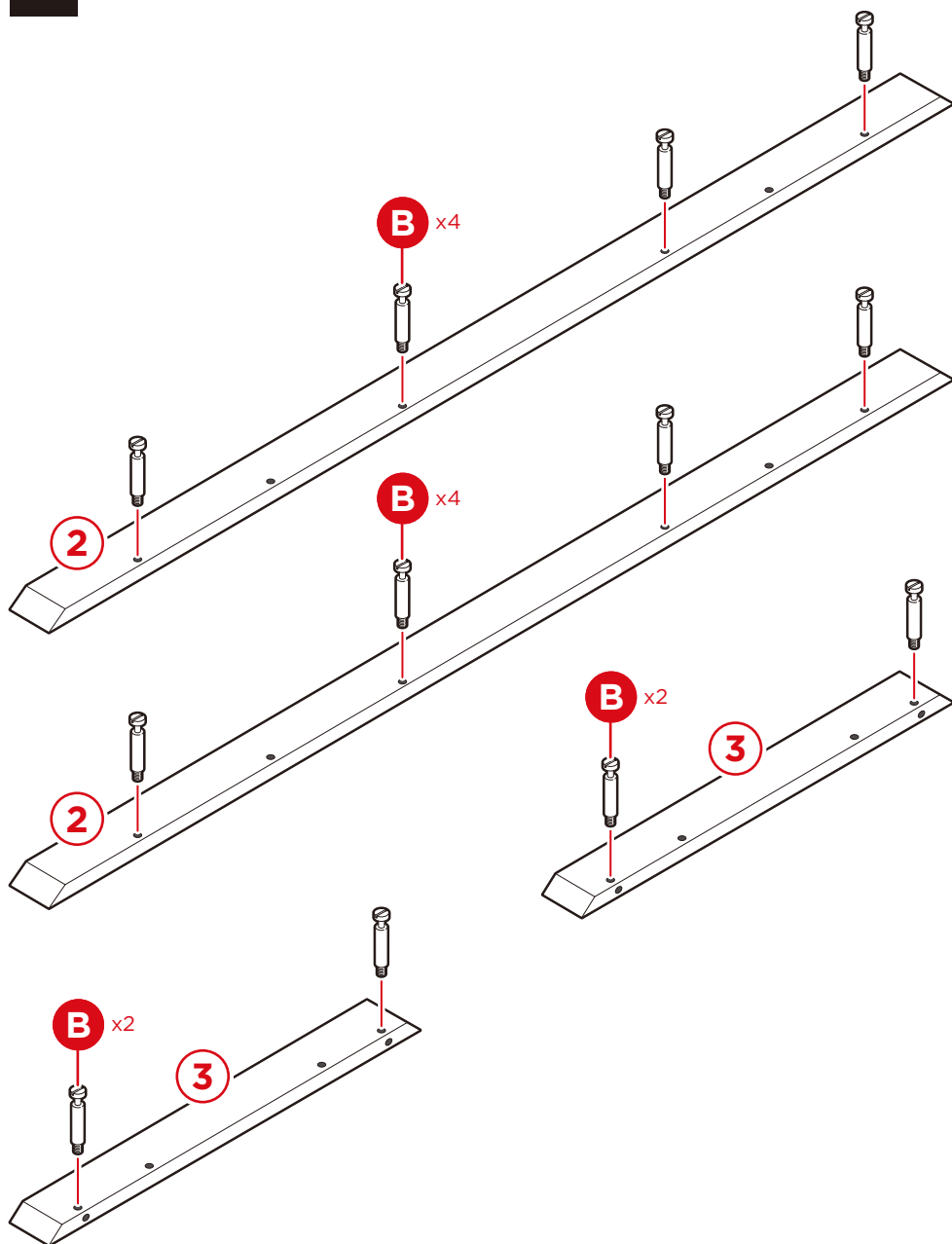

## PRODUCT ASSEMBLY

2

Insert twelve **part C cam locks** and eight **part A dowels** into the **part 1 table top**.

Attach the **part 2 & 3 table tray edges** to the **part 1 table top**, then secure by turning the cam locks.

**NOTE:** Attach **parts 3 & 2** so they are level with the bottom of **part 1**.

Set aside the table top assembly.

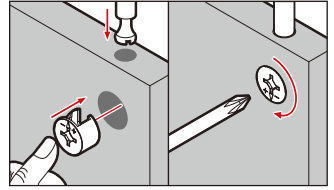

Use a screwdriver to turn the cam lock to secure the cam bolt.

### BOTTOM VIEW

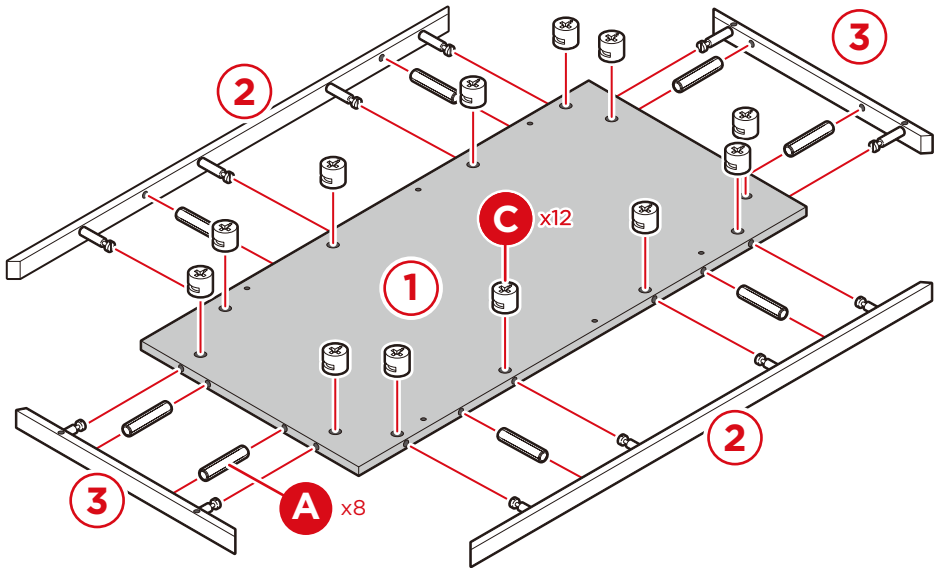

BOTTOM VIEW

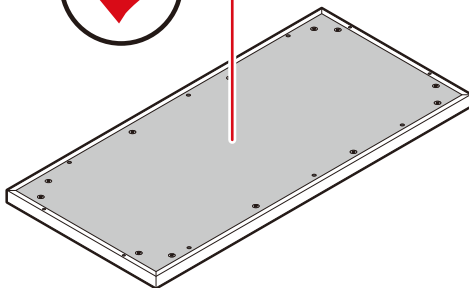

BOTTOM VIEW

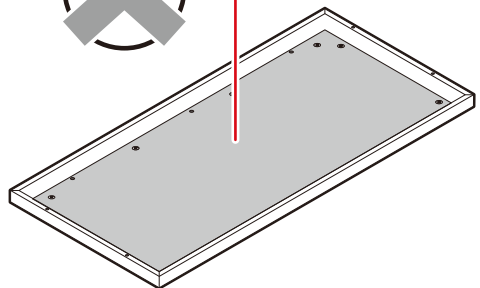

## PRODUCT ASSEMBLY

3

Attach two **part 7 table frame bottoms** to the bottom of the **part 4 bottom board** with six **part F screws**, three screws per frame.

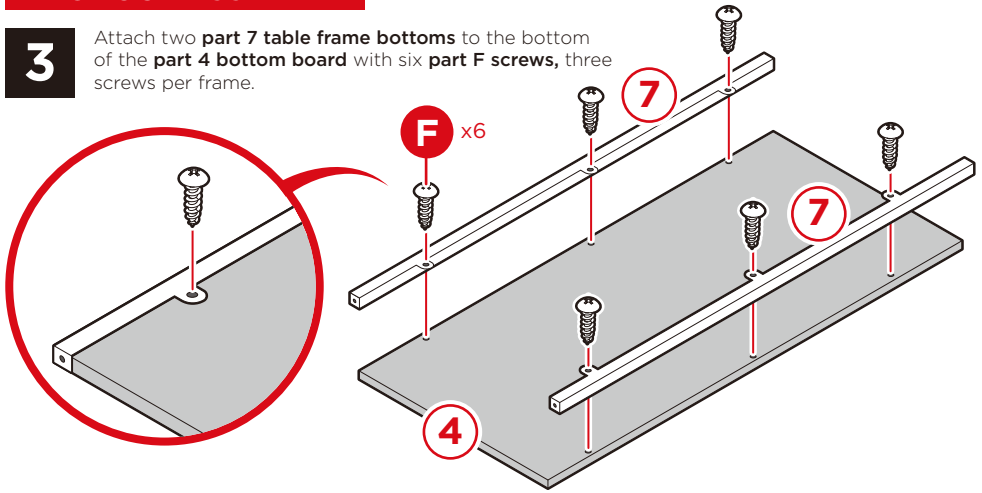

4

Flip the bottom board assembly, then attach two **part 5 frame sides** with four **part E screws**. Attach two **part 6 top frames** to the **part 5 side frames** with four **part E screws**.

**NOTE:** When attaching side frames, take care that the top hardware holes sit on the outer edge of the assembly.

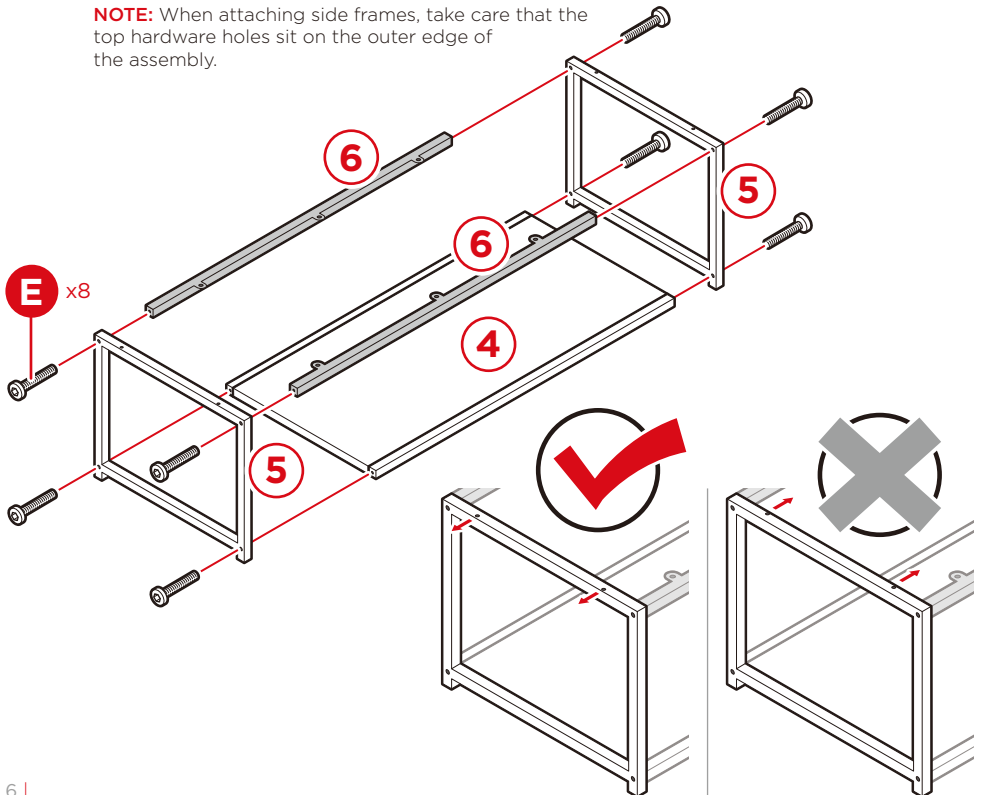

## PRODUCT ASSEMBLY

5

Locate the table top assembly, then attach the **part 6 frames** with six **part F screws**, three screws per frame. Attach the **part 5 side frames** to the **part 1 table top** with four **part D screws**, two screws per side frame.

**NOTE:** It is recommended that two people flip the frame assembly and lower it onto the table top, then attach the two with a power drill.

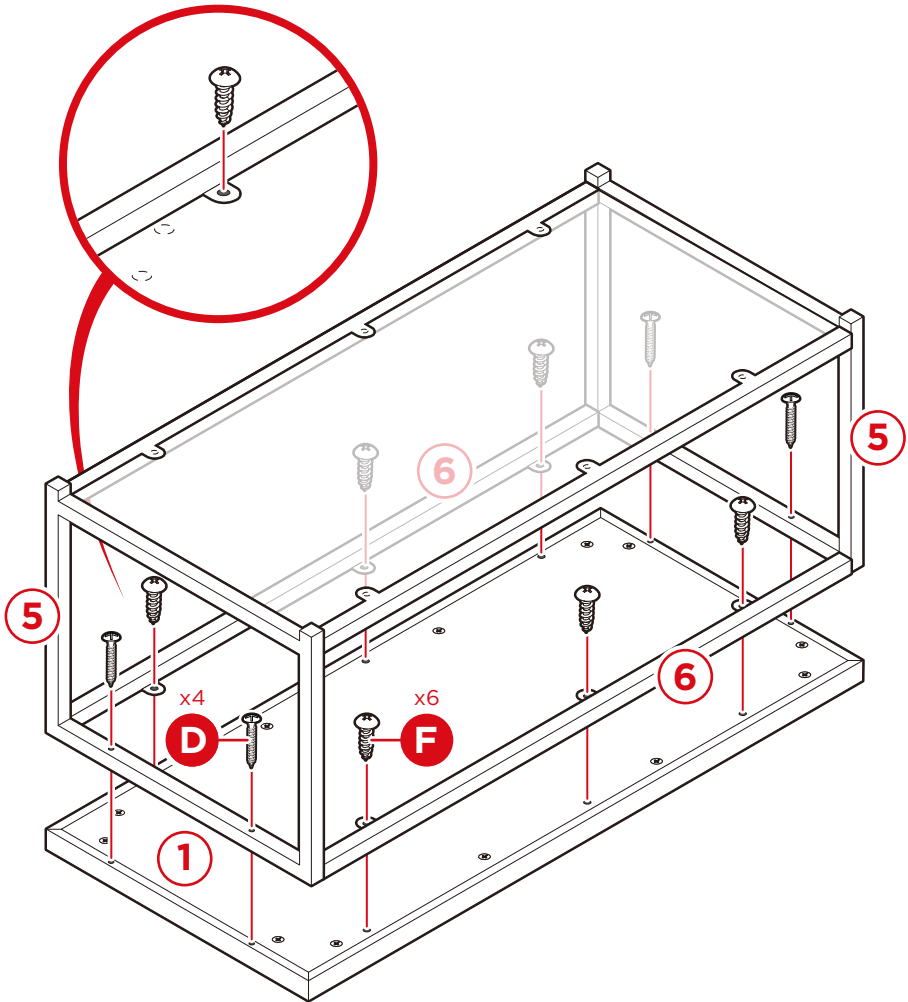



# HELP CENTER



Question about your product? We're here to help. Visit us at:

[help.bestchoiceproducts.com](http://help.bestchoiceproducts.com)



Chat Support



Product Inquiry



Orders FAQ



Product Assembly



Returns & Refunds

## PRODUCT WARRANTY INFORMATION

All items can be returned for any reason within 60 days of the receipt and will receive a full refund as long as the item is returned in its original product packaging and all accessories from its original shipment are included. All returned items will receive a full refund back to the original payment method. All returned items will not be charged a re-stocking fee.

All returned items require an RA (Return Authorization) number, which can only be provided by a Best Choice Products Customer Service Representative when the return request is submitted. Items received without an RA may not be accepted or may increase your return processing time. Once an item has been received by Best Choice Products, refunds or replacements will be processed within 5 business days.

All returns must be shipped back to the Best Choice Products Return Center at the customer's expense. If the reason for return is a result of an error by Best Choice Products then Best Choice Products will provide a pre-paid shipping label via email. Boxes for return shipping will not be provided by Best Choice Products, and is the customer's responsibility to either use the original shipping boxes or purchase new boxes.

Pictures may be required for some returns to ensure an item is not damaged prior to its return. Items returned are not considered undamaged until they are received by Best Choice Products and verified as such. All damages to items are the customer's responsibility until the item has been received by and acknowledge by Best Choice Products as undamaged.

## WARNING

Manufacturer and seller expressly disclaim any and all liability for personal injury, property damage or loss, whether direct, indirect, or incidental, resulting from the incorrect attachment, improper use, inadequate maintenance, unapproved modification, or neglect of this product.