

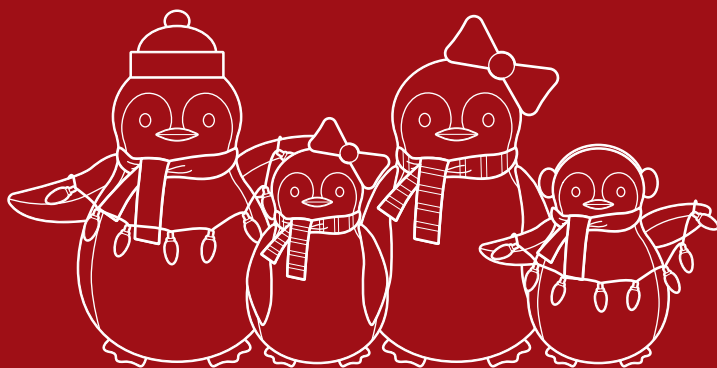

BEST CHOICE
PRODUCTS



INSTRUCTION MANUAL

4-Piece Lighted Pop-Up
Penguin Family

! NOTICE

Please retain these instructions for future reference.

- This product is intended for outdoor use and should be assembled outdoors only.
- This item is not intended for permanent installation or use.
- Unplug item when not in use or if left unattended.
- Ensure that your voltage is consistent with specifications.
- If any parts are missing, broken, damaged, or worn, stop using this product until repairs are made and/or factory replacement parts are installed.
- Do not use this item in a way inconsistent with the manufacturer's instructions as this could void the product warranty.
- This product is intended for residential use only.



1 PERSON
ASSEMBLY



UP TO 45 MIN.
ASSEMBLY

! WARNING

- Do not plug into a wall outlet until item is fully assembled and lights are properly connected.
- Do not use in extreme weather conditions.
- Keep item away from all heat sources (fireplace, stove, heater, etc.).
- Please use the provided stakes to properly secure the figures.
- Do not secure wiring with staples, nails, or sharp hooks.
- Do not hang ornaments or other objects from the cord.

RECOMMENDED PLACEMENT

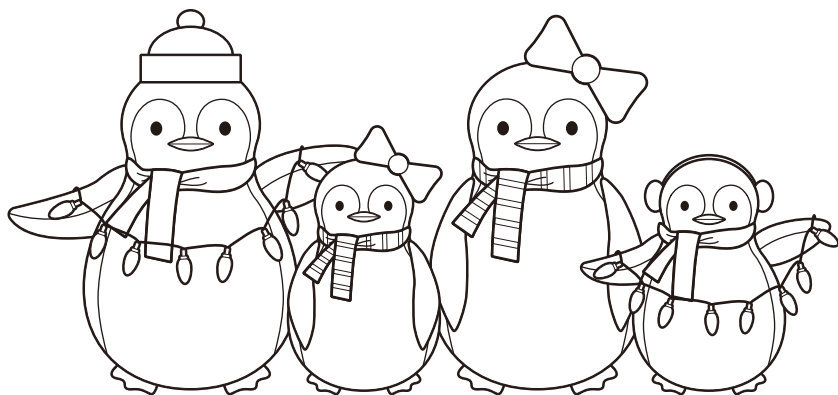

HARDWARE

1

STAKE

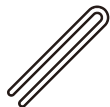

16 PCS

2

LIGHT HOOK



4 PCS

PARTS

A

LARGE PENGUIN
BODY I



1 PC

B

SMALL PENGUIN
BODY I



1 PC

C

LARGE PENGUIN
BODY II



1 PC

D

SMALL PENGUIN
BODY II



1 PC

E

TOP POLE
(LARGE PENGUIN)

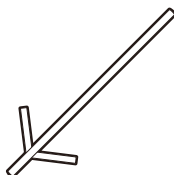

2 PCS

F

TOP POLE
(SMALL PENGUIN)



2 PCS

G

BOTTOM INNER POLE
(LARGE PENGUIN)

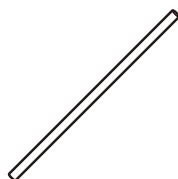

2 PCS

H

BOTTOM INNER POLE
(SMALL PENGUIN)



2 PCS

I

LARGE PENGUIN
WINGS I



1 SET

J

SMALL PENGUIN
WINGS I



1 SET

K

LARGE PENGUIN
WINGS II



1 SET

L

SMALL PENGUIN
WINGS II



1 SET

PARTS

M

LARGE PENGUIN
SCARF I



1 PC

N

SMALL PENGUIN
SCARF I



1 PC

O

LARGE PENGUIN
SCARF II



1 PC

P

SMALL PENGUIN
SCARF II



1 PC

Q

LARGE PENGUIN
BOW

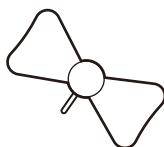

1 PC

R

SMALL PENGUIN
BOW

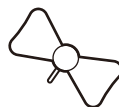

1 PC

S

STRING LIGHTS



2 PCS

T

POWER ADAPTER

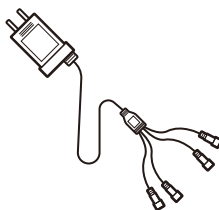

1 PC

PRODUCT ASSEMBLY

1

Locate the **part A large penguin body** and turn it upside down with the penguin's hat on the ground.

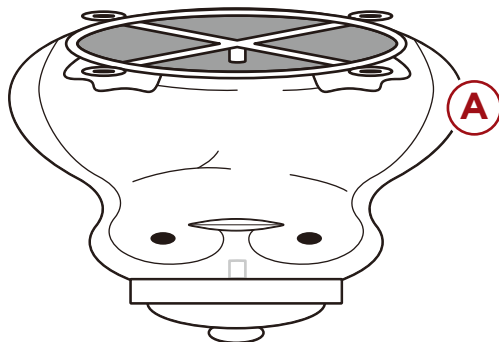

2

Attach **part E top pole** to **part G bottom pole**.

Insert the connected **part E** and **G** through the bottom opening of the **part A large penguin body**.

Insert the **part E top** of the pole into the opening in the penguin's hat, then thread the opposite end of the **part G bottom pole** through the metal insert at the bottom of the penguin body.

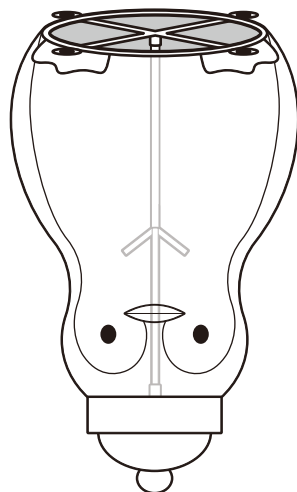
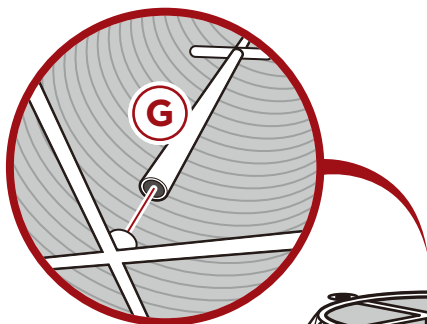
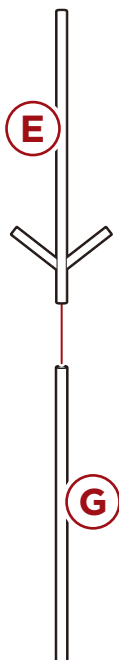

PRODUCT ASSEMBLY

3

Locate the openings on either side of the **part A large penguin body** and insert the **part I wings**. Connect the wings to the branches of the **part E top pole**.

NOTE: If the light plugs on the wings are not connected to the body, connect them before proceeding.

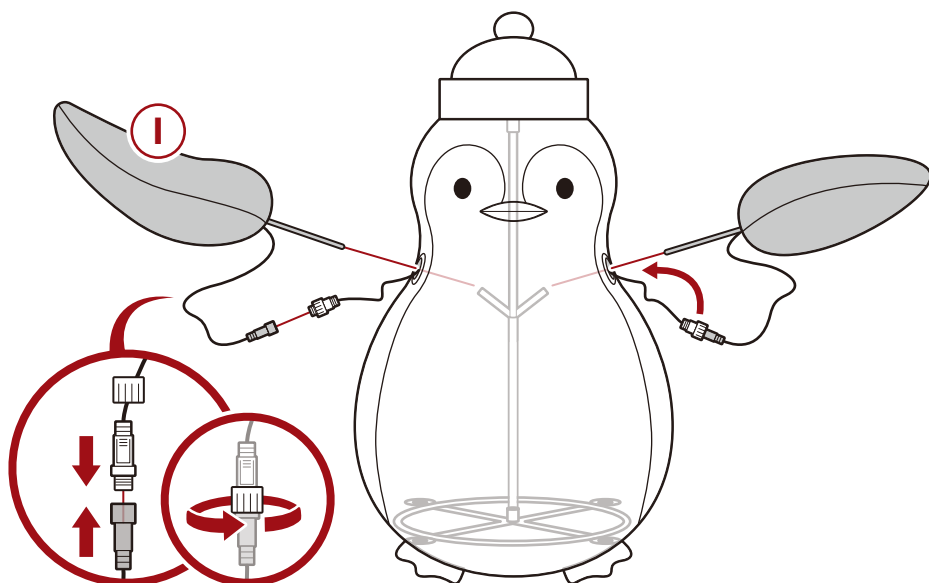

4

Wrap the **part M scarf** around the penguin's neck.

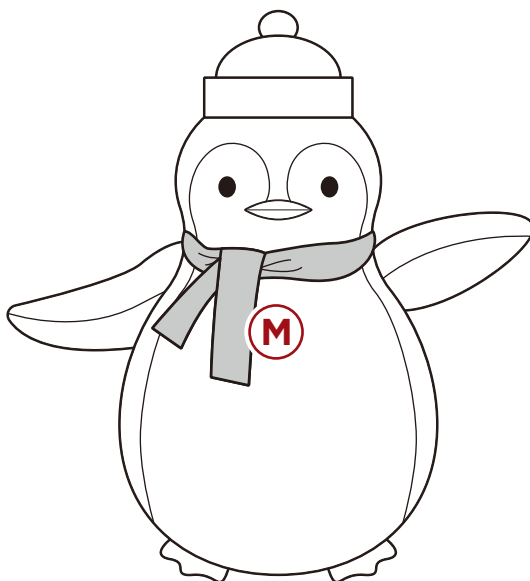

PRODUCT ASSEMBLY

5

Locate the white plug on the **part A large penguin body** and connect it to the green plug on the **part S string lights**.

Attach the **part 2 light hooks** to the **part S string lights** and drape the lights over the penguin as desired.

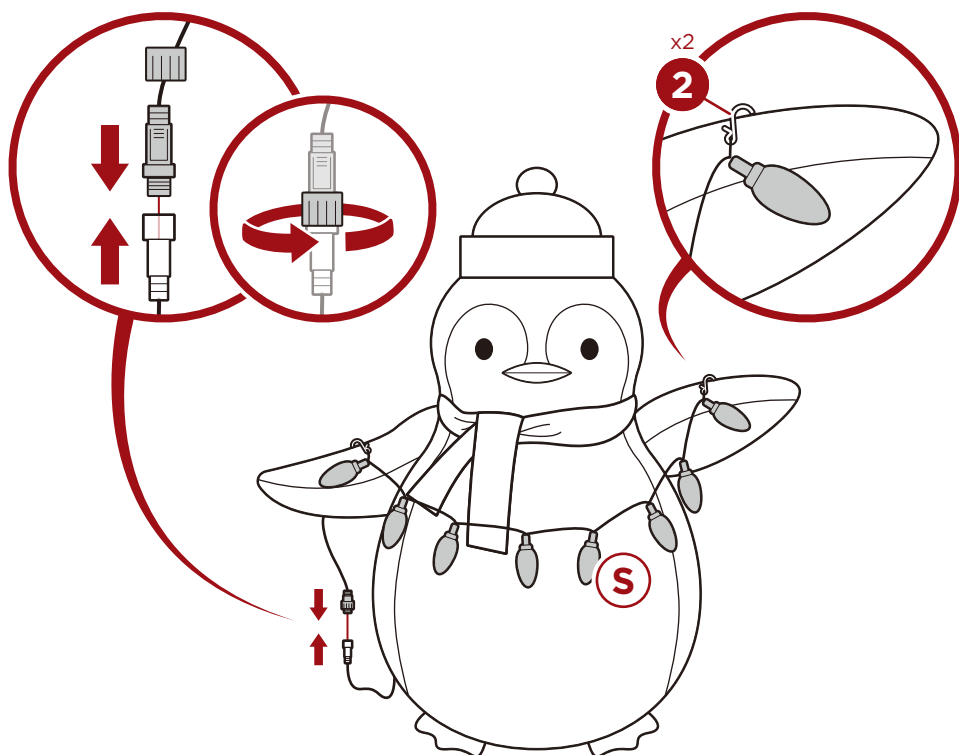

6

Repeat **steps 1-5** to assemble the small penguin.

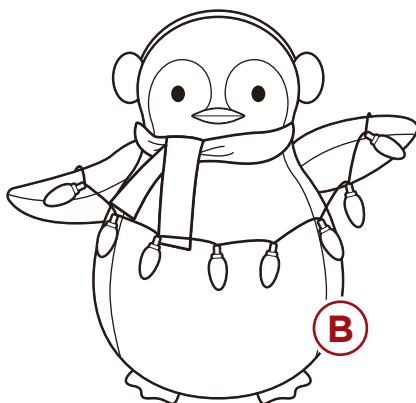

PRODUCT ASSEMBLY

7

Locate the **part C large penguin body** and turn it upside down with the penguin's hat on the ground.

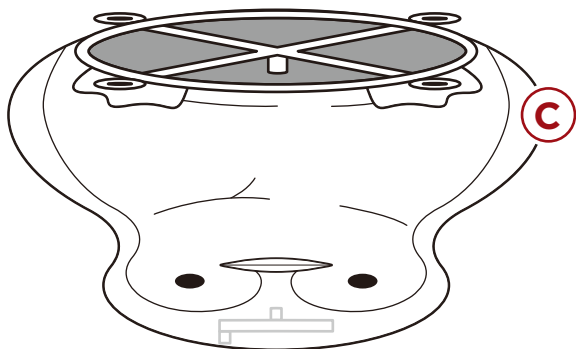

8

Attach **part E top pole** to **part G bottom pole**.

Insert the connected **part E** and **G** through the bottom opening of the **part C large penguin body**.

Insert the **part E top** of the pole into the opening in the penguin's hat, then thread the opposite end of the **part G bottom pole** through the metal insert at the bottom of the penguin body.

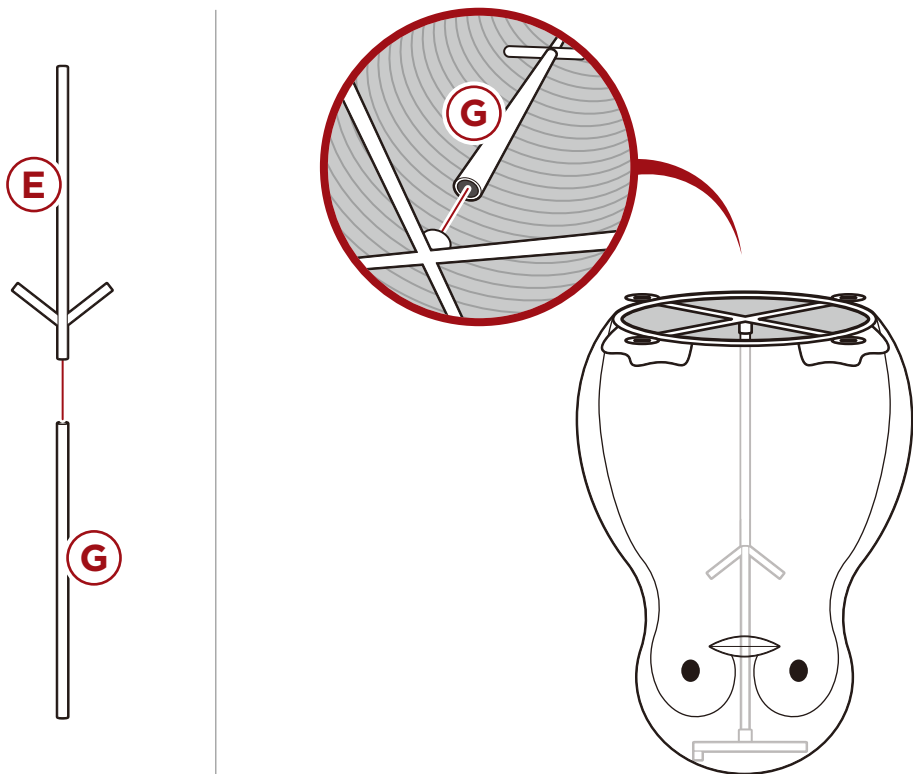

PRODUCT ASSEMBLY

9

Locate the openings on either side of the **part C large penguin body** and insert the **part K wings**.
Connect the wings to the branches of the **part E top pole**.

NOTE: If the light plugs on the wings are not connected to the body, connect them before proceeding.

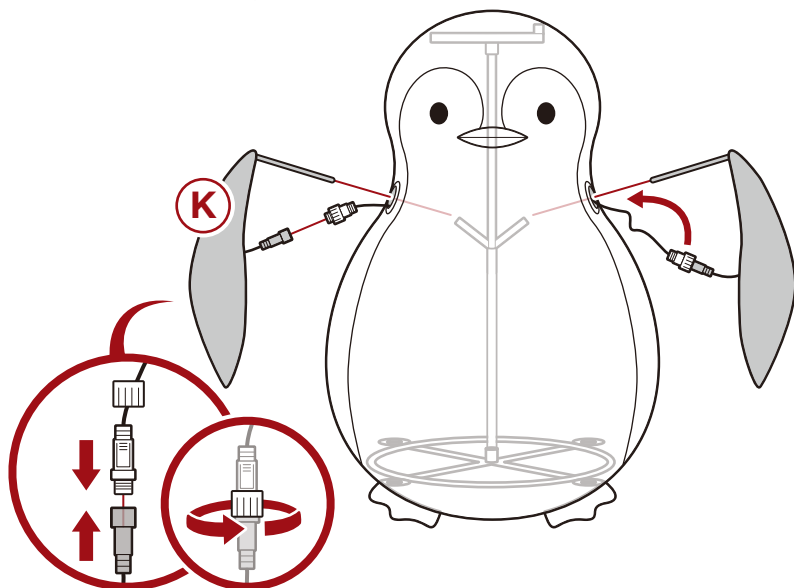

10

Wrap the **part O scarf** around the penguin's neck.

Locate the openings on the penguin's head and insert the **part Q bow**.



PRODUCT ASSEMBLY

11

Repeat **steps 7-10** to assemble the small penguin.



12

Locate the white plug on each penguin body and connect them to the white plugs on the **part T** power adapter.

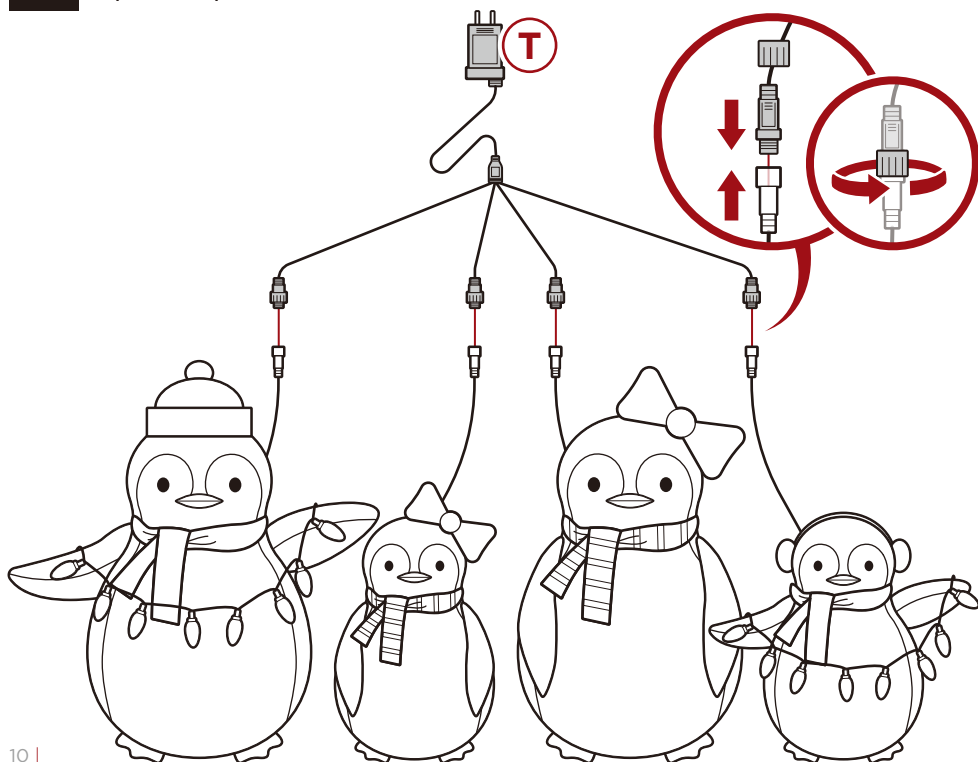

PRODUCT ASSEMBLY

12

Secure the penguin figures to the ground with sixteen part 1 stakes.

Plug into a wall outlet to turn on the lights.

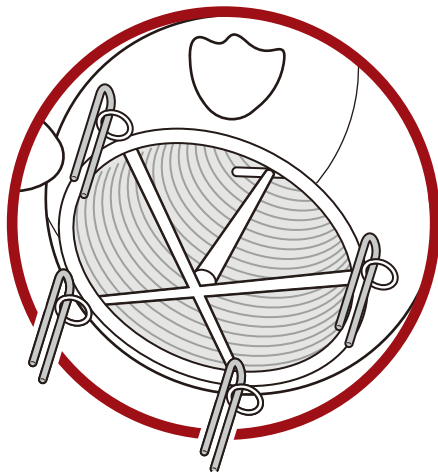
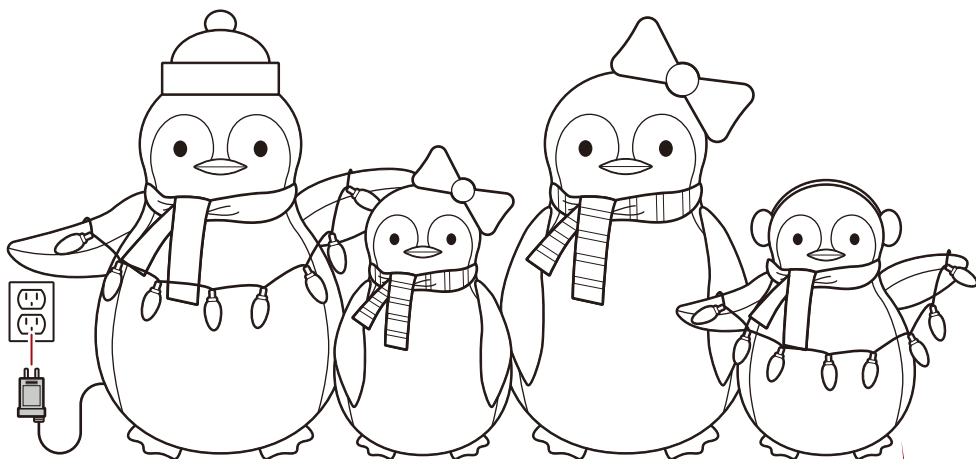

1

x16



HELP CENTER



Question about your product? We're here to help. Visit us at:

help.bestchoiceproducts.com



Chat Support



Product Inquiry



Orders FAQ



Product Assembly



Returns & Refunds

PRODUCT WARRANTY INFORMATION

All items can be returned for any reason within 60 days of the receipt and will receive a full refund as long as the item is returned in its original product packaging and all accessories from its original shipment are included. All returned items will receive a full refund back to the original payment method. All returned items will not be charged a re-stocking fee.

All returned items require an RA (Return Authorization) number, which can only be provided by a Best Choice Products Customer Service Representative when the return request is submitted. Items received without an RA may not be accepted or may increase your return processing time. Once an item has been received by Best Choice Products, refunds or replacements will be processed within 5 business days.

All returns must be shipped back to the Best Choice Products Return Center at the customer's expense. If the reason for return is a result of an error by Best Choice Products then Best Choice Products will provide a pre-paid shipping label via email. Boxes for return shipping will not be provided by Best Choice Products, and is the customer's responsibility to either use the original shipping boxes or purchase new boxes.

Pictures may be required for some returns to ensure an item is not damaged prior to its return. Items returned are not considered undamaged until they are received by Best Choice Products and verified as such. All damages to items are the customer's responsibility until the item has been received by and acknowledge by Best Choice Products as undamaged.

© Best Choice Products, Inc. All rights reserved. Distributed by Best Choice Products, Inc. Newport Beach, CA 92660



WARNING

Manufacturer and seller expressly disclaim any and all liability for personal injury, property damage or loss, whether direct, indirect, or incidental, resulting from the incorrect attachment, improper use, inadequate maintenance, unapproved modification, or neglect of this product.