

# nVent CADDY In-Deck/Slab Solutions



nVent CADDY In-Deck/Slab solutions include a broad range of Stub Down and Stub Up products with accompanying accessories and supports designed specifically for concrete deck and on-grade applications. Speed up and simplify installation while providing additional security and durability to even the most difficult concrete jobs.

## Stub Down

The nVent CADDY Reinforced Conduit Stub Down (RSD) is a fast and secure method to install PVC and ENT to concrete formwork. Designed to guard against damage and prevent loss of raceways during a concrete pour, the RSD series eliminates the need for additional support during installation. Achieve confidence on-the-job knowing your conduit layout will remain in its desired configuration after the concrete deck is finished.

### STUB DOWN, ENT

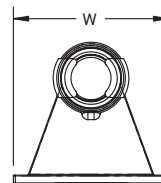
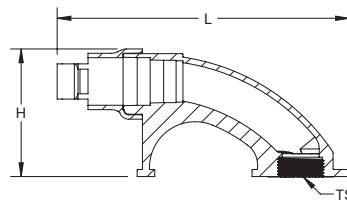

#### Features

- Integrated reinforcing stand - resists up to 200 lbs of force
- Generous radius for ease of wire pull - 50% less force required
- Threaded opening designed for standard fittings
- No fish tape hang ups

Material: Polyvinylchloride

| Part Number | ENT Conduit Size | Thread Size TS | Length L | Width W | Height H |
|-------------|------------------|----------------|----------|---------|----------|
| RSD075F     | 0.75"            | 0.75"-14" NPSM | 8.47"    | 3.78"   | 3.66"    |
| RSD100F     | 1"               | 1"-11.5" NPSM  | 8.26"    | 4"      | 3.61"    |

## STUB DOWN, PVC

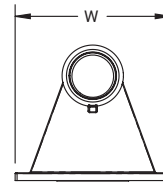
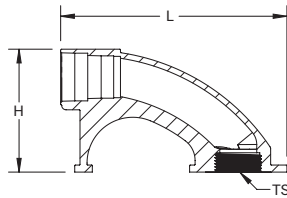

### Features

- Integrated reinforcing stand - resists up to 200 lbs of force
- Generous radius for ease of wire pull - 50% less force required
- Threaded opening designed for standard fittings
- No fish tape hang ups

Material: Polyvinylchloride

| Part Number | PVC Conduit Size | EMT Conduit Size | Thread Size TS | Length L | Width W | Height H |
|-------------|------------------|------------------|----------------|----------|---------|----------|
| RSD075R     | 0.75"            | 0.75"            | 0.75"-14" NPSM | 6.6"     | 3.78"   | 3.54"    |
| RSD100R     | 1"               | 1"               | 1"-11.5" NPSM  | 6.39"    | 101.6"  | 3.49"    |

## STUB DOWN, ACCESSORY

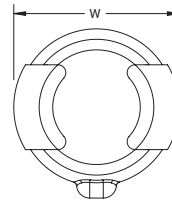
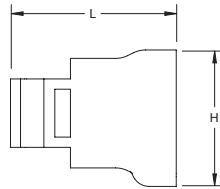

### Features

- Easy to use, tool free push-in adaptor for ENT
- Provides jobsite adaptability for multiple applications

Material: Polyvinylchloride

| Part Number | ENT Conduit Size | Length L | Width W | Height H |
|-------------|------------------|----------|---------|----------|
| RSDFA075    | 0.75"            | 2.42"    | 1.65"   | 1.65"    |
| RSDFA100    | 1"               | 2.43"    | 1.95"   | 1.95"    |

## Stub Up

The nVent CADDY Conduit Stub Up is a fast and secure method to address space constraint issues in overcrowded areas when installing in-deck conduit. This line is designed to provide positional flexibility with the added securement of nVent CADDY Conduit Fasteners. Increase installation efficiency when adding conduit to any concrete environment with our Stub Up offering.

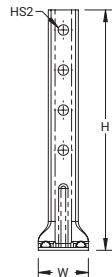
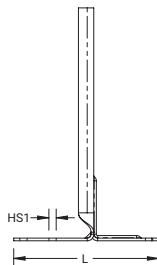

### STUB UP, CONDUIT SUPPORT

- Ideal securement for in-deck conduit routing or stub up
- Stable footprint for concrete pours
- Provides a wide range of height adjustment
- Range of sizes available to accommodate multiple slab depths
- Combine with nVent CADDY Strut or Threaded Rod to support multiple raceways into load center

Finish: Pregalvanized  
Material: Steel

| Part Number | Height H | Hole Size 1 HS1 | Hole Size 2 HS2 | Width W | Length L |
|-------------|----------|-----------------|-----------------|---------|----------|
| FBS4        | 4"       | 0.1875"         | 0.25"           | 1.25"   | 3.75"    |
| FBS6        | 6"       | 0.1875"         | 0.25"           | 1.25"   | 3.75"    |

# Supports and Accessories

The nVent CADDY In-Deck Supports and Accessories are a fast and secure method to address a wide variety of electrical installations for concrete deck and slab-on-grade applications. This line is designed to provide ease of adjustment and flexibility for your most challenging installations while providing added on-site efficiency. All support components are designed for a strong foundation, giving confidence the installation will remain stable during concrete pours.



## ADJUSTABLE BOX SUPPORT

- Ideal solution for in-deck concrete electrical box applications
- Easy, tool-free adjustment for various concrete deck depths
- Universal support for a wide range of commercially available electrical boxes
- Enhanced stability, utilizing the nVent CADDY Footed Box/Conduit Support 4" and 6" base
- More efficient installation compared to traditional methods

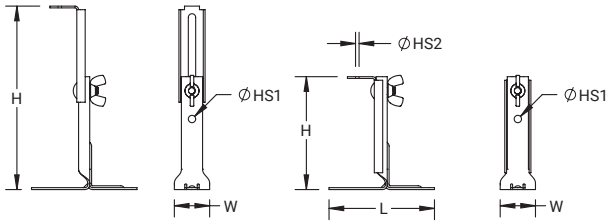

| Part Number | Hole Size 1<br>HS1 | Hole Size 2<br>HS2 | Length<br>L | Width<br>W | Height<br>H |
|-------------|--------------------|--------------------|-------------|------------|-------------|
| ABS1        | 0.188"             | 0.25"              | 3.75"       | 1.25"      | 4.0"–6.5"   |
| ABS2        | 0.188"             | 0.25"              | 3.75"       | 1.25"      | 6.0"–8.5"   |



Our powerful portfolio of brands:

**CADDY ERICO HOFFMAN ILSCO SCHROFF TRACHTE**

