

BLACK DIAMOND®

Project Name: _____

Location: _____

Item #: _____

Qty: _____

Black Diamond Bottle Cooler, 50"W, 14 Cu. Ft., 2 Door, in Black

USBC-50



Designed to store and chill bottled beverages such as beer, soda and water, the Black Diamond 2-Door Bottle Cooler is a must-have for bars, restaurants, pubs and other foodservice establishments that need quick access to chilled drinks for customers. This commercial bottle cooler has a 14 cubic-foot interior with plenty of room to store and chill bottled beverages. This bottle cooler has a painted aluminum interior for easy cleaning and a black-coated steel exterior for a sleek look that goes well with any bar setting.

FEATURES AND CONSTRUCTION

- 14 Cu. Ft. interior offers plenty of room to store and chill bottled beverages such as beer, soda and water
- 2 stainless steel sliding lids
- 3 plastic coated steel dividers
- Black coated steel exterior
- Painted aluminum interior
- Built-in bottle opener with cap catcher
- Uses environmentally-friendly R290 refrigerant
- Foamed-in-place polyurethane high density cell insulation throughout the entire cabinet
- The lids are lockable so that the beverages inside the unit stay safe after hours
- Precise digital temperature controller with LED display

ELECTRIC

115V / 60Hz / 1 ph

Cord Length (Inches): 98.40"

Plug Type: NEMA 5-15P

Cord set included

NEMA 5-15P



3RD PARTY APPROVALS



WARRANTY (USA / CANADA)

Two (2) Year Limited Warranty on Parts and Labor, Five (5) Year Warranty on Compressor and Evaporator

Contact us for details at 1.877.368.2797



STORAGE CAPACITY

- Cubic Feet: 14 Cu. Ft.
- 24 Cases (12 oz. Cans) 16.5 Cases (12 oz. Bottles)

TEMPERATURE

- Holding Temperature (Fahrenheit): 33° - 40°

These models are designed to operate in an environment where temperature and humidity do not exceed 75°F (24°C) and 55% relative humidity



Black Diamond 50" Bottle Cooler, 2 Door

USBC-50

FRONT

SIDE

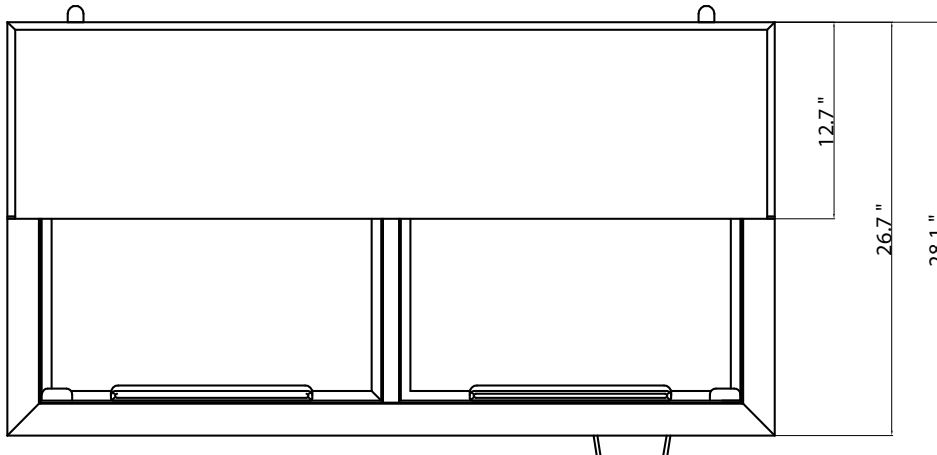
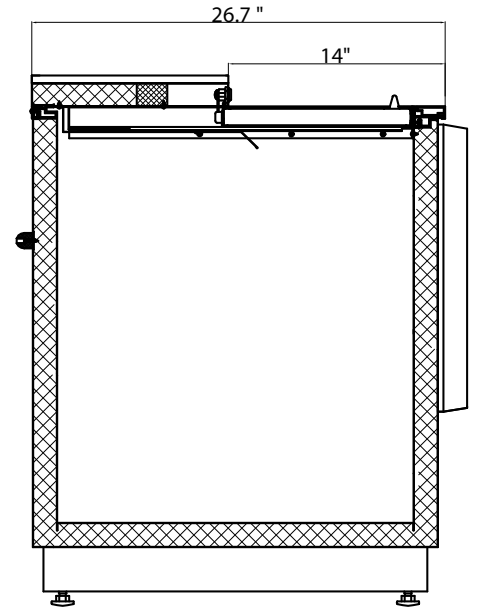
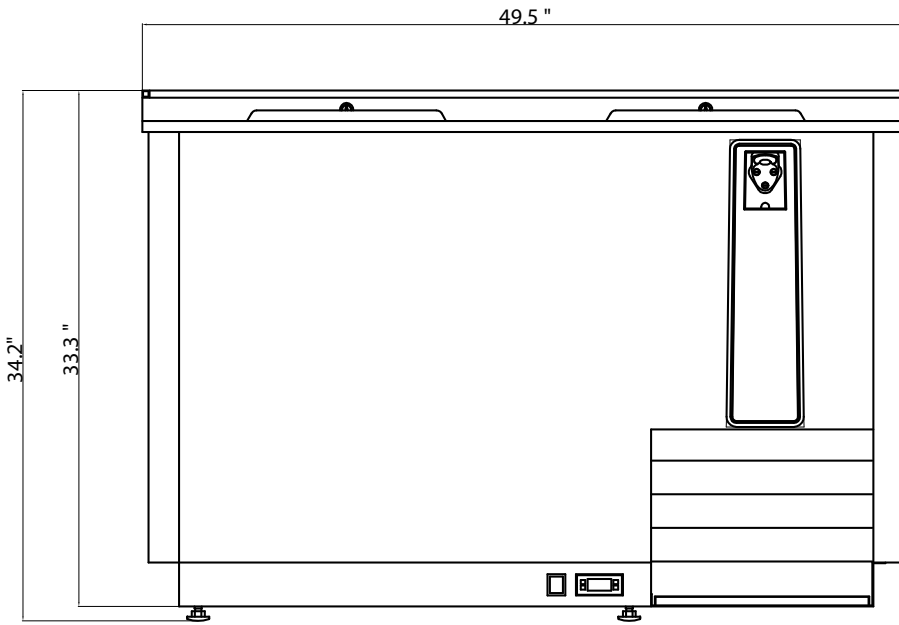

TOP

Bottle Cooler

Doors	Shelves	Amps	Refrigerant	Capacity	Assembled Dimensions (in)	Item Weight (lbs)	Shipping Weight (lbs)
2	3	2.5A	R290 3.3535	14 Cu. Ft.	49.50" x 28.00" x 34.20"	180.8	225.0

Due to periodic changes in designs, methods, procedures, policies and regulations, the specifications contained in this document are subject to change without notice. While we exercise good faith efforts to provide information that is accurate, we are not responsible for errors or omissions in information provided or conclusions reached as a result of using the specifications. By using the information provided, the user assumes all risks in connection with such use.