

ASSEMBLY INSTRUCTION FOR 23760 DRESSER

| HARDWARE LIST | | | |
|---------------|------|----------------------|------|
| NO. | ITEM | DESCRIPTION | QTY. |
| 1 | | JCB Bolt M6 X 20 MM | 10 |
| 2 | | JCB Bolt M6 X 30 MM | 2 |
| 3 | | JCB Bolt M6 X 40 MM | 4 |
| 4 | | JCB Bolt M6 X 50 MM | 4 |
| 5 | | Flat washer M8X25 MM | 20 |
| 6 | | Allen wrench | 1 |
| 7 | | Bolt M8X20 MM | 4 |
| 8 | | Flat washer M8X18 MM | 4 |
| 9 | | Wrench | 1 |

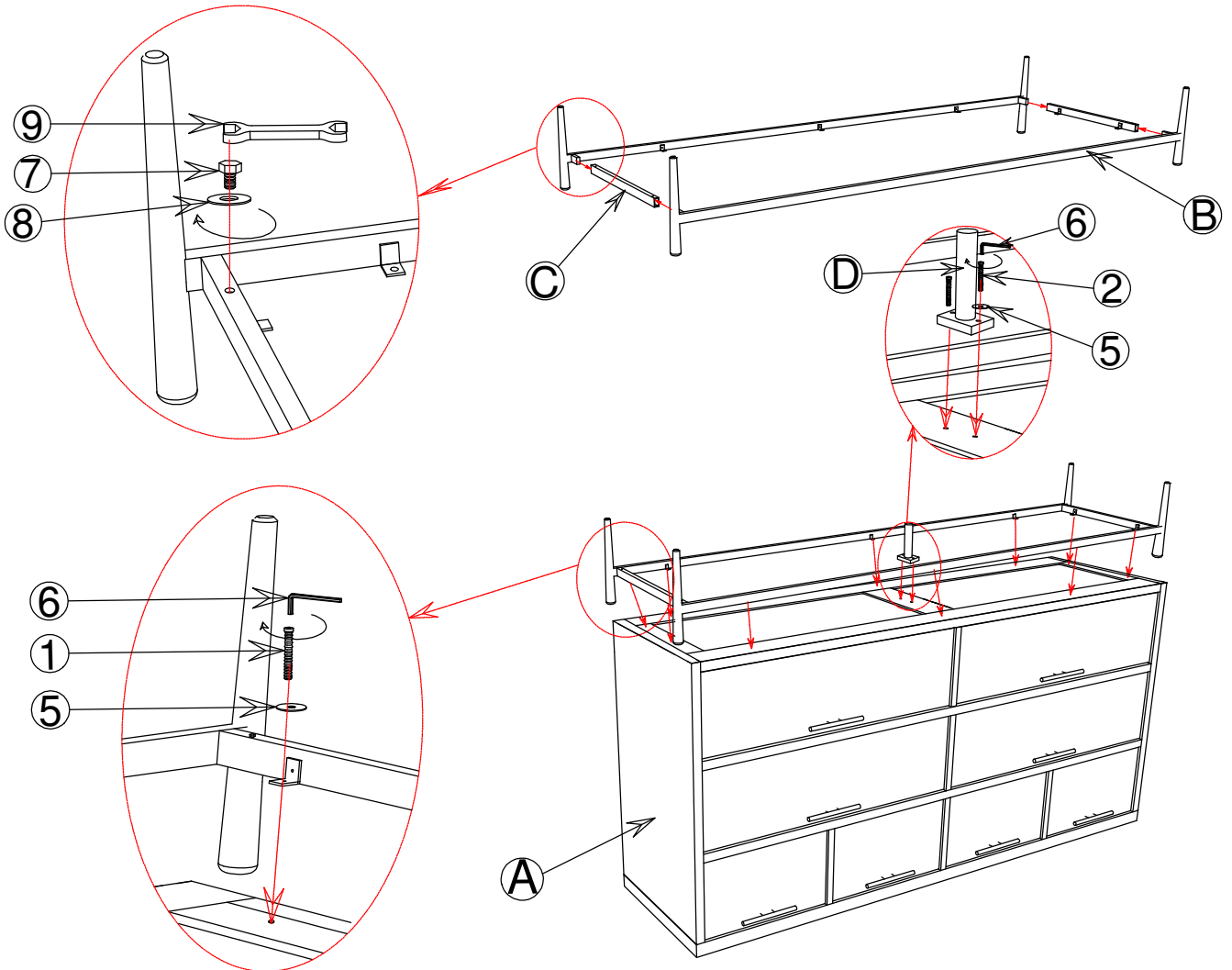
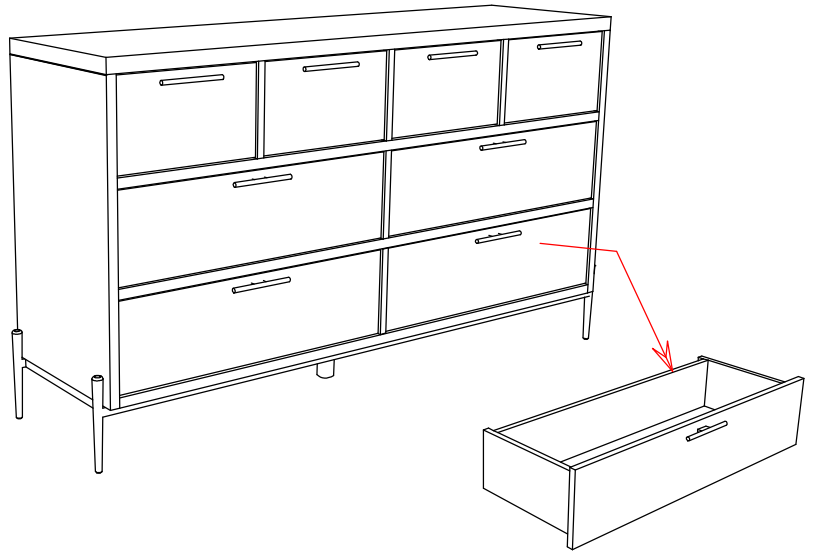

TO ASSEMBLY :

STEP 1 : Unpack dresser and remove drawers.

STEP 2 : Roll dresser on its back, then on its top on a clean, soft surface.

STEP 3 : Thread the HEX. bolt(7) to iron leg(B) & iron cross bar(C).using small washers(8) tighten end assemblies fully.

STEP 4 : Set base assembly on the upside down case and attach with bolt (1) and washer (5) using allen wrench (6).

STEP 5 : Tighten bolts in step 6 fully with allen wrench (6) & wrench (9) then carefully turn the buffet upright.

STEP 6 : Align hole in center leg (D) with holes on bottom of dresser (A) and slide it into position.

STEP 7 : Thread the flat washer(5), JCB bolt (1) to leg (B) .tighten bolts in step 6 fully with allen wrench (6) then carefully turn the table upright.

STEP 8 : Install drawers.

ASSEMBLY INSTRUCTION FOR 23760 DRESSER & 23768 MIRROR

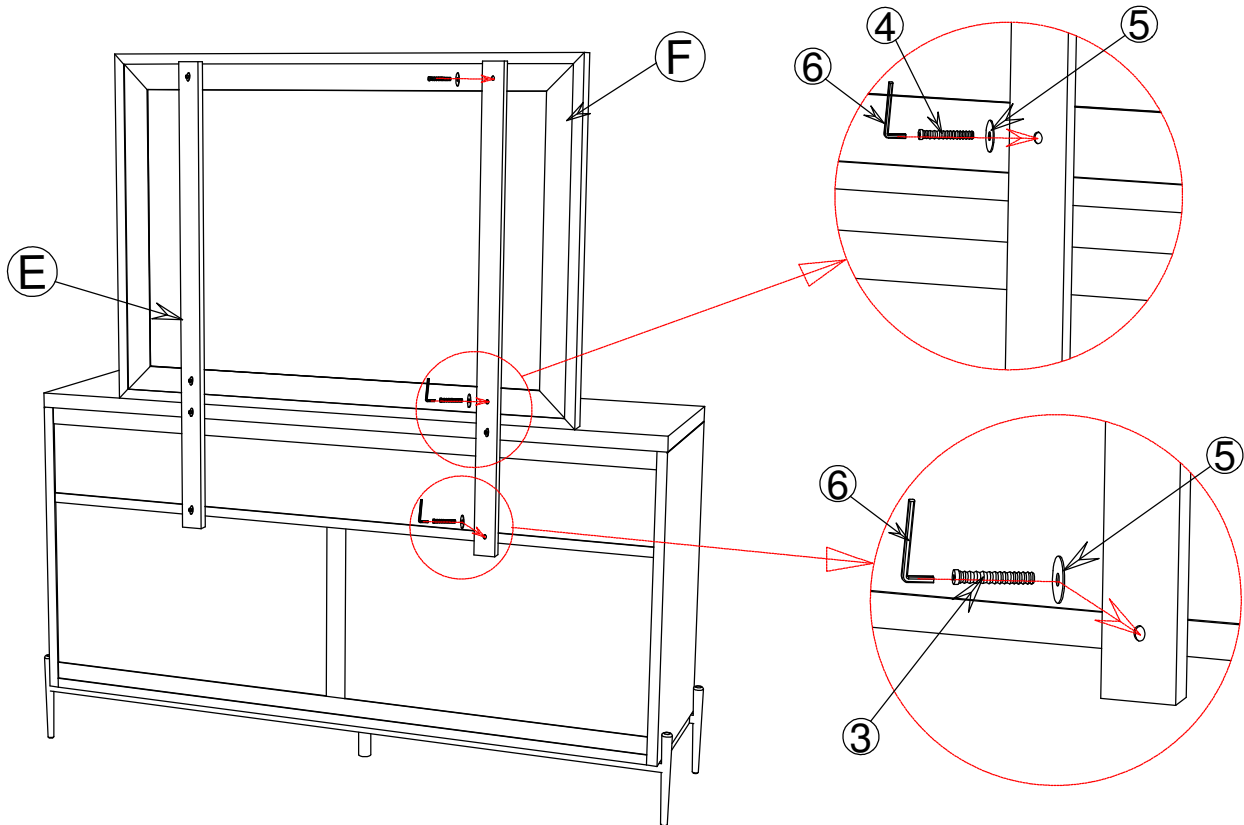

IF REQUIRED TO FIX THE MIRROR WITH CABINET :

Please align the holes of wooden support (E) and holes available at back of cabinet.

tighten it by using allen wrench (6) ,JCB bolt (3) & washer (5).

Align hole wooden support (E) and mirror (F) tighten it by using allen wrench (6) ,JCB bolt (4) & washer (5).