



New  
Classic<sup>®</sup>  
FURNITURE

## Assembly Instructions

ITEM NO. D1434-20  
SKYLINE DINING SIDE CHAIR  
(2 PER CARTON)

Thank you for purchasing this quality product. Be sure to check all packing materials carefully for small parts, which may have come loose inside the carton during shipment. Identify and count all items and compare with the parts list and/or hardware list shown below.

Caution : please read the instruction thoroughly before assembly.

1. We recommended that you assemble this product with the assistance of another person, this will make the assembly easier, and will help eliminate damage to the product or injury to persons during assembly.
2. Please do not tighten screws or bolt until the assembly is completed.
3. Please put all parts on a non-abrasive floor before assembly and follow the assembly steps to assemble your newly purchased product correctly and efficiently.

PARTS LIST			
NO.	DESCRIPTION	SKETCH	QTY
A	CHAIR BACK		2 pcs
B	SEAT		2 pcs
C	RIGHT SIDE FACING (RSF) FRONT LEG		2 pcs
D	LEFT SIDE FACING (LSF) FRONT LEG		2 pcs
E	STRETCHER		4 pcs

HARDWARE LIST			
NO.	DESCRIPTION	SKETCH	QTY
1	SMALL BOLT - M6 x 3/8"		4 pcs
2	MEDIUM BOLT - M6 x 2-3/8"		8 pcs
3	LARGE BOLT - M6 x 3-5/32"		8 pcs
4	SPRING WASHER M6		20 pcs
5	FLAT WASHER - M6 x 3/4"		20 pcs
6	PAN HEAD SCREW - M4 x 1-3/16"		8 pcs
7	ALLEN KEY - M4		1 pc

WEIGHT CAPACITY (PER CHAIR)

300 lbs

**STEP 1** : Assemble the Chair Back (A) to Seat (B) by using Allen Key (7) with hardware 1, 4, and 5.  
\*DO NOT TIGHTEN THE BOLTS

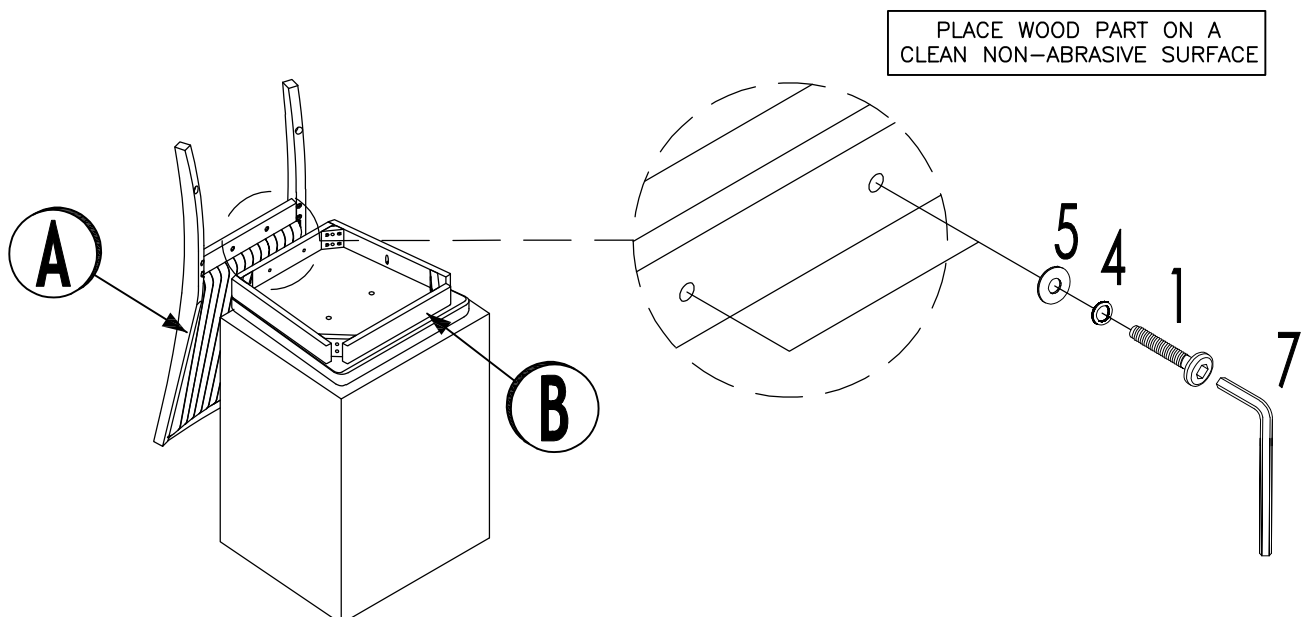



New  
Classic®  
FURNITURE

## Assembly Instructions

ITEM NO. D1434-20  
SKYLINE DINING SIDE CHAIR  
(2 PER CARTON)

**STEP 2** : Assemble the Chair Back (A) to Seat (B) by using Allen Key (7) with hardware 3, 4, and 5.  
\*DO NOT TIGHTEN THE BOLTS

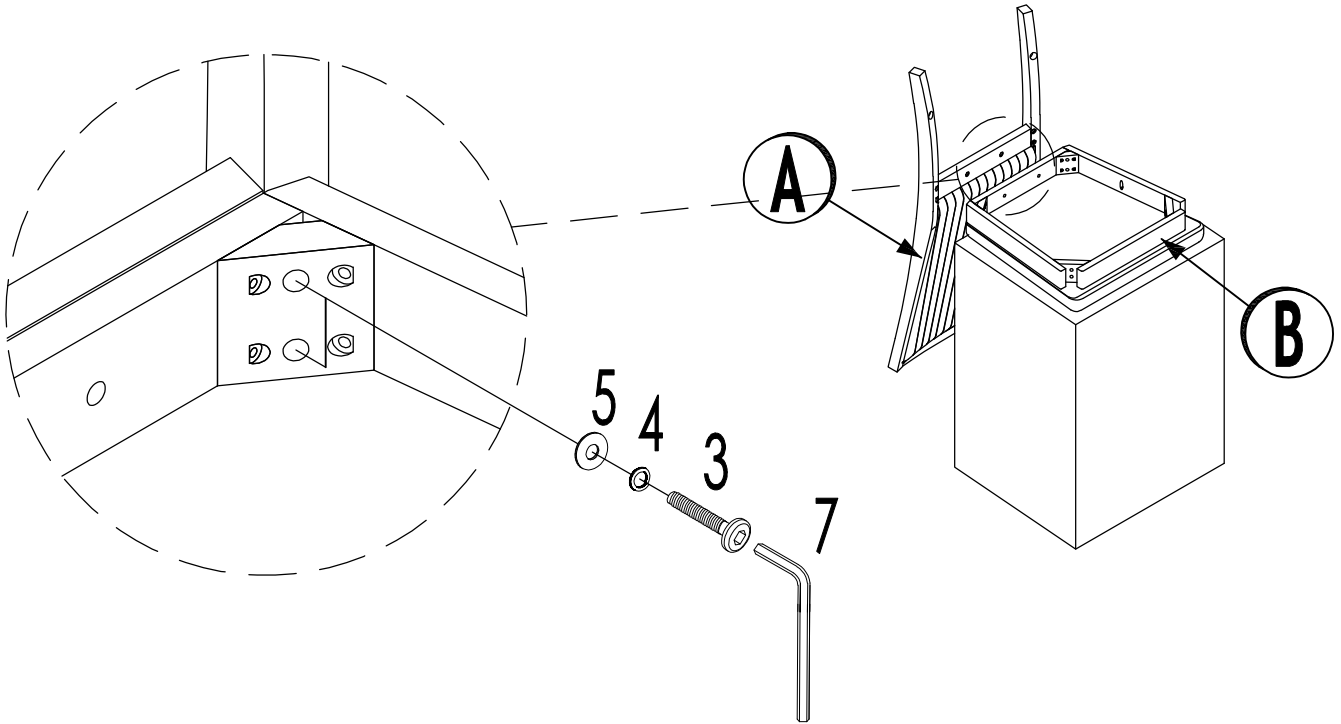

**STEP 3** : Place the stretchers (D) between the chair back (A) and front legs (C & D).  
Assemble the RSF and LSF front legs (C & D) by using the Allen Key (7) with hardware 2, 4, and 5.  
\*DO NOT TIGHTEN THE BOLTS.

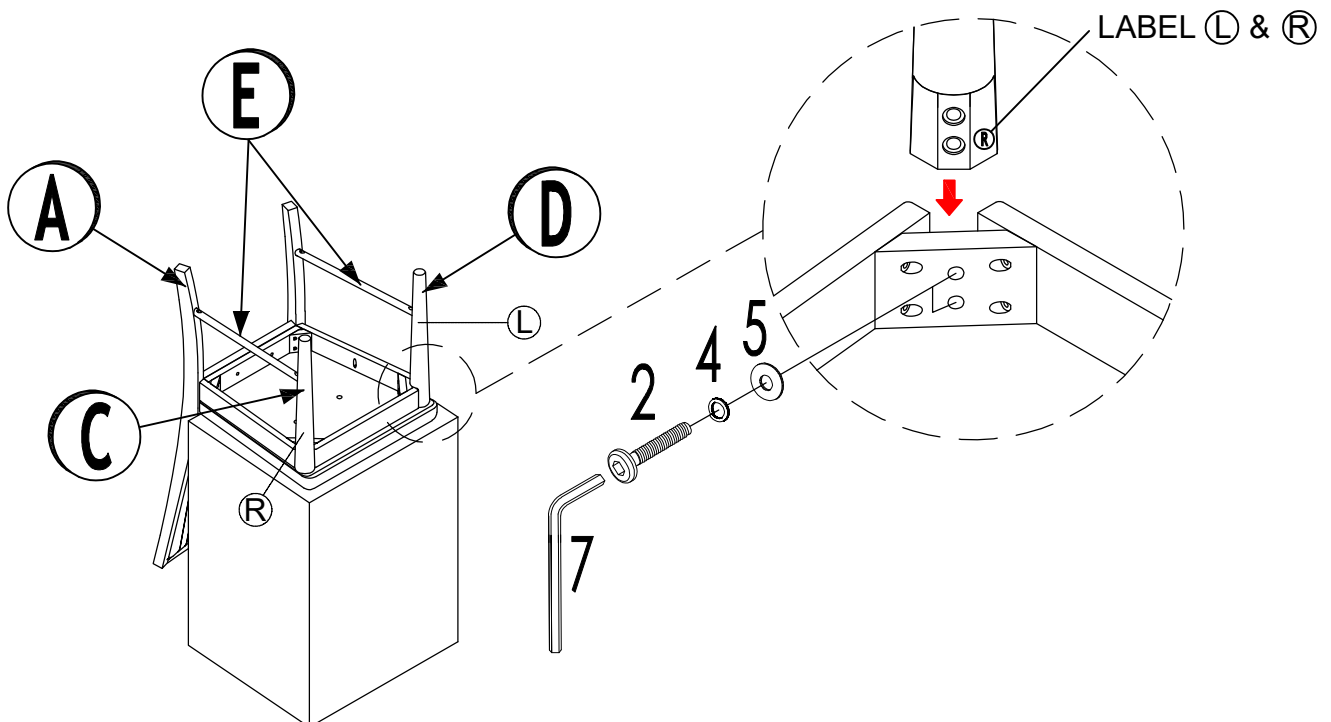



New  
Classic®  
FURNITURE

## Assembly Instructions

ITEM NO. D1434-20  
SKYLINE DINING SIDE CHAIR  
(2 PER CARTON)

**STEP 4** : Assemble the stretchers (D) to the chair back (A) and front legs (C & D) by using a screwdriver with hardware 6.

**\*DO NOT TIGHTEN THE BOLTS**

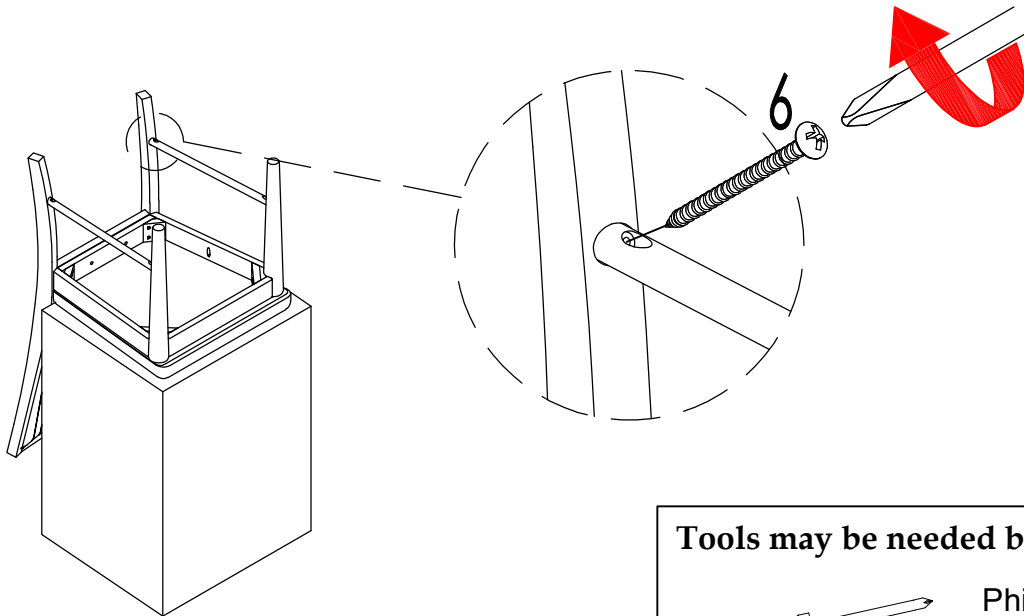

**Tools may be needed but not included**

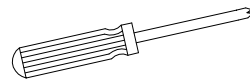

Phillips Head  
Screwdriver

**STEP 5** : To level the chair, stand the chair up on a flat surface and tighten all the bolts by using the Allen Key (7) and all the screws with a screwdriver.

