

ASSEMBLY INSTRUCTIONS



MODEL W843.2 - 10 PERSON MODIFIED DOME TENT W/ SCREEN PORCH

SAFETY WARNING - DOs AND DO NOTs

EVERYONE WHO USES THIS TENT SHOULD READ THIS MANUAL AND BECOME FAMILIAR WITH ALL SAFETY WARNINGS AND PRECAUTIONS FOR SAFE USE, ASSEMBLY, CARE, MAINTENANCE, AND STORAGE. KEEP THIS MANUAL SO YOU CAN REFER TO IT LATER.

!

DANGER CARBON MONOXIDE GAS WILL KILL YOU

Stoves, heaters, grills, lantern, candles, and other fuel-burning devices that burn propane, natural gas, charcoal, kerosene, coal, or other fuels produce a toxic gas called carbon monoxide. Because carbon monoxide gas is invisible, odorless, and colorless, a dangerous level of carbon monoxide gas can accumulate in a tent which cannot be detected by sight, smell, or taste. For these reasons:

- DO NOT use matches, lighters, stoves, heaters, grills, lanterns, candles, cooking equipment, or other fuel-burning devices inside or near a tent.
- DO NOT build fires inside or near a tent.
- DO NOT leave campfires unattended.

Your failure to follow this warning will cause death, serious injury, or permanent disability to you or others.

!

DANGER PROTECT YOUR CHILDREN

- DO NOT leave children unattended inside a tent or in camp.
- DO NOT allow children to assemble a tent.
- DO NOT allow children to enter or exit a tent except through the door.
- DO NOT allow children to remain in a closed-up tent on hot days.

Your failure to follow this warning will cause death, serious injury, or permanent disability to your children.

!

WARNING FLAMMABILITY WARNING KEEP ALL FLAME AND HEAT SOURCES AWAY FROM THIS TENT FABRIC

This tent is made with flame resistant fabric which meets CPAI-84 specification. IT IS NOT FIREPROOF. The fabric will burn if left in continuous contact with any flame source. The application of any foreign substance to the tent fabric may render the flame-resistant properties ineffective. Your failure to follow this warning will cause death, serious injury, or permanent disability to you or others.

CAMPING DO'S AND DON'TS

DO NOT...

1. Do not pitch tent near open fire.
2. Do not leave campfire unattended.
3. Do not leave children unattended inside a tent.
4. Do not use heating, lighting or cooking equipment with open flames in or near tents.
5. Do not use other than recommended water repellent compounds on your tent.
6. Do not spray the tent with insecticide.
7. Do not store tent on concrete floor.

DO...

1. Always extinguish campfire before leaving area.
2. Exercise care when using electricity and lighting in and near tents.
3. Make certain your tent is properly ventilated in all weather conditions. In extreme weather conditions, snow could obstruct airflow and cause asphyxiation unless cleared frequently.
4. Anchor your tent securely to provide additional security from changing climatic conditions. Snow pegs, skis and/or heavy rocks may be necessary to supplement tent stakes and guy cords.
5. Take your tent down and store properly after camping.

CARE

DO NOT LEAVE YOUR TENT SET UP IN DIRECT SUNLIGHT LONGER THAN NECESSARY. THE SUN'S ULTRAVIOLET (UV) LIGHT DEGRADES ALMOST EVERY FABRIC AND MATERIAL. IF LEFT IN SUNLIGHT FOR PROLONGED PERIODS OF TIME, FABRIC WILL FADE AND WEAKEN. DO NOT STORE TENT ON CONCRETE FLOOR. DO NOT SPRAY THE TENT WITH INSECTICIDE.

Your tent is water repellent, however, it is not waterproof. During heavy rain, some leakage may occur. Keep objects from touching the inside of the tent. Such objects may cause leakage at point of contact. If seam leakage occurs, it can be controlled by applying a seam sealer compound.

EXERCISE CARE WHEN USING ELECTRIC DEVICES IN AND NEAR TENTS.

Although our tents and screen houses are constructed to rigid specifications, periods of wind or rain soaking the ground may loosen the stakes and cause the uprights to sink into the ground. This will weaken the rigidity of the overall structure. Water pockets may also form in the roof if the unit is not assembled taut, possibly causing broken frames and torn fabric.

REPLACEMENT PARTS

If you have questions or need to order a part, call 1-800-325-4121 or send an email to contactus@wenzelco.com. Have your model number or part number ready when you call. DO NOT ORDER BY REFERENCE KEY NUMBER.

Send your request for parts to:
Exxel Outdoors, LLC.
1 International Ct.
Broomfield, CO 80021

KEY NO.	W843.2 - 10 PERSON MODIFIED DOME TENT W/ SCREEN PORCH		QTY REQ
	DESCRIPTION	PART NO.	
A	Main Pole	W843.2M	2
B	Side Pole	W843.2S	2
C	Screen Porch Pole	W843.2P	1
	Complete Frame	W843.2ST	1
	Replacement Fly	W843.2F	1
	Guy Rope	A1001	8
	Steel Stake	PIN STAKE	23

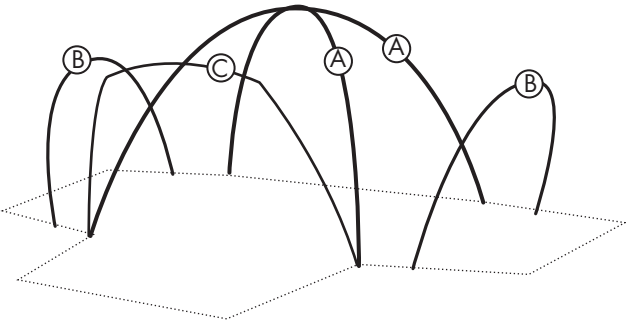

ASSEMBLY INSTRUCTIONS



OZARK TRAIL®
OUTDOOR EQUIPMENT

MODEL W843.2 - 10 PERSON MODIFIED DOME TENT W/ SCREEN PORCH

IMPORTANT: WE ADVISE YOU TO ASSEMBLE THE TENT ONCE BEFORE GOING CAMPING TO BECOME FAMILIAR WITH THE ASSEMBLY OF THE TENT. NOTE: PLEASE LOOK AT THE REPLACEMENT PARTS DIAGRAM TO SEE HOW YOUR FRAME IS ASSEMBLED.

TO PROLONG THE LIFE OF THE TENT FLOOR, SELECT A LEVEL, CLEAN AREA FOR THE CAMPSITE. TO PREVENT DAMAGE TO THE ZIPPER, UNZIP THE DOORS TO ALLOW AIR TO ENTER THE TENT.

TO IMPROVE THE WEATHER RESISTANCE OF YOUR TENT, IT IS ADVISABLE TO USE SEAM SEALER TO COAT ALL EXPOSED SEAMS. YOU SHOULD APPLY ONLY TO THE INSIDE SEAMS OF THE TENT AND UNDERSIDE OF THE TENT FLY. IF APPLIED TO THE OUTSIDE SEAMS, DISCOLORATION OF YOUR TENT MAY OCCUR. SEAM SEALER IS AVAILABLE IN THE CAMPING SECTION OF ANY LOCAL SPORTING GOODS STORE.

STEP 1: Spread tent out flat, floor side down.

STEP 2: Stake the tent to the ground by inserting stakes through the webbing loops at the side corners of the tent. Hammer the stakes into the ground at a 45° angle, making sure the tent floor is pulled out even and tight.

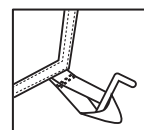

STEP 3: Extend fiberglass tent poles by pulling out each section and placing it into the metal ferrule connectors. You will have five poles. The two longest poles (A) are the main tent poles. The other pair of poles (B) will be used on the sides of the tent. The fifth pole (C) will be used for the front screen porch.

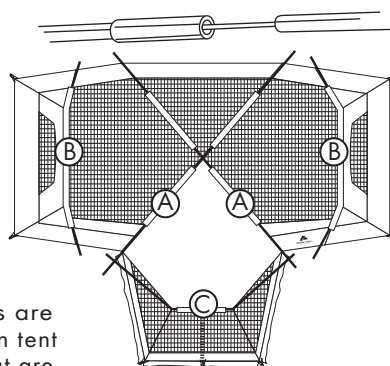

STEP 4: While making sure sleeves are in line with each other, slide the main tent poles (A) through the lime sleeves that are opposite each other on the roof of the tent. Be sure to put the poles through the loop at the center of the roof. Position poles so that they form an "X" across the tent.

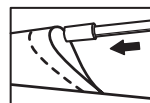

STEP 5: Starting at the back of the tent, insert the pole ends onto the pins located on the rings at the floor edge of the tent. You will find two pins at front location. One pin is for the main tent poles and the other is for the screen porch hoop poles.

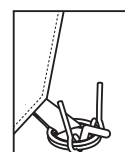
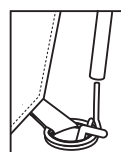

STEP 6: Go to the front of the tent and flex the main pole and place the pole end onto the pin on the ring at the base of the tent. Repeat for the second main tent pole. Clip plastic hooks to the frame.

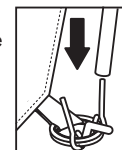

STEP 7: To assemble the side rooms, locate the side room poles (B). Insert one of the poles through the blue pole sleeve at the top of one of the side rooms. With an adult on each end of the side room pole, gently flex the pole into an arch and place the pole end onto the pin on the ring at the base of the tent. Repeat the same procedure for the remaining side room.

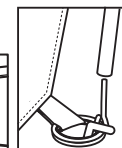

STEP 8: Slide the screen porch pole (C) through the lime sleeve at the front of the tent. Gently flex the pole and place the ends onto the pins located at the base of tent on the rings. Clip the plastic hooks to the pole.

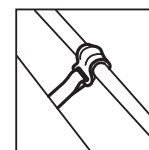

STEP 9: Pull out and stake the screen porch by inserting stakes through the loops at the front corners of the screen porch. Pull the porch out even and tight. Hammer the stakes into the ground at a 45° angle.

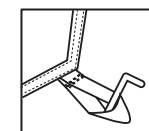

STEP 10: Finish staking down the tent by inserting stakes through the rings at the base of the tent and any intermediate stake loops.

Tent should appear as shown.

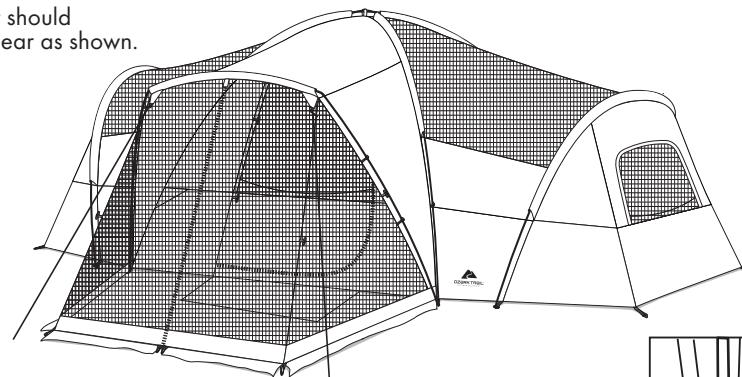

STEP 11: Unfold fly and place over tent so the large grey triangle is located over the screen room. Attach the fly to the tent by hooking the S-hooks located at each of the fly corners to the rings at the base of the tent.



⚠ WARNING: Elastic cords can snap back and hit your eye. To reduce the risk of injury to you and others:

- Keep your body and face clear.
- Do not over stretch elastic cords.
- Maintain firm grip on hook.
- Pull the hook toward you; if it slips it will spring away from you.
- Make sure hook is fully clipped to tent before releasing.
- Wear protective eyewear during tent assembly.

Your failure to follow this warning could cause serious injury or permanent disability.

STEP 12: Fasten the Velcro fasteners on the underside of the fly to the fiberglass poles at all locations.

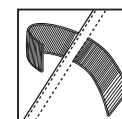

STEP 13: There are guy ropes located on the fly and front porch of the tent to provide additional stability. Extend the guy ropes on the fly and tent edges. Make a loop at opposite end of guy rope by using a slider (as shown) and place loop over stake. Adjust slider to make guy rope tight and stake to the ground.

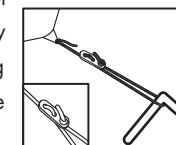

Tent should appear as shown.

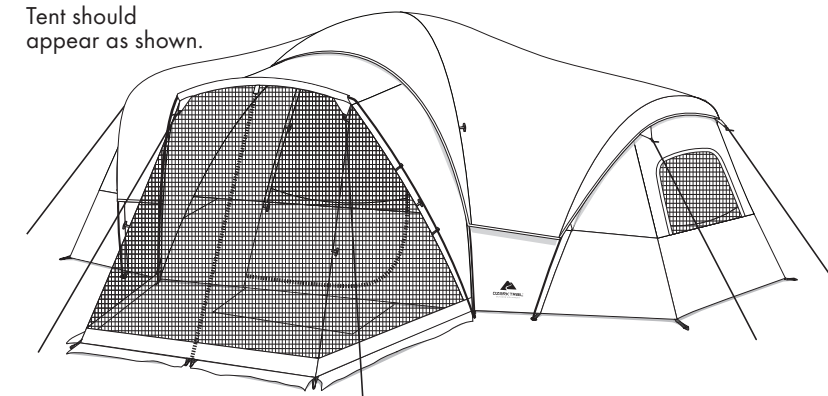

Your tent includes two divider curtains which can be attached to the inside ceiling and walls of your tent to divide it into 3 rooms.

NOTE: To take down tent, follow steps above in the reverse order. Be sure to leave doors and windows unzipped. **Make sure tent is clean and dry before storing.** Place stakes into stake bag and poles into pole bag, which are provided. The tent should be folded into equal parts toward the center of the tent to distribute the bulk. Fold fly and lay on top of tent. Start a small tight roll, the width of your carry bag, at the end opposite the doors. Roll tent around the pole bag toward doors to allow air to escape. Once rolled, tie a string or rope around tent to hold in place. Place tent and stake bag into carry bag.