

SAVANT

Input/Output Modules Quick Reference Guide

Savant Input/Output Modules are used in SmartMediaPro matrix switchers and controllers for audio and video processing. There are four types of modules. (See table below.) This guide provides general information for all modules.

Model Number Prefix	Description
AIM	Audio input module
AOM	Audio output module
VIM	Video input module
VOM	Video output module

Connections on the modules are differentiated by the silkscreen on the module faceplate:

Without Dots: Input module

With Dots: Output module

Combination With and Without Dots: Hybrid module containing both inputs and outputs.

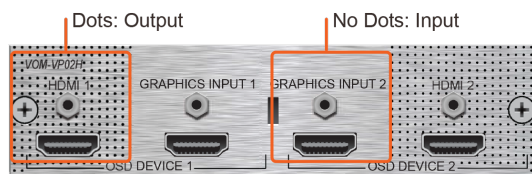

Box Contents

- (1) Input/Output Module
(AIM-xxxx-xx | AOM-xxxx-xx | VIM-xxxx-xx | VOM-xxxx-xx)
- (1) Quick Reference Guide (this document)

IMPORTANT! Module Installation Precautions

ELECTRIC DISCONNECT!

Power Off the controller by setting the power switch on the rear of the chassis to Off (O) and remove the power cord before inserting or removing any module from the SmartMediaPro chassis. Failure to do so may cause damage to the equipment.

IMPORTANT! Electrostatic Discharge (ESD) Warning:

Observe the following precautions to avoid damage from electrostatic discharge (ESD) when handling modules.

- Use an approved ESD wrist or ankle-grounding strap. Ensure the grounding strap makes good skin contact.
- Connect the clip end of the ground strap to a threaded grounding stud on the chassis.



- When returning a replaced module to Savant, place the module in the clamshell package in which it was originally shipped in or a static shielding bag.

NOTE:

The wrist strap only protects the component from ESD voltages on the body; ESD voltages on clothing can still cause damage.

Module Installation

Refer to [Module installation Precautions](#) above before installing module.

1. Power Off the SmartMediaPro Chassis using the power switch located on the rear of the chassis and disconnect the AC power cord.
2. Remove the two (2) M3 x 6 mm retaining screws. Set screws aside as they will be used later in procedure.
3. Align the module board with the two rails located at the bottom of the opening and gently slide the module all the way until a slight resistance is felt. This is where the connector on rear of the board gets seated into the chassis connector.
4. Gently press on the module the rest of the way until it seats into the connector at the rear of the slot and the plate seats against the chassis.
5. Insert the screws removed in step 2 and tighten.

Module Removal

Refer to [Module installation Precautions](#) above before removing module.

1. Power Off the SmartMediaPro Chassis using the power switch located on the rear of the chassis and disconnect the AC power cord.
2. Remove the two (2) M3 x 6 mm retaining screws. Set screws aside as they will be used later in procedure.
3. Insert the module removal tool (included with SmartMediaPro chassis) into the removal tool slot.

For Vertical Removal Slots: Face the notch in the tool downward and insert the tool into the slot in the module faceplate.

For Horizontal Removal Slots: Face the notch in the tool to the left or the right.

4. Hook the tool onto the faceplate.

For Vertical Removal Slots: Lower the tip of the tool downward and with slight outward pressure, pull the module outward. A slight resistance will be felt as the module is unseated from the chassis side of the connector.

For Horizontal Removal Slots: Move the tool to the left or the right and with slight outward pressure, pull the module outward. A slight resistance will be felt as the module is unseated from the chassis side of the connector.

Vertical Removal Slot

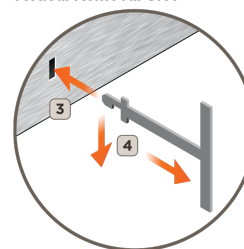

Horizontal Removal Slot

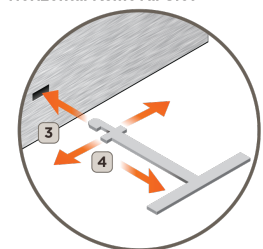

5. Slide module out until it is completely removed from chassis.
6. If the module is being replaced, refer to the [Module Installation](#) instructions for proper installation procedure.
7. If the module is not being replaced, install a blank plate using the two (2) M3 x 6 mm screws removed in step 2. This will ensure that proper airflow through the chassis is retained as well as preventing dust and debris from entering the chassis.