

Black Diamond 2 Door Reach-In Refrigerator, in Silver

USRF-2D



The Black Diamond 2 Door Reach-In Refrigerator is designed to provide essential refrigerated storage while maintaining easy accessibility in your commercial kitchen. This reach-in fridge is constructed of heavy-duty stainless steel both inside and out to withstand the demands of your commercial kitchen. The unit has two self-closing solid doors with recessed handles and 46.7 cubic feet of refrigerated storage. The solid doors help provide better insulation and energy efficiency. This commercial reach-in refrigerator has six shelves.

FEATURES AND CONSTRUCTION

- Constructed of heavy-duty stainless steel both inside and out
- 46.7 Cu. Ft. storage capacity
- 2 self-closing solid doors with recessed handles
- 6 removable plastic-coated wire shelves
- Front digital temperature controller with LED display
- Temperature range of 33° to 40° is ideal for preserving freshness
- Automatic defrosting
- Slide out bottom mounted self-contained refrigeration
- Removable door gasket
- Equipped with 4 casters for easy mobility

ELECTRIC

115V / 60Hz / 1Ph
Cord Length (Inches): 98.40"
Plug Type: NEMA 5-15P
Cord set included

NEMA 5-15P



3RD PARTY APPROVALS



STORAGE CAPACITY

- Cubic Feet: 46.7 Cu. Ft.

TEMPERATURE

- Holding Temperature (Fahrenheit): 33° - 40°

These models are designed to operate in an environment where temperature and humidity do not exceed 75°F (24°C) and 55% relative humidity

WARRANTY (USA / CANADA)

Two (2) Year Limited Warranty on Parts and Labor, Five (5) Year Warranty on Compressor and Evaporator

Contact us for details at 1.877.368.2797





Black Diamond 2 Door Reach-In Refrigerator

USRF-2D

FRONT

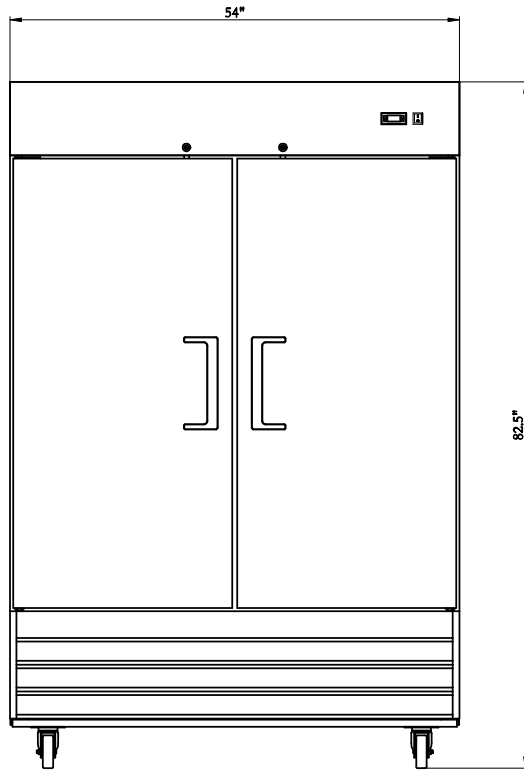

SIDE

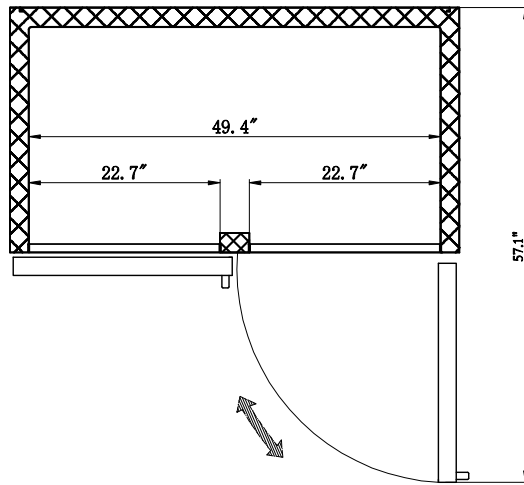
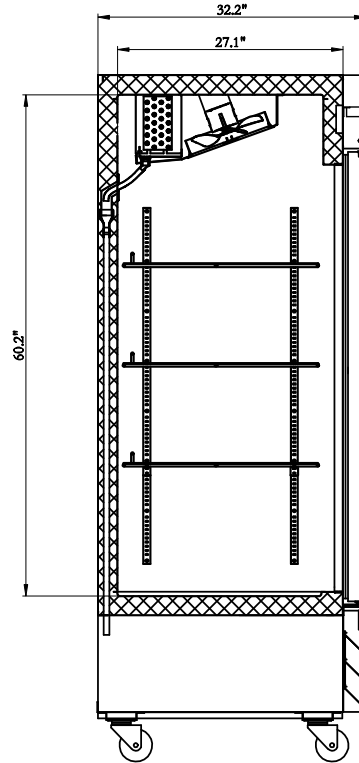

TOP

Reach-In

Doors	Shelves	Amps	HP	Refrigerant	Assembled Dimensions (in)	Item Weight (lbs)	Shipping Weight (lbs)
2	6	6.2A	1/4	R290 4.236	54.00" x 32.20" x 82.50"	446.6	530.0

Due to periodic changes in designs, methods, procedures, policies and regulations, the specifications contained in this document are subject to change without notice. While we exercise good faith efforts to provide information that is accurate, we are not responsible for errors or omissions in information provided or conclusions reached as a result of using the specifications. By using the information provided, the user assumes all risks in connection with such use.