

NOTE

- DO NOT connect low-voltage LED Neon Flexible Lighting to high-voltage power.
- Do not over tighten any screws
- Maintain polarity on all connections, +DC24V to Red and (-) to Black.
- Maximum 16.4 ft. of Neon Flexible Lighting can be connected together.
- For shorter lengths of Neon Flexible Lighting, cut with scissors at cut marks where a black dotted line is shown. **CUT AT DESIGNATED CUT LINES ONLY.**

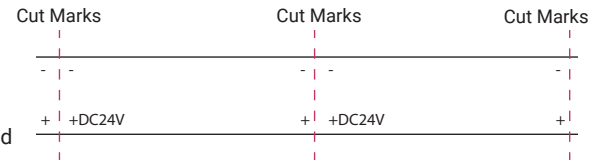

Tools Needed

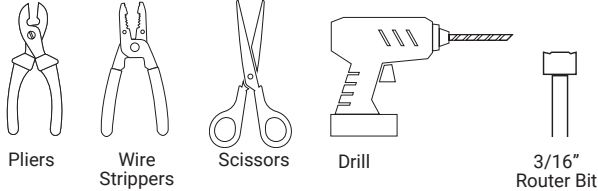

Product Legend



Cutting Neon Flexible Lighting

NOTE: it is recommended to use an End Cap at each connection point not being reconnected.

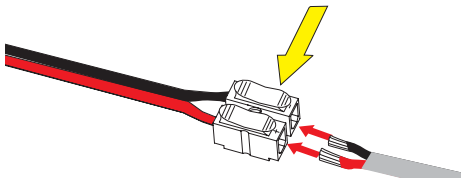

1. Unroll lighting off the reel and use a T-EZWC Push Connector to connect the starter wire to connection wire; match Red to Red and Black to Black to maintain polarity.

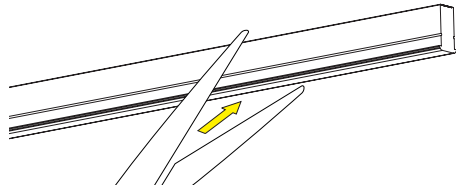

2. Cut lighting to desired length
NOTE: make sure to cut only at the designated cut marks. This product is NOT reconnectable.

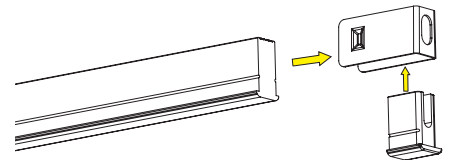

3. Insert clear silicone piece into white end cap and push Neon Flexible Lighting into white end cap.
NOTE: If recessing the lighting, pinch end cap slightly to press into routed groove.

Recess Mount Installation—Side Bend

NOTE: it is recommended to use an End Cap at each connection point not being reconnected.

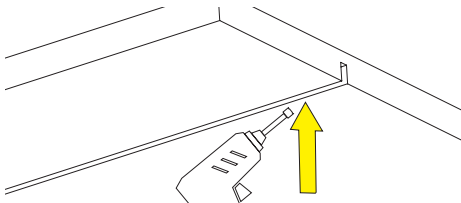

1. Route a groove 3/16" wide and approximately 3/8" deep for lighting to follow.

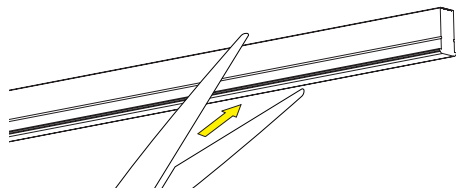

2. If cutting lighting, cut at any of the designated cut marks and use an end cap on the exposed end.

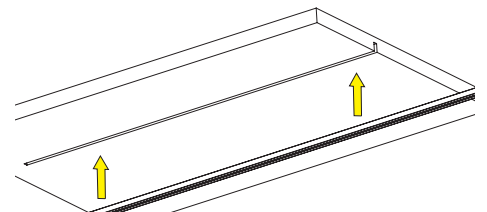

3. Run wire into groove for wire management. Press lighting into groove, making sure to not crease or twist lighting.

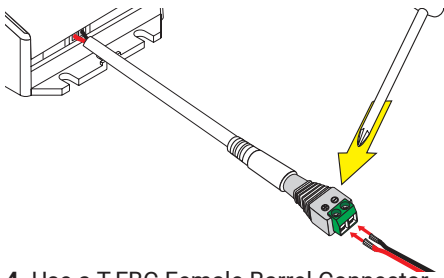

4. Use a T-FBC Female Barrel Connector to connect the starter wire to receiver or power supply; match Red to Red and Black to Black to maintain polarity.
NOTE: if not using T-FBC, connect wire directly into receiver or power supply

Using Loop Mounting Clips for Recessed Mount Installation

NOTE: it is recommended to use an End Cap at each connection point not being reconnected.

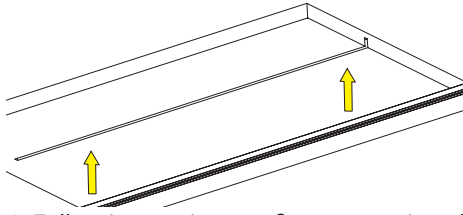

1. Follow instructions on first page to install lighting into routed channel.

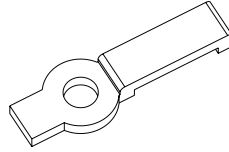

2. It is recommended to use a Loop Mounting Clip every 24"–36" to secure lighting

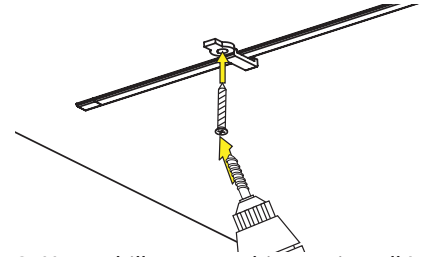

3. Use a drill or screwdriver to install Loop Mounting Clips in desired locations.

NOTE: make sure clip and screw do not pierce Neon Flexible Lighting.

Using Bottom Mounting Clips for Surface Mount Installation

NOTE: it is recommended to use an End Cap at each connection point not being reconnected.

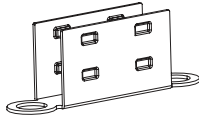

1. It is recommended to use a Bottom Mounting Clip every 24"–36" to secure lighting.

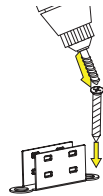

2. Use a drill or screwdriver to install Bottom Mounting Clips in desired locations

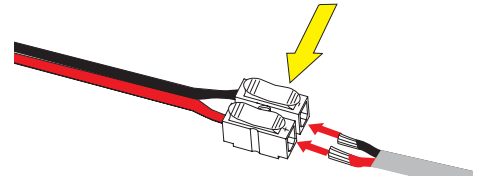

3. Unroll lighting off the reel and use a T-EZWC Push Connector to connect the starter wire to connection wire; match Red to Red and Black to Black to maintain polarity.

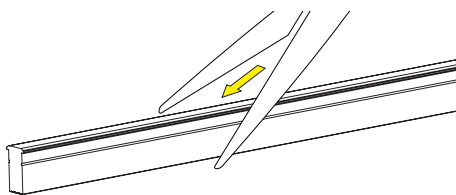

4. Cut lighting to desired length
NOTE: make sure to cut only at the designated cut marks. This product is NOT reconnectable.

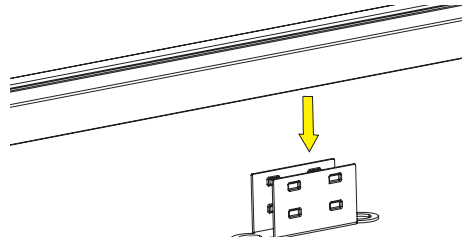

5. Press Neon Flexible Lighting into Bottom Mounting Clips for a secure installation.