

InfoSafe Mobile Drive Enclosure

External 3.5" USB 2.0+FireWire Drive Case

IDECASE35U2F

Instruction Manual



Actual product may vary from photo

InfoSafe

StarTech.com
The Professionals' Source for Hard-to-Find Computer Parts

FCC Compliance Statement

This equipment has been tested and found to comply with the limits for a Class B digital device, pursuant to part 15 of the FCC Rules. These limits are designed to provide reasonable protection against harmful interference in a residential installation. This equipment generates, uses and can radiate radio frequency energy and, if not installed and used in accordance with the instructions, may cause harmful interference to radio communications. However, there is no guarantee that interference will not occur in a particular installation. If this equipment does cause harmful interference to radio or television reception, which can be determined by turning the equipment off and on, the user is encouraged to try to correct the interference by one or more of the following measures:

- Reorient or relocate the receiving antenna.
- Increase the separation between the equipment and receiver.
- Connect the equipment into an outlet on a circuit different from that to which the receiver is connected.
- Consult the dealer or an experienced radio/TV technician for help.

Use of Trademarks, Registered Trademarks, and other Protected Names and Symbols

This manual may make reference to trademarks, registered trademarks, and other protected names and/or symbols of third-party companies not related in any way to StarTech.com. Where they occur these references are for illustrative purposes only and do not represent an endorsement of a product or service by StarTech.com, or an endorsement of the product(s) to which this manual applies by the third-party company in question. Regardless of any direct acknowledgement elsewhere in the body of this document, StarTech.com hereby acknowledges that all trademarks, registered trademarks, service marks, and other protected names and/or symbols contained in this manual and related documents are the property of their respective holders.

Table of Contents

Introduction	1
Features	1
Before You Begin	1
System Requirements	1
Contents	1
Installation	2
Installing a Hard Drive in the Enclosure	2
Installing Drivers (Windows 98SE)	3
Connecting the Enclosure to a Computer	3
Disconnecting the Enclosure from a Computer	4
Troubleshooting	4
Specifications	5
Technical Support	5
Warranty Information	5

Introduction

Thank you for purchasing a StarTech.com InfoSafe external hard drive enclosure. This product allows you to turn virtually any standard 3.5" desktop computer hard drive into a portable storage solution. Perfect for multimedia, digital imaging, audio, and other demanding applications, this product also offers the added dual connectivity of both FireWire as well as USB 2.0, with an IEEE 1394 port and USB 2.0 ports conveniently located on the back of the enclosure.

Features

- Supports almost any 3.5" form factor IDE hard drive
- Can be connected to host computer using USB 1.1 or USB 2.0
- Can be completely powered through your USB ports for ultimate portability
- Provides one FireWire connection, for impressive data transfer speeds

Before You Begin

System Requirements

- A computer with an available USB 1.1 or 2.0 port and/or FireWire 400 port
- An operating system that supports removable hard drives: Windows 98SE/ME/2000/XP, Mac OS 9.1 or higher (other operating systems may also support this product; consult your documentation for specific details)

Contents

This package should contain:

- 1 x IDECASE35U2F hard drive enclosure
- 1 x USB 2.0 data cable
- 1 x FireWire cable
- 1 x Installation CD
- 1 x Instruction Manual
- 1 x Protective cushioning kit
- 1 x Power adapter

Installation

Installing a Hard Drive in the Enclosure

Use caution when installing a hard drive in the enclosure. Excessive shock or force could damage the drive and/or the enclosure, resulting in data loss.

CAUTION: Always ensure that you are properly grounded when handling a hard drive or the enclosure tray, since electronic components can be damaged by static electricity. If an anti-static mat or similar product is not available, ground yourself by touching a computer case or other metal surface for several seconds before handling any components.

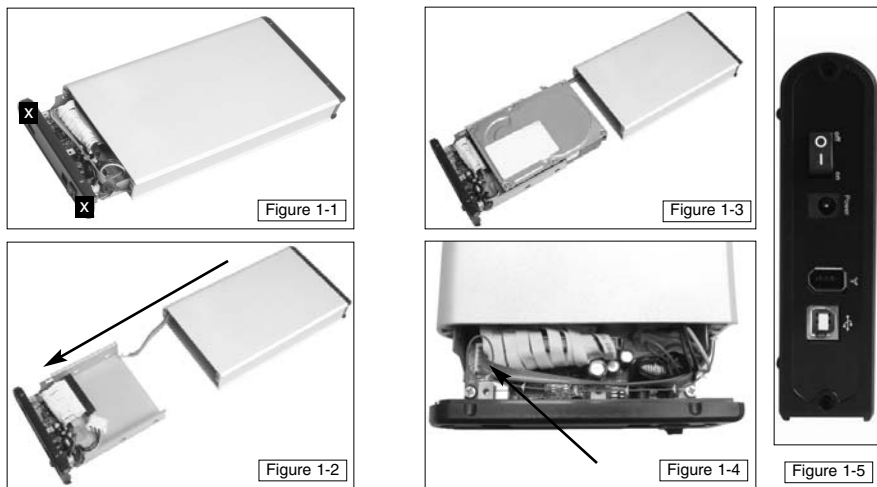

1. Using a small Phillips screwdriver, remove the screws holding the tray in the enclosure, marked with an "x" in the picture above. Use care when removing the screws, as they are extremely small. After you have removed them, place them in a safe location until you are ready to re-insert the tray into the enclosure.
2. Gently slide the tray out of the enclosure in the direction noted above. Insert the hard drive in the tray and line up the screw holes on the hard drive with the corresponding gaps in the tray.
3. Connect the IDE ribbon cable in the tray so that the red stripe faces pin 1 on the hard drive.
4. Connect the LP4-type power connector from the tray to the hard drive.
5. When you have finished connecting the drive to the tray, use standard desktop hard drive screws to secure the drive in the tray. The drive should be screwed snugly to the tray so it does not move.
6. Gently insert the tray into the enclosure, ensuring that the top of the tray matches the top of the enclosure and the rail on the tray fits into the corresponding groove in the enclosure.
7. Before completely inserting the tray in the enclosure, ensure that the cable that

connects to the LED indicator on the front of the enclosure is not pinched. Thread the cable through the back of the enclosure when the drive is three-quarters of the way inserted. Connect the LED to the connector on the tray. Ensure the cable sits below the rear of the enclosure after it is connected.

8. IDECASE35U2F includes two pieces of foam cushioning - one very thin cushion, and another thick cushion. Remove the backing from the thick cushion to expose the adhesive. Attach the thick cushion to the back of the drive. Once the foam has been properly applied, remove the backing from the thinner piece of protective foam, and apply it to the top (exposed portion) of the installed hard drive, so that it fits snugly between the hard drive and the exterior wall bearing the InfoSafe logo.
9. Slide the tray into the enclosure until the rear panel is flush with the enclosure.
10. Using the screws you removed in step 1, re-secure the tray inside the enclosure. The two screws should be tightened snugly.

Installing Drivers (Windows 98SE)

Windows ME/2000/XP/2003 Server and supported versions of Mac OS all support removable hard drives without additional software. Ensure you have the most current updates installed. **Please note:** Computers running Windows 98SE need to install support for USB removable mass storage devices before using the enclosure:

1. Plug the external enclosure into an available USB port on your computer.
2. The system will detect it and display the **Add New Hardware Wizard** dialog. Please click **Next**.
3. When given the option, please ensure that **Search for the best driver for your device (Recommended)** is selected, and click on **Next**.
4. At the next screen, you will be notified that **Windows will search for new drivers in its driver database...** . Please select **CD-ROM drive** and **Specify a location** and click on **Browse...** .
5. On the driver CD, please locate and select the file titled **Wd-pl2507-w98**, under the **PL2507** folder. Once this has been selected, and appears in the dropdown box, please click on **Next**.
6. The next screen will notify you that Windows will search for a driver for the device **USB Mass Storage Device**. Please ensure that the location Windows has specified for the file is correct, and click on **Next**.
7. The next screen will inform that **Windows has finished installing the software that your new hardware device requires**. Please click on **Finish** to complete installation.

Connecting the Enclosure to a Computer

This product has been tested with Windows 98/98SE, ME, 2000, XP, and Mac OS 9.1 and up. Other operating systems may also support this device; consult your documentation or a computer service professional for details on whether this product will work with your operating system and configuration. When used with the Windows operating systems noted above, the drive enclosure is "hot-swappable" which means the

drive can be connected and disconnected while the computer is running and will be immediately accessible to the user like any other hard drive.

1. Place the enclosure near the computer you wish to use.
2. Using the provided USB 2.0 data cable or the included FireWire cable, connect one end to the USB or FireWire port on the rear panel of the drive enclosure as appropriate. Connect the opposite end of the cable to the corresponding port on the back of the computer or a powered USB hub. The LED indicator on the rear panel of the enclosure should light to indicate power.
3. Connect the power adapter (provided) to the port marked **Power** on the rear panel of the enclosure. Move the power switch to the on (I) position.
5. The drive should be ready to use and will be visible under **My Computer** (Windows) or on the desktop (Mac OS).

Disconnecting the Enclosure from a Computer

1. Ensure that any programs that have accessed the drive are closed.
2. You may wish to use your operating system's "safe removal" feature to be absolutely sure that no data is being written to or read from the hard drive in the enclosure when you disconnect it from the computer. In Windows, you can click the Safe Remove icon (see above) and choose the enclosure from the menu. In Mac OS, you can drag the icon for the drive to the trash to "eject" it and stop it safely.
3. You can now safely remove the USB 2.0/FireWire data cable from the enclosure.

Troubleshooting

My computer does not recognize the hard drive or the enclosure.

Ensure that all necessary drivers have been installed. If you are using Windows 98SE, follow the driver installation instructions so that Windows can recognize a removable hard drive. Also, ensure that the drivers for your USB controller have been properly installed. If necessary, use the USB power cable for additional power or attach an external power adapter to ensure the enclosure and hard drive are receiving enough power.

My computer recognizes the hard drive, but I cannot read any of the files.

Depending on your operating system, you may need to format or partition the hard drive to make the drive and its data available to the operating system. If you will be using the hard drive on computers with different operating systems, try using a common file system like FAT32 to partition and format the drive. Some file systems, like the NTFS file system available in Windows 2000 and XP are not backwards compatible with older versions of Windows and other operating systems. For more information on partitioning and formatting hard drives, consult the documentation for your operating system.

Specifications

Bus Type	USB
Form Factor	3.5 inch Drive Enclosure
Connectors	1 X USB Type B Male 1 X FireWire Male
Power Adapter	12VDC, 1.5A Type M Connectors
Cables	1 X USB Type B to Type A 1 X FireWire 6 Pin to 6 Pin
Maximum Data Transfer Rate	USB 480Mbps FireWire 400Mbps
Chipset	ACTRANS - AC39LV512
OS Support	98SE, ME, 2000, XP & MAC 9.1 or higher

Technical Support

StarTech.com's lifetime technical support is an integral part of our commitment to provide industry-leading solutions. If you ever need help with your product, visit www.startech.com/support and access our comprehensive selection of online tools, documentation, and downloads.

Warranty Information

This product is backed by a one-year warranty. In addition, StarTech.com warrants its products against defects in materials and workmanship for the periods noted, following the initial date of purchase. During this period, the products may be returned for repair, or replacement with equivalent products at our discretion. The warranty covers parts and labor costs only. StarTech.com does not warrant its products from defects or damages arising from misuse, abuse, alteration, or normal wear and tear.

Limitation of Liability

In no event shall the liability of StarTech.com Ltd. and StarTech.com USA LLP (or their officers, directors, employees or agents) for any damages (whether direct or indirect, special, punitive, incidental, consequential, or otherwise), loss of profits, loss of business, or any pecuniary loss, arising out of or related to the use of the product exceed the actual price paid for the product.

Some states do not allow the exclusion or limitation of incidental or consequential damages. If such laws apply, the limitations or exclusions contained in this statement may not apply to you.

About StarTech.com

StarTech.com is “The Professionals’ Source for Hard-to-Find Computer Parts”. Since 1985, we have been providing IT professionals with the quality products they need to complete their solutions. We offer an unmatched selection of computer parts, cables, server management solutions and A/V products and serve a worldwide market through our locations in the United States, Canada, the United Kingdom and Taiwan.

Visit www.startech.com for complete information about all our products and to access exclusive interactive tools such as the Parts Finder and the KVM Reference Guide. StarTech.com makes it easy to complete almost any IT solution. Find out for yourself why our products lead the industry in performance, support, and value.