

Complementary Commercial Allied

590-PLGHDF

061203A
Vandal Resistant Laminar Outlet
with Wrench
0.5 GPM (1.9 L/min)

060638A - Optional
Vandal Resistant Laminar Outlet
with Antimicrobial by Agion®
1.5 GPM (5.7 L/min)

060640A - Optional
Vandal Resistant Flow Control
Aerator and Wrench
1.5 GPM (5.7 L/min)

060642A - Optional
Flow Control Aerator
with Wrench
1.5 GPM (5.7 L/min)

RP31704 - Optional
Vandal Resistant Spray Outlet
with Wrench
0.5 GPM (1.9 L/min)

060566A - Optional
Vandal Resistant Spray Outlet
with Wrench
1.0 GPM (3.8 L/min)

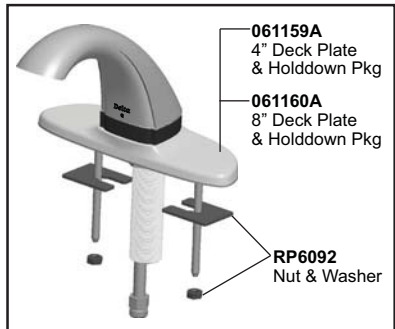
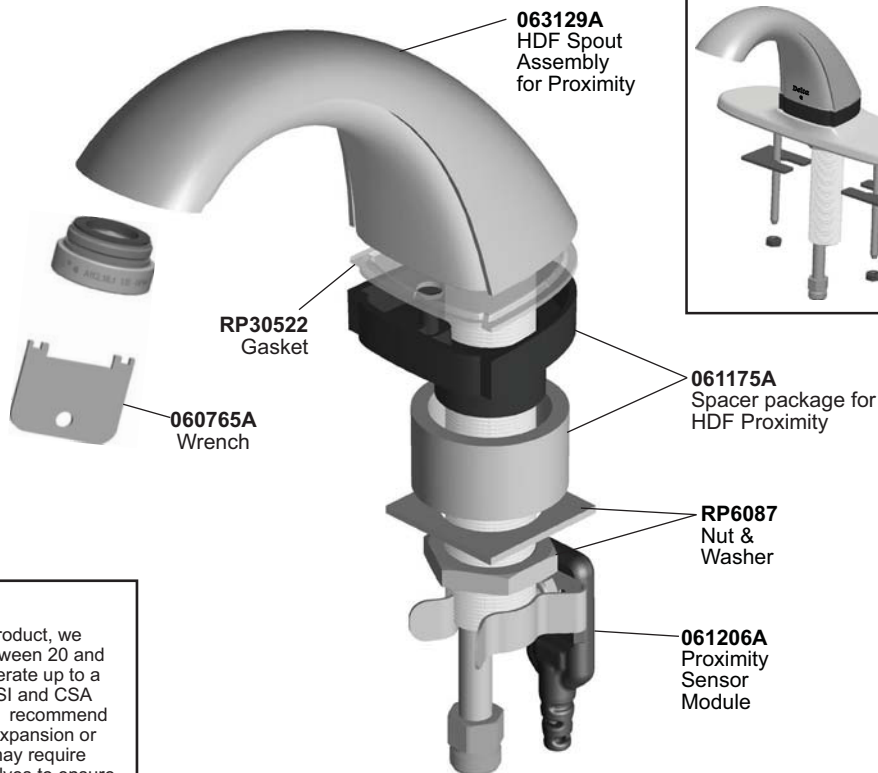

NOTES:
For optimum performance of this product, we recommend a system pressure between 20 and 80 PSI static. This product will operate up to a maximum of 125 PSI static per ANSI and CSA requirements. However, we do not recommend pressure above 80 PSI. Thermal expansion or leaking pressure reducing valves may require use of expansion tanks or relief valves to ensure your system never exceeds its maximum intended pressure setting.
Designed for routine 180°F (82°C) disinfection cycles up to 10 minutes.
Hardwire Proximity models not for use on enamel covered metal sinks.

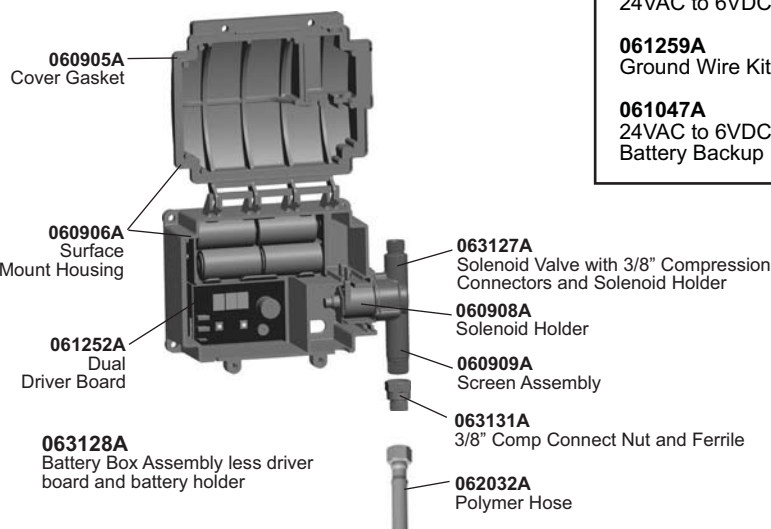

060683A
24VAC to 6VDC Converter
061259A
Ground Wire Kit (for hardwire models)
061047A
24VAC to 6VDC Converter with
Battery Backup

OPTION LIST	
	060681A Battery Holder
TRANSFORMERS	
060704A	Transformer 110 to 24 VAC 20VA up to 5 Electronic Valves
060771A	Transformer 110 to 24 VAC 40VA up to 10 Electronic Valves
060772A	Transformer 110 to 24 VAC 100VA up to 25 Electronic Valves
DECK PLATES	
061159A	4" Deck Plate & Holddown Pkg.
061160A	8" Deck Plate & Holddown Pkg.