

REVISIONS				
ECN	REV.	DESCRIPTION	DATE	APPROVED
	A	RELEASE FOR PRODUCTION	02-16-24	

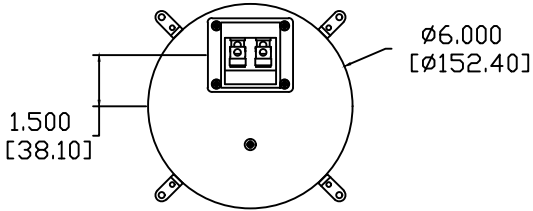

NOTES:

- 1: MATERIAL – 5052 ALUMINUM
UNLESS OTHERWISE SPECIFIED
- 2: FINISH – STUDIO BLACK POWDER COAT
UNLESS OTHERWISE SPECIFIED
- 3: DESIGNED TO BE USED WITH SA853QT-6-ENC (DWR# 240216-S2A)
- 4: BACKWARDS COMPATIBLE WITH FIRST GENERATION SA853Q-6-ENC (DWR# 220519-S2B)

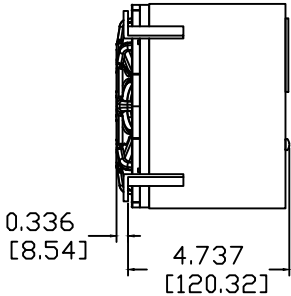
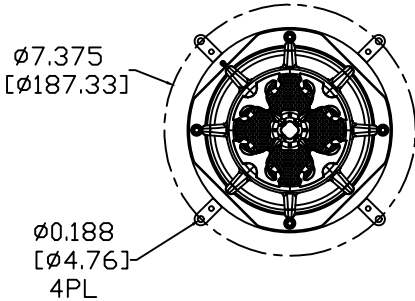
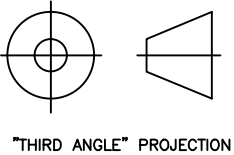

"THIRD ANGLE" PROJECTION

PROPRIETARY INFORMATION THE DESIGNS, INFORMATION, AND DATA CONTAINED HEREIN ARE PROPRIETARY AND ARE SUBMITTED IN CONFIDENCE, AND SHALL NOT BE DISCLOSED, USED OR DUPLICATED IN WHOLE OR IN PART, FOR ANY PURPOSES WHATSOEVER, WITHOUT THE PRIOR WRITTEN PERMISSION OF JAMES LOUDSPEAKER LLC, 2185 PARK PL, MINDEN, NV 89423. THIS LEGEND SHALL BE MARKED ON ANY REPRODUCTIONS HEREOF IN WHOLE OR IN PART. RECEIPT OF THIS DOCUMENT SHALL BE DEEMED TO BE AN ACCEPTANCE OF THE CONDITIONS SPECIFIED HEREIN.	JAMES LOUDSPEAKER	
	SA853QT-6	
	MODULE EXTERNAL DIMENSIONS	
	P/N: SA853QT-6-MOD	
	DWR #: 240216-S101	
	REVISED BY:	
	DRAWN BY: S. LOESCH	
	DATE: 02-16-24	
	APPROVED:	
	DRAFTING APPROVED:	
	SCALE:	
	TOLERANCES: ANG: ± = .5° FRACT. ± = 1/32	
	DECIMALS: .XX ± = .01 .XXX ± = .005	
	REVISION: A	SHEET 1 OF 3