

## USE58 Slide Kit Undermount Slide Installation Instructions

### IMPORTANT:

Before you begin, make sure you familiarize yourself with all the parts and fully read the instructions.

### CUSTOMER SERVICE:

Toll-free customer help line available weekdays between 7:00am and 6:00pm Central Time at 800-463-0660.

### TOOLS NECESSARY:

Screw gun and drill bits. NOTE: If screw gun has a clutch, set to lowest setting so as not to over tighten and/or strip screws during installation.

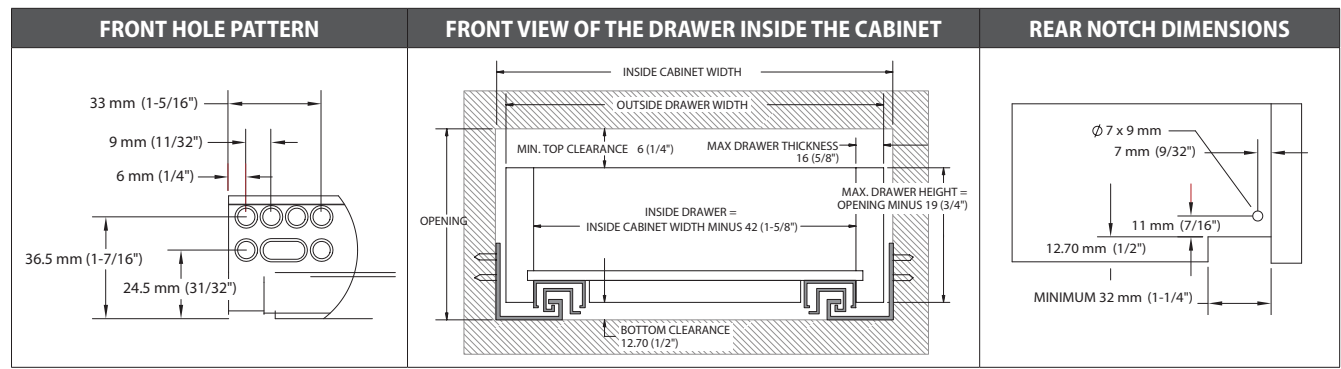

USE58 SLIDE KIT DRAWER BOX MINIMUM WIDTH (VARIES BY CLIP)

	USE58-CLIP-2W	USE58-CLIP-4W
<b>5/8" (16 mm) material</b>	5.50"	9.0625" (9-1/6")
<b>1/2" (13 mm) material</b>	5.25"	8.8125" (8-13/16")

INSIDE CABINET DEPTH

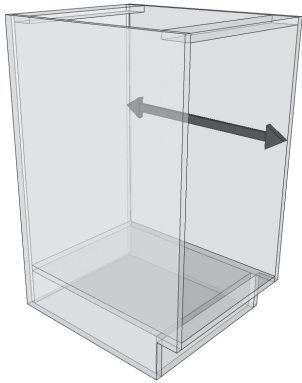

INSIDE CABINET WIDTH

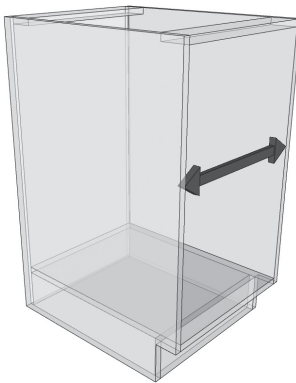

### Verify drawer box is correct width

- Determine Drawer Side Thickness
- Drawer box width = Inside Cabinet Width minus proper Inside Cabinet Width Deduction (**See chart below**)
  - For 5/8" drawer box material, subtract 3/8" from inside cabinet width.
  - For 1/2" drawer box material, subtract 5/8" from inside cabinet width.
- Example: A drawer box made of 5/8" material would measure 14-5/8" for an inside cabinet width of 15".

DRAWER DEPTH

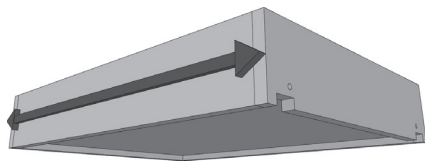

DRAWER WIDTH

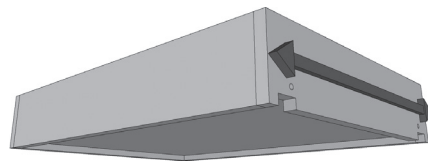

DRAWER HEIGHT

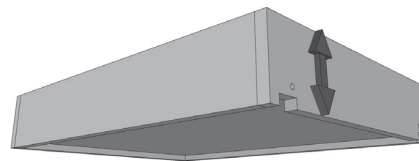

MAXIMUM DRAWER HEIGHT =  
OPENING MINUS 19 MM (3/4")

OUTSIDE DRAWER WIDTH CALCULATIONS

Drawer Side Thickness	Inside Cabinet Width Deduction
<b>5/8" (16 mm)</b>	<b>3/8" (10 mm)</b>
19/32" (15 mm)	15/32" (12 mm)
9/16" (14 mm)	9/16" (14 mm)
<b>1/2" (13 mm)</b>	<b>5/8" (16 mm)</b>
15/32" (12 mm)	23/32" (18 mm)

### Verify drawer front is square

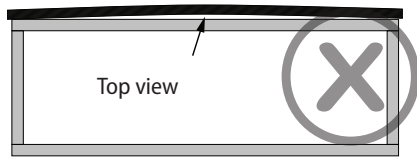
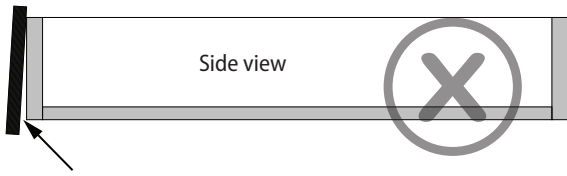

### Install slide release clips



Attach front screws at a 15°-25° angle. Angles above 25° may not allow the clip to sit on the bottom of the drawer box.

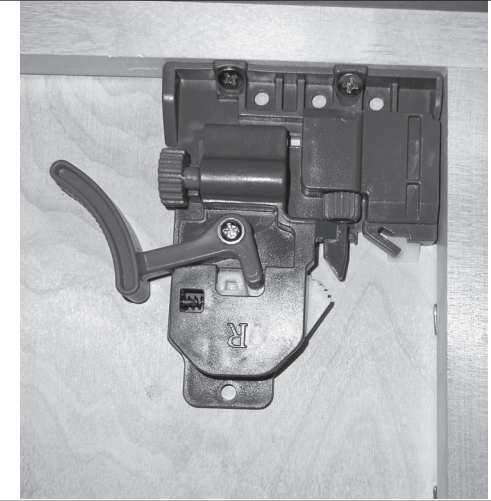

If attaching the clip to the bottom of the drawer box, ensure you are using a 1/2" drawer bottom.

### Measure and mark for slide placement

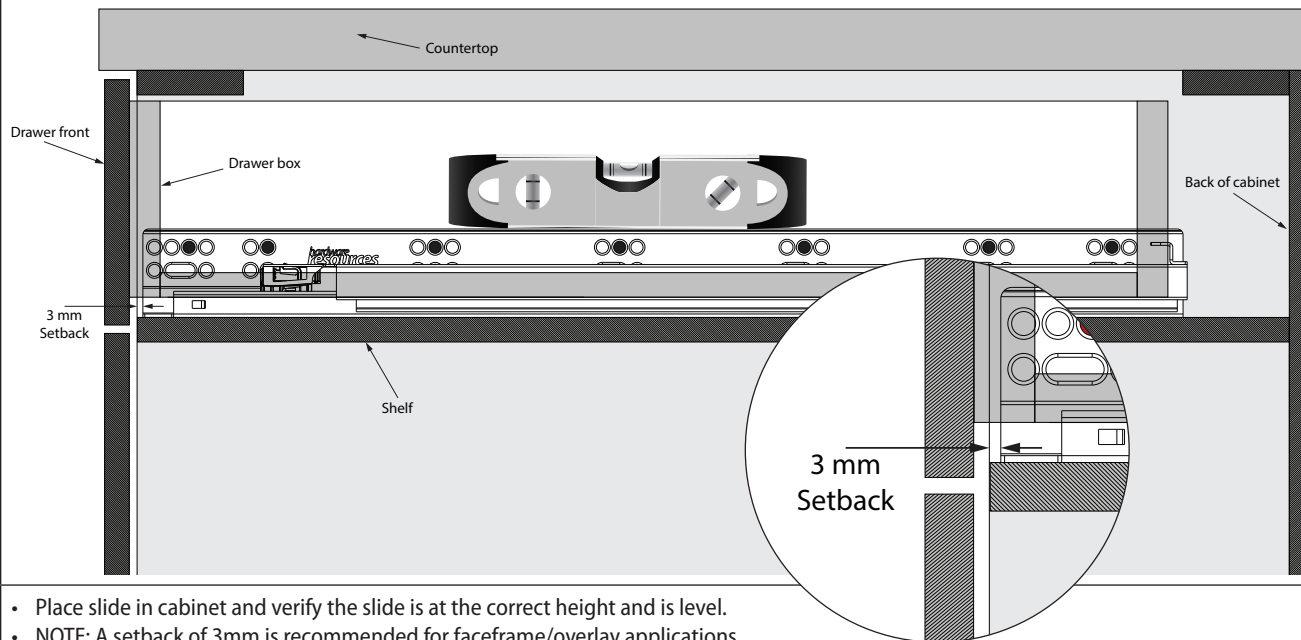

- Place slide in cabinet and verify the slide is at the correct height and is level.
- NOTE: A setback of 3mm is recommended for faceframe/overlay applications.
- Mark holes for predrilling. Remove slide while drilling holes to prevent wood chips from getting on the slide.
- Install slides with recommended #6 x 5/8" pan head screws.

\* Not compatible with drawer bumpers

### Insert and lock drawer box

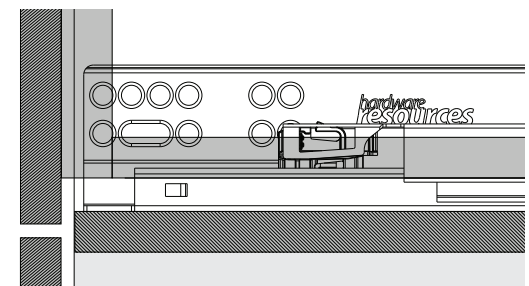
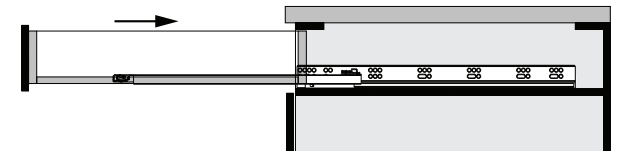
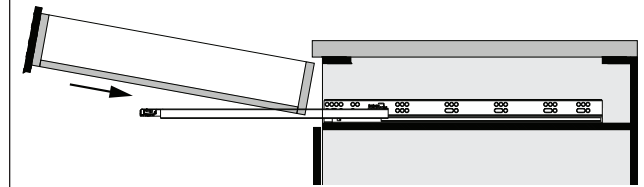

- Insert the drawer box until release clips lock in.