



ResMed

AirFit™ N30i

A more natural mask experience

ResMed AirFit™ N30i features a top-of-head tube design and nasal cradle cushion with ResMed QuietAir™ diffused venting technology that allows patients the freedom to sleep comfortably and quietly in the position of their choice. The SpringFit frame is designed to adapt to each patient's face; having only two frame sizes helps streamline fitting time and SKU management.



[ResMed.com/AirFitN30i](https://www.ResMed.com/AirFitN30i)

AirFit N30i highlights

Quick-release elbow

allows for easy disconnection. The pinch-clip elbow stays attached to the tubing to ensure parts do not get stuck or lost.

SpringFit frame

automatically adjusts to different facial profiles, helping provide an accurate fit the first time.

Top-of-head design gives patients the freedom to sleep in any position and closer to their bed partner.

Soft sleeves designed for added comfort and reduction in facial marks.

NEW Curved cradle cushion with softer silicone chassis allows the cushion to flex and adapt as users switch sleep positions. It's also interchangeable with AirFit P30i nasal pillows cushion.

QuietAir diffused venting technology breaks up exhaled air for an experience that is 57% quieter than the original design.^{1,2}

AirFit N30i product codes

Complete mask systems (frame system, headgear and 2 more cushion sizes)	Product code
AirFit N30i STPK AMER - STD	63800
AirFit N30i STPK AMER - SML	63801
AirFit N30i Sleep Lab Mask STPK - STD	63821
AirFit N30i Sleep Lab Mask STPK - SML	63822
Frame systems (includes frame, cushion and elbow)	
AirFit N30i STD Frame Sys - S	63802
AirFit N30i SML Frame Sys - S	63803
AirFit N30i STD Frame Sys - M	63804
AirFit N30i SML Frame Sys - M	63805
AirFit N30i STD Frame Sys - W	63806
AirFit N30i SML Frame Sys - W	63807
AirFit N30i STD Frame Sys - SW	63808
AirFit N30i SML Frame Sys - SW	63809

Accessories	Product code
AirFit N30i Cushion - SW	63810
AirFit N30i Cushion - M	63811
AirFit N30i Cushion - W	63812
AirFit N30i Cushion - S	63813
AirFit 30i Headgear	63814

Nearly three-quarters of current N30i mask users who tried the redesigned AirFit N30i cushion preferred it to the original cushion design, in a recent study. Cushion comfort was the top reason for preferring the new design to the original.³

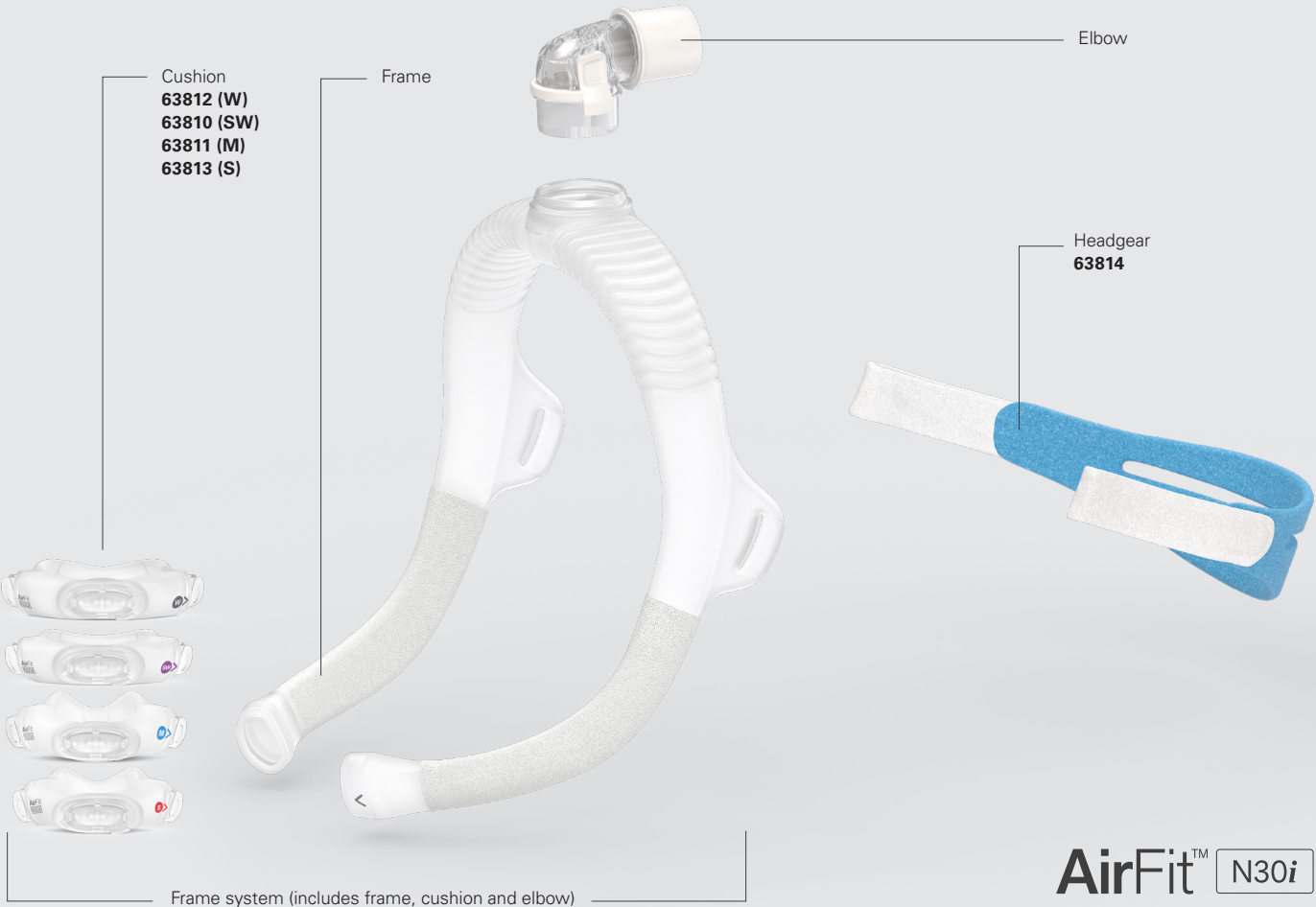

AirFit™ N30i
Nasal cradle mask



Fitting guide for AirFit N30i



- 1 Pull the frame and headgear over the head until the elbow is positioned on top and the headgear is behind the head.



- 2 Place the cushion under the nose.



- 3 Tighten or loosen the headgear until the cushion fits comfortably under the nose.



- 4 Squeeze the side buttons on the elbow and detach from the frame.



- 5 Connect the air tubing from the device to the elbow.



- 6 Reattach the elbow to the frame. The mask is now ready to use.



Additional options

For patients with longer hair, we recommend feeding their hair through the back of the headgear. If tied in a ponytail, it should sit high enough to fit comfortably through the back of the headgear.

Refer to the user guide for further instructions and complete labeling information including indications, contraindications, warnings and precautions.

1 ResMed AirFit N30i (redesigned cushion) user guide, Jan. 2021.

2 ResMed AirFit N30i (original cushion design) user guide, Feb. 2020.

3 ResMed external controlled take-home study of 236 evaluable current AirFit N30i mask users across the US from May 20 – June 3, 2020. 115 participants trialed and evaluated the redesigned AirFit N30i cushion while 121 participants trialed and evaluated the original cushion design at home for 2 weeks. Participants rated criteria for AirFit N30i on a Likert Scale of 1-5.

Distributed by ResMed Corp, 9001 Spectrum Center Boulevard, San Diego, CA 92123 USA (858) 836 5000 or (800) 424 0737 (toll-free). See ResMed.com for other ResMed locations worldwide. AirFit and QuietAir are trademarks and/or registered trademarks of the ResMed family of companies. Specifications may change without notice. For patent and other intellectual property information, see ResMed.com/ip. © 2021 ResMed. 10110761/4 2021-2