

3M Clean Sanding Filter Bag

Technical Data Sheet

Part Number: PN 20452 – Large
PN 28364 – Extra Large

3M I.D. Number: 60-4402-3628-3 - Large
60-4402-3666-3 – Extra Large

UPC Number: 051141-20452 - Large
051141-28364 – Extra Large

Description:

The 3M™ Clean Sanding Filter Bags are designed for use with 3M self-generated vacuum (SGV) Random Orbital Sanders (ROS) and the 3M Clean Sanding abrasive discs.

Efficiency:

This Filter Bag design meets **HEPA** (High Efficiency Particulate Air) filter requirements (collects an average of 99.97% or higher of .3 micron and larger particles). The Filter Bags are tested at 22 CFM of air flow which is the air flow of the 3M SGV ROS. 3M can not guarantee HEPA performance if used on non 3M SGV ROS and 3M Clean Sanding abrasive discs.

A Declaration of Conformance (DoC) is available upon request. Send e-mail to:

elmanor@mmm.com for a pdf of the DoC.

The use of a dust particle respirator is still recommended. The Filter Bag will only collect the dust that goes into the bag.

Application:

For best results, the 3M Clean Sanding Filter Bag is intended to be attached directly to the exhaust outlet of the 3M SGV ROS sanding tool or with a vacuum hose into a backpack (see diagram and picture below). The tool is intended to be used in conjunction with 3M Clean Sanding abrasive discs and the associated 3M back-up or interface pads.

3M Clean Sanding Filter Bags are not intended for use with non-SGV sanding tools, or tools which connect to central vacuum dust handling systems.

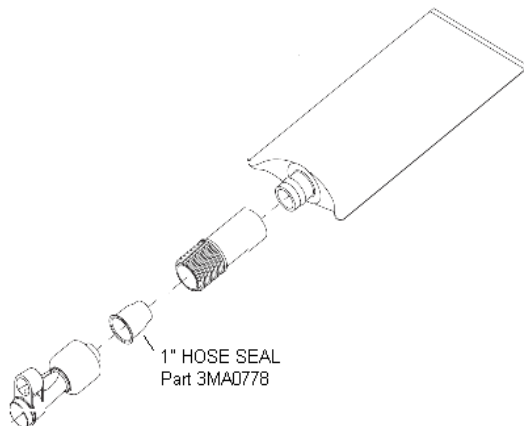

Connecting and Removing the Clean Sanding Filter Bag:

To connect the Clean Sanding Filter Bag, grasp the bag around the black inlet nozzle flange, making sure to grip the internal ribs that can be felt through the fabric of the bag. Push the bag onto the flexible adapter until the nozzle is fully inserted.

To disconnect the Clean Sanding Filter Bag, grasp the bag in the manner previously described and pull firmly – in certain cases it might be necessary to gently twist the inlet nozzle.

Note: During removal, do not grasp the fabric alone, as this may tear the Clean Sanding Filter Bag.

Performance Monitoring of the Clean Sanding Filter Bag

The Clean Sanding Filter Bag is designed to separate and trap dust particulates from the incoming exhaust air. During operation, the bag will start to inflate, the degree of inflation will increase as the bag becomes filled. The bag can be used in conjunction with any abrasive grades – typical bag filling parameters are described in the table below :

<i>Abrasive Grade</i>	<i>Continuous Sanding (mins)*</i>	<i>Approximate Mass of Dust (g)*</i>
Original Filter Bag P800	80-90	120
Original Filter Bag P500	40-45	100
Original Filter Bag P280	24-30	100
Original Filter Bag P80	18-20	90
New 2X Bag P80	40-45	180
XL Filter Bag P80	335**	1200**

- ** Data presented is representative of typical results which might be expected from the specific gelcoat substrate tested, and recorded under specific testing conditions*
- *** Data presented is representative of typical results which might be expected from the specific acrylic substrate tested, and recorded under specific testing conditions*

Capacity Indication - The most obvious indication that the Clean Sanding Filter Bag has reached capacity is the appearance of dust at the working surface, or around the tool / back-up pad interface. When dust begins to be visible in these areas, the bag should be changed. **3M Clean Sanding Filter Bags are not re-usable.**

Users are responsible for ensuring that incompatible materials, which may react adversely when combined, are not captured in the same 3M Clean Sanding Filter bag.

Disposal of Used Clean Sanding Filter Bags

Dust captured in the bag accounts for 75% of its mass at capacity. Therefore, handling and disposal of filled bags should be conducted according to local, State and Federal regulations. It is recommended that used bags be secured with tape around the nozzle area to prevent dust from exiting.

Trouble Shooting

Symptom	Possible Cause
Dust leaking from bag end of adapter tube	Bag nozzle not pushed completely into adapter Sander speed control partially closed Bag is at it's capacity
Dust leaking from tool end of adapter tube or SGV Exhaust Fitting	Adapter not fully attached to the sander Hose seal is not in place

	<p>Sander speed control partially closed</p> <p>Bag is at capacity</p>
Dust leaking from back-up pad area	<p>Air pressure below 90 psi under load</p> <p>Worn or improper abrasive disc</p> <p>Damaged back-up pad</p> <p>Back-up pad is misaligned with interface pad</p> <p>Sander speed control partially closed</p> <p>SGV Assembly not fully/properly attached to the sander</p> <p>Dust skirt not fully/properly attached to the sander</p> <p>Bag is at capacity</p>
Lack of dust pick-up at working surface	<p>Air pressure below 90 psi under load</p> <p>Worn or improper abrasive disc</p> <p>Damaged back-up pad</p> <p>Incorrect back-up pad washer (0.030" recommended)</p> <p>Back-Up pad is misaligned with Interface pad</p> <p>Sander speed control partially closed</p> <p>Bag is at capacity</p>

Contact for Product Information:

Customer Response Center
900 Bush Avenue, Building 21-1W-10
St. Paul, MN 55106
1-800-362-3550 - option 2 – option 1

Effective Date: October 5, 2009
Replaces issue dated: 9-18-09

Abrasive Systems Division/3M
Technical Service

Technical Information: The technical information, recommendations and other statements contained in this document are based upon tests or experience that 3M believes are reliable, but the accuracy or completeness of such information is not guaranteed.

Product Use: Many factors beyond 3M's control and uniquely within user's knowledge and control can affect the use and performance of a 3M product in a particular application. Given the variety of factors that can affect the use and performance of a 3M product, user is solely responsible for evaluating the 3M product and determining whether it is fit for a particular purpose and suitable for user's method of application.

Warranty, Limited Remedy, and Disclaimer: Unless an additional warranty is specifically stated on the applicable 3M product packaging or product literature, 3M warrants that each 3M product meets the applicable 3M product specification at the time 3M ships the product. 3M MAKES NO OTHER WARRANTIES OR CONDITIONS, EXPRESS OR IMPLIED, INCLUDING, BUT NOT LIMITED TO, ANY IMPLIED WARRANTY OR CONDITION OF MERCHANTABILITY OR FITNESS FOR A PARTICULAR PURPOSE OR ANY IMPLIED WARRANTY OR CONDITION ARISING OUT OF A COURSE OF DEALING, CUSTOM OR USAGE OF TRADE. If the 3M product does not conform to this warranty, then the sole and exclusive remedy is, at 3M's option, replacement of the 3M product or refund of the purchase price.

Limitation of Liability: Except where prohibited by law, 3M will not be liable for any loss or damage arising from the 3M product, whether direct, indirect, special, incidental or consequential, regardless of the legal theory asserted, including warranty, contract, negligence or strict liability.