

SharkBite Max™

Polybutylene Adapters

SharkBite Max™ allows users to connect pipe with ease - no tools needed. This new design features a stainless steel retainer for extra strength, higher pressure ratings (400 psi) and a lower insertion effort than previous versions of SharkBite Brass Push to-Connect fittings. SharkBite Max polybutylene adapters require a tube stiffener on the polybutylene connection end and are included with the fitting. The other connection side does not require a PEX stiffener and are compatible with PEX, copper, CPVC, PE-RT and HDPE*.

Applications

Residential and commercial potable water, recirculation, hydronic heating/cooling (up to 50% glycol concentration) and direct burial (wrapping required).

Specifications Data

Materials	
Body	Lead-Free DZR Brass
O-ring	EPDM
Steel Retainer	304 Stainless Steel
Grab Ring	Stainless Steel

Pipe Insertion Depth		Performance	
Fitting Size	Insertion Depth	Max Working Pressure	
1/2 in.	1.00 in.	Max Pressure	400 psi
3/4 in.	1.25 in.	Max Temperature	200°F (93°C)

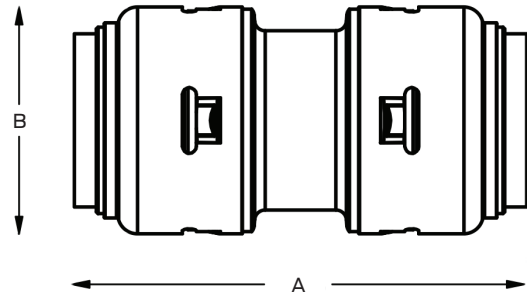

Polybutylene Adapter

Dimensions (Inches)			
Part #	Size	A	B
UR4008	1/2 in.	2.1	1.0
UR4016	3/4 in.	2.6	1.3

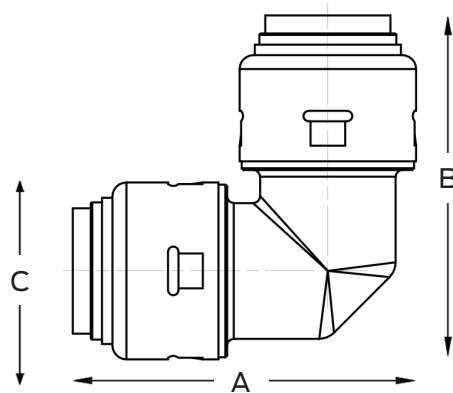

Polybutylene 90° Elbow

Dimensions (Inches)				
Part #	Size	A	B	C
UR4248	1/2 in.	1.9	1.9	1.0
UR4256	3/4 in.	2.5	2.5	1.3

Certifications & Listings

ASME A112.4.14/CSA B125.14, NSF/ANSI 14, NSF/ANSI/CAN 61, NSF/ANSI/CAN 372

For listing information, please contact Customer Service

* HDPE installations must use a tube stiffener. Sold separately by HDPE manufacturer.

Product Submittal	
Name	
Date	
Architect/Owner	
Contractor	
Tag	
Notes	