



TUBE SLIDE

Model # 9198012

Left Exit Slide

Owner's Manual & Assembly Instructions

MANUFACTURED BY:
Backyard Discovery
3305 Airport Drive
Pittsburg, KS 66762
800-856-4445



**INSTALLATION
SERVICES
AVAILABLE!***

Need a helping hand?

Let our team of professionals handle the installation for you!

GOCONFIGURE
888-888-5424

*Installation services are only available to U.S. customers.

average 2 person assembly time



sembly time may vary based on skill level

For the most up to date assembly manual,
to register your set, or to order replacement parts please visit
www.backyarddiscovery.com

**SAVE THIS ASSEMBLY MANUAL FOR FUTURE REFERENCE IN THE EVENT THAT
YOU NEED TO ORDER REPLACEMENT PARTS.**

Para obtener instrucciones en español, visite www.backyarddiscovery.com

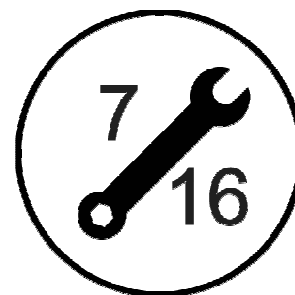
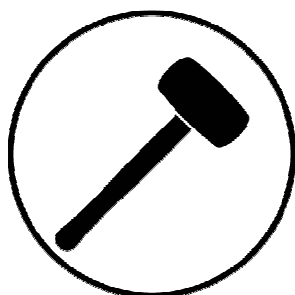
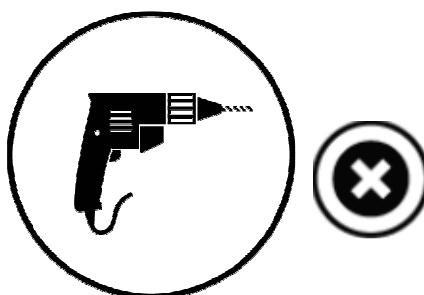
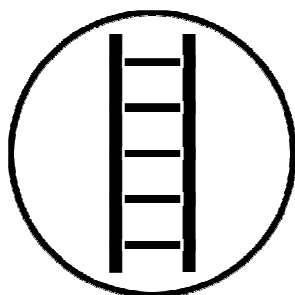
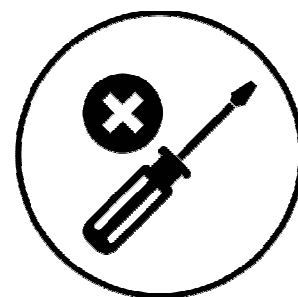
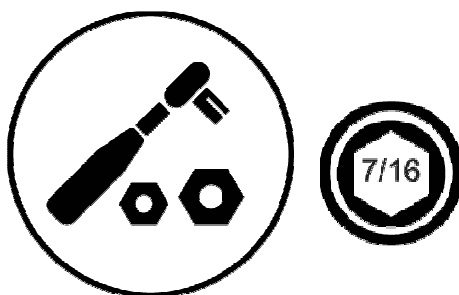
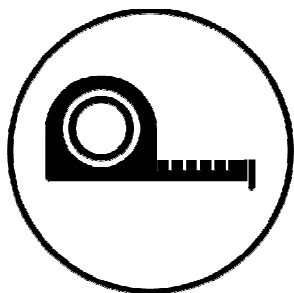

Icons and their uses you will see throughout this manual

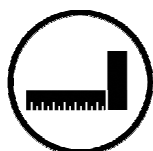

You will need to make sure that your assembly is square before tightening your bolts.



When you see this icon you will need a socket wrench. The icons below show the size of attachments needed for assembly 1/2.



For proper assembly you will need to ensure that your structure is level before proceeding to the next step.

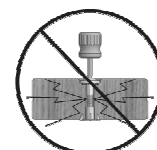

This icon warns you to not over tighten your bolts. This is to prevent structural damage and also splintering your wood.



Some steps in the assembly process will require an extra set of hands. Make sure you have a helper available.



This icon shows the size of an open ended wrench. Using the wrench as the fraction bar.

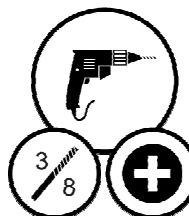

This icon will show you what drill attachments are needed. For this example you will need a Phillips head attachment and 3/8 socket.



Place the set on level ground, not less than 6 ft 7 in [2 m] from any structure or obstruction such as a fence, garage, house, overhanging branches, laundry lines, or electrical wires.

- While assembling unit, take time before and after each phase to make sure fort is level. If fort is not level, assembly will be difficult and improper assembly may result. Extra care must be taken to insure the fort is square.
- The safe play area refers to a zone extending 6 ft (2m) beyond the play product on all sides, including the space above the play product.

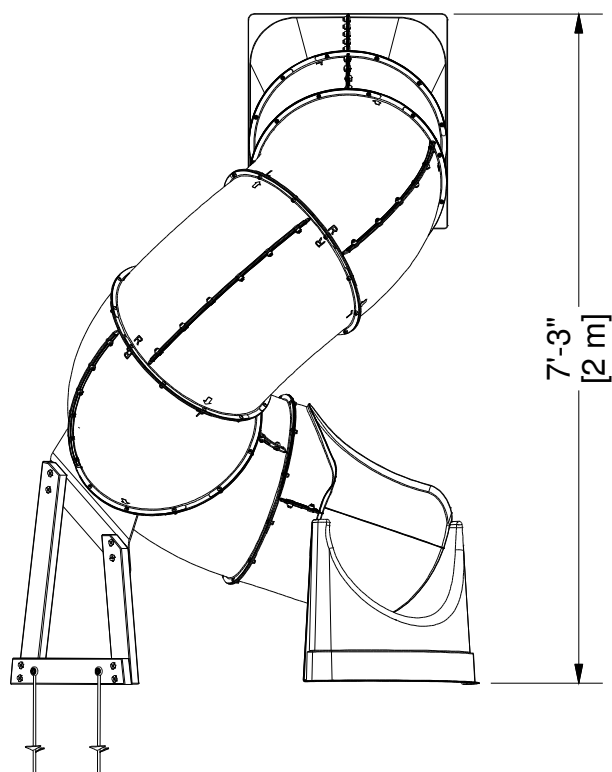
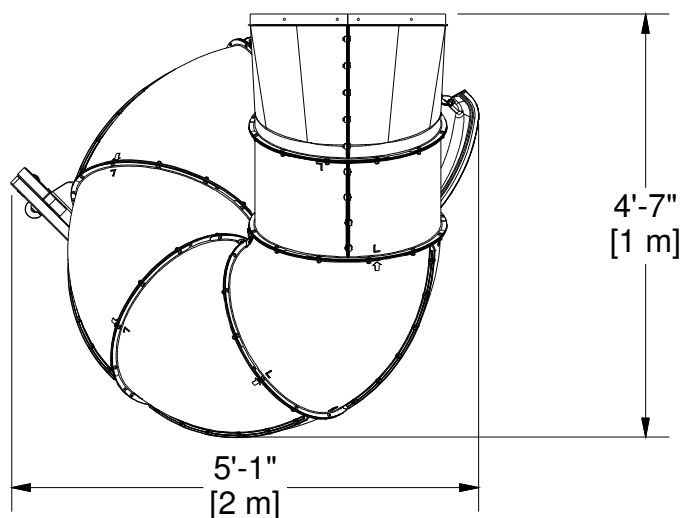

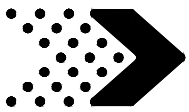

Parts Identification

Wood Components (Not to Scale)

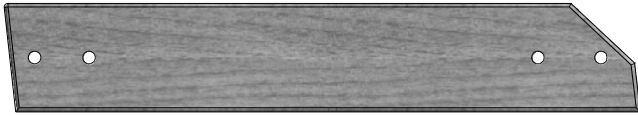

E85 | UPRIGHT - W4L12583
(x1) | 1 3/8"x3 3/8"x19 7/8" (36x86x505)



E87 | GROUND BOARD - W4L12585
(x1) | 1 3/8"x3 3/8"x21" (36x86x533)

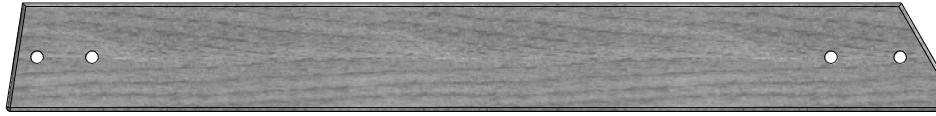

E86 | UPRIGHT - W4L12584
(x1) | 1 3/8"x3 3/8"x29 1/4" (36x86x743)

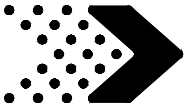

Parts Identification

Hardware Components



H100195 | BOLT WH BLK
(x4) | 5/16x2-3/4

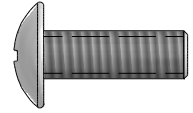

H100769 | BOLT PTH WZ
(x134) | 1/4x3/4



H100148 | NUT LOCK WZ
(x135) | 1/4



H100407 | BOLT WH BLK
(x4) | 5/16x1 1/2

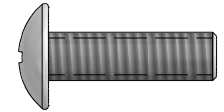

H100795 | BOLT PTH WZ
(x3) | 1/4x7/8

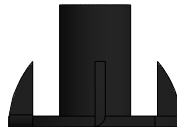

H100379 | T-NUT BLK
(x9) | 5/16



H100406 | BOLT WH BLK
(x2) | 1/4x1 1/2

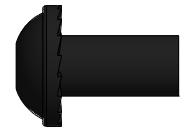

H100404 | NUT BARREL WH BLK
(x2) | 1/4x5/8

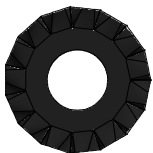

H100198 | WASHER LOCK EXT BLK
(x4) | 8x19



H100474 | WASHER FLAT BLK
(x2) | 9x18

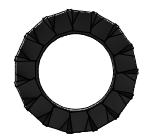

H100400 | WASHER LOCK EXT BLK
(x2) | 8x15

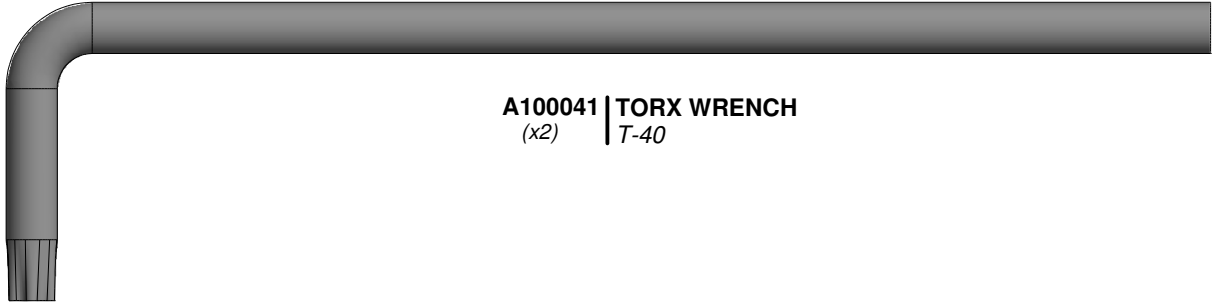
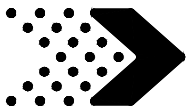

A100041 | TORX WRENCH
(x2) | T-40

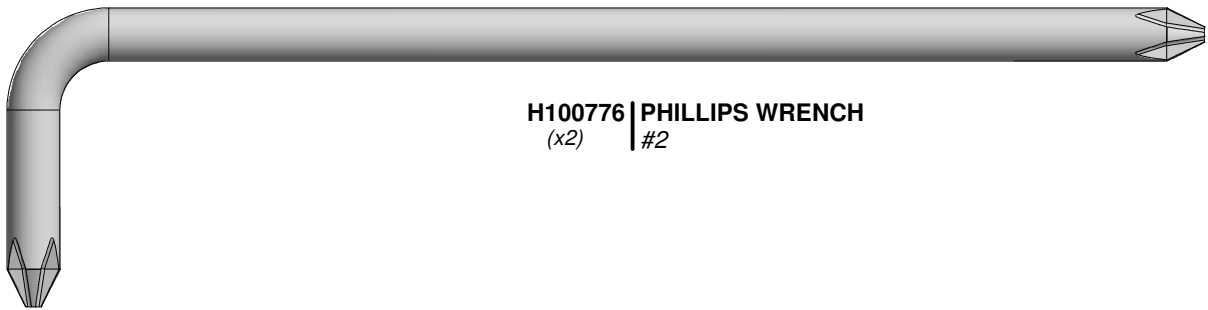

H100776 | PHILLIPS WRENCH
(x2) | #2

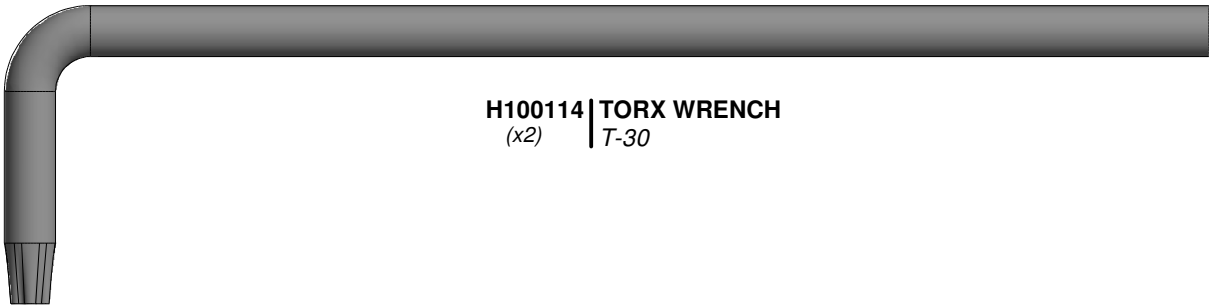

H100114 | TORX WRENCH
(x2) | T-30



H100147 | TORX BIT
(x2) | T-30



A100042 | TORX BIT
(x2) | T-40

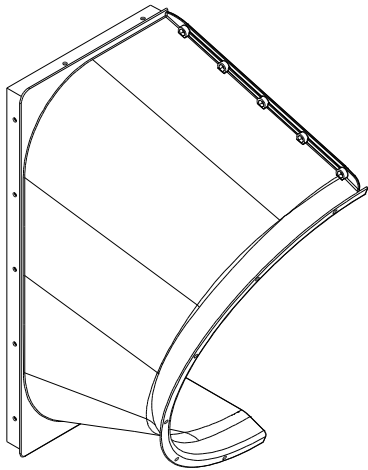
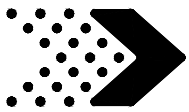

A6P00302-2 | SLIDE ENTRANCE LEFT
(x1)

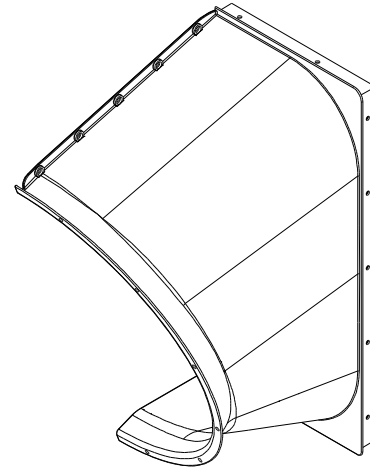

A6P00302-1 | SLIDE ENTRANCE RIGHT
(x1)

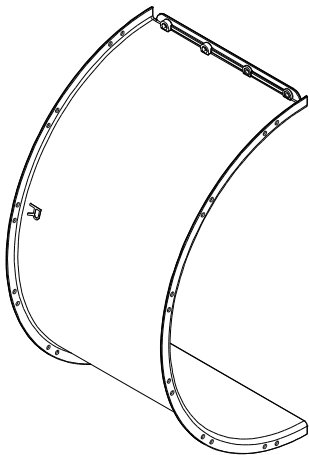

A6P00302-3 | STRAIGHT TUBE
(x2)

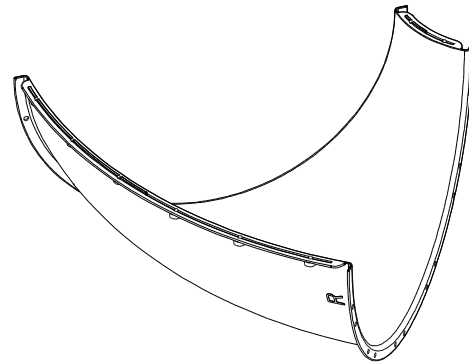

A6P00302-4 | SLIDE ELBOW
(x9)

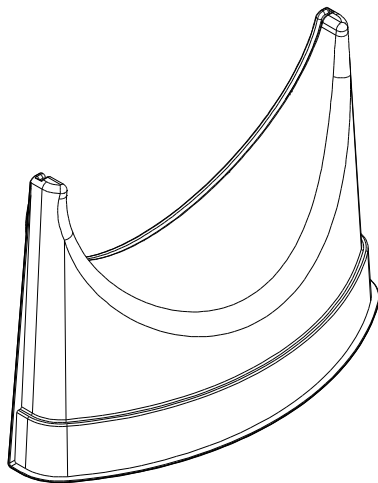

A6P00302-6L | EXIT SUPPORT
(x1)

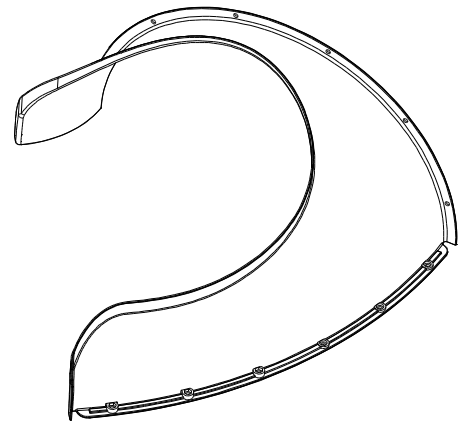

A6P00302-5L | EXIT TOP
(x1)

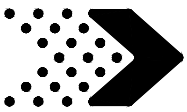

A100178
(x2) | METAL GROUND STAKE BROWN

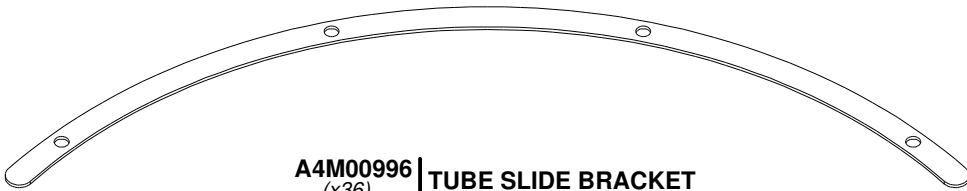

A4M00996
(x36) | TUBE SLIDE BRACKET

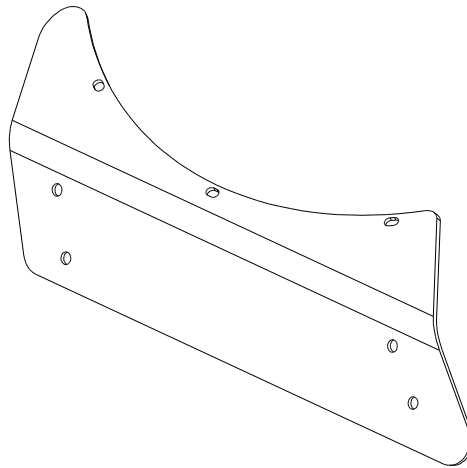

A4M01002
(x1) | TUBE SLIDE BRACKET - LH

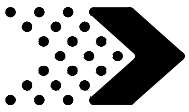

Phase 1

STEP 1

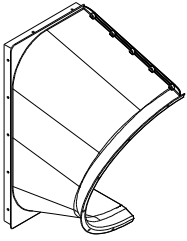

A6P00302-2
(x1) | **SLIDE ENTRANCE LEFT**

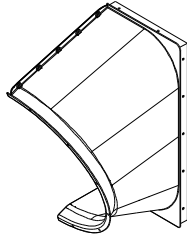

A6P00302-1
(x1) | **SLIDE ENTRANCE RIGHT**



H100769 | **BOLT PTH WZ**
(x8) | 1/4x3/4



H100148 | **NUT LOCK WZ**
(x8) | 1/4

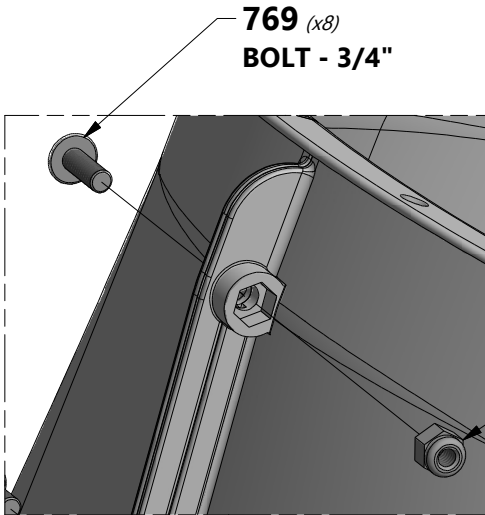

769 (x8)
BOLT - 3/4"

148 (x8)
NUT - 1/4"



TIP:
LAYING THE PARTS ON THEIR FLAT
END MAKES ASSEMBLY EASIER.

302-1 (x1)
SLIDE ENTRANCE RIGHT

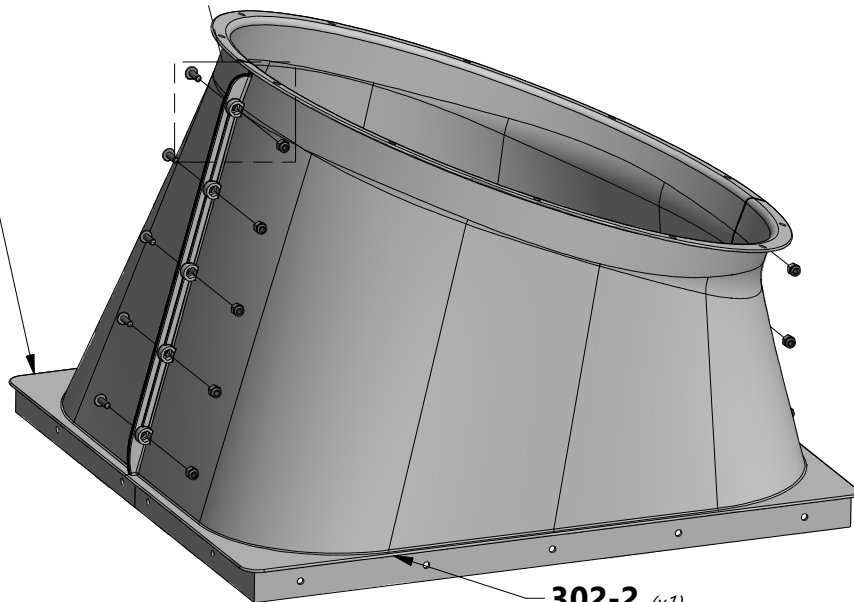

302-2 (x1)
SLIDE ENTRANCE LEFT

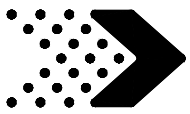

Phase 1

STEP 2

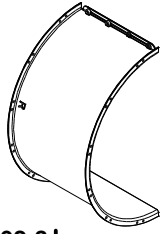

A6P00302-3 | STRAIGHT TUBE
(x2)



H100769 | BOLT PTH WZ
(x8) | 1/4x3/4



H100148 | NUT LOCK WZ
(x8) | 1/4

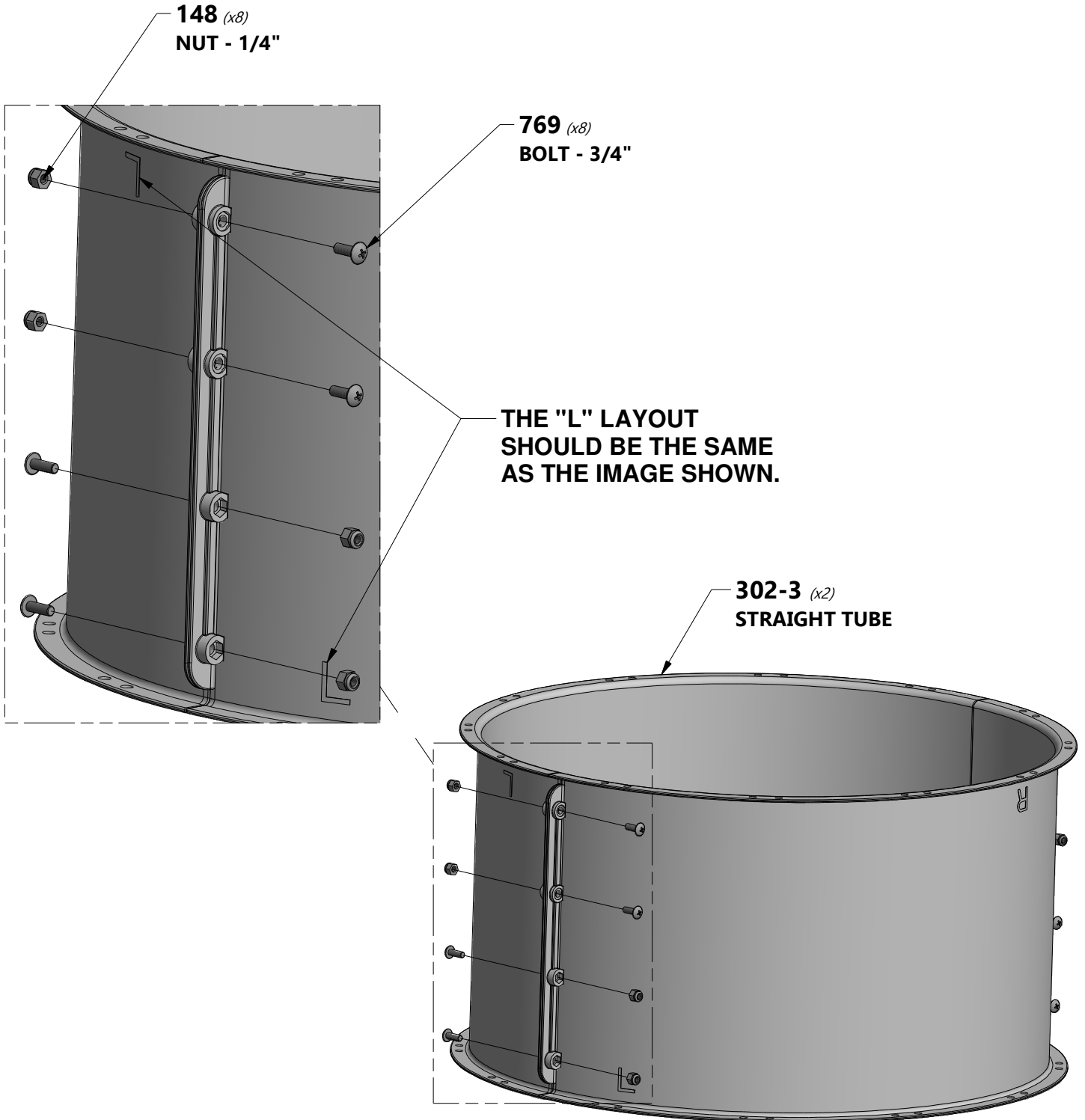

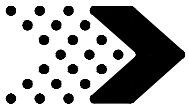

Phase 1

STEP 3

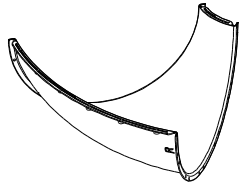

A6P00302-4 | SLIDE ELBOW
(x8)



H100769 | BOLT PTH WZ
(x32) | 1/4x3/4



H100148 | NUT LOCK WZ
(x32) | 1/4

 **NOTE:**
REPEAT THIS STEP (3) MORE TIMES.

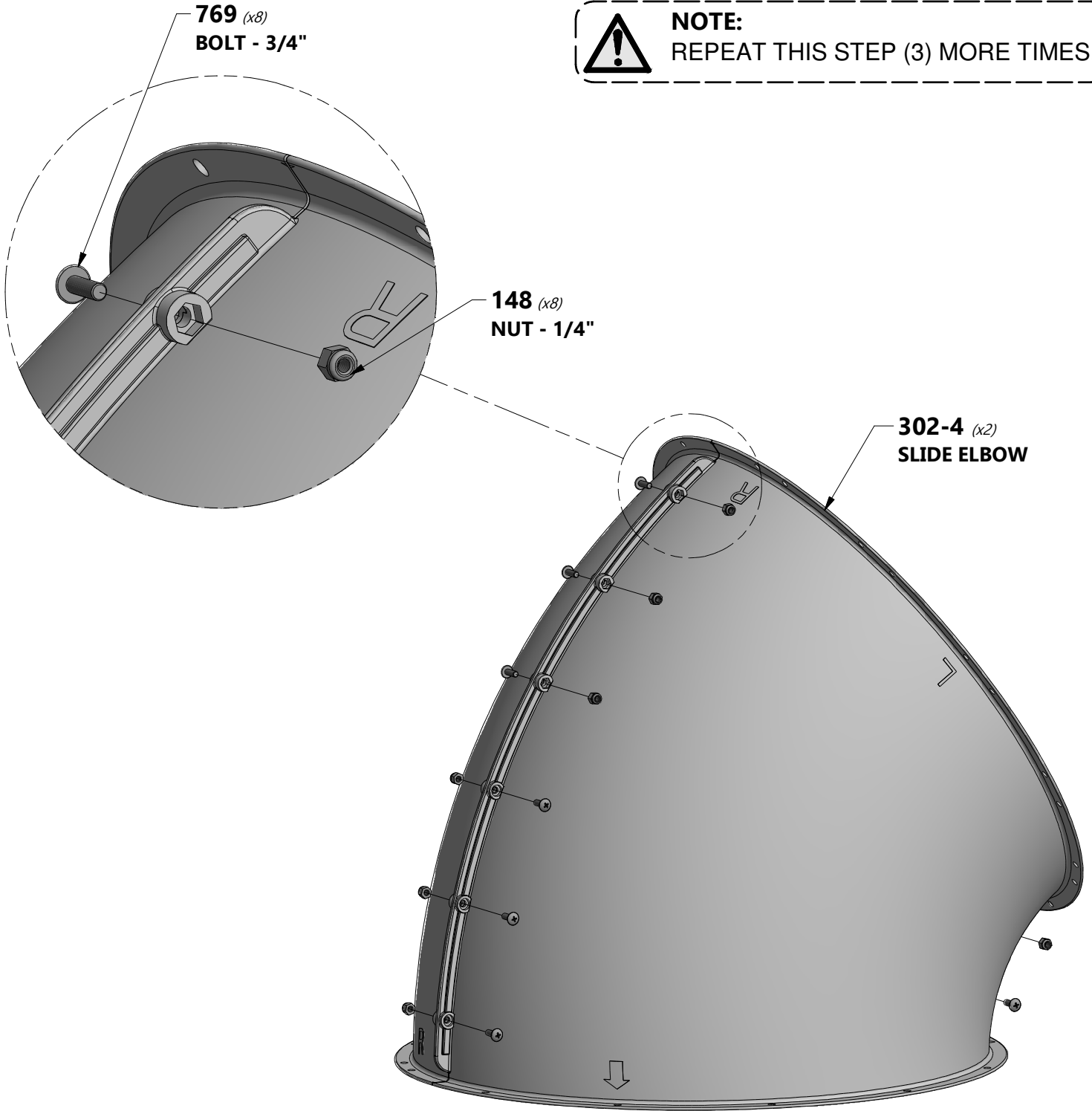

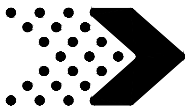

Phase 1

STEP 4

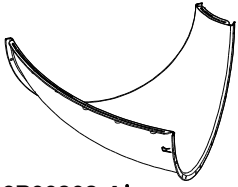

A6P00302-4 | SLIDE ELBOW
(x1)

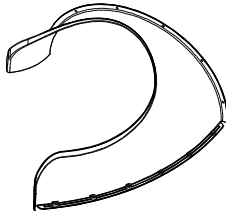

A6P00302-5L | EXIT TOP
(x1)



H100769 | BOLT PTH WZ
(x8) | 1/4x3/4



H100148 | NUT LOCK WZ
(x8) | 1/4

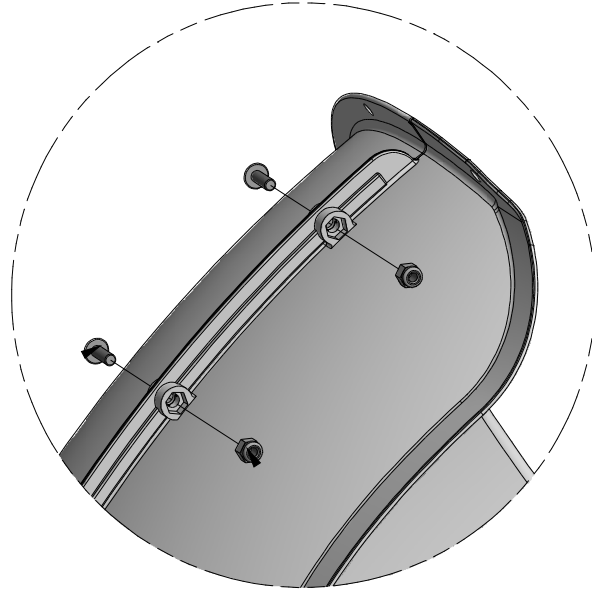

769 *(x8)*
BOLT - 3/4"

302-4 *(x2)*
SLIDE ELBOW

148 *(x8)*
NUT - 1/4"

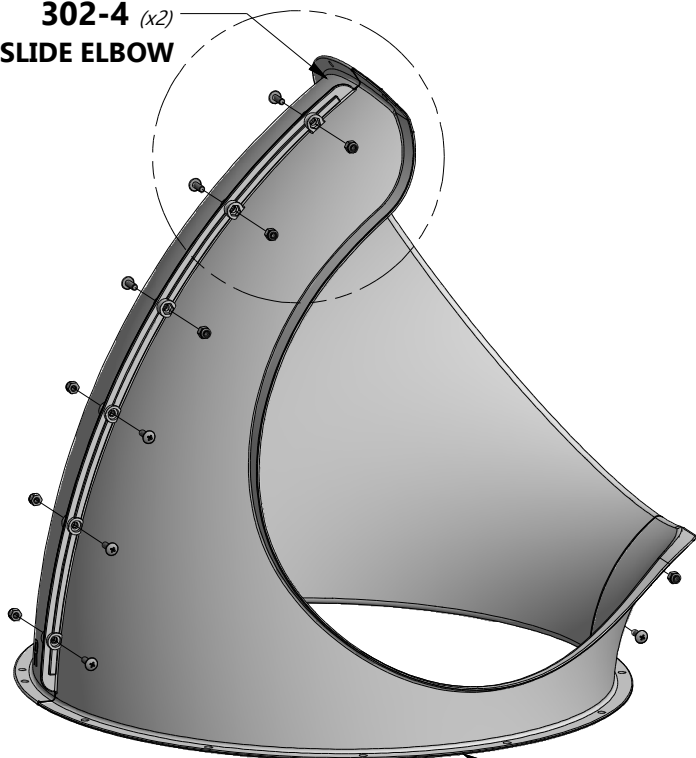

302-5L *(x2)*
EXIT TOP

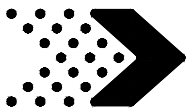

Phase 1

STEP 5

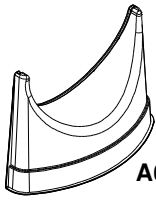

A6P00302-6L | EXIT SUPPORT
(x1)



H100769 | BOLT PTH WZ
(x7) | 1/4x3/4



H100148 | NUT LOCK WZ
(x5) | 1/4



TIP:

- RECOMMENDED BOLT ASSEMBLY ORDER, CLOCKWISE FROM TOP RIGHT.
- MAKE SURE THE 'ARROW' ON THE EXIT SUPPORT IS ALIGNED WITH THE 'R' ON THE SLIDE ELBOW.
- USE A SCREW DRIVER TO ALIGN HOLES.
- WHEN REMOVING SPACER, BEGIN ALIGNMENT OF TUBE SLIDE OPENING FOR EASIER ASSEMBLY.

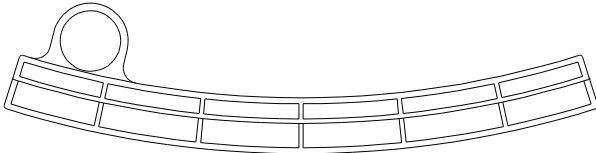

TUBE SLIDE SPACER

SLIDE INTO GROOVE ON EXIT SUPPORT.

FRONT VIEW

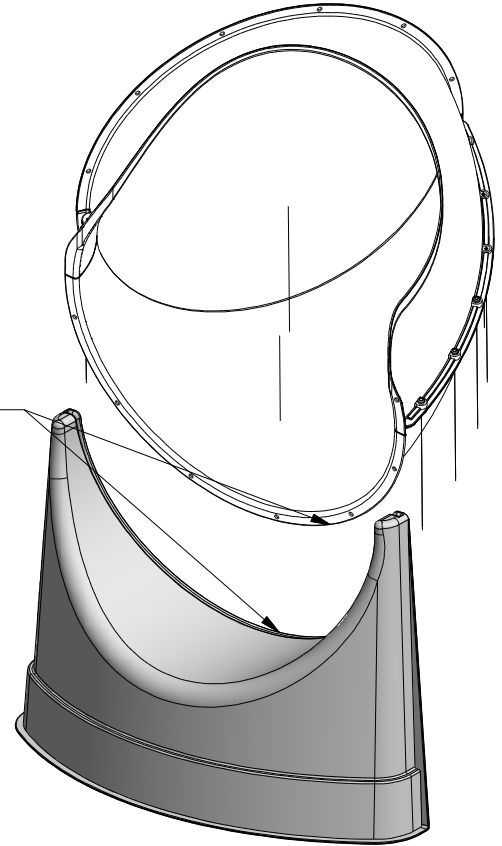

FACTORY INSTALLED NUT. (BOTH CORNERS)

START ALIGNMENT OF HOLES FROM THE TOP LEFT.

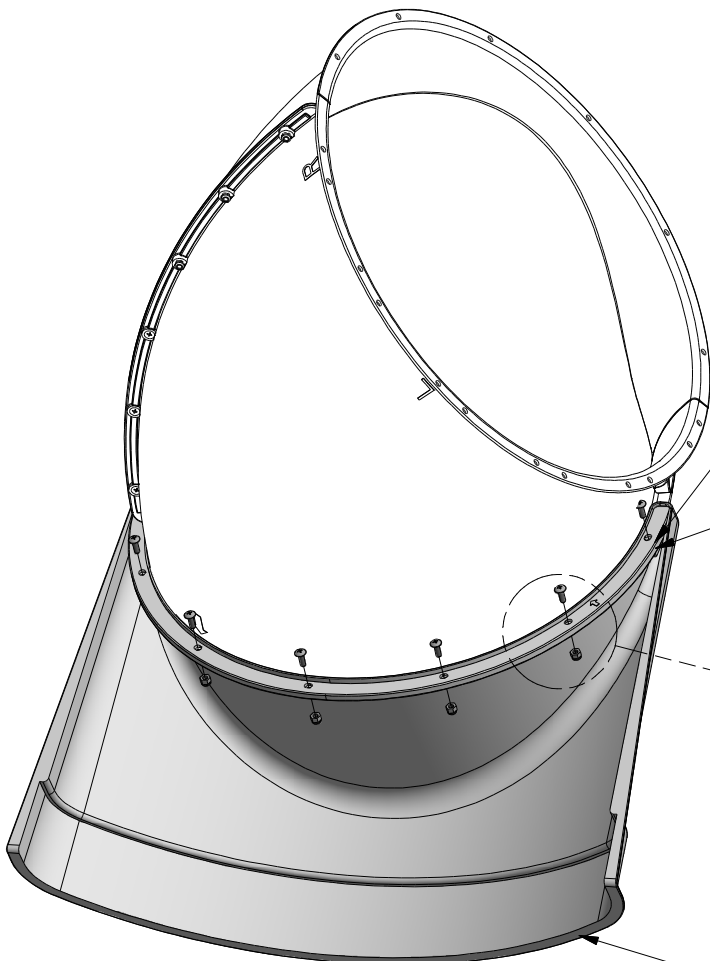

BACK VIEW

012 (x2) EXIT SUPPORT

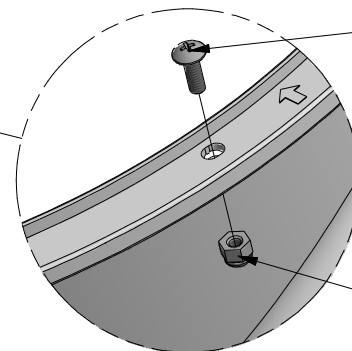

769 (x7) BOLT - 3/4"

148 (x5) NUT - 1/4"

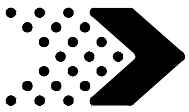

Phase 2

REFERENCE

IMPORTANT: BRACKET CONFIGURATION ASSEMBLY & PLACEMENT.

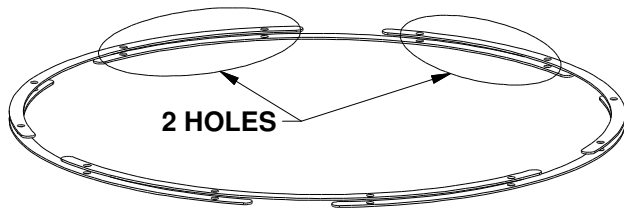

CONFIGURATION 'A' DIAGRAM

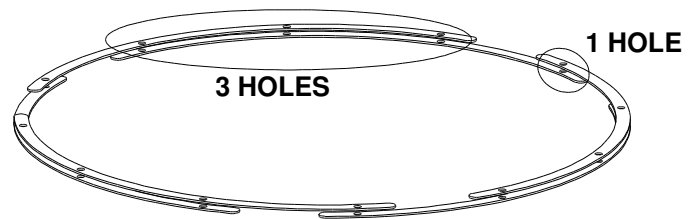

CONFIGURATION 'B' DIAGRAM

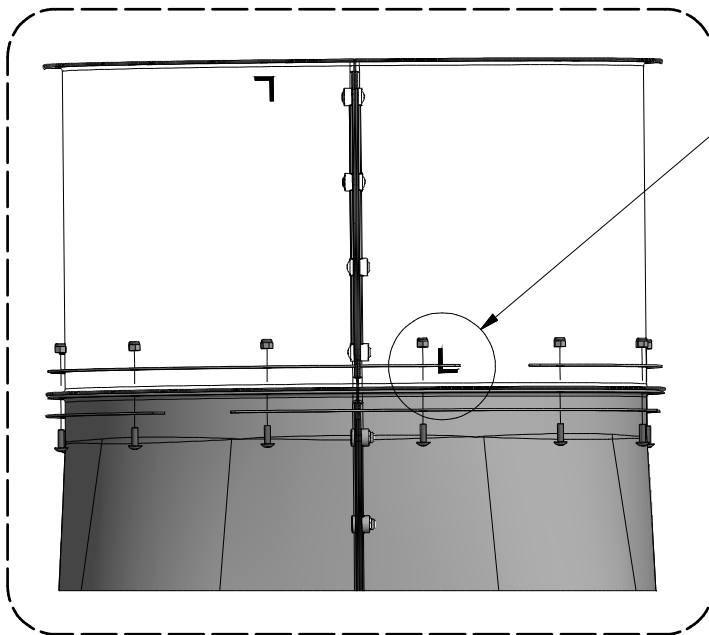

NOTE ALIGNMENT MARKINGS

CONFIGURATION 'A'

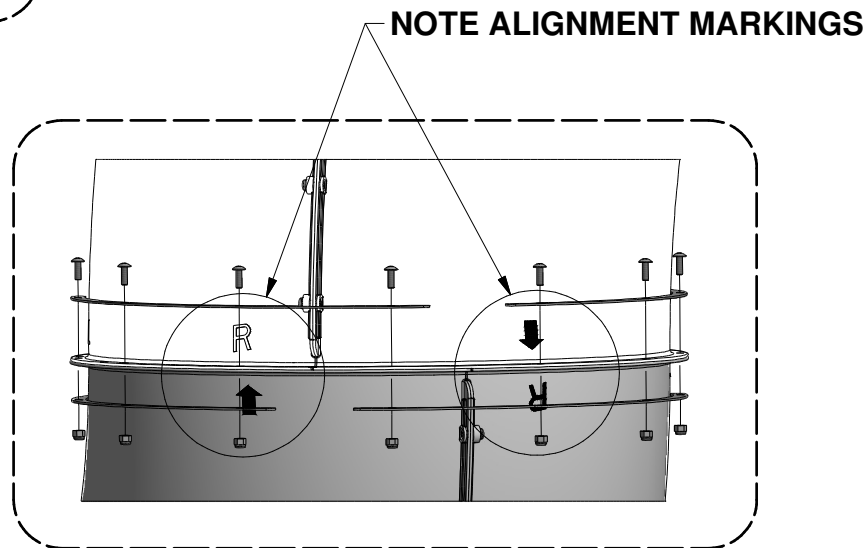

CONFIGURATION 'B'



NOTE:

PAY CLOSE ATTENTION TO THE ALIGNMENT MARKINGS ON EACH SLIDE SECTION. THE MARKINGS WILL AID YOU IN POSITIONING THE METAL SLIDE BRACKETS CORRECTLY.

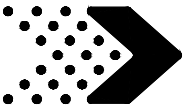

Phase 2

STEP 1

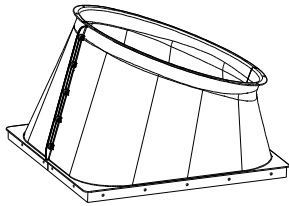

(1)-ENTRANCE SUB-ASSEMBLY

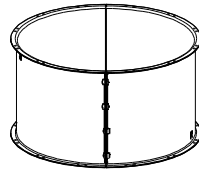

(1)-STRAIGHT TUBE SUB-ASSEMBLY

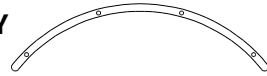

A4M00996 (x6) TUBE SLIDE BRACKET

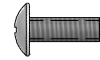

H100769 (x12) BOLT PTH WZ 1/4x3/4



H100148 (x12) NUT LOCK WZ 1/4

 **NOTE:**
THIS SECTION ASSEMBLY USES
BRACKET CONFIGURATION 'A'
SHOWN IN REFERENCE PAGE.

NOTE HOLE ORIENTATION

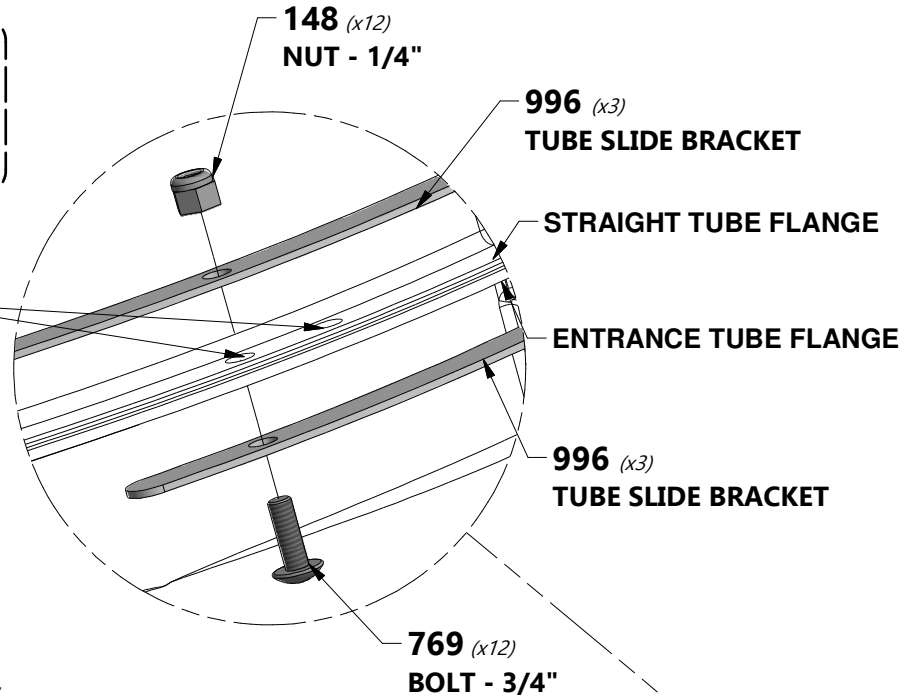

NOTE THE "R" AND THE "L" MARKINGS
TO AID THE POSITIONING THE
METAL BRACKETS

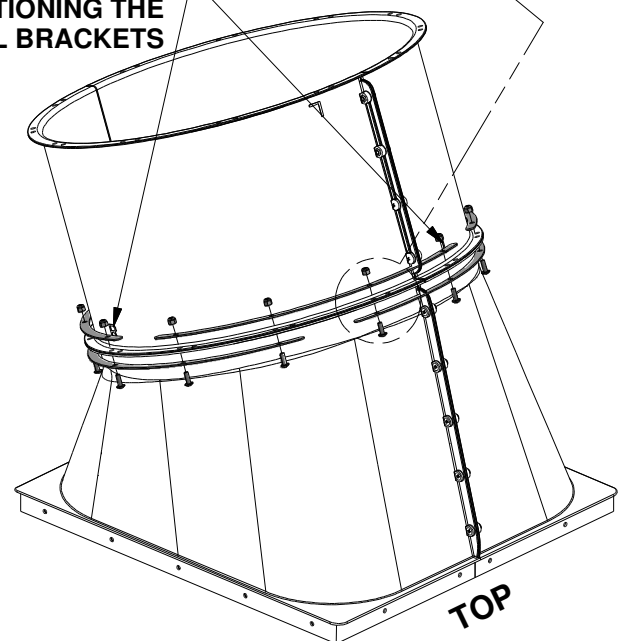
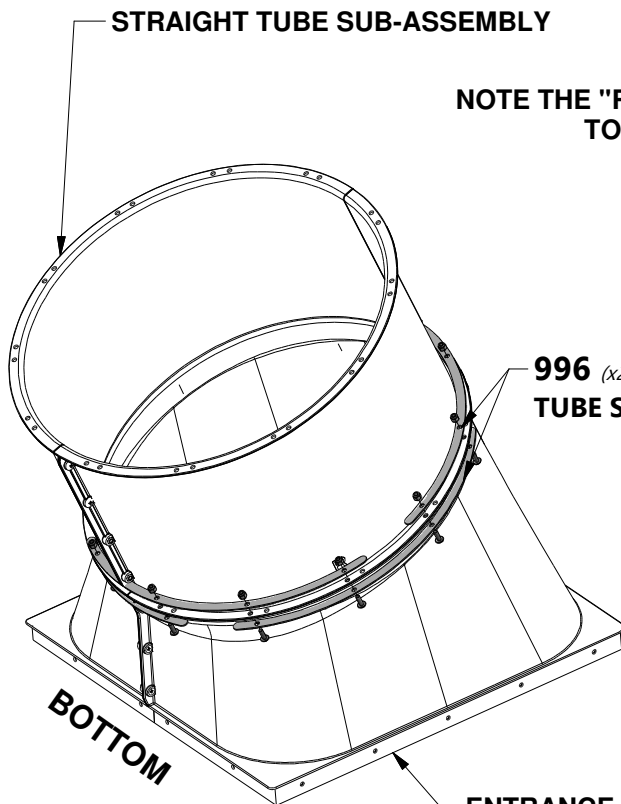

ENTRANCE SUB-ASSEMBLY

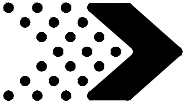

Phase 2

STEP 2

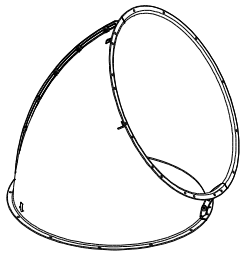

(1)-ELBOW TUBE SUB-ASSEMBLY

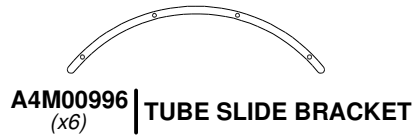

A4M00996 (x6) | TUBE SLIDE BRACKET



H100769 | BOLT PTH WZ
(x12) | 1/4x3/4



H100148 | NUT LOCK WZ
(x12) | 1/4



NOTE:

- ALIGN THE 'L' AND THE 'ARROW' TO ACHIEVE THE PROPER POSITION WHEN ASSEMBLING THE SLIDE.
- NOTE THIS SECTION ASSEMBLY USES CONFIGURATION 'A' SHOWN IN THE REFERENCE PAGE.



TIP:

- USE A SCREW DRIVER TO ALIGN HOLES.

ELBOW TUBE SUB-ASSEMBLY

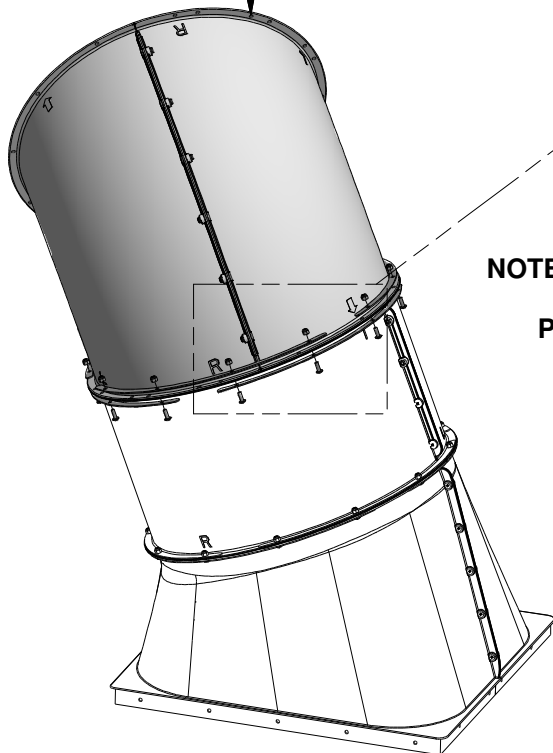

996 (x6) | TUBE SLIDE BRACKET

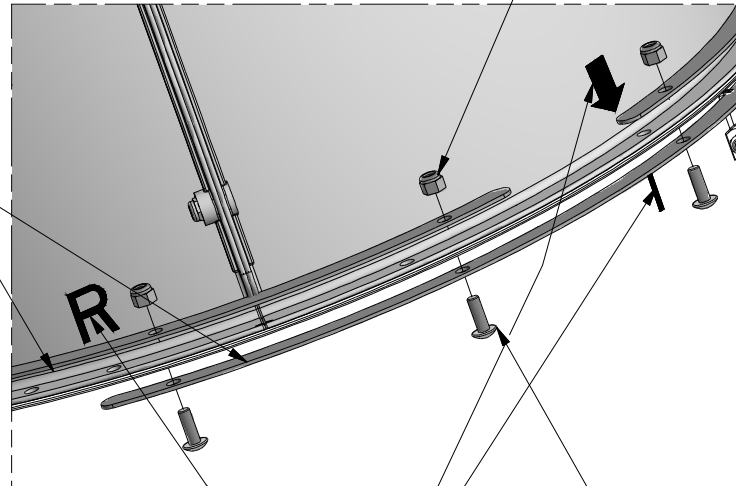

148 (x12) | NUT - 1/4"

769 (x12) | BOLT - 3/4"

NOTE THE "L" AND "ARROW" MARKINGS TO AID IN POSITIONING THE METAL BRACKETS.

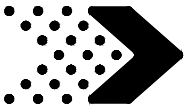

Phase 2

STEP 3

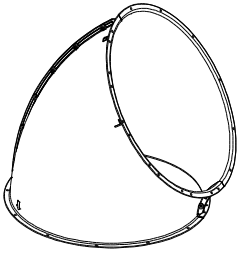

(1)-ELBOW TUBE SUB-ASSEMBLY

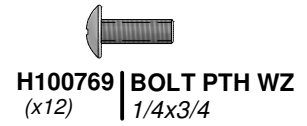
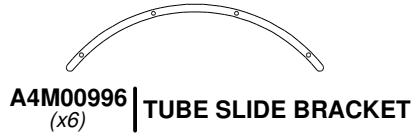

H100769 BOLT PTH WZ
(x12) 1/4x3/4



H100148 NUT LOCK WZ
(x12) 1/4



NOTE:

- ALIGN THE 'L' AND THE 'ARROW' TO ACHIEVE THE PROPER POSITION WHEN ASSEMBLING THE SLIDE.
- NOTE THIS SECTION ASSEMBLY USES CONFIGURATION 'B' SHOWN IN THE REFERENCE PAGE.

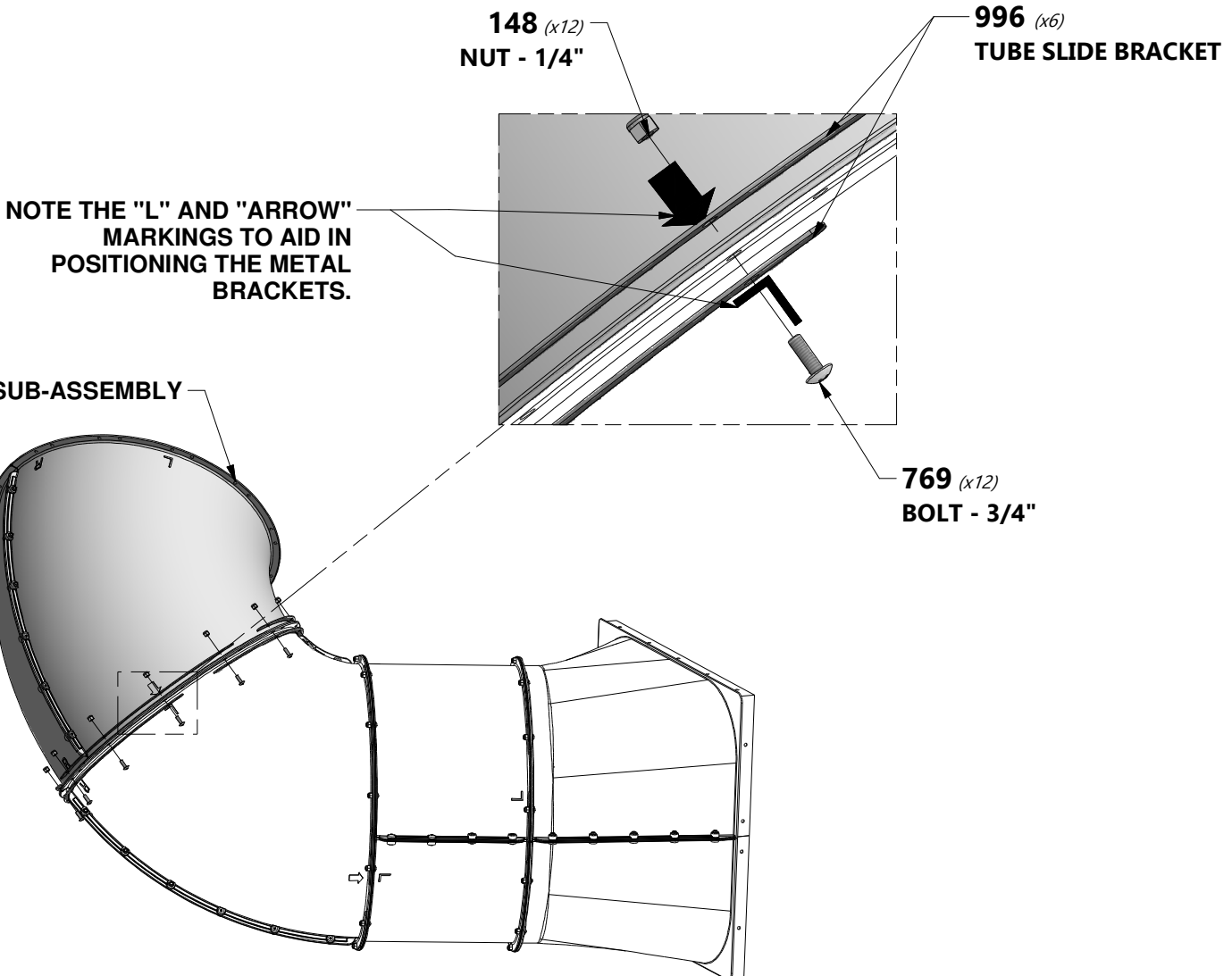

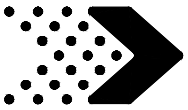

Phase 2

STEP 4

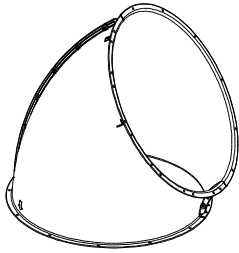

(1)-ELBOW TUBE SUB-ASSEMBLY

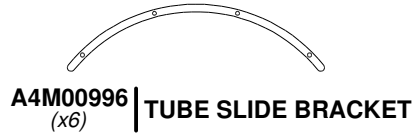

A4M00996 | TUBE SLIDE BRACKET
(x6)



H100769 | BOLT PTH WZ
(x12) | 1/4x3/4



H100148 | NUT LOCK WZ
(x12) | 1/4



NOTE:

- ALIGN THE 'L' AND THE 'ARROW' TO ACHIEVE THE PROPER POSITION WHEN ASSEMBLING THE SLIDE.
- NOTE THIS SECTION ASSEMBLY USES CONFIGURATION 'B' SHOWN IN THE REFERENCE PAGE.

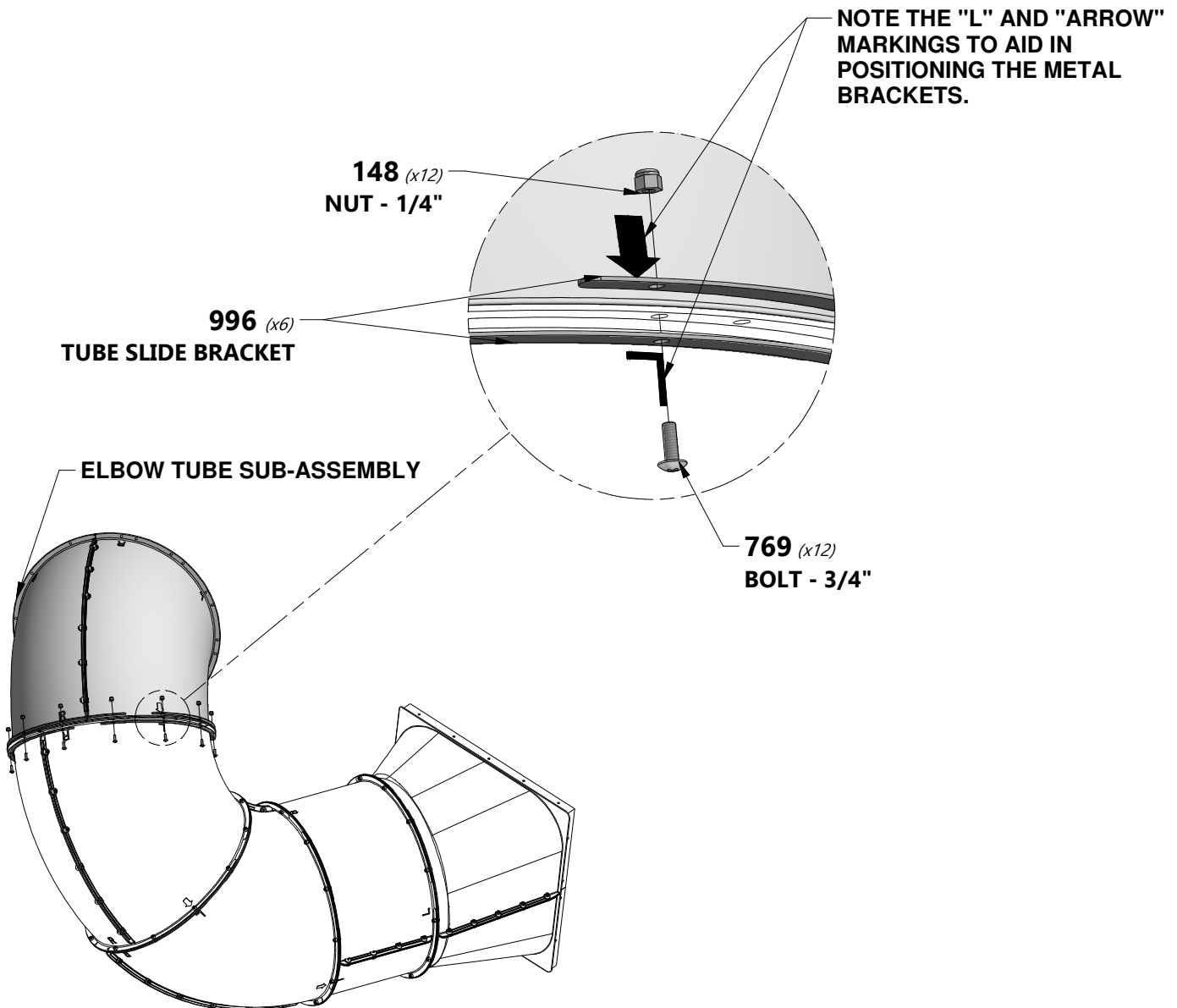

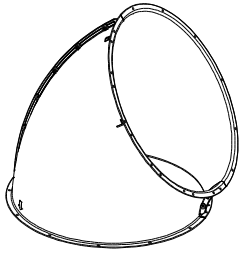
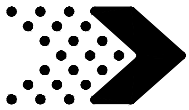

(1)-ELBOW TUBE SUB-ASSEMBLY

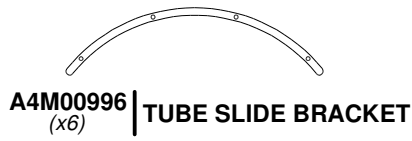

A4M00996 | TUBE SLIDE BRACKET
(x6)

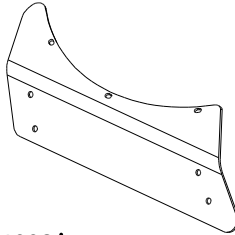

A4M01002 | TUBE SLIDE BRACKET - LH
(x1)

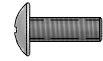

H100769 | BOLT PTH WZ
(x9) | 1/4x3/4



H100148 | NUT LOCK WZ
(x12) | 1/4



H100795 | BOLT PTH WZ
(x3) | 1/4x7/8



NOTE:

- ALIGN THE 'L' AND THE 'ARROW' TO ACHIEVE THE PROPER POSITION WHEN ASSEMBLING THE SLIDE.
- NOTE THIS SECTION ASSEMBLY USES CONFIGURATION 'B' SHOWN IN THE REFERENCE PAGE.
- NOTE THE (3) BOLTS USED TO ASSEMBLE THE SLIDE BRACKET ARE 7/8", NOT 3/4".

002 (x6)

TUBE SLIDE BRACKET - LH

996 (x6)

TUBE SLIDE BRACKET

148 (x12)

NUT - 1/4"

795 (x3)

BOLT - 7/8"

769 (x9)

BOLT - 3/4"

NOTE THE "L" AND "ARROW" MARKINGS TO AID IN POSITIONING THE METAL BRACKETS.

ELBOW TUBE SUB-ASSEMBLY

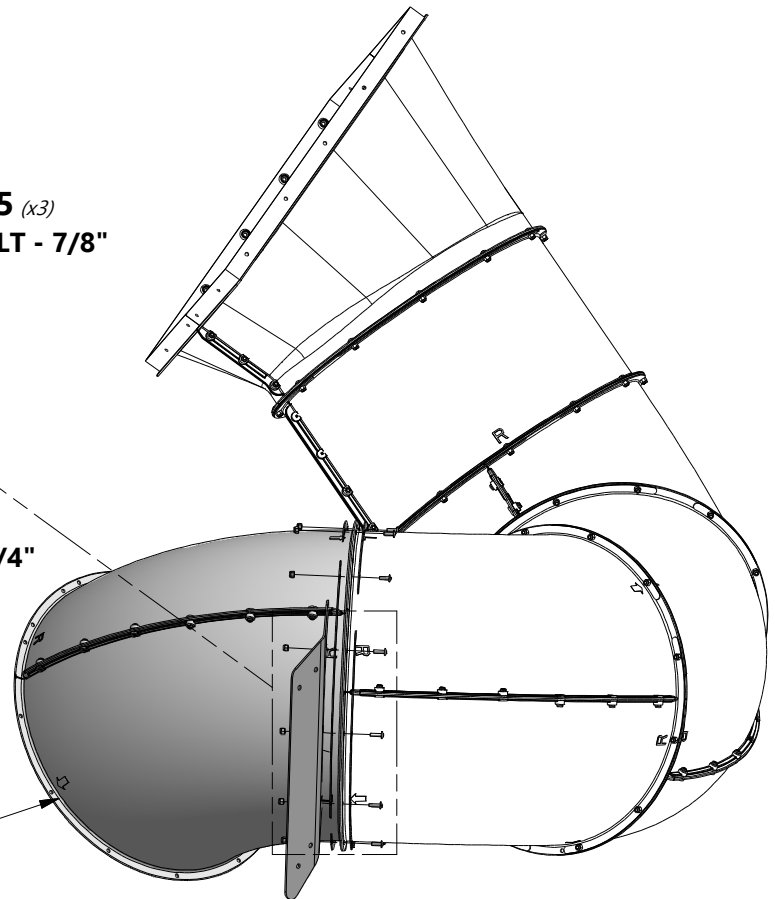

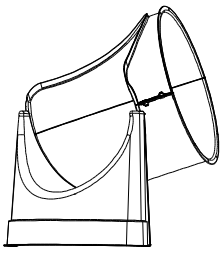
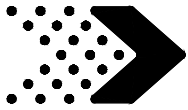

(1)-EXIT SUB-ASSEMBLY

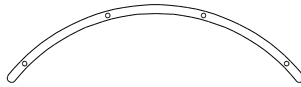

A4M00996 | TUBE SLIDE BRACKET
(x6)

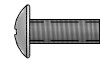

H100769 | BOLT PTH WZ
(x12) | 1/4x3/4



H100148 | NUT LOCK WZ
(x12) | 1/4



NOTE:

- ALIGN THE 'L' AND THE 'ARROW' TO ACHIEVE THE PROPER POSITION WHEN ASSEMBLING THE SLIDE.
- NOTE THIS SECTION ASSEMBLY USES CONFIGURATION 'B' SHOWN IN THE REFERENCE PAGE.

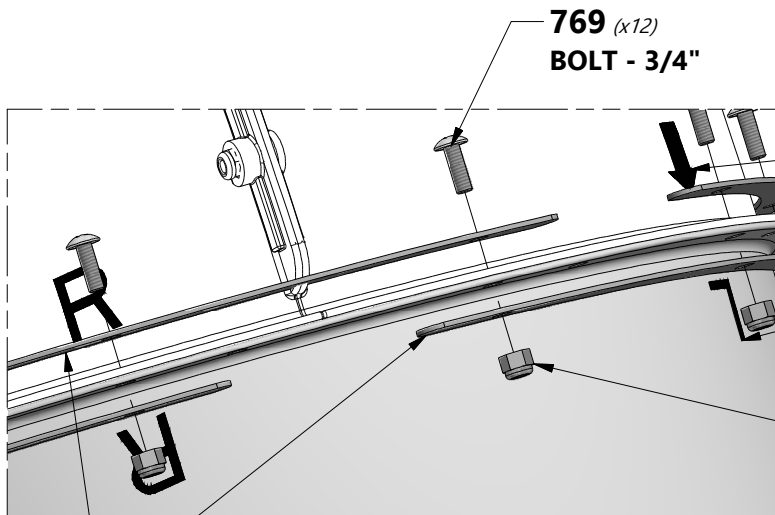

769 (x12)
BOLT - 3/4"

NOTE THE "L" AND "ARROW"
MARKINGS TO AID IN
POSITIONING THE METAL
BRACKETS.

148 (x12)
NUT - 1/4"

996 (x6)
TUBE SLIDE BRACKET

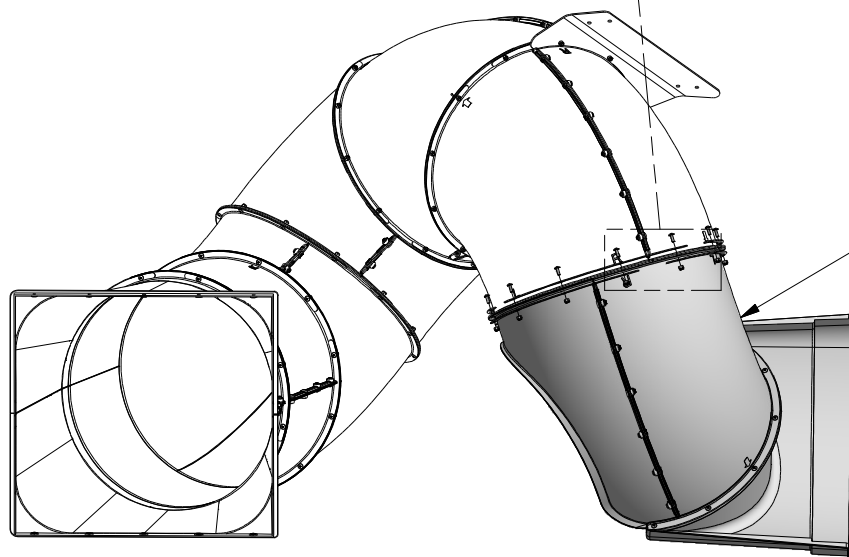

EXIT SUB-ASSEMBLY

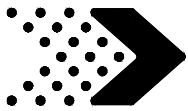

Phase 3

STEP 1

E85 | UPRIGHT - W4L12583
 (x1) | 1 3/8"x3 3/8"x19 7/8" (36x86x505)

E87 | GROUND BOARD - W4L12585
 (x1) | 1 3/8"x3 3/8"x21" (36x86x533)

E86 | UPRIGHT - W4L12584
 (x1) | 1 3/8"x3 3/8"x29 1/4" (36x86x743)

H100195 | BOLT WH BLK
 (x4) | 5/16x2-3/4

H100379 | T-NUT BLK
 (x4) | 5/16

H100198 | WASHER LOCK EXT BLK
 (x4) | 8x19



NOTE:
 HAMMER T-NUTS INTO PROVIDED
 HOLES IN 'E87'.

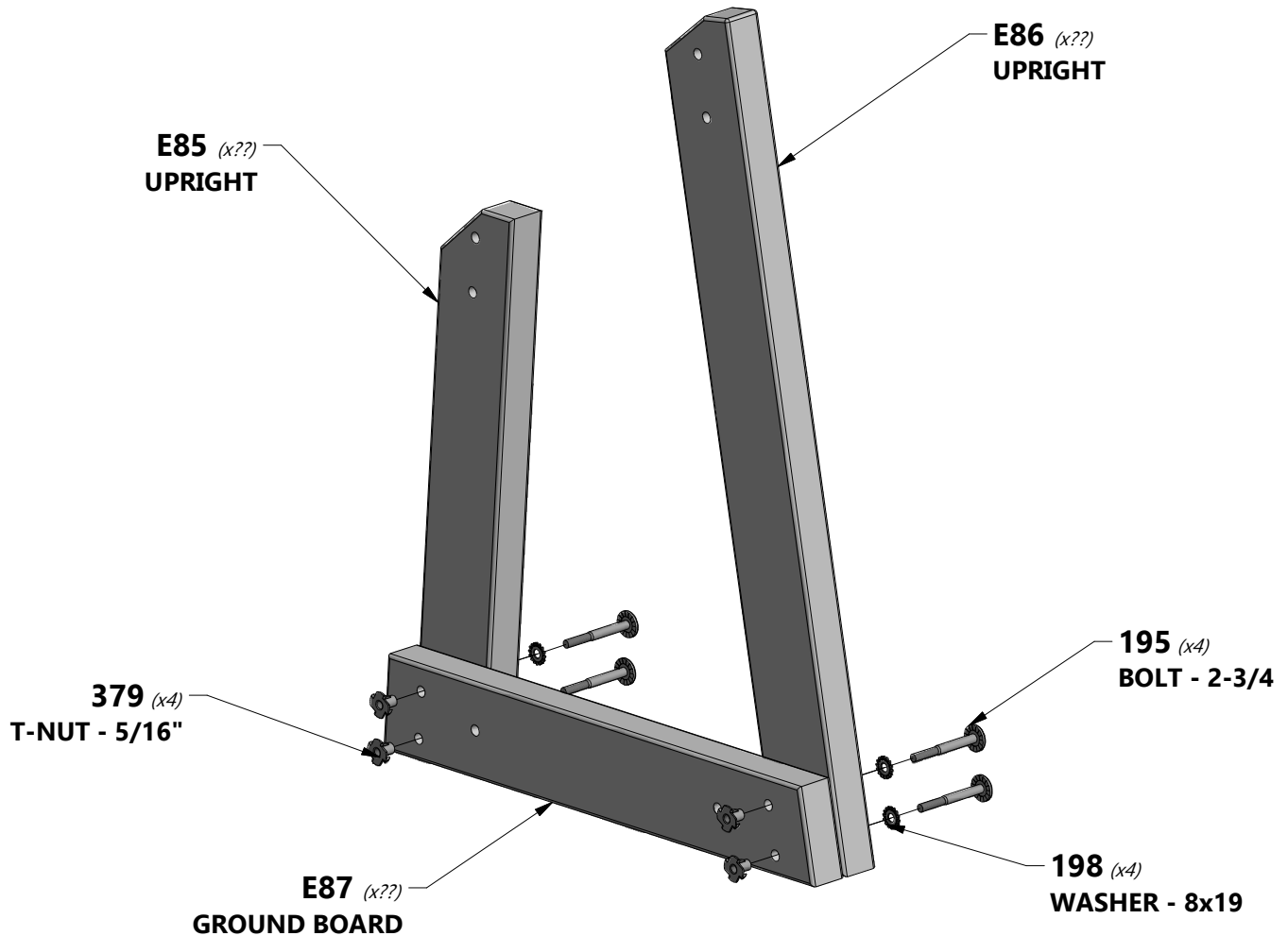

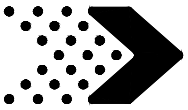

Phase 3

STEP 2

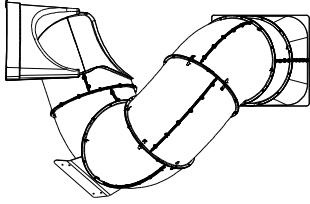

(1)-TUBE SLIDE SUB-ASSEMBLY

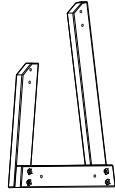

(1)-SLIDE BRACE SUB-ASSEMBLY



H100407 | BOLT WH BLK
(x4) | 5/16x1 1/2



H100379 | T-NUT BLK
(x4) | 5/16



NOTE:
HAMMER T-NUTS INTO PROVIDED HOLES IN 'E85' AND 'E86'.

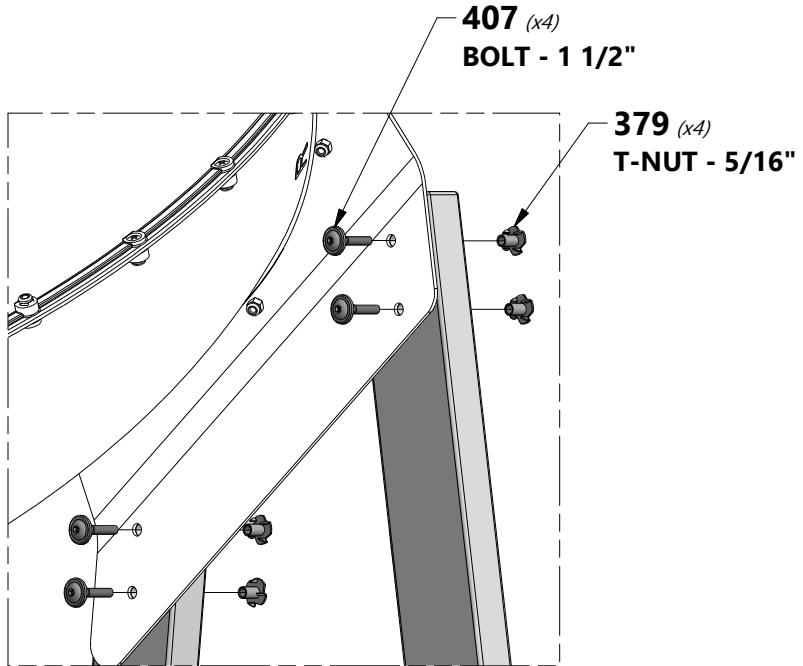
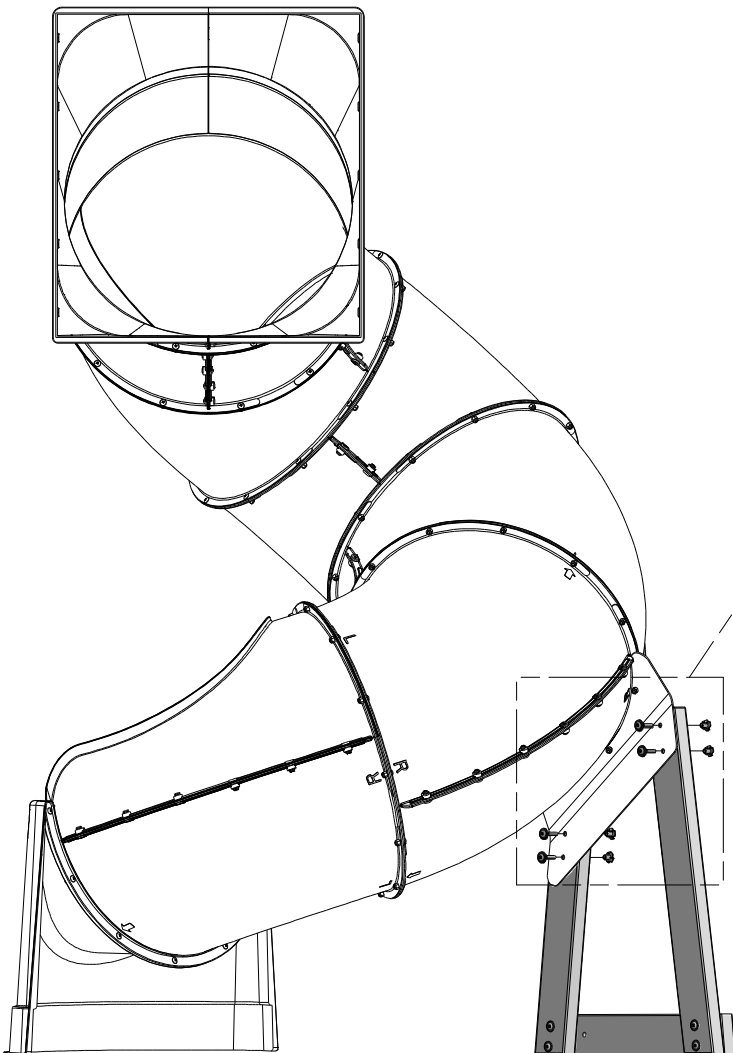

407 (x4)
BOLT - 1 1/2"

379 (x4)
T-NUT - 5/16"

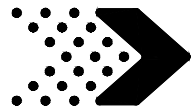

Phase 3

STEP 3

A100178 | METAL GROUND STAKE BROWN
(x2)

H100406 | BOLT WH BLK
(x2) | 1/4x1 1/2

H100474 | WASHER FLAT BLK
(x2) | 9x18

H100404 | NUT BARREL WH BLK
(x2) | 1/4x5/8

H100400 | WASHER LOCK EXT BLK
(x2) | 8x15

