

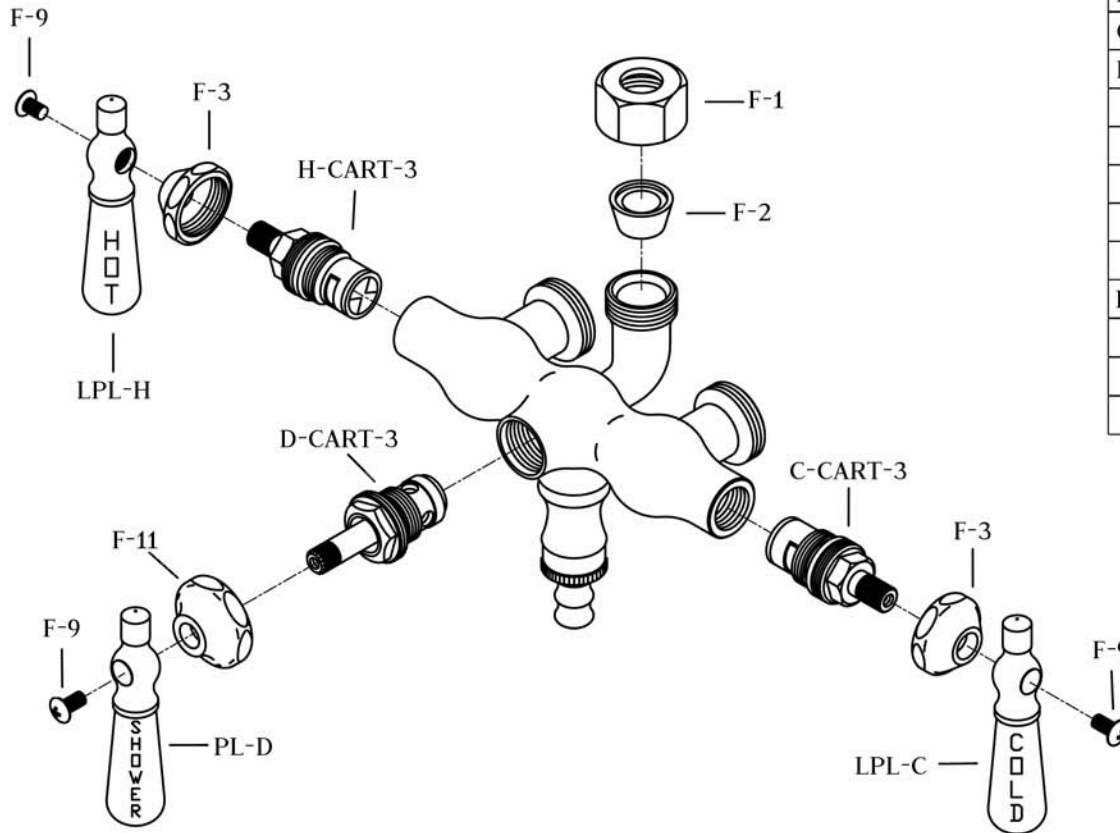

MAIDSTONE

www.MaidstoneSupply.com

Tub Downspout Faucet Body



Unpack and check all the parts, and read the instructions.

PART NO.	DESCRIPTION	QTY
C-CART-3	COLD CARTRIDGE	1
D-CART-3	DIVERTER CARTRIDGE	1
F-1	RISER NUT	1
F-2	RISER CONE WASHER	1
F-3	BELL NUT	2
F-9	LEVER HANDLE SCREW	3
F-11	DIVERTER BELL FLANGE	1
H-CART-3	HOT CARTRIDGE	1
LPL-C	COLD LEVER HANDLE (LG)	1
LPL-H	HOT LEVER HANDLE (LG)	1
PL-D	DIVERTER LEVER HANDLE (LG)	1

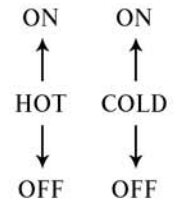



# MAIDSTONE

www.MaidstoneSupply.com

## Hand Held Shower Conversion Unit for Shower Enclosures

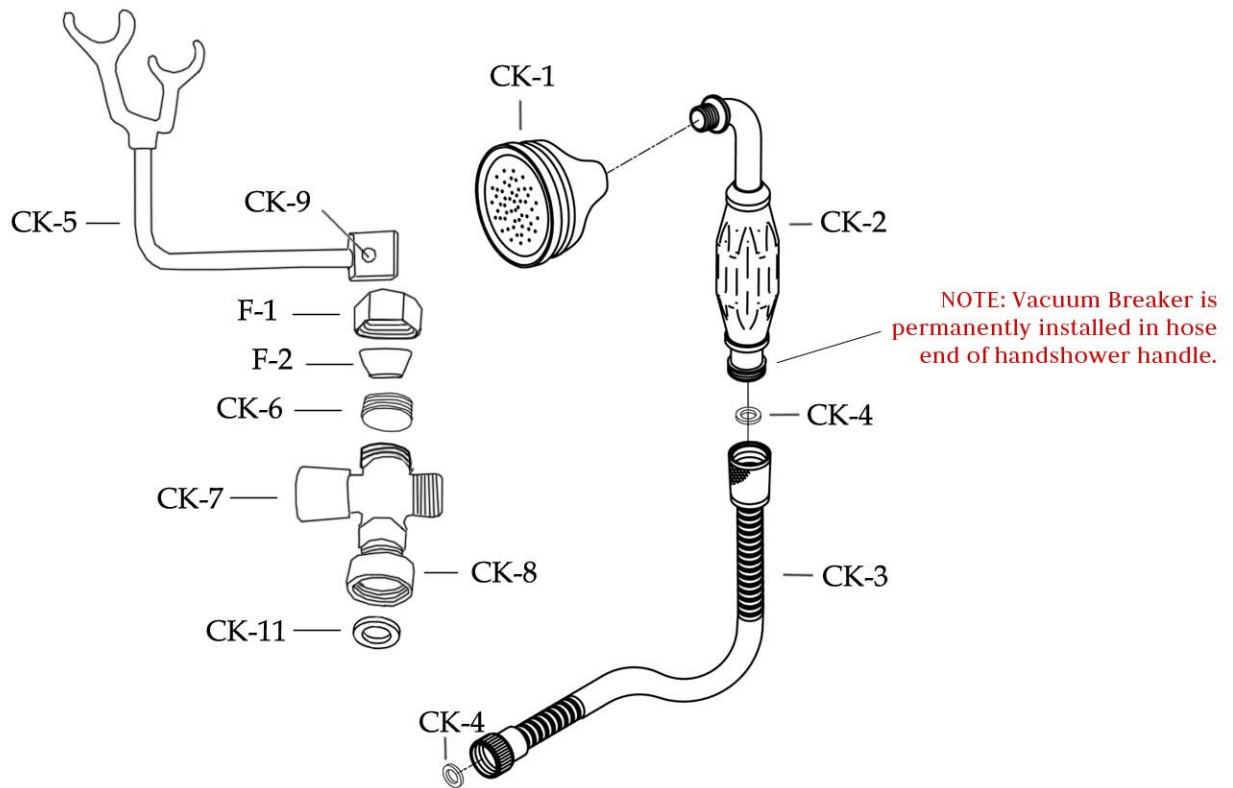

Unpack and check all the parts, and read the instructions.

PART NO.	DESCRIPTION	QTY
CK-1	HANDSHOWER HEAD	1
CK-2	HANDSHOWER HANDLE	1
CK-3	HANDSHOWER HOSE	1
CK-4	HANDSHOWER HOSE WASHERS	2
CK-5	HANDSHOWER RISER CRADLE	1
CK-6	DIVERTER BODY BUSHING	1

PART NO.	DESCRIPTION	QTY
CK-7	DIVERTER BODY	1
CK-8	DIVERTER BODY ADAPTOR NUT	1
CK-9	CRADLE SET SCREW	1
CK-11	HANDSHOWER CRADLE WASHER	1
F-1	FAUCET SLIP NUT	1
F-2	CONE WASHER (LG)	1

## COUPLER & SWING ARM PART SETS

**\*\*NOTE:** You may not receive all part sets listed below. Please refer to your order for your specific product.\*\*

**DECK MOUNT COUPLERS** - Either of these couplers can be used to attach a tub faucet to the rim of a tub.

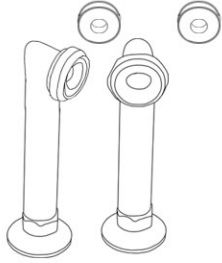

6" Deck Mount Couplers  
Part: 200

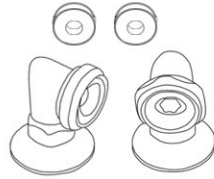

2" Deck Mount Couplers  
Part: 202

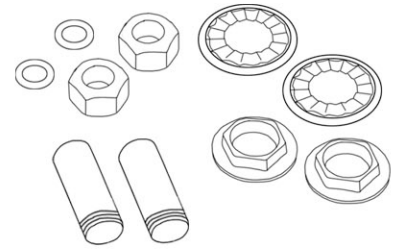

Deck Mount Hook Ups  
Part: RMT500 included in box 200 or 202

**BATHROOM WALL MOUNT COUPLERS** - Either of these couplers can be used to attach a tub faucet to the rim of a tub.

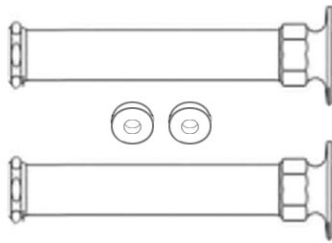

6" Bathroom Wall Mount Couplers  
Part: 170

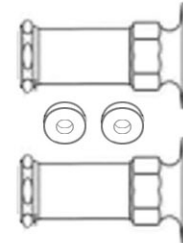

2" Bathroom Wall Mount Couplers  
Part: 160

**TUB WALL MOUNT COUPLERS** - Either of these couplers can be used to attach a tub faucet to the inside wall of a tub.

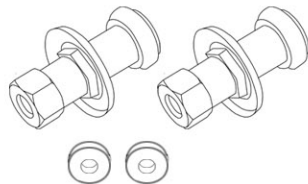

Straight Tub Wall Mount Couplers  
Part: 350

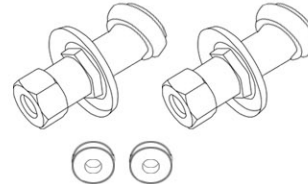

Adjustable Tub Wall Mount Couplers  
Part: A100

**DECK MOUNT /  
FREESTANDING SWING ARMS** -  
used between the couplers and the  
faucet body to create adjustable  
mounting widths.



Part: 300

**TUB WALL / BATHROOM WALL MOUNT SWING ARMS** -  
used between the faucet body and the tub or bathroom wall to create  
adjustable mounting widths.

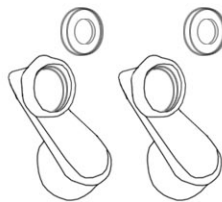

Part: 100

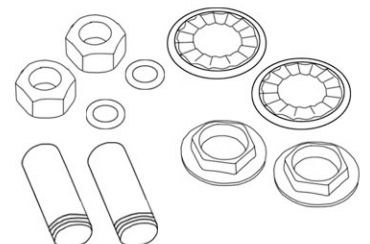

Deck Mount Hook Ups  
Part: T7550 included in box 100



MAIDSTONE

www.MaidstoneSupply.com

Side Mount Shower Conversion Kit with Showerhead

Unpack and check all the parts, and read the instructions.

PART NO.	DESCRIPTION	QTY	NOTES
E-1	48" Lower Riser Tube	1	
E-2	Riser Coupler	1	
E-3	28" Upper Riser Tube	1	
E-6	Side Mount Enclosure Tube "L"	2	
E-7	Riser Enclosure Connector	1	
E-8	Enclosure Connector	2	
E-9	5/8" Support Loop	1	Includes Set Screw
E-10	10" Wall Support Tube	2	
E-11	30" Ceiling Support Tube	2	
E-12	Wall/Ceiling Flange	4	Screws Not Included
E-13	Additional Ceiling Support Tube 30" x 1/4"	1	
E-14	Additional Ceiling Support Flange 1/4" Opening	1	
E-15	Additional Ceiling Support Loop 1/4" Connection	1	Includes Set Screws
E-18	Entire Bag Of Screws And Anchors	1	Not Shown
E-DRYWALL SCREW	Drywall Screw (Finished)	8	Not Shown
E-SET SCREW	Set Screw (Finished)	17	Not Shown
E-ALLEN SCREW	Allen Screw(No-Finish)	1	Not Shown
E-PLASTIC ANCHOR	Plastic Anchor(No-Finish)	8	Not Shown
E-60	60" Side Mount 'C' Tube	1	
	Showerhead	1	Multiple Options

