

### Features

- The bridge and switch module system allows the user to control and operate most electrical devices from the DTV+ interface
- The bridge module provides wireless communication between the DTV+ Controller and the switch modules
- DTV+ system can control up to three switch modules utilizing the bridge module
- Example applications: Bathroom lighting, bathroom fans, switchable glass, towel warmers

### Material

- Premium material construction for durability and reliability

### Installation

- On/off and dimmer switch modules must be located within 25ft of the bridge module for reliable operation
- Includes 6ft RJ45 Ethernet cable for connection to DTV+ System Controller



### Codes/Standards

cUL Listed  
UL Listed

### **KOHLER® Electronic Faucets, Valves, and Controls Five-Year Limited Warranty**

See website for detailed warranty information.

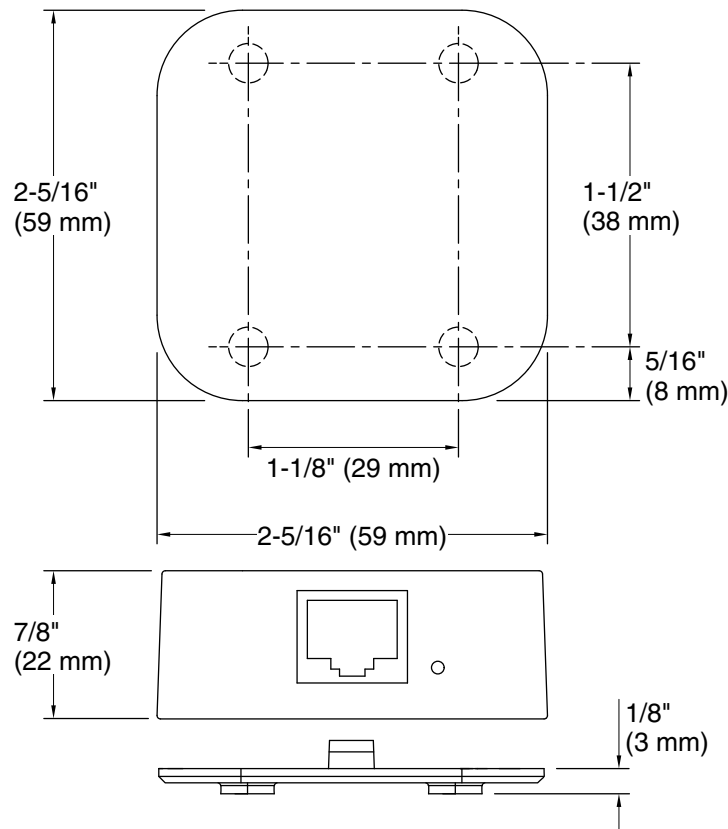

### Technical Information

All product dimensions are nominal.

Max. Ambient temp: 104°F (40°C)

Max. Relative humidity non-condensing: 95%

### Notes

Install this product according to the installation guide.

Install the bridge within 5' (1.5 m) of the DTV+ system controller or obtain a longer cable.