



Y-2 SERIES

SELF CLOSING H2O

**Y-2 Self Closing Series Specialty
Frost-Proof Yard Hydrants**



LEARN MORE ABOUT THE BEST IN THE INDUSTRY AT merrillmfg.com

Y-2 SERIES

SPECIFICATIONS

Inlet: 3/4" NPT
 Outlet: 3/4" No Lead Brass Hose Thread
 Self-Closing can be locked open or closed
 Brass Plunger with three quad ring seals
 1" Galvanized Pipe & Galvanized Internal Pipe
 Outlet stands 3-1/2" above ground level

Y-2 Hydrant Flow Rates

Water System Pressure	Gallons Per Minute (GPM)						
	0	5	10	15	20	25	30
20 PSI	13.6 GPM @ 20 PSI						
30 PSI	15.2 GPM @ 30 PSI						
40 PSI	18.8 GPM @ 40 PSI						
60 PSI	23 GPM @ 60 PSI						

NOTE: Most common 1/2 hp submersible pumps output is 10GPM.

No-Lead Standard 3/4" Inlet Y-2 Self-Closing

Order Number	UPC Bar Code (Qty. 1)	Inlet & Length	Overall Length	Approx. Wt./Lbs.
Y27502	6 42367 03054 4	3/4" x 2' Bury	29"	10.10
Y27503	6 42367 03055 1	3/4" x 3' Bury	41"	12.64
Y27504	6 42367 03056 8	3/4" x 4' Bury	53"	15.18
Y27505	6 42367 03057 5	3/4" x 5' Bury	65"	17.72
Y27506	6 42367 03058 2	3/4" x 6' Bury	77"	20.26
Y27507	6 42367 03059 9	3/4" x 7' Bury	89"	22.80
Y27508	6 42367 03060 5	3/4" x 8' Bury	101"	25.34
Y27510	6 42367 03061 2	3/4" x 10' Bury	125"	27.88

Parts List

Part Description	Part Number
Head Complete - Part No. Y-2A, Y-4, G-6, 1/8x3/8MDK	Y-2
Lock Pin	Y-2A
Roll Pin	1/8x3/8MDK
Compression Spring	Y-3
Spring Retainer	TECTM125ACUT
Countersuck Head Plug	Y-4
No Lead Hose Adapter	GNL-6
1/4" x 1/4" Socket Head Cap Screw (used before 11/1/77)	Y-7
3/8" x 5/16" Self-Locking Socket Head Cap Screw (used after 11/1/77)	Y-8
Flow Control Valve (Optional)	Y-20
3/8" Galvanized Pipe	Y-35
1" Galvanized Pipe	Y-37
Valve Body with Stainless Steel Sleeve	Y-40
Plunger with Seals	Y-41B
Quad Ring Seals (used after 11/1/78)	Y-45X
Container of Silicone Lube	A-250

Optional Accessories List

Order No. Part Description

No-Lead Vacuum Breakers

- BVBADNL75 3/4" Hose - Automatic Drain, No-Lead
- BVBNL75M 3/4" Hose - Manual Drain, No-Lead

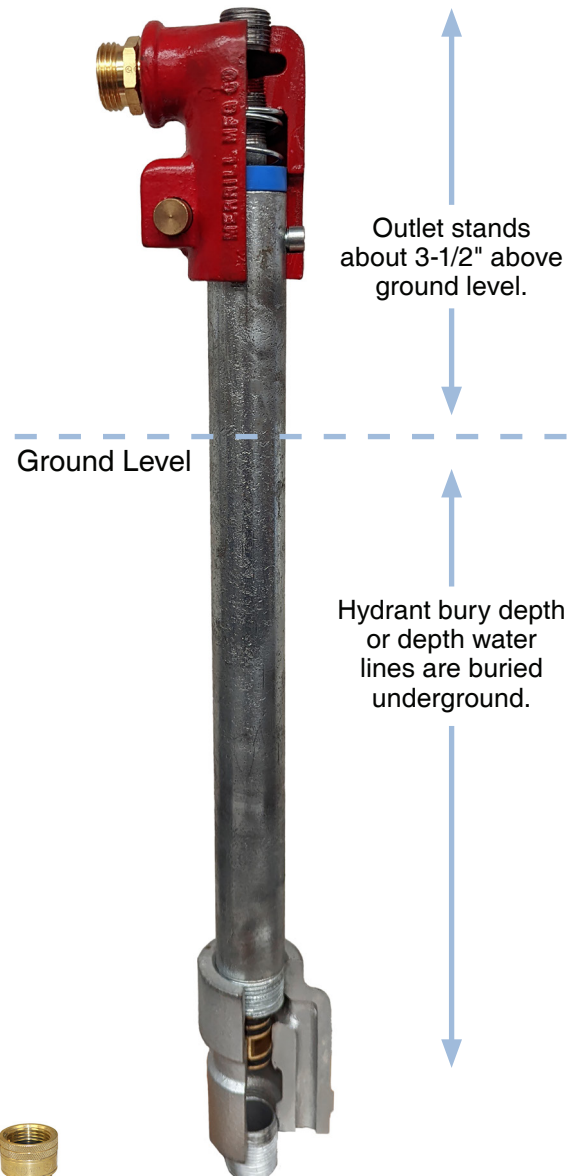

○ CA Certified (No-Lead).



FEATURES AND BENEFITS

- A Part Number: Y-2**
Heavy-duty, thick-walled head casting
- B Part Number: Y-2A**
Lock pin, simply push lock button to lock hydrant open or closed.
- C Part Number: 1/8x3/8MDK**
Roll pin
- D Part Number: Y-3**
Stainless steel compression spring and water pressure shuts off water so it's not wasted.
- E Part Number: TECTM125ACUT**
Spring retainer
- F Part Number: Y-4**
Countersuck
- G Part Number: GNL-6**
Heavy-duty no lead brass hose adapter for standard 3/4" hose coupling ensures the perfect fit.
- H Part Number: Y-7**
Manufactured after 11/1/77, 1/4" x 1/4" socket head cap screw provides strong hold for hydrant head to pipe.
- I Part Number: Y-8**
Manufactured after 11/1/77, 3/8" x 5/16" self-locking socket head cap screw provides strong hold for hydrant head to pipe.
- J Part Number: Y-20**
Standard hydrant sold without flow control valve. To install simply remove top plug.
- K Part Number: Y-35**
High quality and extra heavy 3/8" inside galvanized pipe protected from corrosion.
- L Part Number: Y-37**
High quality and extra heavy 1" galvanized pipe protected from corrosion.
- M Part Number: Y-40**
Valve body with stainless steel sleeve
- N Part Number: Y-41B**
Plunger with seals
- O Part Number: Y-45X**
Manufactured after 11/1/78, quad ring seals.

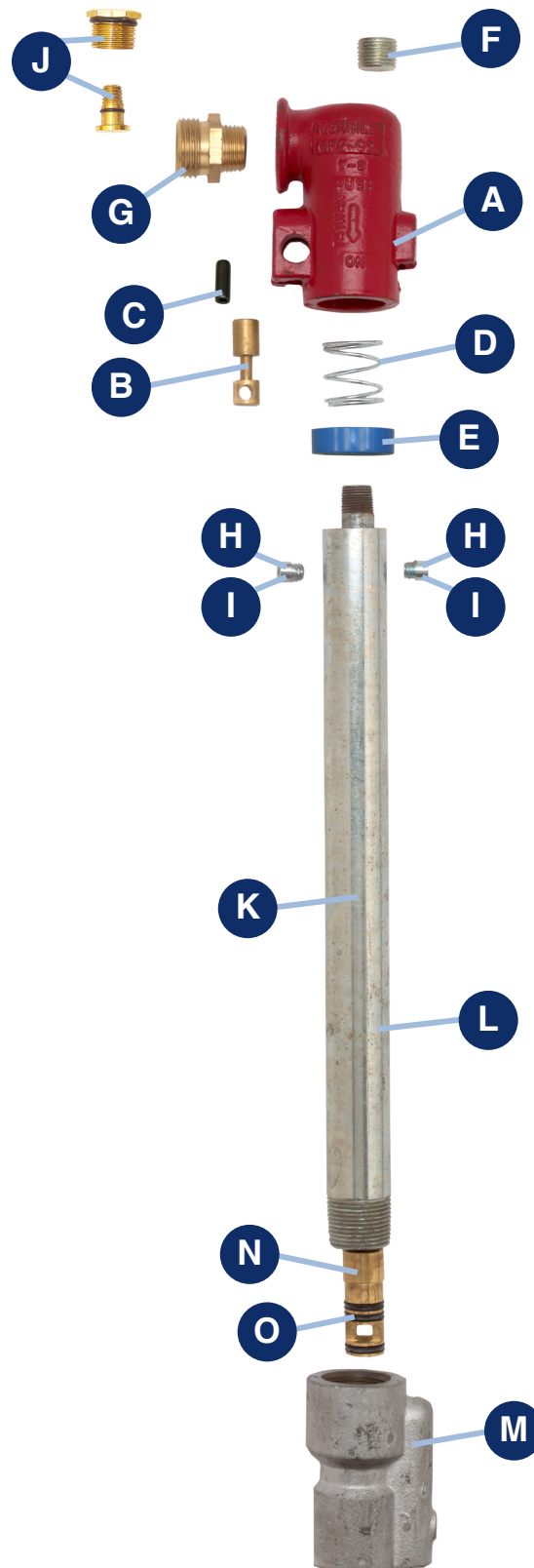

BURY DEPTH MAP

Numbers represent the recommended bury depth in feet.

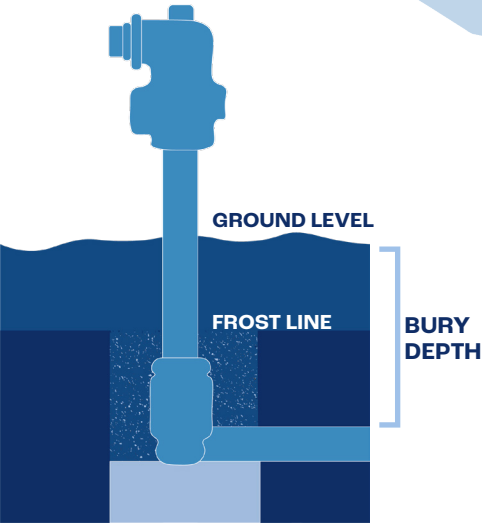
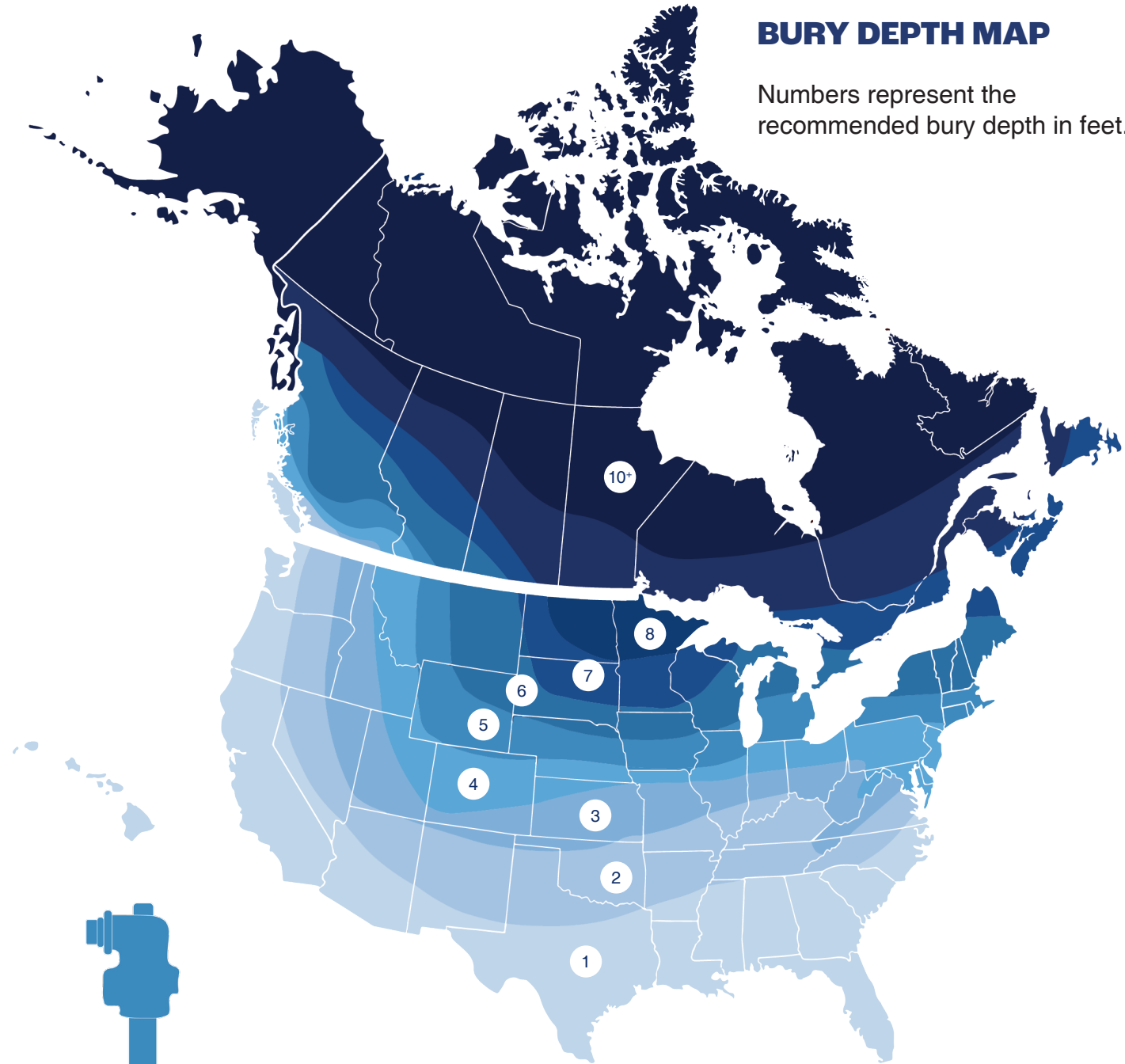

Bury Depth Information

The frost line is simply the deepest point in the ground to which ground water will freeze. It's also referred to as the frost depth. Be sure the hydrant is installed with provision for drainage below the frost line.

Numbers represent the number of feet that is the recommended bury depth for this area. Check with your local code to ensure the right length.

