

# Assembly & Installation Instructions

**CAUTION:** Read instructions carefully and turn electricity off at main circuit breaker panel before beginning installation.

## 4619

\*\*\*\*\*

**WARNING** - If any Special Control Devices are used with this Fixture, Follow the Instructions Carefully to assure full compliance with N.E.C. requirements. If there are any questions, contact a Qualified Electrical Contractor.

**WARNING** - This product contains chemicals known to the State of California to cause cancer, birth defects and /or other reproductive harm. Thoroughly wash hands after installing, handling, cleaning, or otherwise touching this product.

**CAUTION** - All glass is fragile, use care when handling Glass component(s) and or Lamp(s).

\*\*\*\*\*

**ASSEMBLY STEPS:**  
**PASOS PARA ENSAMBLAR:**  
**MODE D'ASSEMBLAGE:**

1. #29 (Ø.136) (3.5mm)

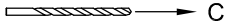

C

2. H,U,T



C

3. D,E



A

4. B,A



C

5. V



D

6. M



N

7. F



X,W,N,M

8. X



Y

9. W,N



Z

10. M



K

11. F



K,G

12. J,L



D

13. R,Q



S

14. P



S

B, C, G & P  
 (NOT FURNISHED)  
 (NO INCLUIDA)  
 (NON FOURNIE)

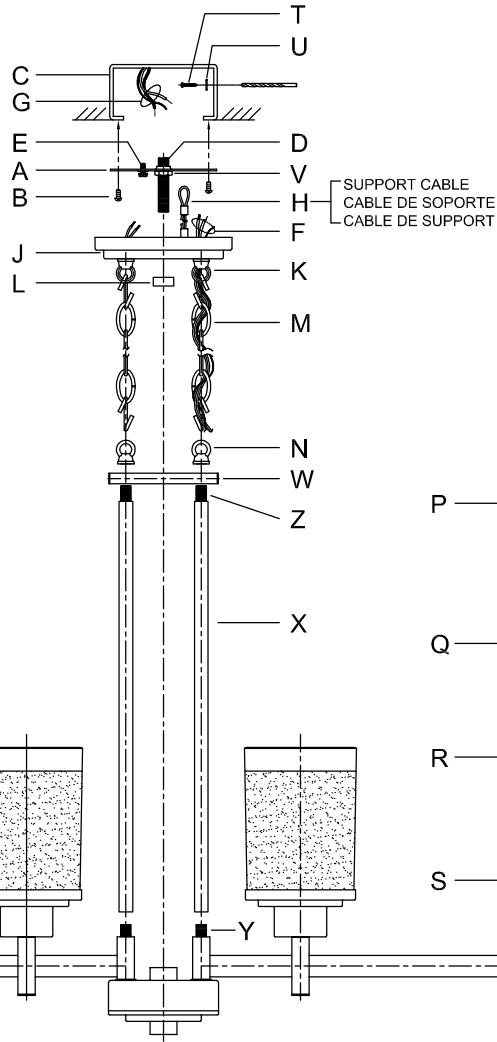
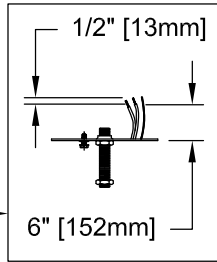

ADJUST HEIGHT WITH "D"  
 V A (TO LOCK)

AJUSTA LA ALTURA CON "D"  
 V A (APRETAR)

RÉGLEZ LA HAUTEUR AVEC "D"  
 V A (À VERROUILLER)

