

# OPEN FACE WALL CLOCK

## SET UP & USE INSTRUCTIONS

FIRSTIME & CO.<sup>®</sup>  
— HOME FURNISHINGS —

### STEP 1

Set the time by turning the adjustment wheel on the back of the clock mechanism in either a clockwise or counterclockwise direction until the hands indicate the correct time.

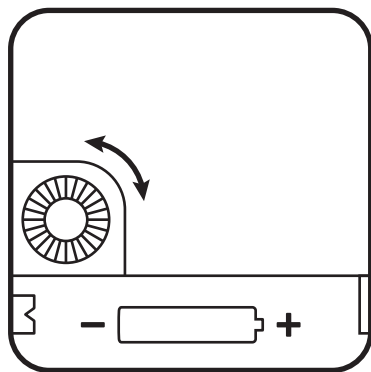

### STEP 2

To activate your clock, install a new, branded alkaline battery as indicated by the symbols on the battery case. Old or poor-quality batteries may cause your clock to lose time or stop.

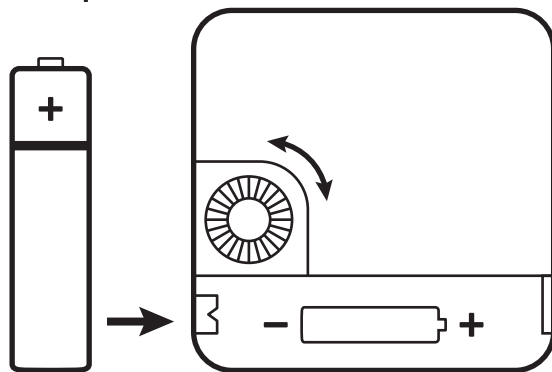

### STEP 3

Install adequate hanging hardware, not included, based on the type of wall, weight of the clock, and the hanger size. Screws and anchors are recommended for heavy clocks.

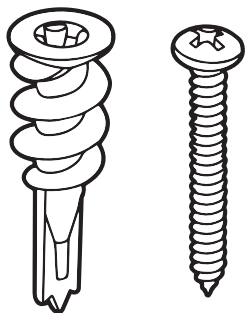

### FULLY INSTALLED

Use the built-in hanger on your clock to place it on the wall, then installation is complete.

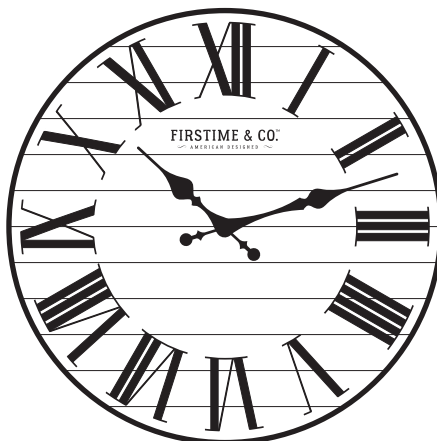

### TROUBLESHOOTING

#### OPTION A

If the clock isn't working, check if the metal prongs in the battery case are touching both ends of the battery and carefully angle them outward until they make contact with the battery.

#### OPTION B

If the hands are crossing, separate them by rotating the adjustment wheel on the back. Hands should be parallel to each other.

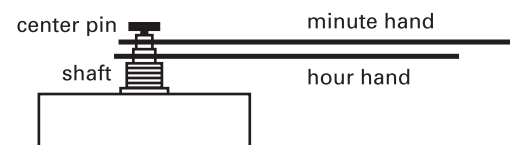

#### OPTION C

If the hands are loose, press each hand and the center pin onto the shaft securely from the front. Some center pins need to be screwed on. Hands can also be bent slightly from the front if they are touching.

# OPEN FACE WALL CLOCK

## HAND REPLACEMENT INSTRUCTIONS

**FIRSTIME & CO.®**  
— HOME FURNISHINGS —

### PARTS

**A**



**B**



**C**



### STEP 1

If the hands are damaged, remove the center pin (C) by gently pulling up and away from the clock or unscrewing it. Repeat this with the minute and then the hour hand.

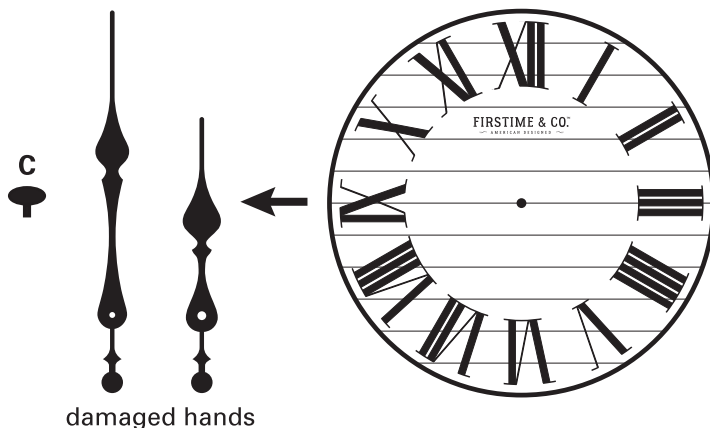

### STEP 2

Have your new set of hands ready. Place the hour (short) hand (A) onto the shaft and gently push down. Point the hand to the 12 position.

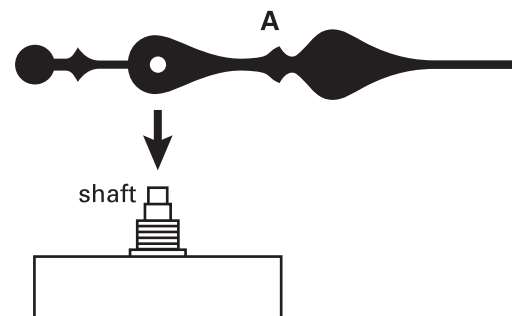

### STEP 3

Place the new minute (long) hand (B) onto the shaft and gently push down. Point the hand to the 12 position.

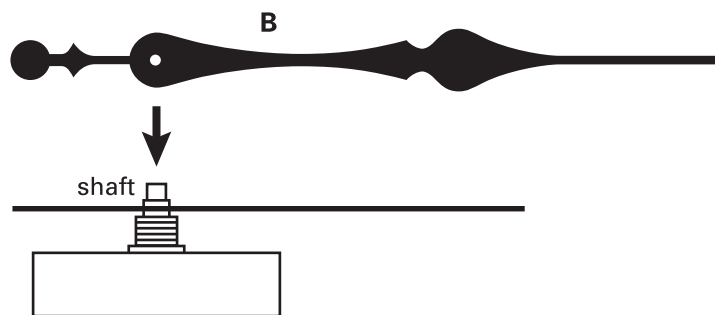

### STEP 4

Place the old center pin (C) back on top of the shaft and gently push down or screw it on. Set the time and install the battery, then assembly is complete.

