



TODAY'S DESIGN HOUSE
 MEQUON, WI 53092
 © 2002

MADE IN CHINA

MOUNTING AND WIRING INSTRUCTIONS

CAUTION: MAKE SURE ELECTRICITY IS TURNED OFF AT MAIN FUSE BOX DURING INSTALLATION

ATTENTION: ASSUREZ-VOUS QUE LE COURANT SOIT COUPE AU TABLEAU DES FUSIBLES PENDANT TOUTE L'INSTALLATION.

PRECAUCION: ASEGURESE DE QUE HA CORTADO LA ELECTRICIDAD EN LA CAJA DE FUSIBLES DURANTE LA INSTALACION

1. Connect the black fixture wire to the current carrying (black) supply wire. Connect the white fixture to the neutral (white) supply wire. Connect the fixture ground wire (green or bare) to the supply ground wire or ground screw.

2. Place post canopy over post and secure with set screws or self-tapping screws.

NOTE: When using self-tapping screws, drill a 1/8" dia. hole in the post prior to installing screw.

1. Connecter le fil noir du bati au fil d'alimentation noir, le fil blanc du bati au fil d'alimentation blanc, le fil de mise a la terre a le cordon comme montre.

2. Installer la rosace de poteau sur le poteau et le fixer a l'aide de vis de pression ou de vis a tole auto-taraudeuses se trouvant dans le poteau. ATTENTION: Pour installer la vis-tarauds, perce le poteau avec une 3mm.

1. Conecte el alambre negro del accesorio al alambre negro de alimentacion, el alambre blanco de alimentacion, y el alambre de descarga a tierra al tornillo de descarga a tierra. Conecte el cable como se indica.

2. Coloque el escudete del poste sobre el poste y asegurelo con los tornillos prisioneros o autorroscantes.

NOTA: Cuando us un tornillo autorroscante, haga un agujero de 1/8 de pulgada (3mm) en el poste antes de insertar el tornillo.

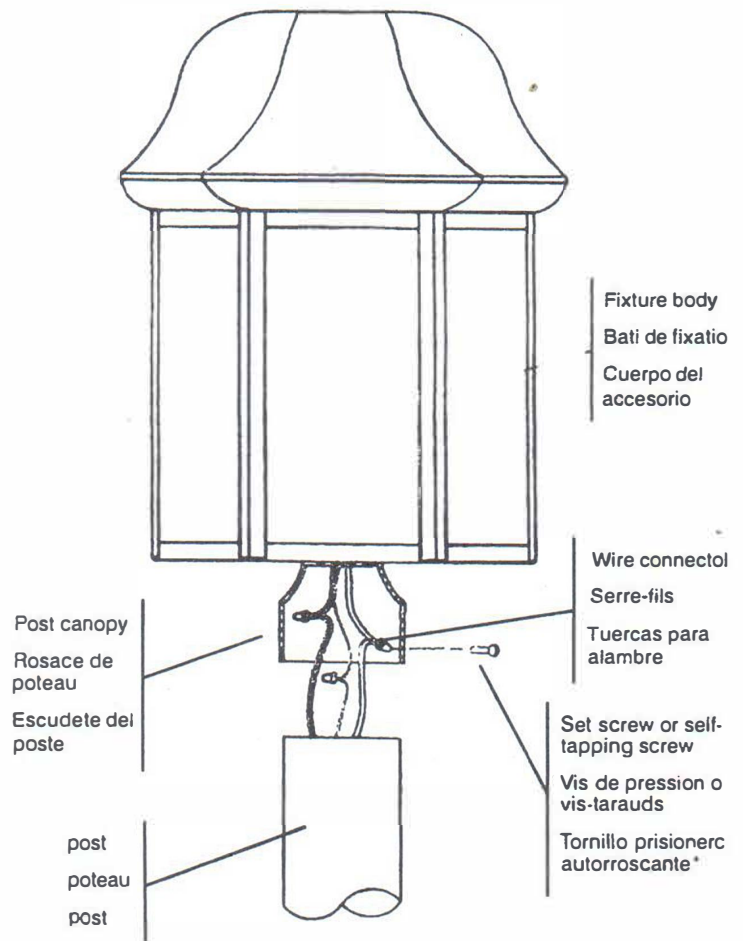

Your new Design House pier base mount will give you years of trouble-free performance. Thank you for choosing our product for your home. **Please read carefully and save these instructions, as you may need them at a later date.**

Required Tools

- Caulk
- Phillips Screwdriver

What's in the box

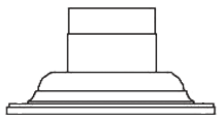

A



B 1-1/2 in Self-Tapping Screws x4



C Anchors x4

Caution

This product contains chemicals known to the State of California to cause cancer, birth defects and/or other reproductive harm. Thoroughly wash hands after installing, handling, cleaning, or otherwise touching this product.

If in doubt about electrical installation, consult a licensed electrician

All electrical connections must be made in accordance with local and National Electrical Code (NEC) standards.

If you are unfamiliar with proper electrical wiring connections, obtain the services of a qualified electrician.

Remove the fixture and the mounting package from the box and make sure that no parts are missing by referencing the illustrations on the installation instructions. Tools are required when installing this fixture.

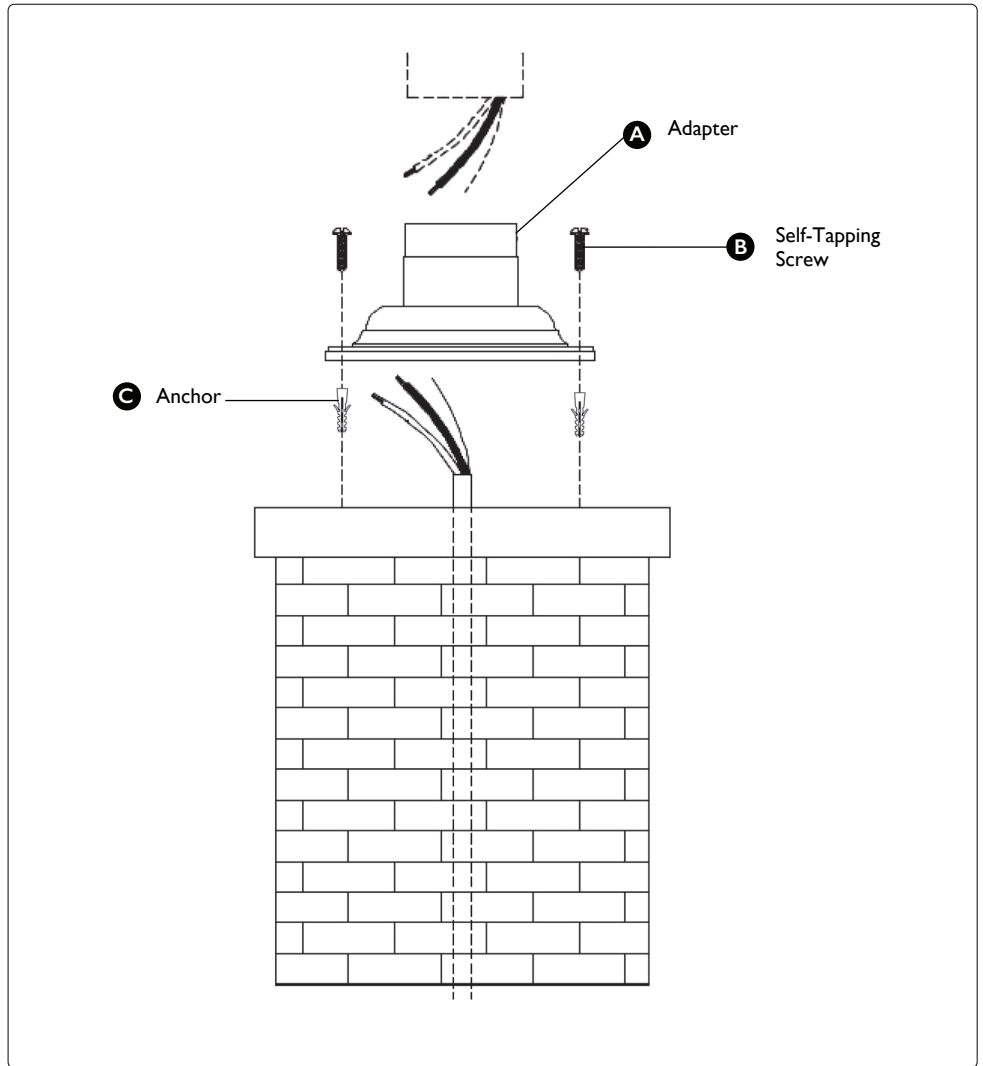

Steps to Install

1. Before installation, turn off the power at fuse or circuit breaker.
2. Carefully unpack and identify all parts.
3. Using the **adapter (A)** as a guide, lay out location of the 9/32 inch diameter anchor holes and position of conduit power feed (*not included*).
4. Install conduit power feed through pedestal (*not included*) so it protrudes at least one inch above top surface of pedestal.
5. Set **anchors (C)** into anchor holes.
6. Set **adapter (A)** onto pedestal with holes aligned with **anchors (C)**. Secure **adapter (A)** to pedestal with **screws (B)** provided. Caulk around base of **adapter (A)** to prevent water from entering.
7. Install fixture according to instructions furnished with fixture threading power wires through conduit power feed.
8. Connect supply cable to power source according to NEC and UL requirements.
9. After installation, turn on the power at fuse or circuit breaker.