

# FLEXSTEEL®

## W1020-8311 / 8312

### RECTANGULAR DINING TABLE

#### IMPORTANT

Carefully remove all parts from the carton, and put them individually on a soft cloth to prevent damage to the parts.

We have taken great care in the design of this product and request that you carefully and accurately follow our assembly instructions to ensure proper set-up.

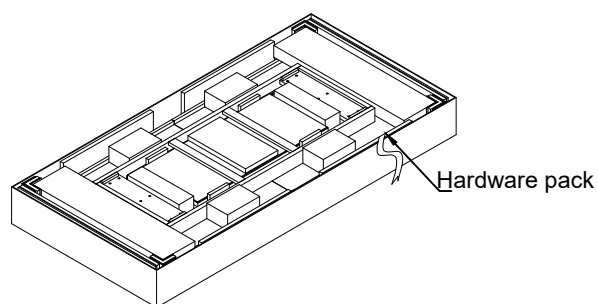
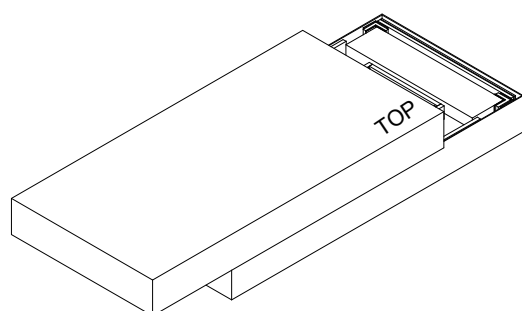
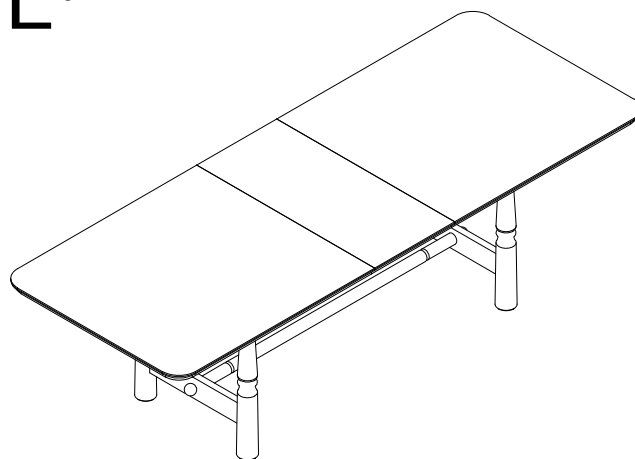

#### Part List

#### Assembly Instructions 1/5

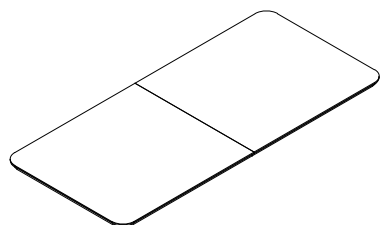

A. Table Top  
1 piece

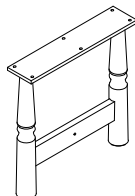

B. Leg  
2 pieces

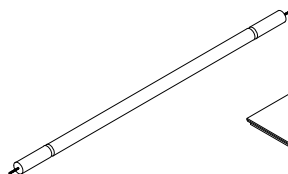

C. Stretcher  
1 piece

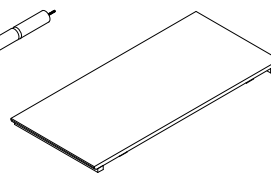

D. Extension Leaf  
1 piece



E. Wooden Buttons  
2 pieces

#### Hardware List

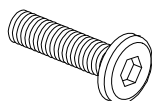

Bolt  
Ø5/16"-18 UNC x 1-1/2"  
12 pieces



Spring Washer  
Ø5/16" x 1.5mm  
12 pieces



Flat Washer  
Ø5/16" x Ø19mm x 1.5mm  
12 pieces

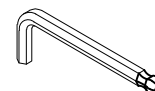

Hex Key  
5/32"  
1 piece

# FLEXSTEEL®

## Assembly Instructions 2/5

### IMPORTANT NOTES

- Do not tighten up all the bolts until each part is properly assembled.
- Keep the Hex Key in a safe place as you may need to tighten up the bolts in the future.
- Use a soft cloth between these parts and the floor.
- We recommend this product be assembled by at least two adults.

### STEP 1

Insert the threaded bolts on the ends of Stretcher (C) through the hole on each Leg (B). Attach the Wooden Buttons (E) to each end of the Stretcher (C) by rotating the Wooden Buttons (E) clockwise by hand (See Figure 1). Do not fully tighten them at this time.

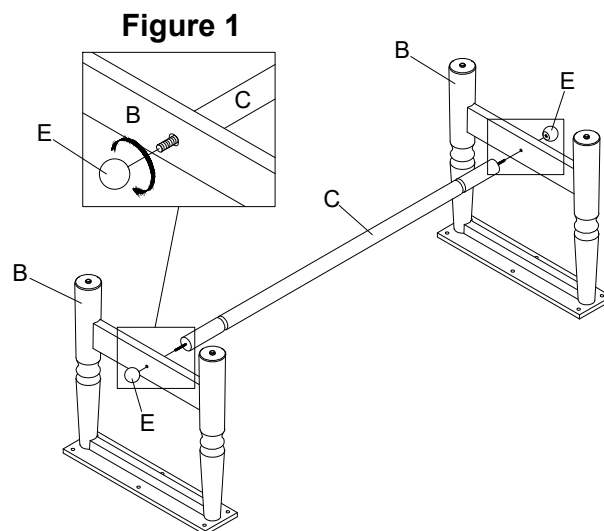

### STEP 2

Attach the Legs (B) to the Table Top (A) using the Bolts, Spring Washers, and Flat Washers. Fully tighten the bolts using the Hex Key (See Figure 2). Finally, fully tighten all the Wooden Buttons (E) from Step 1

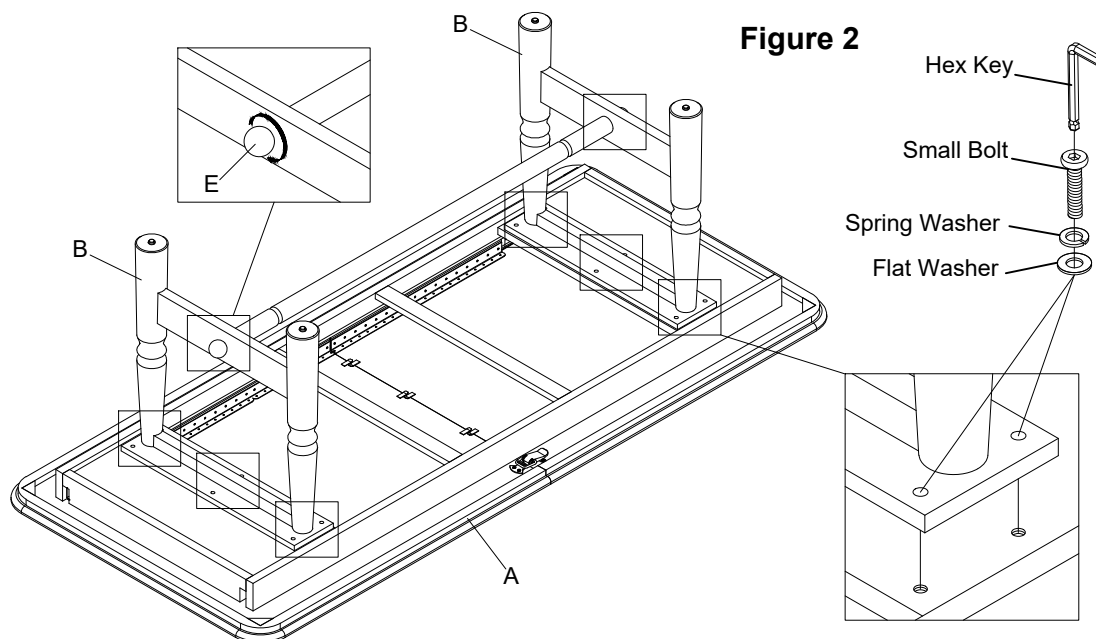

# FLEXSTEEL®

## Assembly Instructions 3/5

### STEP 3

Ask for assistance to lift the unit upright and position it at the desired location.  
Adjust the levelers on the legs until the furniture is leveled. (See Figure 3)

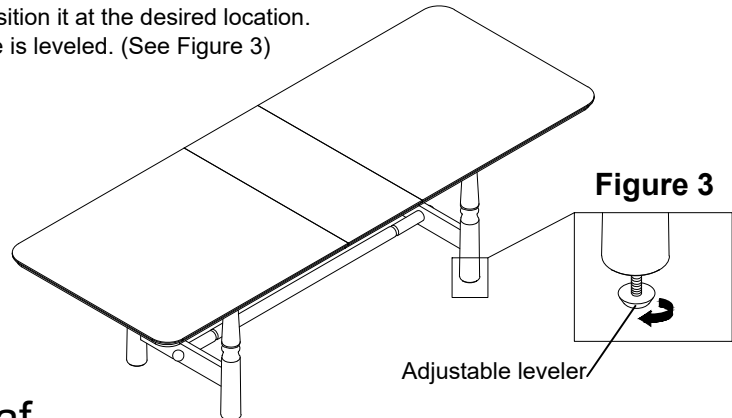

### To Retrieve Extension Leaf

1. Unlock and release the latches on both sides of the Table Top (A). Pull the table top apart from both ends. (See Figure 5)
2. Lift the Extension Leaf (D) out of the Table Top compartment (A) as shown and place it in the center of the Table Top frame. Ensure the Leaf (D) is oriented correctly such that the pins on one edge of the leaf will properly locate into the holes on the edge of one side of the Table Top (A). (See Figure 6)
3. Push the Table Top (A) from both ends, ensuring all pins properly locate into all holes in both the top and the Leaf (D). Latch and lock the latches underneath each side of the Table Top (A) and Leaf (D). (See Figure 7)

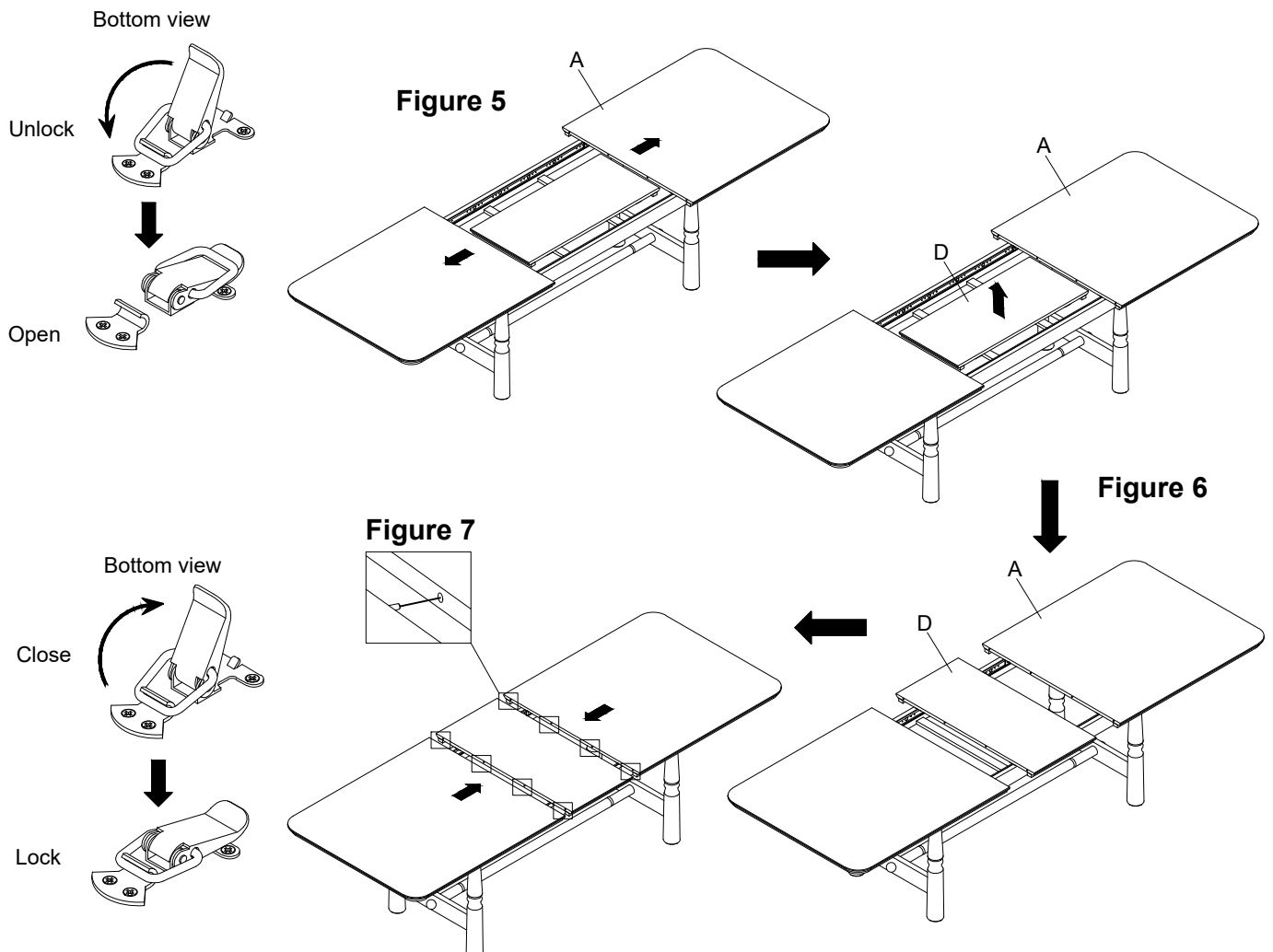

### To Store Extension Leaf

1. Unlock and release the latches on both sides of the Table Top (A) and Leaf (D).  
Pull the table top apart from both ends. (See Figure 8)
2. Lift the Extension Leaf (D) from of the Table Top (A) to store within the compartment. (See Figure 9)
3. Push the Table Top (A) from both ends, ensuring all pins properly locate into all holes in both the top. Latch and lock the latches underneath each side of the Table Top (A). (See Figure 10)

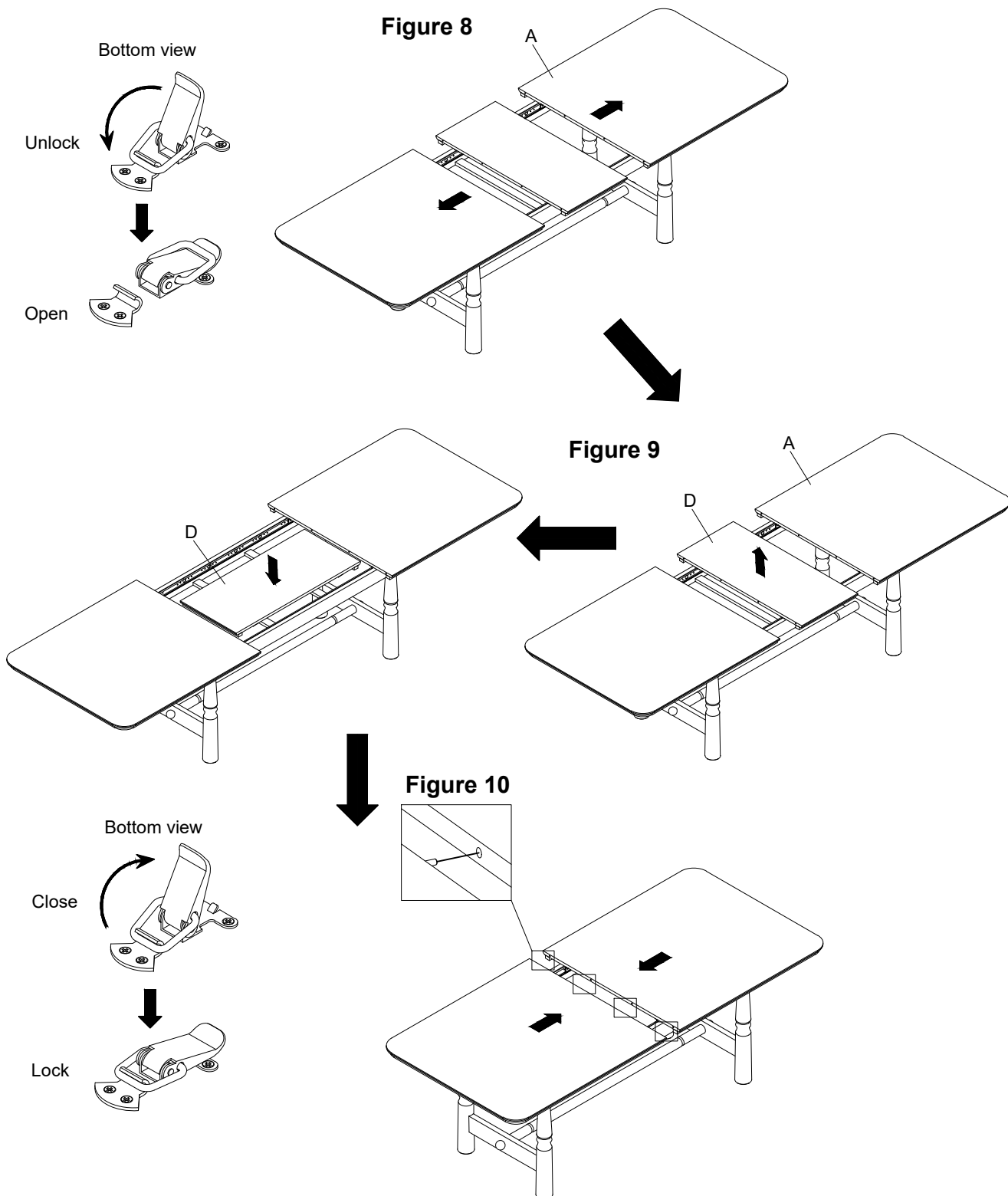

# FLEXSTEEL®

Assembly Instructions 5/5

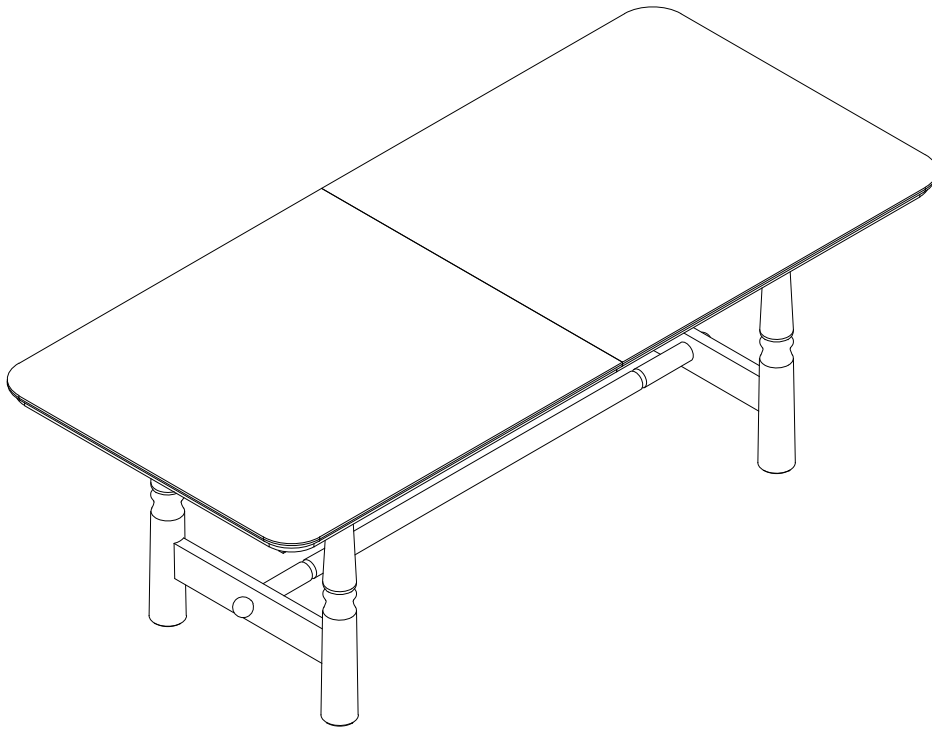

## CARE INSTRUCTIONS

- To avoid scratches, do not place sharp or jagged objects directly on the table top.
- Do not place hot items directly on the table top.
- Use placemats or trivets under hot items and coasters under beverages to prevent marks and stains.
- Avoid the use of harsh chemicals or abrasive cleaning materials.
- Wipe the table clean with a soft, dry cloth after each use.
- Wipe up spills quickly with a soft, dry cloth.

Flexsteel Industries, Inc.

For Parts or Customer Service call

toll-free:

1-888-415-3979

Monday-Friday

8:00 a.m. -5:00 p.m.

(Central Time)

Email:

[customersolutions@flexsteel.com](mailto:customersolutions@flexsteel.com)

[www.flexsteel.com](http://www.flexsteel.com)