

Robie 3 Light Chandelier

3121603, 3121605 1.0

GENERATION LIGHTING

CAUTION - RISK OF FIRE

This product must be installed in accordance with the applicable installation code by a person familiar with the construction and operation of the product and the hazards involved.

Use minimum 90°C supply conductors.

GENERAL PRODUCT INFORMATION:

These fixtures are intended to be installed utilizing NEC compliant junction boxes.

This product is safety listed for damp locations.

Incandescent version may be dimmed with a standard incandescent dimmer. LED version may be dimmed with a LED dimmer. Consult lamp manufacturer for additional information.

This instruction shows a typical installation.

GENERATION LIGHTING

7400 Linder Ave, Skokie, IL 160077

800.969.3347

www.visualcomfort.com

©2023 Visual Comfort & Co.. All rights reserved. The Visual Comfort & Co. logo is a registered trademark of Visual Comfort & Co. Visual Comfort & Co. reserves the right to change specifications for product improvements without notification

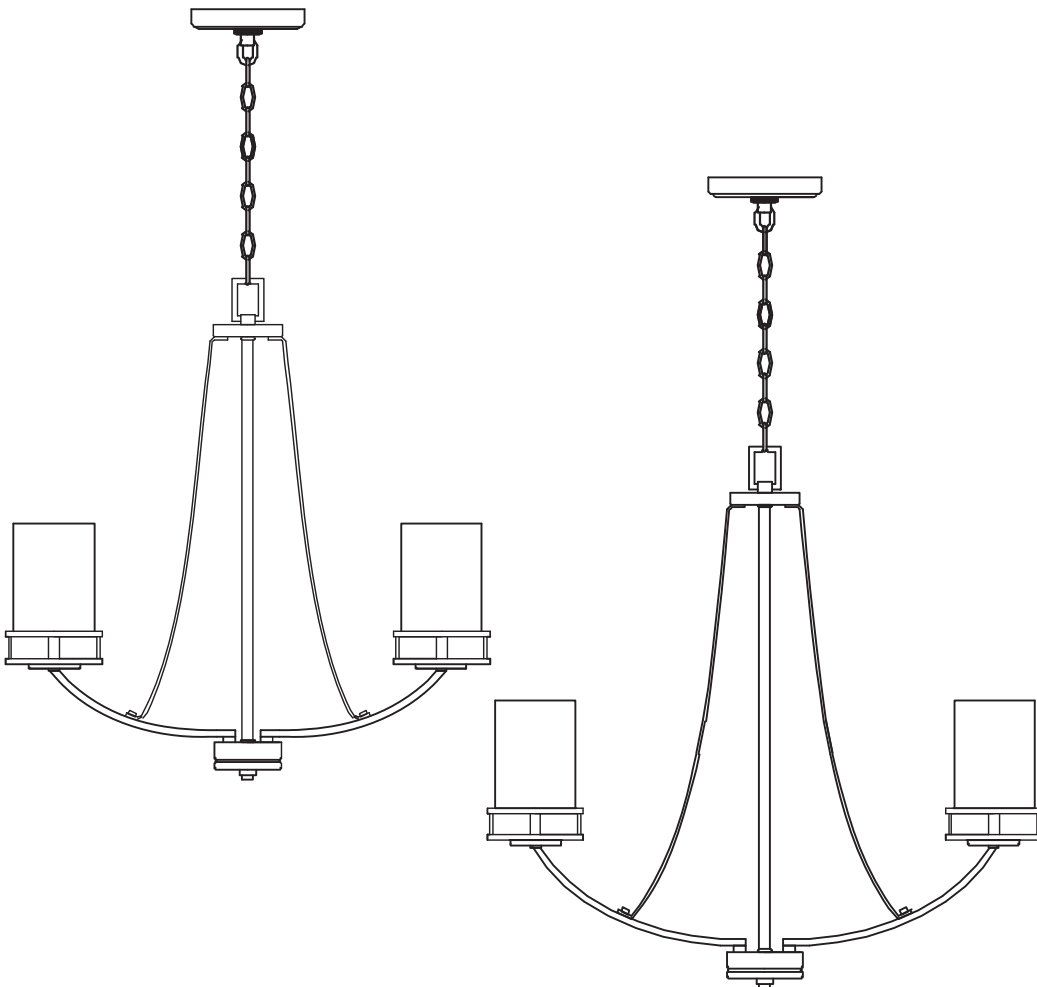

SAVE THESE INSTRUCTIONS!

Install the Fixture

1A

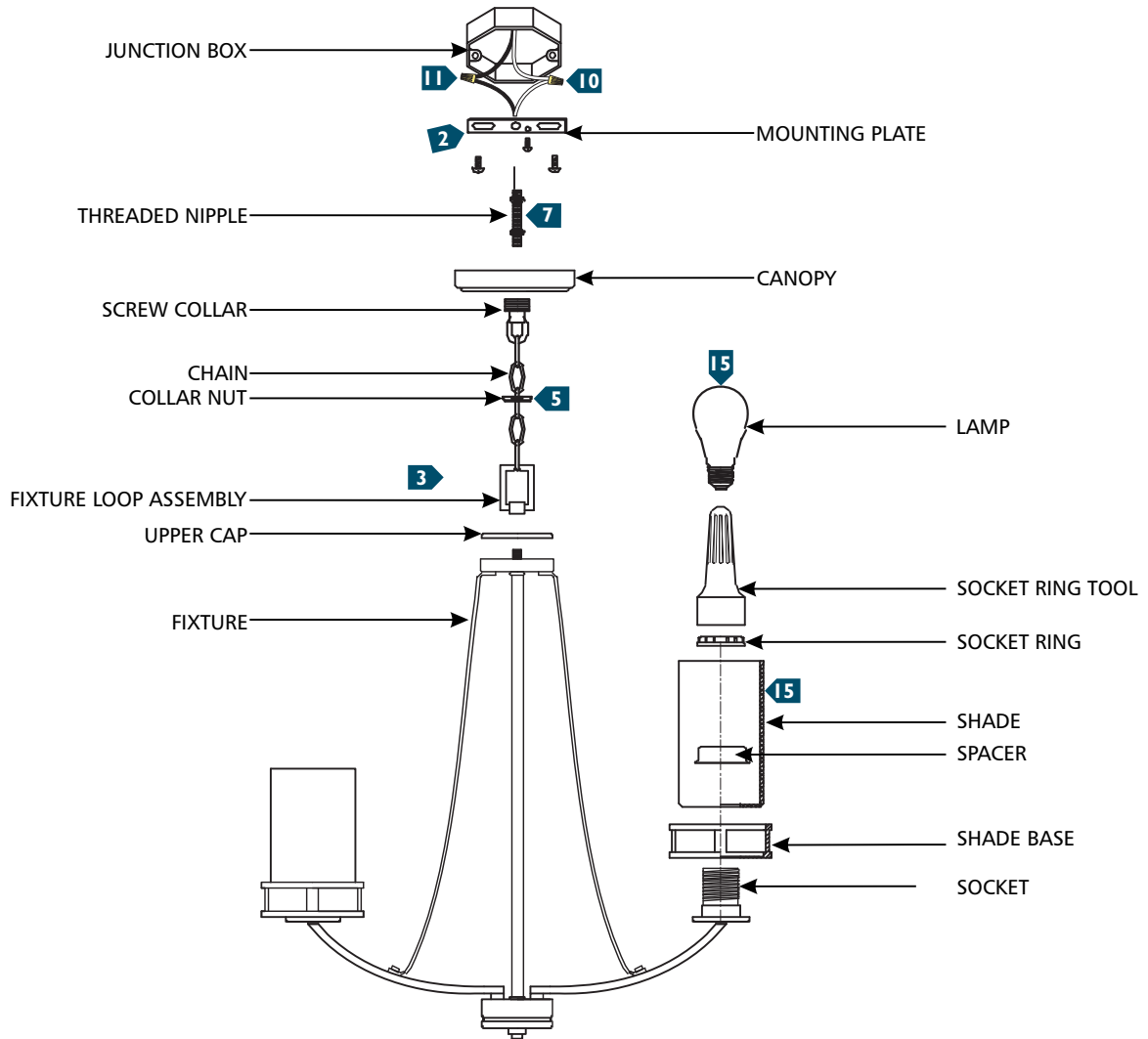

- 1** If necessary, screw the shorter end of the threaded nipple tightly onto the mounting plate and the screw collar onto the threaded nipple.
- 2** Secure the mounting plate to the junction box.
- 3** Feed the cord from the fixture through the upper cap and fixture loop assembly and screw them together.
- 4** Determine the wanted height of the fixture and remove a portion of the chain by opening a link with pliers.
- 5** Open the chain link with pliers and install the chain on the fixture loop, then re-close the chain link.
- 6** Unscrew the collar nut from the screw collar, install the collar nut and the canopy onto the chain (in that order).
- 7** Open a link on the other end of the chain with pliers and install the chain onto the screw collar to secure the fixture, re-close the link.
- 8** Weave the cord through the chain, canopy, collar nut, screw collar, threaded nipple, and out of the junction box. Trim the cord leaving enough to make electrical connections.
- 9** Connect the fixture to a suitable ground in accordance to local electrical codes.
- 10** Connect the white fixture wire (square and/or rigid) to the neutral power line wire with a wire nut.
- 11** Connect the black fixture wire (round and/or smooth) to the hot power line wire with a wire nut.
- 12** Neatly place all the wires into the junction box, place the canopy onto the ceiling, and secure it in place by screwing the collar nut tightly onto the screw collar.
- 13** Place the shade base, shade and space over the socket and secure in place with the socket ring using the socket ring tool.
- 14** Screw the lamps into the sockets. Refer to the label on the socket for Max Wattage Information.
- 15** Place two washers onto the threaded pipe and slide the shade over the center rod and secure in place with two more washers and the other hex nut.
- 16** Place the lower cap on to the threaded pipe and secure in place with the finial.