

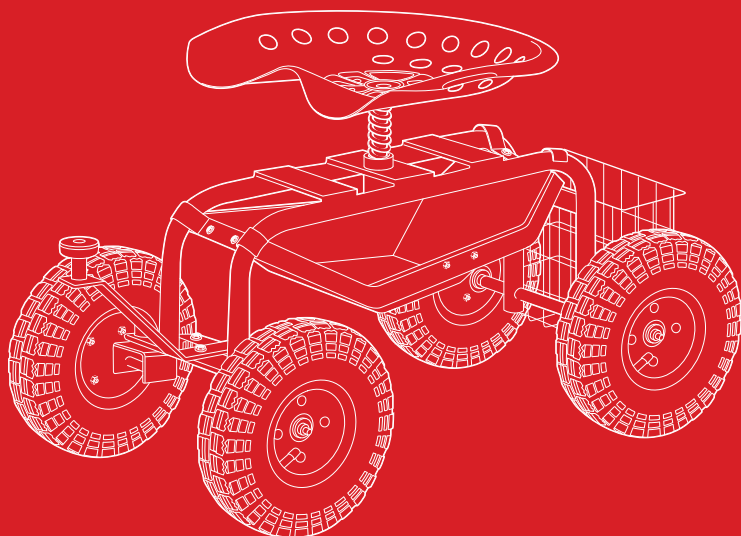

bestchoiceproducts



INSTRUCTION MANUAL

Rolling Garden Work Seat



bestchoiceproducts

As shoppers, we're always trying to find the perfect balance between quality & value. At BCP, we believe we've achieved that. Our diverse catalog of everyday essentials is tailored especially to our customers & guaranteed to hit that sweet spot of high quality & low price.

— Always. —

! NOTICE

- Please do not exceed the weight limitations of this item.
- Do not stand on or use any part of this item as a step ladder.
- Firmly secure all bolts, screws and knobs before use.
- Reconfirm that all bolts, screws, and knobs are secure every 90 days.
- Be aware that some parts are heavy and have sharp edges.
- If any parts are missing, broken, damaged, or worn, stop using this product until repairs are made and/or factory replacement parts are installed.
- Do not use this item in a way inconsistent with the manufacturer's instructions as this could void the product warranty.

⚠ WARNING

- Do not overinflate the tires. Maximum pressure is **30 PSI**.
- Do not use on inclines; seat may tip over.
- Do not operate if any parts are damaged or broken.

TOOLS REQUIRED



PHILLIPS
SCREWDRIVER



ADJUSTABLE
WRENCH



NEEDLE NOSE
PLIERS



300 LBS
SEAT
CAPACITY



5 LBS
TRAY
CAPACITY



1 PERSON
ASSEMBLY



APPROXIMATELY
45 MIN.
ASSEMBLY

HARDWARE

1

M6 BOLT SET

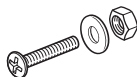

6 PCS

2

M8 X 20MM
BOLT SET

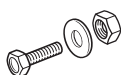

3 PCS

3

M8 X 30MM
BOLT SET

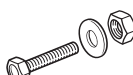

1 PC

4

M10 BOLT SET



4 PCS

5

M8 WASHER



2 PCS

6

M12 WASHER



4 PCS

HARDWARE

7

M8 NUT



2 PCS

8

M16 LARGE
WASHER



1 PC

9

COTTER PIN



1 PC

PARTS

A

FRAME

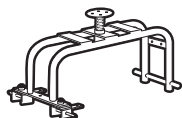

1 PC

B

SEAT



1 PC

C

PLASTIC TRAY

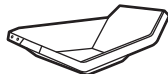

1 PC

D

BASKET



1 PC

E

REINFORCING
PLATE



3 PCS

F

HANDLE



1 PC

G

TRAY BRACKET

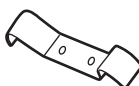

2 PCS

H

WHEEL



4 PCS

I

REAR AXLE

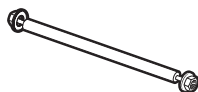

1 PC

J

STEERING
CONNECTOR



1 PC

PRODUCT ASSEMBLY

1

Place a part E reinforcing plate into the D basket and attach it to the rear of the part A frame with two part 1 bolt sets.

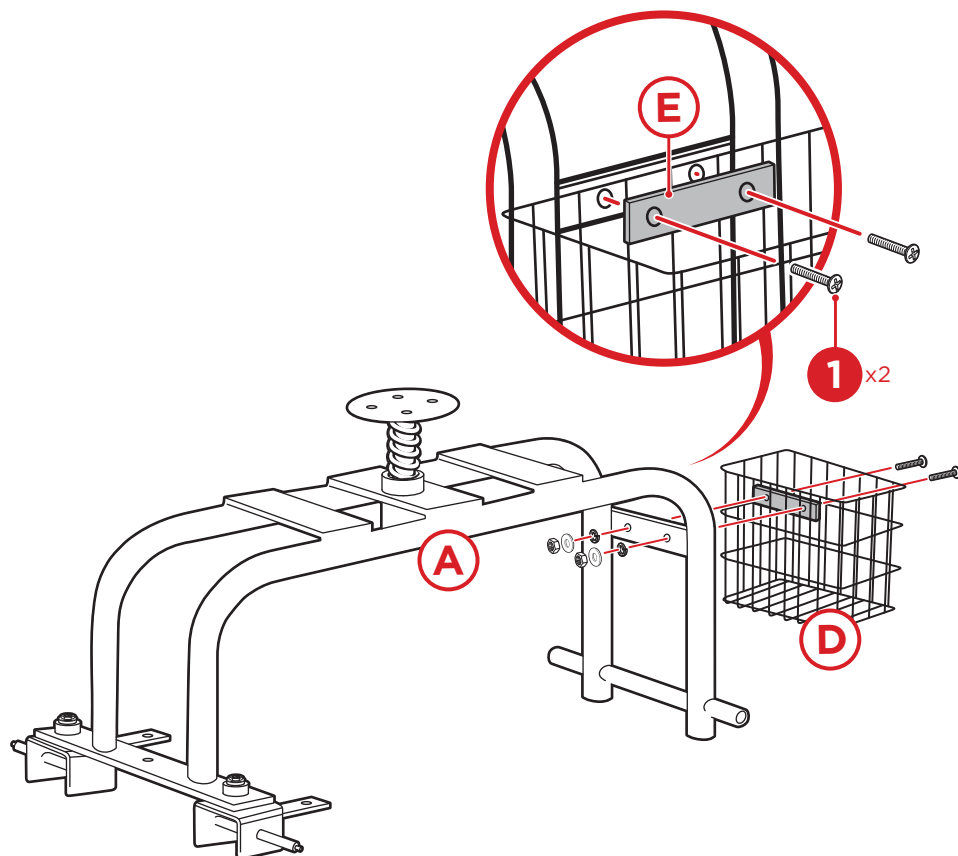

PRODUCT ASSEMBLY

2

Place two part G tray brackets on the frame and attach the part C plastic tray with four part 1 bolt sets and two part E reinforcing plates.

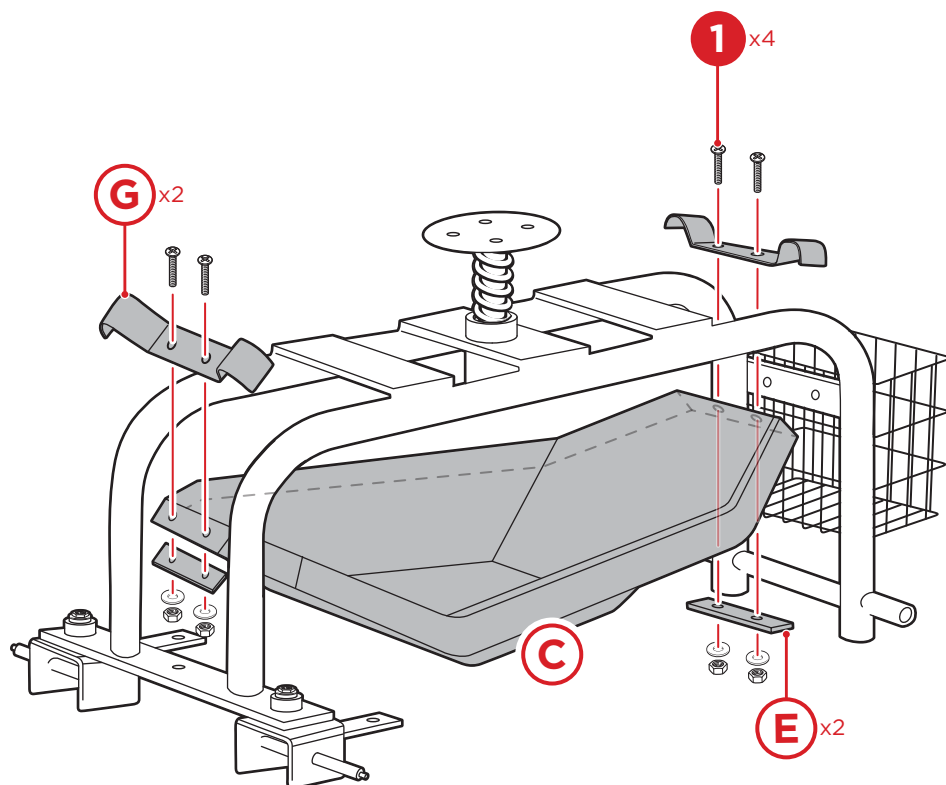

PRODUCT ASSEMBLY

3

Attach the part J steering connector with two part 2 bolt sets.

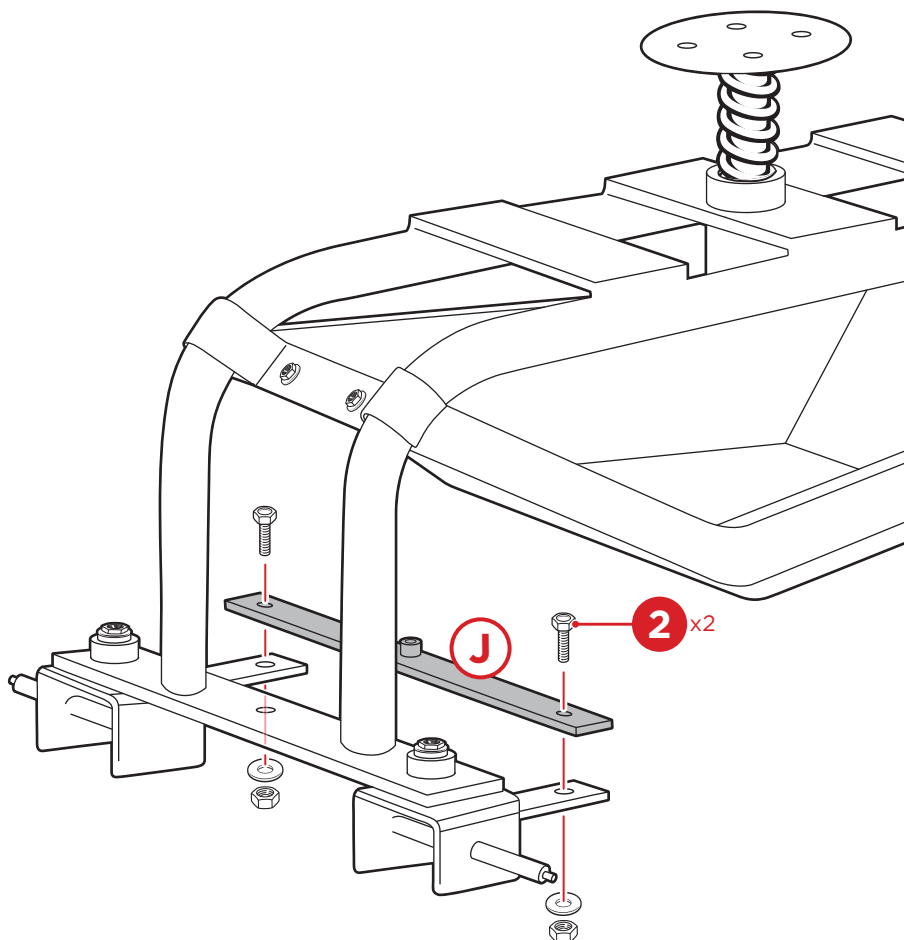

PRODUCT ASSEMBLY

4

Attach the part F handle with a part 2 bolt set and part 3 bolt set.

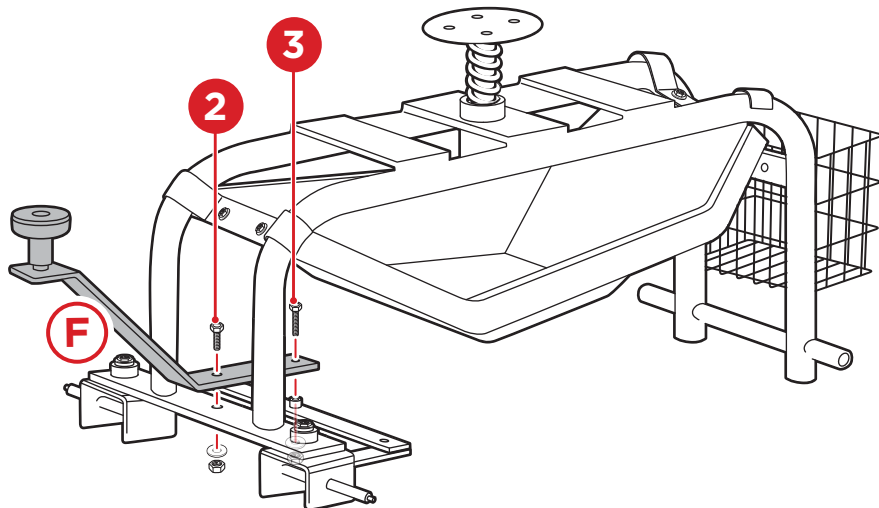

5

Remove the nuts and washers from the part I rear axle. Slide the rear axle into the rear of the frame.

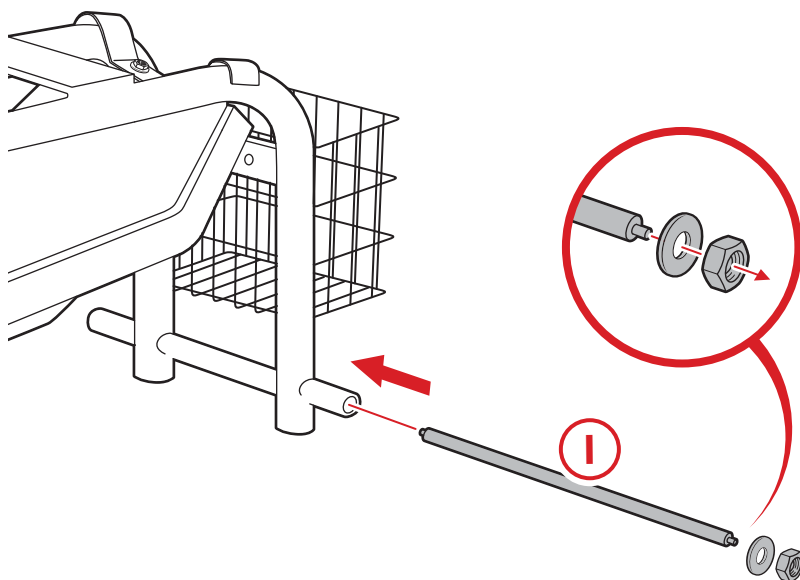

PRODUCT ASSEMBLY

6

Slide two part 6 washers onto the rear axle. Slide on two part H wheels, then replace the washers/nuts to secure the wheels.

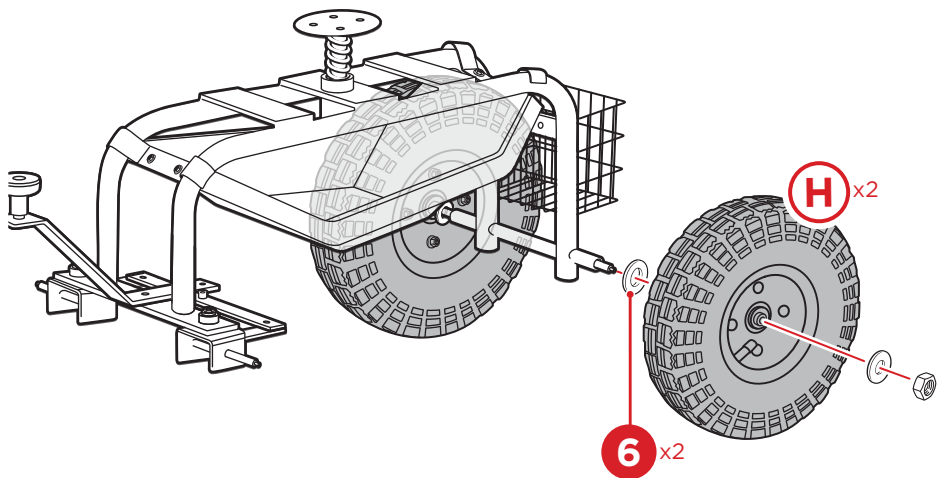

7

Slide two part 6 washers onto the front axle. Slide on two part H wheels and secure with two part 5 washers and two part 7 nuts.

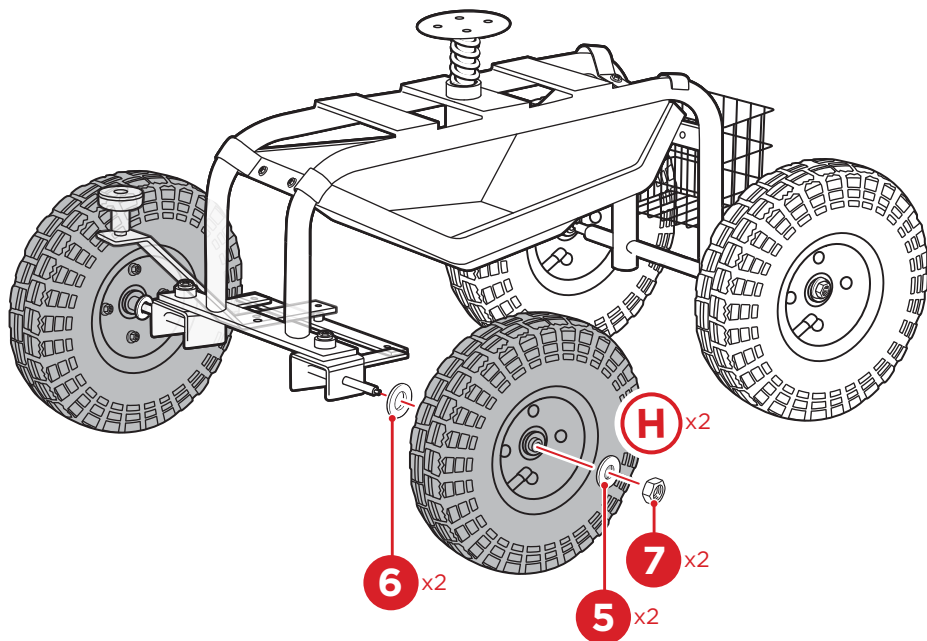

PRODUCT ASSEMBLY

8

Attach the part B seat to the seat post with four part 4 bolt sets.

Place the part 8 large washer on the bottom of the seat post and secure with a part 9 cotter pin.

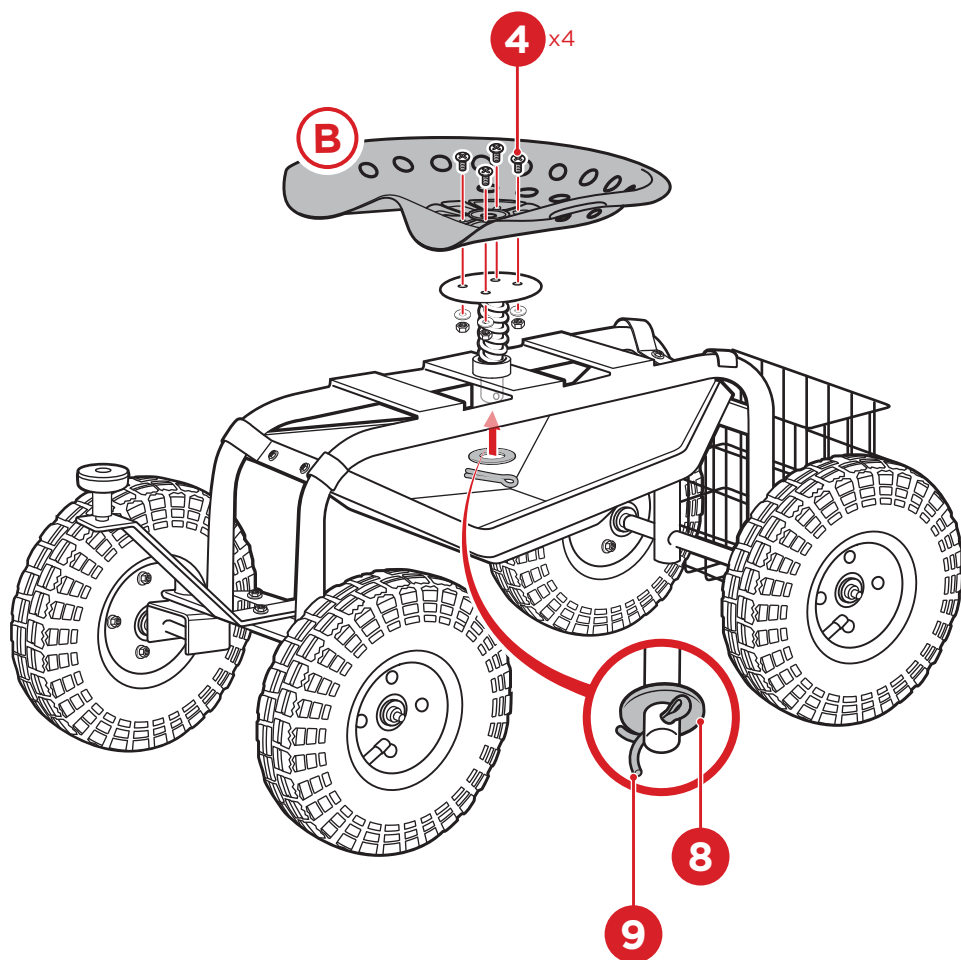

Use needle nose pliers to bend the pin and secure the seat post.

Earn points while you shop. Join today!

bestchoiceproducts **rewards**\$

Join | Earn | Redeem

Give your friends 15% off their first order! For each successful referral you'll receive 100 points.

bestchoiceproducts.com



HELP CENTER



Question about your product? We're here to help. Visit us at:

help.bestchoiceproducts.com



Product Assembly



Returns & Refunds

PRODUCT WARRANTY INFORMATION

All items can be returned for any reason within 60 days of the receipt and will receive a full refund as long as the item is returned in its original product packaging and all accessories from its original shipment are included. All returned items will receive a full refund back to the original payment method. All returned items will not be charged a re-stocking fee.

All returned items require an RA (Return Authorization) number, which can only be provided by a Best Choice Products Customer Service Representative when the return request is submitted. Items received without an RA may not be accepted or may increase your return processing time. Once an item has been received by Best Choice Products, refunds or replacements will be processed within 5 business days.

All returns must be shipped back to the Best Choice Products Return Center at the customer's expense. If the reason for return is a result of an error by Best Choice Products then Best Choice Products will provide a pre-paid shipping label via email. Boxes for return shipping will not be provided by Best Choice Products, and is the customer's responsibility to either use the original shipping boxes or purchase new boxes.

Pictures may be required for some returns to ensure an item is not damaged prior to its return. Items returned are not considered undamaged until they are received by Best Choice Products and verified as such. All damages to items are the customer's responsibility until the item has been received by and acknowledge by Best Choice Products as undamaged.

WARNING

Manufacturer and seller expressly disclaim any and all liability for personal injury, property damage or loss, whether direct, indirect, or incidental, resulting from the incorrect attachment, improper use, inadequate maintenance, or neglect of this product.