



Form Series

Furniture Set

Horizontal fixing with Legge 990
and other Mortice Locks

INSTALLATION INSTRUCTIONS

Box contents

- Rose & lever set – contains 2 factory fitted screws
- Horizontal fixing kit pack
- Jig template

Door thickness

- Latch furniture - 30mm to 55mm

Tools required

- Tape measure
- Pencil
- Level
- Drill
- Drill bits – 4mm & 8mm
- Spade bit – 25mm
- Screwdriver (Phillips)

1. DOOR PREPARATION

After preparing for the lock, line up the centre of the jig with the mortice lock spindle hole.

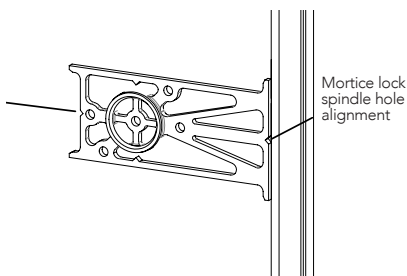

2. DRILL SPINDLE HOLE

With the jig in position, mark and then drill Ø25mm spindle hole from both sides of the door.

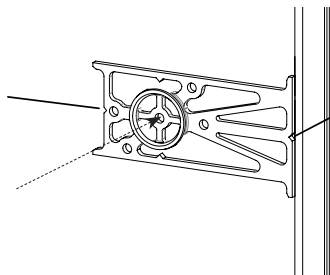

3. DRILL HOLES

Position jig within the drilled spindle hole. Mark 2x horizontal holes. Drill pilot holes Ø4mm from both sides of the door. Re-drill Ø8mm holes from both sides of the door.

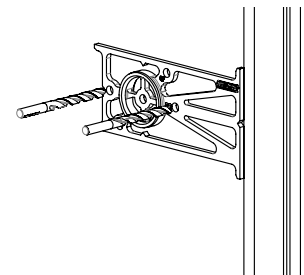

4. PREPARE LEVER

Remove factory fitted screws and studs from inside face of door rose. Discard these screws and studs.

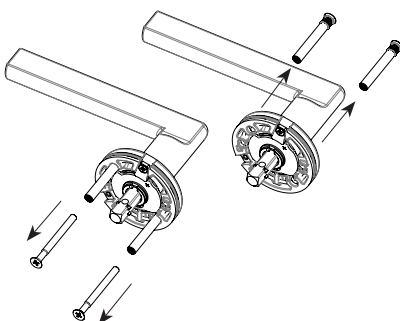

5. ASSEMBLY

Using the horizontal fixing kit, cut screws to suit door thickness, $L = D + 8\text{mm}$. Install furniture, fixing with adjusted screw lengths and barrel nuts supplied.

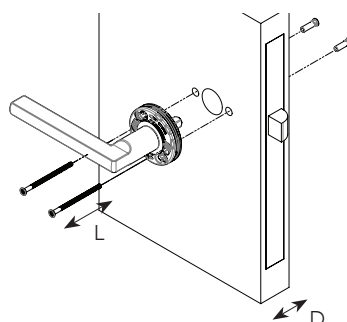

6. FINISHING

Tighten screws, add anti-rotational screws and fit rose cover.

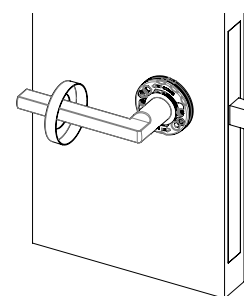

Allegion (Australia) Pty Ltd
Freephone 1800 098 094
Email info.au@allegion.com
www.allegion.com.au

Allegion (New Zealand) Limited
Freephone 0800 477 869
Email nzinfo@allegion.com
www.allegion.co.nz

WARRANTY
10 year mechanical warranty.
For finish warranty, refer to our website
www.allegion.co.nz/finisheswarranty

