

Tiny Love®

4-in-1 Jump & Play Activity Center

User Guide

Model SB002, 180960E001
Toys and styles may vary.



Tools needed: Phillips head screwdriver (not included).
Requires two AAA alkaline batteries (not included).

Maximum weight: 25 lbs. (11.3 kg)
Maximum height: 30" (76.2 cm)

US: 4358-8734
TL: E80961S658 0B

IMPORTANT: READ CAREFULLY AND KEEP FOR FUTURE REFERENCE

- Read all instructions before assembly and use of the Jump & Play Activity Center.
- Keep instructions for future use.
- Do not use the product if it is damaged or broken.
- For use as a toddler play table: When child can stand up and walk unassisted up to 5 years old.
- Indoor use only.
- Adult assembly required.

 WARNING
<p>FALL HAZARD: Babies can FALL from product resulting in head injuries.</p> <ul style="list-style-type: none">• NEVER leave child unattended. ALWAYS keep child in view while in Jump & Play Activity Center.• NEVER use near stairs.• To avoid tipping over, place product on a flat, level surface. <p>STRANGULATION HAZARD: Strings can cause STRANGULATION.</p> <ul style="list-style-type: none">• DO NOT place items with a string around child's neck, such as hood strings or pacifier cords.• DO NOT suspend strings over product or attach strings to toys.• Use only for child who<ul style="list-style-type: none">• can hold head up unassisted• is not able to climb out• does not weigh more than 25 lbs. (11.3 kg) or who is taller than 30 in. (76.2 cm).• Discontinue use of Stationary Activity Center when baby can walk unassisted.• Allow only the child's toes to touch the floor.• Discontinue use of Stationary Activity Center if baby can stand flat footed in any mode, in the highest height position.

<p>Important Battery Information: Keep these instructions as they contain important information. We recommend alkaline batteries for longer battery life.</p> <p>CAUTION: TO AVOID BATTERY LEAKAGE:</p> <ul style="list-style-type: none">• ALWAYS follow the instructions carefully. Use only specified batteries. Make sure to insert batteries with the correct polarity.• Remove exhausted batteries from the product.• DO NOT short-circuit the supply terminals.• Remove batteries when stored for long periods of non-use.• RECHARGEABLE BATTERIES: Rechargeable batteries are to be removed from the product before being charged. Rechargeable batteries are only to be charged under adult supervision. DO NOT recharge non-rechargeable batteries.• DO NOT mix old and new batteries.• DO NOT mix alkaline, standard (carbon-zinc), or rechargeable batteries.• Keep battery out child's reach. Swallowing battery could be fatal.
--



Recycle or dispose of batteries safely according to federal, state, and local laws.

Care and Maintenance

- Remove all contents from packaging and discard box, protective plastic covering, and/or poly bags.
- Grip Strips: **ALWAYS MAKE SURE GRIP STRIPS ARE KEPT CLEAN.** Clean grip strips with water only and air dry.
- Base and Tray Assembly: Clean with warm, soapy water. Be sure to keep product away from direct sunlight or heat.
- Wash fabric seat: Machine wash in cold water gentle cycle. **DO NOT** bleach. Air dry. **DO NOT** iron. **DO NOT** dry clean.
- Toys: **DO NOT SUBMERGE TOYS IN WATER.** Hand wash and dry all toys and make sure to wring out cloth thoroughly beforehand. Avoid wiping electronic areas.
- Lay out and identify all parts.
- Please do not return this product to the place of purchase. To address any issues, please visit us at www.tinylove.com to chat with us there. You can also text us at (812) 652-2525 or call Consumer Care at (800) 544-1108. Have your model number and date code (manufacture date located on the bottom of the tray assembly) ready.

FCC Statement

This device complies with Part 15 of the FCC Rules. Operation is subject to the following two conditions:

1. This device may not cause harmful interference, and
2. This device must accept any interference received, including interference that may cause undesired operation.

RADIO AND TELEVISION INTERFERENCE

This equipment has been tested and found to comply with the limits for a Class B digital device, pursuant to Part 15 of the FCC rules. These limits are designed to provide reasonable protection against harmful interference in a residential installation. This equipment generates, uses, and can radiate radio frequency energy and, if not installed and used in accordance with the instructions, may cause harmful interference to radio communications. However, there is no guarantee that interference will not occur in a particular installation. If this equipment does cause harmful interference to radio or television reception, which can be determined by turning the equipment off and on, the user is encouraged to try to correct the interference by one or more of the following measures:

- Reorient or relocate the receiving antenna.
- Increase the separation between the equipment and the receiver.
- Consult the dealer or an experienced radio/TV technician for help.

Changes and Modifications not expressly approved by the manufacturer or registrant of this equipment can void your authority to operate this equipment under Federal Communications Commission's rules.

One (1) Year Limited Warranty

Dorel Juvenile Group, Inc. warrants to the original purchaser that this product (4-in-1 Jump and Play Activity Center) is free from material and workmanship defects when used under normal conditions for a period of one (1) year from the date of purchase. Should the product contain defects in material or workmanship Dorel Juvenile Group, Inc., will repair or replace the product, at our option, free of charge. Purchaser will be responsible for all costs associated with packaging and shipping the product to Dorel Juvenile Group Consumer Relations Department at the address noted on last page and all other freight or insurance costs associated with the return. Dorel Juvenile Group will bear the cost of shipping the repaired or replaced product to the purchaser. Product should be returned in its original package accompanied by a proof of purchase, either a sales receipt or other proof that the product is within the warranty period. This warranty is void if the owner repairs or modifies the product or the product has been damaged as a result of misuse.

This warranty excludes any liability other than that expressly stated previously, including but not limited to, any incidental or consequential damages.

SOME STATES DO NOT ALLOW THE EXCLUSION OR LIMITATION OF INCIDENTAL OR CONSEQUENTIAL DAMAGES, SO THE ABOVE LIMITATION OR EXCLUSION MAY NOT APPLY TO YOU.

THIS WARRANTY GIVES YOU SPECIFIC LEGAL RIGHTS, AND YOU MAY ALSO HAVE OTHER RIGHTS THAT MAY VARY FROM STATE TO STATE.

Parts List

- A** Fabric seat/Seat ring
- B** Activity tray (Made without BPA)
- C** Height adjust straps (3)
- D** Upper leg assemblies (3)
- E** Hanging toys (3)
- F** Lower legs/Feet (3)
- G** Metal hoop
- H** Toys for activity tray (6)
- I** Electronic musical drum— Requires two AAA alkaline batteries (not included)
- J** Leg (3)
- K** Grip Strips
- L** Tray

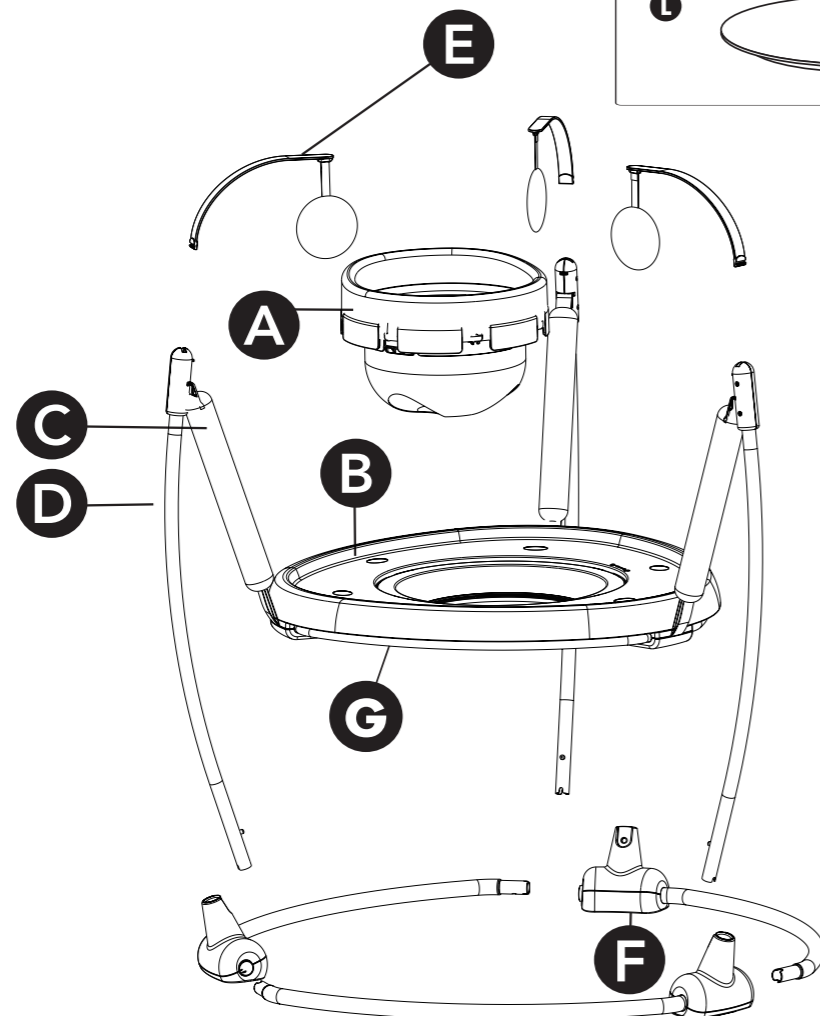
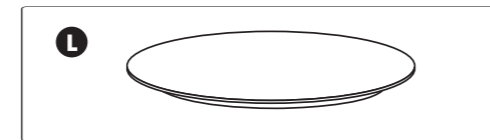
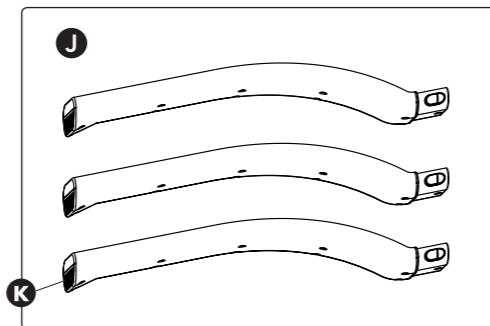
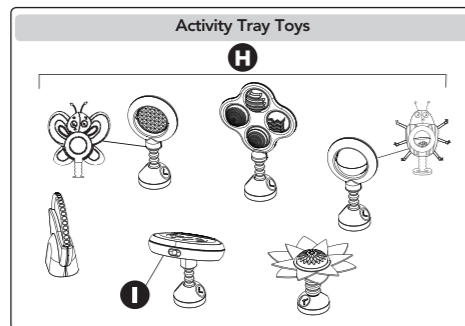

Assembly - Jumper Mode

1

Attach seat ring

Press seat ring into tray assembly until attachment tab clicks (Figure 1 a).

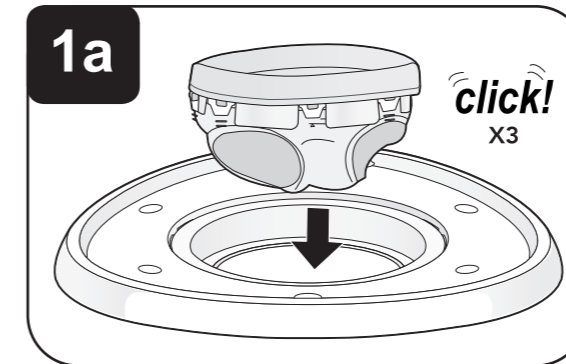

1b

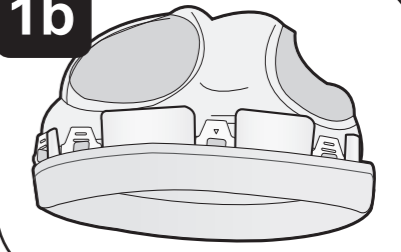

1c

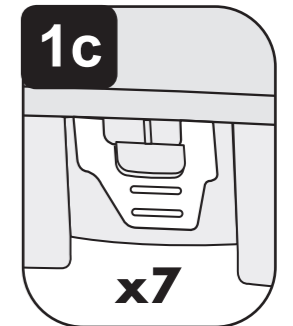

Fabric seat

NOTE: For your convenience, the fabric seat comes pre-assembled. However, follow instructions to be certain it hasn't loosened during shipping:

With seat ring upside down, hook fabric seat to 7 fabric seat posts (Figure 1 b).

Ensure that 7 posts are completely through 7 slots (Figure 1 c).

Ensure seat ring release tab is completely snapped onto tray assembly.

NOTE: The seat pad tab with a triangle (all other tabs have 2 lines) should line up with the widest post.

2

Assemble lower legs/feet:

Align pins to openings, push tubes together, and ensure pins "click" in place (Figure 2).

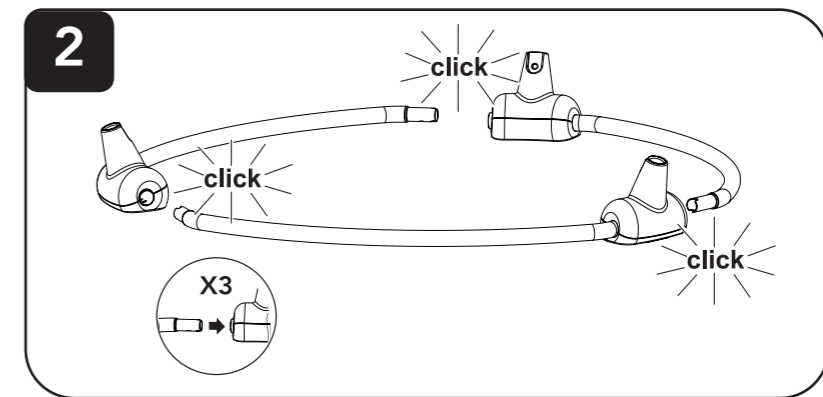

3

Upper leg assemblies:

Align pins to openings, and while pressing the pin in, push tubes together, and ensure pins "click" in place (Figure 3). Make certain all leg posts are fully secured before proceeding.

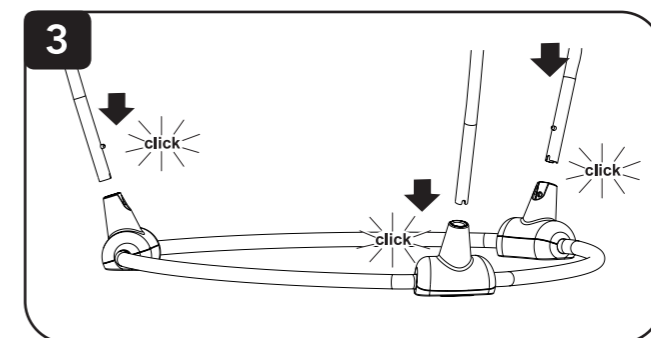

4

Install and replace batteries:

Using Phillips head screwdriver, remove battery compartment cover in the electronic musical drum.

Insert two AAA batteries (not included) into the compartment as indicated (Figure 4).

Replace and secure battery cover.

NOTE: Reference battery compartment for proper battery orientation.

Troubleshooting: Install new batteries and retry function before calling Consumer Care on electronics.

We recommend alkaline batteries for longer battery life.

4

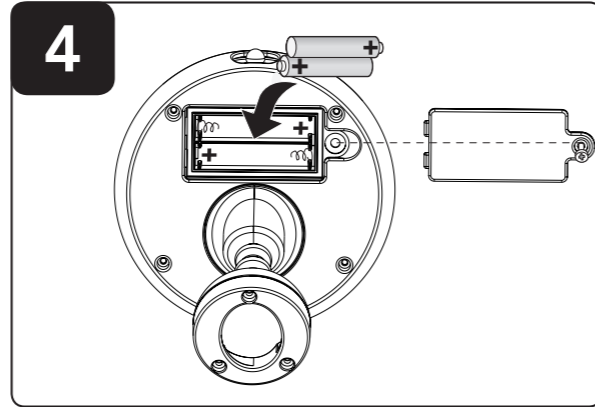

5

Electronic musical drum:

To activate, move switch to "ON" position and press sound and lights button on toy bar (Figure 5).

5

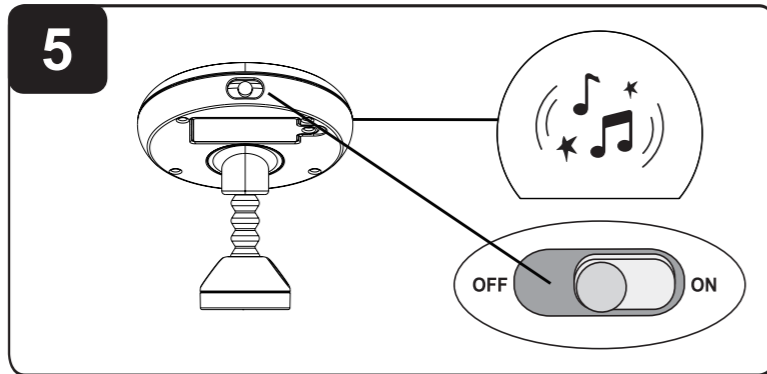

6

Attach toys:

Reach under tray and press button up under each toy. Insert toy in opening, push down, and turn toy clockwise into place. Repeat for all other toys. (Figure 6a).

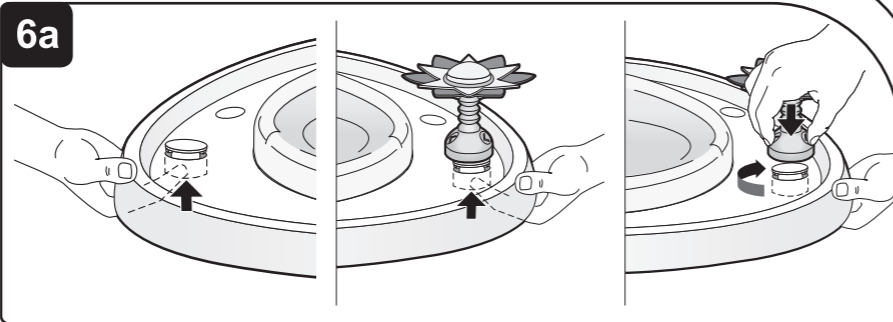

Insert hangers in corresponding openings as shown and push them down until they click into place (Figure 6b). **NOTE:** Install batteries **BEFORE** assembling sounds and lights toy.

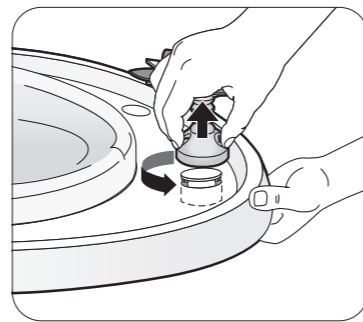
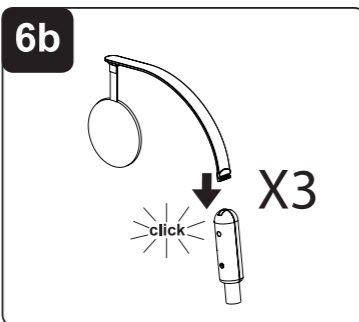

To remove toys for play:

Reach under tray and press up on button under each toy. Turn toy counter-clockwise and pull up.

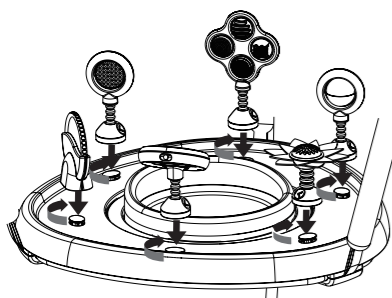

7

Attach tray and check strap assembly:

Align 3 pockets under tray to corresponding posts on the metal hoop as shown, and push down until they click into place to secure pockets and posts connecting correctly (Figure 7).



Use

1

Adjusting height:

Remove baby from activity center. Slide up each fabric cover. Press each button and push or pull each strap so that the same number appears at the center of the buckle (Figure 1a). Adjust all three sides evenly. Pull fabric covers down over buckle.

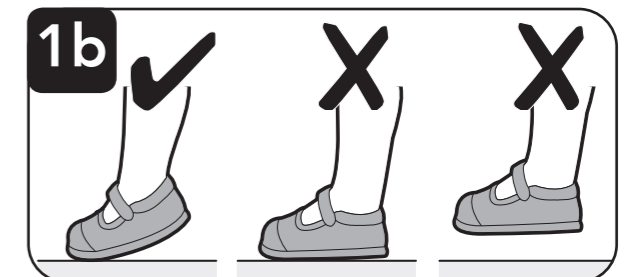
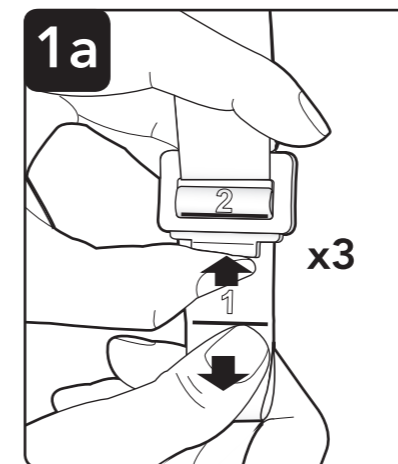

Adjust height so your baby can stand comfortably making sure that only the ball of each foot is touching the floor (Figure 1b).

If the ball of each foot does not touch the floor, lower the height. If baby stands flat footed, raise the height. Always ensure that the straps are set at the same height before use.

NOTE: Discontinue use if baby can stand flat footed in the highest position.

Switch from Jumper to Stationary Activity Center:

1

Remove the metal hoop from the tray:

Press the release buttons on each of the posts on the metal hoop, then gently pull away from the tray (Figure 1).

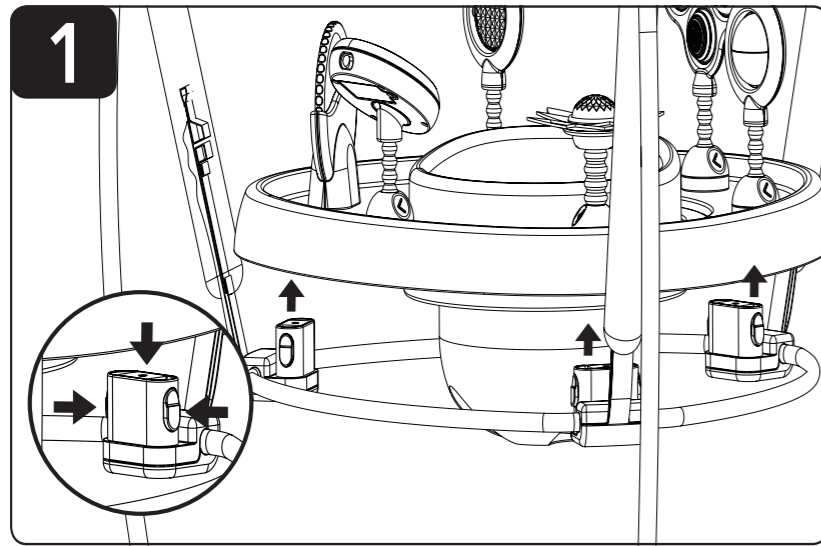

2

Install the three legs

Insert the first leg into the activity tray: align the first leg with the corresponding slot in the tray, and gently push it in until you hear a click (Figure 2).

Repeat for the remaining two legs: align the remaining two legs with the other slots in the tray center, pushing each one in until firmly installed with an audible click.

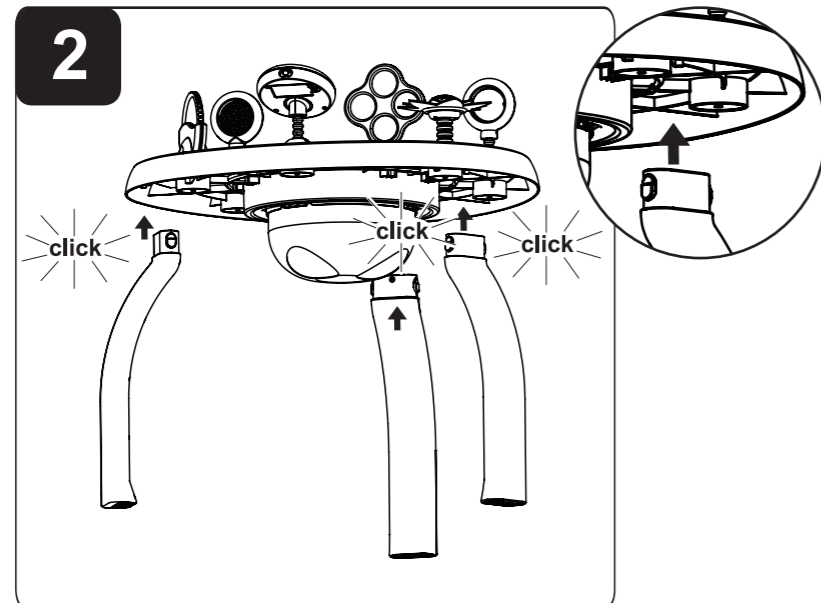

3

Check and confirm

1. Check Leg Stability: Gently shake each leg to ensure they are securely installed and do not wobble.
2. Final Confirmation: Ensure that all three legs are correctly installed and the tray assembly is stable.

Assembly – Toddler Activity Table

1

Remove fabric seat and seat ring

Locate and push out the 3 seat ring tabs under the tray (see Figure 1a).

Push seat ring out of tray (see Figure 1b).

1a Seat Ring Tabs

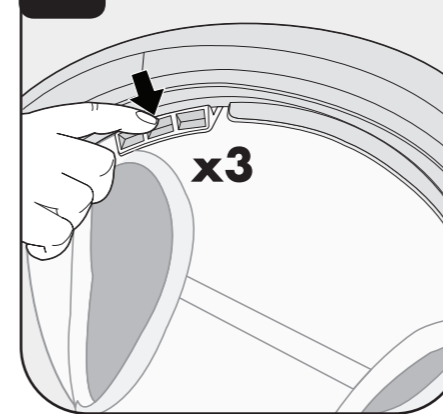

1b

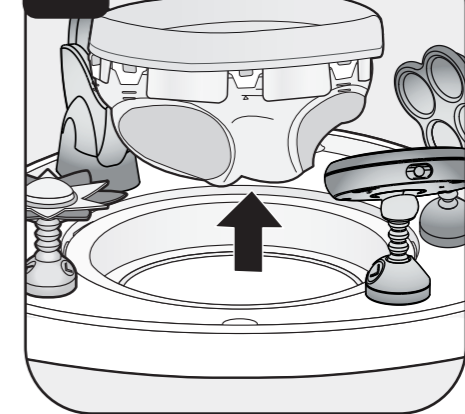

2

Assemble the cover to the main tray:

Place the cover into the seat opening (Figure 2a).

Rotate the cover until the arrow on the cover is in line with the lock symbol on the activity center (Figure 2b).

2a

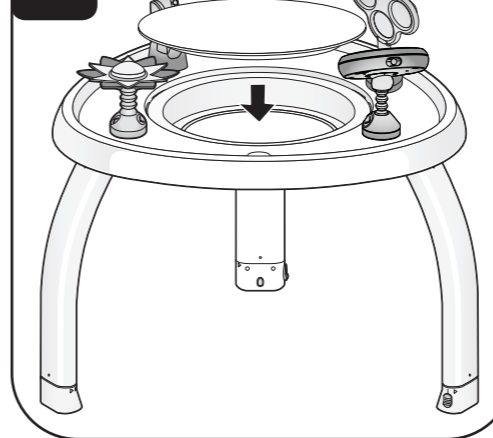

2b

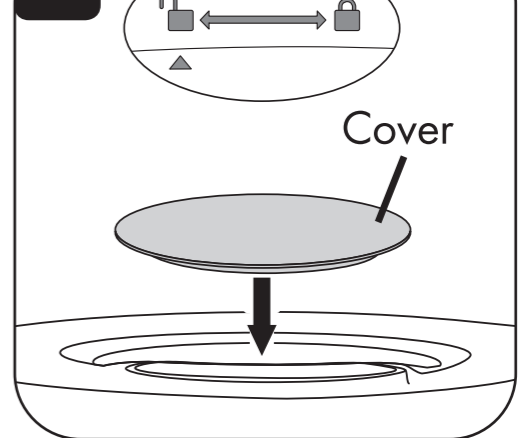

3

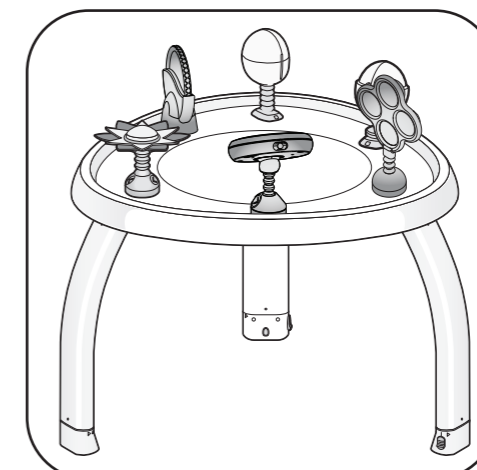

Assembly - Child Play Table

1

Remove toys from tray:
Reach under tray and press up on button under each toy. Turn toy counter-clockwise and pull up (Figure 1 a).

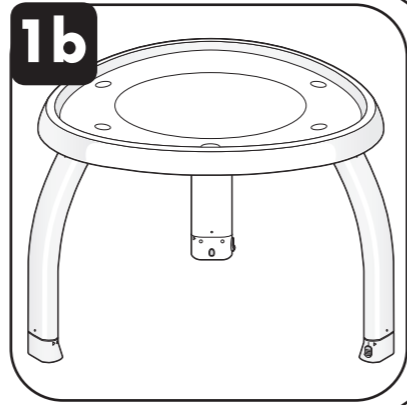
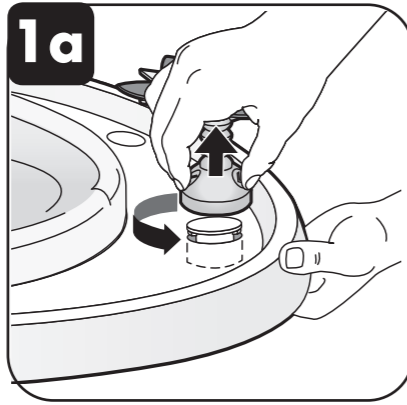

Remove Fabric Seat Pad and Seat Ring:

1

Seat Ring Tabs

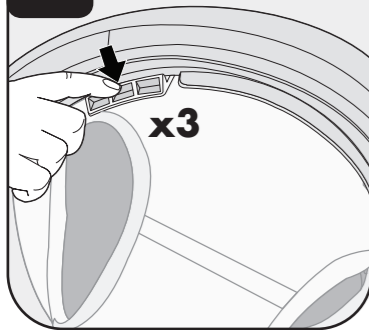

1. Locate and push out the seat ring tabs under the tray.

2

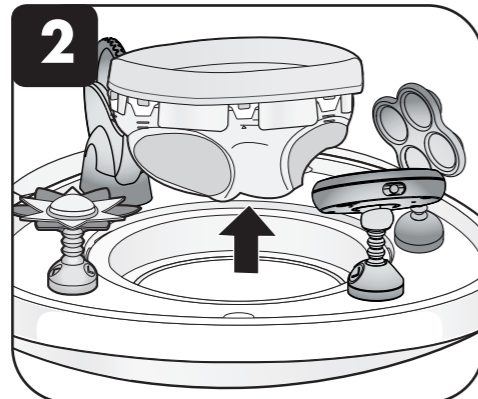

2. Push seat ring out of tray.

3

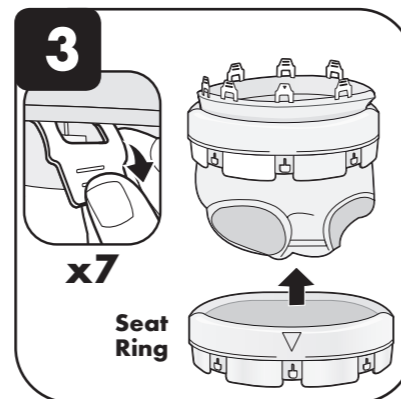

3. Disengage the tabs around the seat ring and remove seat pad.
NOTE: Remove toys, if desired, by referring to the Attach Toys section.

For Storage

Remove the legs

1. Press the release button on each leg, then gently pull the leg out of the tray center. (Figure 1).
2. Check all connections: ensure that all connection points are undamaged during the removal process.
3. Remove the batteries for long-term storage or periods of non-use.

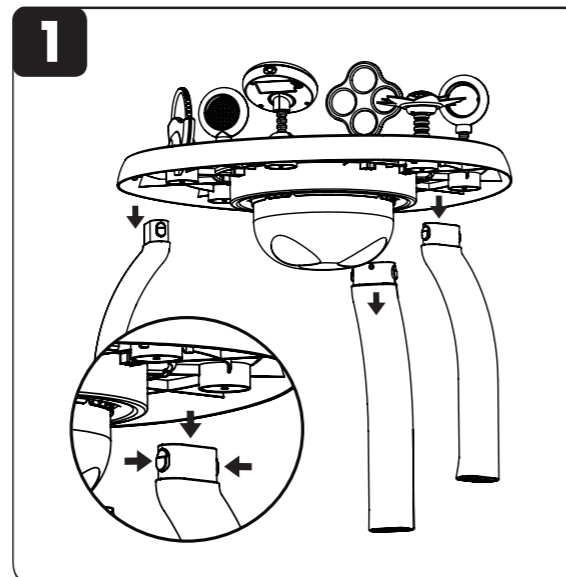



Tiny Love®

**For more developmental
information and playing tips,
please visit:**

www.tinylove.com

©2025 Tiny Love LTD. www.tinylove.com

©2025 Dorel Juvenile Group, Inc. (800) 544-1108 www.djgusa.com. Styles, colors, and labeling may vary. Los estilos, colores y etiquetado pueden variar. Made in CHINA. Hecho en CHINA. Distributed by (distribuido por) Dorel Juvenile Group, Inc., 2525 State St., Columbus, IN 47201-7494. Dorel Juvenile Canada, 2233 Argentia Road, Suite 110, Mississauga, ON L5N 2X7. Representante exclusivo en Chile: DOREL JUVENILE CHILE S.A. Av. del Parque 4161, oficina 602 A, Huechuraba, Santiago, Chile - Fono: 56 2 24971500 - www.infanti.cl - www.dorel.cl. Importado y distribuido en Perú por: COMEXA COMERCIALIZADORA EXTRANJERA S.A. SUCURSAL DEL PERÚ - Los Libertadores 455, San Isidro, Lima 27, Lima, Perú RUC 20431062870 - Fono: 4413029 - www.infanti.com.pe. En Centro América, Caribe y Ecuador por: Best Brands Group S.A. - Av. Balboa, Bay Mall Plaza, Planta Baja, local 9, Panamá. - Fono: (507) 300 2884. En Colombia por: Baby Universe S.A.S. - Vía 40 No. 77-29, Barranquilla, Colombia - Fono: (575) 353 1110 Importador: DJGM, S.A. DE C.V. Gabriel Mancera No. 1041 Col. Del Valle, Benito Juárez C.P. 03100 México, Ciudad de México R.F.C. DJG140305GN9 Tel. (55) 671992020

11/25

E80961S658 OB