

# ASSEMBLY INSTRUCTION

ITEM NO:850S450W/850S451W

DO NOT TIGHTEN SCREWS UNTIL COMPLETELY ASSEMBLED

## STEP:1

No	DESCRIPTION	Q'TY
A	CHAIR BACK	1pc
B	SEAT	1pc
C	FRONT LEG	2pcs
D	LOCK WASHER Ø 5/16	11pcs
E	FLAT WASHER Ø 5/16"	11pcs
F	BOLT 1/4 DIA Ø 5/16x2-1/4"	4pcs
G	BOLT 1/4 DIA Ø 5/16x3"	7pcs
I	ALLEN WRENCH Ø 5/16"	1pc

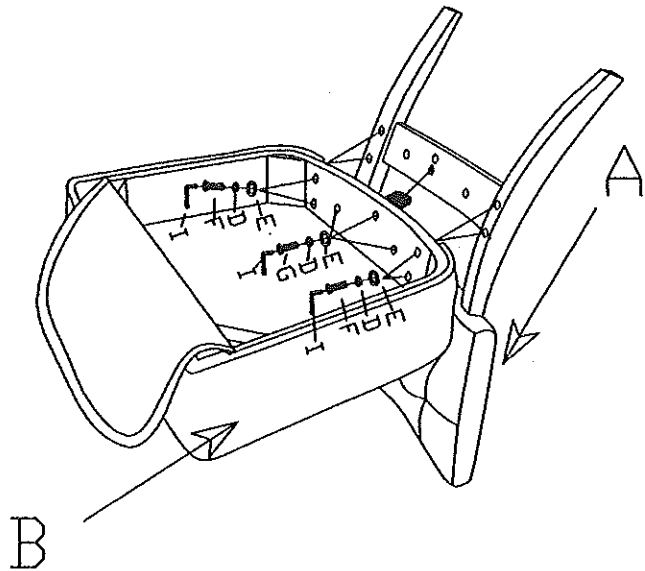

## STEP:2

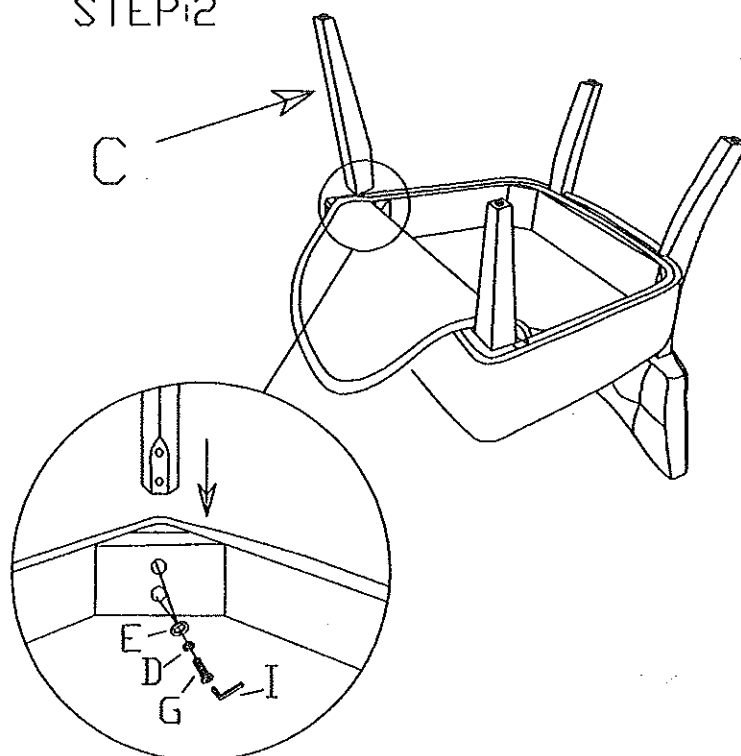

## STEP:3

