

Tub Spouts and Adapters

Surtidores para Bañeras y Adaptadores

RP17453▲
Standard pull-down diverter spout
6" total length
Sweat onto 1/2" C.W.T.
Thread onto 1/2" I.P.S. nipple
Non-metallic
RP12307 adapter assembly included

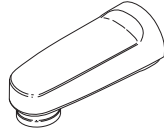

RP5836
Slip-on pull-down diverter spout
6" total length
Slip onto 1/2" C.W.T.
Non-metallic
RP33794 adapter assembly included

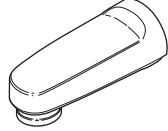

RP17454▲
Standard pull-down diverter spout
6" total length
Sweat onto 1/2" C.W.T.
Thread onto 1/2" I.P.S. nipple
Metal
RP12307 adapter assembly included

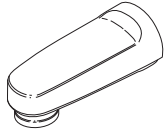

RP3914
Hand shower diverter spout for tub valves only
5" total length - Pull-out to divert
Thread onto 1/2" or 3/4" I.P.S.
Metal

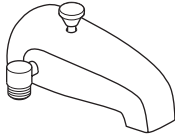

RP19820
Slip-On diverter spout
5 1/2" total length.
Pull-up to divert
Slip onto 1/2" C.W.T.
Non-metallic
RP33794 adapter assembly included

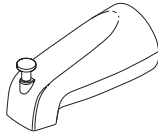

RP5834
Standard diverter spout
5 1/2" total length
Pull-up to divert
Sweat onto 1/2" C.W.T.
Thread onto 1/2" I.P.S.
Non-metallic
RP12307 adapter assembly included

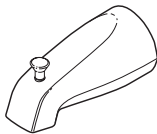

RP19895
Standard diverter spout
5 1/2" total length
Threads in nose of spout
Pull-up to divert
Thread onto 1/2" I.P.S. nipple
Metal

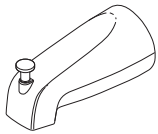

RP34357▲
Traditional diverter
7 1/2" total length
Pull-up to divert
Sweat onto 1/2" C.W.T.
Thread onto 1/2" I.P.S. nipple
50/50
RP12307 adapter assembly included



RP38449▲
Botanical™ diverter spout
6 1/2" total length
Pull-up to divert
Sweat onto 1/2" C.W.T.
Thread onto 1/2" I.P.S. nipple
50/50
RP12307 adapter assembly included



RP38450▲
Botanical™ diverter spout
7 5/8" total length
Pull-up to divert
Sweat onto 1/2" C.W.T.
Thread onto 1/2" I.P.S. nipple
50/50
RP12307 adapter assembly included



RP40625▲
Michael Graves Collection™
Diverter spout
7" total length
Pull-up to divert
Sweat onto 1/2" C.W.T.
Thread onto 1/2" I.P.S. nipple
Non-metallic
RP12307 adapter assembly included

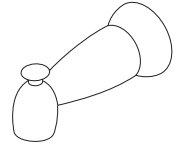

RP36497▲
Slip-on diverter spout
7" total length
Pull-up to divert
Slip onto 1/2" C.W.T.
Metal

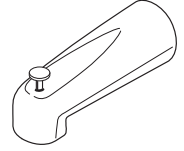

RP36498▲
Slip-on non-diverter spout
7" total length
Slip onto 1/2" C.W.T.
Metal

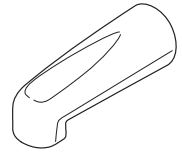

RP18396▲
Roman Tub spout
Wall mount
9" total length
Thread onto 1/2" I.P.S. nipple
Metal

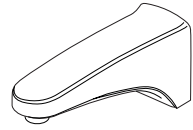

RP5835
Slip-on non-diverter spout
5 1/4" total length
Slip onto 1/2" C.W.T.
Metal

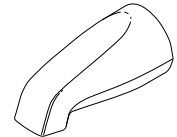

RP5833▲
Non-diverter spout
5 1/4" total length
Thread onto 1/2" I.P.S. nipple
Threads in nose of spout
Metal

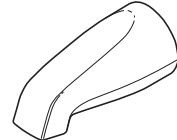

RP12307
Adapter Assembly -
sweat onto 1/2" C.W.T.
or thread onto 1/2" I.P.S.

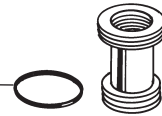

RP1745
O-Ring

RP33794
Adapter Assembly - slip onto 1/2" C.W.T.

RP33482
Inside O-Ring

RP1745
Outside O-Ring

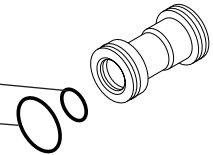

RP17472
Removable Decal for Pull-Down
Spout Operation

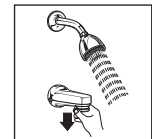

RP17829
Wall Decal-Pull-Down Diverter
Tub Spout Operation



Miscellaneous Parts / Piezas Misceláneas

RP25

RP25MBS (120 per case/120 por caja)
O-Rings-Spout-1H Kitchen
Anillos "O"-Tubo de Salida-1H Cocina



RP50▲

Cap w/Adj. Ring-Single Handle
Tapa con Anillo Ajustable-
Manija Sencilla



RP61

RP61MBS (60 per case/60 por caja)
Cam & Packing - Single Lever Handle
Leva y Empaque - Manija de
Palanca Sencilla



RP70

RP70MBS (60 per case/60 por caja)
Ball Assembly - Single Lever Handle-SS
Ensamble de la Bola - Manija-Palanca
Sencilla - Acero Inoxidable



RP76

Pipe Plug-1/2" IPS-T/S
Tapón de Tubería-1/2" IPS-T/S



RP90

Handle w/Set Screw
Manija con Tornillo de Ajuste



RP116

Plasterguard/Thin Wall Mounting
Bracket-600/1600
Protector de Enlucido/Soporte para
Montura en Pared Delgada-600/1600



RP152▲

Set Screw-Single Lever Handle -
1/4-28x5/16" (uses 1/8" allen wrench)
Tornillo de Ajuste-Manija-Palanca
Sencilla-1/4"-28 (Usa Llave Allen 1/8")



RP188

RP188MBS (60 per case/60 por caja)
Cam & Packing - Single Knob Handle
Leva y Empaque - Perilla Sencilla



RP196▲

Screws-1H T/S Escutcheon -
2 3/4" x 10-24
Tornillos-1H T/S Chapetón -
2 3/4" x1 0-24



RP212

RP212MBS (60 per case/60 por caja)
Ball Assembly - Single Knob Handle-SS
Ensamble de la Bola-Manija -Palanca
Sencilla - Acero Inoxidable



RP246

Aerator w/Wrench-VR - 15/16"-27
Male Thread - 2.0 gpm @ 80 psi
Aireador con Llave de Tuerca-
Resistente al Maltrato-15/16"-27
Rosca Macho -7.6L/Min @ 551 kPa



RP250

RP250MBS (60 per case/60 por caja)
Adjusting Ring-Single Handle
Anillo de Ajuste-Manija Sencilla



RP320

RP320MBS (60 per case/60 por caja)
Diverter Assembly-1H Kitchen w/Spray
Ensamble del Desviador-1H Cocina
con Rociador



RP330▲

RP330MBS (60 per case/60 por caja)
Aerator - 15/16"-27 Male Thread -
2.0 gpm @ 80psi
Aireador - 15/16"-27 Rosca Macho -
7.6L/Min @ 551 kPa



RP334

Gasket (Black) - 1H Kitchen
Empaque (Negro) - 1H Cocina



RP574

Pressure Balance Assembly - 600/1600
Ensamble de Balance de Presión-
600/1600



RP691▲

Trip Lever Bath Waste Assembly - Brass
Ensamble del Desagüe/Bañera/
Operado con Palanquita de
Desenganche - Bronce



RP693▲

Toe-Operated Bath
Waste Assembly-Brass
Ensamble del Desagüe/Bañera/
Operado con Pie-Bronce



RP1001▲

Soap/Lotion Dispenser Assembly
Ensamble del Surtidor de
Jabón/Loción



RP1129

O-Ring - Spout - NEO STYLE™,
Waterfall® Kitchen
Anillo "O"-Tubo de Salida -
NEO STYLE™, Waterfall® Cocina



RP1740

RP1740MBS (60 per case/60 por caja)
Stem Unit Assembly - 2H-SS Plate
Ensamble Unidad-Espiga, 2H - Placa
de Acero Inoxidable



RP1745

O-Ring for Tub Spout Adapter
Anillo "O" para Adaptador del
Tubo de Salida



RP1806

RP1806MBS (240 seats per case/
240 asientos por caja)
Seats / Asientos



RP1974

Wrench - 1/8" Allen — For Lever
Handle Set Screw/All Adjusting Rings
Llave de Turcas Allen — 1/8" para
Tornillo de Ajuste-Palanca/Todos los
Anillos de Ajuste



RP1991

RP1991MBS (12 per case/12 por caja)
Stem Unit Assembly w/Seats - 1600
Ensamble de la Unidad-Espiga
con Asientos - 1600



RP2055

O-Rings - Spout-2H Kitchen
Anillos "O"-Tubo de Salida-2H Cocina



RP2090

Screwdriver/Check Stop
Assembly - 600/1600 Pressure Balance
Destornillador/Ensamble del Tope -
Series 600/1600 Presión Balanceada



RP2189

Spray Round Swivel Aerator - Fits
15/16"-27 Male Thread or 55/64"-27
Female Thread - 2.0 gpm @ 80 psi
Rociador-Aireador Giratorio Redondo -
para 15/16"-27 Rosca Macho o
para 55/64"-27 Rosca Hembra -
7.6L/Min @ 551 kPa



RP2389

Handle w/Button & Screw -
Clear-1H Knob-Lav
Manija con Botón y Tornillo-
Transparente-1H Perilla-Lav



RP2390

Handle - Clear - 2H Knob
Manija - Transparente - 2H Perilla



RP2391

Handle w/Button & Screw -
Clear-1H Knob-600
Manija con Botón y Tornillo-
Transparente-1H Perilla-600



RP2392

Handle w/Button & Screw - Clear
Manija con Botón y Tornillo -
Transparente



RP2393▲

Lever Handle w/Set Screw-1H Kitchen
Palanca con Tornillos de Ajuste-
1H Cocina



RP2411

Button-Clear-1H Knob-Red/Blue-
Gold Insert-1 3/8" dia.
Botón-Transparente-1H Perilla-Rojo/
Azul-Dorado-Inserción Dorada-1 3/8" dia.



RP2412

Button Set-Clear-2H Blade-3/16" dia.
Botones-Transparente-
2H Aleta - 3/16" dia.



RP2932

Boxed Assortment Maintenance
Parts Kit (5-RP61, 2-RP188,
2-RP250, 12-RP4993 plus 24 extra
seats, RP1974, 2-RP212, 2-RP70,
4-RP320, 6-RP25)
Piezas Surtidas de Mantenimiento en Caja
(5-RP61, 2-RP188, 2-RP250, 12-RP4993 Más
24 Asientos Extras, 1-RP1974, 2-RP212,
2-RP70, 4-RP320, 6-RP25)



RP3427

RP3427MBS
(240 springs per case
240 Resortes por caja)
Springs / Resortes

