

### IMPORTANT:

Before you begin, make sure you familiarize yourself with all the parts and fully read the instructions. Outlet must be installed or accessible within 4 feet of where the drawer will be installed.

### TOOLS NECESSARY:

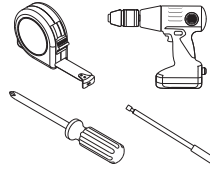

- Tape Measure
- Screw Gun
- Phillips Screwdriver
- Long Extension Bit

NOTE: If screw gun has a clutch, set to lowest setting so as not to over tighten and/or strip screws.



Scan QR or visit link to view installation video.

<https://delivr.com/2gdaa>

### PARTS IDENTIFICATION:

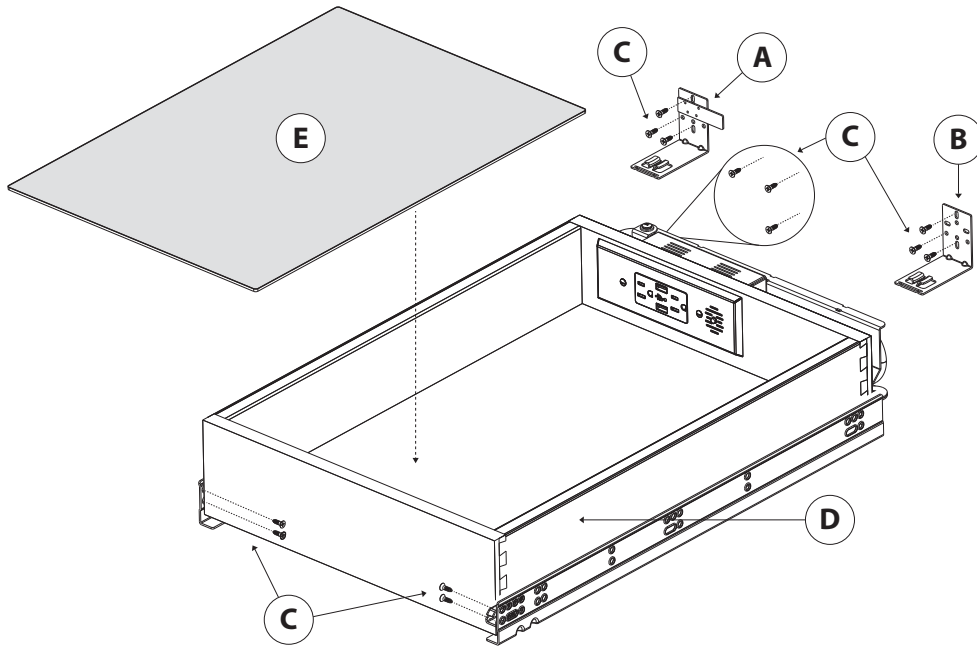

A	Rear Mounting L Bracket with Alignment Tab	1 pc
B	Rear Mounting L Bracket	1 pc
C	#6 x 1/2" Flat Head Screw	13 pcs
D	Drawer Box	1 pc
E	Drawer Protective Liner	1 pc

NOTE: Drawer Box assembled with HR MAX™ clips, HR MAX™ soft-close undermount slides, power outlet, and cable management arm.

### IMPORTANT SAFETY INSTRUCTIONS:

**CAUTION: To reduce risk of fire or electronic shock or injury to persons**

- Not intended for long-term storage. Items should be monitored.
- Do not alter plug.
- Do not store combustibles such as aerosols in unit.

### OPERATING INSTRUCTIONS:

- Install 120v GFCI outlet in rear of cabinet within 4 feet of back of unit. Wiring should only be performed by a licensed electrician. All wiring must follow NEC regulations.
- Do not overload outlet.
- Customer is responsible for electrical wiring outside of this unit.
- Product is intended for powered device charging.
- Overall safety of this product is determined by its end use.

### MAINTENANCE INSTRUCTIONS:

- Clean with a damp cloth and wipe dry.
- If you're experiencing issues with your unit, unplug from outlet, remove unit, and inspect for damage.
- Route and secure cords so that they will not be put in a bind or under strain when unit is closed.
- Unit must be properly grounded using provided cable with grounding pin.
- This product is for use on a nominal 120-volt circuit and has a grounding plug that looks like the plug illustrated to the right. Make sure that the product is connected to an outlet having the same configuration as the plug. No adapter should be used with this product.

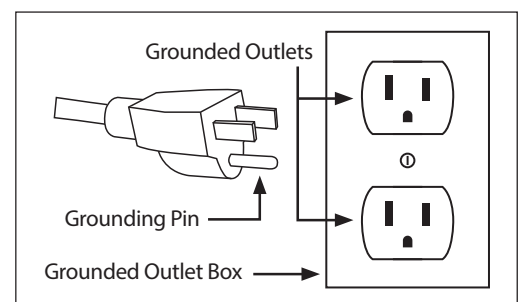

WARNING - RISK OF FIRE AND SHOCK; USE ONLY SJT EQUIVALENT 14AWG CORD

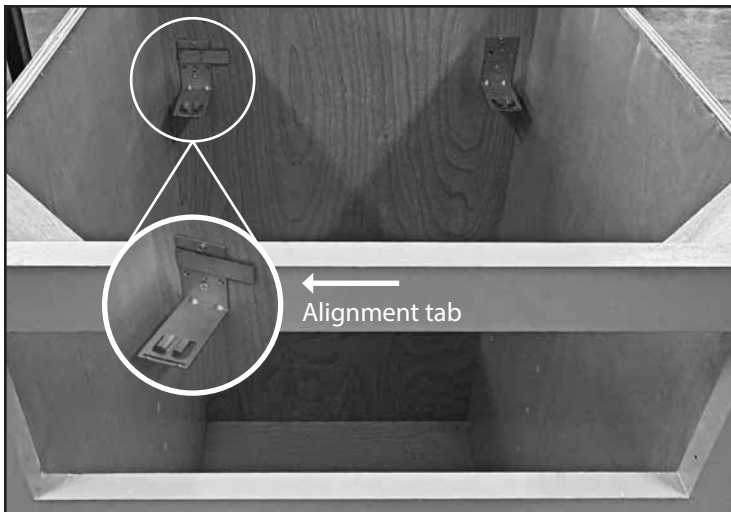

**1**

Attach rear mounting L bracket with alignment tab to the back panel on the left side. Attach standard rear mounting L bracket to the back panel on the right side.

NOTE: Rear brackets can also be installed with HR MAX™ Slide Rear Bracket Installation Tool (sold separately).

**Scan to watch how to use your Rear Bracket Installation Tool**

<https://delivr.com/2yhj3>

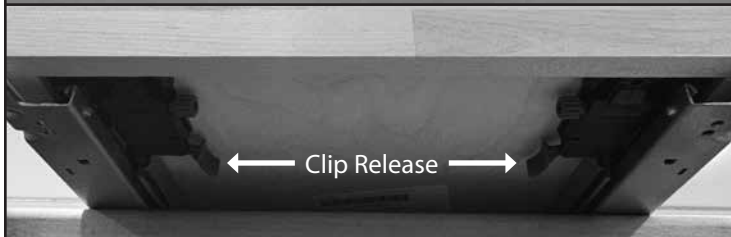

**2**

Press the clips under the drawer to release the pre-installed slides and separate the drawer from the slides.



**3**

Attach the rear of the slides into the L brackets as shown. Place the front of the slides 1/8" from front of face frame and secure to face frame with two (2) #6 x 1/2" screws as shown.

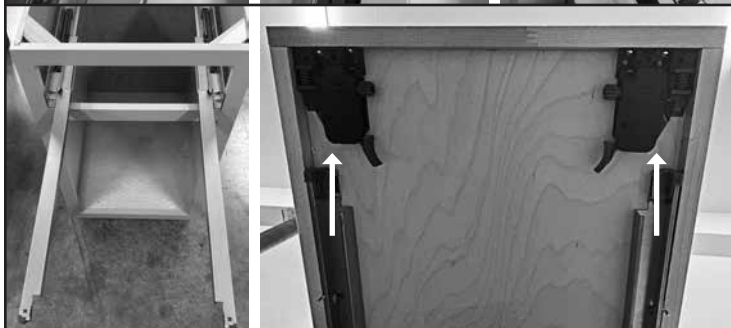

**4**

Extend slides and place charging drawer into opening. Engage slides into clips by reaching under drawer and pulling slide into clip. You should hear an audible click when slide engages.



**5**

With drawer extended, slide power arm onto alignment tab of left rear mounting L bracket as shown and secure with three (3) #6 x 1/2" screws.



**6**

Plug unit into existing wall outlet.

NOTE: If the power outlet is not in the cabinet where the unit is installed, drill holes as needed and feed the plug through hole to access the outlet, ensuring that the cable is secured in such a manner that it can't be damaged when the unit is retracted.

Once installation is complete, drawer front and decorative hardware (not provided) can be installed.