

# BLACK DIAMOND®

Project Name: \_\_\_\_\_

Location: \_\_\_\_\_

Item #: \_\_\_\_\_

Qty: \_\_\_\_\_

## Black Diamond Reach-In Refrigerator, Double Solid Doors, 46.7 Cu. Ft., in Stainless Steel

### GRRF-2DES



The Black Diamond Reach-In Refrigerator delivers 46.7 Cu. Ft. of high-capacity, energy-efficient cold storage, making it ideal for commercial kitchens, restaurants, and foodservice operations. Its double solid stainless steel doors and bottom-mounted compressor provide quick access, durability, and simple service. Digital controls enable precise temperature management between 33° and 40°F, while the environmentally responsible R290 refrigerant ensures eco-friendly operation. The unit features adjustable shelving, interior lighting, and comes mounted on heavy-duty casters for easy mobility.

### FEATURES AND CONSTRUCTION

- Provides 46.7 Cu. Ft. of refrigerated storage to accommodate large volumes of perishable items
- Equipped with a 0.75 horsepower bottom-mounted compressor for optimal energy efficiency and simplified maintenance
- Durable exterior and interior stainless steel construction ensures strength and easy cleaning
- Maintains a consistent temperature range of 33° to 40°F to maximize product freshness
- Utilizes R290 refrigerant for eco-friendly and effective cooling
- Includes six adjustable shelves for flexible configuration of food and beverage products
- Mounted on four heavy duty 4-inch casters for easy mobility and positioning
- Double solid right-swing stainless steel doors protect contents and provide dependable access

### ELECTRIC

115V / 60Hz / 1Ph  
Cord Length (Inches): 98"  
Plug Type: NEMA 5-15P  
Cord set included

NEMA 5-15P



### 3RD PARTY APPROVALS



### WARRANTY (USA / CANADA)

Two (2) Year Limited Warranty on Parts and Labor, Five (5) Year Warranty on Compressor and Evaporator

Contact us for details at 1.877.368.2797



### STORAGE CAPACITY

- Cubic Feet: 46.7 Cu. Ft.

### TEMPERATURE

- Holding Temperature (Fahrenheit): 33° - 40°

These models are designed to operate in an environment where temperature and humidity do not exceed 75°F (24°C) and 55% relative humidity



# Black Diamond Double Solid Door Reach-In Refrigerator

GRRF-2DES

FRONT

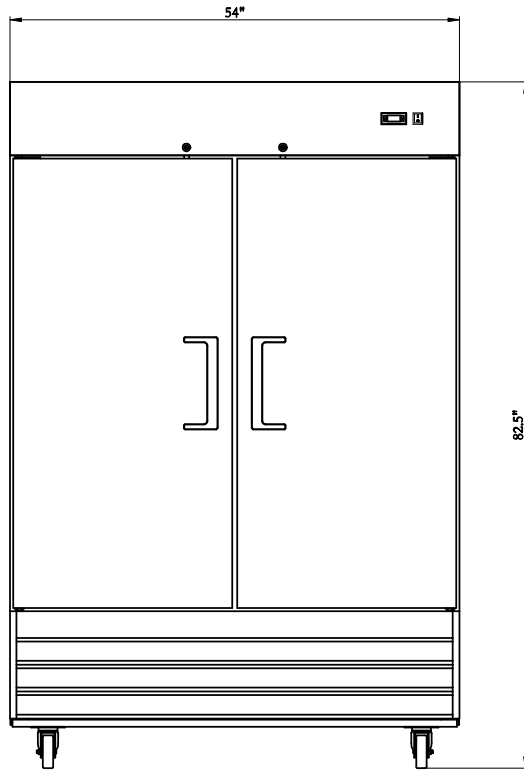

SIDE

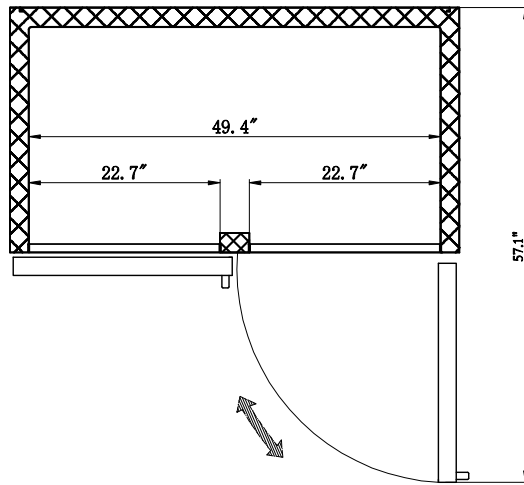
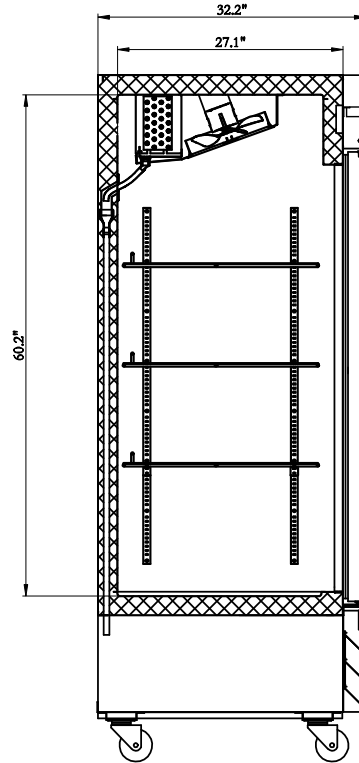

TOP

## Reach-In

Doors	Shelves	Amps	HP	Refrigerant	Assembled Dimensions (in)	Item Weight (lbs)	Shipping Weight (lbs)
2	6	4.5A	1/4	R290 2.65	32.20" x 54.00" x 82.50"	447.0	530.0

Due to periodic changes in designs, methods, procedures, policies and regulations, the specifications contained in this document are subject to change without notice. While we exercise good faith efforts to provide information that is accurate, we are not responsible for errors or omissions in information provided or conclusions reached as a result of using the specifications. By using the information provided, the user assumes all risks in connection with such use.