

REVISIONS				
ECN	REV.	DESCRIPTION	DATE	APPROVED
	A	RELEASE FOR PRODUCTION	6/12/25	

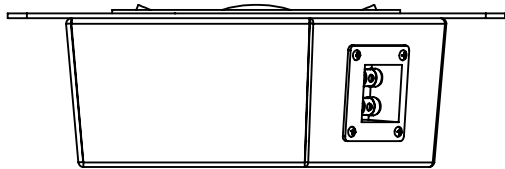

FOR  
PROTOTYPE  
ONLY

PROTO APPROVAL:  
7/1/25 - TCR

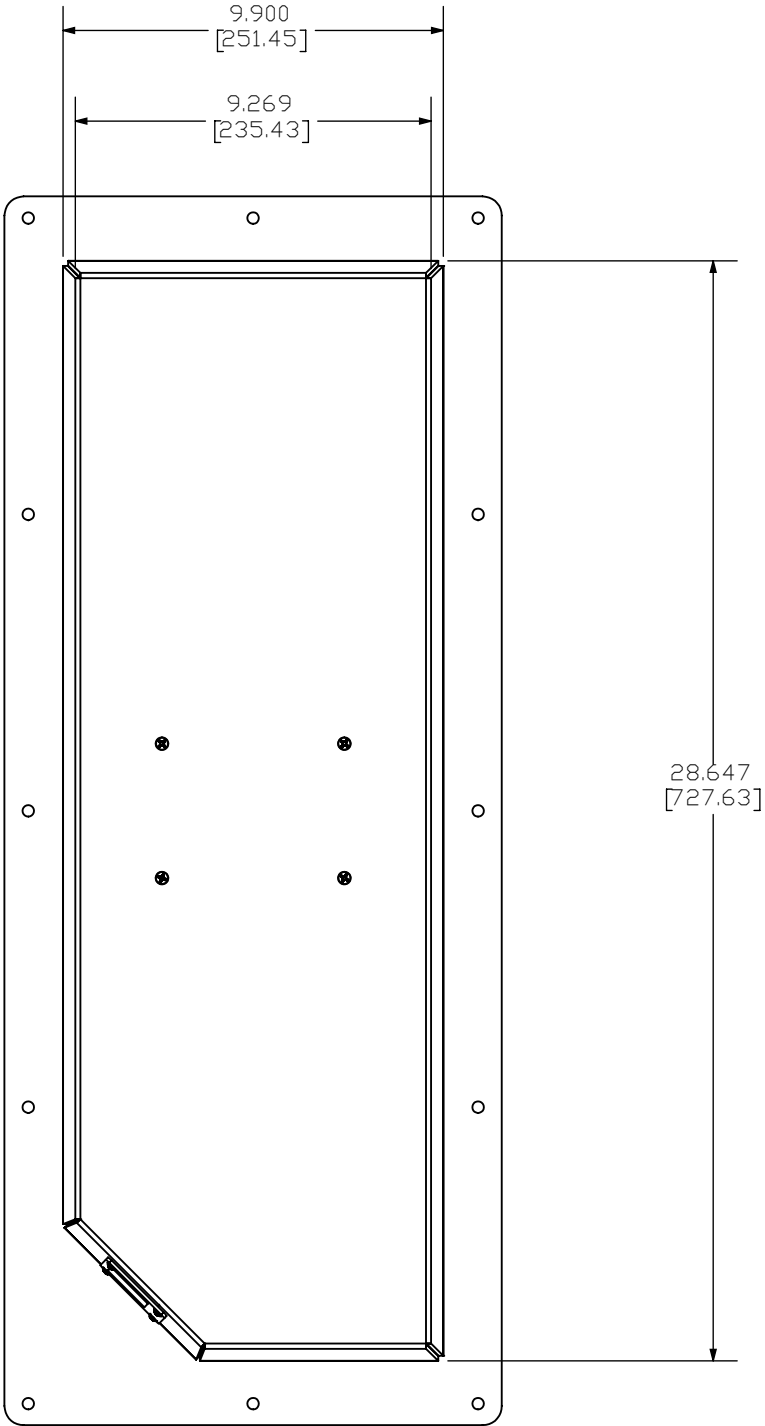
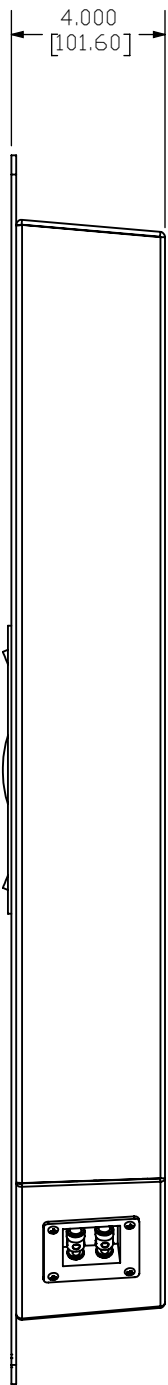
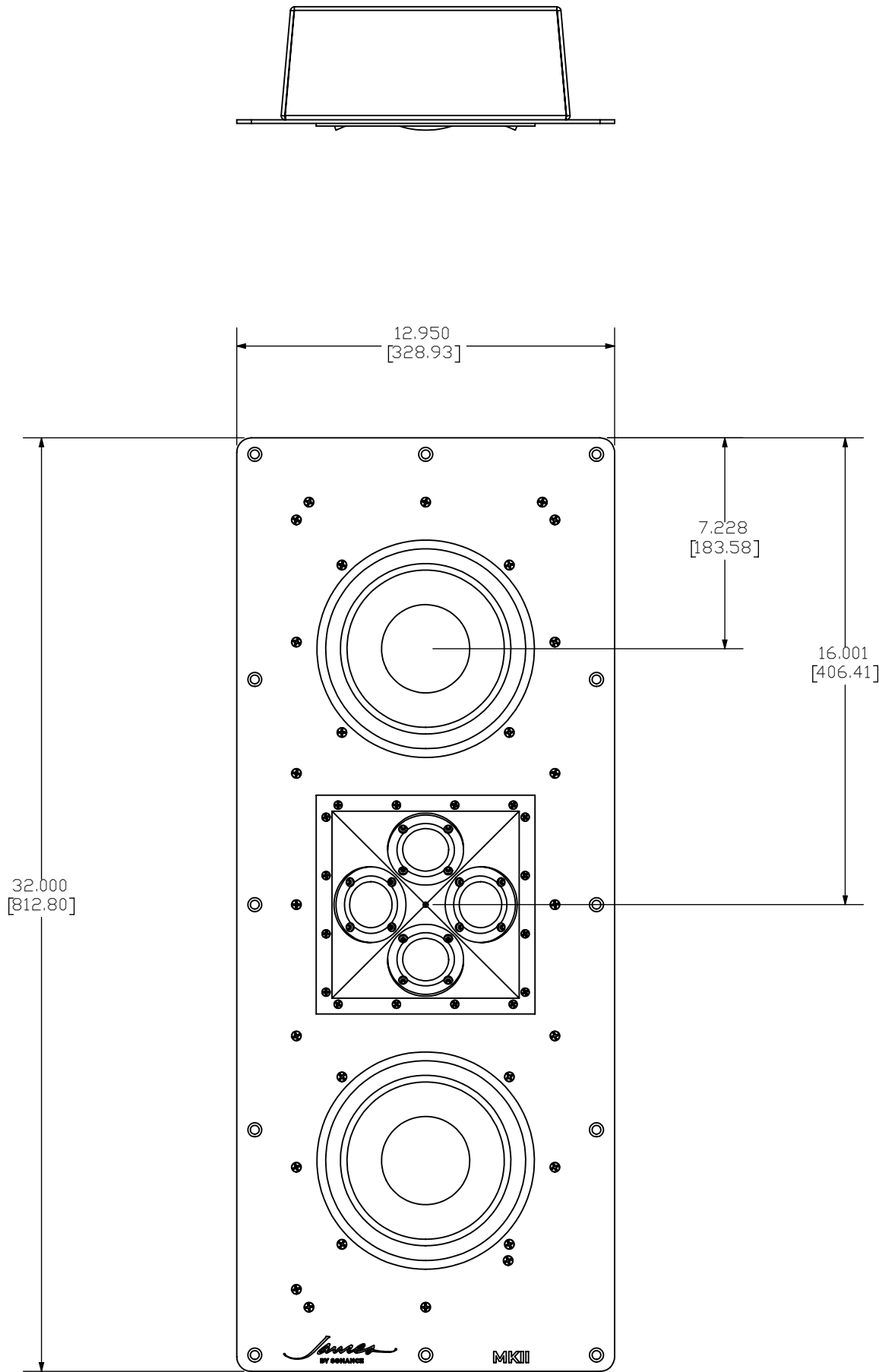
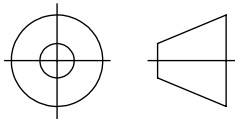

“THIRD ANGLE” PROJECTION

PROPRIETARY INFORMATION	JAMES LOUDSPEAKER
THE DESIGNS, INFORMATION, AND DATA CONTAINED HEREIN ARE PROPRIETARY AND ARE SUBMITTED IN CONFIDENCE, AND SHALL NOT BE DISCLOSED, USED OR DUPLICATED IN WHOLE OR IN PART, FOR ANY PURPOSES WHATSOEVER, WITHOUT THE PRIOR WRITTEN PERMISSION OF JAMES LOUDSPEAKER LLC, 2185 PARK PL, MINDEN, NV 89423. THIS LEGEND SHALL BE MARKED ON ANY REPRODUCTIONS HEREOF IN WHOLE OR IN PART. RECEIPT OF THIS DOCUMENT SHALL BE DEEMED TO BE AN ACCEPTANCE OF THE CONDITIONS SPECIFIED HEREIN.	<b>BE806-MKII</b>
	EXTERNAL DIMENSIONS
	P/N: BE806-MKII
	DWR #: 250612-JG101
	REVISED BY:
	DRAWN BY: J. GALLAGHER
	DATE: 06-12-25
	SCALE:
	TOLERANCES: ANG: ± = .5° FRACT. ± = 1/32
	DECIMALS: .XX ± = .01 .XXX ± = .005
	SHEET 1 OF 4