

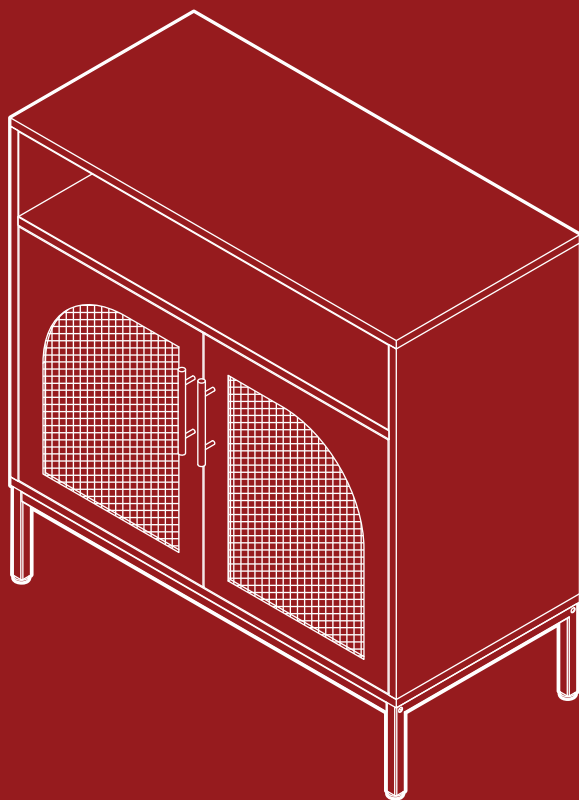

BEST CHOICE
PRODUCTS



INSTRUCTION MANUAL

2-Door Rattan
Sideboard Cabinet



99 LBS
CABINET TOP
CAPACITY



66 LBS
TOP SHELF
CAPACITY



33 LBS
ADJUSTABLE SHELF
CAPACITY



99 LBS
CABINET BOTTOM
CAPACITY



2 PERSON
ASSEMBLY



UP TO 60 MIN.
ASSEMBLY

! NOTICE

Please retain these instructions for future reference.

- Please do not exceed the weight limitations of this item.
- Do not stand on or use any part of this item as a step ladder.
- Firmly secure all bolts, screws, and knobs before use.
- Reconfirm that all bolts, screws, and knobs are secure every 90 days.
- Fasten screws loosely during initial assembly. Do not firmly tighten the screws until the item is completely assembled.
- Do not use or store this item in the proximity of open flame or flammable/combustible chemicals.
- Be aware that some parts are heavy and have sharp edges.
- If any parts are missing, broken, damaged, or worn, stop using this product until repairs are made and/or factory replacement parts are installed.
- Do not use this item in a way inconsistent with the manufacturer's instructions as this could void the product warranty.
- This product is intended for residential use only.

TOOLS REQUIRED



PHILLIPS
SCREWDRIVER



M4 ALLEN WRENCH
(PROVIDED)



POWER DRILL
(RECOMMENDED)

HARDWARE

A

Ø7.8 x 30mm
DOWEL



12 PCS

B

M6 x 35mm
CAM BOLT



12 PCS

C

Ø15 x 12mm
CAM LOCK



12 PCS

D

SHELF
SUPPORT



4 PCS

E

SHELF LOCK



4 PCS

F

M4 x 18mm
SCREW



4 PCS

G

M7 x 38mm
SCREW



4 PCS

H

M6 x 28mm
BOLT



6 PCS

HARDWARE

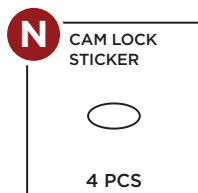
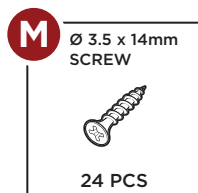
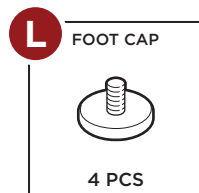
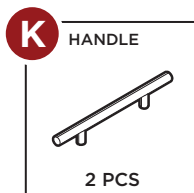
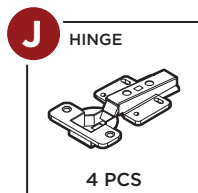
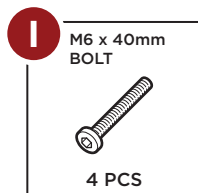

PARTS

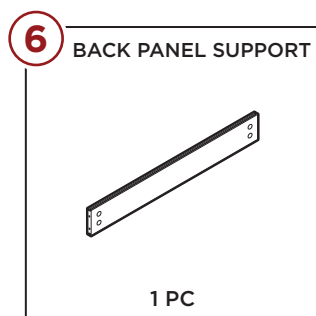
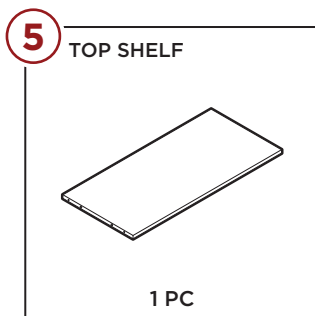
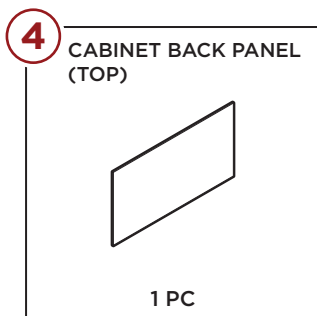
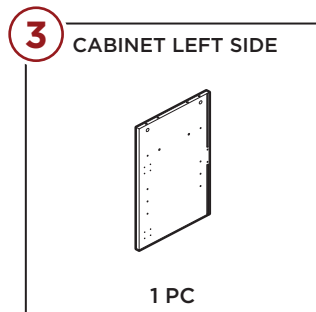
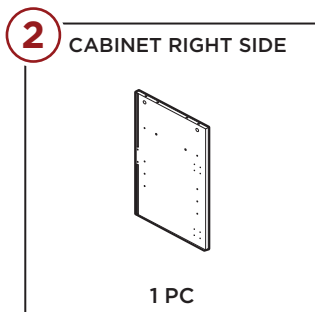
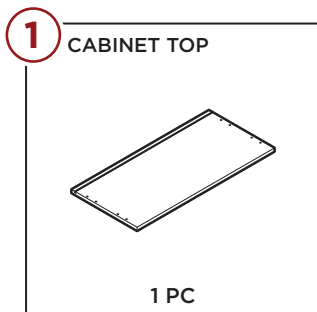

PARTS

7

ADJUSTABLE SHELF

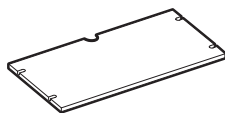

1 PC

8

CABINET BACK PANEL
(BOTTOM)

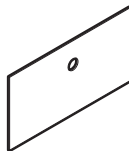

1 PC

9

CABINET BOTTOM

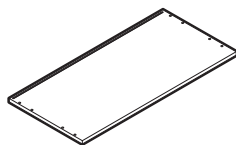

1 PC

10

LEFT DOOR

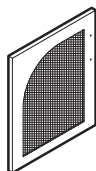

1 PC

11

RIGHT DOOR

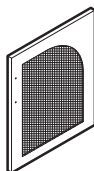

1 PC

12

BASE FRAME
CONNECTOR



2 PCS

13

BASE SIDE FRAME



2 PCS

BEFORE ASSEMBLY

1

Insert four **part B** cam bolts into the **part 1** cabinet top.

Insert four **part B** cam bolts into the **part 2** right side.

Insert four **part B** cam bolts into the **part 3** left side.

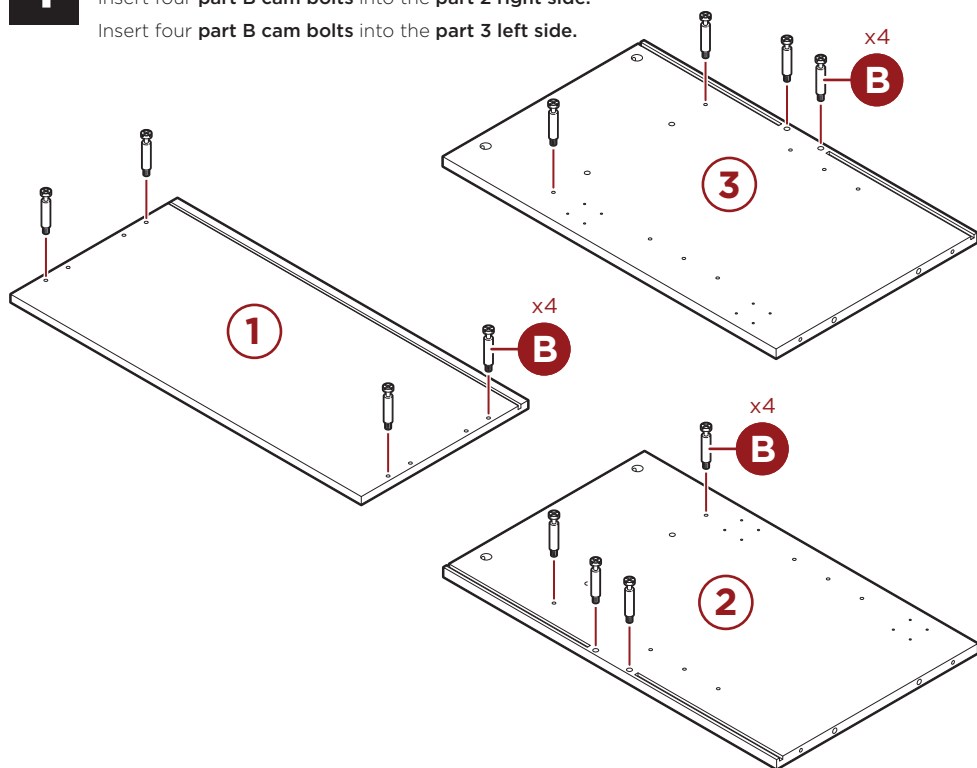

2

Attach two **part J** hinges to the **part 10** left door with four **part M** screws, two screws per hinge.

Attach two **part J** hinges to the **part 11** right door with four **part M** screws, two screws per hinge.

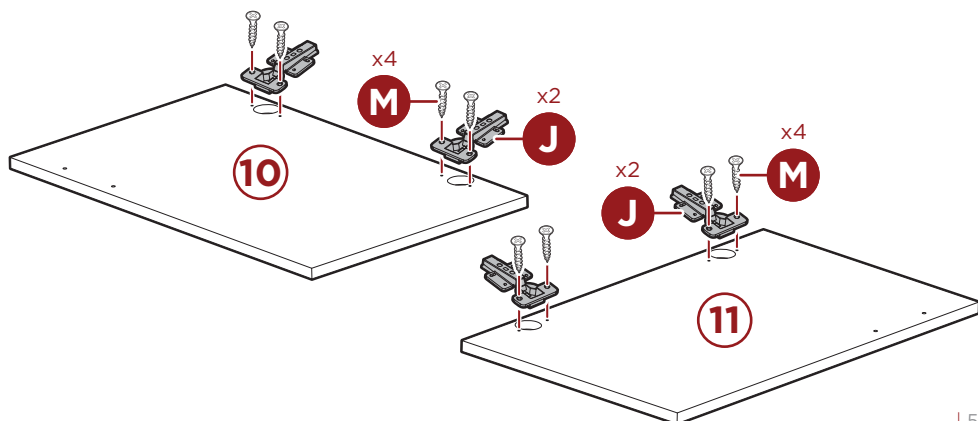

PRODUCT ASSEMBLY

1

Attach the **part 5 top shelf** to the **part 2 right side** with two **part A dowels** and two **part C cam locks**, turn the cam locks to secure.

Attach the **part 6 back panel support** with two **part C cam locks**, then turn the cam locks to secure.

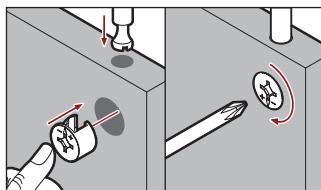
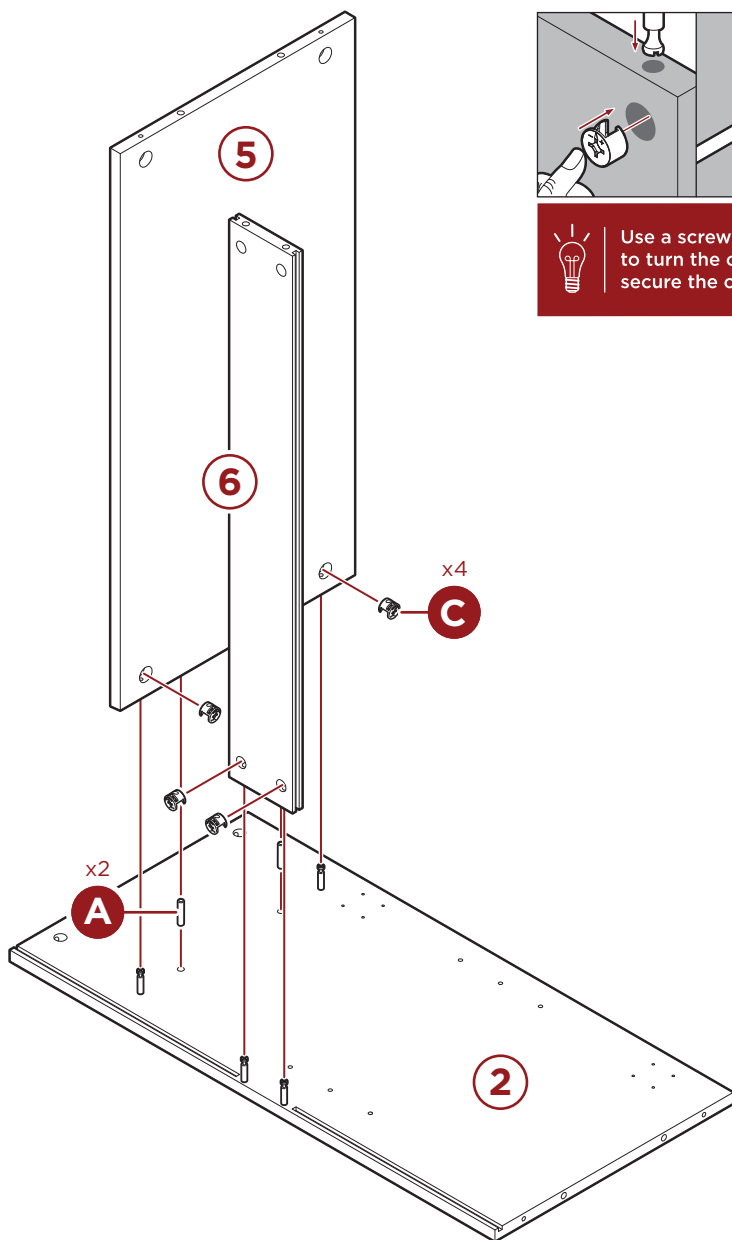

Use a screwdriver to turn the cam lock to secure the cam bolt.

PRODUCT ASSEMBLY

2

Slide the **part 4 cabinet back panel (top)** into its designated grooves, perpendicular to the **part 5 top shelf**.

Slide the **part 8 cabinet back panel (bottom)** into its designated grooves.

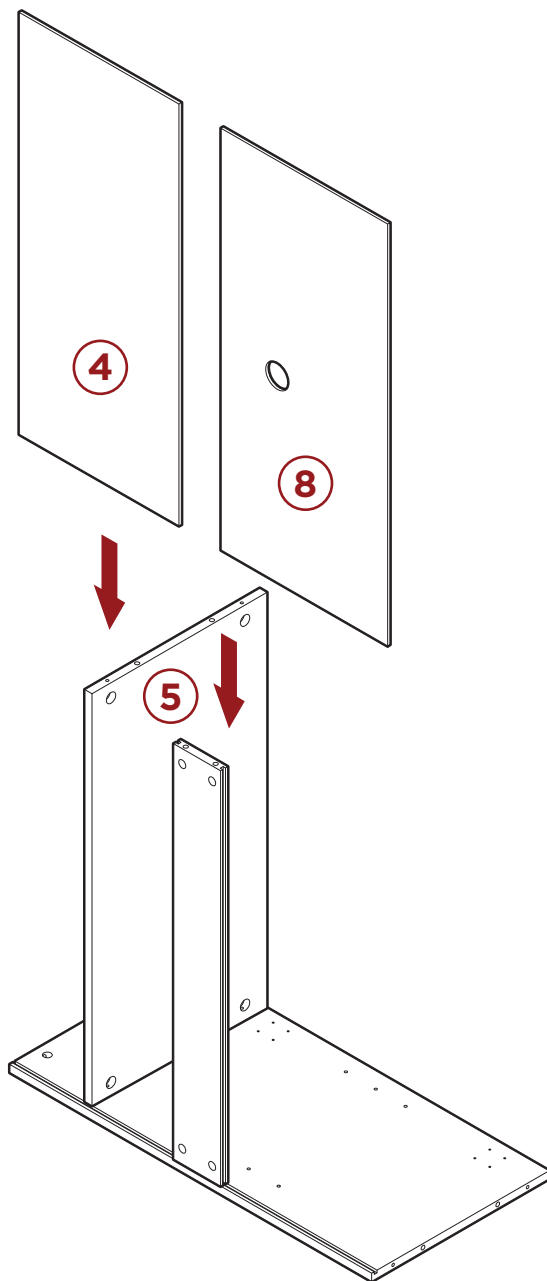

PRODUCT ASSEMBLY

3

Insert two **part C cam locks** each into the **part 6 back panel support** and **part 5 top shelf**, four locks total.

Insert two **part A dowels** into the **part 5 top shelf**, then attach the **part 3 left side** and turn the cam locks to secure.

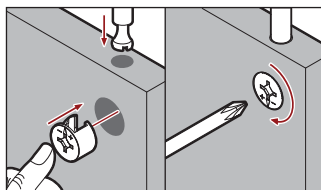
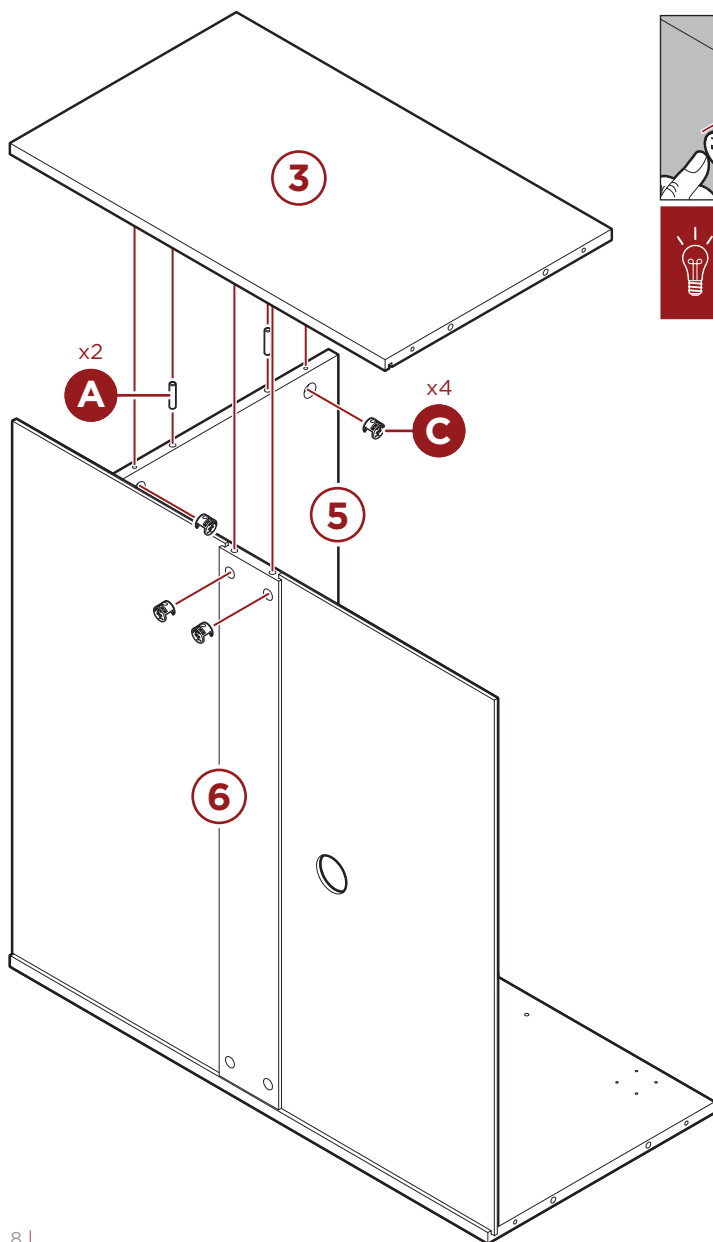

Use a screwdriver to turn the cam lock to secure the cam bolt.

PRODUCT ASSEMBLY

4

Insert two **part A dowels** each into the **part 2 and 3 right and left sides** then attach the **part 9 cabinet bottom**, secure with four **part G screws**.

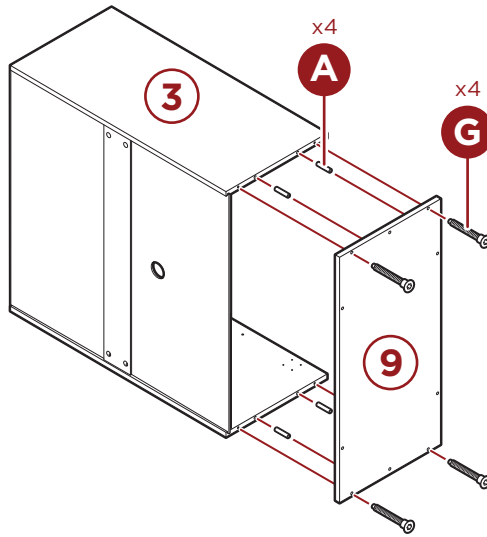

5

Insert two **part A dowels** and two **part C cam locks** each into the **part 2 & 3 right and left sides**, two dowels and two locks per side.

Attach the **part 1 cabinet top**, then turn the cam locks to secure.

Place four **part N cam lock stickers** over the exposed cam locks above the **part 5 top shelf**.

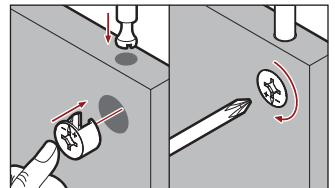
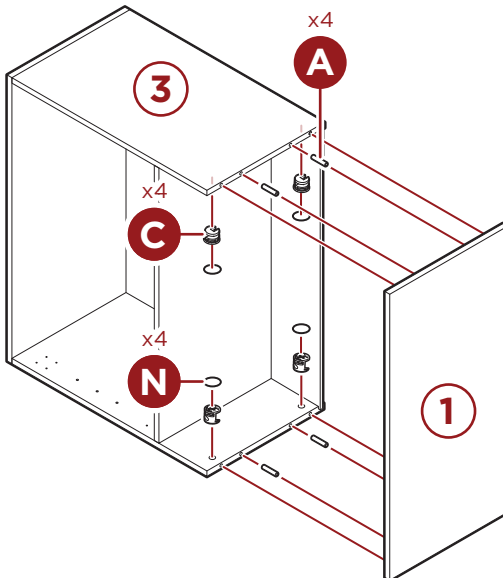

Use a screwdriver to turn the cam lock to secure the cam bolt.

PRODUCT ASSEMBLY

6

Attach two **part 12 base frame connectors** to one **part 13 base side frame** with two **part I bolts**, connect the remaining side frame with two more **part I bolts**.

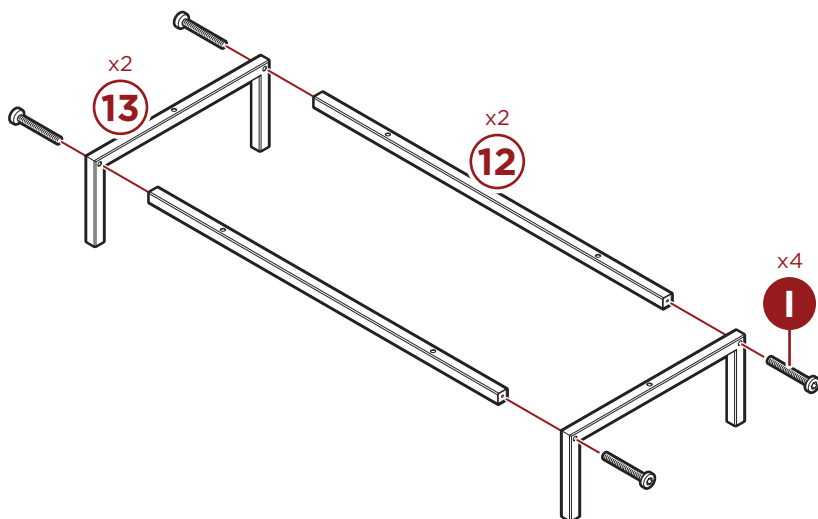

7

Attach the base frame assembly to the **part 9 cabinet bottom** with six **part H bolts**.

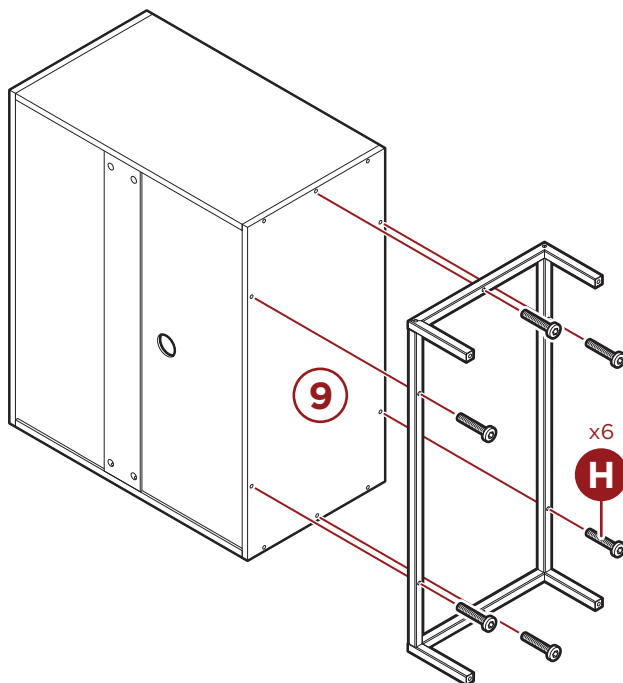

PRODUCT ASSEMBLY

8

Screw four **part L foot caps** into the **part 13 side supports**, adjust so all feet are level.

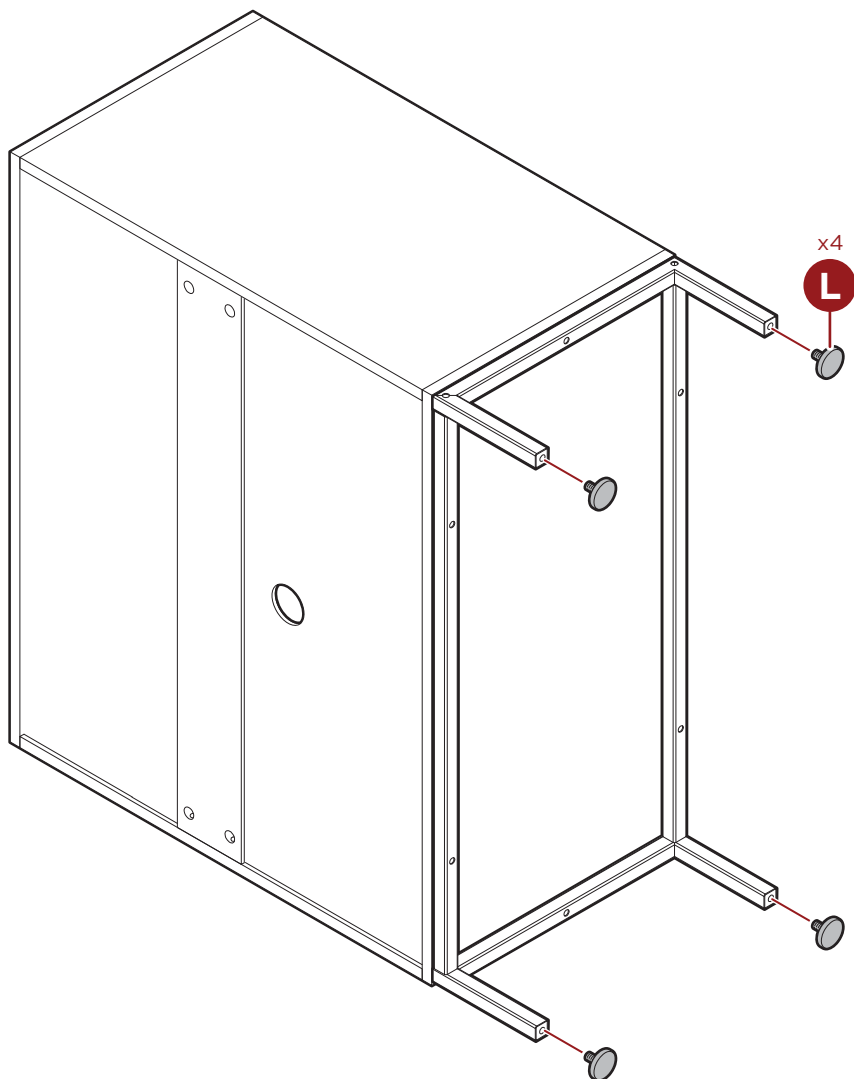

PRODUCT ASSEMBLY

9

Attach one **part K** handle to the **part 10 left door** with two **part F** screws, then repeat to attach a second handle to the **part 11 right door**.

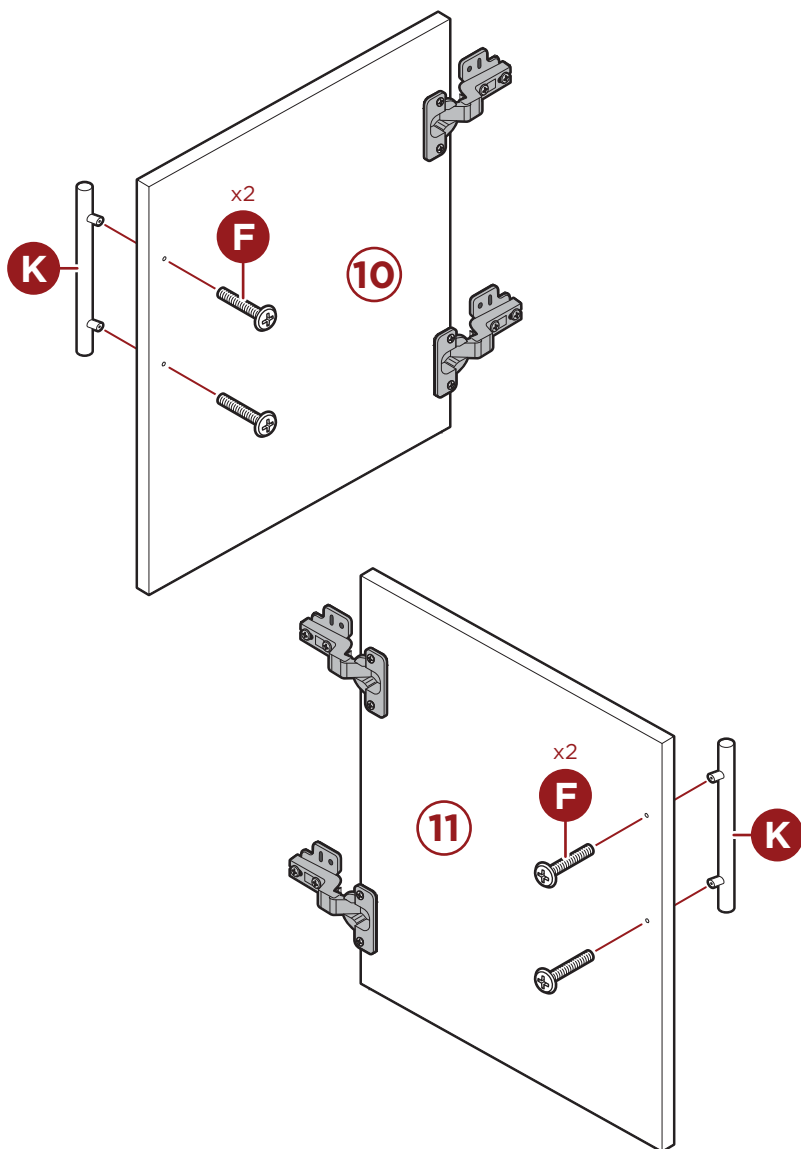

PRODUCT ASSEMBLY

10

Attach the **part 10** and **11** left and right doors to the **part 2** and **3** right and left sides by securing sixteen **part M** screws, to the **part J** hinges, four screws per hinge.

NOTE: Use a philip's screwdriver to secure the (2) pre-installed screws on each hinge after attaching the **part J** screws to adjust the position of the doors.

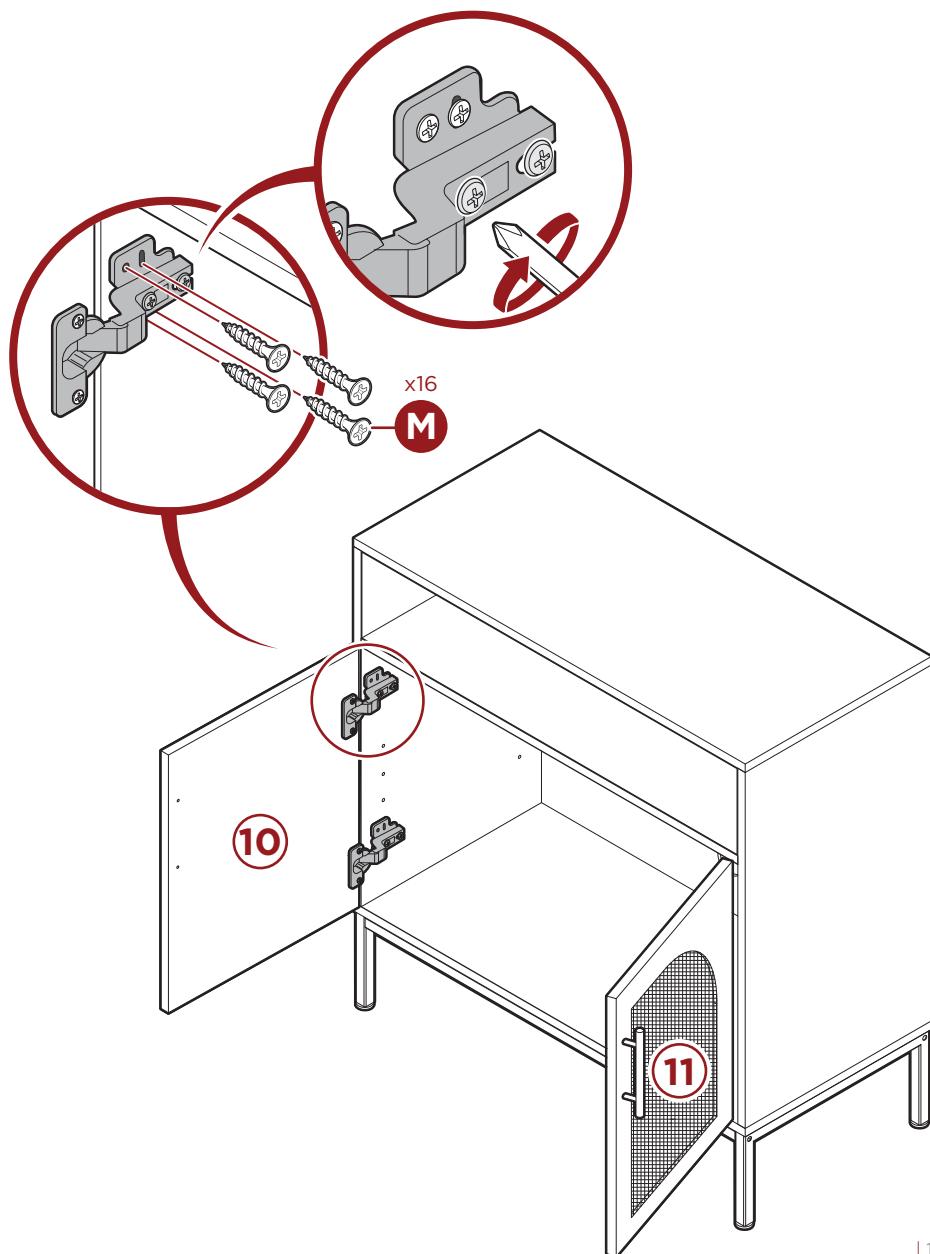

PRODUCT ASSEMBLY

11

Insert four **part D shelf supports** into the **part 2 and 3 right and left sides**.

NOTE: There are three insertion levels for the shelf supports, make sure all shelf supports are inserted on the same level.

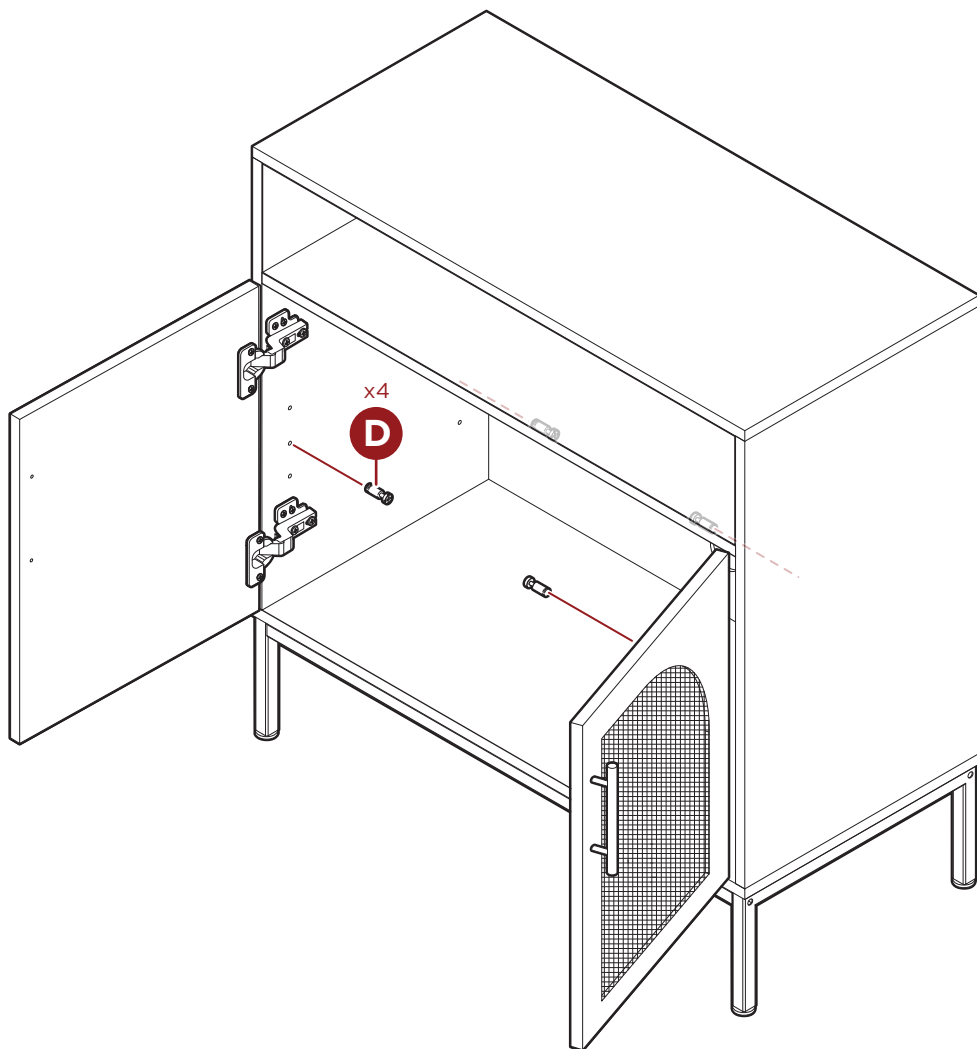

PRODUCT ASSEMBLY

12

Insert four **part E shelf locks** into the **part 7 adjustable shelf** and place the shelf onto the **part D shelf supports**. Turn the locks to secure.

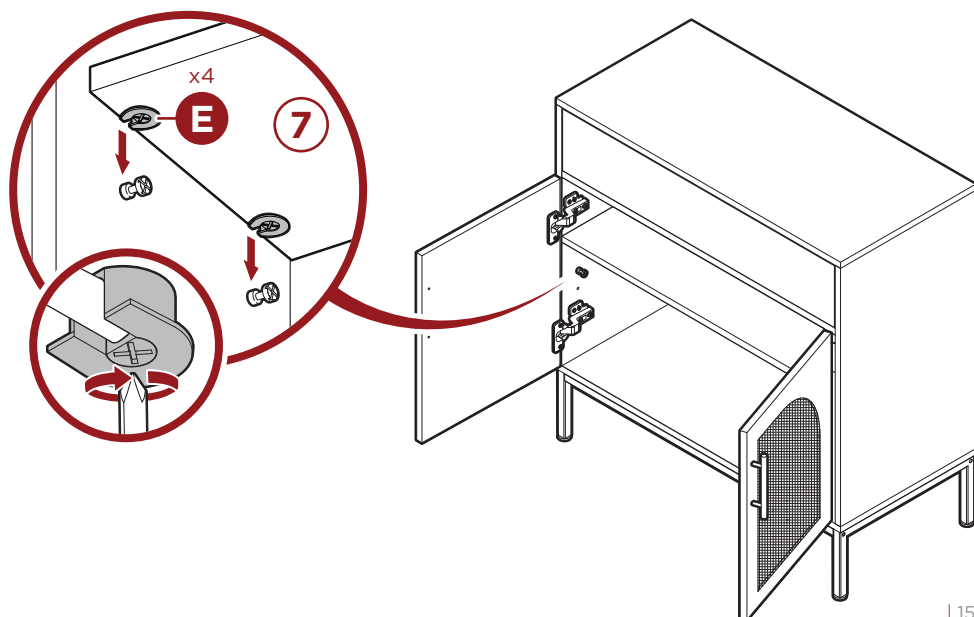
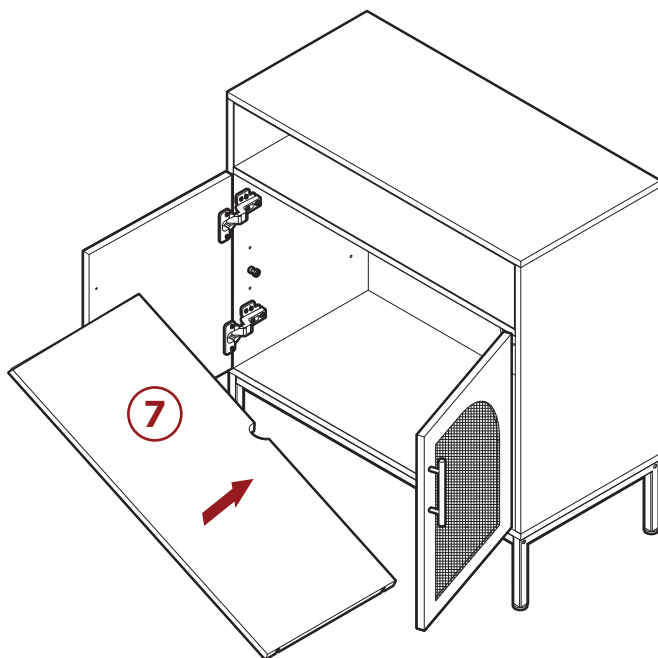



HELP CENTER



Question about your product? We're here to help. Visit us at:

help.bestchoiceproducts.com



Chat Support



Product Inquiry



Orders FAQ



Product Assembly



Returns & Refunds

PRODUCT WARRANTY INFORMATION

All items can be returned for any reason within 60 days of the receipt and will receive a full refund as long as the item is returned in its original product packaging and all accessories from its original shipment are included. All returned items will receive a full refund back to the original payment method. All returned items will not be charged a re-stocking fee.

All returned items require an RA (Return Authorization) number, which can only be provided by a Best Choice Products Customer Service Representative when the return request is submitted. Items received without an RA may not be accepted or may increase your return processing time. Once an item has been received by Best Choice Products, refunds or replacements will be processed within 5 business days.

All returns must be shipped back to the Best Choice Products Return Center at the customer's expense. If the reason for return is a result of an error by Best Choice Products then Best Choice Products will provide a pre-paid shipping label via email. Boxes for return shipping will not be provided by Best Choice Products, and is the customer's responsibility to either use the original shipping boxes or purchase new boxes.

Pictures may be required for some returns to ensure an item is not damaged prior to its return. Items returned are not considered undamaged until they are received by Best Choice Products and verified as such. All damages to items are the customer's responsibility until the item has been received by and acknowledge by Best Choice Products as undamaged.

© Best Choice Products, Inc. All rights reserved. Distributed by Best Choice Products, Inc. Tustin, CA 92780



WARNING

Manufacturer and seller expressly disclaim any and all liability for personal injury, property damage or loss, whether direct, indirect, or incidental, resulting from the incorrect attachment, improper use, inadequate maintenance, unapproved modification, or neglect of this product.