

Grow and Go™ Extend 'n Ride LX

All-in-One Convertible Car Seat

Your model may look different than one shown on cover.

Read all instructions BEFORE USING this car seat.

KEEP INSTRUCTIONS FOR FUTURE USE.

⚠ Failure to follow the warnings on the labels and in the instruction manual can result in serious injury or death to your child. Serious injury may include paralysis and/or permanent brain injury.

4358-8710 07.02.25

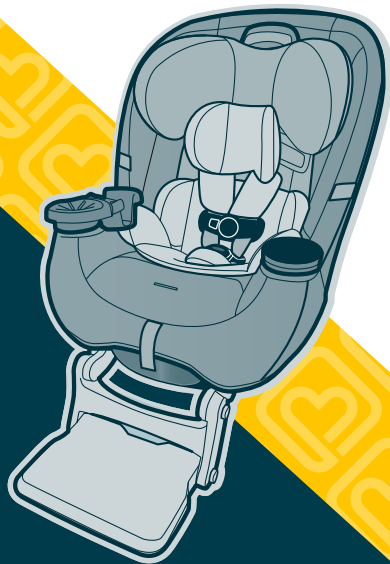

Welcome to the Safety 1st Family!

Thank you for
choosing this car
seat, also known as
a child restraint!

To help you get
started using your
child's new car seat,
here are the 4 main
tasks you'll need
to complete.

1

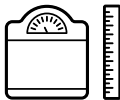

**Measure
Your Child**

2



**Adjust Car Seat to
Fit Your Child**



**Install Car Seat
into Your Vehicle**



**Secure Your Child
in Car Seat**

Your child's safety is worth the time it will take to read and follow these instructions.

Ready? Let's go!

Pages 1–4 will introduce you to the parts of the car seat.

The Back Cover of this Manual has our contact information.

If at any point you would like assistance, please feel free to reach out to us.

Contents

1	Getting Started	29	Securing Child in Car Seat
1	Parts of Car Seat	32	Booster Seat Section
3	Accessory Use	34	Storing Harness System
5	Choosing Car Seat Mode	37	Booster Seat Use in Vehicle
7	Rear-Facing Section	40	Booster Seat Child Fit
9	Rear-Facing Child Fit	41	Making Adjustments to Car Seat
11	Rear-Facing Vehicle Install	41	Changing Headrest/Harness Height
18	Forward-Facing Section	42	Changing Buckle Position
20	Forward-Facing Child Fit	44	Harness System Adjustments for Smaller Infants
22	Forward-Facing Vehicle Install	48	Reclining Car Seat
		49	Using Footrest

50 Wash and Care

50 Removing Seat Pad Set

**52 Cleaning Parts of Car Seat and
Installing Seat Pad Set**

53 Vehicle Belt and LATCH Information

53 LATCH: Lower Anchor Belt

55 Vehicle Belts

59 Top Tether

60 Safety Information

60 Child Restraint Use

61 Vehicle Seating Position

62 Installation in Vehicle

63 Replacement and Expiration

64 Registration and Safety Notices

65 Aircraft Information

66 Warranty

©2025 Dorel Juvenile Group, Inc. Safety 1st™ and the Safety 1st logo and design are trademarks of Dorel Juvenile Group, Inc. (800) 544-1108 www.safety1st.com. Styles and colors may vary. Los estilos y los colores pueden variar. Made in USA from American and imported parts (including seat pad). Hecho en EE.UU. a partir de piezas americanas e importadas (incluyendo la almohadilla del asiento). Distributed by (distribuido por) Dorel Juvenile Group, Inc., 2525 State St., Columbus, IN 47201-7494. Dorel Juvenile Canada, 2233 Argentia Road, Suite 110, Mississauga, ON L5N 2X7. Representante exclusivo en Chile: DOREL JUVENILE CHILE S.A. Av. del Parque 4161, oficina 602 A, Huechuraba, Santiago, Chile - Fono: 56 2 24971500 - www.infanti.cl - www.dorel.cl. Importado y distribuido en Perú por: COMEXA COMERCIALIZADORA EXTRANJERA S.A. SUCURSAL DEL PERÚ - Los Libertadores 455, San Isidro, Lima 27, Lima, Perú RUC 20431062870 - Fono: 4413029 - www.infanti.com.pe. En Centro América, Caribe y Ecuador por: Best Brands Group S.A. - Av. Balboa, Bay Mall Plaza, Planta Baja, local 9, Panamá. - Fono: (507) 300 2884. En Colombia por: Baby Universe S.A.S. - Vía 40 No. 77-29, Barranquilla, Colombia - Fono: (575) 353 1110 Importador: DJGM, S.A. DE C.V. Gabriel Mancera No. 1041 Col. Del Valle, Benito Juárez C.P. 03100 México, Ciudad de México R.F.C. DJG140305GN9 Tel. (55) 67199202



Parts of Car Seat

1

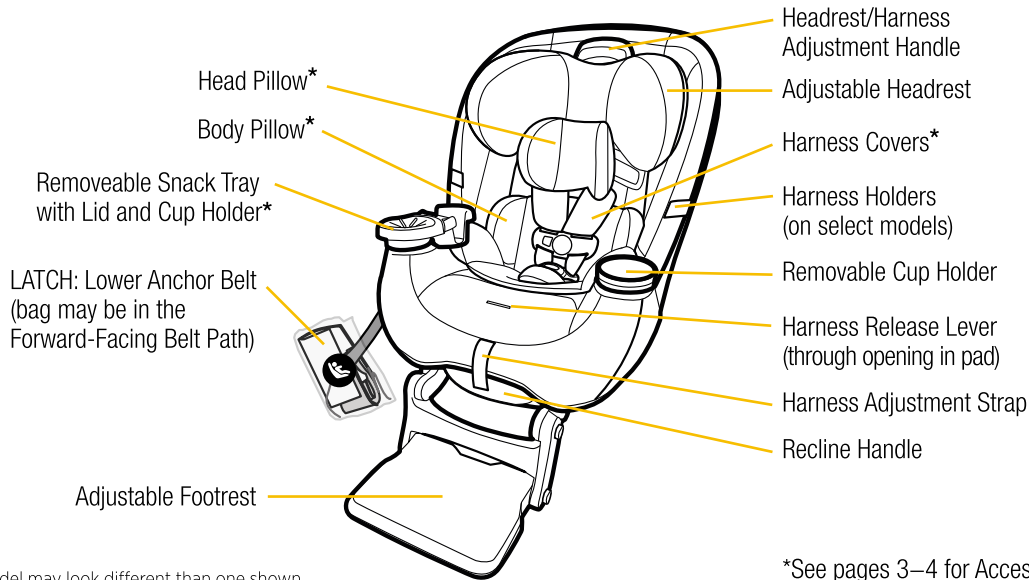

Your model may look different than one shown.

*See pages 3–4 for Accessory Use.

Harness System

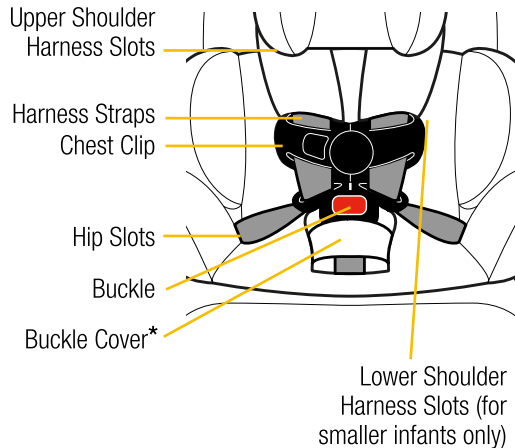

*See pages 3–4 for Accessory Use.

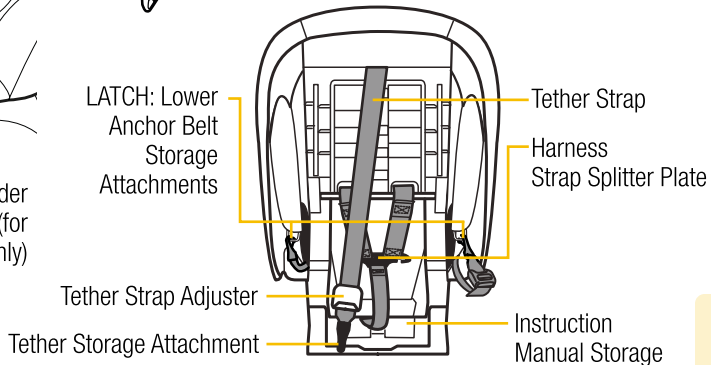
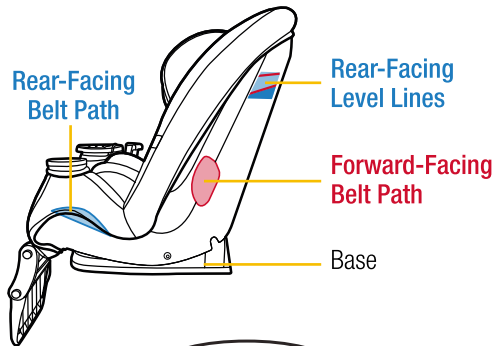

Accessory Use

3

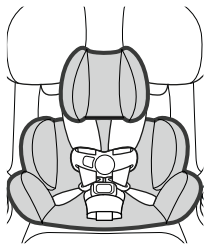

Head and Body Pillows

For Optional Use in **Rear-Facing Mode Only**

The head and body pillows MUST be used together.

To remove head pillow: From the back of the head pillow, gently pull the fabric tabs out of the slots in the seams of the headrest fabric.

To attach head pillow: Insert the fabric tabs on the back of the head pillow into the slots in the seams of the headrest fabric.

To remove body pillow: Undo the buckle and then pull it through the slot in the body pillow. Gently pull the body pillow off the car seat.

To attach body pillow: Undo the buckle and place the body pillow in the seat. Pull the buckle through the body pillow using the same buckle slot as the seat pad.

If using the lower shoulder harness slots for smaller infants, see page 45–47.

To rethread harness for upper harness slots, see page 47.



Buckle Cover

For Optional Use in **Rear-Facing Mode** or **Forward-Facing Mode**

To remove buckle cover: Undo the buckle and pull the buckle cover off the buckle.

To install buckle cover: Undo the buckle and slide the cover over the buckle. Tuck the bottom part of the cover behind the buckle strap into the body pillow or seat pad slot.

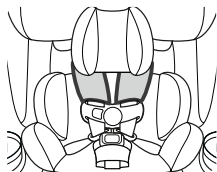

Harness Covers

For Optional Use in **Rear-Facing Mode** or **Forward-Facing Mode**

The harness covers help provide comfort to your child's neck.

If the harness covers will not allow proper positioning of the chest clip or interfere with getting a tight enough harness fit for a smaller infant, remove and do not use. Store until your child is large enough to use the harness covers while maintaining a properly fitting harness.

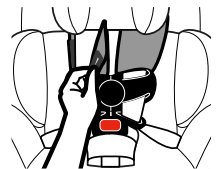

To remove harness covers:
Pull the fastening strips apart and pull the harness covers off the harness straps.

To install harness covers:
Place the upper part of the harness strap above the chest clip into the harness cover. Reattach both sides of the fastening strip. Repeat with the other harness cover.



Removable Cup Holder(s), Snack Lid, and Snack Tray

For Use in All Modes
The cup holder(s), snack lid, and snack tray are top-rack dishwasher safe.

To remove cup holder: twist the cup holder counterclockwise. Pull it out of the slot in the car seat.

To remove snack lid: pull it off the top of the cup holder.

To remove snack tray: locate the 2 tabs underneath of the snack tray. Squeeze them together and lift the snack tray out of the slot in the car seat.

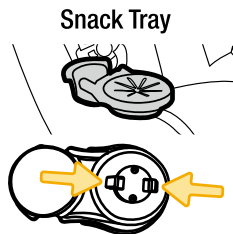

WARNING

Failure to follow these instructions may result in serious injury or death to your child. Serious injury can include paralysis and/or permanent brain injury.

Be certain to measure your child's weight and height (do not guess) before choosing this car seat's mode.

Your child's height, weight, and age determine how the car seat should be placed in the vehicle.

Children vary widely in body size, shape, and temperament—**please consult your doctor before switching between any modes within the limits and fit requirements of the car seat.**

Infants and Toddlers

Children must ride rear-facing and remain rear-facing until they reach the maximum weight or height limits for rear-facing mode. Rear-facing child restraints installed behind another vehicle seat must be installed touching the back of the vehicle seat in front of it, or be as close as possible.

Toddlers and Preschoolers

Children can only use a forward-facing car seat once they outgrow rear-facing weight or height limits. Once they are forward-facing, children must use their child restraint in forward-facing mode with a harness until they reach the maximum weight or height limits for forward-facing harness mode.

School-Aged Children

Children can only use a belt-positioning booster car seat once they outgrow forward-facing harness weight or height limits. Children must use the belt-positioning booster mode until the vehicle's lap and shoulder seat belt fit them properly without the belt-positioning booster.



Rear-Facing Mode

5–40 lb (2.3–18 kg) and
19–40 in. (48–101.6 cm)

In this car seat, your child **MUST** ride **Rear-Facing** and remain in **Rear-Facing** mode until they outgrow any one of the above.

Rear-Facing Section

PAGE 7

Rear-Facing Child Fit

PAGE 9

Rear-Facing Vehicle Install

PAGE 11



Forward-Facing Mode

30–65 lb (13.7–29.5 kg) and
34.4–49 in. (87.1–125 cm)

In this car seat, your child **MUST** remain in harnessed **Forward-Facing** mode until they outgrow any one of the above.

Forward-Facing Section

PAGE 18

Forward-Facing Child Fit

PAGE 20

Forward-Facing Vehicle Install

PAGE 22



Booster Seat Mode

40–100 lb (18.1–45.4 kg) and
43.4–52 in. (110.1–132.1 cm)

In this car seat, your child can use the **Booster Seat** mode until they fit the vehicle's lap and shoulder seat belt properly without a **Booster Seat** **OR** outgrow any one of the above.

Booster Seat Section **PAGE 32**

Storing Harness System **PAGE 34**

Booster Seat Use in Vehicle **PAGE 37**

Booster Seat Child Fit **PAGE 40**

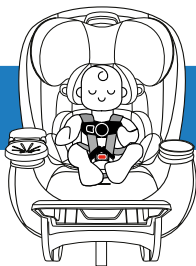

5–40 lb (2.3–18 kg) and 19–40 in. (48–101.6 cm)

In this car seat, your child **MUST** ride **Rear-Facing** and remain in **Rear-Facing** mode until they outgrow any one of the following:

- **Weight Limit:** 40 lb (18 kg); **OR**
- **Height Limit:** 40 in. (101.6 cm); **OR**
- **Rear-Facing Child Fit** requirements, see page 9.

Before installing the car seat in your vehicle, check your child's fit in the car seat.

This way you won't have to redo the vehicle installation to make adjustments to the car seat.

Rear-Facing Child Fit: Page 9

Rear-Facing Vehicle Install: Page 11

WARNING



NEVER install a rear-facing child restraint in the front seat of a vehicle equipped with an active frontal airbag.

DO NOT use the tether for rear-facing mode. Secure the tether strap hook to its storage attachment.

DO NOT use the lower anchor belt along with the vehicle lap or lap/shoulder belt.

DO NOT fasten multiple lower anchor hooks on the same lower anchor bar in the vehicle.

Check the vehicle belt or the lower anchor belt before each use.

Use **ONLY** if the belt can be tightened properly and locked securely in place.

Even when unoccupied, this child restraint **MUST** be firmly secured to the vehicle with the lower anchor belt or with the vehicle seat belt.

This child restraint **MUST ALWAYS** face the rear of the vehicle until the child has reached the maximum weight or height limit for the rear-facing mode.

1

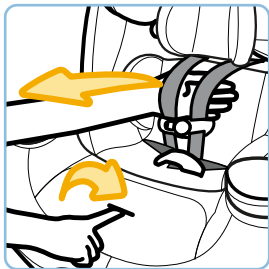

Fully Loosen Harness Straps

Push down on the harness release lever (through the opening in the pad) while pulling out on the harness straps as shown.

2

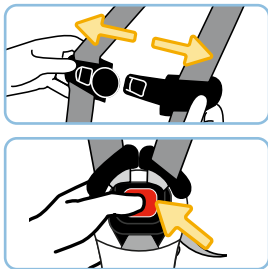

Undo Chest Clip and Buckle

It may be easier to undo the buckle by pressing in towards the top of the button.

3

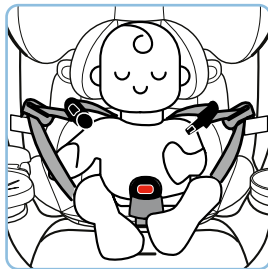

Place Child in Car Seat

Your child's bottom and back should be flat against the car seat.

4

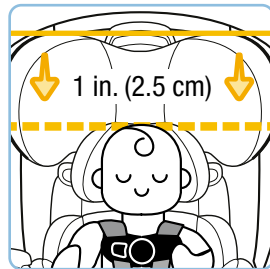

Check Head Position

The top of your child's head **must be at least 1 in. (2.5 cm) below** the top of the car seat's headrest.

5

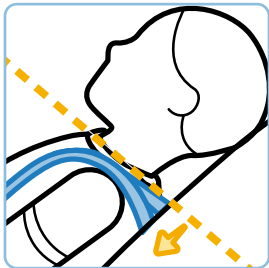

Check Harness Strap Position

The harness strap **MUST** be placed **at the shoulder** when possible, or slightly below; never above.

6

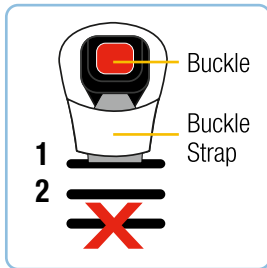

Check Buckle Position

- Use the slot closest to your child.
- The buckle strap **should not be underneath or behind** your child.

DO NOT use 3rd slot in **Rear-Facing Mode**.

i

To change the harness strap height, see page 41.

To change the buckle position, see page 42.

To learn how to check harness tightness, see pages 29–30.

If you cannot achieve a snug harness fit for your child, see pages 44–47.



- Before installing the car seat in your vehicle, check to see if you need to adjust the buckle position for your child. **See step 6 on page 10 for child fit.** Once the car seat is installed, you will not be able to adjust the buckle position.
- **Review vehicle owner's manual.** Determine the type of vehicle belts in your car and how to use them to lock a car seat in place **OR** where LATCH: lower anchor seating positions are located in your vehicle.
- If you are using a vehicle belt to install the seat, make sure the lower anchor belt is stored away (see page 54).
- Make sure the tether strap is properly stored away (see page 59).

There are 2 different methods for install.

Use only one:



Vehicle Belt

OR



LATCH: Lower Anchor Belt



WARNING

DO NOT use both the LATCH: lower anchor belt and vehicle belt at the same time to install the car seat.

1

2

3

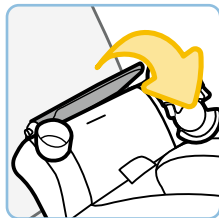

Rotate Footrest Out of Way For Now

You will make adjustments to the footrest **AFTER** the car seat is installed.

For more information about using the footrest, see page 49.

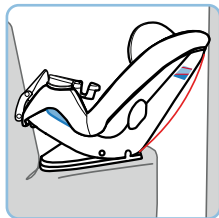

Place Car Seat Rear-Facing in Back Seat

The car seat base **MUST** be flat on the vehicle seat.

When using the passenger or driver-side locations, the car seat **MUST** be touching the back of the vehicle seat in front of it, or be as close as possible.

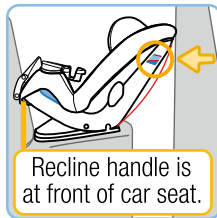

Recline handle is at front of car seat.

Recline Car Seat and Check Rear-Facing Level Lines

For children 5–30 lb (2.3–13.6 kg) and 19–34.3 in. (48–87 cm), the bottom level line on the car seat **MUST** be parallel with the ground.

For children 30–40 lb (13.7–18 kg) and 34.4–40 in. (87.1–101.6 cm) **AND** can sit up unassisted, the top level line on the car seat **MUST** be parallel with the ground.

i

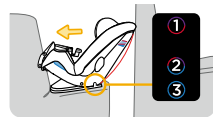

Use Position 3 or 2 to make sure the appropriate level line for your child's weight and height is parallel to the ground.

DO NOT use Position 1 for Rear-Facing Mode. See Reclining Car Seat on page 48.

continued on next page

4

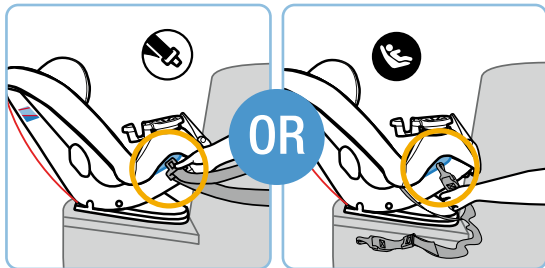

Locate **Rear-Facing Belt Path** and Route Vehicle Belt or Lower Anchor Belt through It

For the Lower Anchor Belt: You may need to fully lengthen the belt before routing it into the belt path. Squeeze the adjuster button and pull the belt out as shown.



5

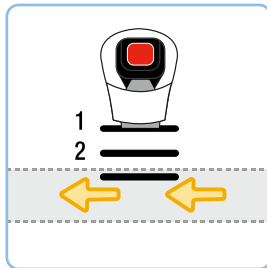

Vehicle Belt or Lower Anchor Belt Goes:

- Under the car seat pad; **AND**
- Across the car seat; **AND**
- In front of the buckle; **AND**
- Out the other **Rear-Facing Belt Path** opening.

DO NOT twist belt.

i

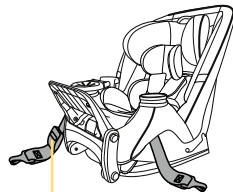

Adjuster

Finished Lower Anchor Belt Routing

The adjuster can be on either side of the car seat.

6

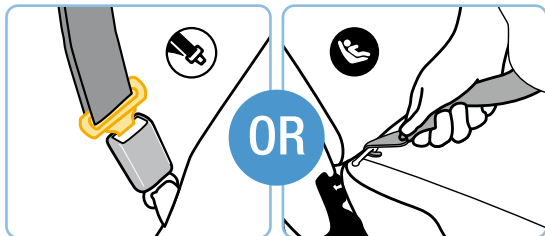

Buckle Vehicle Belt

If your car has a **switchable retractor**, use it to lock the vehicle belt. Review page 57 of this manual or your vehicle owner's manual.

Attach Lower Anchor Belt Hooks to Vehicle's Lower Anchors

7

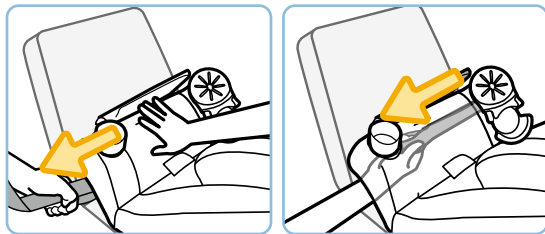

Tighten Belt

Place your hand in the car seat and firmly push the car seat down and back towards the vehicle seat. Pull the belt towards you and parallel (in line) with the belt path as shown.

For the Lower Anchor Belt or Lap Only Vehicle Belt: it may be easier to tighten if you route the free end of the belt back into the **Rear-Facing Belt Path**, reach into the **Rear-Facing Belt Path**, and pull the free end of the belt towards you.

continued on next page

8

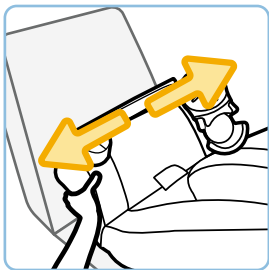

Check Belt Tightness

Hold the **Rear-Facing Belt Path** with your non-dominant hand. Push and pull the car seat from side to side. It should not move more than **1 in.** (2.5 cm) at the belt path.

i

If the car seat moves more than 1 in. (2.5 cm), you can try:

- Pulling the belt tighter; **OR**
- Reinstalling the car seat; **OR**
- Changing to a different seating location; **OR**
- Switching to a different install method (LATCH or vehicle belt).

9

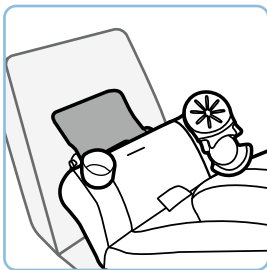
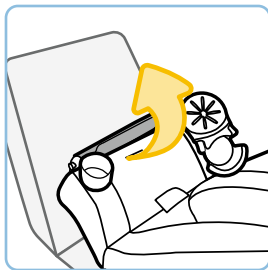

Adjust Footrest

Use one of the 3 **Rear-Facing** footrest positions to put the footrest as flush against the vehicle seat as possible. The footrest does not need to touch the back of the vehicle seat; there can be a small gap.



Rear-Facing Mode Footrest Use



1A



1B



1C

For more information
about using the
footrest, see page 49.

10

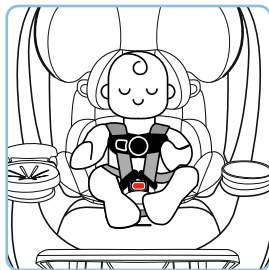

Secure Child in Car Seat

See page 29–31.

11

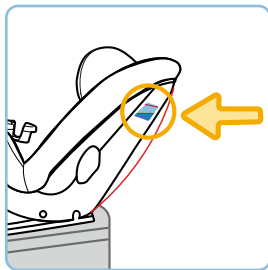

Recheck Rear- Facing Level Lines

Redo the installation if the
car seat is not reclined
correctly for your child.
See step 3 and the info
box on page 12.

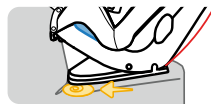

Only if necessary, you
may place a tightly
rolled towel(s) or foam
pool noodle(s) under
the front of the car seat
base to help make the
appropriate **Rear-Facing
Level Line** for your
child's weight and height
parallel with the ground.

Check often to make sure
padding is still in place
and the belt is tight.

continued on next page

FINISHED!

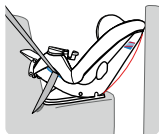

Lap/Shoulder Belt



Lap Belt

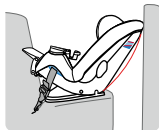

LATCH: Lower
Anchor Belt

- ☒ **Vehicle Belt Install:** Is the vehicle belt locked? See step 6.
- ☒ **LATCH: Lower Anchor Belt Install:** Are the hooks securely attached to the vehicle's lower anchors? See step 6.
- ☒ Is the belt tightened enough so that the car seat does not move more than 1 in (2.5 cm) from side to side at the belt path? Check the tightness of the install often to make sure it has not loosened. See steps 7 and 8.
- ☒ Is the appropriate level line for your child parallel with the ground? See steps 3 and 11 and the info box on page 12.
- ☒ Is the footrest in either position 1A, 1B, or 1C? See step 9.

When using the passenger or driver-side locations, the car seat **MUST** be touching the back of the vehicle seat in front of it, or be as close as possible.

Forward-Facing Section



30–65 lb (13.7–29.5 kg) and 34.4–49 in. (87.1–125 cm)

In this car seat, your child **MUST** remain in harnessed **Forward-Facing** mode until they outgrow any one of the following:

Weight Limit: 65 lb (29.5 kg); **OR**

Height Limit: 49 in. (125 cm); **OR**

Forward-Facing Child Fit requirements, see page 20

Before installing the car seat in your vehicle, check your child's fit in the car seat.

This way you won't have to redo the vehicle installation to make adjustments to the car seat.

Forward-Facing Child Fit: Page 20

Forward-Facing Vehicle Install: Page 22

WARNING

DO NOT use the lower anchors of the child restraint anchorage system (LATCH system) to attach this child restraint when restraining a child weighing more than 50 lb (22.7 kg).

The vehicle belt **MUST** be used for installation if your child weighs more than 50 lb (22.7 kg).

When anchors are available, you **MUST ALWAYS** attach, adjust, and secure the tether (top anchorage) strap when installing the car seat in the Forward-Facing mode with internal harness.

DO NOT use the lower anchor belt along with the vehicle lap or lap/shoulder belt.

Check the vehicle belt or the lower anchor belt before each use.

Use **ONLY** if the belt can be tightened properly and locked securely in place.

DO NOT fasten multiple lower anchor hooks on the same lower anchor bar in the vehicle.

Even when unoccupied, this child restraint **MUST** be firmly secured to the vehicle with the lower anchor belt or with the vehicle seat belt.

Before using this seat in Forward-Facing mode, your child must have outgrown the seat in rear-facing mode.

Forward-Facing Child Fit

1

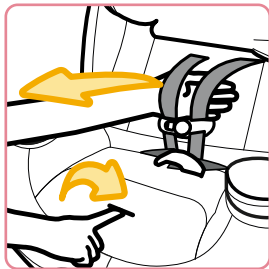

Fully Loosen Harness Straps

Push down on the harness release lever (through the opening in the pad) while pulling out on the harness straps as shown.

2

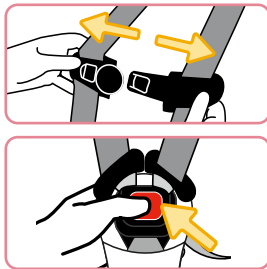

Undo Chest Clip and Buckle

It may be easier to undo the buckle by pressing in towards the top of the button.

3

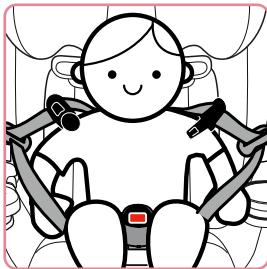

Place Child in Car Seat

Your child's bottom and back should be flat against the car seat.

4

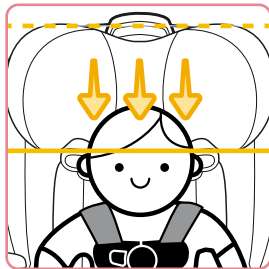

Head Position

The top of your child's ears **MUST be below** the top of the car seat's headrest.

continued on next page

5

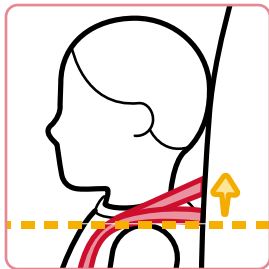

Harness Strap Position

The harness strap **MUST** be placed **at the shoulder** when possible, or slightly above; never below.

6

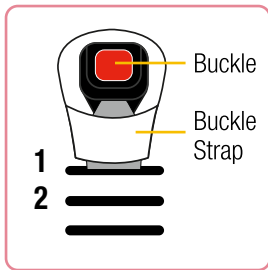

Buckle Position

- Use the slot closest to your child.
- The buckle strap **should not be underneath or behind** your child.

The buckle can be used in **any** buckle slot.

i

To change the harness strap height, see page 41.

To change the buckle position, see page 42.

To learn how to check harness tightness, see pages 29–30.

Forward-Facing Vehicle Install



- Before installing the car seat in your vehicle, check to see if you need to adjust the buckle position for your child. **See step 6 on page 21 for child fit.**
- **Review vehicle owner's manual.** Determine what kind of vehicle belts your car has and how to use them to lock a car seat in place **OR** where LATCH: lower anchor seating positions are located in your vehicle.
- If you are using a vehicle belt to install the seat, make sure the lower anchor belt is stored away (see page 54).

There are 2 different methods for install.

Use only one:



Vehicle Belt+ Tether

for a child up to 65 lb (29.5 kg)

OR



**LATCH: Lower Anchor Belt
+ Tether**

Do not install by this method for a child weighing more than 50 lb (22.7 kg).

WARNING

DO NOT use both the LATCH: lower anchor belt and vehicle belt at the same time to install the car seat.

When anchors are available, you **MUST ALWAYS** attach, adjust, and secure the tether (top anchorage) strap when installing the car seat in the Forward-Facing Mode with internal harness.

continued on next page

1

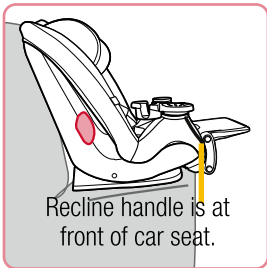

Recline handle is at front of car seat.

Put Car Seat Upright into Position 1 and Place Car Seat Forward-Facing in Back Seat

The base of the car seat should be flat against the vehicle seat bottom. The vehicle seat back **MUST** be in the upright position, but you can adjust the angle slightly to better match the angle of the car seat. Refer to the vehicle owner's manual for how to adjust the vehicle seat back.

i

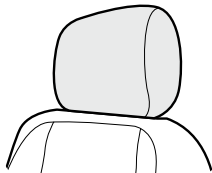

If your vehicle has a headrest that interferes with a flush car seat fit, check your vehicle owner's manual to see if it can be removed, adjusted, or if there are other possible seating locations for you to install.

2

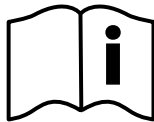

Locate Vehicle Top Tether Anchors

Review your vehicle owner's manual for top tether anchor locations and how to route the tether strap when there are vehicle headrests.

3

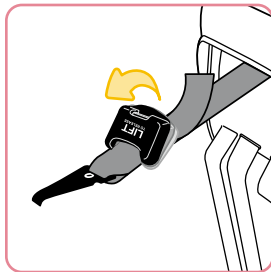

Loosen Tether Strap

Lift the tether adjuster to loosen the strap. Or, if your car seat has an adjuster with a button, then squeeze the adjuster button and pull the strap to loosen as shown.



4

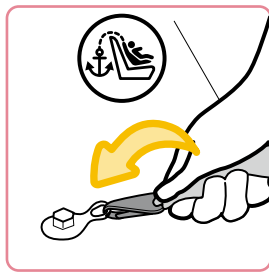

Attach Tether Hook to Vehicle's Top Tether Anchor

5

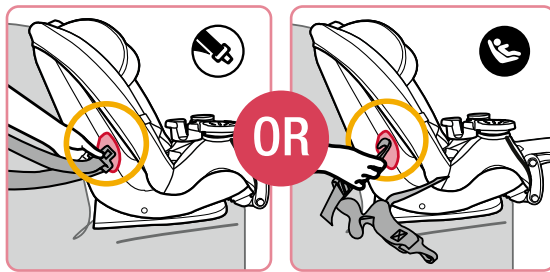

Locate **Forward-Facing Belt Path** and Route Vehicle Belt or Lower Anchor Belt through It

For the Lower Anchor Belt: You may need to fully lengthen the belt before routing it into the belt path. Squeeze the adjuster button and pull the belt out as shown.

continued on next page

6



Vehicle Belt or Lower Anchor Belt Goes:

Under the car seat pad; **AND**

Across the car seat; **AND**

Out the other **Forward-Facing Belt Path** opening.

DO NOT twist belt.

i



Finished Lower Anchor Belt Routing

The adjuster can be on either side of the car seat.

7

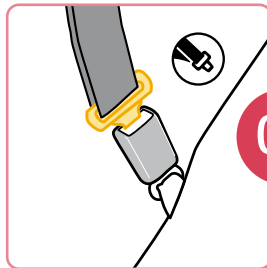

OR



Buckle Vehicle Belt

If your car has a **switchable retractor**, use it to lock the vehicle belt. Review page 57 of this manual or your vehicle owner's manual.

Attach Lower Anchor Belt Hooks to Vehicle's Lower Anchors

8

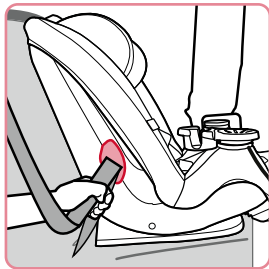

Tighten Belt

Place your hand in the car seat and firmly push the car seat down and back towards the vehicle seat. Pull the belt towards you and parallel (in line) with the belt path as shown.

For the Lower Anchor Belt or Lap Only Vehicle Belt: it may be easier to tighten if you route the free end of the belt back into the **Forward-Facing Belt Path**, reach into the **Forward-Facing Belt Path**, and pull the free end of the belt towards you.

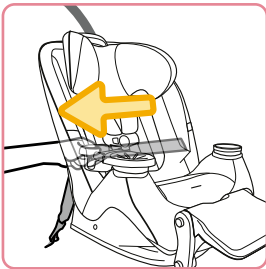

9

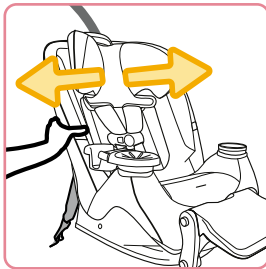

Check Belt Tightness

Hold the **Forward-Facing Belt Path** with your non-dominant hand. Push and pull from side to side. It should not move more than **1 in.** (2.5 cm) at the belt path.

i

If the car seat moves more than 1 in. (2.5 cm), you can try:

- Pulling the belt tighter; **OR**
- Reinstalling the car seat; **OR**
- Changing to a different seating location; **OR**
- Switching to a different install method (LATCH or vehicle belt).

continued on next page

10

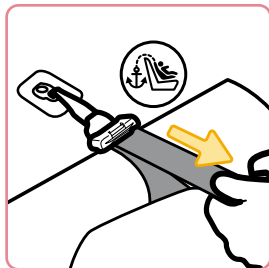

Tighten Tether

Push firmly on the back of the car seat and pull the free end of the tether strap to remove all of the slack.

11



Adjust Footrest

Use the **Forward-Facing** footrest arm and footrest positions that best fits your child. You may also place the footrest into the storage position. Your child's knees **MUST NOT** pass the top of the cup holders and/or snack tray.

i

Forward-Facing Mode Footrest Use



1D



1E



2 or 3



and any footrest position
that best fits your child.



Storage

For more information
about using the
footrest, see page 49.

FINISHED!

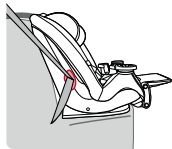

Lap/Shoulder Belt + Tether
for a child up to 65 lb (29.5 kg)

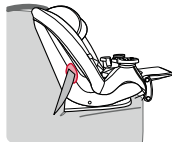

Lap Belt + Tether
for a child up to 65 lb (29.5 kg)

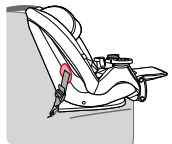

LATCH: Lower Anchor Belt + Tether



Do not install by this method for a child weighing more than 50 lb (22.7 kg).



Vehicle Belt Install: Is the vehicle belt locked? See step 7.



LATCH: Lower Anchor Belt Install: Are the hooks securely attached to the vehicle's lower anchors? See step 7.



Is the belt tightened enough so the car seat does not move more than 1 in (2.5 cm) from side to side at the belt path? Check the tightness of the install often to make sure it has not loosened. See steps 8 and 9.



Has the tether been installed and tightened? See steps 4 and 10.



Is the footrest in a position that best fits your child? See step 11.

Securing Child in Car Seat

29

1

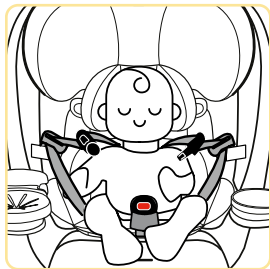

Place Child in Car Seat

Your child's bottom and back should be flat against the car seat.

2

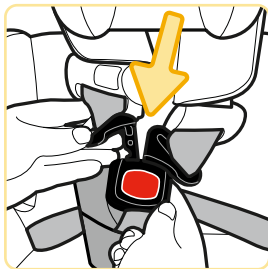

Buckle Harness

Pull the harness straps up to make sure buckle is locked.

3

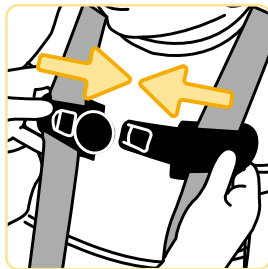

Fasten Chest Clip

Insert right half of the chest clip into the left half and snap together.

4

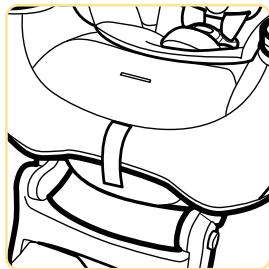

Tighten Harness

Pull the harness adjustment strap straight out to snugly tighten the harness.

5

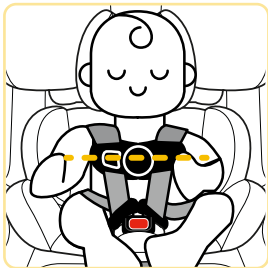

Position Chest Clip

Slide chest clip up the harness straps and position it at mid-chest (even with armpits) and away from your child's neck.

6

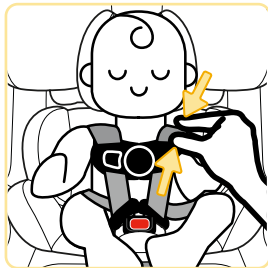

Check Harness Tightness

Unfasten harness covers.

Try to pinch the harness at the shoulders vertically between index finger and thumb as shown.

If your fingers slip off, the harness is tight enough.

If you can pinch the harness strap, tighten more.

Fasten harness covers.

i

A snug strap should not allow any slack. It lies in a relatively straight line without sagging. It does not press on the child's flesh or push the child's body into an unnatural position.

If one side of the harness is tighter than the other, lengthen the tighter side by pulling up the harness near the hip slot.

continued on next page

FINISHED!



Your child is now secured in the car seat.

Check your child's fit often and make any needed adjustments to the car seat as they grow.

To Remove Child from Car Seat:

1. Loosen harness strap.
2. Unbuckle harness.
3. Release chest clip.
4. Remove child.

Troubleshooting

1. If the buckle or harness release lever sticks: DO NOT lubricate. Check for dropped food, sticky spilled drinks, dirt, leaves, etc.

Clean with warm water and/or remove the object with tweezers. If you cannot get the harness to adjust and remain tight with the buckle securely locked, **do not** use this car seat.

2. If your harness twists:

Straighten the harness each time you put your child in the car seat. Lock the buckle and tighten the harness so it will be ready for next use.

WARNING

Failure to fasten and tighten the harness system correctly may allow the child to be ejected from the child restraint in a crash or sudden stop causing serious injury or death. Serious injury can include paralysis and/or permanent brain injury.

DO NOT mistake comfort for safety. The harness system must be snugly adjusted.



DO NOT put snowsuits or bulky garments on your child when placing them in the child restraint.

Bulky clothing can prevent the harness straps from being tightened properly.

Booster Seat Section



40–100 lb (18.1–45.4 kg) and 43.4–52 in. (110.1–132.1 cm)

In this car seat, your child can use the **Booster Seat** mode until they fit the vehicle's lap and shoulder seat belt properly without a **Booster Seat** OR outgrow any one of the following:

Weight Limit: 100 lb (45.4 kg); **OR**

Height Limit: 52 in. (132.1 cm); **OR**

Booster Seat Child Fit requirements, see page 40

You **MUST** store the harness system and remove the accessories (except the cup holder and/or snack tray) when using the **Booster Seat Mode**. To remove accessories, see pages 3–4.

Storing Harness System: Page 34

Booster Seat Use in Vehicle: Page 37

Booster Seat Child Fit: Page 40

WARNING

DO NOT use the harness system when using as a booster seat.

DO NOT use LATCH when using as a booster seat. Secure the lower anchor belt and the tether strap to their storage attachments.

Warning! Use only the vehicle's lap and shoulder belt system when restraining the child in this booster seat.



DO NOT use only the lap belt when using this seat as a booster seat. The shoulder belt **MUST** always be adjusted snugly across the child's chest.



NEVER place shoulder belt under the child's arms or behind their back.

DO NOT use this booster seat if the tops of your child's ears are above the top of the booster seat's headrest.

Storing Harness System

1



**Fully Loosen
Harness Straps**

2

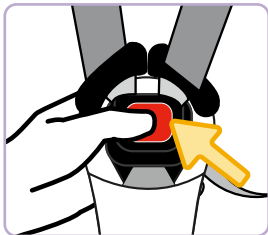

Undo Buckle

3

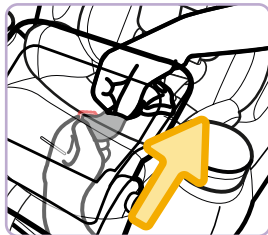

Recline Car Seat

Reach under the car seat.
Rotate the buckle's metal
retainer and push it up
through the car seat.

4

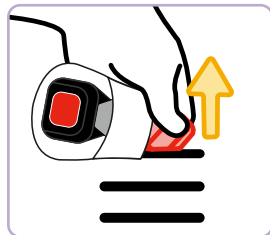

**Pull Buckle and
Buckle Cover Out
of Car Seat**

Store the buckle and
buckle cover in a safe
place for future use.

continued on next page

5

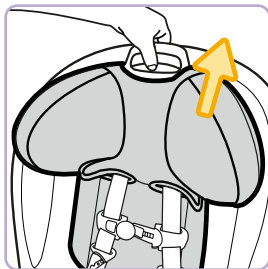

**Adjust Headrest to
Highest Position**

6

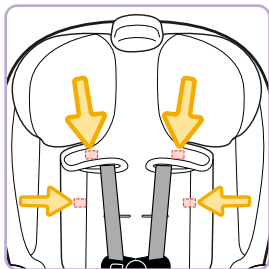

**Undo Fabric Tabs on
Headrest Pad and
Seat Pad**

7

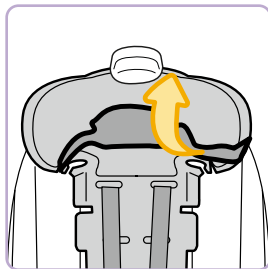

**Gently Pull Headrest
Pad Off Bottom
of Headrest**

8

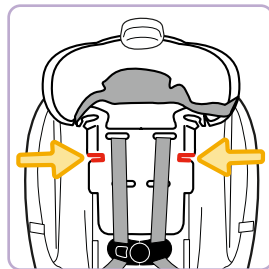

**Thread Harness
Straps into
Slots on Sides
of Headrest**

9

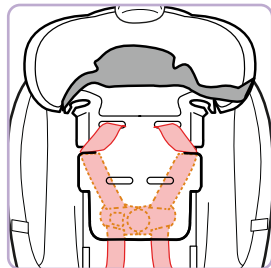

**Place Chest Clip,
Harness Straps,
and Buckle Tongues
Behind Headrest**

10

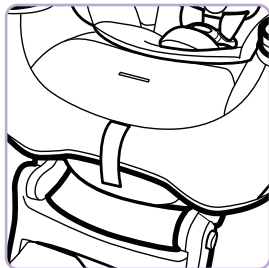

Tighten Harness
Remove any slack from the
harness system.

11

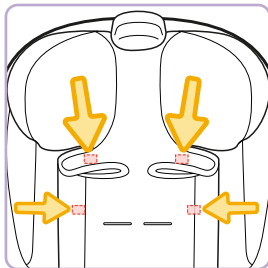

**Wrap Headrest Pad
Around Bottom
of Headrest**

Attach the fabric tabs on
the headrest pad and the
seat pad.

FINISHED!

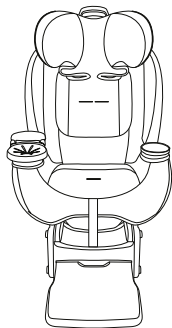

The car seat has
been converted to the
Booster Seat Mode.

See next page for
**Booster Seat Use
in Vehicle.**

1



Recline handle is at front of car seat.

Put Booster Seat into Position 1

Place the booster seat in the back seat. The booster seat **MUST** be flush against the back of the vehicle seat.

The booster seat **MUST be upright**. The vehicle seat back **MUST** be in the upright position, but you can adjust the angle slightly to better match the angle of the car seat. Refer to the vehicle owner's manual for how to adjust the vehicle seat back.

i

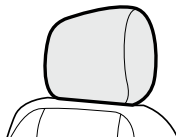

If your vehicle has a headrest that interferes with a flush car seat fit, check your vehicle owner's manual to see if it can be removed, adjusted, or if there are other possible seating locations for you to install.

2



Adjust Footrest

Use the **Booster Seat** footrest arm positions **2** or **3** and any footrest position that best fits your child. You may also place the footrest into the storage position. Your child's knees **MUST NOT** pass the top of the cup holders and/or snack tray.

i

Booster Seat Mode Footrest Use



2 or 3
and any footrest position
that best fits your child.



Storage

For more information
about using the
footrest, see page 49.

3

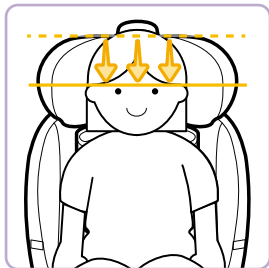

Have Child Sit in Booster Seat

The top of your child's ears
should **never be above**
the top of the booster
seat's headrest.

4

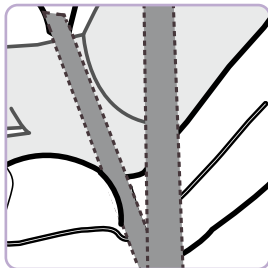

Position Lap Belt on Child

Route the lap belt portion of the
vehicle belt through the **Booster
Seat Belt Path** as shown. The lap
belt should lay snugly across your
child's hips; not on their stomach.

5

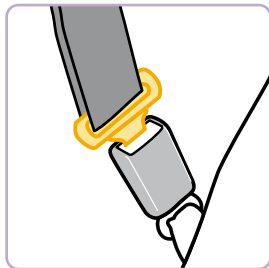

Buckle Vehicle Belt

Pull the shoulder belt
to tighten.

continued on next page

6

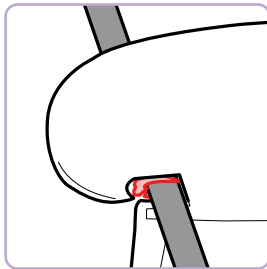

Position Shoulder Belt on Child

Thread the shoulder belt through the belt-positioning guide in the headrest.

Pull the shoulder belt up to tighten so that it lies snugly across the center of your child's shoulder and across their chest.

FINISHED!

Check periodically to make sure your child has not moved out of position and loosened the shoulder belt.

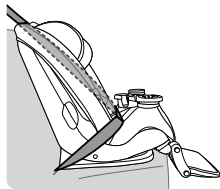

Keep the booster seat securely belted even when unoccupied.

Booster Seat Child Fit

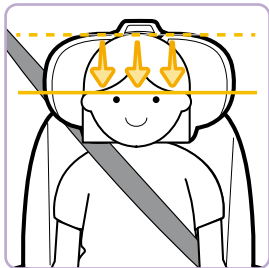

Head Position

The top of your child's ears should **never be above** the top of the booster seat's headrest.

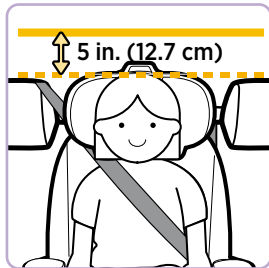

Car Position

DO NOT use the booster seat if your child's head is less than 5 in (12.7 cm) below the roof of the car. Consult your vehicle manual for proper seatbelt usage.

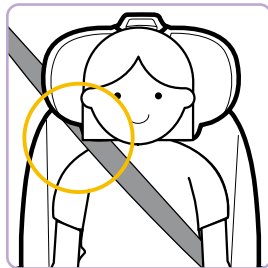

Shoulder Belt Position

The shoulder belt should lay snugly across the center of your child's shoulder and across their chest.

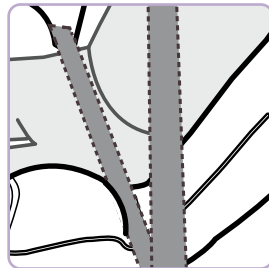

Lap Belt Position

The lap belt should lay snugly across your child's hips; **not on their stomach.**

Changing Headrest/Harness Height

41

1

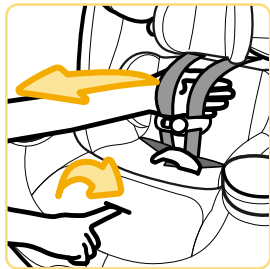

Fully Loosen Harness Straps

Push down on the harness release lever (through the opening in the pad) while pulling out on the harness straps as shown.

2

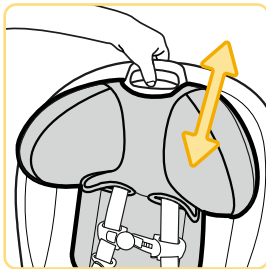

Adjust Headrest/Harness Height

1. Squeeze the adjustment handle lever up.
2. Move the headrest up or down to the proper height for your child.
3. Release the handle to lock in place.
4. Make sure it is locked securely.

i

For Rear-Facing Child Fit, see page 9.

For Forward-Facing Child Fit, see page 20.

To learn how to check harness tightness, see pages 29–30.

If you cannot achieve a snug harness fit for your child, see pages 44–47.

Check the harness straps often for any wear or damage.

Changing Buckle Position

WARNING

Failure to place buckle's metal retainer completely through pad and child restraint can result in serious injury or death. Serious injury can include paralysis and/or permanent brain injury.

1



Unbuckle Harness

Press in towards the top of the red button.

2

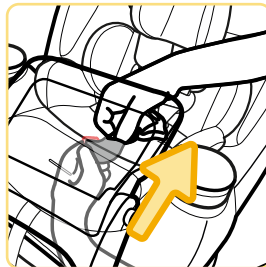

Recline Car Seat

Reach under the car seat. Rotate the buckle's metal retainer and push it up through the car seat.

3

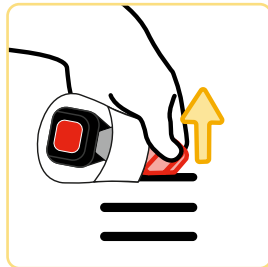

From Top of Car Seat, Pull Buckle and Buckle Cover Out of Car Seat and Pad

continued on next page

4

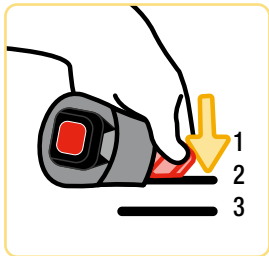

Insert Buckle's Metal Retainer into Buckle Slot Closest to Child

The buckle **MUST** face out. Tuck the ends of the buckle cover into the same pad slot as the buckle.

Rear-Facing Mode: You **MUST** use the 1st or 2nd buckle slot.

Forward-Facing Mode: **ANY** slot can be used.

5

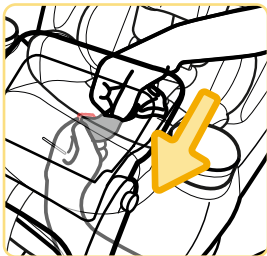

Reach Under Car Seat Between Base and Car Seat

Pull the buckle's metal retainer completely through the seat pad and car seat.

6

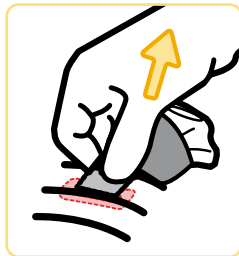

Check Buckle

Pull up on the buckle to make sure it is secured.

The buckle **MUST NOT** pull out.

i

For Rear-Facing Child Fit, see page 9.

For Forward-Facing Child Fit, see page 20.

To learn how to check harness tightness, see pages 29–30.

If you cannot achieve a snug harness fit for your child, see pages 44–47.

Harness System Adjustments for Smaller Infants

i

If you cannot achieve a snug harness fit for your child, you may need to adjust the buckle position and/or harness strap length and location as shown in this section.

WARNING

The harness system **MUST BE** installed correctly. **DO NOT** use a child restraint with damaged harness straps.

Failure to place buckle's metal retainer completely through pad and child restraint can result in serious injury or death. Serious injury may include paralysis and/or permanent brain injury.

Adjusting Buckle

1

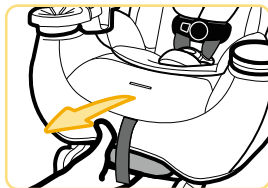

With Buckle in 1st Slot, Fully Recline Car Seat

If you need to move the buckle to the 1st slot, see pages 42–43.

2

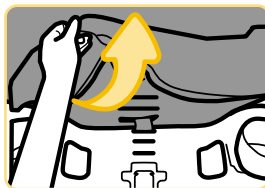

Pull Front of Car Seat Pad Up

3

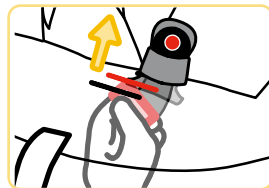

Reach Under Car Seat

Pull the buckle's metal retainer down and then push it up into the middle slot as shown.

continued on next page

Adjusting Harness Straps

4

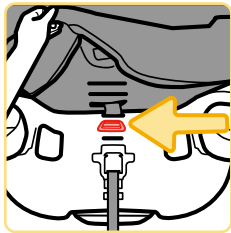

From Top of Car Seat, Lay Metal Retainer Flat Against Car Seat

5

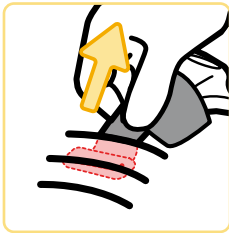

Tuck Car Seat Pad Around Front of Car Seat and Check Buckle

Pull up on the buckle to make sure it is secured. The buckle **MUST NOT** pull out.

i

When using the lower shoulder harness slots for smaller children, you **MUST** use the head and body pillow and the headrest **MUST** be in the lowest position.

1

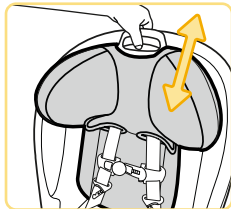

Adjust Headrest to Lowest Position and Fully Loosen Harness Straps



2

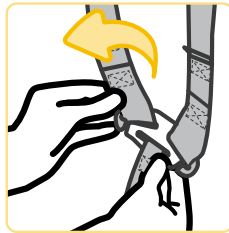

From Back of Car Seat, Remove Harness Strap Loops From Splitter Plate

3

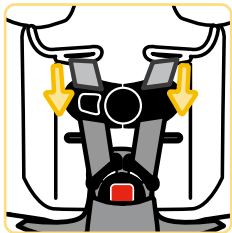

Pull Harness
Straps Out of
Upper Shoulder
Harness Slots

4

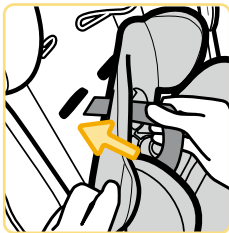

Pull Body Pillow
Forward Away
from Car Seat

Thread the harness straps through the slots in the pillow, the lower shoulder harness slots in the seat pad, and the car seat.

5

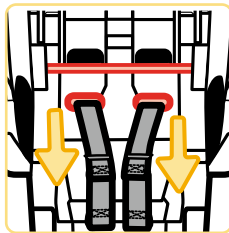

From Back of Car
Seat, Pull Harness
Straps Through
Car Seat

The harness straps **MUST BE** in the shoulder harness slots **below** the metal bar.

6

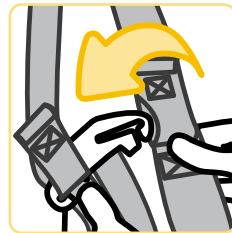

Attach 2nd
Harness Strap
Loops to
Splitter Plate

continued on next page

i

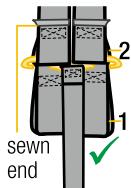

The sewn ends of the harness strap loops **MUST** face towards you.

DO NOT twist the harness strap or the harness adjustment strap.

Make sure the same harness strap loops are fitted completely on both sides of the splitter plate.

i

To return the harness straps to upper shoulder harness slots, follow the steps below to rethread them.

1. Remove harness strap loops from splitter plate and pull harness straps out of lower shoulder harness slots in body pillow and car seat.

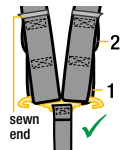
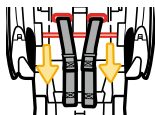

2. Thread harness straps into upper shoulder harness slots in seat pad and car seat.

3. From back of car seat, thread harness straps **OVER** metal bar.

4. Attach 1st harness strap loops to splitter plate. The sewn ends of the harness strap loops **MUST** face towards you. **DO NOT** twist the harness strap or the harness adjustment strap. Make sure the lower harness strap loops (labeled "1") are fitted completely on both sides of the splitter plate.



If harness straps have been removed from chest clip and buckle, rethread them:

The harness strap ends go through the **back** of the buckle tongues and through the chest clip **front to back**.

Reclining Car Seat

This car seat has 3 positions.

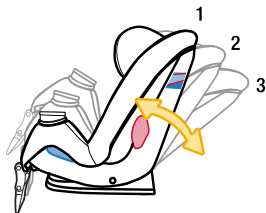

Rear-Facing Mode – 3 Reclined or 2 Semi-reclined

Use Position 3 or 2 to make sure the appropriate **Rear-Facing Level Line** is parallel to the ground. To determine which **Rear-Facing Level Line** to use for your child's weight and height, see page 12 step 3.

Forward-Facing Mode – Position 1 Fully Upright

Booster Seat Mode – Position 1 Fully Upright

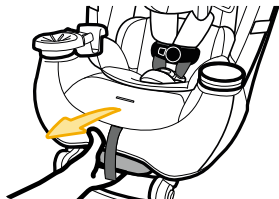

To Recline: Pull out on the recline handle and push the top of the car seat back.

For More Upright: Pull out on the recline handle and pull the top of the car seat forward.



In **Forward-Facing Mode** or **Booster Seat Mode**, the vehicle seat back **MUST** be in the upright position, but you can adjust the angle slightly to better match the angle of the car seat. Refer to the vehicle owner's manual for how to adjust the vehicle seat back.

Using Footrest

49

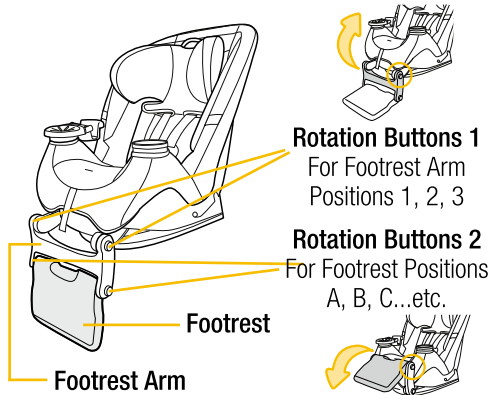

⚠ WARNING



DO NOT use in this position.

Rear-Facing



1A



1B



1C

The footrest does not need to touch the back of the vehicle seat; there can be a small gap.

Forward-Facing



1D



1E



2 or 3
and any footrest
position that best
fits your child.



Storage

Your child's knees **MUST NOT** pass the top of the cup holders and/or snack tray.

Booster Seat



2 or 3
and any footrest
position that best
fits your child.



Storage

Your child's knees **MUST NOT** pass the top of the cup holders and/or snack tray.

i

You do not need to remove the harness system to remove the pad from the car seat.

DO NOT fully pull the harness strap out of the car seat. Leave it threaded in the hip harness slots. If removed, you will not be able to rethread it.

To remove accessories, see pages 3–4.

Removing Seat Pad Set

1

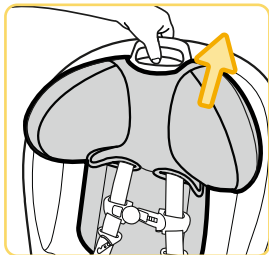

Adjust Headrest to Highest Position

2

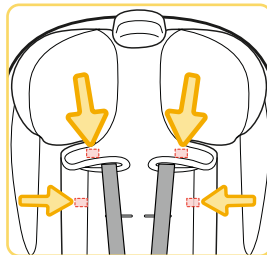

Undo Fasteners on Headrest Pad and Seat Pad

3

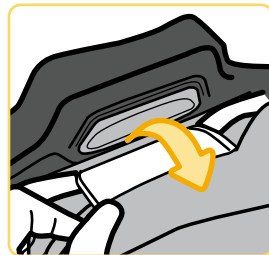

Locate Pad Fabric Tab Slot in Headrest

Pull the fabric tab out of the slot in the headrest as shown.

continued on next page

4

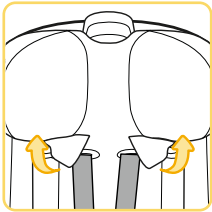

Undo the Fabric Flaps on the Bottom of the Headrest Pad

Pull the two fabric flaps out of the slots between the foam and plastic on the bottom of the headrest.

5

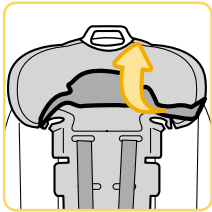

Gently Pull Headrest Pad Off Bottom of Headrest

6

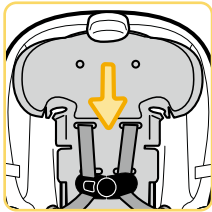

Lower Headrest to Middle of Car Seat

7

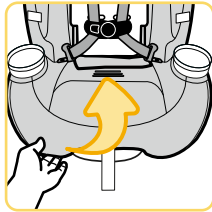

Pull Seat Pad Off Sides and Front of Car Seat

8

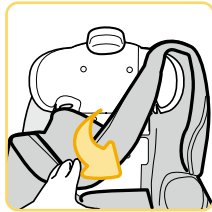

Pull Seat Pad Around Headrest and Off of Car Seat

Cleaning Parts of Car Seat and Installing Seat Pad Set

Cleaning Pad and Accessories

Machine wash separately with cold water on a gentle cycle. Make sure the harness covers are closed so the fastening strips are not exposed. **DO NOT** use bleach. Tumble dry separately for 10-12 minutes on low heat. Remove immediately.

Cleaning Harness Strap

Check the harness straps often for any wear or damage.

Spot clean using warm sudsy water and damp cloth. Spilled food and liquids on the car seat may result in mold or bacterial growth over time. These spills could also attract insects or rodents.

Cleaning Buckle and Car Seat

Spot clean using warm sudsy water and damp cloth. **DO NOT** submerge into water.

Installing Seat Pad Set

1. Lower headrest to middle of car seat.
2. Pull seat pad around headrest and onto car seat.
3. Pull headrest pad on to headrest.
4. Insert the bottom headrest pad fabric flaps into the slots between the foam and plastic in the bottom of the headrest.
5. Insert the top headrest fabric flap into the slot on the top of the headrest.
6. Attach the fabric tabs on the headrest.



DO NOT use the child restraint without the seat pad or with damaged harness straps.

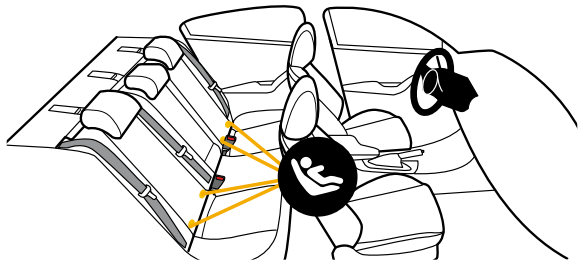

Your vehicle's features may be considerably different than those pictured here.

The lower anchors of **LATCH** (**L**ower **A**nchors and **T**ethers for **C**hildren) is a universal system for installing car seats without using vehicle seat belts. The LATCH: lower anchor belt can **ONLY** be used in vehicles that have the lower anchor bars installed in designated seating positions. Most vehicles manufactured after September 2002 are equipped with LATCH: lower anchor bars. Check your vehicle owner's manual to see which seating positions may be equipped with LATCH: lower anchor bars.

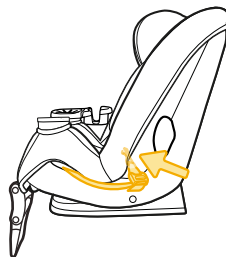

**Lower Anchor Belt
Storage Location**

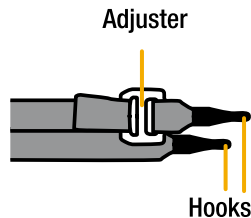

**Lower Anchor
Belt Parts**

To Remove Lower Anchor Belt from Storage Location on Car Seat

Squeeze the spring lever on the hooks and remove the hooks from the attachments in the storage location.

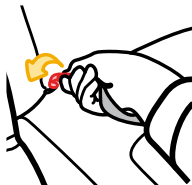
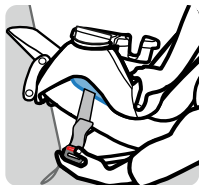

To Remove Lower Anchor Belt from Vehicle's Lower Anchor Bars

1. Remove the tension from the belt by pushing down on the side of the car seat with the adjuster.
2. Then press the adjuster's button to loosen the belt.
3. Squeeze the spring lever on the hooks, push the hooks back into the vehicle seat, and rotate the hooks to the side.
4. Pull the hooks out of the vehicle seat.

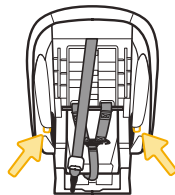

To Store Lower Anchor Belt

The lower anchor belt **MUST** be properly stored in its storage location when:

Using the vehicle belts to install the car seat; **OR**

Using the **Booster Seat Mode**; **OR**

The car seat is not installed in a vehicle.

Secure the hooks to the attachments in the storage location as shown. Gently tighten the belt to remove slack.

WARNING

DO NOT use both the lower anchor belt and vehicle belt at the same time.

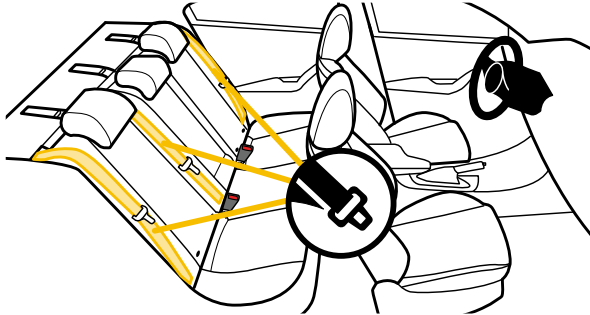

Your vehicle's features may be considerably different than those pictured here.

If LATCH: lower anchors are not an option or if your child weighs more than **50 lb** (22.7 kg), you must use the vehicle seat belt system to install the car seat.

Not all vehicle belts and seating positions will work with car seats. Please go through the following steps to understand how to lock a car seat in **Rear-Facing Mode or **Forward-Facing Mode** with a vehicle belt.**

1

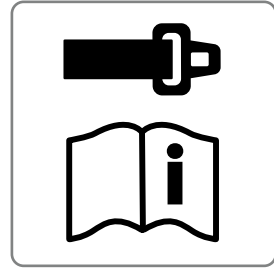

You MUST Review Your Vehicle Owner's Manual

Your vehicle owner's manual will let you know which vehicle belts and seating positions car seats can be installed in.

2



Check How This Car Seat Will Be Locked Into Place

The vehicle belt **MUST NOT** loosen after tightening.

- This requires locking it by using either.**
- The vehicle belt's retractor (see step 3); **OR**
 - The vehicle belt's latch plate (see step 4).

3

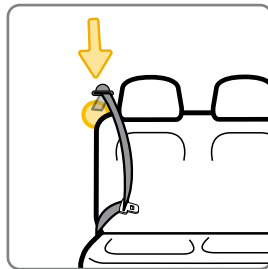

Check Retractor

Retractors pull vehicle belts into stored positions and lock the belt to hold passengers in place.

See the next page for some common types of vehicle belt retractors that will work with this car seat.

continued on next page

Types of Retractors



Switchable Retractor

(most vehicles have this type)

This retractor can be switched to a locking mode.

You **MUST have the retractor in the locking mode** to use the seat belt with this car seat.

Switching to locking mode: Slowly pull the shoulder belt all the way out, then let it go back in **1–2 in.** (2.5–5 cm).

As it goes back in, you will most likely hear a ratcheting sound.

Gently pull the belt to see if it has locked. You will not be able to pull any more belt out if the lock has engaged.

Automatic Locking Retractor

This retractor always locks.

It will automatically lock after slowly pulling the seat belt out at least halfway and letting the belt go back into the retractor **1–2 in.** (2.5–5 cm).

Emergency Locking Retractor

See Step 4

Check Latch Plates

If the retractor does not lock, it is most likely an Emergency Locking Retractor. These retractors only lock during a sudden stop or collision.

You will need to determine if your seat belt's latch plate can lock the belt. See step 4, Check Latch Plates.

4

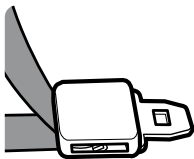

Locking
Latch Plate

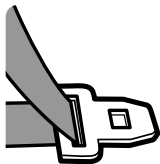

Sliding
Latch Plate

Check Latch Plates

Latch plates are the part of the vehicle belt that goes into the buckle.

To see if the latch plate locks:

1. Buckle vehicle belt.
2. Slowly pull up on the lap portion of the vehicle belt.

If the vehicle belt does not slide through the latch plate, it's locked.

If the vehicle belt slides through the latch plate, it is a **sliding latch plate**.

Sliding latch plates easily slip between the lap and shoulder portions of the belt.



If you have an Emergency Locking Retractor with a Sliding Latch Plate, you must use a locking clip.

Please contact us for one, see the back cover of the manual.

Never Use the Following With This Car Seat:

**Emergency Locking Retractor Lap Only Belt
Inflatable Seat Belts**

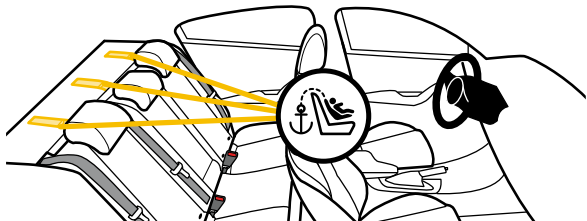

Your vehicle's features may be considerably different than those pictured here.

When anchors are available, you **must always attach, adjust, and secure the tether (top anchorage) strap** when installing the car seat in the **Forward-Facing Mode** with internal harness. Tethers improve the installation and stability of car seats and reduce the risk of injury. Attach the tether hook to the tether anchor designated by your vehicle manufacturer for that seating position. Check your vehicle owner's manual for more information. If the seating position does not have a tether anchor, use a different seating position or see your dealer or a qualified mechanic and have one installed.

WARNING

Using this child restraint without the tether strap anchored as required by the manufacturer would be a misuse of the child restraint and, in a sudden stop or crash, could result in serious injury or death. Serious injury can include paralysis and/or permanent brain injury.

DO NOT fasten multiple tether hooks on the same tether anchor in the vehicle.

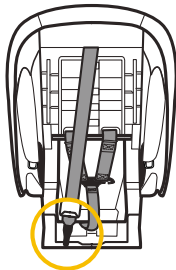

Storing Top Tether Strap

The tether strap **MUST** be properly stored in its storage location when:

- installing in **Rear-Facing Mode**; **OR**
- using the **Booster Seat Mode**; **OR**
- the car seat is not installed in a vehicle.

Attach the tether hook to its storage location as shown. Gently tighten to remove slack.

Child Restraint Use

WARNING

NEVER take your child out of the child restraint while the vehicle is moving.

NEVER leave your child unattended.

Placing your child in a hot child restraint may result in burns.

DO NOT use a child restraint with damaged or missing parts.

DO NOT use a child restraint with cut, frayed, or damaged harnesses.

DO NOT substitute parts or try to modify the child restraint in any way. **DO NOT** lubricate buckles and fasteners.

DO NOT use any child restraint accessory except those approved by Dorel Juvenile Group.

NEVER allow any child to play with this child restraint; it is not a toy.

DO NOT remove or cover up any of the warning labels or other labels on the child restraint.

This child restraint has been certified for use in passenger vehicles. **DO NOT** use in a boat, on a motorcycle, or in a cargo van or bus where there are no seat belts or tether anchors.

Read all instructions for additional warnings.

WARNING



NEVER place a child rear-facing in a seating position with an active frontal air bag.



Check the vehicle owner's manual for more information about air bag/child restraint use.



Use the child restraint only on vehicle seats that face forward.

DO NOT use on seats that face the sides or rear of the vehicle.

For vehicles without a back seat, refer to your vehicle owner's manual.



According to accident statistics, children are safer when properly restrained in the rear seating positions than in the front seating positions.

Rear seating positions are statistically safer, whether you have air bags, advanced air bags, or no air bags at all.

If you are not sure where to place the car seat in your vehicle:

- Consult your vehicle owner's manual; **OR**
- Contact Dorel Juvenile Group Consumer Care Department; **OR**
- Visit your local Child Passenger Inspection Station. Go to <https://www.nhtsa.gov/vehicle-safety/car-seats-and-booster-seats> to find your closest station.

Installation in Vehicle

To avoid your child being seriously burned, take the following precautions:

- Park in the shade or where the sun does not directly hit the car seat.
- Cover the car seat with a sheet or blanket when not in use.
- Check for hot seat and buckles before placing child in car seat.

To help protect your vehicle seat's upholstery from damage: you may use an accessory approved by Dorel Juvenile Group or a single layer towel underneath and behind car seat.

WARNING

Check the vehicle belt or lower anchor belt before each use. Use only if the belt can be tightened properly and locked securely in place.

Even when unoccupied, this child restraint **MUST** be firmly secured to the vehicle with the lower anchor belt or with the vehicle seat belt.

Even when unoccupied, this booster seat **MUST** be firmly secured to the vehicle with the vehicle seat belt.

In a crash or sudden stop, an unsecured child restraint or booster seat could injure occupants.

DO NOT risk your child's safety.

To keep your child as safe as possible, Dorel Juvenile Group strongly recommends replacing the car seat even after a minor crash; even if it was not occupied at the time.

Replacement After a Minor Crash

The National Highway Traffic Safety Administration states that for a crash to be considered minor **ALL of the following MUST be true:**

- Vehicle able to drive away from the crash site; **AND**
- Vehicle door nearest the car seat was not damaged; **AND**
- No passengers were injured; **AND**
- Airbags did not deploy; **AND**
- There is no visible damage to the car seat.

If the crash your car seat was involved in meets **ALL** the criteria, you may not need to replace the car seat.

If one or more of these criteria are not true or if you are uncertain of any of your answers, replace the car seat immediately.

Replacement After a Moderate to Severe Crash

You **MUST** replace this car seat if it has been in a moderate to severe car crash.

This car seat is intended to protect a child in a single crash. During a crash, the car seat and all of its parts absorb crash energy which can deform or weaken it. Damage is not always visible. A damaged car seat **MUST** be replaced immediately.

Expiration

On the side of the car seat there is a date of manufacture label as shown.

DO NOT use this car seat more than 10 years after the date of manufacture.

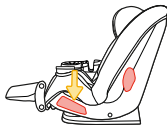

Registration and Safety Notices

Please complete the postage-paid registration card that came with your child restraint, and send it to us.

Child restraints could be recalled for safety reasons.

You must register this restraint to be reached in a recall.

Send your name, address, e-mail address if available and the restraint's model number and manufacturing date to:

Dorel Juvenile Group

P.O. Box 2609
Columbus, IN 47202

or call 1-800-544-1108 or register online at
www.djgusa.com/registration/carseat/us.

For recall information, call the U.S. Government's Vehicle Safety Hotline at 1-888-327-4236 (TTY: 1-800-424-9153), or go to www.NHTSA.gov.

0515079	Tear Off and Mail This Part or Register Online		4348-0081D
Consumer: Just fill in your name, address and email. Please print (use dark ink).			
Your Name			
Your Street Address			
City		State	Zip Code
Email Address (optional)			
Model Number	Model Name	Manufacture Date	
AB123CDE	Brand Car Seat	2024/05/01	
		L#11 B265035	

Example of model number, manufacture date, and line code.

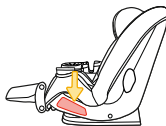

If you don't have the card or if your address changes, you will find the model number, manufacture date, and line code on the label located on the side of the car seat.

This restraint is certified for aircraft use when used with the internal harness.



Rear-Facing Aircraft Installation

Follow the vehicle belt install steps on 11–17.



Forward-Facing Aircraft Installation

Follow the vehicle belt install steps on pages 22–28, skipping the tether strap steps.



Booster Seat

This restraint is not certified for aircraft use, when used as a booster seat, because aircraft seats do not have shoulder belts.

Install the car seat in a window seat to avoid blocking the aisle. If the aircraft lap belt is too short, ask the flight attendant for a belt extender.

Use only on forward-facing aircraft seats. Contact the airline for their specific policies.

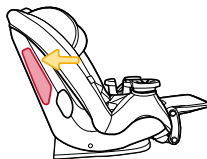

Some airlines may ask to see a label stating that this car seat is certified for aircraft use.

There is an airplane certification label located on the side of this car seat as shown.

WARNING

You **MUST** store the lower anchor belt and tether strap when installing with aircraft belts.

Warranty

Dorel Juvenile Group, Inc. (DJG) warrants this product to the original retail purchaser as follows: This product is warranted against defective materials or workmanship for one year from the date of original purchase.

An original receipt is required to validate your warranty.

DJG will, at its option, provide replacement parts or replace this product. DJG reserves the right to substitute if the part or model has been discontinued.

To make a claim under this warranty, please contact our Consumer Care Department by phone: 1-800-544-1108 or text: 1-812-652-2525. Our hours of operation are from 8:00 a.m. to 6:00 p.m. EST Monday through Thursday and from 8:00 a.m. to 4:30 p.m. on Friday.

Proof of purchase is required and shipping charges are the responsibility of the consumer.

Warranty Limitations: This warranty does not include damages which arise from misuse or abuse of this product.

Limitation of Damages: The warranty and remedies as set

forth are exclusive and in lieu of all others, oral or written, expressed or implied. In no event will DJG or the dealer selling this product be liable to you for any damages, including incidental or consequential damages, arising out of the use or inability to use this product.

Limitation of warranties and other warranty terms and state law rights: Any implied warranties, including implied warranties of the merchantability and fitness for a particular purpose, shall be limited to the duration and terms of the express written warranty.

Some states do not allow limitations as to how long an implied warranty lasts or the exclusion or limitation of incidental or consequential damages, so the above limitations may not apply to you.

This warranty gives you specific legal rights, and you may have other rights, which vary from state to state. Neither DJG nor the dealer selling this product authorized any person to create for it any other warranty, obligation, or liability in connection with this product.

You can also:



Send Us a Text: 1-812-652-2525
(US and Canada Only.
Carrier Fees May Apply)



Find Us Online: www.safety1st.com
Email Us: support@djgusa.com



Give Us a Call: 1-800-544-1108
(Toll Free, US and Canada Only)



safety 1st



**SCAN
HERE**
TO LEARN
MORE



Replacement Parts List

(on select models)

- Buckle Assembly
- Chest Clip
- Seat Pad Set
- Removable Cup Holder(s)
- Removable Snack Lid
- Removable Snack Tray
- Lower Anchor Belt
- Top Tether
- Locking Clip
- Instructions

**For parts availability and questions,
call, text, or chat.**

**If requested color is not available, similar
color will be substituted.**

**Applicable tax and shipping and handling will also
be added.**