

# ELURA

SOUND + PERFORMANCE

## OWNER'S MANUAL & INSTALLATION GUIDE

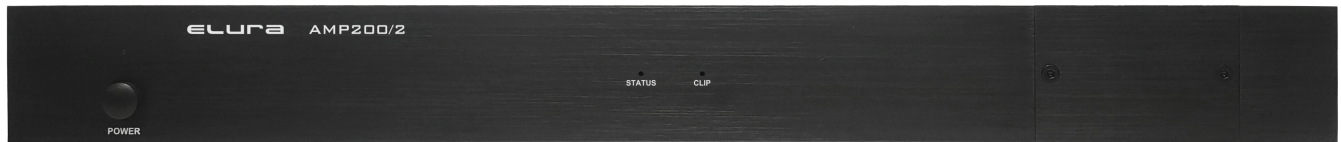

### AMP 200/2

HIGH PERFORMANCE AMPLIFIER



**CAUTION**  
RISK OF ELECTRIC SHOCK  
DO NOT OPEN

**ATTENTION**  
RISQUE D'ÉLECTROCUTION  
NE PAS OUVRIR



**WARNING:**

To reduce the risk of fire or electric shock, do not expose this apparatus to rain or moisture.

**AVIS:**

Pour réduire le risque d'incendie ou de choc électrique, ne pas exposer cet appareil sous la pluie et l'humidité.

The apparatus shall not be exposed to dripping or splashing and that no objects filled with liquids, such as vases, shall be placed on apparatus.

L'appareil ne doit pas être exposé aux écoulements ou aux éclaboussures et aucun objet ne contenant de liquide, tel qu'un vase, ne doit être placé sur l'objet.



The lightning flash with arrowhead symbol, within an equilateral triangle, is intended to alert the user to the presence of uninsulated "dangerous voltage" within the product's enclosure that may be of sufficient magnitude to constitute a risk of electric shock to persons.

Le symbole de l'éclair fléché dans un triangle équilatéral, est destiné à alerter l'utilisateur de la présence d'une "tension dangereuse" dans le boîtier du produit qui peuvent être des ampleur suffisante pour constituer un risque d'électrocution aux personnes.



This symbol is intended to alert the user to the presence of important operation and maintenance (servicing) instructions in the literature accompanying the appliance.

Ce symbole est destiné à alerter l'utilisateur de la présence d'opération et de maintenance (entretien) dans la documentation accompagnant l'appareil.

## Important Safety Instructions

1. Read these Instructions.  
*Lisez ces instructions.*
2. Keep these Instructions.  
*Conservez ces instructions.*
3. Heed all Warnings.  
*Respectez tous les avertissements.*
4. Follow all instructions.  
*Suivez toutes les instructions.*
5. Do not use this apparatus near water.  
*Ne pas utiliser cet appareil près de l'eau.*
6. Clean only with a dry cloth.  
*Nettoyer uniquement avec un chiffon sec.*
7. Do not block any ventilation openings. Install in accordance with the manufacturer's instructions.  
*Ne pas bloquer les ouvertures de ventilation. Installer conformément aux instructions du fabricant.*
8. Do not install near any heat sources such as radiators, heat registers, stoves, or other apparatus (including amplifiers) that produce heat.  
*Ne pas installer près de sources de chaleur telles que radiateurs, registres de chaleur, poêles ou autres appareils (y compris les amplificateurs) produisant de la chaleur.*
9. Do not defeat the safety purpose of the polarized or grounding - type plug. polarized plug has two blades with one

wider than the other. When the provided plug does not fit into your outlet, consult an electrician for replacement of the obsolete outlet.

*Ne détruisez pas la sécurité de la terre ou polarisées - fiche. Une fiche polarisée possède deux lames dont une est plus large que l'autre. Si la fiche fournie ne rentre pas dans votre prise, consultez un électricien pour remplacer la prise obsolète.*

10. Protect the power cord from being walked on or pinched particularly at plugs, convenience receptacles, and the point where they exit from the apparatus.

*Protégez le cordon d'alimentation d'être piétiné ou pincé, particulièrement au niveau des fiches, des prises, et le point où ils sortent de l'appareil.*

11. Only use attachments/accessories specified by the manufacturer.  
*N'utilisez que des accessoires spécifiés par le fabricant.*

12. Use only with a cart, stand, tripod, bracket, or table specified by the manufacturer, or sold with the apparatus. When a cart or rack is used, use caution when moving the cart/apparatus, combination to avoid injury from tip-over.



Utilisez uniquement un chariot, stand, trépied, support ou table spécifiés par le fabricant ou vendu avec l'appareil. Quand un panier ou rack est utilisé, faites attention lorsque vous déplacez l'ensemble chariot / appareil, pour éviter d'éventuelles blessures en cas de chute.

13. Unplug this apparatus during lightning storms or when unused for long periods of time.

*Débranchez cet appareil pendant les orages ou lorsqu'il n'est pas utilisé pendant de longues périodes de temps.*

14. Refer all servicing to qualified service personnel. Servicing is required when the apparatus has been damaged in any way, such as power-supply cord or plug is damaged, liquid has been spilled or objects have fallen into the apparatus, the apparatus has been exposed to rain or moisture, does not operate normally, or has been dropped.

*Confiez toute réparation à un personnel qualifié. Une réparation est nécessaire lorsque l'appareil a été endommagé de quelque façon que ce cordon d'alimentation ou la fiche est endommagé, liquide a été renversé ou des objets sont tombés dans l'appareil, l'appareil a été exposé à la pluie ou à l'humidité, ne fonctionne pas normalement, ou s'il est tombé.*

15. **WARNING:** The appliance coupler is used as disconnect device, the disconnect device shall remain readily operable.

*AVERTISSEMENT: La fiche d'alimentation (appareil coupleur) est utilisé comme dispositif de déconnexion, le dispositif de déconnexion doit rester facilement accessible.*

16. No naked flame sources, such as lighted candles, should be placed on the apparatus.

*Aucune source de flamme nue, telle que des bougies allumées, ne doit être placé sur l'appareil*

17. Protective earthing terminal. The apparatus should be connected to a mains socket outlet with a protective earthing connection.



*Borne de terre de protection. L'appareil doit être connecté à une prise secteur avec une prise de terre.*

## FCC Statement

This device complies with part 15 of the FCC Rules. Operation is subject to the following two conditions: (1) This device may not cause harmful interference, and (2) this device must accept any interference received, including interference that may cause undesired operation.

## Overview.

Thank you for purchasing Elura Amplifier products. Elura is a high performance custom installed product engineered for movie and music enthusiasts. Each Elura product is manufactured to the highest quality standard using state of the art components and built for years of enjoyment.

## Features.

- Digital high power amplification
- Low impedance
- Bridgeable
- Low Noise
- Small chassis
- Less Heat
- Efficient design
- Rack mountable
- Automation circuit

## Contents.

- Amplifier
- Rack Mounting Hardware
- Power cord
- Manual

## Front Panel LEDs.

The Elura AMP200/2 has LEDs on the front panel to indicate the amplifier's power state. The Power LED indicates the amplifier is ON.

There is two LED indicating the working status of the amplifier.

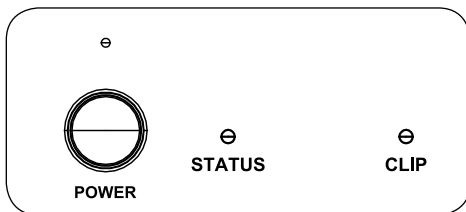

Power ON = Blue  
Power OFF = Red

### Status LED

Amplifier has a input signal = Blue  
Amplifier protection = Red  
Amplifier has no input signal = The LED goes out.

### Clipping indicator

When the clipping indicator light is red, it means that the input signal is exceeding the working range of the amplifier and affecting the output sound quality. Once the input level is reduced, the clipping LED will not flash or stay on.

## Amp Volume Settings.

The volume for the amplifier is on the front panel. It offers integrated control of the speaker output for Left / Right.

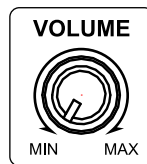

## 12V Trigger in/Out

For triggering the power on/off from other devices such as processors or receivers that have a 12V trigger output.

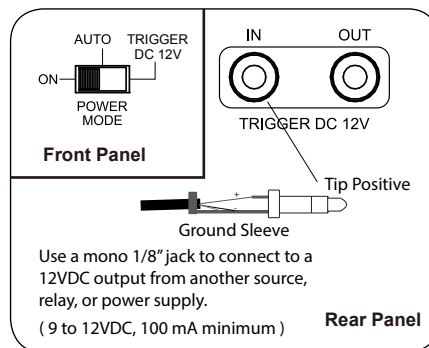

Note: that this function should be

used in conjunction with the ON/AUTO/TRIGGERED switch on the front panel

## Auto Power Modes.

The AMP 200/2 has three power modes, ON / AUTO / TRIGGERED.

ON = Always ON

AUTO = Signal sensing via audio  
TRIGGERED = 12VDC tip positive

Amplifiers produce light noise when left on. The noise is a light hiss and is heard when music isn't playing in a very quiet room. If you are using a master switch to turn off power to your audio equipment, always on is acceptable. In a louder or light commercial environment, always ON may be acceptable. In quiet rooms, it is suggested to use AUTO or TRIGGERED options.

## Preamp Connections.

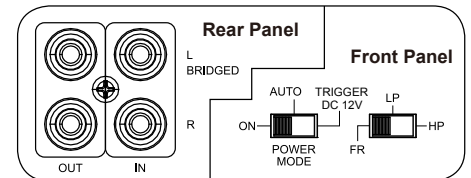

Preamplified connections are made using Stereo RCA patch cables. The AMP200/2 provides a convenient IN and OUT loop. Use the output to connect to another amp or other device sharing the pre-amp source signal. Other high-end options include using the amplifier's built in EQ filters to amplify just the low frequencies or the high frequencies using the FR/HP/LP switch.

FR= Full Range  
HP= High Pass  
LP= Low Pass

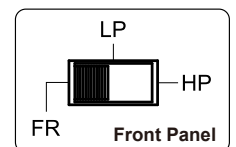

### Front Panel

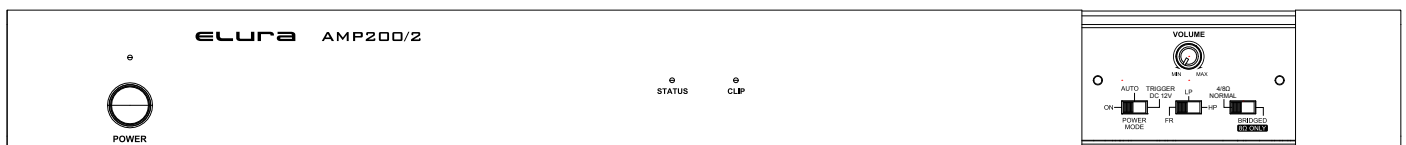

### Rear Panel

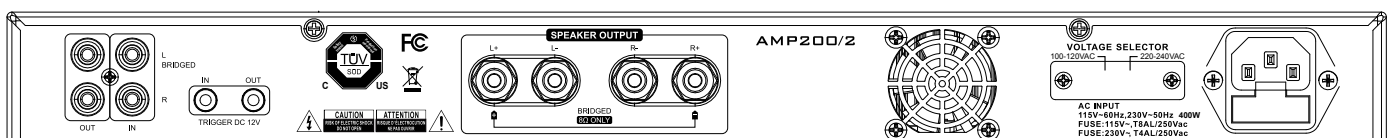

# Bridging.

Bridging offers the user more power to the speaker. The compromise is that you lose a channel of the amplifier and the lowest impedance in bridge mode is 8 Ω. Bridging is an excellent way to increase the power to a pair of larger speaker. The diagram below shows an amplifier connected to a single speaker. For a pair, you would need two amplifiers and repeat the connections for left and right source outputs and

speaker connections. See the image to the left for more details.

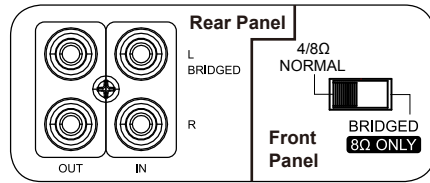

## Speaker Connections.

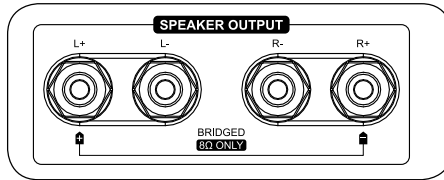

The AMP 200/2 has 5-way binding posts to make connecting your speaker wire easy and secure. The connector can be used to screw down onto bare wire, or banana jacks, spade connectors or pins. Position and polarity are color coded and marked to avoid phase issues. Be sure to follow and maintain proper polarity and position.

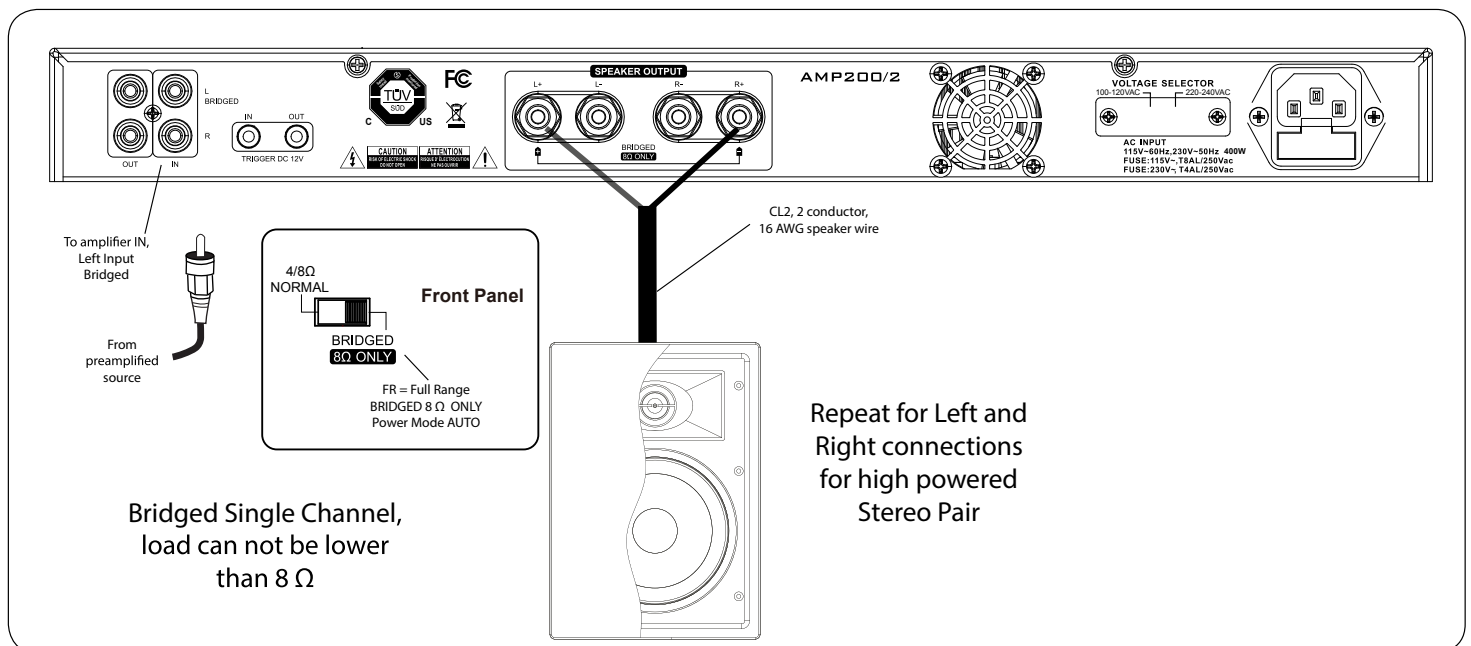
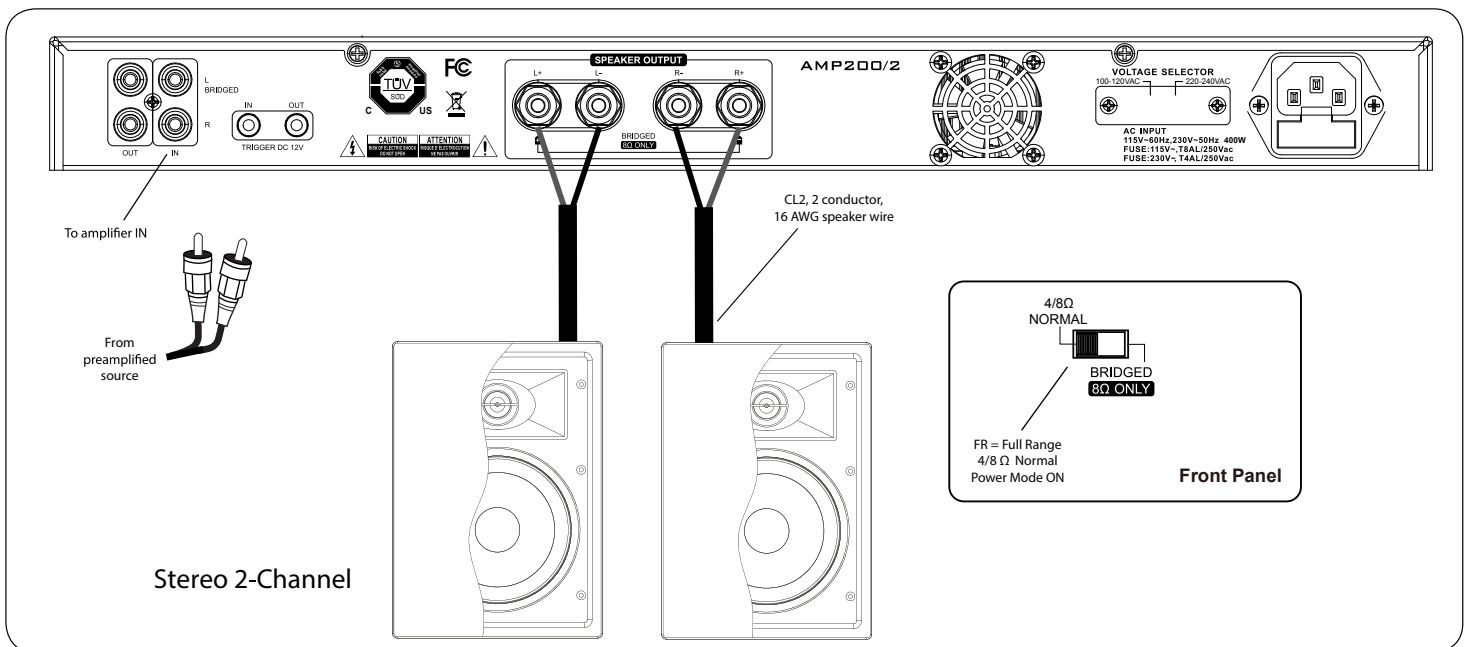

# Bi-amping.

Bi-amping your speakers using two AMP200/2 amplifiers is an excellent and efficient way to get the most out of your speakers. In this case, the frequencies are crossed over in the amplifier and the speakers drivers are fed the most power possible directly to the tweeters and the drivers. Each speaker is driven by an amplifier channel bypassing the crossover components. While this setup can be a little more complicated, the performance is top notch!

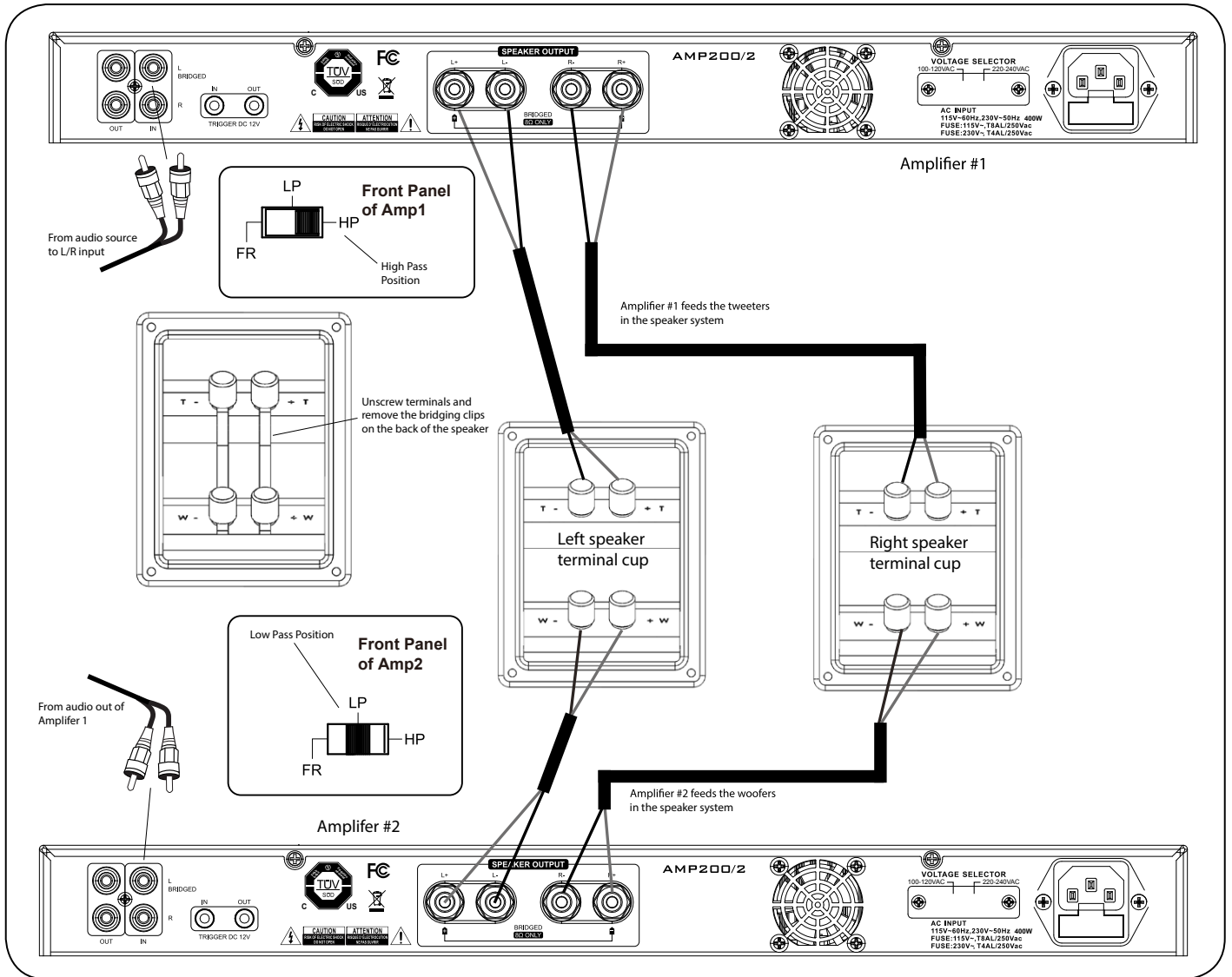

## Input AC & Power Cord

The AMP200/2 can operate in 110V and 220V environments. Before powering the amplifier on, make sure that the input AC Selector is in the correct position and that the correct fuse installed. Plug the AC power cord into the amplifier first and then into the wall outlet.

Make sure it is firmly connected.

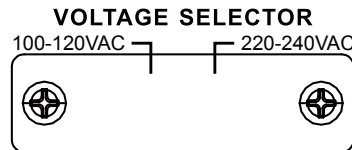

## Caution

The fuse holder is located directly under the power socket. It contains one extra 8 ampere, 250V fuse.

When accessing the fuse holder, first make sure the AMP200/2, is turned off and unplugged from both the wall outlet and the amplifier's power socket. Place a flat head screwdriver just above the groove on the top of the fuse holder to pry it off.

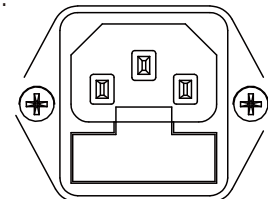

# Specifications

**Model:** AMP200/2

**Description:** High performance Amplifier

**Output Power:** 200W x 2 @ 4Ω 1kHz

**THD+N:** @4Ω=0.9% / @8Ω=1.0%

**Input Sensitivity:** 600mV

**Frequency Response:** 10Hz - 20kHz

**High Pass Filter:** 150Hz - 20kHz /-3dB

**Low Pass Filter:** 10Hz - 150Hz / -3dB

**Signal to Noise Ratio:** -75dB

**Auto Turn ON:** 5mV

**Turn OFF Delay:** 8min

**Supply Voltage:** AC230V / 50Hz

AC110V / 60Hz

**Dimension (H x W x D):**

44mm x 437mm x 263mm (1.73"X17.2"X10.35")

**Weight:** 3.7kg (8.1lb)

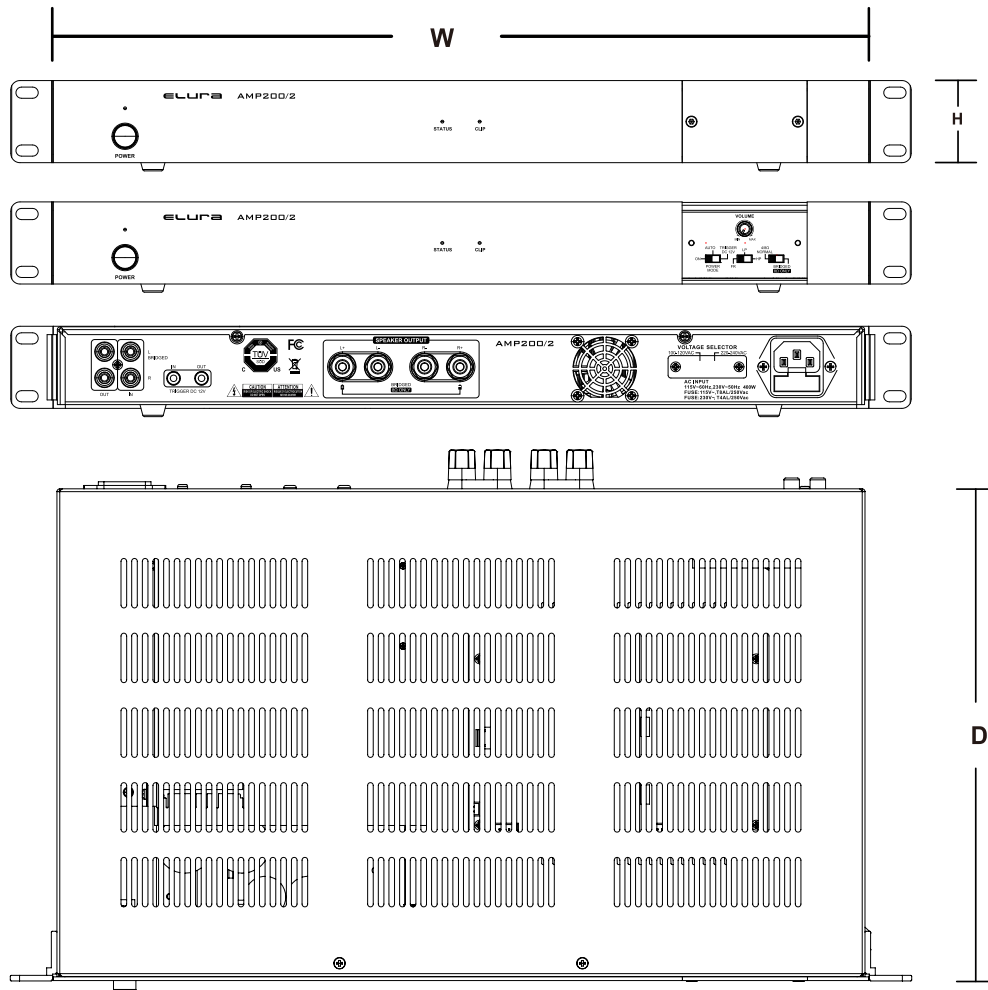

## Troubleshooting

### **NO audio**

- Power cable to the amplifier is not fully or incorrectly connected or plugged into an outlet that does not have power. Check connections and verify power is on at the outlet. Verify the power button on the front panel is "BLUE".
- Audio cable to the source component is not connected properly, or the cable is defective.
- Check the audio source for output, try it with another amplifier.
- Check the LED'S on the front panel. for Blue on Red (fault).
- Make certain the volume control on the front panel is turned up.
- Check the speaker output connections for proper polarity wiring and that no wires are shorted.

### **Hum or buzzing sound is heard**

- Check input cables by removing them one at time (powering down the amplifier before disconnecting) and checking to see if a connection or cable is the problem.

### **Amplifier will not turn on**

- The amplifier must be plugged into a live outlet.
- Check the On, Auto, TRIGGER switch position for Normal or Auto-On. if you are using Auto-On, an audio signal must be applied for the amp to turn on.

### **Audio is lacking low frequency or high frequency output**

- Check the High-Pass and Low-Pass switch setting on the front panel.

## Product Warranty

The seller warrants the AMP200/2 free from defects in the material and workmanship for 2 years from the date of purchase from the seller or authorized dealer. Should this product fail to be in good working order within the warranty period, the product will be repaired or replaced provided that the unit has not been subjected to accident, disaster, abuse, or any unauthorized modification. This warranty is offered by the seller for its buyer with direct transaction only. This warranty does not apply to products that have been abused, incorrectly installed, modified, disassembled and/or repaired by anyone other than Elura or our appointed repair facility.

A unit that fails under conditions other than those covered will be repaired at the current price of parts and labor in effect at the time of repair. Such repairs are warranted for 90 days from the day of reshipment to the buyer. If the unit is delivered by mail, customers agree to insure the unit or assume the risk of loss or damage in transit. Under no circumstances will a unit be accepted without a return authorization number.

The warranty is in lieu of all other warranties expressed or implied, including without limitations, any other implied warranty, all of which are expressly disclaimed. Proof of sale may be required in order to claim warranty.

The content of this manual has been carefully checked and is believed to be accurate. However, the seller assumes no responsibility for any inaccuracies that may be contained in this manual. Also, the technical information contained herein regarding the features and specifications are subject to change without further notice.