

**⚠ WARNING**

**This gas control assembly contains a Propane (LP) orifice. If installing the gas control assembly in a Natural Gas (NG) application, you must remove the LP orifice and replace with the NG orifice (supplied in box).**

**Orifice Replacement — (Propane to Natural Gas)**

1. Locate orifice cover plate on top portion of gas valve.
2. Remove 3 screws securing orifice cover plate.
3. Remove Propane (LP) orifice from the housing.
4. Install Natural Gas (NG) orifice into housing.
5. Confirm gasket is correctly in place - Groove side of gasket must be facing outwards. Reinstall orifice cover plate using 3 screws to secure it to the gas valve.

Applicable Rinnai Product	Series Name	Gas Valve Assembly Part Number	Orifice Color	
			Natural Gas (NG)	Propane Gas (LP)
Tankless Water Heater	RU and CU Series	106000117	Blue	Red
Boiler	I-Series			
Boiler	I-Series Plus (175K BTU and Larger)	806000089	Black	Gray

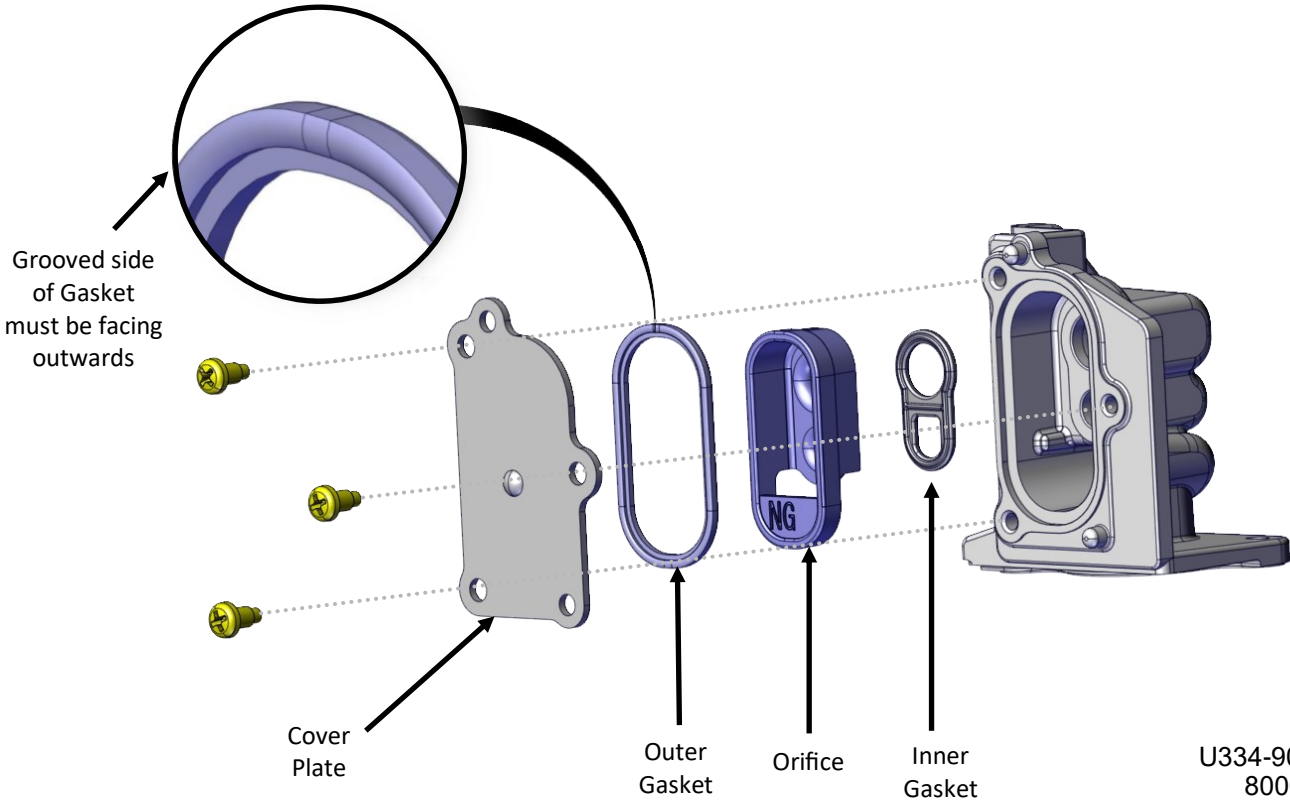

U334-9053(01)  
800000266