

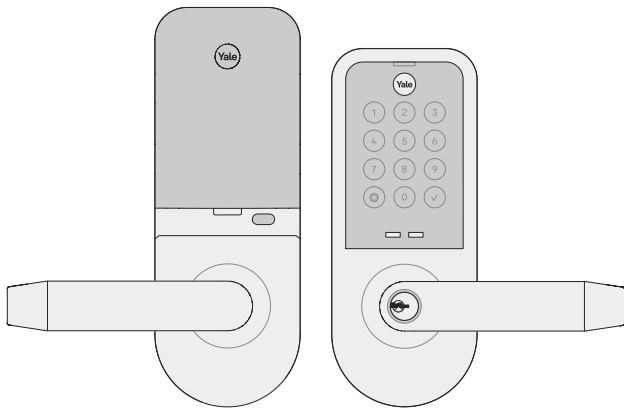

Yale Pro[®] 2 Cylindrical Lock

YMB614/YMB624/YMB634/YMB644



Install Your Lock

Follow the step-by-step Installation Guide in this manual (page 5-24).

Set Up, Program, and Use Your Lock

Follow the instructions in this manual (page 26-28), the Quick Start Guide, or the partner app to set up and program your lock. Create permanent entry codes, issue entry codes for guests, and more (page 25-38).



This page was left intentionally blank.

Contents

In the Box	4		
Installation and Setup Guide	5		
Determine Door Hand	6		
Check Door Measurements	7		
Make or Adjust Holes	8		
Install Latch Bolt and Strike Plate	9		
Disassemble Handle Assembly	10		
Adjust Door Thickness	11		
Assemble Exterior Assembly	12		
Install Exterior Assembly	13		
Install Bracket and Gasket	14		
Change Handling for Interior Lock	15		
Install Interior Mounting Hardware	16		
Attach Wire Cable to Interior Lock	17		
Install Interior Lock	18		
Test Levers and Key	19		
		Install DoorSense (Optional)	20
		Install Yale Smart Module (Optional)	23
		Install Batteries and Initial Setup	24
		Using Your Lock	25
		Create Programming Code	26
		Configuring Your Lock	27
		LED Alerts	29
		Resetting Your Lock to Factory Defaults	30
		Features	31
		Lock Operations Troubleshooting	35
		Hardware Troubleshooting	37

In the Box

Lock

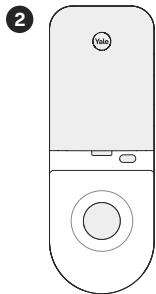
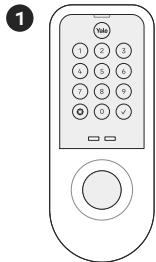

Hardware

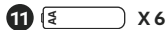
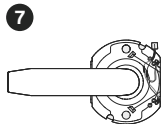
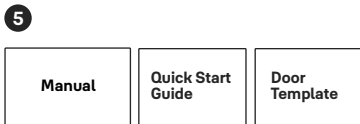
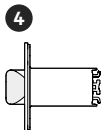
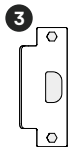

Add-Ons

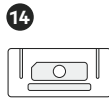
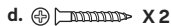

1. Exterior Keypad
2. Interior Lock
3. Strike Plate
4. Latch Bolt
5. Manual, Quick Start Guide, and Door Template
6. Exterior Handle Assembly
7. Interior Handle Assembly
8. Keys
9. Cap
10. Reset Pin
11. AA Batteries
12. Screws
 - a. Latch Bolt Screws
 - b. Strike Plate Screws
 - c. Mounting Screws
13. DoorSense
 - a. Housing
 - b. Cover
 - c. Mounting Tape
 - d. Screws
 - e. Flush Mount Cap
14. Smart Module (Included for Wi-Fi, Z-Wave, and Zigbee models)

Installation and Setup Guide

Required Tools

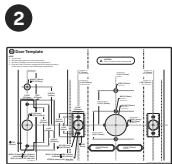
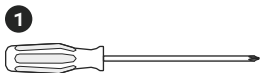

You Might Also Need

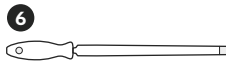
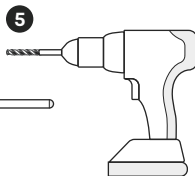
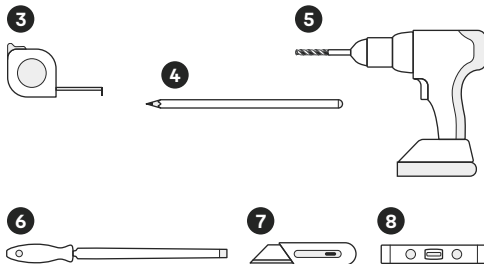

1. **Phillips Head Screwdriver**
2. **Door Template**
(a separated page)
3. **Tape Measure**
4. **Pencil**
5. **Drill**
6. **Wood Mortise Chisel**
7. **Utility Knife**
8. **Level**



Failure to follow the Installation Guide precisely could result in damage to the product, voiding the factory warranty, and could lead to failure of the product to provide access.

1 Determine Door Hand

The hand of a door is determined from the secure side of the door. The "secure side" refers to the side from which you initially unlock and enter.

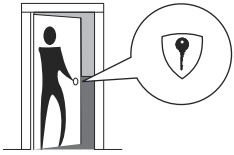

Left Hand "**LH**", Hinges Left.
Open Inward.



Left Hand Reverse "**LHR**",
Hinges Left. Open Outward.



Right Hand "**RH**", Hinges Right.
Open Inward.



Right Hand Reverse "**RHR**",
Hinges Right. Open Outward.

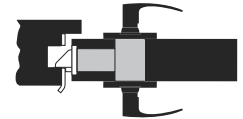
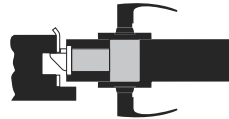
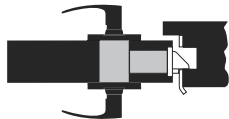
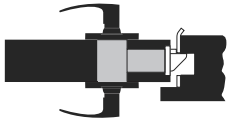
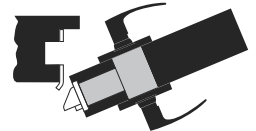
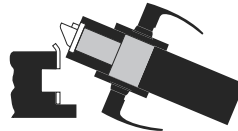
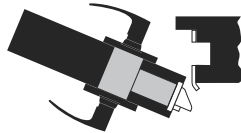
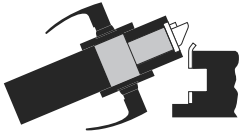

2a Check Door Measurements

If your door doesn't have holes, please proceed to step 2b. →

Use the **Door Template** and follow the guidelines to measure each aspect of your door and frame.

✏ If you need to make adjustments, find the closest match to each aspect of your door on the **Door Template** and follow **step 2b**. Please note that there are some cases when existing holes cannot be adjusted to be compatible.

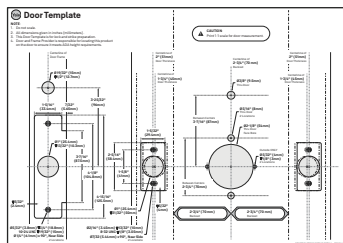

⚠ Please do not drill any holes until you confirm that your door is compatible.

If you have confirmed that the existing holes are compatible with your new lock, please proceed to step 3 (skip step 2b).

2b Make or Adjust Holes

If you have confirmed that the existing holes are compatible, proceed to step 3. →

1. Prepare your door:

1a. Tape the Door Template onto the door as shown.

1b. Check the door thickness. Follow the template to mark and drill the required holes.

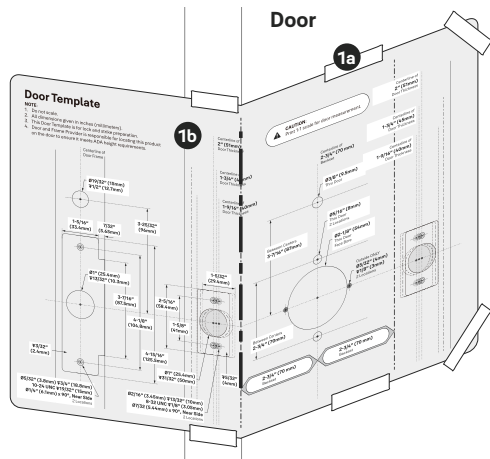

2. Prepare your door frame:

2a. Close the door from the inside. Insert a pencil through the edge bore to mark the center of the strike pocket on the door frame.

2b. On the door frame, center the strike plate hole on the pencil mark. Trace the outline of the strike plate with pencil.

2c. Chisel out the outlined area to the depth of the strike plate so it sits flush with your door frame. Follow the template to mark and drill the required holes.

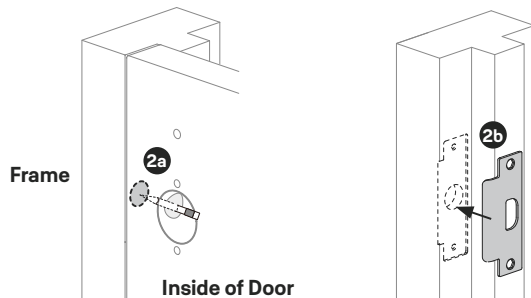

3 Install Latch Bolt and Strike Plate

1. Align the strike plate with the latch bolt.

Note: Curved edge of latch bolt faces direction door closes.

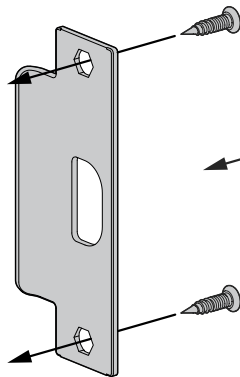
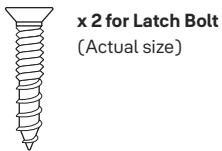
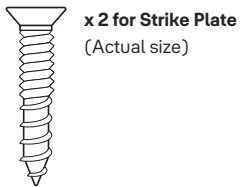

1

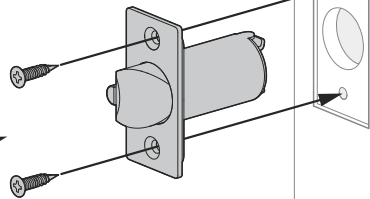

! Curved edge of latch bolt faces direction door closes.

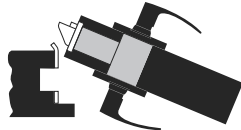

! **Install your lock with the door open.**
Do not close your door until all the steps are completed.

4 Disassemble Handle Assembly

1. Insert the reset pin into the holes on the handles.
2. Pull the lever off the assembly.
3. Pull the lock body off the interior mounting hardware.

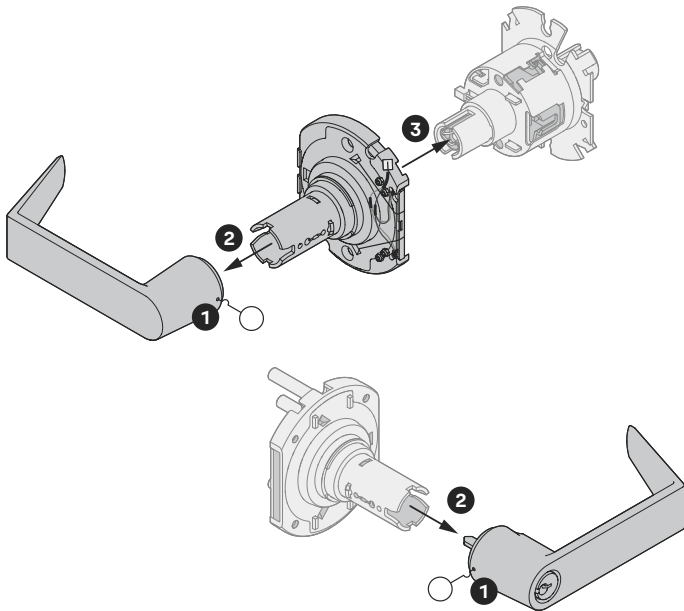

5 Adjust Door Thickness

1. Insert the reset pin into the designated hole of the rotating plate on the lock body.
2. Adjust the rotating plate on the lock body to the appropriate position based on your dock thickness.

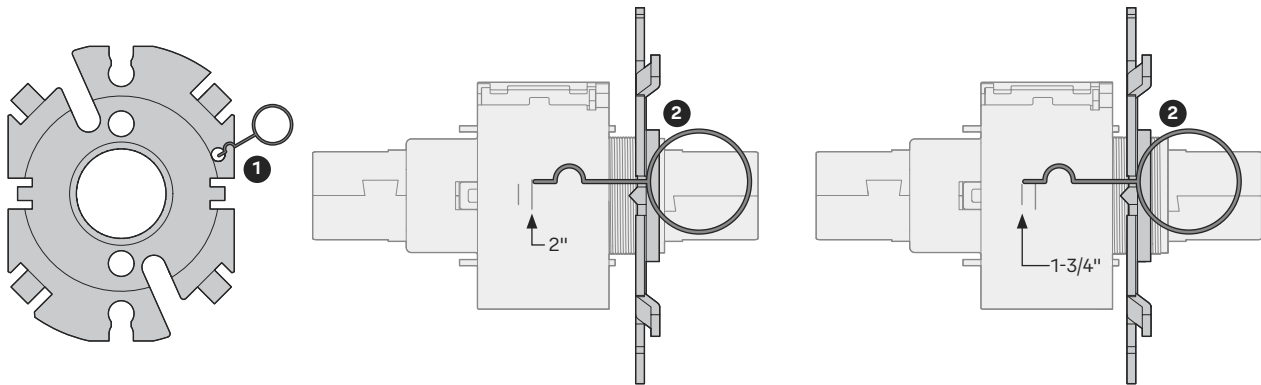

6a Assemble Exterior Assembly

1. Position exterior mounting hardware based on your door hand:
 - a. **Right-Hand Door:** Ensure "RH" is pointed towards the "RH/LH" marking on the back of the keypad;
 - b. **Left-Hand Door:** Ensure "LH" is pointed towards the "RH/LH" marking on the back of the keypad.
2. Assemble exterior lever, keypad and exterior mounting hardware together as shown.
3. Tighten the two screws to secure exterior mounting hardware to the keypad.

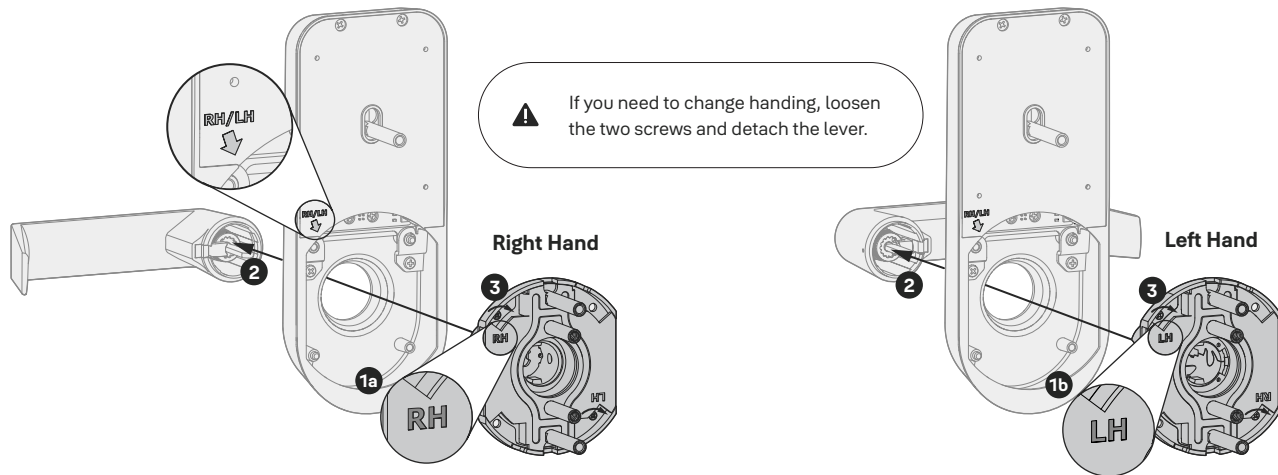

6b Install Exterior Assembly

1. Insert the cap into the lock body.
2. Position and orient the lock body so that its pocket faces the latch bolt.
3. Guide the screw posts of exterior assembly into the holes on the lock body.

Note: Make sure the tailpiece slot in the lock body is in horizontal position.

4. Route the front wire through the channel in the lock body, then guide it through the face bore along with the motor wire on the lock body.
5. Insert the screw posts of the assembly into corresponding holes on your door.

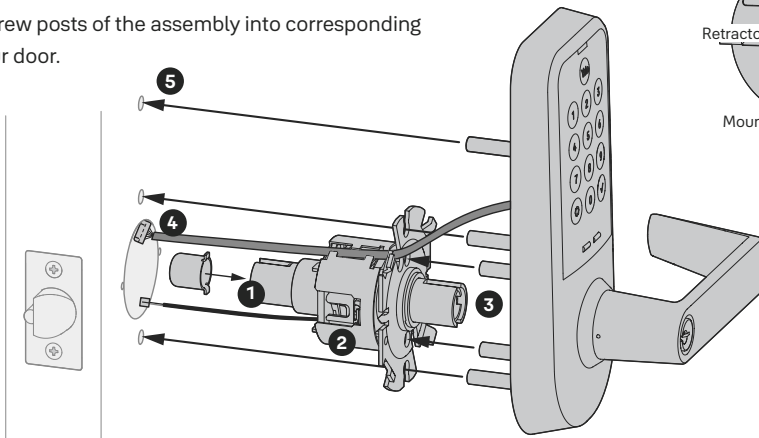

The two moving "T" tabs must be fully captured in Retractor Pocket, and the Mounting Flanges must be in Mounting Flange Pockets.

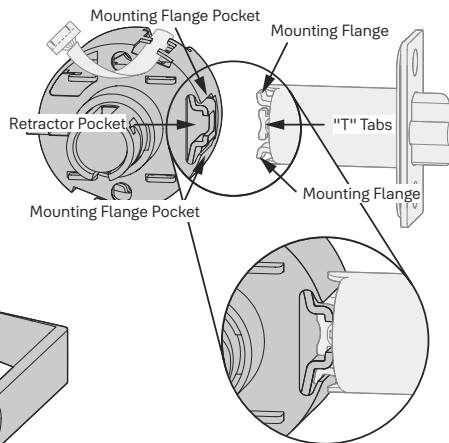

7 Install Bracket and Gasket

1. Insert the reset pin into the hole above the interior lock.
2. Remove the battery cover.
3. Loosen the screws to remove the bracket and the gasket from the back of the interior lock.
4. Guide the front wire and the motor wire through the designated hole on the bracket and the gasket.
5. Tighten the screws to secure the bracket and the gasket.

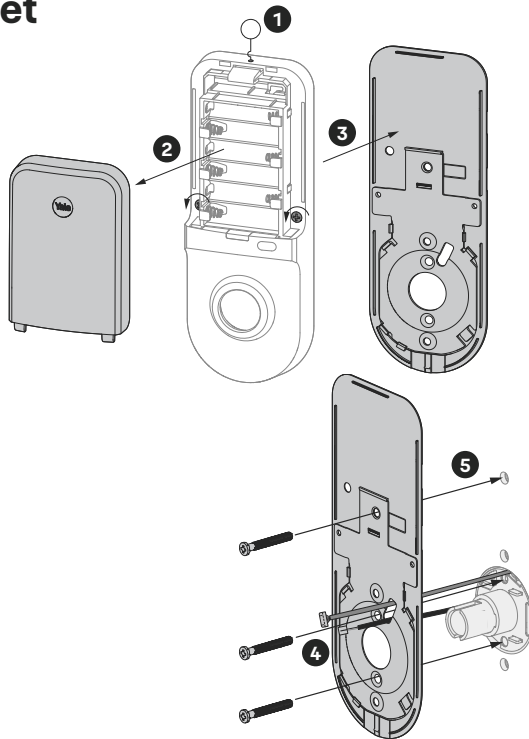

Ensure that the wire cables are not pinched to prevent it from reducing your lock's battery life.

8a Change Handing for Interior Lock (Optional)

If you do not wish to change from Right Hand to Left Hand, please proceed to step 8b. →

1. The default setting is for right-hand door, with the rex switch wire under the upper wire clip on the right.
2. To change handing for left-hand door:
 - a. Detach the rex switch wire from the upper wire clip on the interior mounting hardware;
 - b. Replace the rex switch wire under the lower wire clip;
 - c. Position the interior mounting hardware so that the wire clips face the left side.

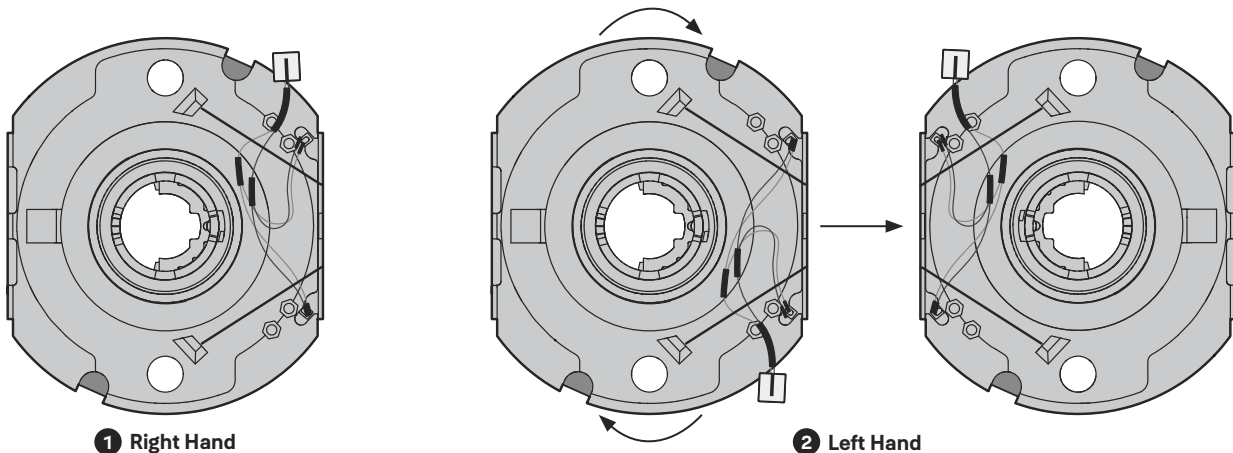

8b Install Interior Mounting Hardware

1. Guide the front wire and the motor wire through the gaps on the interior mounting hardware.
2. Install the interior mounting hardware onto the lock body.
3. Tighten the screws to secure the interior mounting hardware.

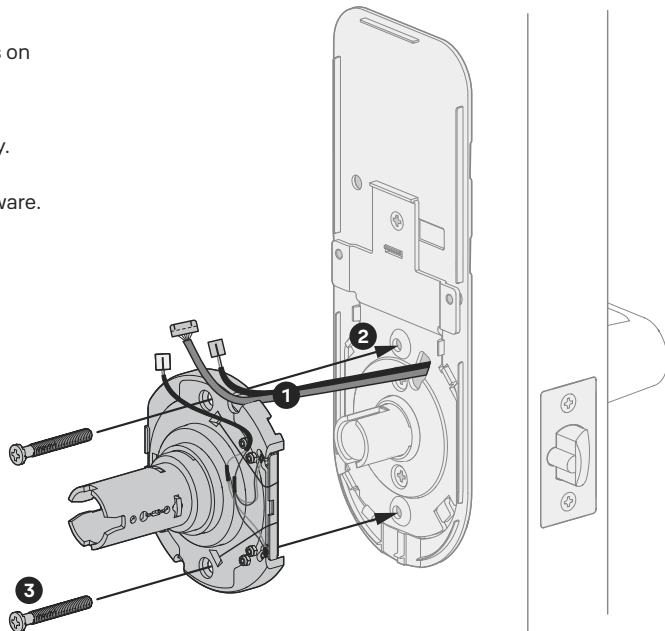

9 Attach Wire Cables to Interior Lock

1. Make sure the side of the cable end with the ridges and the marked line faces outward.
2. Push the front wire into the designated slot until it clicks into place.
3. Push the motor wire into the "**MOTOR**" slot until it clicks into place.
4. Push the rex switch wire into the "**REX**" slot until it clicks into place.
5. If an external power supply is required, push the power wire into the "**PWR**" slot until it clicks into place.

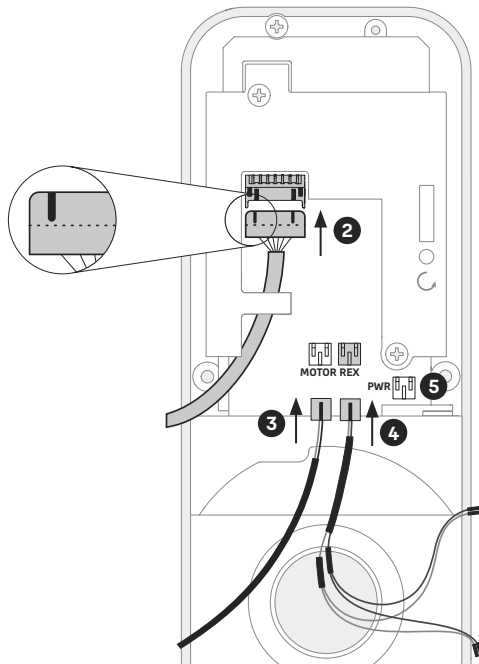

10 Install Interior Lock

1. Install the interior lock onto the mounting hardware, and tighten the screws.
2. Install the interior lever, and then pull the lever to ensure it is secured.

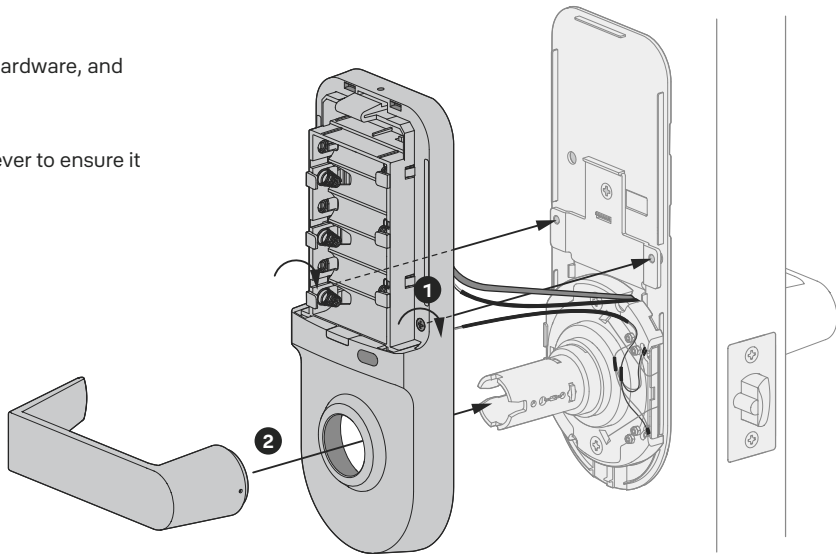

⚠ When fully tightened, lock should be flush to door.

11 Test Levers and Key

If latch bolt does not lock or unlock with the **key** (from the outside) or the **handles** (from the outside & the inside):

- Ensure that the latch bolt is centered in the face bore hole;
- Ensure that the tailpiece is positioned horizontally and inserted through the cylinder slot (**step 6b, point 3**).

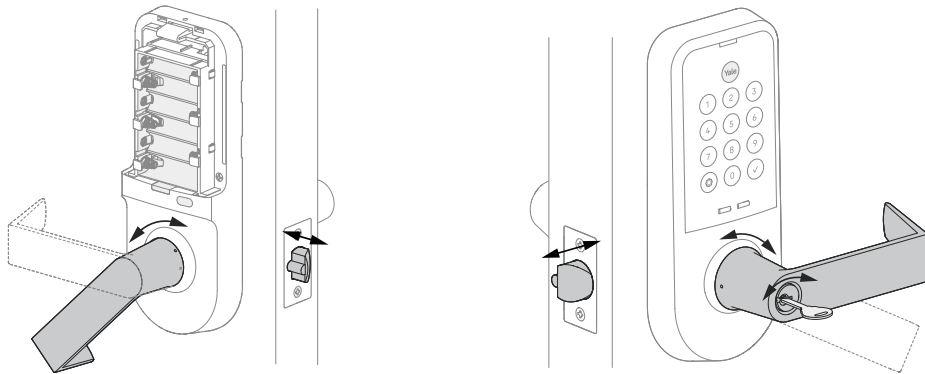

⚠ Smooth deadbolt latch operation will enhance your battery life.

12a Install DoorSense (Optional)

If you do not wish to install DoorSense, please proceed to step 13. →

⚠ Before installing DoorSense, confirm it is supported by the app the lock will be setup in.

DoorSense is a magnetic sensor installed on your door frame that can keep track of when the door is opened and closed.

For **surface mount** instructions, please proceed to **step 12b.** →

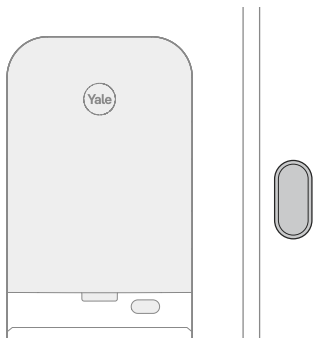

Surface mount is a quick and easy option to secure DoorSense on the inside of your door frame.

For **flush mount** instructions, please proceed to **step 12c.** →

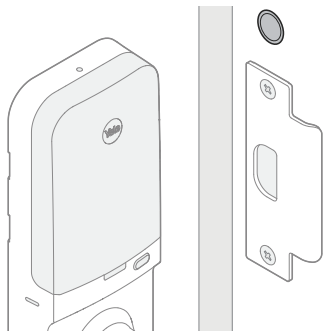

Flush mount is installing DoorSense into the edge of the door frame. It provides a cleaner look with more robust performance but requires drilling.

12b DoorSense Surface Mount

1. Remove one side of the backing from the adhesive.
2. Attach tape to the back of the DoorSense, ensuring it is aligned with the edges of the device and the screw holes.
3. Remove the remaining backing from the adhesive.
4. Determine mounting location. For optimal performance, DoorSense should be mounted within 1-1/2" from the edge of your door frame.

Note: DoorSense will still work if placed on curved or angled trim moulding around the door frame as long as it is within 1-1/2" from the edge.

5. Ensure the center of DoorSense is in the proper position by aligning it 3-25/32" above the face bore center, and adhere it to the door frame.
6. Tighten pre-installed screws and attach cover.

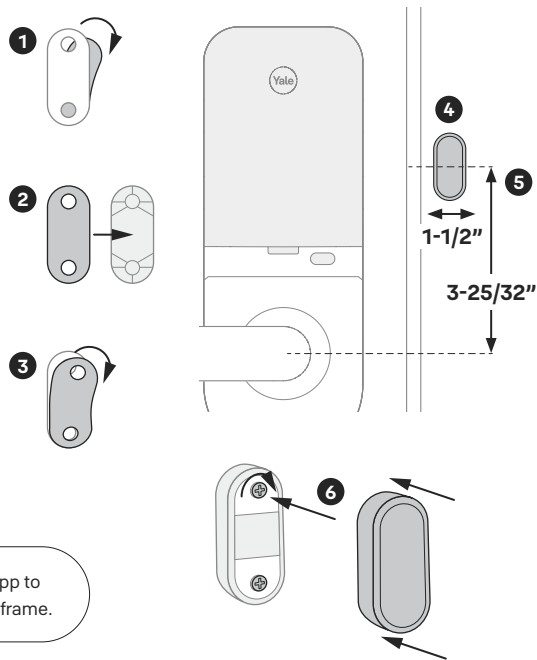

It is recommended to complete the last step after your lock is calibrated with the app to ensure you are able to retrieve accurate door state readings before modifying your frame.

12c DoorSense Flush Mount

1. Take off DoorSense cover.
2. Push the magnet out of the housing.
3. Expose the adhesive on the magnet cap by removing the blue backing.
4. Press the magnet onto the cap so that the notches interlock.
5. Determine mounting location on the door frame. The distance from the center of the strike plate to the center of the DoorSense should be $3\text{-}25/32''$, making the DoorSense in line with the logo on the battery cover of the lock.
6. Mark a hole that's horizontally centered on the door frame and is $19/32''$ in diameter.
7. Drill a $1/2''$ deep hole where marked.
8. Insert DoorSense into the hole.

Note: If it is too snug to push in by hand, protect the frame with a piece of scrap wood and use light blows with a hammer or mallet. If it is too loose, try wrapping tape around it so that it fits snugly.

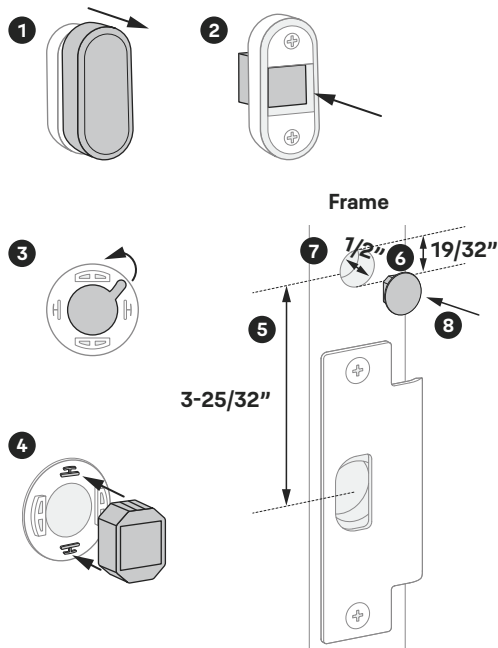

13 Install Yale Smart Module (Optional)

If your lock model does not include a Smart Module, please proceed to step 14. →

1. Insert Yale Smart Module into the designated slot at the top of the body of the lock.



Batteries must not be installed when inserting or removing Yale Smart Module.

Note: If you purchased your module separately, check the compatibility with your Yale Pro 2. See the table below for the list of compatible modules.

AYR-MOD-ZW4-USA	Z-Wave 800 Series Module
AYR-MOD-ZB3-USA	Zigbee 3.0 Module
AYR-MOD-WF1-USA	Wi-Fi Module
AYR202-AUG-CON	Yale Connect Bridge*

*Plugs into the wall, not the interior of the lock.

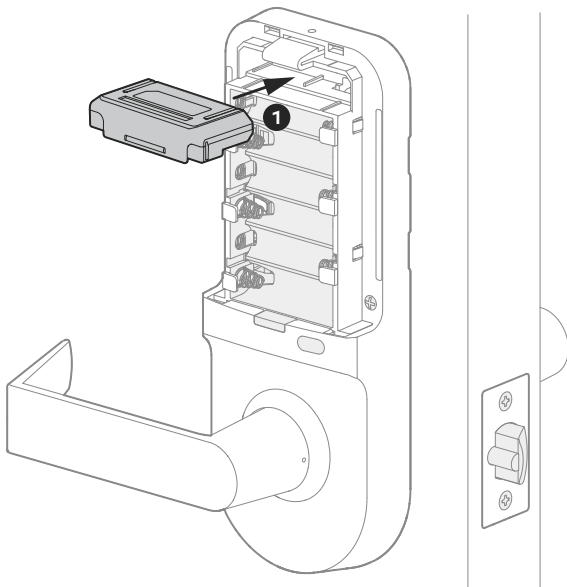

14 Install Batteries and Initial Setup



Make sure you have downloaded the partner app.

Once batteries are inserted, lock is ready to be set up with the app.

1. Install 6 batteries.
2. Complete initial setup according to your connectivity option:

Connectivity Option	Initial Setup Instructions
Bluetooth (Built-in) /Wi-Fi	<ol style="list-style-type: none">a. The keypad lights up in a clockwise pattern.b. The lock automatically enters BLE pairing mode. Note: If the lock exits BLE pairing mode, simply press the Yale logo to restart.c. Open your partner app, and follow the in-app setup instructions. Scan the QR code on the battery compartment when prompted by the app.
Z-Wave/Zigbee	<ol style="list-style-type: none">a. The 1 and ⚙️ are illuminated on the keypad.b. The lock enters programming mode. Follow the instructions in the "Create Programming Code" section (see page 27).c. Follow the instructions in the "Configure Your Lock" section (see page 28-29) to join wireless network and set up your lock.

3. Replace cover.



Bluetooth/Wi-Fi

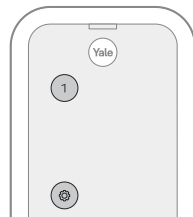

Z-Wave/Zigbee

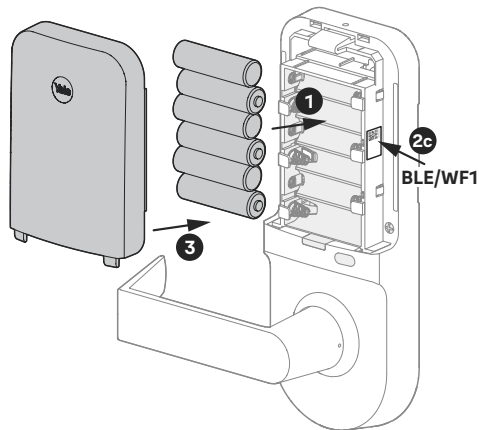

Using Your Lock

Exterior Keypad

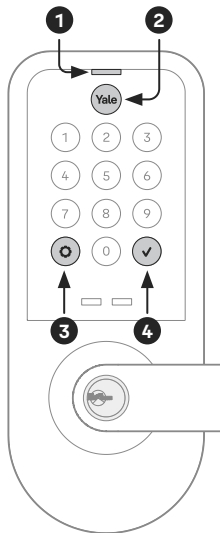

To **lock** your door

Touch or press 

To **unlock** your door

Touch or press 

With entry user code

Enter entry user code →

Press 

Interior Lock

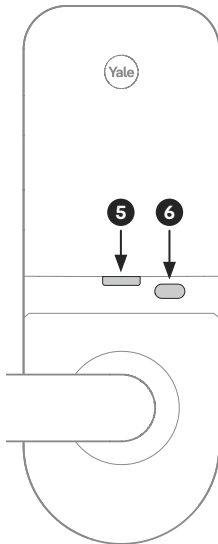

1. Exterior LED Indicator
2. Wake/One-Touch Locking
3. Warnings/Menu
4. Submit Entry Code
5. Interior LED Indicator
6. Passage/Privacy Button

Create Programming Code



Z-Wave/Zigbee: Follow this section to create programming code via keypad.

Bluetooth/Wi-Fi: Follow the instructions on your partner app to create programming code, or follow this section if required by your app.

1. Press and hold the passage/privacy button on the interior lock until the 1 and ⚙ are illuminated on the keypad.





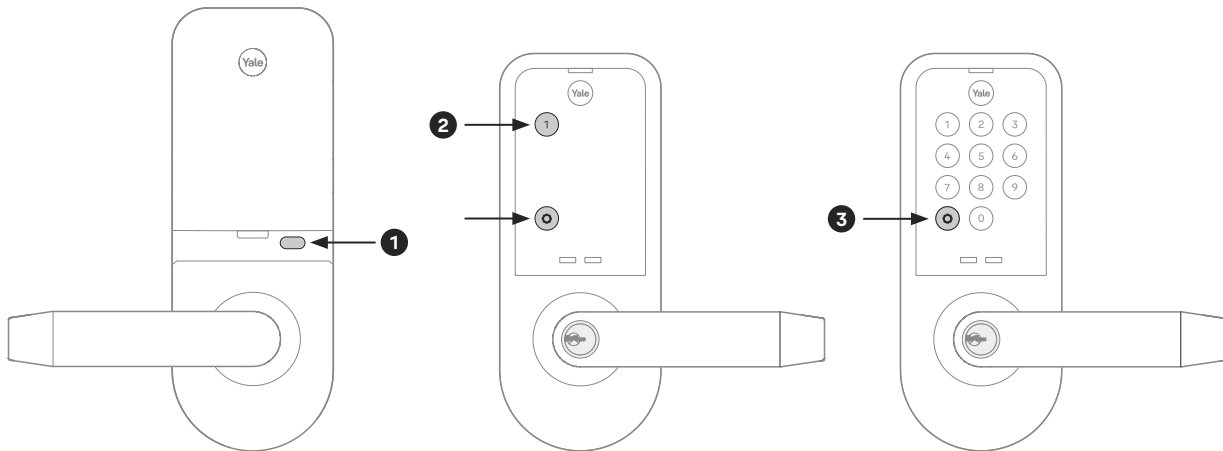





















Note: Skip this step if the 1 and ⚙ are already illuminated.

2. Touch the 1 followed by the ⚙. Enter the settings menu.
3. Enter a 4-8 digit programming code, followed by the ⚙.



Configure Your Lock (Z-Wave/Zigbee Only)

Enter the programming code you just created, and then touch  to enter the settings menu. Choose the setting to change. Enter the digits corresponding to the function to be performed.

Digit	Function	Configuration						
1	 Programming Code Setting	1	 Set Programming Code			Enter a 4-8 digit programming code		
2	 User Code Setting	1	 Create User Codes			Enter a 4-8 digit user code		
		3	 Remove User codes			Enter a 4-8 digit user code		
				0	0	Remove all user codes		
3	 Advanced Settings	1	 Auto Lock	1		Enable, enter a number between 1-180 seconds		
				3		Disable		
		2	 Interior LED Indicator	1		Enable		
				3		Disable		
		3	 One-Touch Lock	1		Enable		
				3		Disable		
		4	 Privacy Mode	1		Enable		
				3		Disable		
		6	 Escape Return Mode	1		Enable		
				3		Disable		

Configure Your Lock (Z-Wave/Zigbee Only)

Digit		Function	Configuration								
			8	⚙️	DoorSense Setting	1	⚙️	Calibrate & Enable DoorSense	1	⚙️	Reset; Calibrate door open status
									2	⚙️	Calibrate door ajar status
									3	⚙️	Calibrate door close status
						3	⚙️	Disable			
4	⚙️	Volume Setting	1	⚙️	High						
			2	⚙️	Low						
			3	⚙️	Silent						
6	⚙️	All Code Lockout	1	⚙️	Enable						
			3	⚙️	Disable						
7	⚙️	Wireless Module Setting	1	⚙️	Join Wireless Network*						
			3	⚙️	Exit Wireless Network						
8	⚙️	BLE Advertising Start		⚙️	Start						

*After you follow the configuration steps for joining wireless network, put your hub into inclusion mode. Lock will automatically timeout once Z-Wave/Zigbee inclusion is completed.

Exterior Keypad Alerts

Gear flashes amber	Low battery level 1
Gear flashes red	Low battery level 2
Gear flashes red, then stays red	Low battery level 3
Gear flashes white	During initial set up

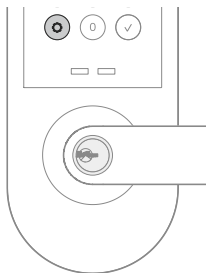

Interior Lock Alerts

LED indicator flashes blue	Low battery levels 1, 2, and 3
LED indicator flashes red	Locked state
LED indicator flashes green	Unlocked state
LED indicator flashes magenta	Passage Mode is on

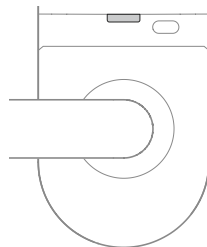

Resetting Your Lock to Factory Defaults



If you have set up your lock with the partner app, you should reset it using the app.

Go to your lock's settings and choose "Factory Reset".

1. Insert the reset pin into the designated hole on the interior handle to remove it.
2. Insert the reset pin into the designated hole above the interior lock to remove the battery cover. Remove one battery.
3. Untighten the screws to remove the interior lock from your door.
4. Insert reset pin into the designated reset hole on the back of the interior lock.
5. Press and hold the reset pin.
6. While holding the reset pin, reinsert battery.
7. Keep holding the reset pin for 5 more seconds.
8. After the keypad numbers light up sequentially from 1, take out the reset pin.

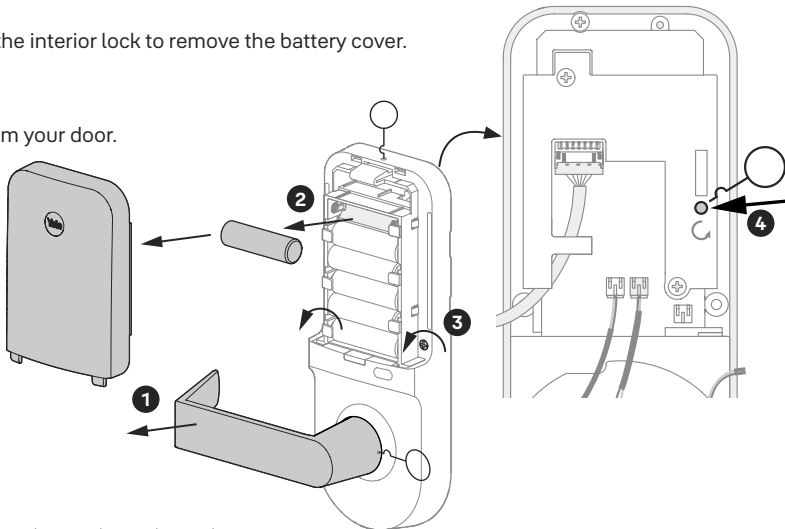

Features

Please note that features and functionality may vary depending on the partner app.

Feature	Definition	Z-Wave/Zigbee	BLE/WF1
Entry Codes	• Entry codes are used to unlock your door. Maximum number of user codes is 500.	✓	✓
	• Entry codes are used to lock your door when One-Touch Lock is disabled.	✓	✓
	• You can set permanent, recurring and temporary entry codes.	✓	✓
DoorSense	• DoorSense keeps track of when your door is closed or open.	✓	✓
Auto-Lock	• Auto-Lock automatically locks the door for you.	✓	✓
	• It can be set to lock on a timer for 1-180 seconds.	✓	✓
	• Auto-Lock is disabled by default.	✓	✓
	• When using the Auto-Lock feature with DoorSense, your door will not lock until it is closed.	✓	✓
	• Auto-Lock can be set up in the lock settings of the app or from the keypad.	✓ (via keypad)	✓ (via app)
Auto-Unlock	• Auto-Unlock knows when you arrive and unlocks the door as you approach.	X	✓
	• Auto-Unlock can be set up in the lock settings of the app.	X	✓

Features

Please note that features and functionality may vary depending on the partner.

Feature	Definition	Z-Wave/Zigbee	BLE/WF1
One-Touch Lock	• Touching or pressing the Yale logo can lock the door.	✓	✓
	• One-Touch Lock is enabled by default.	✓	✓
	• One-Touch Lock can be set up in the lock settings of the app or from the keypad.	✓ (via keypad)	✓ (via app)
All Code Lock Out Mode	• Restrict all entry codes from unlocking the door. When attempting to enter code while in All Code Lock Out Mode, there will be an audible lock response.	✓	✓
	• All Code Lock Out Mode is disabled by default.	✓	✓
	• All Code Lock Out Mode is configured in the lock settings of the app or from the keypad.	✓ (via keypad)	✓ (via app)
Escape Return	• Allow the door to remain unlocked in the case of an emergency.	✓	X
	• Cause the door to automatically unlock upon opening and remain unlocked even if the door swings closed. The locking action requires at least one intentional user interaction to return to the locked state.	✓	X
	• When Escape Return is enabled, Auto Lock and One-Touch Lock are automatically disabled.	✓	X

Features

Please note that features and functionality may vary depending on the partner.

Feature	Definition	Z-Wave/Zigbee	BLE/WF1
Passage Mode	• Use Passage Mode when you want to disable Auto-Lock for an extended period of time.	✓	✓
	• Passage Mode is enabled by default.	✓	✓
	• Passage Mode is configured through programming code from the keypad.	✓	X
	• The passage/privacy button operates based on the settings for each mode.	✓	✓
Privacy Mode	• Use Privacy Mode when you want to disable all keypad functions for an extended period of time.	✓	✓
	• Privacy Mode is disabled by default.	✓	✓
	• Privacy Mode is configured through the programming code from the keypad.	✓	✓
	• The passage/privacy button operates based on the settings for each mode.	✓	✓
	• Privacy Mode duration ends when door is opened and a sound indicates Privacy Mode is disabled.	✓	✓
Tamper Alert	• Audible alarm sounds if attempting to forcibly remove outside lock from door.	✓	✓

Features

Please note that features and functionality may vary depending on the partner.

Feature	Definition	Z-Wave/Zigbee	BLE/WF1
Wrong Code Entry Limit	<ul style="list-style-type: none">After the set number (Default: 3) of unsuccessful attempts at entering a valid entry code, the lock will not accept a code for the duration of the shut down time. The keypad will flash, and a red gear button will be at the bottom of the keypad.	✓	✓
	<ul style="list-style-type: none">The keypad will be available after the shut down time ends.	✓	✓
	<ul style="list-style-type: none">The wrong code entry limit can be changed via your partner app.	✓	✓
Shut Down Time	<ul style="list-style-type: none">Shut down for the set period of time (Default: 60 seconds) and will not allow operation until this time period ends.	✓	✓
	<ul style="list-style-type: none">When the unit is in shut down mode, the keypad will be flashing.	✓	✓
	<ul style="list-style-type: none">The shut down time can be changed via your partner app.	✓	✓
Volume Setting Mode	<ul style="list-style-type: none">The volume setting for entry code verification and passage/privacy button is set to High (1) by default.	✓	✓
	<ul style="list-style-type: none">The volume can be set to Low (2) or Silent (3) for quiet areas from the keypad or your partner app.	✓	✓
	<ul style="list-style-type: none">Menu setting and warning sounds are set to High (1) regardless of the volume setting.	✓	✓

Lock Operations Troubleshooting

Symptom	Suggested Action
Lock does not respond. There are no lights or chimes and there is no mechanical sound indicating latch bolt movement.	<ul style="list-style-type: none">• Touch Yale logo to activate the keypad.• If keypad numbers are visible, check if they respond when pressed.• Check that batteries are installed and oriented correctly (polarity). Replace batteries if needed*.• Check that the keypad wire is fully connected and not pinched.
Lock does not respond – door is locked and unaccessible.	<ul style="list-style-type: none">• Batteries may not have enough power. Replace batteries*.• Use mechanical key to unlock the door.• Apply 9V battery to terminals on the keypad for emergency power jump option.
Lock is on for a while then shows no reaction. Lights dim.	<ul style="list-style-type: none">• Batteries do not have enough power. Replace batteries*.
Lock chimes indicating code acceptance but door will not open.	<ul style="list-style-type: none">• Check for any foreign objects between door and frame.• Check that the wire is firmly connected to the interior lock.
Lock operates to allow access but will not automatically re-lock.	<ul style="list-style-type: none">• Ensure Auto-Lock Mode is enabled by Master user.• Replace batteries*.• Ensure Passage Mode is disabled.• Ensure Escape Return mode is disabled.

* After replacing your batteries, it's highly recommended to use your app to lock or unlock your device. This will allow the app to connect to the lock to ensure that the internal time of the device is correct.

Symptom	Suggested Action
Gear button flashes on the keypad.	<ul style="list-style-type: none"> • This is the alert to replace the batteries. Replace all six (6) batteries with new AA alkaline batteries*.
Entry code will not register.	<ul style="list-style-type: none"> • If low battery indicator is lit, replace batteries*. • Verify that your user code consists of 4 to 8 digits. • User code may already be registered. • User code must be entered within 30 seconds (while the keypad is active) or process will have to be restarted. • ✓ or ⚙ cannot be used as part of the user code.
Upon entering an entry code and pressing the Check key, the lock displays error or lock times out without responding.	<ul style="list-style-type: none"> • Ensure All Code Lockout Mode is disabled by Master user. • The digits entered were incorrect or incomplete. Re-enter 4-8 digits followed by ✓. • Master user may have deleted the user code. • User code must be entered within 7 seconds (while the keypad is active) or process will have to be restarted.
Lock operates but makes no sound.	<ul style="list-style-type: none"> • Check if volume is set to Silent by Master user.
DoorSense does not work.	<ul style="list-style-type: none"> • Check for "Step 12a - Install DoorSense" on page 20.

* After replacing your batteries, it's highly recommended to use your app to lock or unlock your device. This will allow the app to connect to the lock to ensure that the internal time of the device is correct.

Symptom	Suggested Action
Door is binding.	<ul style="list-style-type: none">• Check that the door and the frame are properly aligned and the door is free swinging.• Check hinges: They should not be loose or have excessive wear on knuckles.
Bolt will not deadlock.	<ul style="list-style-type: none">• Check for sufficient clearance of the bolt within the strike-side jamb. Correct this by increasing the depth of the pocket for the bolt.• Check for misalignment of bolt and/or strike which may be preventing bolt from properly entering the strike. With the door open, extend and retract the bolt; if it is smooth, check the strike alignment.
Bolt does not extend or retract smoothly.	<ul style="list-style-type: none">• Bolt and strike are misaligned, see above.• Check the backset of door relative to adjustments already made to bolt.• Verify proper door preparation and re-bore holds that are too small or misaligned.• Verify keypad wire harness is routed properly (see step 9).
Keypad numerics are scrolling.	<ul style="list-style-type: none">• Remove interior lock:<ol style="list-style-type: none">a. Check that wire terminals are securely connected.b. Check that wire harness lies flat against mounting plate and is routed through wire hook on mounting plate so cable is not pinched at any point.

Use:

Use of the Works with Apple badge means that an accessory has been designed to work specifically with the technology identified in the badge and has been certified by the developer to meet Apple performance standards.

Apple is not responsible for the operation of this device or its compliance with safety and regulatory standards.

Apple®, Apple Home™, Apple Watch®, HomeKit®, and iPhone® are trademarks of Apple Inc., registered in the U.S. and other countries and regions.

Google, Google Play and Google Home are trademarks of Google LLC.

Amazon, Alexa and all related logos are trademarks of Amazon.com, Inc. or its affiliates.

Wi-Fi is a registered trademark of Wi-Fi Alliance®.

The Bluetooth® word mark and logos are registered trademarks owned by Bluetooth SIG, Inc. and any use of such marks by Yale is under license. Other trademarks and trade names are those of their respective owners.

FCC and IC RF Radiation Exposure Statement: This equipment complies with FCC and IC RF Radiation exposure limits set forth for an uncontrolled environment. This device and its antenna must not be co-located or operating in conjunction with any other antenna or transmitter. This equipment should be installed and operated with a minimum distance of 20 cm between the radiator and your body.

RF du FCC et IC d'exposition aux radiations: Cet équipement est conforme à l'exposition de FCC et IC rayonnements RF limites établies pour un environnement non contrôlé. L'antenne pour ce transmetteur ne doit pas être même endroit avec d'autres émetteur sauf conformément à FCC et IC procédures de produits Multi-émetteur. Cet équipement doit être installé et utilisé avec une distance minimale de 20 cm entre le radiateur et votre corps.

FCC:

FCC ID: MZR-YMB624

FCC Part 15.19 This device complies with Part 15 of the FCC Rules. Operation is subject to the following two conditions: (1) This device may not cause harmful interference, and (2) this device must accept any interference received, including interference that may cause undesired operation

FCC Part 15.21 Any changes or modifications (including the antennas) to this device that are not expressly approved by the manufacturer may void the user's authority to operate the equipment

Class B Equipment

This equipment has been tested and found to comply with the limits for a Class B digital device, pursuant to Part 15 of the FCC Rules. These limits are designed to provide reasonable protection against harmful interference in a residential installation. This equipment generates, uses, and can radiate radio frequency energy and, if not installed and used in accordance with the instructions, may cause harmful interference to radio communications. However, there is no guarantee that interference will not occur in a particular installation. If this equipment does cause harmful interference to radio or television reception, which can be determined by turning the equipment off and on, the user is encouraged to try to correct the interference by one or more of the following measures:

- Reorient or relocate the receiving antenna.
- Increase the separation between the equipment and receiver.
- Connect the equipment into an outlet on a circuit different from that to which the receiver is connected.
- Consult the dealer or an experienced radio/TV technician for help.
- Distance between EUT and users is 20 cm.

Warning:

Changes or modifications to this device, not expressly approved by **Yale Home** could void the user's authority to operate the equipment.

Industry Canada:

IC ID: 2676A-YMB624

This Class A digital apparatus meets all requirements of the Canadian Interference Causing Equipment Regulations.

This device contains licence-exempt transmitter(s)/receiver(s) that comply with Innovation, Science and Economic Development Canada's licence-exempt RSS(s). Operation is subject to the following two conditions:

- (1) This device may not cause interference.
- (2) This device must accept any interference, including interference that may cause undesired operation of the device.

L'émetteur/récepteur exempt de licence contenu dans le présent appareil est conforme aux CNR d'Innovation, Sciences et Développement économique Canada applicables aux appareils radio exempts de licence. L'exploitation est autorisée aux deux conditions suivantes:

- (1) L'appareil ne doit pas produire de brouillage;
- (2) L'appareil doit accepter tout brouillage radioélectrique subi, même si le brouillage est susceptible d'en compromettre le fonctionnement.

CAN ICES-3 (B) / NMB-3 (B)

Yale Home

24/7 Support: 1-855-213-5841 • support.shopyalehome.com

Yale® and Pro® 2 are registered trademarks of Master Lock Company LLC and its affiliates. Other products' brand names may be trademarks or registered trademarks of their respective owners and are mentioned for reference purposes only. ©Copyright 2025. All rights reserved. Reproduction in whole or in part without the express written permission of Master Lock Company LLC or its affiliates is prohibited.

Trusted Every Day

P/N YMB614/YMB624/YMB634/YMB644